

Fitting Instructions

Clean the door and the door frame thoroughly. It is **essential** that surfaces are clean and free from silicone or polish.

The flexible cover has self adhesive strip on faces which attach to the door and door frame. Before fitting you should remove pink cover from adhesive strip.

Ensure adhesive is firmly pressed into place. Measure door height and trim flexible cover if necessary. Allow a gap of 10mm at top and bottom of door.

For easy maintenance screw fix channel at 400mm centres with screws provided. Each pack contains: 1 x channel

To fit Little Fingers Rear Hinge Cover follow the simple instructions below:

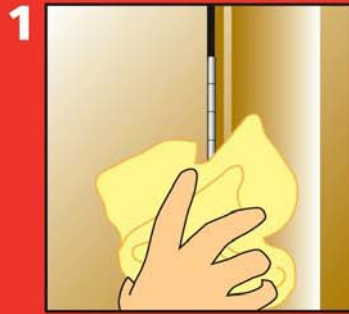

Clean the door and door frame thoroughly.

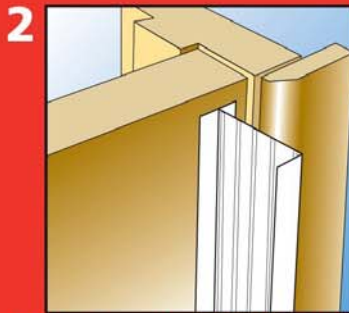

With door shut, stick 'T' shape section of cover to the hinge edge of the door.

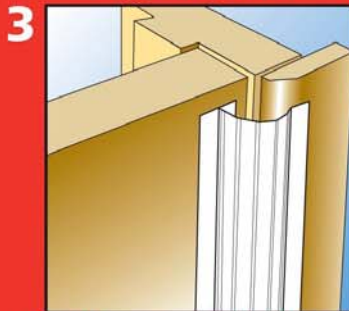

With door shut, stick 'L' shape section of cover to the door frame / architrave.



If necessary fix dome head screws through edge profiles.