

Tumbledrier Ducting Kit Fixing Instructions

1703

1. Select a suitable position in an external wall for your tumbledrier outlet. Prepare a 112mm diameter hole through the wall.
2. Extend the flexible aluminium ducting to the width of the wall and insert into the hole. Make good if necessary. See Diagram 1.
3. Fit the external grille by pushing the spigot into the aluminium ducting. Fix to the wall using the screws and wall plugs provided. See diagrams 2 & 3.
4. Insert the connector into the ducting on the internal side of the wall and secure the wall plate using the screws provided. See diagram 4.
5. Fix the p.v.c. flexible ducting to the wall plate using the plastic tie provided. See diagram 5.
6. Clean around the outlet of the tumbledrier to remove any dust and dirt, using a cloth moistened with methylated spirits.
7. Remove the backing from the white self adhesive foam disk. Carefully slide it over the spigot until it has stuck to the flange.

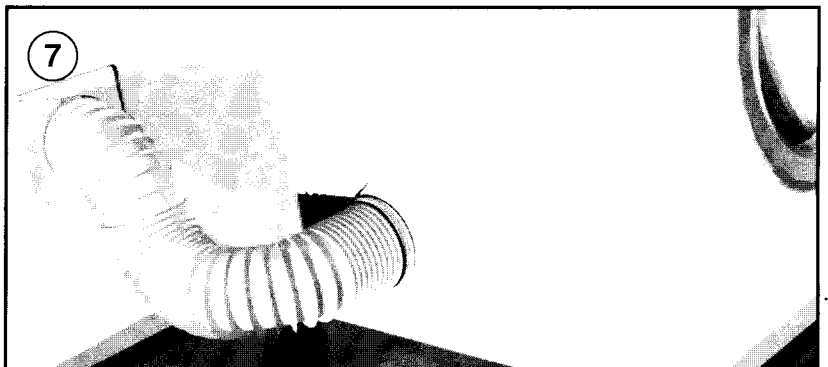
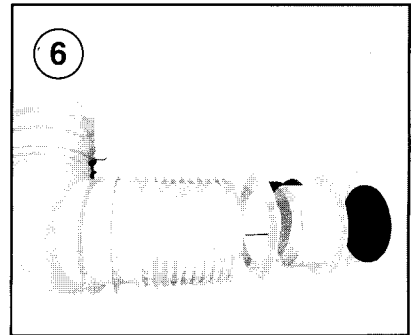
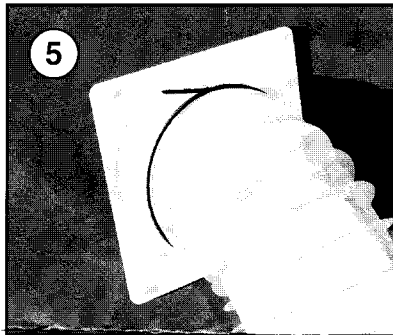
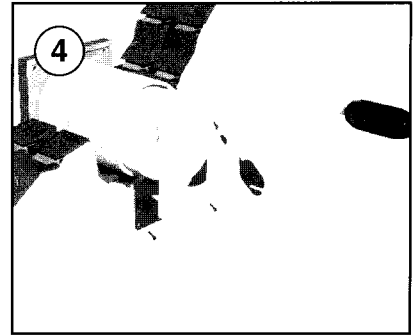
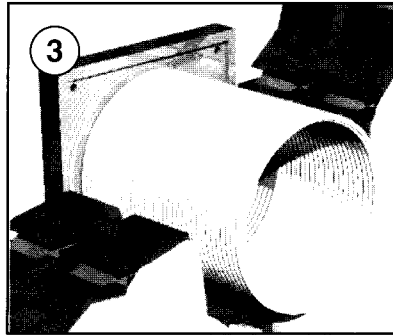
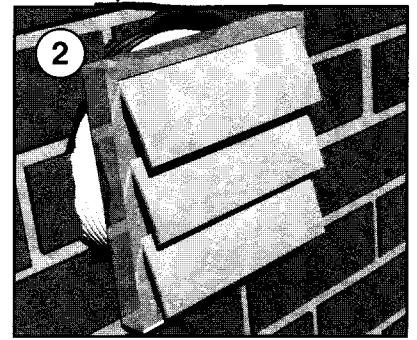
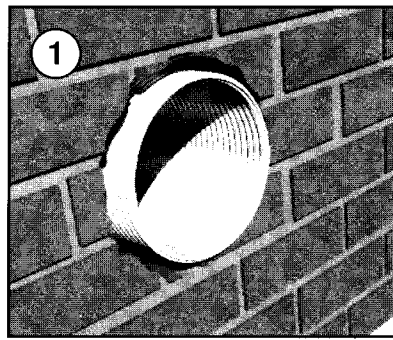

Position the spigot over the outlet of the tumbledrier pushing the adhesive disk and flange hard onto the metal surface of the drier until it has bonded securely. See diagram 6.

NOTE

Leave the disk to bond for 24 hours before using the appliance.

8. Connect the p.v.c. ducting by gently pushing it into the mounting spigot. Secure using the plastic ties provided. See diagram 7.

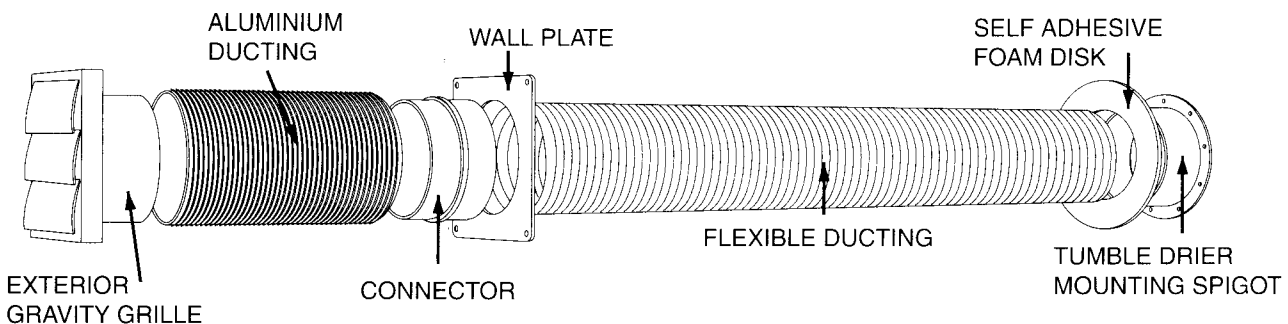

Screwfix Direct, Houndstone Business Park, Yeovil, BA22 8RT
Telephone: 0870 010 41 41 Fax: 01935 414000