

Step by Step Installation Guide - UNDERGROUND DRAINAGE



1

- ✓ Dig your trench to the British Standards and Building Regulations.



2

- ✓ To ensure the pipe is supported correctly, drop in pea shingle to form the pipe bed.



3

- ✓ Plan out where the major fittings will sit. Ensure the inspection chamber is aligned so that the flow of water is maintained through the main channel to minimise any potential blockages.

FloPlast Inspection Chambers have unique 10° flexible joints which make fitting both quicker and easier.



4

- ✓ If fitting to a vertical soil and ventilation pipe, it is important to place a solid support under the long radius rest bend.

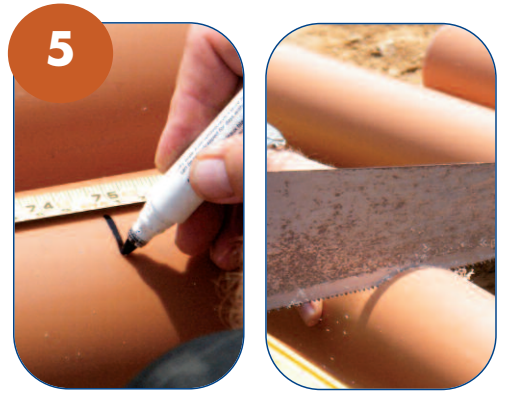

5

- ✓ Measure and cut the length of pipe that joins the rest bend to the first Inspection Chamber.



6

- ✓ Ensure all cut lengths of pipe are chamfered to roughly a 45° angle.



7

- ✓ Join the first piece of pipe using a spray or gel silicone lubricant on the seal to ease fitting.
- ✓ Repeat the previous procedure for all the remaining fittings.



8

- ✓ Traps, bottle gullies and other available fittings can be added to the system accordingly.

Step by Step Installation Guide - UNDERGROUND DRAINAGE



- ✓ Soil and ventilation pipes connect straight into the long radius bend.



- ✓ Rainwater downpipes connect to the system via a Universal Rainwater Adaptor.



- ✓ To complete the installation of Inspection Chambers, add risers to the required depth.



- ✓ Mini Access Chambers can be added up to a maximum height of 600mm.
- ✓ Large Inspection Chambers can be up to 1.2m in height with the standard 450mm frame and lid.
- ✓ Up to 3m using a 350mm reduced access frame and lid.



- ✓ Backfill with pea shingle up to the crown of the pipework, and then backfill using the dug out soil.

For additional installation advise, please check our website:

www.floplast.co.uk