

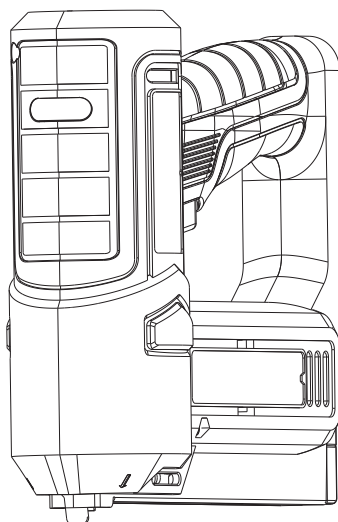

EN

TITAN

3.6 V Cordless 12mm Stapler



Original Instructions_MNL_TTB960STP_GB_V2_230628

TTB960STP

EAN: 5063022074256

CAUTION: Read the instructions before using the product.



BX220IM

Let's get started...

These instructions are for your safety. Please read through them thoroughly prior to handling the product and retain them for future reference.



Getting started... 02

Safety information	03
Your product	18
Technical specifications	19
Before you start	20



In more detail... 24

Functions & Settings	25
Operation	27
Care and maintenance	29
Troubleshooting	32
Recycling and disposal	33
Guarantee	34
Declaration of conformity	35

Safety information

General power tool safety warnings



WARNING! Read all safety warnings, instructions, illustrations and specifications provided with this power tool. *Failure to follow all instructions listed below may result in electric shock, fire and/or serious injury.*

Save all warnings and instructions for future reference.

The term “power tool” in the warnings refers to your mains-operated (corded) power tool or battery-operated (cordless) power tool.

Work area safety

- a) **Keep work area clean and well lit.** *Cluttered or dark areas invite accidents.*
- b) **Do not operate power tools in explosive atmospheres, such as in the presence of flammable liquids, gases or dust.** *Power tools create sparks which may ignite the dust or fumes.*
- c) **Keep children and bystanders away while operating a power tool.** *Distractions can cause you to lose control.*

Electrical safety

- a) **Power tool plugs must match the outlet. Never modify the plug in any way. Do not use any adapter plugs with earthed (grounded) power tools.** *Unmodified plugs and matching outlets will reduce risk of electric shock.*

Getting started...

Safety information

- b) **Avoid body contact with earthed or grounded surfaces, such as pipes, radiators, ranges and refrigerators.** *There is an increased risk of electric shock if your body is earthed or grounded.*
- c) **Do not expose power tools to rain or wet conditions.** *Water entering a power tool will increase the risk of electric shock.*
- d) **Do not abuse the cord. Never use the cord for carrying, pulling or unplugging the power tool. Keep cord away from heat, oil, sharp edges or moving parts.** *Damaged or entangled cords increase the risk of electric shock.*
- e) **When operating a power tool outdoors, use an extension cord suitable for outdoor use.** *Use of a cord suitable for outdoor use reduces the risk of electric shock.*
- f) **If operating a power tool in a damp location is unavoidable, use a residual current device (RCD) protected supply.** *Use of an RCD reduces the risk of electric shock.*

Personal safety

- a) **Stay alert, watch what you are doing and use common sense when operating a power tool. Do not use a power tool while you are tired or under the influence of drugs, alcohol or medication.** *A moment of inattention while operating power tools may result in serious personal injury.*
- b) **Use personal protective equipment. Always wear eye protection.** *Protective equipment such as dust mask, non-skid safety shoes, hard hat, or hearing protection used for appropriate conditions will reduce personal injuries.*

- c) **Prevent unintentional starting. Ensure the switch is in the off-position before connecting to power source and/or battery pack, picking up or carrying the tool.** *Carrying power tools with your finger on the switch or energising power tools that have the switch on invites accidents.*
- d) **Remove any adjusting key or wrench before turning the power tool on.** *A wrench or a key left attached to a rotating part of the power tool may result in personal injury.*
- e) **Do not overreach. Keep proper footing and balance at all times.** *This enables better control of the power tool in unexpected situations.*
- f) **Dress properly. Do not wear loose clothing or jewellery. Keep your hair and clothing away from moving parts.** *Loose clothes, jewellery or long hair can be caught in moving parts.*
- g) **If devices are provided for the connection of dust extraction and collection facilities, ensure these are connected and properly used.** *Use of dust collection can reduce dust-related hazards.*
- h) **Do not let familiarity gained from frequent use of tools allow you to become complacent and ignore tool safety principles.** *A careless action can cause severe injury within a fraction of a second.*

Power tool use and care

- a) **Do not force the power tool. Use the correct power tool for your application.** *The correct power tool will do the job better and safer at the rate for which it was designed.*
- b) **Do not use the power tool if the switch does not turn it on and off.** *Any power tool that cannot be controlled with the switch is dangerous and must be repaired.*

Safety information

- c) **Disconnect the plug from the power source and/ or remove the battery pack, if detachable, from the power tool before making any adjustments, changing accessories, or storing power tools.** *Such preventive safety measures reduce the risk of starting the power tool accidentally.*
- d) **Store idle power tools out of the reach of children and do not allow persons unfamiliar with the power tool or these instructions to operate the power tool.** *Power tools are dangerous in the hands of untrained users.*
- e) **Maintain power tools and accessories. Check for misalignment or binding of moving parts, breakage of parts and any other condition that may affect the power tool's operation. If damaged, have the power tool repaired before use.** *Many accidents are caused by poorly maintained power tools.*
- f) **Keep cutting tools sharp and clean.** *Properly maintained cutting tools with sharp cutting edges are less likely to bind and are easier to control.*
- g) **Use the power tool, accessories and tool bits etc. in accordance with these instructions, taking into account the working conditions and the work to be performed.** *Use of the power tool for operations different from those intended could result in a hazardous situation.*
- h) **Keep handles and grasping surfaces dry, clean and free from oil and grease.** *Slippery handles and grasping surfaces do not allow for safe handling and control of the tool in unexpected situations.*

Battery tool use and care

- a) **Recharge only with the charger specified by the manufacturer.** *A charger that is suitable for one type of battery pack may create a risk of fire when used with another battery pack.*
- b) **Use power tools only with specifically designated battery packs.** *Use of any other battery packs may create a risk of injury and fire.*
- c) **When battery pack is not in use, keep it away from other metal objects, like paper clips, coins, keys, nails, screws or other small metal objects that can make a connection from one terminal to another.** *Shorting the battery terminals together may cause burns or a fire.*
- d) **Under abusive conditions, liquid may be ejected from the battery; avoid contact. If contact accidentally occurs, flush with water. If liquid contacts eyes, additionally seek medical help.** *Liquid ejected from the battery may cause irritation or burns.*
- e) **Do not use battery pack or tool that is damaged or modified.** *Damaged or modified batteries may exhibit unpredictable behaviour resulting in fire, explosion or risk of injury.*
- f) **Do not expose a battery pack or tool to fire or excessive temperature.** *Exposure to fire or temperature above 130 °C may cause explosion.*
- g) **Follow all charging instructions and do not charge the battery pack or tool outside the temperature range specified in the instructions.** *Charging improperly or at temperatures outside the specified range may damage the battery and increase the risk of fire.*

Safety information

Service

- a) **Have your power tools serviced by a qualified repair person using only identical replacement parts.** *This will ensure that safety of the power tool is maintained.*
- b) **Never service damaged battery packs.** *Service of battery packs should only be performed by the manufacturer or authorized service providers.*

Stapler safety warnings

- a) **Always assume that the tool contains fasteners.** *Careless handling of the stapler can result in unexpected firing of fasteners and personal injury.*
- b) **Do not point the tool towards yourself or anyone nearby.** *Unexpected triggering will discharge the fastener causing an injury.*
- c) **Do not actuate the tool unless the tool is placed firmly against the workpiece.** *If the tool is not in contact with the workpiece, the fastener may be deflected away from your target.*
- d) **Disconnect the tool from the power source when the fastener jams in the tool.** *While removing a jammed fastener, the stapler may be accidentally activated if it is plugged in.*
- e) **Use caution while removing a jammed fastener.** *The mechanism may be under compression and the fastener may be forcefully discharged while attempting to free a jammed condition.*
- f) **Do not use this stapler for fastening electrical cables.** *It is not designed for electric cable installation and may damage the insulation of electric cables thereby causing electric shock or fire hazards.*

- g) **Use suitable detectors to determine if there are hidden supply lines or contact the local utility company for assistance.** *Contact with electric cables can cause fire and electric shock. Damaging gas lines can lead to explosion. Breaking water pipes causes property damage.*
- h) **Switch the product off when loading and unloading fasteners, making adjustments or changing accessories.** *The tool may be accidentally activated if it is connected to the power source, which may result in personal injury.*
- i) **Be careful when handling fasteners, especially when loading and unloading.** *The fasteners have sharp points which may result in personal injury.*
- j) **Keep fingers away from the trigger when not operating the tool and when moving from one operating position to another.** *Unexpected triggering will discharge a fastener, which may result in personal injury.*
- k) **Hold the tool by insulated gripping surfaces, when performing an operation where the fastener may contact hidden wiring.** *A fastener contacting a “live” wire may make exposed metal parts of the tool “live” and could give the operator an electric shock.*
- l) **Hold the tool with a firm grasp during operation.** *Uncontrolled recoil of the tool may result in unintended activation, which may result in personal injury.*
- m) **Keep all body parts such as hands and legs, etc. away from the firing direction of the tool.** *The fastener may penetrate the workpiece as well as any object behind it, which may result in personal injury.*

Safety information

- n) **When using the tool, keep all body parts such as hands and legs, etc. away from the area where the fastener is driven into the workpiece. The fastener could deflect and exit the workpiece, which may result in personal injury.**
- o) Hold the product only by the handle grip (5) and ensure that the main trigger (4) is not pressed down in the work area.
- p) Consider the space that is available in the work area. Staples may penetrate thin workpieces or slide off workpieces during work on corners and edges, thus endangering person.
- q) Read the instructions carefully. Be familiar with the controls and the correct use of the product.
- r) Use the product only in daylight or good artificial light.
- s) Never allow children or people unfamiliar with these instructions to use the product. Local regulations can restrict the age of the operator.
- t) Keep in mind that the operator or user is responsible for accidents or hazards occurring to other people or their property.
- u) Keep the area clear of all bystanders, children, and pets while operating the product.
- v) Switch the product off before carrying out maintenance or cleaning work.
- w) Use only the manufacturer's recommended accessories.
- x) Inspect and maintain the product regularly. Have the product repaired only by an authorized repairer.
- y) When not in use, store the product out of the reach of children.
- z) Store the product in a location where the ambient temperature is between 0 °C and 40 °C.

Safety warnings specific for power adaptor



WARNING! Read all safety warnings, instructions, illustrations and specifications. Failure to follow all instructions listed below may result in electric shock, fire and/or serious injury.

Save all warnings and instructions for future reference.

- a) This appliance can be used by children aged from 8 years and above and persons with reduced physical, sensory or mental capabilities or lack of experience and knowledge if they have been given supervision or instruction concerning use of the appliance in a safe way and understand the hazards involved. Children shall not play with the appliance. Cleaning and user maintenance shall not be made by children without supervision.
- b) Only charge the appliance specified in this instruction manual through the delivered USB charger cable.
- c) Do not charge any batteries.
- d) Disconnect the power adaptor from the power supply and allow it to cool down before cleaning, maintenance, storage and transportation.
- e) Protect the electrical parts against moisture. Do not immerse such parts in water or other liquids to avoid electrical shock. Never hold the power adaptor under running water. Read the instructions provided in the chapter "Care and maintenance".
- f) Before using the power adaptor, read all the instructions and cautionary markings on the power adaptor
- g) Only use the power adaptor charging the appliance indoors as the power adaptor is designed for indoor use only.

Getting started...

Safety information

- h) Do not place any object on top of the power adaptor as it could cause overheating. Do not place the power adaptor near any heat source.
- i) Do not use the power adaptor if it has been subjected to a heavy knock, dropped or otherwise damaged in any way. Have the power adaptor checked and repaired by an authorised service centre.
- j) Do not disassemble the power adaptor. Incorrect re-assembly may result in the risk of fire, electric shock or electrocution.
- k) To reduce the risk of damage to the charger cable and plug, always pull the plug rather than the charger cable when disconnecting the power adaptor from power supply.

Additional safety warnings for built-in battery

- a) **Battery needs to be charged before use.** *Always refer to the power adaptor's instruction and charge it properly.*
- b) **Remove the USB charger cable from the product after the finish of charging.**
- c) **Don't maintain the battery on the charger when not in use.**
- d) **After extended periods of storage, it may be necessary to charge and discharge the battery several times to obtain the maximum performance.**
- e) **Longer life and better performance can be obtained if the battery is charged when the air temperature is between 18 °C and 24 °C.** *Do not charge the battery in air temperature below 5 °C or above 40 °C. This is important as it can prevent serious damage to the battery.*

- f) **Do not charge battery in a damp or wet location.** *Following this rule will reduce the risk of electric shock.*
- g) **Do not disassemble the battery and avoid mechanical damage to the battery. Risk of short circuit and fumes may be emitted.** *Ensure fresh air and seek medical assistance in the event of discomfort.*
- h) **When disposing of battery, keep the battery of different electrochemical systems separate from each other.**

Health surveillance

All employees should be part of an employer's health surveillance scheme to help identify any vibration related diseases at an early stage, prevent disease progression and help employees stay in work.

Vibration and noise reduction

To reduce the impact of noise and vibration emission, limit the time of operation, use low-vibration and low-noise operating modes as well as wear personal protective equipment.

Take the following points into account to minimise the vibration and noise exposure risks:

1. Only use the product as intended by its design and these instructions.
2. Ensure that the product is in good condition and well maintained.
3. Use correct attachments for the product and ensure they are in good condition.
4. Keep tight grip on the handles/grip surface.
5. Maintain this product in accordance with these instructions and keep it well lubricated (where appropriate).
6. Plan your work schedule to spread any high vibration tool use across a longer period of time.

Safety information

7. Prolonged use of the product exposes the user to vibrations that can cause a range of conditions collectively known as hand-arm vibration syndrome (HAVS) e.g. fingers going white; as well as specific diseases such as carpal tunnel syndrome. To reduce this risk when using the product, always wear protective gloves and keep your hands warm.

Emergency

Familiarise yourself with the use of this product by means of this instruction manual. Memorise the safety directions and follow them to the letter. This will help to prevent risks and hazards.

1. **Always be alert when using this product, so that you can recognise and handle risks early.** *Fast intervention can prevent serious injury and damage to property.*
2. **Switch the product off if there are malfunctions.** *Have the product checked by a qualified professional and repaired, if necessary, before you operate it again.*

Residual risks

Even if you are operating this product in accordance with all the safety requirements, potential risks of injury and damage remain. The following dangers can arise in connection with the structure and design of this product:

1. Crushing hazard.
2. Risk of injury by staples.
3. Ear damage if working without ear protection.
4. Health defects resulting from vibration emission if the product is being used over long periods of time or not adequately managed and properly maintained.









5. Injuries and damage to property due to broken attachments or the sudden impact of hidden objects during use.



WARNING! This product produces an electromagnetic field during operation! This field may under some circumstances interfere with active or passive medical implants! To reduce the risk of serious or fatal injury, we recommend persons with medical implants to consult their doctor and the medical implant manufacturer before operating this product!

Symbols

On the product, the rating label and within these instructions you will find among others the following symbols and abbreviations. Familiarise yourself with them to reduce hazards like personal injuries and damage to property.

V \equiv	Volt, (direct current voltage)	mAh	Milliampere per hour
V \sim	Volt, (alternating voltage)	Hz	Hertz
W	Watt	A	Ampere
/min or min ⁻¹	Per minute	mAh	Milliampere per hour
g	Gram	kg	Kilogram
mm	Millimetre	m	Metre
dB(A)	Decibel (A-rated)	m/s ²	Metres per second squared
°C	Degree Celsius		Short-circuit-proof safety isolating transformer
	Lock / to tighten or secure.		Unlock / to loosen.
	Read the instruction manual.		Note / Remark.
			Caution / Warning.
	SMPS (Switch mode power supply unit)		
	This symbol describes the USB port's polarity: negative (-), positive (+).		
IPX0	Protection against ingress of the solid foreign objects having a diameter of 12.5 mm and greater.		

Getting started...

Symbols

yyWxx Manufacturing date code; year of manufacturing (20yy) and week of manufacturing (Wxx)



Always wear hearing protection.



Always wear eye protection.



Wear a dust mask.



Wear face shield.



Wear protective gloves.



Wear protective, slip-resistant footwear.



This power adaptor is of protection class II. That means it is equipped with enhanced or double insulation.



This product is of protection class III.



Only charge the product by the power adaptor indoors. Only use the product indoors.



To indicate that the power supply unit shall not be used, if pins of the plug part are damaged.



Switch the product off before assembly, cleaning, adjustments, maintenance, storage and transportation.



Do not expose the product to rain or wet conditions (moisture).



To prevent serious injury, keep your hands away from shot duct (15b)!



LED indicator for visual guide of the product.



Ejected staples by the product could hit the user or other bystanders. Always ensure that other people and pets remain at a safe distance from the product when it is in operation. In general, children must not come near the area where the product is. Minimum distance is 10 m.



WEEE symbol. Waste electrical products should not be disposed of with household waste. Please recycle where facilities exist. Check with your Local Authority or local store for recycling advice.



Crossed out dust bin. Battery should not be disposed of with household waste. Please recycle where facilities exist. Check with your Local Authority or local store for recycling advice.



Do not dispose of battery in rivers or immerse in water.



Do not dispose of battery in fire. They will explode and cause injury.



Do not expose battery to heat in excess of 40 °C.
Do not charge or store the battery in temperatures below 5 °C (41 °F) and above 40 °C (104 °F).



The product complies with the applicable European directives and an evaluation method of conformity for these directives was done.

UK Conformity Assessed.

Rating label explanation

Model Number: TTB960STP

TT = TITAN (brand)
B = Voltage (230-240V~)
960 = Sequential code
STP = Stapler

Charger: TTB993CHR

TT = TITAN (brand)
B = Voltage (230-240V~)
993 = Sequential code
CHR = Charger

Getting started...

Product description

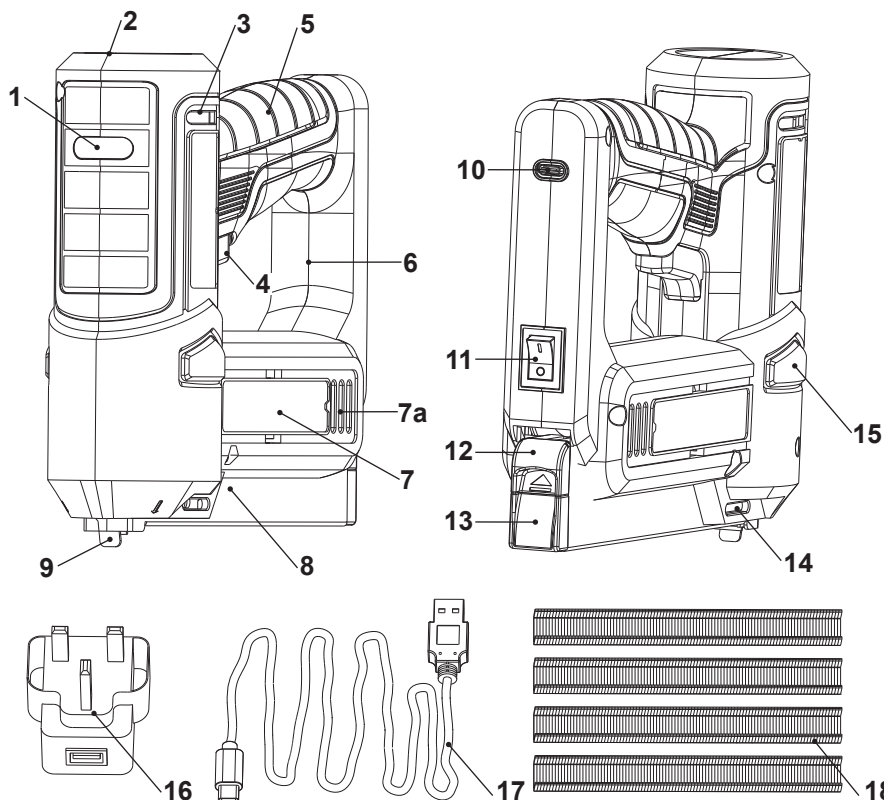

- | | | |
|--|-----------------------------------|--|
| 1. Power / Charger indicator | 7. Motor housing
a) Air vents* | 12. Magazine release button |
| 2. Top housing | 8. Magazine | 13. Pull lever |
| 3. Air vents | a) Magazine slider | 14. Check window (x2) |
| 4. Main trigger | 9. Safety yoke | 15. Side support (x2) |
| 5. Handle grip
a) Built-in battery* | 10. Type-C USB port | 16. Power adaptor |
| 6. Rear grip | 11. On/off switch | 17. USB charger cable |
| | | 18. Staple strip (12 mm
x 84 pcs staples) x4) |



NOTE: Parts marked with * are not shown in this overview. Please refer to the respective part in the instruction manual.

Technical specifications

General

- > **Rated voltage** : 3.6V 
- > **Impact rate** : Up to 30 min⁻¹
- > **Magazine volume** : Up to 84 staples
- > **Degree of protection** : IP20
- > **Weight** : approx. 1.16 kg
- > **Dimensions** : approx. 200*80*65 mm

Staple strip

- > **Type** : 20 Ga
- > **Width** : 10.6 mm to 10.7 mm
- > **Usable length** : 6 / 8 / 10 / 12 mm

Built-in battery

- > **Voltage** : 3.6 V 
- > **Capacity** : 1500 mAh

Power adaptor

- > **Model no.** : TTB993CHR
- > **Rated input** : 100-240 V~, 50-60 Hz, 10W
- > **Rated output** : 5 V d.c., 1 A
- > **Charging time** : approx. 1.5 -2 h
- > **Ambient temperature range for charger and battery use** : 5 °C to 40 °C

Hand arm vibration values

- > **Handle a_{h,w}** : 1.9 m/s²
- > **Uncertainty K** : 1.5 m/s²

The sound value(s) have been determined according to noise test code given in EN 60745-2-16, using the basic standards EN ISO 11201 and EN ISO 3744.

The sound intensity level for the operator may exceed 80 dB(A) and ear protection measures are necessary.

The declared total vibration value(s) and the declared noise emission value(s) have been measured in accordance with a standard test method and may be used for comparing one tool with another;

The declared total vibration value(s) and the declared noise emission value(s) may also be used in a preliminary assessment of exposure.

In more detail...

Technical specifications



WARNING! The vibration and noise emission during actual use of the power tool can differ from the declared total value depending on the ways in which the tool is used especially what kind of workpiece is processed;

The need to identify safety measures to protect the operator that are based on an estimation of exposure in the actual conditions of use (taking account of all parts of the operating cycle such as the times when the tool is switched off and when it is running idle in addition to the trigger time).

Unpacking

1. Unpack all parts and lay them on a flat, stable surface.
2. Remove all packing materials and shipping devices if applicable.
3. Make sure the delivery contents are complete and free of any damage. If you find that parts are missing or show damage do not use the product but contact your dealer. Using an incomplete or damaged product represents a hazard to people and property.
4. Ensure that you have all the accessories and tools needed for assembly and operation. This also includes suitable personal protective equipment.



WARNING! The product and the packaging are not children's toys! Children must not play with plastic bags, sheets and small parts! There is a danger of choking and suffocation!

You will need

(items not supplied)

Suitable personal protective equipment
 Suitable lubricants
 Suitable plier

(items supplied)

Power adaptor (16)
 USB charger cable (17)
 Staple strip (12 mm x 84 pcs staples) (18)



NOTE: The accessories required depend on the intended application. Ask your dealer for advice.

Assembly



WARNING! Before using the product, familiarise yourself with the operating features read the entire instruction manual paying particular attention to the safety rules and operating procedures. Do not connect the product to power supply before it is completely assembled.

Staples



WARNING! Only original staples that match to the precision parts of the stapler such as the magazine (8), the striker and the shot duct (9a) can be used. Other manufacturers use different steel grades and sizes, which may damage the stapler.

Select the appropriate size of the staple as shown in Fig. 1:

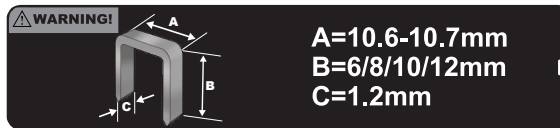

Fig. 1

Loading the magazine

1. Lift up the magazine release button (12) (Fig. 2, step 1), and the magazine slider (8a) will automatically pop up.



WARNING! Risk of ejection injury. Keep your hand away from the ejection direction of the magazine slider (8a).

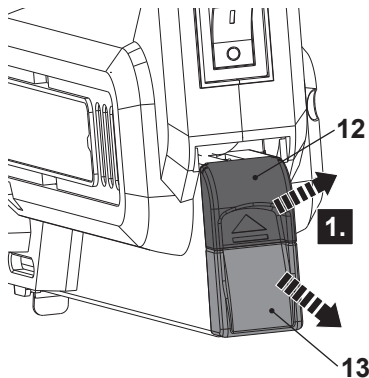

Fig. 2

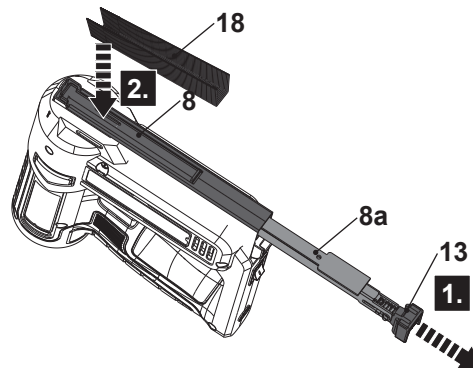

Fig. 3

Getting started...

Assembly

2. Turn the product around.
3. Hold the pull lever (13) and pull the magazine slider (8a) out of the back of the stapler until it stops (Fig. 3, step 1).
4. Fill the magazine (8) with the delivered staple strip (18) (Fig. 3, step 2). Ensure that the staple tips pointing upwards.
5. After loading, slide the magazine slider (8a) back into the magazine (8) until it clicks into place.



WARNING! Don't load staples of different lengths into the magazine (8) at the same time.
Don't put nails into the magazine (8).
Don't use excessive force when opening, loading or closing the magazine (8).

Built-in battery

Charging the built-in battery

The built-in battery (5a) for this product has been shipped in a low charge condition. Charge it fully before first use.

1. To charge the built-in battery (5a), connect the Type-C USB port (10) to the power adaptor (16) via the USB charger cable (17) (Fig. 4).
2. Plug the power adaptor (16) into a plug socket.

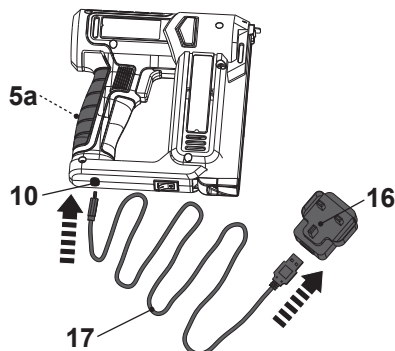

Fig. 4



WARNING! Check the voltage! The voltage must comply with the information on the rating label!

3. The charging process will begin:
 - Charging: The charge indicator (1) turns red (Fig. 5).
 - Fully charged: The charge indicator (1) turns green.
4. Remove the plug socket from the power supply on completion of charging. The charging time is approx. 1.5-2 h.
5. Remove the USB charger cable (17) from the product. The product is now ready for use.

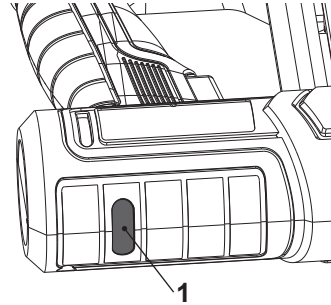

Fig. 5



NOTE: It is normal for the charger to become warm (but not hot) during charging process.

In more detail...



Functions & settings	25
Operation	27
Care and maintenance	29
Troubleshooting	32
Recycling and disposal	33
Guarantee	34
Declaration of conformity	35

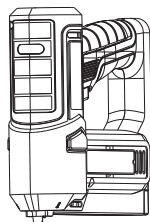

Intended use

This cordless stapler TTB960STP is designated with a rated voltage of 3.6 V --- .

The product is intended for stapling fabrics, leather, cardboard, foils, insulation material and similar materials to a soft surface, such as wood or wood-like materials. The product is not suitable for fastening wall or ceiling panelling.

Do not use the product for any other purpose.

For safety reasons it is essential to read the entire instruction manual before first operation and to observe all the instructions therein.

This product is intended for private domestic use only, not for any commercial trade use. It must not be used for any purposes other than those described.

Switching on/off

1. Switch the product on by pressing the on/off switch (11) at "I" marking (Fig. 6).
2. Switch the product off by pressing the on/off switch (11) at "O" marking.

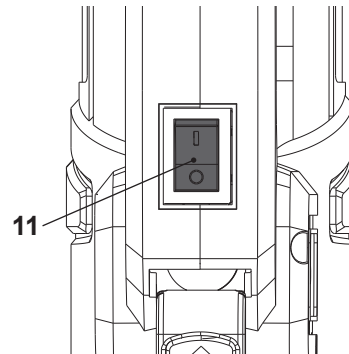

Fig. 6

Check window and reload indicator

The user can check the filling status of the staples from either of the two check windows (14) (Fig. 7).

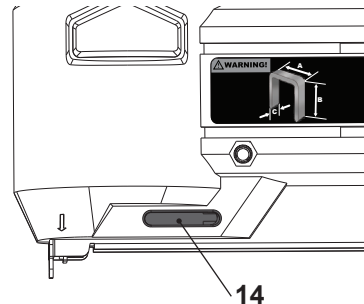

Fig. 7

In more detail...

Main trigger and firing

Follow the below steps for firing:

1. Switch the product on and the power indicator (1) will turn green.
2. Press the safety yoke (9) onto the material/workpiece that you want to staple (Fig. 8, step 1).
3. Press the main trigger (4) (Fig. 8, step 2).
4. The firing will be performed.

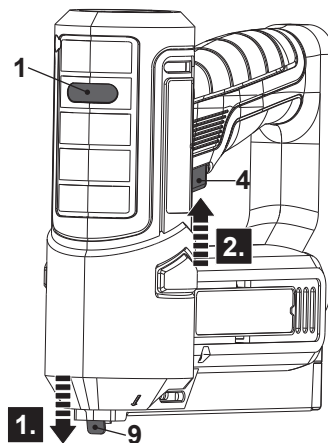

Fig. 8



WARNING! Don't perform the firing in reverse order.
Always remove the finger from the main trigger (4) when not operating.

Power / Charger indicator

The product is equipped with power / charge indicator (1) for visual guide of product status.

Power/ charger indicator (1)	Status	Status
In working mode	Green on	The product is switched on and ready for use
	Green flashing	Over-current protection is activated. Remove the jam before resuming operation.
	Red on	Battery is empty. Stop operation and charge it.
	Red flashing	Over-temperature protection is activated. Wait for 30 minutes or until the product has cooled down before resuming operation.
In charging mode	Green on	Fully charged.
	Red on	In charging
	Off	The product is switched off or no power.
	Red flashing	Over-temperature protection is activated. Wait for 30 minutes or until the product has cooled down before resuming operation.

General operation

1. Check the product, the charger cable and power adaptor as well as accessories for damage before each use. Do not use the product if it is damaged or shows wear. Take care of any problem you find or have the product checked by qualified specialist.
2. Double check that the accessories and tool attachments are properly fixed.
3. Always hold the product on the handle grip (5). Keep the handle dry to ensure safe operation.
4. Ensure that the air vents (3 / 7a) are always unobstructed and clear. Clean them if necessary with a soft brush. Blocked air vents may lead to overheating and damage the product.
5. Switch the product off immediately if you are disturbed while working by other people entering the working area.
6. Do not overwork yourself. Take regular breaks to ensure you can concentrate on the work and have full control over the product.
7. While working, ensure that the product does not strike hard objects, as this can cause damage.

Checking



NOTE: Before operating the product, perform the following tests to check the function of the safety yoke (9) and the main trigger (4).

1. Remove the staples out of the magazine (8).
2. Switch the product on and the power indicator (1) will turn green.
3. Press the safety yoke (9) onto the soft wooden pad, then squeeze the main trigger (4) for firing. The safety yoke (9) and the main trigger (4) should move smoothly. The firing should be performed.
4. If any malfunctions occur, stop to use the product immediately and turn to the dealer for repair.

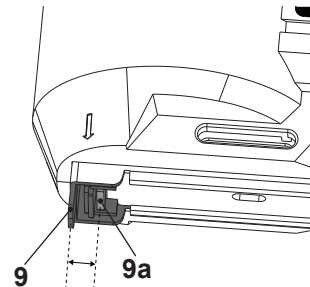

Fig. 9



NOTE: There is a gap between the safety yoke (9) and the shot duct (9a). Make several trials to staple at your desired position (Fig. 9).

In more detail...

Firing

1. Load the magazine (8) with a suitable staple strip (18).
2. Switch the product on and the power indicator (1) will turn green.
3. Ensure that no people or animals are in the work area.
4. Hold the product firmly on the handle grip (5) with one hand. Always keep your hand away from the shot duct (9a).
5. Press the safety yoke (9) onto the material/workpiece that you want to staple (Fig. 10, step 1).
6. Maintain the contact pressure and briefly press the main trigger (4) (Fig. 10, step 2).
7. Once the staple from the shot duct (9a) has been completely driven in, release the main trigger (4) and lift the safety yoke (9) from the workpiece (Fig. 10, step 3). Never fire again at the same spot.
8. Repeat step 1 to step 3 for performing more firings.

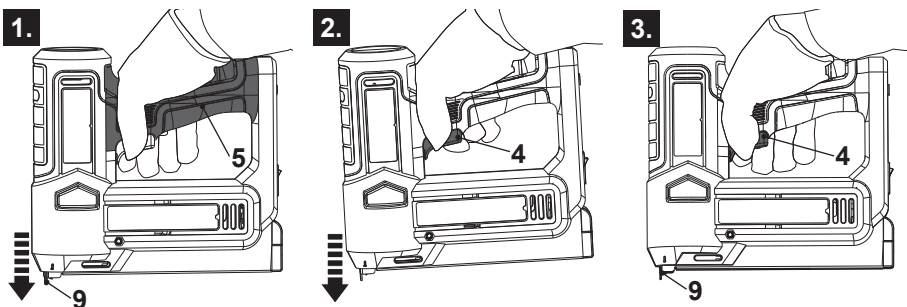

Fig. 10



NOTE: The safety yoke (9) should be pressed before squeezing the main trigger (4).

Carefully set the safety yoke (9) down on the material. Soft workpieces (e.g. pine wood) could be damaged if you press down too hard.

The power of the stapler will be automatically cut off in 30 min and the power indicator (1) goes out, the stapler should be restarted by operating the on/off switch (11).



WARNING! Wear safety gloves when working on the staples and close to them!



To prevent serious injury, keep your hands away from shot duct (9a)! Switch the product off while loading the magazine or conducting any intermediate checks.



Use appropriate tools to remove debris, e. g. a brush! Never use your bare hands!



After use

1. Release the main trigger (4) and the safety yoke (9), switch the product off and let it cool down.
2. Remove the staples out from the magazine (8).
3. Check, clean and store the product as described below.

The golden rules for care



WARNING! Always switch the product off and let the product cool down before performing inspection, maintenance and cleaning work!

1. Keep the product clean. Remove debris from it after each use and before storage.
2. Regular and proper cleaning will help ensure safe use and prolong the life of the product.
3. Inspect the product before each use for worn and damaged parts. Do not operate it if you find broken and worn parts.



WARNING! Only perform repairs and maintenance work according to these instructions! All further works must be performed by a qualified specialist!

General cleaning

1. Clean the product with a damp cloth and pH-neutral soap. Use a brush for areas that are hard to reach.
2. In particular clean the air vents (3 / 7a) after every use with a cloth and brush.
3. Remove stubborn dust with high pressure air (max. 3 bar).



NOTE: Do not use chemical, alkaline, abrasive or other aggressive detergents or disinfectants to clean this product as they might be harmful to its surfaces.

4. Check for any damage and wear. Repair damages in accordance with this instruction manual or take it to an authorised service centre before using the product again.

In more detail...

Maintenance

Before and after each use, check the product and accessories (or tool attachments) for wear and damage. If required, exchange them for new ones as described in this instruction manual. Observe the technical requirements.

Removing jams



WARNING! Wear safety gloves when working on the staples and close to them!



Use proper tools to remove jammed staple! Never use your bare hands! The jammed staple should be removed before being put back into use, otherwise the mechanical device will be permanently damaged.

If a staple is caught in the magazine or unit, please proceed as follows:

1. Switch the product off.
2. Lift up the magazine release button (12) (Fig. 11, step 1), and the magazine slider (8a) will automatically pop up.
3. Hold the pull lever (13) and pull the magazine slider (8a) out of the back of the stapler until the stop (Fig. 11, step 2).
4. Remove all staples in the magazine (8).
5. For the jammed staple, remove it with a suitable plier (not supplied) (Fig. 12).

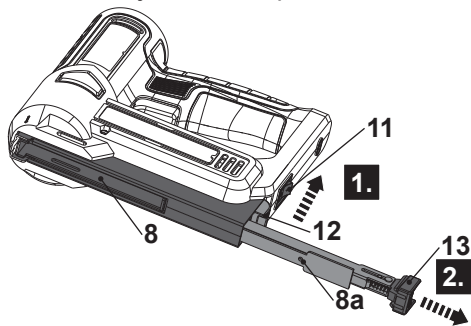

Fig. 11

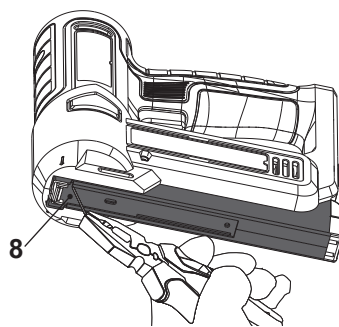

Fig. 12

6. Keep the magazine (8) open and switch the product on, attempting to fire 3-4 times on the soft wooden pad (Fig. 13).
7. Load the magazine (8) with the staple strip (18) and attempt to fire 3-4 times on the soft wooden pad.
8. If any malfunctions occur, stop to use the product immediately and turn to the dealer for repair.

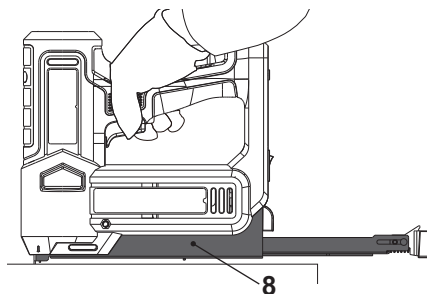

Fig. 13

Repair

This product does not contain any parts that can be repaired by the consumer. Contact an authorised service centre or a similarly qualified person to have it checked and repaired.

Storage

1. Switch the product off and empty the magazine (8).
2. Clean the product as described above.
3. Clean and lubricate the safety yoke (9) as needed.
4. Store the product and its accessories in a dark, dry, frost-free, well-ventilated place.
5. Always store the product in a place that is inaccessible to children. The ideal storage temperature is between 10 °C and 30 °C.
6. We recommend using the original package for storage or covering the product with a suitable cloth or enclosure to protect it against dust.
7. Charge the built-in battery (5a) before long-time storage.

Transportation

1. Switch the product off and empty the magazine (8).
2. Attach transportation guards, if applicable
3. Always carry the product by its handle grip (5).
4. Protect the product from any heavy impact or strong vibrations which may occur during transportation in vehicles.
5. Secure the product to prevent it from slipping or falling over.

In more detail...

Troubleshooting

Suspected malfunctions are often due to causes that the users can fix themselves. Therefore check the product using this section. In most cases the problem can be solved quickly.



WARNING! Only perform the steps described within these instructions! All further inspection, maintenance and repair work must be performed by an authorised service centre or a similarly qualified specialist if you cannot solve the problem yourself!

Problem	Possible cause	Solution
1. Product does not start	1.1. Built-in battery is discharged	1.1. Charge it
	1.2. Built-in battery is damaged	1.2. Check by a specialist electrician
	1.3. Battery pack is damaged	1.3. Refer to section "Operation -> Firing"
	1.4. Other electrical defect to the product	1.4. Check by a specialist electrician
2. Product does not reach full power	2.1. Built-in battery capacity is too low	2.1. Charge it
	2.2. Air vents are blocked	2.2. Clean the air vents
3. Unsatisfactory working result	3.1. The driven staples are not flush with the work surface	3.1. The impact force is not enough for working material
	3.2. Improper staples are used	3.2. Choose suitable size of the staples
4. The firing suddenly stops	4.1. Built-in battery is discharged	4.1. Charge it
	4.2. Staple is blocked	4.2. Remove jam
	4.3. Magazine (8) is empty	4.3. Refill the magazine (8)
5. Excessive vibration or noise	5.1. Bolts/nuts are loose	5.1. Tighten bolts/nuts

Recycling and disposal



Waste electrical products should not be disposed of with household waste. Please recycle where facilities exist.

Check with your Local Authority or local store for recycling advice.



For further information visit www.recycle-more.co.uk.

The product comes in a package that protects it against damage during shipping. Keep the package until you are sure that all parts have been delivered and the product is working properly. Recycle the package afterwards.

Disposal of an exhausted built-in battery



The battery is Li-Ion type. To preserve natural resources, please recycle or dispose of the built-in battery properly. Consult your local waste authority for information regarding available recycling and / or disposal options.

Discharge your built-in battery by operating your tool, then dismantle the product and remove the built-in battery and cover the built-in battery connections with heavy duty adhesive tape to prevent short circuit and energy discharge.

Do not attempt to open or remove any of the components.

In more detail...

Guarantee

We take special care to select high quality materials and use manufacturing techniques that allow us to create products incorporating design and durability. This product (3.6V Cordless 12mm Stapler) has a manufacturer's guarantee of 2 years against manufacturing defects, from the date of purchase (if bought in store) or date of delivery (if bought online), at no additional cost for normal (non-professional or commercial) household use.

To make a claim under this guarantee, you must present your proof of purchase (such as a sales receipt, purchase invoice or other evidence admissible under applicable law), please keep your proof of purchase in a safe place. For this guarantee to apply, the product you purchased must be new, it will not apply to second hand or display products. Unless stated otherwise by applicable law, any replacement product issued under this guarantee will only be guaranteed until expiry of the original guarantee period.

This guarantee covers product failures and malfunctions provided the product was used for the purpose for which it is intended and subject to installation, cleaning, care and maintenance in accordance with the information contained in these terms and conditions, in the user manual and standard practice, provided that standard practice does not conflict with the user manual.

This guarantee does not cover defects and damage caused by normal wear and tear or damage that could be the result of improper use, faulty installation or assembly, neglect, accident, misuse, or modification of the product. Unless stated otherwise by applicable law, this guarantee will not cover, in any case, ancillary costs (shipping, movement, costs of uninstalling and reinstalling, labour etc), or direct and indirect damage.

This guarantee does not cover defects and damage caused by or resulting from:

- Normal wear and tear
- Overload, misuse or neglect
- Repairs attempted by anyone other than an authorised agent
- Cosmetic damage
- Damage caused by foreign objects, substances or accidents
- Accidental damage or modification
- Failure to follow manufacturer's guidelines
- Loss of use of the goods

If the product is defective, we will, within a reasonable time, repair or replace it. Rights under this guarantee are enforceable in the country in which you purchased this product. Guarantee related queries should be addressed to the store you purchased this product from.

The guarantee is in addition to and does not affect your statutory rights.

Declaration of conformity

 (EN) EU DECLARATION OF CONFORMITY (FR) DÉCLARATION UE DE CONFORMITÉ (PL) DEKLARACJA ZGODNOŚCI UE (RO) DECLARAȚIA DE CONFORMITATE UE (ES) DECLARACIÓN UE DE CONFORMIDAD (PT) DECLARAÇÃO DE CONFORMIDADE UE		
Product / Produit / Produkt / Produsul / Producto / Produto		
<ul style="list-style-type: none"> • 3.6V Cordless 12mm Stapler / Agrafeuse sans fil 12mm/ Grapadora inalámbrica de 12 mm/ Agrafador sem fios de 12 mm • TTB960STP • Serial number range 000001 to 999999 		
Name and address of the manufacturer or his authorised representative: Nom et adresse du fabricant ou de son mandataire: Nazwa i adres producenta lub jego upoważnionego przedstawiciela: Denumirea și adresa producătorului sau a reprezentantului său autorizat: Nombre y dirección del fabricante o de su representante autorizado: Nome e endereço do fabricante ou do respetivo mandatário:		
Kingfisher International Products B.V., Rapenburgerstraat 175E, 1011 VM Amsterdam, The Netherlands		
This declaration of conformity is issued under the sole responsibility of the manufacturer. La présente déclaration de conformité est établie sous la seule responsabilité du fabricant. Niniejsza deklaracja zgodności wydana zostaje na wyłączną odpowiedzialność producenta. Prezenta declarație de conformitate este emisă pe răspunderea exclusivă a producătorului. La presente declaración de conformidad se expide bajo la exclusiva responsabilidad del fabricante. A presente declaração de conformidade é emitida sob a exclusiva responsabilidade do fabricante.		
Object of the declaration / Objet de la déclaration / Przedmiot deklaracji / Obiectul declarației / Objeto de la declaración / Objeto da declaração		
Product / Produit / Produkt / Produsul / Producto / Produto	Model / Modèle / Model / Modelul / Modelo / Modelo	EAN
3.6V Cordless 12mm Stapler / Agrafeuse sans fil 12mm/ Grapadora inalámbrica de 12 mm/ Agrafador sem fios de 12 mm	TTB960STP	5063022074256
The object of the declaration described above is in conformity with the relevant Union harmonisation legislation: L'objet de la déclaration décrit ci-dessus est conforme à la législation d'harmonisation de l'Union applicable: Wymieniony powyżej przedmiot niniejszej deklaracji jest zgodny z odnośnymi wymaganiami unijnego prawodawstwa harmonizacyjnego: Obiectul declarației descris mai sus este în conformitate cu legislația relevantă de armonizare a Uniunii: El objeto de la declaración descrita anteriormente es conforme con la legislación de armonización pertinente de la Unión: O objeto da declaração acima descrito está em conformidade com a legislação de harmonização da União aplicável:		
2006/42/EC as amended Machinery Directive 2014/30/EU as amended Directive Electromagnetic compatibility 2011/65/EU as amended Directive Restriction of the use of certain hazardous substances in electrical and electronic equipment Directive 2006/42/CE relative aux machines 2014/30 / UE telle que modifiée Directive Compatibilité électromagnétique Directive 2011/65/UE relative à la limitation de l'utilisation de certaines substances dangereuses dans les équipements électriques et électroniques 2006/42/WE w zmienionej dyrektywie maszynowej 2014/30 / UE ze zmianami Dyrektywa Kompatybilność elektromagnetyczna		

In more detail...

2011/65 / UE ze zmianami Dyrektywa Ograniczenie stosowania niektórych niebezpiecznych substancji w sprzęcie elektrycznym i elektronicznym
 2006/42/CE, astfel a fost modificată Directiva privind echipamentele
 2014/30/UE, astfel a fost modificată Directiva privind compatibilitatea electromagnetică
 2011/65/UE, astfel a fost modificată Directiva privind limitarea utilizării anumitor substanțe periculoase în echipamentele electrice și electronice
 Directiva sobre maquinaria modificada 2006/42/CE
 2014/30/UE modificada Directiva Compatibilitad electromagnética
 2011/65/UE modificada Directiva Restricción del uso de determinadas sustancias peligrosas en equipos eléctricos y electrónicos
 2006/42/CE como diretiva de máquinas alteradas
 2014/30/UE como alteração da compatibilidade eletromagnétic
 2011/65/UE como restrição diretiva alterada da utilização de certas substâncias perigosas em equipamentos elétricos e eletrônicos

2014/35/EU Directive Electrical Safety: Low-voltage electrical equipment
 2014/35/EU Directive Sécurité électrique: matériel électrique à basse tension
 2014/35/EU Dyrektywa Bezpieczeństwo elektryczne: sprzęt elektryczny niskiego napięcia
 Directiva 2014/35/UE siguranța electrică: echipamente electrice de joasă tensiune
 2014/35/EU Directiva Seguridad Eléctrica: Equipos eléctricos de baja tensión
 2014/35/Diretiva UE Segurança Eléctrica: Equipamento elétrico de baixa tensão

References to the relevant harmonised standards used or references to the other technical specifications in relation to which conformity is declared:

Références des normes harmonisées pertinentes appliquées, y compris la date de celles-ci, ou des autres spécifications techniques, y compris la date de celles-ci, par rapport auxquelles la conformité est déclarée:

Odwwołania do odnosnych norm zharmonizowanych, które zastosowano, wraz z datą normy, lub do innych specyfikacji technicznych, wraz z datą specyfikacji, w odniesieniu do których deklarowana jest zgodność:

Trimiteri la standardele armonizate relevante folosite, inclusiv data standardului, sau trimiteri la celelalte specificații tehnice, inclusiv data specificațiilor, în legătură cu care se declară conformitatea:

Referencias a las normas armonizadas pertinentes utilizadas, incluidas las fechas de las normas, o referencias a las otras especificaciones técnicas, incluidas las fechas de las especificaciones, respecto a las cuales se declara la conformidad:

Referências às normas harmonizadas aplicáveis utilizadas, incluindo a data da norma, ou às outras especificações técnicas, incluindo a data da especificação, em relação às quais é declarada a conformidade:

Cordless Stapler TTB960STP

Charger TTB993CHR

EN 62841-1:2015+AC:15+A11:2022

EN 60745-2-16:2010

EN IEC 55014-1:2021

EN IEC 55014-2:2021

EN IEC 61000-3-2:2019+A1:2021

EN 61000-3-3:2013+A1:2019+A2:2021

EN 60335-2-29:2004+A2:2010+A11:2018 to be used

in conjunction with EN 60335-1:2012+A11:2014+A13:

2017+A1:2019+A14:2019 and EN 62233:2008

EN IEC 55014-1:2021

EN IEC 55014-2:2021

EN IEC 61000-3-2:2019+A1:2021

EN 61000-3-3:2013+A1:2019+A2:2021

Authorized Signatory and technical file holder / Signataire et responsable de la documentation technique autorisée / Podmiot uprawniony do wystawienia i adres przechowywania dokumentacji technicznej / Semnatar autorizat și detinătorul dosarului tehnic / Firmante autorizado y titular del expediente técnico / Signatário autorizado e detentor da ficha técnica:

Kingfisher International Products B.V.,
 Rapenburgerstraat 175E,
 1011 VM Amsterdam,
 The Netherlands

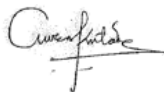

David Awe
 Group Quality Director

On : 30-05-2023

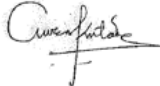
 (UK) DECLARATION OF CONFORMITY		
Product		
<ul style="list-style-type: none"> • 3.6V Cordless 12mm Stapler • TTB960STP • Serial number range 000001 to 999999 		
Name and address of the manufacturer or his authorised representative:		
Kingfisher International Products Limited 1 Paddington Square London W2 1GG United Kingdom		
This declaration of conformity is issued under the sole responsibility of the manufacturer.		
Object of the declaration		
Product	Model	EAN
3.6V Cordless 12mm Stapler	TTB960STP	5063022074256
The object of the declaration described above is in conformity with the relevant legislation:		
Electrical Equipment (Safety) Regulation 2016 as amended Electromagnetic Compatibility Regulations 2016 as amended Supply of Machinery (Safety) Regulations 2008 as amended The Restriction of the use of Certain Hazardous Substances in Electrical and Electronic Equipment Regulations 2012 as amended		
References to the relevant designated standards used or references to the other technical specifications in relation to which conformity is declared:		
Cordless Stapler TTB960STP BS EN 62841-1:2015+AC:15+A11:2022 BS EN 60745-2-16:2010 EN IEC 55014-1:2021 EN IEC 55014-2:2021 EN IEC 61000-3-2:2019+A1:2021 EN 61000-3-3:2013+A1:2019+A2:2021	Charger TTB993CHR BS EN 60335-2-29:2021+A1:2021 to be used in conjunction with BS EN 60335-1:2012+A11:2014+A13:2017+A1:2019+A2:2019+A14:2019+A15:2021 and BS EN 62233:2008 EN IEC 55014-1:2021 EN IEC 55014-2:2021 EN IEC 61000-3-2:2019+A1:2021 EN 61000-3-3:2013+A1:2019+A2:2021	
Authorised signatory and technical file holder:		
Kingfisher International Products Limited 1 Paddington Square London W2 1GG United Kingdom		
		
David Awe Group Quality Director		
		On 30/05/2023

In more detail...



Manufacturer, Fabricant, Producent, Producător, Fabricante:

UK Manufacturer:

Kingfisher International Products Limited
1 Paddington Square, London, W2 1GG
United Kingdom
www.kingfisher.com/products

EU Manufacturer:

Kingfisher International Products B.V.
Rapenburgerstraat 175E
1011 VM Amsterdam
The Netherlands
www.kingfisher.com/products

- | | | |
|-----------|--|---|
| EN | www.diy.com | To view instruction manuals online, visit
www.kingfisher.com/products |
| FR | www.castorama.fr | Pour consulter les manuels d'instructions en ligne,
rendez-vous sur le site www.kingfisher.com/products |
| PL | www.castorama.pl | Aby zapoznać się z instrukcją obsługi online, odwiedź
stronę www.kingfisher.com/products |
| RO | www.bricodpot.ro | Pentru a consulta manualele de instrucțiuni online, vizitați
www.kingfisher.com/products |
| TR | www.koctas.com.tr | Kullanım kılavuzuna internet üzerinden ulaşmak için
www.kingfisher.com/products adresini ziyaret edin |