

315*297



Specifications:

GU10 – SMALGU320G25RCN1P

Dimensions: 50 x 54 mm
 Kelvins: 2700K – 6500K
 Colours: RGB + CCT
 Lifetime: 25,000 hours
 Wattage: 4.5W
 Lumens: 320lm
 Beam Angle: 38°
 WiFi: 2.4 GHz
 Warranty: 2 Year Warranty

These SMART GU10s are not compatible with dimmer switches.

Warranty

The manufacturer provides warranty in accordance with the legislation of the customer's own country of residence, with a minimum of 2 year, starting from the date on which the appliance is sold to the end user.

The warranty only covers defects in material or workmanship.

When making a claim under the warranty, the original bill of purchase (with purchase date) must be submitted. The warranty will not apply in cases of:

Normal wear and tear. Use of force, damage caused by external influences. Misuse e.g. connection to an unsuitable mains supply. Partially or completely dismantled appliances.

Declaration

TCP hereby declares that the device is in compliance with the essential requirements and other relevant provisions of directives 2014/53/EU and 2011/65/EU.

Full declaration can be viewed at tcp.eu.

CORRECT DISPOSAL OF THIS PRODUCT

(Waste Electrical & Electronic Equipment) This marking shown on the product indicate that it should not be disposed with other household wastes at the end of its

lifetime. Please separate it from other types of waste and recycle responsibly. If in doubt, please contact your local recycling centre for details of where and how this item can be safely recycled.

These SMART GU10s are not compatible with dimmer switches.

These SMART GU10s are not compatible with dimmer switches.

These SMART GU10s are not compatible with dimmer switches.

These SMART GU10s are not compatible with dimmer switches.

These SMART GU10s are not compatible with dimmer switches.

These SMART GU10s are not compatible with dimmer switches.

These SMART GU10s are not compatible with dimmer switches.

These SMART GU10s are not compatible with dimmer switches.

These SMART GU10s are not compatible with dimmer switches.

These SMART GU10s are not compatible with dimmer switches.

These SMART GU10s are not compatible with dimmer switches.

These SMART GU10s are not compatible with dimmer switches.

These SMART GU10s are not compatible with dimmer switches.

These SMART GU10s are not compatible with dimmer switches.

These SMART GU10s are not compatible with dimmer switches.

These SMART GU10s are not compatible with dimmer switches.

These SMART GU10s are not compatible with dimmer switches.

These SMART GU10s are not compatible with dimmer switches.

These SMART GU10s are not compatible with dimmer switches.

These SMART GU10s are not compatible with dimmer switches.

These SMART GU10s are not compatible with dimmer switches.

These SMART GU10s are not compatible with dimmer switches.

These SMART GU10s are not compatible with dimmer switches.

These SMART GU10s are not compatible with dimmer switches.

These SMART GU10s are not compatible with dimmer switches.

These SMART GU10s are not compatible with dimmer switches.

These SMART GU10s are not compatible with dimmer switches.

These SMART GU10s are not compatible with dimmer switches.

These SMART GU10s are not compatible with dimmer switches.

These SMART GU10s are not compatible with dimmer switches.

These SMART GU10s are not compatible with dimmer switches.

These SMART GU10s are not compatible with dimmer switches.

These SMART GU10s are not compatible with dimmer switches.

These SMART GU10s are not compatible with dimmer switches.

These SMART GU10s are not compatible with dimmer switches.

These SMART GU10s are not compatible with dimmer switches.

These SMART GU10s are not compatible with dimmer switches.

These SMART GU10s are not compatible with dimmer switches.

These SMART GU10s are not compatible with dimmer switches.

These SMART GU10s are not compatible with dimmer switches.

These SMART GU10s are not compatible with dimmer switches.

These SMART GU10s are not compatible with dimmer switches.

These SMART GU10s are not compatible with dimmer switches.

These SMART GU10s are not compatible with dimmer switches.

These SMART GU10s are not compatible with dimmer switches.

These SMART GU10s are not compatible with dimmer switches.

These SMART GU10s are not compatible with dimmer switches.

App Install Instructions:

01. Download the TCP Smart App from the App Store or Google Play. Log in or set up an account using the on screen prompts.

Use the add device button in the top right corner.



- The add device menu should pop up automatically.
- Enter the network details if prompted.
- Wait for the device to add.
- Once the device has been added continue to the next screen.
- A device can be linked to the room where it is located.

Smart Home Assistant

TCP Smart products work with Amazon Alexa, Google Nest & Siri Shortcuts.

For further information on connecting to smart home assistants visit

<https://www.tcpsmart.eu/faq/>

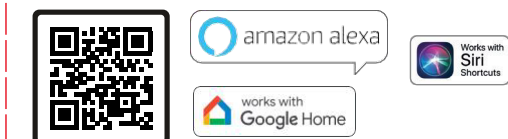

We are social, check us out!

YouTube [@TCPsmart](https://www.youtube.com/c/TCPsmart) Instagram [@tcpsmart](https://www.instagram.com/tcpsmart)

Main Screen

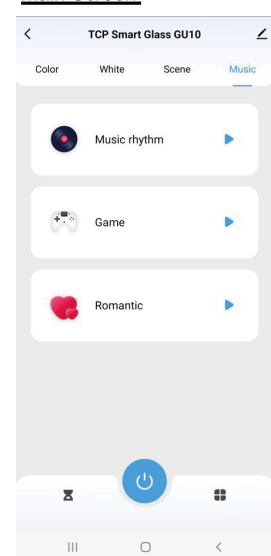

- Turn product on or off
- Colour – choose colour and brightness
- White – choose white colour and brightness
- Scene – choose from pre-loaded colour scenes
- Music - choose for music sync
- Timer function
- Access to more functions – see below

Colour Screen

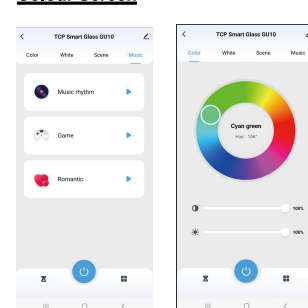

From the main screen press Colour in the top row. In the next screen move the indicator in the colour circle round to choose the colour.

- Move the slide to adjust contrast of the colour
- Move the slide to adjust the brightness of the colour
- Press < to return to main screen

brightness

Note: The period between each timing must exceed 15 minutes.

Schedule Set Up

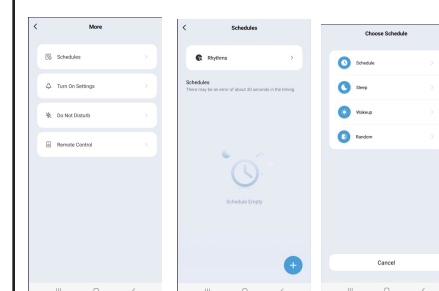

Press schedules to move to the next page. Press the add button in the bottom right hand corner. Choose from the options available:

Schedule – set up times for the light to come on and off.

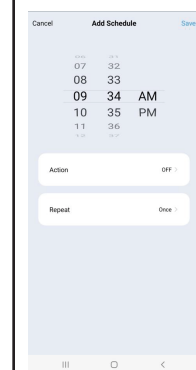

To turn on for a specific day(s) and time(s):
 Select the Action – Press ON
 Select the time. AM and PM are both 12hrs
 Select repeat. For this option choose
 Once for one occurrence
 Everyday for all days of the week
 Custom – select specific days
 To turn off the above action
 Select the Action – Press OFF
 Select the time. AM and PM are both 12hrs
 The above can then be repeated for multiple schedules

Sleep

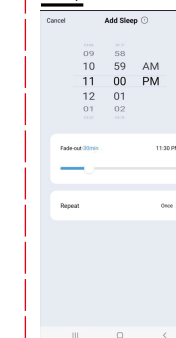

Select the time you want the lamp to turn on. Note: the times AM and PM are 12 hrs

Use the fade out slide to select the fade out time for the lamp

Repeat – see above schedule on how to set up the day(s)

Wake Up

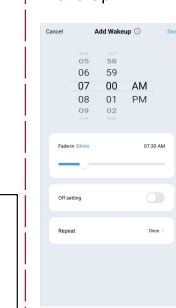

Select the time you want the lamp to turn on. Note: the times AM and PM are 12 hrs

Use the fade in slide to select the fade in time for the lamp. Once this time has been reached the lamp will turn off.

Repeat – see above schedule on how to set up the day(s).

Random

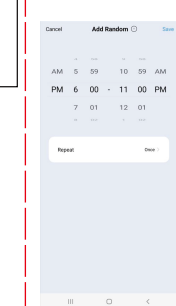

Select the time you want the lamp to turn on. Note: the times AM and PM are 12 hrs

Repeat – see above schedule on how to set up the day(s).

Turn On Settings

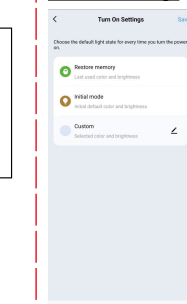

This function allows the choice of set up for when the product is turned on. Choose from

- Restore memory Uses the last colour and brightness.
- Initial mode Uses the initial colour and brightness that was set
- Custom Choose your own colour and brightness

Do Not Disturb



This function stops the light from automatically turning on in the event turning on after a power failure.

The function is automatically set to off. If you want to turn the light back on after a power failure turn the device OFF and ON twice within 5 seconds

To have the light come back on automatically after a power failure press the Do Not Disturb button to activate.

Remote Control

Note: this function is not available with the TCP Smart Glass GU10.

TCP, 1 Exchange Court, Cottingham Road, Corby, Northants, NN17 1TY

White Screen

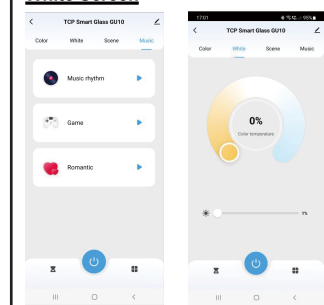

From the main screen press White in the top row. In the next screen move the indicator in the colour circle round to choose the colour.

- Move the slide to adjust contrast of the colour
- Move the slide to adjust the brightness of the colour
- Press < to return to main screen

Scene

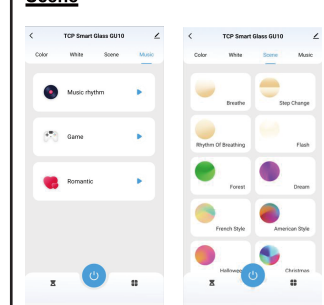

From the main screen press Scene in the top row. In the next screen choose the required scene by pressing the tab. Press < to return to main screen

Music

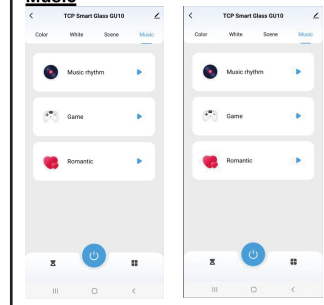

From the main screen press Music in the top row. In the next screen choose the required music setting by pressing the tab. Press < to return to main screen

Timer

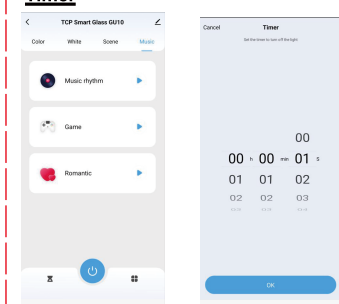

From the main screen press to access the timer function.

Select hour/minute/second. Press OK to save. Once the timer has completed the countdown the GU10 will turn off.

Press < to return to the main screen.

More

Press to access more applications and choose from:

- Schedules Use preset or custom timings. Use for a gradual wake up or sleep, and random turn on and off if you are away from home.
- Turn on Settings Restore memory in event of a power failure
- Do not Disturb Use to have the device turn on or stay off after a power failure

Schedules

Options are:

- Rhythms Allows preset or customer timings for different white colour temperatures during the day.
- Schedule Program the GU10 to turn on and off at different time(s) during the day, and on specific day(s).
- Sleep This function allows you to set a specific time for the GU10 to gradually decrease in brightness until it eventually turns off completely. The gradual decrease in brightness can provide a more relaxing and calming environment than an abrupt turn-off, which can be jarring and disruptive.
- Wakeup This feature allows you to set a specific time for the GU10 to gradually increase in brightness until it reaches its maximum brightness level, and then turn off after a specified duration. This can simulate a natural sunrise and provide a gentle and calming way to wake up in the morning.
- Random This feature allows you to set a specific time for a lamp or light to turn on and off at random intervals, simulating someone being at home even when you are away. This can be a great way to enhance the security of your home and deter potential burglars.

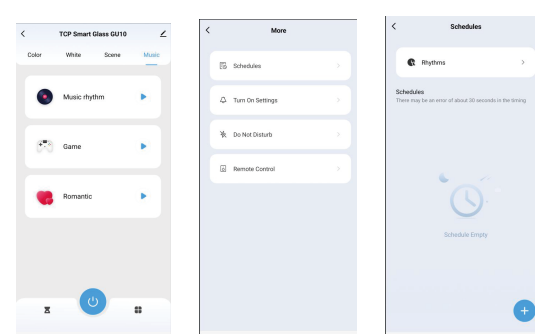

Rhythms

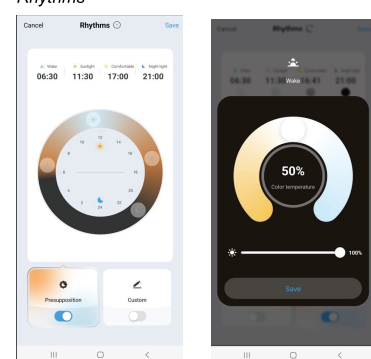

Press Rhythms tab. Preset times and colour from the white spectrum for the lamp.

Press presupposition for preloaded times and colour. To change the time press the

corresponding icon for the time you want to change eg . Slide the icon to the desired time. To change the colour press the corresponding icon at the top of the page

eg 06:30. On the next page press the circle on the colour wheel and move to the desired colour. To adjust brightness use the slider and move to the desired