

1011WH	1.0kW Compact HEPA - White
1011SS	1.0kW Compact HEPA - Stainless Steel

## Compact HEPA Automatic Hand Dryer

### Features

- Manufactured from 1.2mm grade 304 stainless steel to protect against corrosion and vandalism with low noise level of 72dB
- Anti-tamper cover (fixing screws included)
- Internal switch to alternate between warm air at 950W or room temperature air at 500W, saving energy during warmer periods
- Self-resetting overheat thermostat provides protection from overheating if hand dryer becomes blocked
- Automatic shut off after 60 seconds to avoid wasted energy
- Self-resetting overheat thermostat provides protection from overheating if hand dryer becomes blocked

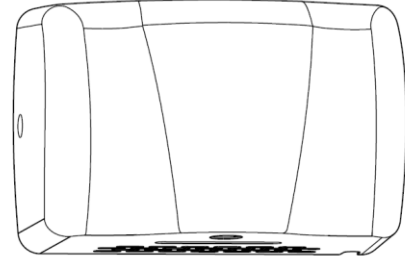

### Safety Instructions

1. These instructions should be read carefully and retained after installation for future reference and maintenance.
2. Ensure that the mains power is switched off before carrying out installation or maintenance.
3. Installation must be carried out in accordance with the current edition of IET wiring regulations BS 7671, and by a qualified electrician.
4. The hand dryer should be supplied from a switched fused spur. This Hand Dryer is electrical class 1 construction and must be earthed.
5. Ensure all electrical connections are secure and that there are no loose strands.
6. Do not install above washbasins or immediately adjacent to urinals, lavatories, baths and showers.
7. When in use, the hand dryers will accumulate dust. Cleaning and maintenance must be carried out regularly.
8. The unit is intended for drying hands only. Long hair should be kept away from air inlet vents.

### Environmental Instructions

This product may contain substances that can be hazardous to the environment if not disposed of properly. Electrical and electronic equipment should never be disposed of with general waste but must be separated for its correct treatment and recovery. Where possible recycle your packaging.

### Installation Instructions

1. Remove the metal front cover by removing the security screws on the sides of hand dryer.

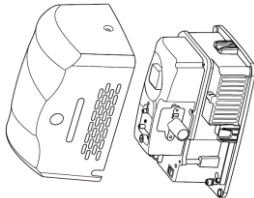

2. Using the hand dryer base as a template, mark out and drill the fixing holes on the mounting surface.

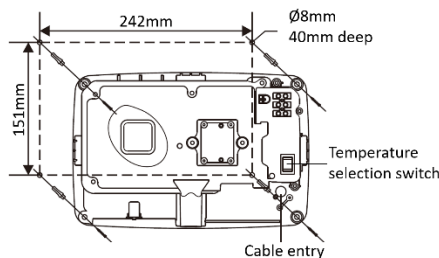

3. Fix the base of the hand dryer on the mounting surface using the wall plugs and the screws provided.
4. Feed the supply cable through the cable entry hole in the base and terminate the conductors into the terminal block ensuring the correct polarity is observed.
5. Secure the supply cable in the cord grips and terminate into a spur.
6. Replace the metal front cover back on the base and secure in position using the security screws.

### HEPA Filter Replacement \*

1. Push the filter cover to open it and remove the old filter.
2. Insert the new filter and close the filter cover.

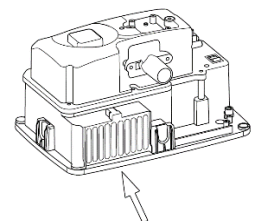
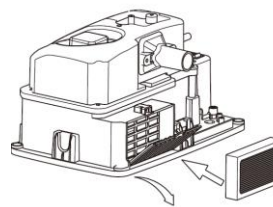

### Operation

The hand dryer is automatically activated when hands are placed under the air outlet. Once the hands are removed, the hand dryer automatically switches off within 2 seconds. If the hand dryer is running continuously, it will switch off after 60 seconds to conserve energy. To reactivate the hand dryer, move the hands away from the air outlet and place back.

### Specification

Input Voltage:	220V – 240V AC 50Hz	Air Speed	100m/s	
Electrical Classification:	Class I	Noise Level (at 2m)	72dB	
Rated Power	Heater Element	500W	IP Rating	IPX3
	Motor	500W	Weight	4.5kg
Drying time	10-12Sec	Dimensions	183x275x162mm	

\* It is recommended that the HEPA filter is replaced every 6 months