

SENSOR & MANUAL INTEGRATED FAUCET

User's Manual

► Please read the instruction before installation and retain it well for future reference

Open-Package Inspection Notes

1. Please check all the components as the packing list. Any shortage or query please contact local retailer.
2. Please take carefully to move all the components for avoid damage.

Packing List

1	Faucet body assembly	1SET	
2	Hose	2PC	
3	Battery case	1PC	D type
4	Battery case holder	1PC	D type
5	Strainers	2PC	
6	Accessories pack	1PC	1 anchors , 1 screws
7	User's manual	1PC	
8	G1/2 Connector	2PC	M12X1-G1/2
9	AC adaptor	1PC	A Type 100-240VAC/DC6V
10	3MM inner hexagon spanner	1PC	
11	Pouch	1PC	
12	Glove	1PC	

Caution

1. To avoid trouble, please don't tap the product as it had been installed with precision electronic components and solenoid valve.
2. To avoid the product surface corrosion or inner electronic component being damaged, please use soft cloth with neutral liquid to clean its surface, then use damp cloth to wipe off wash liquid and then make it dry with soft cloth. Don't use water to rush it or use soap detergent which includes massive power, or something have high acidity, alkalinity or nylon brush etc. Especially note that don 't damage detector cover of sensor window to avoid the sensitivity being reduced.

Quality Guarantee

Please contact local retailer for the detailed quality guarantee policy .

Battery Replacement

If indicator light flash red when you use the faucet , or sensor not work as usual , please repalce with new battery :

1. Disconnect the battery case .
2. Open the battery case cover with screwer and put new battery inside . Please pay attention to the +/- direction . Then put back the cover and screws .
3. Connect the battery plug .

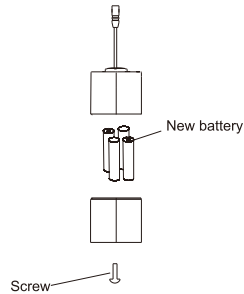

Trouble Shooting

No water flow	Sensor silence or closed	Click function button again or 7 times
	Angle valve is closed	Open the angle valve
	Low battery	Replace with new battery
	Faulty connect of AC plug	Make sure plug connect well
	Dirt on sensor	Clean sensor with soft cloth
	Block before the sensor	Remove the block
	Faulty connect of battery case	Reconnect the battery case
	Solenoid valve problem	Ask for after sale service
Weak water flow	Angle valve not open enough	Adjust angle valve
	Block on strainers	Clean strainers
	Block on areater	Clean areater
Water flow can't stop	Block before sensor	Remove the block
	Dirt on sensor	Clean sensor with soft cloth
	Solenoid valve problem	Ask for aftersale service

Please refer to explosive view for the mentioned parts above .

Technical Parameters

MODEL	Type A	Type B
Power Supply	100-240V AC 50/60Hz	4XAA Alkaline Batteries
Applicable Water Pressure	0.05-0.7MPa	
Water temperature	0.1-75°C	
Environment Temperature	0.1-60°C	
Water Supplying Caliber	G1/2"	
Maximum Flow Of Manual Valve	12L/min(under 0.3Mpa dynamic water pressure)	
Sensing Distance Of Induction Valve	5-20cm Adjustable	
Way Of Adjusting Distance	Self Adjust	
Trigger Time Of Sensor	300ms	

Overall Dimensions

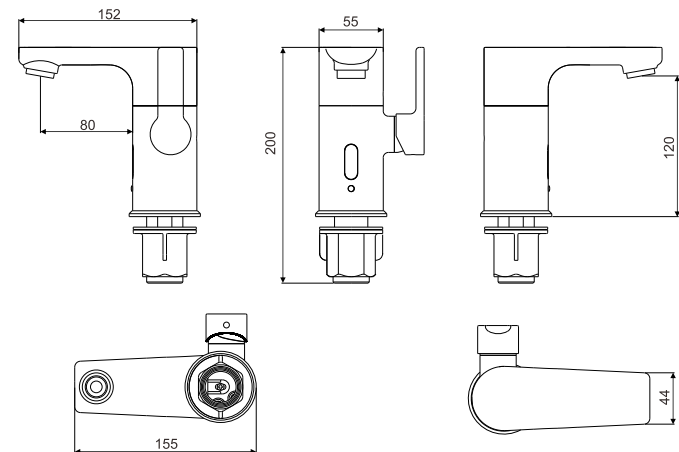

Explosive view

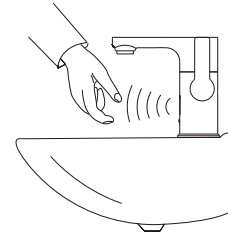
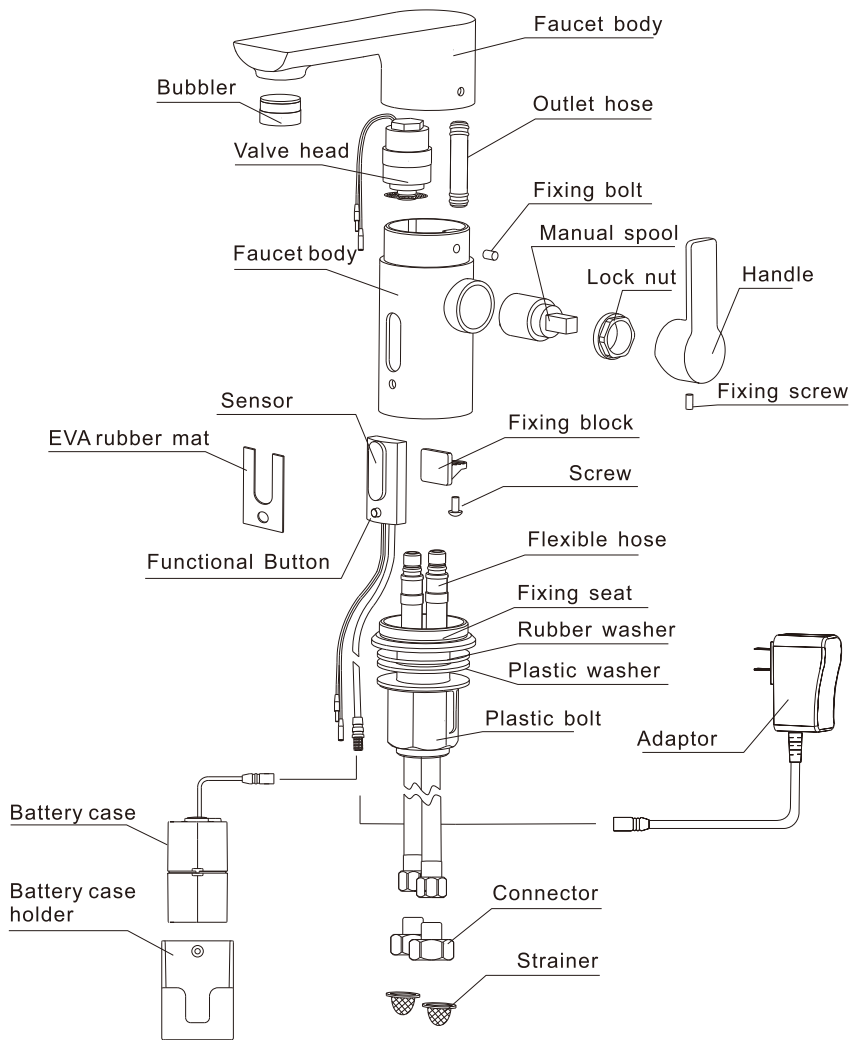

4. Indicator light fast flush 15 times (in 2 seconds) Then begin auto adjust to your hand distance.
Note: Do not move your hand which before the sensor during the adjusting.

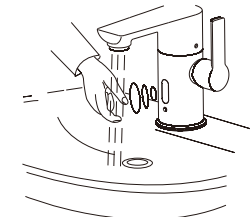

5. If the indicator light on a while, the new distance is accepted.

Turn Off Sensor

A. ON/OFF Sensor silence

Click function button once, the sensor keep silence for 5-30seconds. Default set is 15 seconds. The sensor can back to work by click function button again or auto backup after 15seconds.

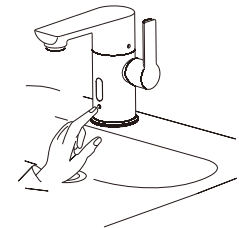

B. Adjust Sensor silence time

Click function button 5 times, the indicator light on for 2seconds. Then enter adjust silense time mode. Click function button each time for add 5 seconds silence time. Max 30 seconds (6 click). If none click will back to default set after 10seconds.

C. Close sensor for long time

Click function button 7 times, wait 3 seconds, then indicator light on for 1seconds. Then the sensor is closed. If do it again, you can turn on the sensor again.

Note: indicator light flush with each click, do not over 3 seconds between each click.

How to use

Move hands before the sensor, the indicator light flush one time and water come out. When hands remove, the indicator light also flush one time and water stop.

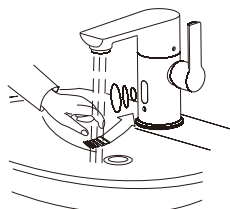

How to adjust water direction

Water direction can be adjusted by twist the aeraters.

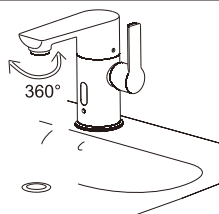

Use as handle mode

Use the handle directly as common faucet, also you can turn off the sensor first for more convenient.



Adjust Sensor Distance

You can adjust the sensor distance as below instructions :



1. Clip the function button 3 times

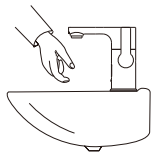

2. Keep your hand before the sensor as your required distance

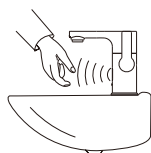

3. After 3 seconds the indicator light flush 8 times . (in 4 seconds)

Installation

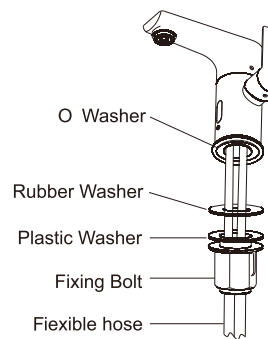
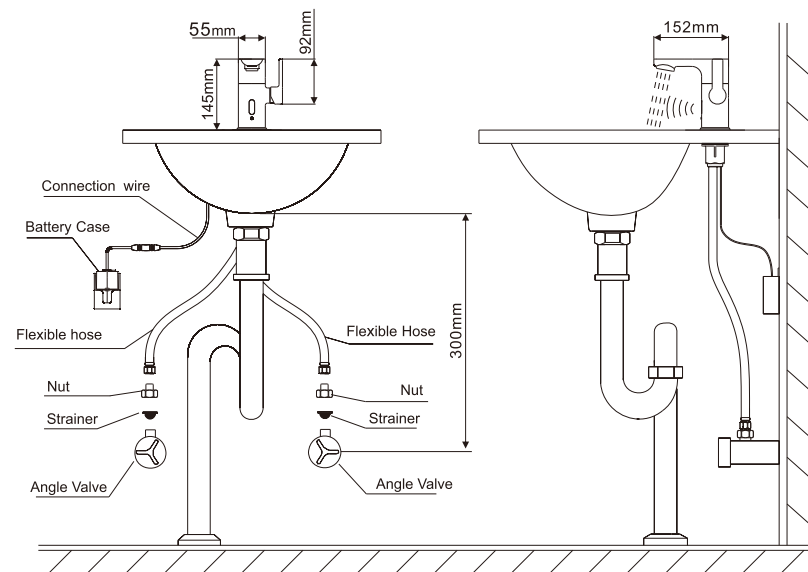

Step one :
Take away the rubber washer, plastic washer and fixing bolt.

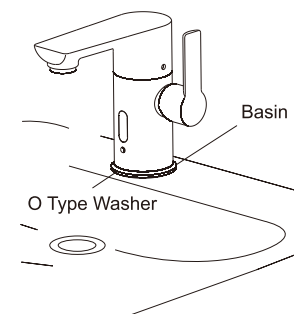

Step two :
Install the faucet with O-ring in basin.

Installation

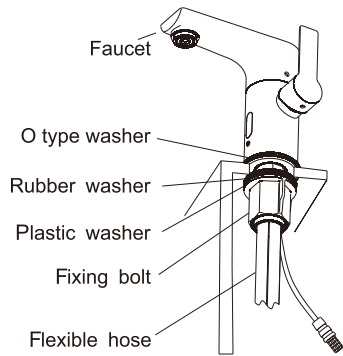

Step three:

Fix faucet with rubber washer, plastic washer and fixing bolt.

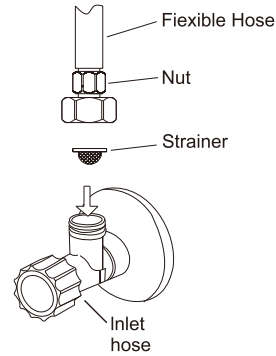

Step four:

Turn on the inlet valve for a while to make sure there is no impurity in the pipe. Connect the hose with blue mark to the cold water angle valve. Connect the hose with red mark to the hot water angle valve.

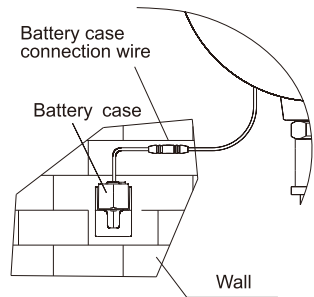

Step five:

Take away the cover of adhesive sticker, paste the battery case holder to the clean wall. Put the battery case into the holder and connect the connection wire.

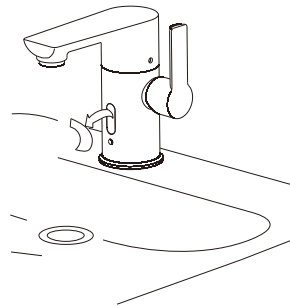

Step six:

Take away the protective film of sensor.

Installation

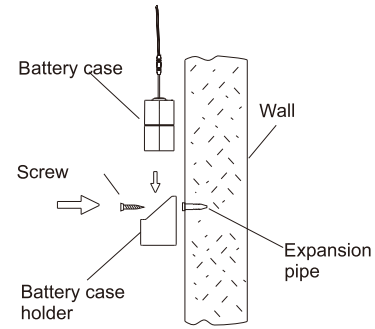

Step seven:

When you install the battery case holder, if the wall is not smooth, please use the expansion pipe and self-tapping screw.

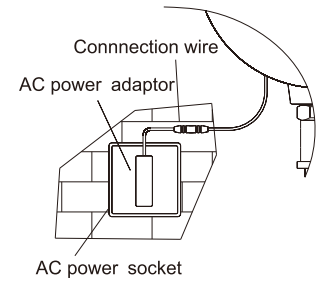

Step eight:

If there is AC power supply (100-220V 50/60Hz) under the basin, you can use the AC adaptor.

Setup and Use

SETUP

1. The indicator light flush 5 seconds after power on, the sensor work as self-adjustment, The inside valve work twice. Then it is ready for use.
2. Sensor can be turn off by clip function button on the faucet body. And if not be clip again the sensor will back to work after 15seconds.

