

Thank you for purchasing this light fitting. Please read the instructions carefully before use to ensure safe and satisfactory operation of this product. Please keep these instructions for future reference.

Warnings!

This is a Class 1 product and must be earthed.

Please read these instructions carefully before commencing any work. It is recommended that this fitting is installed by a qualified electrician.

Install in accordance with the IEE Wiring regulations and the Building Regulations.

To prevent electrocution switch off at mains supply before installing or maintaining this fitting. Ensure other persons cannot restore the electrical supply without your knowledge. If you are in any doubt, please consult a qualified electrician.

This light fitting should be connected to a 5 amp fused circuit.

If replacing an existing fitting, make a note of the connections.

This product is suitable for indoor use only, on normal flammable surfaces.

This product is not suitable for use with a dimmer switch.

Fixing Instructions

Make sure you have the following items which are required to install this light fitting:

Small electrical screwdriver, cross head screwdriver

Step 1

Referring to the diagram in step 3 below, remove the fixing bracket from the wall back and attach to the wall using the screws provided. Take care to avoid damaging any concealed wiring and pipes.

Step 2

Having identified the household wiring from your existing light fitting, connect to the connection block inside the product in the following way:

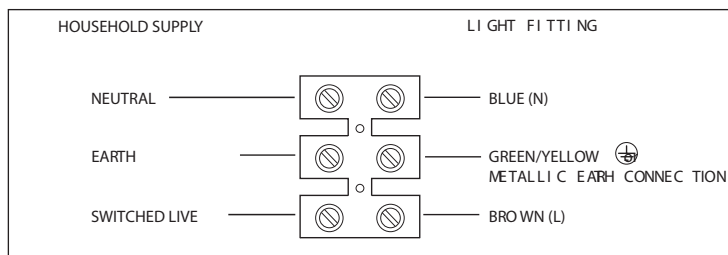

Check that....

You have correctly identified the house wires.

The connections are tight.

No loose strands have been left out of the connection block.

Step 3

Re-attach the product to the fixing bracket, by refitting the screws into the holes in the wall back and tightening the screws to secure. Product can be mounted horizontally only with the LEDs facing downwards.

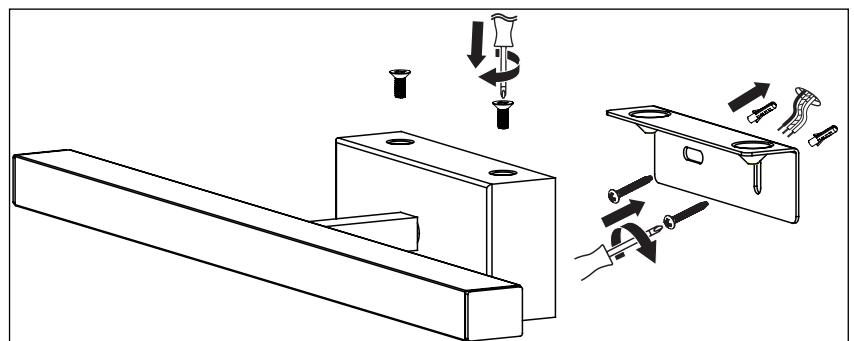

Step 4

Replace fuse or circuit breaker and switch on. Your light is now ready for use.

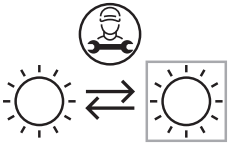

Replaceable light source by a professional

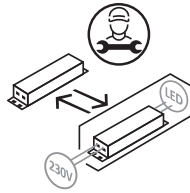

Replaceable control gear by a professional

LED driver replacement

Obtain suitable replacement driver - ensuring all technical specifications match the existing item.

The wiring is pre-attached to the LED driver.

Connect the "PRI" cables to the input power terminal block. Connect Blue cable to Neutral and Brown cable to Live.

Connect the "SEC" cables to the wires coming from the product. Red cable to red cable and black cable to black cable.

Twist the cables together and join with approved crimp connectors and insulate with heat shrink sleeving or insulation tape.

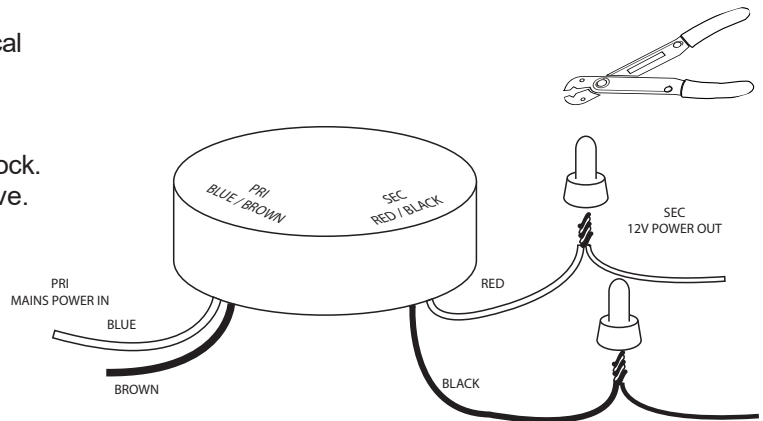

This product contains a light source of energy efficiency class G

For further information please visit: www.lighting-info.co.uk/99339

Care and cleaning

Finish - We recommend cleaning with a soft dry cloth. Do not use abrasive materials as these will damage the finish.

Safety Information

For your safety, always switch off the supply before cleaning.

 Waste electrical products should not be disposed of with household waste. Please recycle where facilities exist. Check with your Local Authority or retailer for recycling advice.

We have taken great care to ensure that this product reaches you in perfect condition. However, should any parts be damaged or missing please access our website: www.poolelighting.com to request spare parts or please call our Product Helpline on (01202) 690945.

We will despatch to you, within 7 working days, your missing/damaged part. When phoning please ensure you have the following information available: Name and Address, Daytime Telephone Number, Date of Purchase, Product Reference number or barcode number (on product label or on box label), Description of Missing/Damaged Part. This does not affect your statutory rights.

Manufactured by: Poole Lighting Ltd.

UK: BH17 7BY

EU: Brilliant AG, Brilliantstrasse 1, D-27442 Gnarrenburg