

**Yale**<sup>®</sup>

# Shed & Garage Alarm

(SAA5015 & SAA5010)

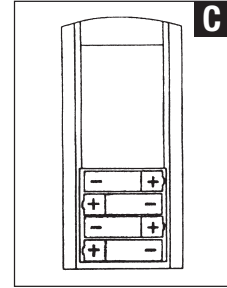
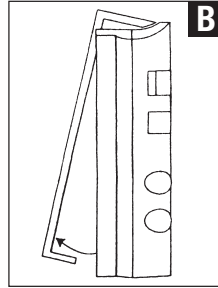
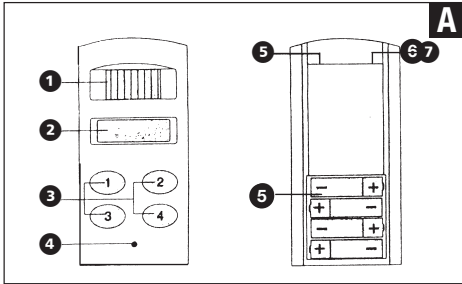

## Description

- 1 Motion sensor
- 2 Alarm speaker
- 3 Keypad
- 4 Battery low LED
- 5 Battery compartment
- 6 4.5V AC adaptor socket  
(AC adaptor not included)

## Battery Installation

- 1 The battery compartment is accessed from the rear of the alarm unit by removing the screw from the base and lifting the back cover (as shown in image B).
- 2 Insert 4 'AA' size batteries (not included) following the polarity (as shown in image C). When the last battery is inserted the alarm will beep very loudly to indicate that the batteries are installed properly.

- 3 Replace the back cover and fix with screw.

**Note:** The Battery Low LED will light when the batteries need replacing.

## Programming the Alarm

Immediately after inserting the batteries, the desired 4 digit security code must be set, simply press the desired 4 digits on the keypad.

**Note:** After removing the batteries, press number 4 before installing new ones. The alarm must be re-programmed with your security code each time the batteries are removed or replaced.

For more information on this product visit [www.yale.co.uk](http://www.yale.co.uk)  
**Consumer Support:** [info@yale.co.uk](mailto:info@yale.co.uk)



The 2 year guarantee for this product is active from the date of purchase (A copy of this guarantee is available on our website).



## Installation

- 1 Place the alarm in the desired location, preferably near the front or back door.
- 2 Remove the back cover and fix it to the wall using the screws and rawplugs supplied, (as shown in image D).
- 3 The alarm body can then be snapped into place on to the back cover and secured using the screw at the base.

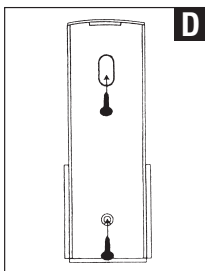

- **Note:** This alarm can also be used free standing.

## Operation

### Leaving the protected area

Press keypad number 4 and a confirmation tone will indicate that the alarm is armed. You have 30 seconds in which to vacate the area. After this time, if motion is detected then the alarm will sound.

### Entering the protected area

Type your 4 digit security code within 10 seconds. This will disarm the alarm.

### Care and maintenance

To clean the case, simply use a soft slightly damp cloth with water and wipe dry immediately.

**Caution:** Never use chemicals to clean the case, as they may cause damage to the plastic and cause the alarm not to function.

## Troubleshooting

### The unit does not sound when the batteries are installed

Ensure that the batteries are connected correctly following the polarity (as shown in image C).

### The alarm does not arm

Ensure that the back plate of the alarm unit is secure to hold the batteries in place and that the red light illuminates when the keypad buttons are pressed.

### The red light on the base of the alarm is on

This is the 'Battery Low Indicator'. The batteries need replacing.

## Battery precautions

When using this product follow these precautions at all times.

- Use only the appropriate size batteries
- Be sure to follow the correct polarity when installing the batteries as indicated in the battery compartment. Incorrect polarity may cause damage to the alarm.
- Do not mix different types of battery such as Alkaline and Carbon-zinc or old batteries with new.
- If the alarm is not used for long periods of time, remove the batteries to prevent damage or injury from possible battery leakage.
- Do not recharge batteries not intended to be recharged as they can overheat and rupture. (Always follow the manufacturer's directions).



PACKAGING

### WEEE

Note: Waste electrical products and batteries should not be disposed of with household waste. Please recycle where facilities exist. Check with your local authority or retailer for recycling advice.

Information and illustrations are subject to change. Yale reserves the right to alter the specification and product design at any time without notice.

Issue No. 11B

