

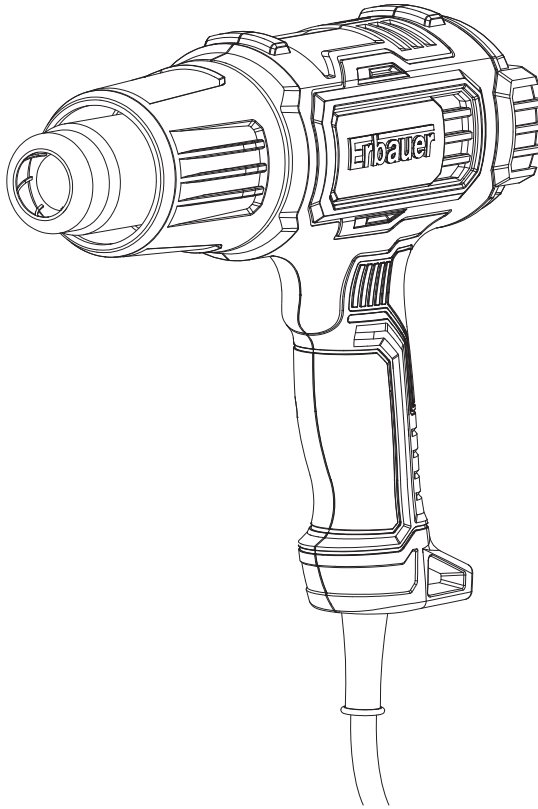

Erbauer



Original Instructions - MNL_EHG2000_GB_V1_201022

EHG2000

EAN: 5059340043234

ORIGINAL INSTRUCTIONS

EN









WARNING: Read the instructions before using the product!

V11020 / BX220IM



EN

	Safety instructions	3
	Product description	17
	Assembly	23
	Use	26
	Care & maintenance	32
	Guarantee	37
	Declaration of conformity	38



Safety instructions

SAFETY WARNINGS

1. This appliance can be used by children aged from 8 years and above and persons with reduced physical, sensory or mental capabilities or lack of experience and knowledge if they have been given supervision or instruction concerning use of the appliance in a safe way and understand the hazards involved.
2. Children shall not play with the appliance. Cleaning and user maintenance shall not be made by children without supervision.
3. If the supply cord is damaged, it must be replaced by the manufacturer, its service agent or similarly qualified persons in order to avoid a hazard.

GENERAL POWER TOOL SAFETY WARNINGS



WARNING! Read all safety warnings, instructions, illustrations and specifications provided with this power tool. Failure to follow all instructions listed below may result in electric shock, fire and/or serious injury.

Save all warnings and instructions for future reference. The term “power tool” in the warnings refers to your mains-operated (corded) power tool or battery-operated (cordless) power tool.

Work area safety

1. **Keep work area clean and well lit.** Cluttered or dark areas invite accidents.



EN

2. **Do not operate power tools in explosive atmospheres, such as in the presence of flammable liquids, gases or dust.** Power tools create sparks which may ignite the dust or fumes.
3. **Keep children and bystanders away while operating a power tool.** Distractions can cause you to lose control.

Electrical safety

1. **Power tool plugs must match the outlet. Never modify the plug in any way. Do not use any adapter plugs with earthed (grounded) power tools.** Unmodified plugs and matching outlets will reduce risk of electric shock.
2. **Avoid body contact with earthed or grounded surfaces, such as pipes, radiators, ranges and refrigerators.** There is an increased risk of electric shock if your body is earthed or grounded.
3. **Do not expose power tools to rain or wet conditions.** Water entering a power tool will increase the risk of electric shock.
4. **Do not abuse the cord. Never use the cord for carrying, pulling or unplugging the power tool. Keep cord away from heat, oil, sharp edges or moving parts.** Damaged or entangled cords increase the risk of electric shock.
5. **When operating a power tool outdoors, use an extension cord suitable for outdoor use.** Use of a cord suitable for outdoor use reduces the risk of electric shock.
6. **If operating a power tool in a damp location is unavoidable, use a residual current device (RCD) protected supply.** Use of an RCD reduces the risk of electric shock.



Personal safety

1. **Stay alert, watch what you are doing and use common sense when operating a power tool. Do not use a power tool while you are tired or under the influence of drugs, alcohol or medication.** A moment of inattention while operating power tools may result in serious personal injury.
2. **Use personal protective equipment. Always wear eye protection.** Protective equipment such as dust mask, non-skid safety shoes, hard hat, or hearing protection used for appropriate conditions will reduce personal injuries.
3. **Prevent unintentional starting. Ensure the switch is in the off-position before connecting to power source and/or battery pack, picking up or carrying the tool.** Carrying power tools with your finger on the switch or energising power tools that have the switch on invites accidents.
4. **Remove any adjusting key or wrench before turning the power tool on.** A wrench or a key left attached to a rotating part of the power tool may result in personal injury.
5. **Do not overreach. Keep proper footing and balance at all times.** This enables better control of the power tool in unexpected situations.
6. **Dress properly. Do not wear loose clothing or jewellery. Keep your hair, clothing and gloves away from moving parts.** Loose clothes, jewellery or long hair can be caught in moving parts.
7. **If devices are provided for the connection of dust extraction and collection facilities, ensure these are connected and properly used.** Use of dust collection can reduce dust-related hazards.

Power tool use and care

1. **Do not force the power tool. Use the correct power tool for your application.** The correct power tool will do the job better and safer at the rate for which it was designed.
2. **Do not use the power tool if the switch does not turn it on and off.** Any power tool that cannot be controlled with the switch is dangerous and must be repaired.
3. **Disconnect the plug from the power source before making any adjustments, changing accessories, or storing power tools.** Such preventive safety measures reduce the risk of starting the power tool accidentally.
4. **Store idle power tools out of the reach of children and do not allow persons unfamiliar with the power tool or these instructions to operate the power tool.** Power tools are dangerous in the hands of untrained users.
5. **Maintain power tools. Check for misalignment or binding of moving parts, breakage of parts and any other condition that may affect the power tool's operation. If damaged, have the power tool repaired before use.** Many accidents are caused by poorly maintained power tools.
6. **Keep cutting tools sharp and clean.** Properly maintained cutting tools with sharp cutting edges are less likely to bind and are easier to control.
7. **Use the power tool, accessories and tool bits etc. in accordance with these instructions, taking into account the working conditions and the work to be performed.** Use of the power tool for operations different from those intended could result in a hazardous situation.

Service

1. **Have your power tools serviced by a qualified repair person using only identical replacement parts.** This will ensure that safety of the power tool is maintained.



Safety warnings for heat gun

1. **WARNING!** The tool must be placed on its stand when not in use.
2. A fire may result if the product is not used with care, therefore
 - be careful when using the product in places where there are combustible materials;
 - do not apply to the same place for a long time;
 - do not use in presence of an explosive atmosphere;
 - be aware that heat may be conducted to combustible materials that are out of sight;
 - place the product on its stand after use and allow it to cool down before storage;
 - do not leave the product unattended when it is switched on.

Additional safety warnings for heat gun

1. Keep other people as well as pet out of the working area during operation and before the work area is cleaned thoroughly.
2. Do not use the product near flammable liquids or in explosive atmospheres, such as near fumes, gases or dust. The flameless heat from the product may ignite the dust or fumes. Remove materials or debris that may become ignited from work area.
3. Hidden areas such as behind walls, ceilings, floors, soffit boards and other panels may contain flammable materials that may ignite when using the product in these locations. Ignition of these materials may not be readily apparent and could result in property damage and personal injury. Check these areas before applying heat. If in doubt, use a different method.
4. Keep away from the hot air outlet. This product releases an air stream of high temperature that can cause serious burns and personal injury.



EN

5. Clean up all paint scrapings and dust. Do not sweep, dry dust or vacuum to avoid the paint dust will be thrown up into the air where it can be inhaled or contaminate other areas. Wet mop floors. Use a wet cloth to clean all walls, sills and other surfaces where paint and dust have accumulated.
6. Dispose of paint scrapings properly.
7. Do not obstruct either the air vents or nozzle outlet, as this may cause excessive heat build up resulting in damage to the product.
8. Do not direct the hot air blast at persons.
9. Do not aim the hot airflow at the same area for prolonged periods. Working with plastic, paint, varnish or similar materials may produce easily flammable gases.
10. Safely place the power tool on the storage surfaces after use and let it cool completely before packing it away. The hot nozzle can cause damage.
11. Do not leave the switched-on power tool unattended.
12. Keep your work area well-ventilated. The gas and steam produced during work are often harmful to one's health.
13. Do not use the power tool as a hair dryer or attempt to dry pets.
14. The distance between the nozzle and the workpiece depends on the material you are working on (metal, plastic, etc.) and the intended working method. Always test the amount of air and temperature first.
15. If operating the power tool in a damp location is unavoidable, use a residual current device (RCD) protected supply. Use of an RCD reduces the risk of electric shock.

Safety Warnings for stripping paint.

1. Before stripping any paint, you should determine whether the paint contains any lead. Paint containing lead should be removed by a professional and not by using a heat gun.



2. Ideally move the workpiece to an outdoor location. If this is not possible, ensure the work area is well ventilated.
3. Wear an approved dust respirator mask or dual filter mask for dust and fumes. Ensure that the mask fits properly. Disposable paper masks are not adequate.
4. Keep the gun moving when in use to avoid excessive heat build up.
5. Keep food and drink out of the work area. Wash hands and face thoroughly before eating or drinking.

The following information applies to professional users only but is good practice for all users:

ADDITIONAL SAFETY WARNINGS FOR CONSTRUCTION DUST

The updated Control of Substances Hazardous to Health Regulations 1st October 2012 now also targets to reduce the risks associated with silica, wood and gypsum dusts.

Construction workers are one of the at-risk groups within this because of the dust that they breathe: silica dust is not just a nuisance; it is a real risk to your lungs!

Silica is a natural mineral present in large amounts in things like sand, sandstone and granite. It is also commonly found in many construction materials such as concrete and mortar. The silica is broken into very fine dust (also known as Respirable Crystalline Silica or RCS) during many common tasks such as cutting, drilling and grinding. Breathing in very fine particles of crystalline silica can lead to the development of:

- lung cancer
- Silicosis
- Chronic obstructive pulmonary disease (COPD).

And breathing in fine particles of wood dust can lead to the development of Asthma. The risk of lung disease is linked to people who regularly breathe construction dust over a period of time, not on the odd occasion.



EN

To protect the lung, the COSHH Regulations sets a limit on the amount of these dusts that you can breathe (called a Workplace Exposure Limit or WEL) when averaged over a normal working day. These limits are not a large amount of dust: when compared to a penny it is tiny – like a small pinch of salt:

This limit is the legal maximum; the most you can breathe after the right controls have been used.

How to reduce the amount of dust?

1. Reduce the amount of cutting by using the best sizes of building products.
2. Use a less powerful tool e.g. a block cutter instead of angle grinder.
3. Using a different method of work altogether – e.g. using a nail gun to direct fasten cable trays instead of drilling holes first.

Please always work with approved safety equipment, such as those dust masks that specially designed to filter out microscopic particles and use the dust extraction facility at all time.

For more information please see the HSE website:

<http://www.hse.gov.uk/construction> or <http://www.hse.gov.uk/pubns/cis69.pdf>



WARNING! Some dust particles created by power sanding, sawing, grinding, drill and other construction jobs contain chemicals known to cause cancer, birth defects or other reproductive harm. Some examples of these chemicals are:

- Lead from lead-based paints.
- Crystalline silica from bricks and cement and other masonry products.
- Arsenic and chromium from chemically treated timber.

Your risk from these exposures varies, depending upon how often you do this type of work. To reduce your exposure to these dusts:

- Work in a well-ventilated.
- Work with approved protective equipment, such as those dust masks that are specially designed to filter microscopic particles.

VIBRATION

The European Physical Agents (Vibration) Directive has been brought in to help reduce hand arm vibration syndrome injuries to power tool users. The directive requires power tool manufacturers and suppliers to provide indicative vibration test results to enable users to make informed decisions as to the period of time a power tool can be used safely on a daily basis and the choice of tool.

SEE TECHNICAL SPECIFICATIONS IN THE INSTRUCTION MANUAL FOR THE VIBRATION LEVELS OF YOUR TOOL.

The declared vibration emission value should be used as a minimum level and should be used with the current guidance on vibration.

Calculating the actual period of use can be difficult and the HSE website has further information.



EN

The declared vibration total value has been measured in accordance with standardised test and may be used for compare one tool with another.

The declared vibration total value may also be used in a preliminary assessment of exposure.



WARNING! The vibration emission during actual use of the power tool can differ from the declared total value depending on the ways in which the tool is used:

- How the materials are grinded, cut or drilled.
- If the tool is in good condition and well maintained.
- Use correct accessory for the tool and ensure it is sharp and in good condition.
- The tightness of the gripping handles.

While working with this power tool, hand/arm vibrations occur. Adopt the correct working practices in order to reduce the exposure to vibration. This tool may cause hand-arm vibration syndrome if its use is not adequately managed.



WARNING! Identify safety measures to protect the operator that are based on an estimation of exposure in the actual conditions of use (taking account of all parts of the operating cycle such as the times when the tool is switched off and when it is running idle in addition to the trigger time).

Note:

- The use of other tools will reduce the users' total working period on this tool.
- Helping to minimise your vibration exposure risk. ALWAYS use sharp chisels, drills and blades.
- Maintain this tool in accordance with these instructions and keep well lubricated (where appropriate).
- Avoid using tools in temperatures of 10 °C or less. Plan your work schedule to spread any high vibration tool use across a number of days.

Health surveillance

All employees should be part of an employer's health surveillance scheme to help identify any vibration related diseases at an early stage, prevent disease progression and help employees stay in work.

VIBRATION AND NOISE REDUCTION

To reduce the impact of noise and vibration emission, limit the time of operation, use low-vibration and low-noise operating modes as well as wear personal protective equipment.

Take the following points into account to minimise the vibration and noise exposure risks:

1. Only use the product as intended by its design and these instructions.

2. Ensure that the product is in good condition and well maintained.
3. Use correct attachments for the product and ensure they are in good condition.
4. Keep tight grip on the handles/grip surface.
5. Maintain this product in accordance with these instructions and keep it well lubricated (where appropriate).
6. Plan your work schedule to spread any high vibration tool use across a longer period of time.
7. Prolonged use of the product exposes the user to vibrations that can cause a range of conditions collectively known as hand-arm vibration syndrome (HAVS) e.g. fingers going white; as well as specific diseases such as carpal tunnel syndrome. To reduce this risk when using the product, always wear protective gloves and keep your hands warm.

Emergency

Familiarise yourself with the use of this product by means of this instruction manual. Memorise the safety instructions and follow them to the letter. This will help to prevent risks and hazards.

1. **Always be alert when using this product, so that you can recognise and handle risks early.** Fast intervention can prevent serious injury and damage to property.
2. **Switch off and disconnect from the power supply if there are malfunctions.** Have the product checked by a qualified professional and repaired, if necessary, before you operate it again.



RESIDUAL RISKS

Even if you are operating this product in accordance with all the safety requirements, potential risks of injury and damage remain. The following dangers can arise in connection with the structure and design of this product:

1. Health defects resulting from vibration emission if the product is being used over long periods of time or not adequately managed and properly maintained.
2. Injuries and damage to property due to broken attachments or the sudden impact of hidden objects during use.
3. Danger of injury and property damage caused by flying objects or poor power tool accessories.



WARNING! This product produces an electromagnetic field during operation! This field may under some circumstances interfere with active or passive medical implants! To reduce the risk of serious or fatal injury, we recommend persons with medical implants to consult their doctor and the medical implant manufacturer before operating this product!



EN



WARNING! Please read all safety warnings carefully and be sure that they are fully understood before handling the tool.

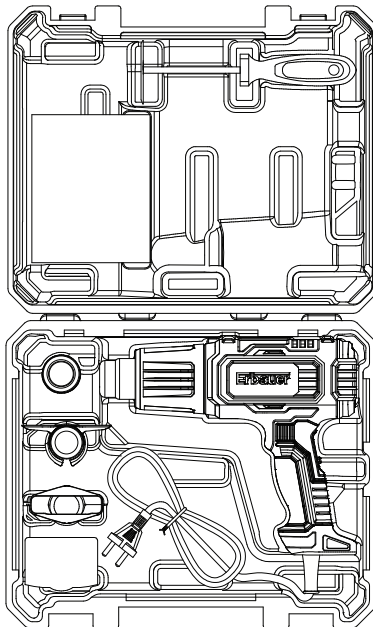



Product description

1

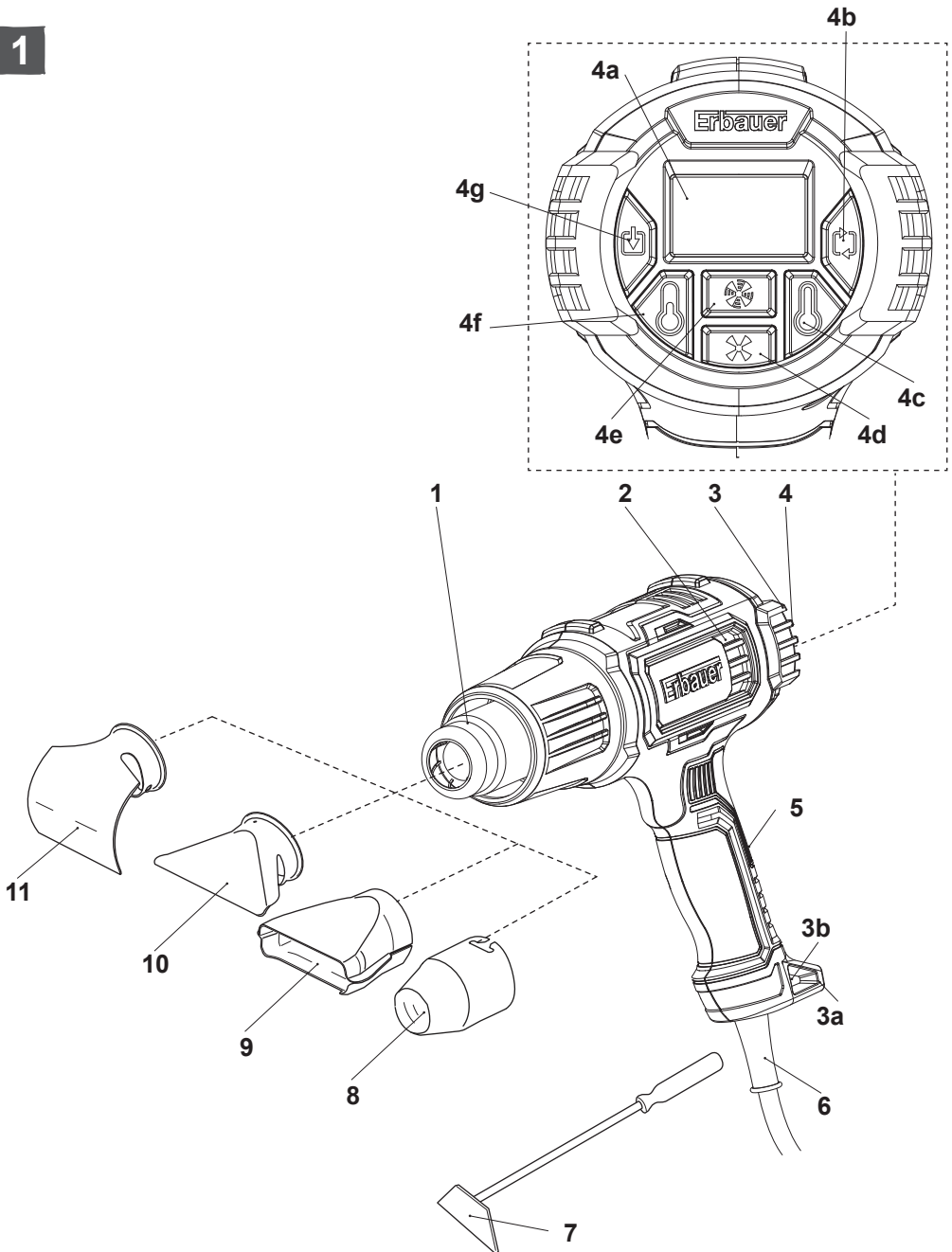



EN

A

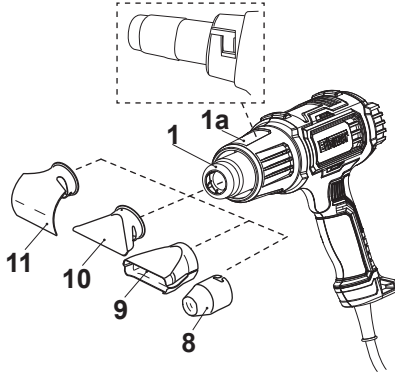

B

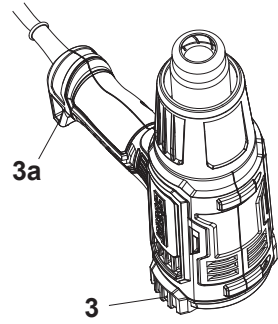

C

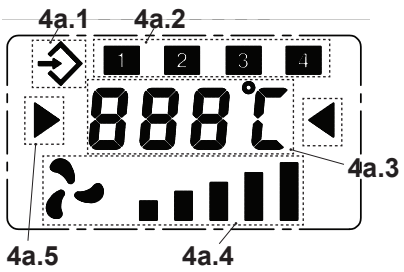

D

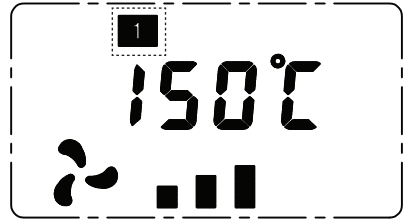

E

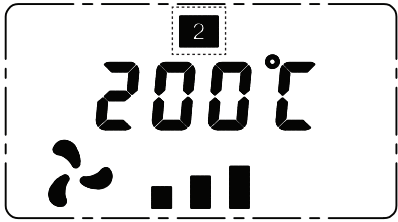

F

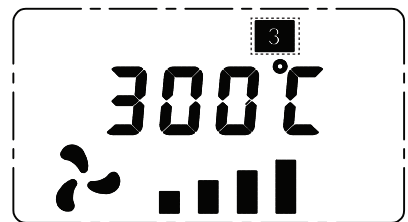

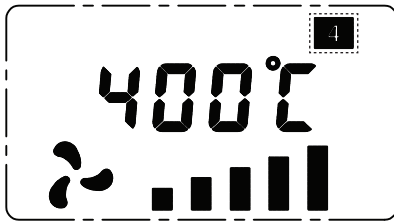
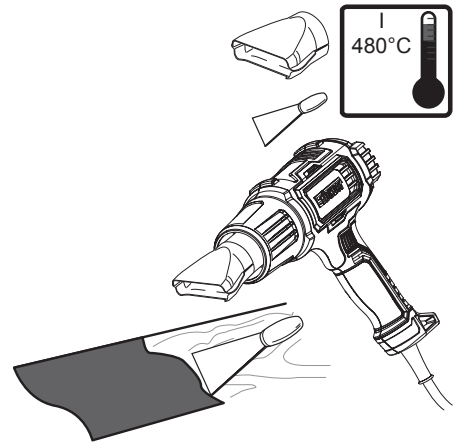
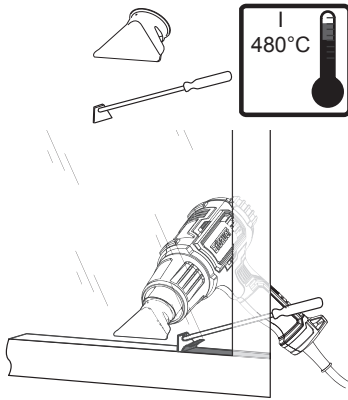
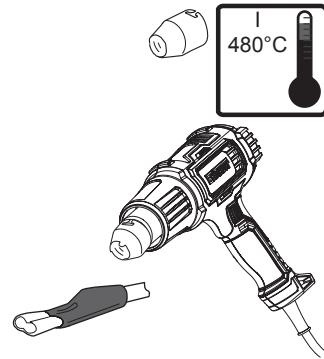
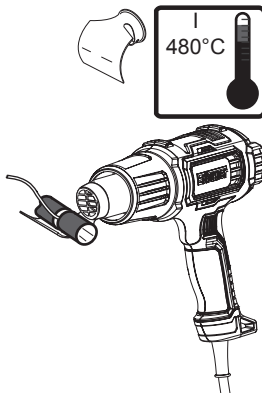
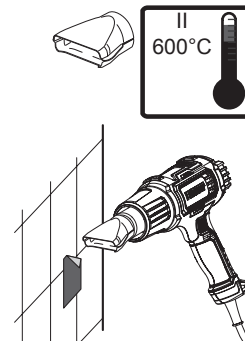
**G****H****I****J****K****L**



EN

M

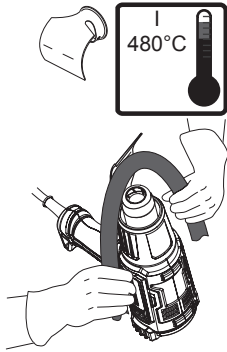

N

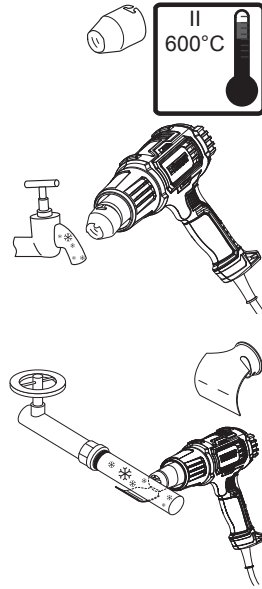











Part index

The index below refers to Fig. 1 on page 10.

- | | |
|--------------------------------|--------------------------------|
| 1. Hot air outlet | f) Decrease temperature button |
| 2. Air intake opening | |
| 3. Stand | g) Pre-set save button |
| a) Rear stand | |
| b) Hanging hook | |
| 4. Control panel | 5. On/off switch O/III |
| a) LCD display | 6. Power cord |
| b) Pre-set selection button | 7. Scraper |
| c) Increase temperature button | 8. Concentrator nozzle |
| d) Decrease air flow button | 9. Spreader nozzle |
| e) Increase air flow button | 10. Glass protector nozzle |
| | 11. Reflector nozzle |

Symbols

On the product, the rating label and within these instructions you will find among others the following symbols and abbreviations. Familiarise yourself with them to reduce hazards like personal injuries and damage to property.

V~	Volt, (alternating voltage)	W	Watt
kg	Kilogram	Hz	Hertz
°C	Celsius degree	l/min	Litre per minute
	Lock / to tighten or secure		Unlock / to loosen.
	Wear protective, slip-resistant footwear		
	Always wear eye protection.		Always wear ear protection.
	Wear respiratory protection.		Wear protective gloves.
	Note / Remark.		Caution / Warning.

EN



Read the instruction manual



Switch the product off and disconnect it from the power supply before assembly, cleaning, adjustments, maintenance, storage and transportation.



This product is of protection class II. That means it is equipped with enhanced or double insulation.



The product complies with the applicable European directives and an evaluation method of conformity for these directives was done.



WEEE symbol. Waste electrical products should not be disposed of with household waste. Please recycle where facilities exist. Check with your Local Authority or local store for recycling advice.

yyWxx

Manufacturing date code; year of manufacturing (20yy) and week of manufacturing (Wxx)

Technical data

General

Rated voltage/frequency	: 220 - 240 V ~ / 50 Hz
Rated input	: 2000 W
Temperature/air flow setting	
Switch position I	: 50°C / 250 - 500 l/min
Switch position II	: 50 - 650°C / 250 - 500 l/min
Protection class	: II 
Degree of protection	: IPX0
Weight	: 0.97 kg

Rating label explanation

EHG2000 = Model number
E = ERBAUER
HG = Heat gun
2000= Rated power input 2000 W



Assembly

01 Unpacking

1. Unpack all parts and lay them on a flat, stable surface.
2. Remove all packing materials and shipping devices, if applicable.
3. Make sure the delivery contents are complete and free of any damage. If you find that parts are missing or damaged do not use the product and contact your dealer. Using an incomplete or damaged product represents a hazard to people and property.
4. Ensure all the accessories and tools needed for assembly and operation are at your disposal, including suitable personal protective equipment.



WARNING! The product must be fully assembled before operation! Do not use a product that is only partly assembled or assembled with damaged parts!



Wear protective gloves for this assembly work and always lay the product on a flat and stable surface while assembling.

Follow the assembly instructions step-by-step and use the pictures provided as a visual guide to easily assemble the product!



Do not connect the product to power supply before it is completely assembled!



WARNING! The product and the packaging are not children's toys! Keep plastics bags, sheets and small parts away from children. There is a danger of choking and suffocation!

02 Accessories (Fig. A)

Different nozzle attachments can be used depending on the work being conducted. The heat protection collar (1a) can be removed for hard-to reach locations. Hold and rotate the collar (1a) anti-clockwise to remove it.







WARNING! Always use accessories according to the intended use!



Some accessories are very sharp and become hot during use! Handle them carefully!

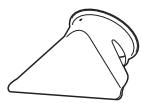

Wear safety gloves when handling accessories in order to avoid injuries like burns and cuts!

Illustration	Description	Application
	Concentrator nozzle (8)	Directs hot air onto small specific areas.
	Spreader nozzle (9)	Directs a long narrow heat pattern to the workpiece. For removing paint or varnish from large flat surfaces such as skirting boards, doors, stairs etc. To be used in conjunction with the scraper.
	Glass protector nozzle (10)	Deflects the heat away from glass or other fragile areas and back onto the workpiece. Stripping paint and varnish on window sills.
	Reflector nozzle (11)	Directs hot air onto hard to reach, awkward areas or to spread the heat more evenly around copper pipes.



Attaching accessories

1. Align the required nozzle (8 - 11) with the hot air outlet (1) and attach it. Ensure it fits properly.

Removing/replacing accessories

1. After use, let the nozzle cool down before removing it.
2. Remove the nozzle (8 - 11) from the hot air outlet (1) and attach a new nozzle as required.



WARNING! Do not touch the nozzle as it becomes very hot during use and remains hot for up to 30 minutes after use.



03 Connection to power supply

1. Make sure the on/off switch (5) is set on its **O** position.
2. Connect the plug with a suitable socket.



WARNING! Check the voltage! The voltage must comply with the information on the rating label!

3. Your product is now ready to be used.



EN



Use

Intended use

This heat gun EHG2000 is designated with a rated input of 2000 Watts.

This product is intended for removing paint, forming and bending of plastic tubes, and the warming of heat-shrinkable tubing, using the respective nozzles. The product is also suitable for soldering and tinning, loosening adhesive joints and defrosting water pipes.

This product must not be used on clothing or drying the hair or other body parts of pets and humans.

For safety reasons it is essential to read the entire instruction manual before first operation and to observe all the instructions therein.

Always place the product on its stand (3) after operation, when not in use.

Before you start

01 Protection



Controls



WARNING! Do not connect the product to power supply before it is completely assembled!





01 Stand (Fig. B)

Always place the product on its stand (3) after operation, when not in use.

02 On/off switch

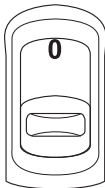
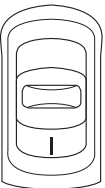
Set the on/off switch (5) to desired position.

Position	Setting	Applications
	0 – Off	– Cleaning and storage
	I – On Cool-off position 50 °C	<ul style="list-style-type: none"> – Changing the mode from high temperature to cool temperature quickly. – Reducing the cooling time of the product before changing accessories. – Reducing the cooling time of the product before storage – Reducing the cooling time of the workpiece.
	II – On 50- 650 °C	<ul style="list-style-type: none"> – Removing paint. – Shrinking plastic sleeves. – Soldering pipes. – Bending plastic tubes. – Removing stickers. – Defrosting taps and tubes.







NOTE: If you are not sure about the correct setting, start with a low temperature setting and gradually increase the temperature until you achieve optimum results.

03 Control panel

LCD display

The LCD display shows the product status (Fig. C).

Element	Function	Description
	Pre-set input	The current setting can be stored as pre-set mode.
	Pre-set mode indication	Current pre-set mode number.
	Temperature indication	Current temperature.
	Air flow indication	Current air flow.
	Flash	It will disappear after the temperature reaching the setting value.

Setting the temperature

1. Press the increase temperature button (4c) to increase the set temperature on the display (4). The temperature is increased by intervals of 10 °C. Alternatively, press and hold the increase temperature button (4c) until the required temperature setting is reached.
2. Press the decrease temperature button (4f) to decrease the set temperature on the display (4). The temperature is decreased by intervals of 10 °C. Alternatively, press and hold the decrease temperature button (4f) until the required temperature setting is reached.



NOTE: When setting the required temperature, keep in mind that the maximum reachable temperature is limited by the on/off switch (5) setting. To reach the product maximum temperature, first set the on/off switch to its II position.

Setting the air flow rate

1. Set the air flow rate to one of its five levels, using the control panel (4).
2. Press the increase air flow button (4e) to increase the air flow. Press the decrease air flow button (4d) to decrease the air flow.

Preset mode selection

1. 4 preset modes are available for quick selection of temperature and air flow settings for the most frequently used applications (Fig. D ~ Fig. G).
2. Set the on/off switch on its II position. Press the pre-set selection button (4b) to select the required preset temperature and air flow.

Preset mode input

1. Select one available preset mode.
2. Set the desired temperature and air flow by clicking the relevant buttons (4c, 4d, 4e, 4f). During the process, the preset input symbol keeps flashing.
3. Press the pre-set save button (4g) for 2 seconds until the preset input symbol disappears. The new temperature and air flow setting is stored into the preset mode for quick selection.

04 Thermal protection

This product is equipped with a self-resettable safety cut-out which will operate to cut off the power supply to the heating elements when the internal temperature gets too high. It will reset automatically when the product has cooled down.

Operation

1. Check the product, its power cord and plug as well as accessories for damage before each use. Do not use the product if it is damaged or shows wear.
2. Double check that accessories or attachments are properly fixed.
3. Always hold the product by its handle. Keep the handle dry and clean to ensure safe support.



WARNING! Do not drop the product. The heating element inside the product is particularly sensitive to shock and impact.

4. Ensure that the air vents are always unobstructed and clear. Clean them if necessary with a soft brush. Blocked air vents may lead to overheating and damage the product.
5. Switch the product off immediately if you are disturbed while working with it and when other people enter the working area. Always let the product come to complete stop before putting it down.
6. Do not overwork yourself. Take regular breaks to ensure you can concentrate on the work and have full control over the product.



EN

**WARNING!**

During operation fumes will be generated! Some fumes and dust are highly inflammable and explosive!

Do not smoke during operation, keep heat sources and open flames out of the working area!

Always wear an approved dust mask to protect yourself against hazards resulting from fumes and fine dust!

**01 Removing paint**

Do not use this product to remove paint containing lead. The peelings, residue and vapours of paint may contain lead, which is poisonous. Any pre-1960 building may have been painted in the past with paint containing lead and covered with additional layers of paint. Once deposited on surfaces, hand to mouth contact can result in the ingestion of lead. Exposure even to low levels of lead can cause irreversible damage to the brain and nervous system. Young and unborn children are particularly vulnerable. When removing paint, ensure the work area is enclosed. Wear a dust mask.

Do not burn the paint. Use the scraper and keep the nozzle at least 25 mm away from the painted surface. When working in a vertical direction, work downwards to prevent paint from falling into the product and burning.

Dispose of all paint debris safely and ensure the work area is thoroughly cleaned after completing the work.

Large surfaces (Fig. H)

1. Soften the paint using hot air and remove evenly using a spatula.
2. Do not heat the paint for too long since this will burn the paint, making it more difficult to remove.

Window frames and profiles (Fig. I)

1. Do not apply airflow directly to glass as this may crack or shatter – danger of property damage or personal injury.
2. Strip paints on window frames and profiles using the scraper.



NOTE: The proper amount of heat for each application depends on the temperature range selected, distance between the nozzle and workpiece as well as the length of time heat is applied.

Experiment with scrap materials and start with the lowest temperature setting.

3. Be careful when working until the proper combination of heat, distance and time of application has been obtained. Use a back and forth motion when applying heat unless concentrated heat is desirable. Pausing or lingering in one spot may ignite or melt the workpiece or the material behind it.

02 Shrinking plastic sleeves (Fig. J)

1. Apply the air stream evenly to the sleeve.
2. Avert the air stream once the sleeve shrinks.

03 Soldering pipes (Fig. K)

1. Apply suitable soldering grease or paste to the pipe ends to be soldered when solder without flux is used.
2. Stick the pipe end together and warm the connection for 1 to 2 minutes depending on the material.
3. Apply the solder which will melt due to the workpiece temperature.
4. Remove remaining flux after the soldered pipes have cooled down.

04 Removing stickers (Fig. L)

1. Many adhesives (e.g. stickers) become softer when heated allowing adhesive bonds to be separated or adhesive to be removed.
2. Heat the sticker carefully and pull it off.

05 Bending plastic tubes (Fig. M)

1. Fill the tubing with sand and seal at both ends, to avoid kinking the tubing
2. Heat the tubing evenly by moving it from side to side.
3. Unseal the tubing and remove sand after bending.

06 Defrosting taps and tubes (Fig. N)

1. Always heat the frozen zone from the outside to the middle.
2. Be careful when applying the heat to plastic pipes to avoid damage.



WARNING! Do not attempt to use the product on gas pipes – Danger of explosion! Before defrosting always ensure that the pipe you are going to defrost is a water pipe!

After use

1. Turn the on/off switch to its “I” position and let the product run for a few minutes to reduce the cooling time.
2. Switch the product off, place it on its stand (3), disconnect it from the power supply and let it cool down.
3. Check, clean and store the product as described below.



Care & maintenance



WARNING!

Always switch the product off, disconnect it from the power supply and let the product cool down before performing inspection, maintenance and cleaning work!



1. Keep the product clean. Remove debris from it after each use and before storage.
2. Regular and proper cleaning will help ensure safe use and prolong the life of the product.
3. Inspect the product before each use for worn and damaged parts. Do not operate it if you find broken and worn parts.



WARNING!

Only perform repairs and maintenance work according to these instructions! All further works must be performed by a qualified specialist!



Clean

1. Clean the product with a slightly damp cloth and mild soap. Use a brush for areas that are hard to reach.
2. In particular clean the air intake opening (2) after every use with a cloth and brush.
3. Remove stubborn dirt with high pressure air (max. 3 bar).
4. Check for any damage and wear. Repair damages in accordance with this instruction manual or take it to an authorised service centre before using the product again.



NOTE: Do not use chemical, alkaline, abrasive or other aggressive detergents or disinfectants to clean this product as they might be harmful to its surfaces.

Maintenance

Before and after each use, check the product and accessories (or attachments) for wear and damage. If required, exchange them for new ones as described in this instruction manual.

01 Power cord

If the supply cord is damaged, it must be replaced by the manufacturer, its service agent or similarly qualified persons in order to avoid a hazard.

02 UK plug (only for UK market)

If you need to replace the fitted plug, then follow the instructions below.

IMPORTANT: The wires in the mains lead are coloured in accordance with the following code:

Blue – Neutral Brown – Live

As the colours of the wire in the mains lead of this product may not correspond with the coloured marking identifying the terminals in your plug, proceed as follows. The wire, which is coloured blue, must be connected to the terminal, which is marked with N or coloured black. The wire, which is coloured brown, must be connected to the terminal, which is marked L or coloured red.

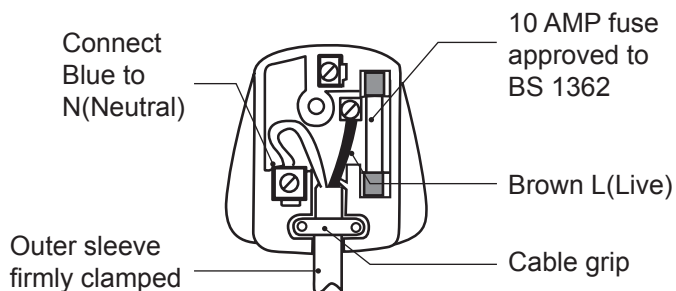

WARNING! Never connect live or neutral wires to the earth terminal of the plug, which is marked with E.

Only fit an approved 10 Amp BS 1363 or BS 1363/A plug and the correctly rated fuse. If in doubt, consult a qualified electrician.

If a moulded plug is fitted and has to be removed take great care in disposing of the plug and severed cable, it must be destroyed to prevent engaging into a socket.

03 Repair

This product does not contain any parts that can be repaired by the consumer. Contact an authorised service centre or a similarly qualified person to have it checked and repaired.

Transportation

1. Switch the product off and disconnect it from the power supply.
2. Attach transportation guards, if applicable.
3. Always carry the product by its handle.
4. Protect the product from any heavy impact or strong vibrations which may occur during transportation in vehicles.
5. Secure the product to prevent it from slipping or falling over.

Storage

1. Switch the product off and disconnect it from the power supply.
2. Clean the product as described above.

3. Store the product and its accessories in a dry, frost-free place.
4. Always store the product in a place that is inaccessible to children. The ideal storage temperature is between 10 °C and 30 °C.
5. We recommend using the original package for storage or covering the product with a suitable cloth or enclosure to protect it against dust.

Troubleshooting

Suspected malfunctions are often due to causes that the users can fix themselves. Therefore check the product using this section. In most cases the problem can be solved quickly.



WARNING! Only perform the steps described within these instructions! All further inspection, maintenance and repair work must be performed by an authorised service centre or a similarly qualified specialist if you cannot solve the problem yourself!

Problem	Possible cause	Solution
1. Product does not start	1.1 Not connected to power supply 1.2 Power cord or plug is defective 1.3 Other electrical defect to the product	1.1 Connect to power supply 1.2 Check by a specialist electrician. 1.3 Check by a specialist electrician
2. Product does not reach full power	2.1 Extension cord not suitable for operation with this product 2.2 Power source (e.g. generator) has too low voltage 2.3 Air vents are blocked	2.1 Use a proper extension cord 2.2 Connect to another power source 2.3 Clean the air vents
3. Unsatisfactory result	3.1 Accessory not suitable for workpiece material 3.2 Temperature / airflow not suitable for application	3.1 Use proper accessory 3.3 Adjust temperature / air flow



EN

Recycling and disposal



Waste electrical products should not be disposed of with household waste. Please recycle where facilities exist. Check with your local authority or local store for recycling advice.

The product comes in a package that protects it against damage during shipping. Keep the package until you are sure that all parts have been delivered and the product is working properly. Recycle the package afterwards.



Guarantee

At **Erbauer** we take special care to select high quality materials and use manufacturing techniques that allow us to create ranges of products incorporating design and durability. We carry out stringent testing procedures on all our tools and are confident that they can provide regular, sustained daily use during the period covered. That's why we offer a 3 year guarantee against manufacturing defects on our **Erbauer** power tool products.

This power tool is guaranteed for 3 years from the date of purchase, if bought in store, delivered or bought online. You may only make a claim under this guarantee upon presentation of your sales receipt or purchase invoice. Please keep your proof of purchase in a safe place.

This guarantee covers product failures and malfunctions provided the **Erbauer** power tool was used for the purpose for which it is intended and subject to installation, cleaning, care and maintenance in accordance with standard practice and with the information contained above and in the user manual. This guarantee does not cover defects and damage caused by or resulting from:

- Normal wear and tear
- Overload, misuse or neglect
- Repairs attempted by anyone other than an authorised agent
- Cosmetic damage
- Damage caused by foreign objects, substances or accidents
- Accidental damage or modification
- Failure to follow manufacturer's guidelines
- Loss of use of the goods

This guarantee is limited to parts recognised as defective. It does not, in any case, cover ancillary costs (movement, labour) and direct and indirect damage.

If the **Erbauer** power tool is defective during the guarantee period, then we reserve the right, at our discretion, to replace the item with a product of equivalent quality and functionality or to provide a refund.

This guarantee only applies to the country of purchase or delivery and is not transferrable to any other countries. This guarantee is non-transferrable to any other person or product. Relevant local law will apply to this guarantee.

Guarantee related queries should be addressed to a store affiliated with the distributor from where you purchased the **Erbauer** power tool.

This guarantee is in addition to and does not affect your statutory rights relating to faulty goods as a consumer.



(EN) EU DECLARATION OF CONFORMITY
(FR) DÉCLARATION UE DE CONFORMITÉ
(PL) DEKLARACJA ZGODNOŚCI UE
(RO) DECLARAȚIA DE CONFORMITATE UE
(ES) DECLARACIÓN UE DE CONFORMIDAD
(PT) DECLARAÇÃO DE CONFORMIDADE UE

Product/ Produit/ Produkt/Produsul/Producto/Produto

- 2000W Heat Gun/Pistolet thermique 2000 W/2000W opalarka/2000W Pistol de căldură/Pistola térmica de 2000W/2000W Pistola de calor
- EHG2000
- Serial number: from 000001 to 999999

Name and address of the manufacturer or his authorised representative:
 Nom et adresse du fabricant ou de son mandataire:
 Nazwa i adres producenta lub jego upoważnionego przedstawiciela:
 Denumirea și adresa producătorului sau a reprezentantului său autorizat:
 Nombre y dirección del fabricante o de su representante autorizado:
 Nome e endereço do fabricante ou do respetivo mandatário:

Kingfisher International Products B.V.,
 Rapenburgerstraat 175E,
 1011 VM Amsterdam,
 The Netherlands

This declaration of conformity is issued under the sole responsibility of the manufacturer.

La présente déclaration de conformité est établie sous la seule responsabilité du fabricant.

Niniejsza deklaracja zgodności wydana zostaje na wyłączną odpowiedzialność producenta.

Prezenta declarație de conformitate este emisă pe răspunderea exclusivă a producătorului.



La presente declaración de conformidad se expide bajo la exclusiva responsabilidad del fabricante.

A presente declaração de conformidade é emitida sob a exclusiva responsabilidade do fabricante.

Object of the declaration/Objet de la declaration/Przedmiot deklaracji/
Obiectul declarației/Objeto de la declaración/Objeto da declaração

Product/Produit/Produkt/
Produsul/ Producto/ Produto

Model/Modèle/
Model/Modelul/
Modelo/ Modelo

EAN

2000W Heat Gun/Pistolet
thermique 2000 W/2000W
opalarka/2000W Pistol de
căldură/Pistola térmica de
2000W/2000W Pistola de calor

EHG2000

5059340043234
5059340043241

The object of the declaration described above is in conformity with the relevant Union harmonisation legislation:

L'objet de la déclaration décrit ci-dessus est conforme à la législation d'harmonisation de l'Union applicable:

Wymieniony powyżej przedmiot niniejszej deklaracji jest zgodny z odnośnymi wymaganiami unijnego prawodawstwa harmonizacyjnego:

Obiectul declarației descris mai sus este în conformitate cu legislația relevantă de armonizare a Uniunii:

El objeto de la declaración descrita anteriormente es conforme con la legislación de armonización pertinente de la Unión:

O objeto da declaração acima descrito está em conformidade com a legislação de harmonização da União aplicável:

2014/30/EU as amended Directive Electromagnetic compatibility
2014/35/EU Directive Electrical Safety: Low-voltage electrical equipment
2011/65/EU & (EU) 2015/863 as amended Directive Restriction of the
use of certain hazardous substances in electrical and electronic equipment

2014/30 / UE telle que modifiée Directive Compatibilité électromagnétique
 2014/35/EU Directive Sécurité électrique: matériel électrique à basse tension
 Directive 2011/65 / UE & (EU) 2015/863 telle que modifiée Limitation de
 l'utilisation de certaines substances dangereuses dans les équipements
 électriques et électroniques
 2014/30 / UE ze zmianami Dyrektywa Kompatybilność elektromagnetyczna
 2014/35/EU Dyrektywa Bezpieczeństwo elektryczne: sprzęt elektryczny niskiego
 napięcia
 2011/65 / UE & (EU) 2015/863 ze zmianami Dyrektywa Ograniczenie stosowania
 niektórych niebezpiecznych substancji w sprzęcie elektrycznym i elektronicznym
 2014/30/UE, astfel a fost modificată Directiva privind compatibilitatea
 electromagnetice
 Directiva 2014/35/UE siguranța electrică: echipamente electrice de joasă tensiune
 2011/65/UE, astfel a fost modificată Directiva privind limitarea utilizării anumitor
 substanțe periculoase în echipamentele electrice și electronice
 2014/30/UE modificada Directiva Compatibilidad electromagnética
 2014/35/EU Directiva Seguridad Eléctrica: Equipos eléctricos de baja tensión
 2011/65/UE modificada Directiva Restricción del uso de determinadas sustancias
 peligrosas en equipos eléctricos y electrónicos
 2014/30/UE como alteração da compatibilidade eletromagnética
 2014/35/Diretiva UE Segurança Elétrica: Equipamento elétrico de baixa tensão
 2011/65/UE & (EU) 2015/863 como restrição diretiva alterada da utilização de
 certas substâncias perigosas em equipamentos elétricos e eletrônicos

References to the relevant harmonised standards used or references to the
 other technical specifications in relation to which conformity is declared:
 Références des normes harmonisées pertinentes appliquées, y compris la
 date de celles-ci, ou des autres spécifications techniques, y compris la date
 de celles-ci, par rapport auxquelles la conformité est déclarée:
 Odwołania do odnośnych norm zharmonizowanych, które zastosowano,
 wraz z datą normy, lub do innych specyfikacji technicznych, wraz z datą
 specyfikacji, w odniesieniu do których deklarowana jest zgodność:
 Trimiteri la standardele armonizate relevante folosite, inclusiv data s
 tandardului, sau trimiteri la celelalte specificații tehnice, inclusiv data
 specificațiilor, în legătură cu care se declară conformitatea:



Referencias a las normas armonizadas pertinentes utilizadas, incluidas las fechas de las normas, o referencias a las otras especificaciones técnicas, incluidas las fechas de las especificaciones, respecto a las cuales se declara la conformidad:

Referências às normas harmonizadas aplicáveis utilizadas, incluindo a data da norma, ou às outras especificações técnicas, incluindo a data da especificação, em relação às quais é declarada a conformidade:

EN 60335-2-45 2002+A1:2008+A2:2012

EN 60335-1:2012+AC:2014+A11:2014+A13:2017+A1:2019+A14:2019+A2:2019

EN 62233:2008+AC:2008

EN 55014-1: 2017

EN 55014-2: 2015

EN IEC 61000-3-2:2019

EN 61000-3-3:2013+A1:2019

Authorized Signatory and technical file holder/ Signataire et responsable de la documentation technique autorisé/ Podmiot uprawniony do wystawienia i adres przechowywania dokumentacji technicznej/ Semnatar autorizat și deținătorul dosarului ethnic/ Firmante autorizado y titular del expediente técnico/Signatário autorizado e detentor da ficha técnica:

Kingfisher International Products B.V.,
Rapenburgerstraat 175E,
1011 VM Amsterdam,
The Netherlands

David Awe
Group Quality & Sustainability Director

: 30/08/2020



EN

Erbauer

**Manufacturer, Fabricant, Producent,
Producător, Fabricante:**

UK Manufacturer:
Kingfisher International Products Limited
3 Sheldon Square
London
W2 6PX
United Kingdom

EU Manufacturer:
Kingfisher International Products B.V.
Rapenburgerstraat 175E
1011 VM Amsterdam

EN www.diy.com

www.screwfix.com

To view instruction manuals online,
visit www.kingfisher.com/products
