

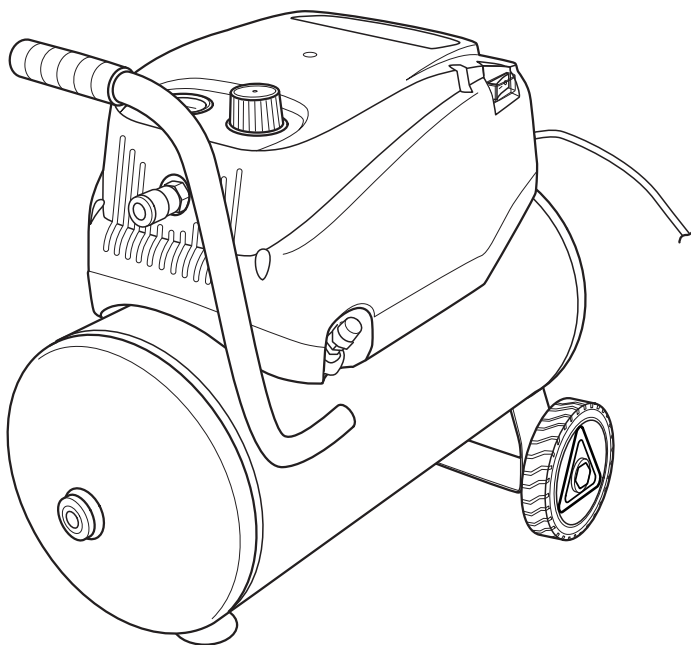

EN

24L 1.5HP Oil Free Air Compressor



Original Instructions_TTB797CPR_GB_V01_201130

TTB797CPR

EAN: 5059340195100

BX220IM



WARNING! Read the instructions before using the appliance!



Let's get started...

These instructions are for your safety. Please read through them thoroughly before use and retain them for future reference.



Getting **started**...

02

Safety information 03**Your** product 13**Before** you **start** 14

In more **detail**...

17

Product functions 18**Operation** 20**Care** and **maintenance** 22**Troubleshooting** 26**Recycling** and **disposal** 27**Guarantee** 27**EC** declaration of conformity 28



Safety warnings

- >Children shall not play with the appliance.
- >Cleaning and user maintenance shall not be made by children without supervision.

General safety warnings



WARNING! When using electric tools basic safety precautions should always be followed to reduce the risk of fire, electric shock and personal injury including the following. Read all these instructions before attempting to operate this product and save these instructions.

Safe operation

- >Keep work area clear
 - Cluttered areas and benches invite injuries.
- >Consider work area environment
 - Do not expose the product to rain.
 - Do not use the product in damp or wet locations. There is a risk of electric shock!
 - Keep work area well lit.
 - Do not use the product in the presence of flammable liquids or gases. There is a risk of explosion!
- >Guard against electric shock
 - Avoid body contact with earthed or grounded surfaces (e.g. pipes, radiators, ranges, refrigerators).
- >Keep other persons away
 - Do not let persons, especially children, not involved in the work touch the product or the extension cord and keep them away from the work area.



Safety warnings

- >Store idle product
 - When not in use, the product should be stored in a dry locked-up place, out of reach of children.
- >Do not overload the product
 - It will do the job better and safer in the role for which it was designed.
- >Use the right attachment tool
 - Do not force small attachment tool to do the job of a heavy duty attachment tool.
 - Do not use attachment tools for purposes not intended.
- >Dress properly
 - Do not wear loose clothing or jewellery, they can be caught in moving parts.
 - Non-skid footwear is recommended when working outdoors.
 - Wear protective hair covering to contain long hair.
- >Use protective equipment
 - Use safety glasses.
 - Use face or dust mask if working operations create dust.
- >Connect dust extraction equipment
 - If the attachment tool is provided for the connection of dust extraction and collecting equipment, ensure these are connected and properly used.
- >Do not abuse the cord
 - Never yank the cord to disconnect it from the socket. Keep the cord away from heat, oil and sharp edges.
- >Secure work
 - Where possible use clamps or a vice to hold the work. It is safer than using your hand.
- >Do not overreach
 - Keep proper footing and balance at all times.
- >Maintain attachment tools with care
 - Keep cutting tools sharp and clean for better and safer performance.



- Follow instruction for lubricating and changing accessories.
- Inspect product cords periodically and if damaged have them repaired by an authorised service facility.
- Inspect extension cords periodically and replace if damaged.
- Keep handle dry, clean and free from oil and grease.
- > Disconnect the product
 - When not in use, before servicing and when changing accessories for the attachment tool, disconnect the product from the power supply.
- > Remove adjusting keys and wrenches
 - Form the habit of checking to see that keys and adjusting wrenches are removed from the product before turning it on.
- > Avoid unintentional starting
 - Ensure switch is in “off” position when plugging in.
- > Use outdoor extension leads
 - When the tool is used outdoors, use only extension cords intended for outdoor use and so marked.
- > Stay alert
 - Watch what you are doing, use common sense and do not operate the product when you are tired.
- > Check damaged parts
 - Before further use of the product, it should be carefully checked to determine that it will operate properly and perform its intended function.
 - Check for alignment of moving parts, binding of moving parts, breakage of parts, mounting and any other conditions that may affect its operation.
 - A guard or other part that is damaged should be properly repaired or replaced by an authorised service centre unless otherwise indicated in this instruction manual.
 - Have defective switches replaced by an authorised service centre.
 - Do not use the product if the switch does not turn it on and off.

Safety warnings

>Warning

- The use of any accessory or attachment other than one recommended in this instruction manual may present a risk of personal injury.
- ### >Have your product repaired by a qualified person
- This electric product complies with the relevant safety rules. Repairs should only be carried out by qualified persons using original spare parts; otherwise this may result in considerable danger to the user.

Air compressor safety warnings

- >Make sure that all compressed air lines and fittings are suitable for the maximum permissible operating pressure of this product.
- >Place this product securely on an even and stable surface.
- >The compressor pump and lines can become very hot during operation. Avoid touching these parts during operation.
- >The air which is sucked in by the compressor pump must be kept free of impurities that could cause fires or explosions in the compressor pump.
- >When releasing the hose coupling, hold the connector with your hand to protect yourself against injury from a rebounding hose.
- >It is recommended using an air line with a safety cable for pressures above 7 bars.
- >Keep the pressure vessel in good working condition. Operate the vessel correctly, monitor it, carry out necessary maintenance and repair work immediately as well as meet the relevant safety precautions.
- >A pressure vessel is not allowed to be used if it has faults or deficiencies that can endanger users.



- > Check the pressure vessel for signs of rust and damage each time before operation. Do not use this product with a damaged or rusty pressure vessel. If you discover any damage, then please contact the customer service centre.
- > Never leave the product unattended during use.
- > The compressed air from your product is not safe for breathing. Never inhale air from your product or from a breathing product connected to the product.
- > Do not modify or attempt to repair. Never drill into, weld, or make any modifications to the product or its attachments.
- > During operation, never point the product at yourself or others, taking particular care to avoid the eyes and ears. Risk of injury!
- > Do not direct the nozzle or hose at animals or bystanders.
- > Warning! When spraying paint or cleaning agents the fine mist produced could ignite. Do not smoke and keep naked flames and other sources of ignition well away from the work area. Make sure that the area in which you are working has good ventilation and protect your nose and mouth with a suitable face mask. Always check the safety data sheets for substances being sprayed and ensure manufacturers instructions are followed.
- > This air compressor must be used in a suitable environment. There must be adequate ventilation, the ambient temperature must be +5 / +40 °C. The working area must be free from dust, acid vapour, explosive gases and flammable materials.
- > Do not direct compressed air at yourself, any other person or animals. Do not direct any liquid or any other material that is being sprayed by yourself towards any other person or animals.

Safety warnings

- > Only use hoses and connectors designed for use with compressed air. The maximum working pressure of hoses and connectors must be higher than the maximum working pressure of the compressor. Do not attempt to move the compressor by pulling on the air hose.
- > This compressor is designed for tyre inflation, the operation of pneumatic tools, spray painting and spraying non-corrosive cleaning agents. Do not use this compressor for filling cylinders for breathing or diving apparatus. Compressed air from this compressor must not be used for pharmaceutical, food or health applications.
- > Always transport the compressor by lifting or pulling it with the appropriate grips or handles.
- > Do not insert your fingers or other objects inside the motor to avoid physical damage or damage to the compressor.
- > If any of the compressor is damaged, it should be carefully checked to determine that it will operate correctly and perform its intended function. Check for alignment of parts, damage to parts, air leaks and any other conditions that may affect its operation. A guard or any other part that is damaged or defective should be properly repaired or replaced by an authorised service centre. Defective pressure switches must be replaced prior to further use of the compressor.
- > Avoid kinking or trapping the air hose. Always replace faulty hoses – never attempt a repair if a leak is detected.
- > Drain the tank after each use. Switch off and slowly open the drain valve to release the air then tilt the compressor to empty condensed water.
- > Keep the motor vent clear and free from dust, wipe regularly to maintain an adequate supply of clean air to the air compressor.



Vibration and noise reduction

To reduce the impact of noise and vibration emission, limit the time of operation, use low-vibration and low-noise operating modes as well as wear personal protective equipment.

Take the following points into account to minimise the vibration and noise exposure risks:

- > Only use the product as intended by its design and these instructions.
- > Ensure that the product is in good condition and well maintained.
- > Use correct attachments for the product and ensure they are in good condition.
- > Keep tight grip on the handles / grip surface, this also includes accessories.
- > Maintain this product in accordance with these instructions and keep it well lubricated (where appropriate).

Important

Familiarise yourself with the use of this product by means of this instruction manual. Memorise the safety directions and follow them to the letter. This will help to prevent risks and hazards.

- > **Always be alert when using this product, so that you can recognise and handle risks early.** Fast intervention can prevent serious injury and damage to property.
- > **Switch off and disconnect from the power supply if there are malfunctions.** Have the product checked by a qualified professional and repaired, if necessary, before you operate it again.

Residual risks

Even if you are operating this product in accordance with all the safety requirements, potential risks of injury and damage remain. The following dangers can arise in connection with the structure and design of this product:

Safety warnings

- >Injuries and damage to property due to broken attachments or the sudden impact of hidden objects during use.
- >Danger of injury and property damage caused by flying objects.



WARNING! This product produces an electromagnetic field during operation! This field may under some circumstances interfere with active or passive medical implants! To reduce the risk of serious or fatal injury, we recommend persons with medical implants to consult their doctor and the medical implant manufacturer before operating this product!



WARNING! Some dust created by power sanding, sawing, grinding, drilling and other construction activities contains chemicals known to cause cancer, birth defects or other reproductive harm. Some examples of these chemicals are:

- Lead from lead-based paint
- Crystalline silica from bricks and cement and other masonry products
- Arsenic and chromium from chemically treated timber

Your risk from these exposures varies, depending upon how often you do this type of work. To reduce your exposure to these chemicals:

- Work in a well-ventilated area.
- Work with approved protective equipment, such as those dust masks that are specially designed to filter microscopic particles.



WARNING! In the event that an air line is cut or broken, the air supply must be turned off at the compressor.

A broken air line which is not supported is extremely dangerous and can whip around very quickly, both with the capability of striking people, and blowing foreign particles into the air.

Do not attempt to catch the air line but immediately keep bystanders well clear and disconnect the air supply to the hose by disconnecting the compressor from the power supply, and then remove the hose from the compressor.

Symbols

On the product, the rating label and within these instructions you will find among others the following symbols and abbreviations. Familiarize yourself with them to reduce hazards like personal injuries and damage to property.

V~	Volt, (alternating voltage)	Hz	Hertz
W	Watt	/min or min ⁻¹	Per minute
s	Second	mm	Millimetre
l	Litre	kg	Kilogram
bar	Pressure unit	dB(A)	Decibel (A-rated)
yyWxx	Manufacturing date code; year of manufacturing (20yy) and week of manufacturing (Wxx)		

IP30 Protection against contact with the solid foreign bodies with $\phi 2.5\text{mm}$.
No protection against water.



Lock / to tighten or secure.



Unlock / to loosen.



Note / Remark.



Caution / Warning.



Read the instruction manual.



Hearing protection must be worn



Wear eye protection.



Wear a dust mask.

Symbols



Wear protective gloves.



Wear protective, slip-resistant footwear.



Beware of electric voltage!



Warning! Risk of high temperature!



Warning! The product may start without warning to maintain the set pressure inside the pressure vessel.



Important! Do not turn the pressure regulator open before the air hose is attached.



Do not direct air stream at persons or animals.



Switch the product off and disconnect it from the power supply before assembly, cleaning, adjustments, maintenance, storage and transportation.



Protective earth.



The product complies with the applicable European directives and an evaluation method of conformity for these directives was done.



UK conformity assessed.



WEEE symbol. Waste electrical products should not be disposed of with household waste. Please recycle where facilities exist. Check with your Local Authority or local store for recycling advice.



Your product

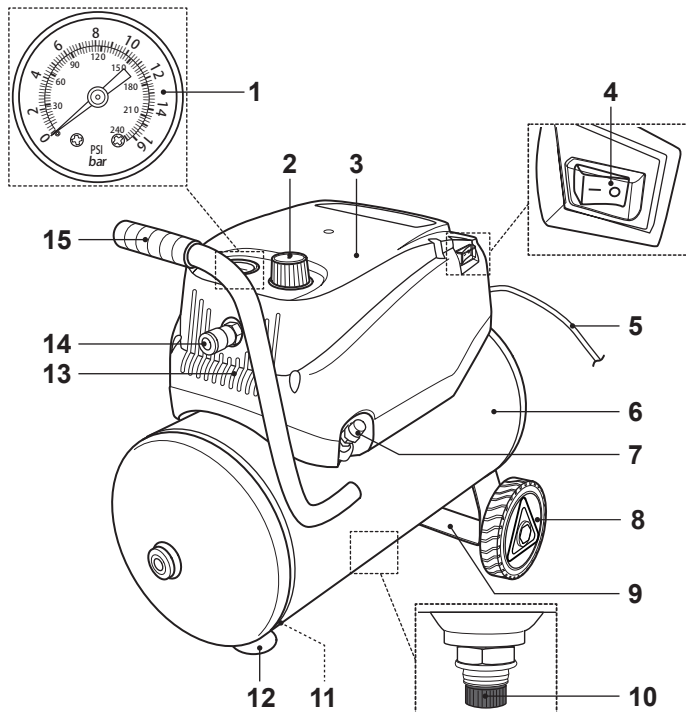

- | | |
|-------------------------------------|--------------------------|
| 1. Pressure gauge | 10. Drain valve |
| 2. Pressure regulator | 11. Front support |
| 3. Cover | 12. Rubber foot |
| 4. On / off switch | a. Bolt* |
| 5. Power cord with plug | b. Nut* |
| 6. Pressure vessel | 13. Air vents |
| 7. Safety valve | 14. Quick-lock coupling |
| 8. Wheel (x 2) | (air outlet) |
| a. Axle with washer and welded nut* | 15. Transport handle |
| b. Locking nut* | 16. Adaptor (male plug)* |
| 9. Rear support | |



NOTE: Parts marked with * are not shown in this overview. Please refer to the respective section in the instruction manual.

Getting started...

Technical specifications

General

- > **Rated voltage, frequency** : 220 - 240 V~, 50 Hz
- > **Nominal power** : 1.5HP/1.2kW
- > **Rated no load speed n_0** : 3450 min⁻¹
- > **Degree of protection** : IP30
- > **Protection class** : I 
- > **Weight** : 15.5 kg
- > **Dimensions** : 580 x 275 x 520 mm

Compressor

- > **Operating pressure** : 8 bars
- > **Maximum allowable pressure at the outlet of the compressor** : 8 bars
- > **Pressure vessel capacity** : 24 l
- > **Intake rate (theoretical)** : approx. 180 l/min
- > **Pump-up time** : 150 s
- > **Recovery time** : 40 s
- > **Minimum operating temperature** : + 5 °C
- > **Maximum operating temperature** : + 40 °C

Sound values

- > **Sound pressure level L_{pA}** : 76 dB(A)
- > **Sound power level L_{WA}** : 96 dB(A)
- > **Uncertainty K_{pA} , K_{WA}** : 3 dB(A)

The sound values have been determined according to noise test code given in EN 1012-1, using the basic standard EN ISO 2151.

The sound intensity level for the operator may exceed 80 dB(A) and ear protection measures are necessary.

TTB797CPR

TT = TITAN

B = 240V AC

797 = Version number

CPR = Compressor

Unpacking

- > Unpack all parts and lay them on a flat, stable surface.
- > Remove all packing materials and shipping devices, if applicable.



- > Make sure the delivery contents are complete and free of any damage. If you find that parts are missing or show damage do not use the product but contact your dealer. Using an incomplete or damaged product represents a hazard to people and property.
- > Ensure that you have all the accessories and tools needed for assembly and operation. This also includes suitable personal protective equipment.



WARNING! The product and the packaging are not children's toys! Children must not play with plastic bags, sheets and small parts! There is a danger of choking and suffocation!

You will need

(items not supplied)

Suitable personal protective equipment
Wrench

(items supplied)

Wheels (8)
Foot (12)
Adaptor (male plug) (16)

Assembly



WARNING! The product must be fully assembled before operation! Do not use a product that is only partly assembled or assembled with damaged parts!

Follow the assembly instructions step-by-step and use the pictures provided as a visual guide to easily assemble the product! Do not connect the product to power supply before it is completely assembled!



NOTE: Take care of small parts that are removed during assembly or when making adjustments. Keep them secure to avoid loss.

Wheels

- > Align the bolt (8a), the hole of the wheel (8) with the hole on the rear support (9) and insert it. (Fig. 1, step 1). Screw the locking nut (8b) with washer (8c) to the bolt (8a) hand tight. (Fig.1, step 2).
- > Then tighten the locking nut with a suitable wrench to secure the connection. Do not overtighten.
- > Repeat previous steps for assembling the second wheel. Lift the product by its handle (15) and ensure both wheels rotate smoothly.

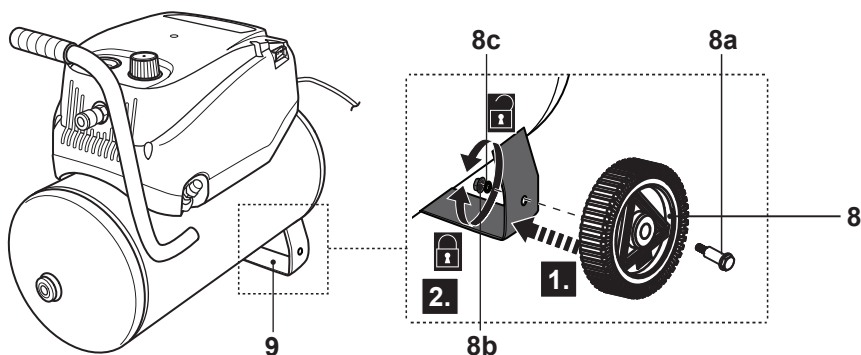

Fig. 1

Assembly

Foot

- > Align the bolt (12a) of the foot (12) with the opening on the front support (11) and insert it (Fig. 2, step 1).
- > Screw the nut (12b) onto the bolt (12a) (Fig. 2, step 2). Do not overtighten.

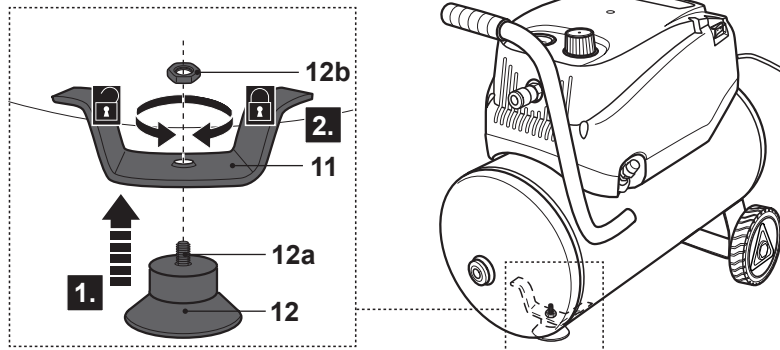

Fig. 2

Connection to power supply

- > Make sure the on / off switch (4) is in its off position **O**.
- > Connect the plug (5) with a suitable socket.



WARNING! Check the voltage! The voltage must comply with the information on the rating label!

- > Your product is now ready to be used.



In more detail...

Product functions	18
Operation	20
Care and maintenance	22
Troubleshooting	26
Recycling and disposal	27
Guarantee	27
EC declaration of conformity	28

In more detail...

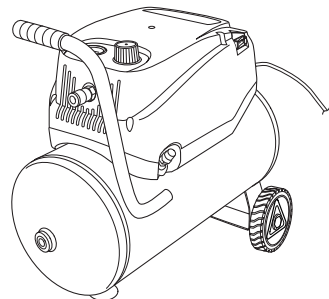



Intended use

This air compressor TTB797CPR is designated with a nominal power of **1.5HP /1200Watts.**

This product is intended for generating and supplying compressed air to pneumatic power tools and tyres. Connect only attachment tools which maximum air consumption is less than the air output of this product.

The product is not designed for inflating small-volume items or continuous operation.

For safety reasons it is essential to read the entire instruction manual before first operation and to observe all the instructions therein.

This product is intended for private domestic use only, not for any commercial trade use. It must not be used for any purposes other than those described.

Safety features

Overload protection

The motor of this product is equipped with an overload protection. When the motor is over limit temperature 140 °C, the product stops automatically.

- > Press the on / off switch (4) to its off position **O** to switch the product off, and then disconnect plug from the power supply. Turn the pressure regulator (2) counter clockwise to stop the air flow to the quicklock coupling (14).
- > Disconnect the product from the power supply and let it cool down for 10 minutes.
- > Carefully release the remaining pressure in the attachment tool by operating it until no airflow can be heard. and disconnect it from the quick-lock coupling (14). Remove the cause of the overload.
- > Reconnect the attachment tool to the quick-lock coupling. Ensure the connection is secured.



WARNING! Make sure the on / off switch (4) is set to its off position **O** and then insert the plug into a properly installed socket.

- > Reconnect the product to the power supply and press the on / off switch (4) to its on position **I**.
- > Perform a test for about 2 minutes and 30 seconds to ensure the product runs smoothly before continuing further operation. If you cannot switch the product on, see chapter "Troubleshooting".

Safety valve

In the event that the pressure inside the vessel exceeds the maximum allowable pressure level, the safety valve is activated. Once the pressure drops down to



proper levels, the safety valve is automatically deactivated. If the Safety Valve is activated, a hissing noise will be heard. This will stop when the pressure has been released.

To check the operation of the safety valve, carry out the following procedure. With the compressor charged, open the relief nut (7.1) until a hissing sound is heard. Once this sound is heard, do not open the valve any further.

Fully re-tighten the relief nut (7.1) on completion of this check.

This check should be carried out on a monthly basis to ensure continued operation of the valve.

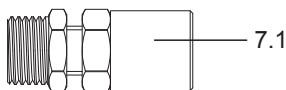

Fig. 3



WARNING! Apart from the testing mentioned above, do not tamper with the safety valve. Risk of injury and property damage! Never use the product with a defective or damaged safety valve. In case the safety valve appears damaged or malfunctioning, have it checked and repaired by a specialist before using the product again!

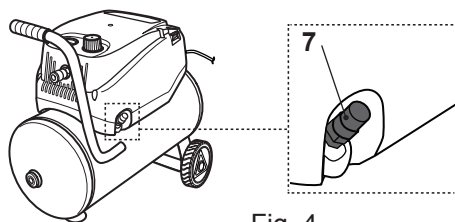

Fig. 4

Air pressure measurement

The product can measure air pressure without being connected to the power supply.

- > Insert a suitable attachment tool onto the product (see Operation - Attachment tools).
- > Connect the product to the inflatable item to proceed with the measure.
- > Read the value on the pressure gauge.
- > Disconnect the product from the inflatable item and then remove the attachment tool from the product.

In more detail...



NOTE: The Pressure gauge is not calibrated. It is recommended to use a calibrated tyre pressure gauge for an accurate final reading.

Switching on / off

- > Press the on / off switch (4) to its on position **I** to switch the product on (Fig. 5).
- > Press the on / off switch (4) to its off position **O** to switch the product off (Fig. 6).

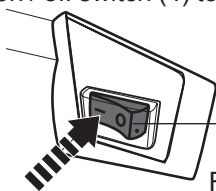

Fig. 5

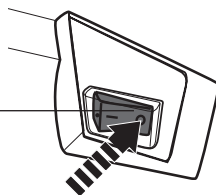

Fig. 6

General operation

- > Check the product, its power cord and plug as well as accessories for damage before each use. Do not use the product if it is damaged or shows wear.
- > Double check that the accessories and attachments are properly fixed.
- > Ensure that the air vents are always unobstructed and clear. Clean them if necessary with a soft brush. Blocked air vents may lead to overheating and damage the product.
- > Switch the product off immediately if you are disturbed while working by other people entering the working area. Always let the product come to complete stop before averting.
- > Do not overwork yourself. Take regular breaks to ensure you can concentrate on the work and have full control over the product.



WARNING! Several parts such as the cover (3) become very hot during operation! Be careful when using this product and avoid contact with hot surfaces – danger of burns.

Attachment tools

This product is delivered with attachment tools.

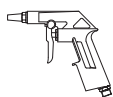

Air duster
operation pressure
45-75psi (3.1-5.1bar)

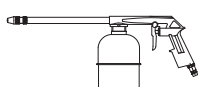

Washing gun
operation pressure
30-55 psi (2-3.7bar)



Spray gun
operation pressure
45-55 psi (3.1-3.7bar)

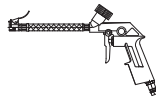

Inflating gun
gauge 0-150psi
(0-10.3bar)



Air hose
size 5x8mmx5m



PTFE
tape



Quick-lock
coupling

Fig. 7



WARNING! Always switch the product off and disconnect it from power supply before attaching / removing any accessories!

- > Wrap the thread of the quick-lock coupling with appropriate amount of PTFE tape, connect it into the nut at one end of the air hose and tighten it with a spanner. Do not over tighten.
- > Wrap the thread of the attachment tool (Air duster / Washing gun / Spray gun / Inflating gun / Air hose) with appropriate amount of PTFE tape, connect it into the nut at other end of the air hose and tighten it with a spanner. Do not over tighten.
- > Connect the quick-lock coupling into air outlet before operation.

Operation

- > Connect the attachment tool to the quick-lock coupling (14), as described above.
- > Check the drain valve is fully closed, otherwise the compressor will not pressurise.
- > Press the on / off switch (4) to its on position **I** to switch the product on (Fig. 7 step 1). As the product starts, pressure inside the vessel will rise to reach the maximum pressure.
- > Wait until the product stops (approximately 2.5 minutes), then turn the pressure regulator (2) clockwise to set the pressure according to the attachment tool technical specifications (Fig. 8, step 2). Ensure the setting is correct by reading the set pressure on the pressure gauge (1).



WARNING! As the pressure regulator is turned to increase the output pressure, the air pressure will also act on the regulator mechanism, making it harder to turn as the pressure rises. This is normal. Do not over-tighten! The maximum achievable pressure is approximately 8 bar.

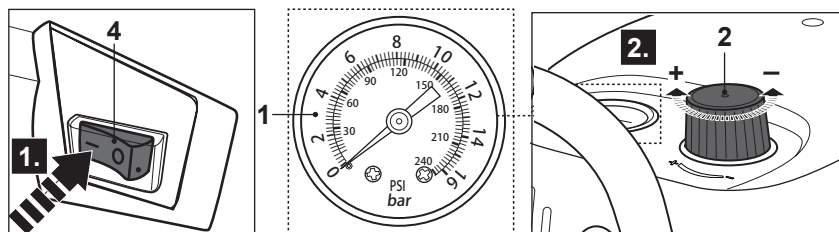

Fig. 8

- > Perform a test to ensure the product runs smoothly before further operation.
- > Once the task is complete, turn the pressure regulator fully counterclockwise to close the air flow and press the on / off switch to its off position **O** to switch the product off.

In more detail...



- > Disconnect the attachment tool as described above.

Inflating



WARNING! Always check the compatibility between the product and inflatable items. Never exceed recommended pressure values on inflatable items! Switch the product off immediately when you reach the desired pressure!

Do not operate the product in a dusty environment. There is a risk of fire and the product could be damaged.

Never leave the product running unattended. It can burst car tyres and other inflatable items.

- > Connect a suitable attachment tool onto the quick-lock coupling (14) to inflate items, such as tyres.
- > Connect the attachment tool to the inflatable item.
- > Switch the product on and wait until it stops, then turn the pressure regulator to adjust pressure to required level.
- > When the desired pressure has been reached, switch the product off.
- > Disconnect the product from the inflatable item and then remove the attachment tool from the product.



NOTE: For tyres with counter-pressure (e. g. partially inflated tyres), it is recommended to switch the product on before connecting it to the inflatable item.

Releasing pressure in the cylinder

- > Switch off the tool.
- > Insert Air Hose with Air Duster Attached.
- > With the tool off, turn the outlet pressure regulator to display an output pressure on the gauge.
- > Operate the Air Duster to release pressure in the cylinder.
- > Continue to operate air duster until no further air can be heard escaping.
- > Disconnect the air hose and duster.
- > Return the pressure regulator to the minimum position.

After use

- > Switch the product off and disconnect it from the power supply.
- > Disconnect the attachment tool, if necessary.
- > Turn the pressure gauge (1) counterclockwise all the way and let the product cool down.
- > Refer to Releasing pressure in the cylinder process above.
- > Check, clean and store the product as described below.

The golden rules for care



WARNING! Always switch the product off, disconnect the product from the power supply and let the product cool down before performing inspection, maintenance and cleaning work!

- > Keep the product clean. Remove debris from it after each use and before storage.
- > Regular and proper cleaning will help ensure safe use and prolong the life of the product.
- > Inspect the product before each use for worn and damaged parts. Do not operate it if you find broken and worn parts.



WARNING! Only perform repairs and maintenance work according to these instructions! All further works must be performed by a qualified specialist!

General cleaning

- > Clean the product with a dry cloth. Use a brush for areas that are hard to reach.
- > In particular clean the air vents (13) after every use with a cloth and brush.
- > Remove stubborn dirt with high pressure air (max. 3 bars).



NOTE: Do not use chemical, alkaline, abrasive or other aggressive detergents or disinfectants to clean this product as they might be harmful to its surfaces.

- > Check for worn or damaged parts. Replace worn parts as necessary or contact an authorised service centre for repair before using the product again.

Maintenance

Before and after each use, check the product and accessories (or attachments) for wear and damage. If required, exchange them for new ones as described in this instruction manual. Observe the technical requirements.

Condensation water

Condensation water accumulates inside the pressure vessel during use as a natural by-product of operation. Accumulation of condensation water can cause internal corrosion and result in safety hazards.



WARNING! Drain the condensation water from the pressure vessel (6) after each use!

Always switch the product off and disconnect it from power supply before attaching / removing any accessories!

Release all the pressure in the vessel before opening the drain valve (10).

- > Place a suitable container under the pressure vessel (6) and unscrew the drain valve (10) from the drainage opening (Fig.9).
- > Once the water stops dripping, screw the drain valve back in place to close the pressure vessel. Dispose of the condensate properly, according to local regulations.

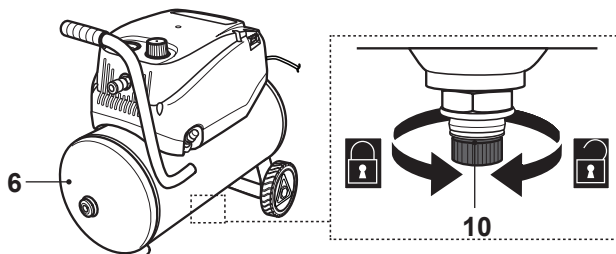

Fig. 9



NOTE: Internal inspection of cylinder. It is important that the internal surface of the cylinder is inspected every 5 years to check that there is no corrosion present. Corrosion can lead to weakening of the cylinder and may cause a danger to the user. This inspection needs to be carried out by a specialist engineer.

Repair

This product does not contain any parts that can be repaired by the consumer. Contact an authorised service centre or a similarly qualified person to have it checked and repaired.

There are no spare parts available for this product. Contact an authorised dealer or through our customer service for more information.

Power cord

If the power cord is damaged, it must be replaced by the manufacturer, its service agent or similarly qualified persons in order to avoid a safety hazard.

UK plug

This appliance is supplied with a BS1363 3 pin plug fitted with a 13 Amp fuse. Should the fuse require replacement, it must be replaced with a fuse rated at 13 Amp and approved to BS1362. If in doubt, consult a qualified electrician.

IMPORTANT: The wires in the mains lead are coloured in accordance with the following code:

Blue – Neutral

Brown – Live

Green/Yellow – Earth

As the colours of the wire in the mains lead of this product may not correspond with the coloured marking identifying the terminals in your plug, proceed as follows. The blue wire must be connected to the terminal marked with N or coloured black. The brown wire must be connected to the terminal marked L or coloured red.

The green/yellow wire must be connected to the earth terminal which is marked with an E or with the earth symbol.

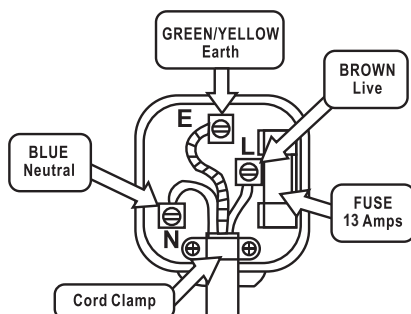

WARNING! Never connect live or neutral wires to the earth terminal of the plug, which is marked with E.



NOTE: If a moulded plug is fitted and has to be removed take great care in disposing of the plug and severed cable, it must be destroyed to prevent engaging into a socket.

Storage

- > Switch the product off and disconnect it from the power supply.
- > Release all the pressure in the vessel (6) if you are not going to use the product for an extended period of time.
- > Clean the product as described above.
- > Store the product and its accessories in a dark, dry, frost-free, well-ventilated place.
- > Always store the product in a place that is inaccessible to children. The ideal storage temperature is between 10 °C and 30 °C.
- > We recommend using the original package for storage or covering the product with a suitable cloth or enclosure to protect it against dust.

Transportation

- > Switch the product off and disconnect it from the power supply.
- > Attach transportation guards, if applicable.
- > Move the product on its wheels (8) by using its handle (15) only.
- > Protect the product from any heavy impact or strong vibrations which may occur during transportation in vehicles.
- > Secure the product to prevent it from slipping or falling over.

In more detail...



Troubleshooting

Suspected malfunctions are often due to causes that the user can fix themselves. Therefore check the product using this section. In most cases the problem can be solved quickly.



WARNING! Only perform the steps described within these instructions! All further inspection, maintenance and repair work must be performed by an authorised service centre or a similarly qualified specialist if you cannot solve the problem yourself!

Problem	Possible cause	Solution
1. Product does not start	1.1. Not connected to power supply 1.2. Power cord or plug is defective 1.3. Other electrical defect to the product 1.4. Overloaded product	1.1. Connect to power supply 1.2. Check by a specialist electrician 1.3. Check by a specialist electrician 1.4. Disconnect the product and remove cause of overload
2. Product does not reach operating pressure	2.1. Air vents are blocked 2.2. System is not airtight 2.3. Power source (e. g. generator) has too low voltage	2.1. Clean the air vents 2.2. Check and tighten all connections / valves 2.3. Connect to another power source
3. Unsatisfactory result	3.1. System is not airtight 3.2. Insufficient pressure set on the pressure gauge 3.3. Obstructed air vents 3.4. Damaged pressure gauge 3.5. Inflatable item is leaking	3.1. Check and tighten all connections / valves 3.2. Increase set pressure according to technical specifications 3.3. Clean air vents 3.4. Have the pressure gauge replaced by a specialist 3.5. Repair the item before inflating again
4. Excessive vibration / noise	4.1. Bolts / nuts are loose 4.2. System is not airtight 4.3. Damaged motor	4.1. Tighten bolts / nuts 4.2. Check and tighten all connections / valve 4.3. Have the product checked by a specialist



Recycling and disposal



Waste electrical products should not be disposed of with household waste. Please recycle where facilities exist.

Check with your Local Authority or local store for recycling advice.

The product comes in a packaging that protects it against transportation damage. Keep hold of the packaging until you are sure that all the parts have been delivered and the product is functioning properly. Recycle the packaging afterwards.

In more detail...



Guarantee

We take special care to select high quality materials and use manufacturing techniques that allow us to create products incorporating design and durability. This product (**TITAN** 24L **1.5HP/1.2kW** Oil Free Air Compressor) has a manufacturer's guarantee of 2 years against manufacturing defects, from the date of purchase (if bought in store) or date of delivery (if bought online), at no additional cost for normal (non-professional or commercial) household use.

To make a claim under this guarantee, you must present your proof of purchase (such as a sales receipt, purchase invoice or other evidence admissible under applicable law), please keep your proof of purchase in a safe place. For this guarantee to apply, the product you purchased must be new, it will not apply to second hand or display products. Unless stated otherwise by applicable law, any replacement product issued under this guarantee will only be guaranteed until expiry of the original guarantee period.

This guarantee covers product failures and malfunctions provided the product was used for the purpose for which it is intended and subject to installation, cleaning, care and maintenance in accordance with the information contained in these terms and conditions, in the user manual and standard practice, provided that standard practice does not conflict with the user manual.

This guarantee does not cover defects and damage caused by normal wear and tear or damage that could be the result of improper use, faulty installation or assembly, neglect, accident, misuse, or modification of the product. Unless stated otherwise by applicable law, this guarantee will not cover, in any case, ancillary costs (shipping, movement, costs of uninstalling and reinstalling, labour etc), or direct and indirect damage.

This guarantee does not cover defects and damage caused by or resulting from:

- Normal wear and tear

- Overload, misuse or neglect

- Repairs attempted by anyone other than an authorised agent

- Cosmetic damage

- Damage caused by foreign objects, substances or accidents

- Accidental damage or modification

- Failure to follow manufacturer's guidelines

- Loss of use of the goods

If the product is defective, we will, within a reasonable time, repair or replace it.

Rights under this guarantee are enforceable in the country in which you purchased this product. Guarantee related queries should be addressed to the store you purchased this product from.

The guarantee is in addition to and does not affect your statutory rights.



EC declaration of conformity

TITAN

We
Kingfisher International Products B.V.
Rapenburgerstraat 175E 1011 VM Amsterdam
The Netherlands

Declare that the product
24L 1.5HP/1.2kW Oil Free Air Compressor
Serial number: from 000001 to 999999

Complies with the essential health and safety requirements of the following directives:
The Machinery Directive 2006/42/EC

EN 1012-1:2010
EN 60204-1:2006/A1:2009

The EMC Directive 2014/30/EU
EN 55014-1:2017
EN 55014-2:2015
EN 61000-3-2:2014
EN 61000-3-3:2013

The Outdoor Noise Directive 2000/14/EC, Annex VI, as amended by 2005/88/EC
Measured Sound Power Level: 96dB(A)
Guaranteed Sound Power Level: 97 dB(A)
EN ISO 3744 : 1995

Test report Nr.: 160801205SHA-001/A3
Notified body: 0359, Intertek Testing & Certification Ltd,
12 Davy Avenue, Knowlhill, Milton Keynes, MK5 8NL

Authorized Signatory and technical file holder
Signed for and on behalf of:

Kingfisher International Products B.V.
Rapenburgerstraat 175E 1011 VM Amsterdam
The Netherlands

David Awe
Group Quality & Sustainability Director

on:20/04/2021

In more detail...



TITAN

Manufacturer • Fabricant • Producent • Producător • Fabricante:

UK manufacturer:

Kingfisher International Products Limited
3 Sheldon Square London W2 6PX
United Kingdom
www.kingfisher.com/products

EU manufacturer:

Kingfisher International Products B.V.
Rapenburgerstraat 175E
1011 VM Amsterdam
The Netherlands

www.diy.com | www.screwfix.com | www.screwfix.ie

To view instruction manuals online,
visit www.kingfisher.com/products