

TITAN

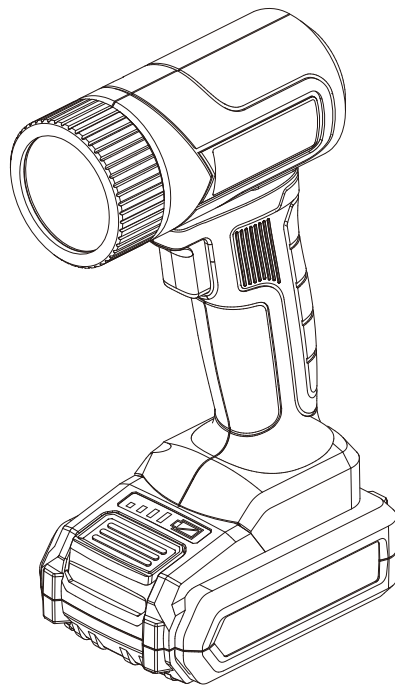

TTI913TOR



WARNING: Read the instructions before using the product!

Let's get started...

These instructions are for your safety. Please read through them thoroughly before use and retain them for future reference.



Getting **Started...** 02

Safety information	03
Symbols	08
Your product	10
Technical specifications	11
Before you start	12



In more detail... 14

Intended use	15
Product functions	15
Care and maintenance	16
Troubleshooting	17
Recycling and disposal	18
Guarantee	19
Declaration of conformity	20

Safety warnings



WARNING! *Read all safety warnings, instructions, illustrations and specifications provided with this torch. Failure to follow all instructions listed below may result in electric shock, fire and/or serious injury. Save all warnings and instructions for future reference.*



WARNING! *Fire hazard. Do not operate torch near flammable liquids or in gaseous or explosive atmospheres. Internal sparks may ignite fumes causing personal injury.*

- > *Do not expose torch to wet or damp areas. Do not expose torch to rain or snow.*
- > *Do not wash torch with water or allow water to get inside torch. Do not submerge torch in water at any time. Check the torch, its battery pack and charger for damage before each use. Do not use the product if it is damaged.*
- > *The torch shall be always used with its protective shield. If the protective shield is cracked, it shall be replaced.*



WARNING! *Do not place the torch in a position which may cause anyone to intentionally or unintentionally stare into the torch. Serious eye injury could result.*



CAUTION! *When not in use, place torch on its side on a stable surface where it will not cause a tripping or falling hazard. Some products with large battery packs will stand upright on the battery pack but may be easily knocked over.*

BATTERY TOOL USE AND CARE

- > **Recharge only with the charger specified by the manufacturer.** *A charger that is suitable for one type of battery pack may create a risk of fire when used with another battery pack.*
- > **Use torch only with specifically designated battery packs.** *Use of any other battery packs may create a risk of injury and fire.*
- > **When battery pack is not in use, keep it away from other metal objects, like paper clips, coins, keys, nails, screws or other small metal objects, that can make a connection from one terminal to another.** *Shorting the battery terminals together may cause burns or a fire.*
- > **Under abusive conditions, liquid may be ejected from the battery; avoid contact. If contact accidentally occurs, flush with water. If liquid contacts eyes, additionally seek medical help.** *Liquid ejected from the battery may cause irritation or burns.*
- > **Do not use battery pack or tool that is damaged or modified.** *Damaged or modified batteries may exhibit unpredictable behaviour resulting in fire, explosion or risk of injury.*
- > **Do not expose a battery pack or tool to fire or excessive temperature.** *Exposure to fire or temperature above 130 °C may cause explosion.*

- > **Follow all charging instructions and do not charge the battery pack outside the temperature range specified in the instructions.** *Charging improperly or at temperatures outside the specified range may damage the battery and increase the risk of fire.*

SERVICE

- > **Have your torch serviced by a qualified repair person using only identical replacement parts.** *This will ensure that the safety of the torch is maintained.*
- > **Never service damaged battery packs.** *Service of battery packs should only be performed by the manufacturer or authorized service providers.*

ADDITIONAL SAFETY WARNINGS FOR BATTERY

- > *Do not connect the positive terminal and negative terminal of the battery to each other with any metal object (such as wire).*
- > *Do not carry or store battery together with necklaces, hairpins or other metal objects.*
- > *Do not pierce the battery with nails, strike the battery with a hammer, step on the battery or otherwise subject it to strong impacts or shocks.*
- > *Do not solder directly onto the battery.*
- > *Do not expose battery to water or salt water, or allow the battery to get wet.*
- > *Do not disassemble or modify the battery.*
- > *Do not place the battery in or near fire, on stoves or other high temperature locations. Do not place the battery in direct sunlight, or use or store the battery inside cars in hot weather.*
- > *Do not place the battery in microwave ovens, highpressure containers or on induction cookware.*

> If you intend to store a battery for a period without use then store battery at room temperature (19°C to 25°C), charged to about 30 – 50% of capacity. When storing for very long periods boost charge the battery once per year to prevent over discharge.

Additional safety warnings for charger

- > This charger can be used by children aged from 8 years and above and persons with reduced physical, sensory or mental capabilities or lack of experience and knowledge if they have been given supervision or instruction concerning use of the charger in a safe way and understand the hazards involved.*
- > Children shall not play with the charger. Cleaning and user maintenance shall not be made by children without supervision.*
- > Disconnect the charger from the power supply and allow it to cool down before cleaning, maintenance, storage and transportation.*
- > Before using the charger, read all the instructions and cautionary markings on the charger and battery pack.*
- > The charger and battery pack supplied with it are specifically designed to work together. Only use the charger with the battery pack specified for this product.*
- > Charge the battery pack indoors only as the charger is designed for indoor use only.*
- > Do not charge non-rechargeable batteries.*
- > Protect the charger against moisture and wet conditions. There is a danger of electric shock.*
- > Do not place any object on top of the charger as it could cause overheating. Do not place the charger near any heat source.*
- > Do not use an extension cord unless it is absolutely necessary. The use of an improper extension cord could cause the risk of fire, electric shock or electrocution.*



> Do not use the charger if it has been subjected to a heavy knock, dropped or otherwise damaged in any way. Have the charger checked and repaired by an authorised service centre.

Symbols



Do not dispose of battery packs in rivers or immerse in water.



Do not dispose of battery packs in fire. They will explode and cause injury.



Do not expose battery packs to heat in excess of 45°C. Do not charge or store the battery pack in temperatures below 0°C (32°F) and above 45°C (113°F).



Class III torch.



Do not stare at the operating light source.

yyWxx

Manufacturing date code: Year of manufacturing (20yy) and week of manufacturing (Wxx)



The product complies with the applicable European directives and an evaluation method of conformity for these directives was done.



WEEE symbol. Waste electrical products should not be disposed of with household waste. Please recycle where facilities exist. Check with your Local Authority or local store for recycling advice.



Crossed out dust bin. Batteries and battery packs should not be disposed of with household waste. Please recycle where facilities exist. Check with your Local Authority or local store for recycling advice.



Indoor use only.



Approx. 1h charging time.



Replace any cracked protective shield

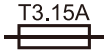

Time lag fuse with rated current of 3.15A



This is a product of class II. This means it is equipped with an insulation reinforced or double insulation.



Read instructions manual

ta: 45°C

Maximum ambient temperature



The product complies with the applicable European directives and an evaluation method of conformity for these directives was done.



UK Conformity Assessed.



Your product

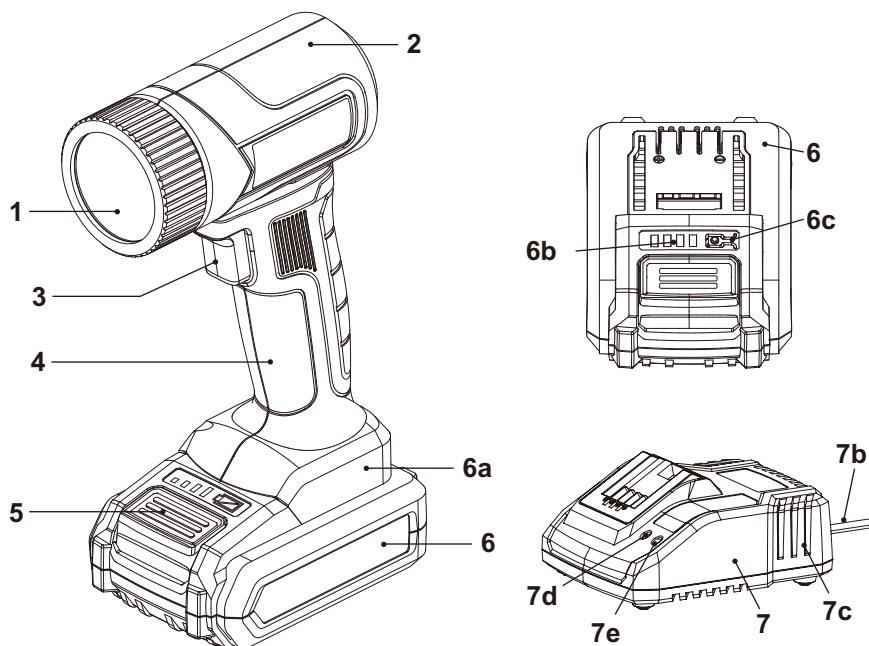

1. Lens (Transparent cover)
2. Rotative torch head
3. ON/OFF switch
4. Main handle
5. Battery pack release button
6. Battery pack
 - a. Battery docking port
 - b. Battery capacity indicators
 - c. Battery capacity button

7. Charger
 - a. Sliding slots
 - b. Power cord with plug
 - c. Air vents
 - d. Charging status indicator (**RED**)
 - e. Power indicator (**GREEN**)

Technical specifications

Torch

- > **Rated voltage** : 18 V 
- > **Head pivot** : 0°-90°
- > **Illumination** : 280 Lumen
- > **Weight (without battery)** : approx. 0.3 kg

Battery pack

- > **Model no.** : TTI801BAT
- > **Cell** : Li-ion, 5 pcs
- > **Capacity** : 2000 mAh
- > **Voltage** : 18 V 
- > **Weight** : approx. 0,4 kg

Charger

- > **Model no.** : TTB804CHR
- > **Rated output** : 21,4V  2,4 A

Usable battery pack (sold separately)

- > **Model no.** : TTI802BAT / TTI803BAT
- > **Capacity** : 4 000 mAh / 5 000 mAh

Usable charger (sold separately)

- > **Model no.** : TTB805CHR
- > **Rated output** : 21,4 V  4 A
- > **Ambient temperature range for charger and battery use** : 5 °C to 40 °C

Rating label explanation

TTI913TOR = MODEL NUMBER

TT = TITAN

I= 18V Lithium-Ion

913 = Serial Number

TOR = Torch

Before you start

Unpacking

- > Unpack all parts and lay them on a flat, stable surface.
- > Remove all packing materials and shipping devices if applicable.
- > Make sure the delivery contents are complete and free of any damage. If you find that parts are missing or show damage do not use the product but contact your dealer. Using an incomplete or damaged product represents a hazard to people and property.
- > Ensure that you have all the accessories and tools needed for assembly and operation. This also includes suitable personal protective equipment.



WARNING! The product and the packaging are not children's toys! Children must not play with plastic bags, sheets and small parts! There is a danger of choking and suffocation!

Battery pack

Attach / Release

- > Align the battery pack (6) with the sliding slots of the battery docking port (6a) and slide the battery pack in to attach it. Ensure it clicks in place (Fig. 1).
- > Press the release button (5) and slide the battery pack (6) from the battery docking port (5) (Fig. 2).

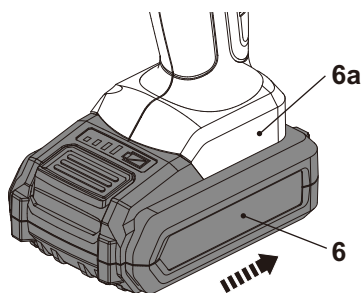

Fig. 1

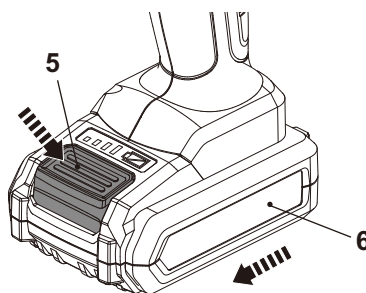

Fig. 2

Charging

Charging the battery pack

The battery pack (6) for this product has been shipped in a low charge condition. Charge it fully before first use.

1. Refer to the charger's instruction manual for the details.

The battery pack (6) is equipped with the battery capacity indicators (6b) which are used to give an indication of the battery pack's remaining capacity. Press the battery capacity button (6c) to check battery capacity (Fig. 3). The LEDs will stay lit for approximately 10 seconds.

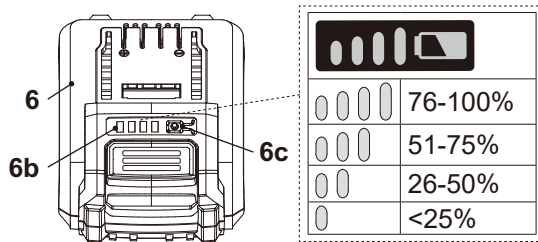
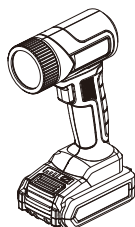

Fig. 3

In more detail...



Intended use	15
Product functions	15
Care and maintenance	16
Troubleshooting	17
Recycling and disposal	18
Guarantee	19
Declaration of conformity	20





Intended use

This product is a cordless torch. It is intended for use as illumination in dim or dark working areas. Use the product in a dry environment only.

Product functions

ON/ OFF SWITCH (Fig.4)

- > Press the ON/OFF switch to turn on the torch.
- > Press the ON/OFF switch to turn off the torch.

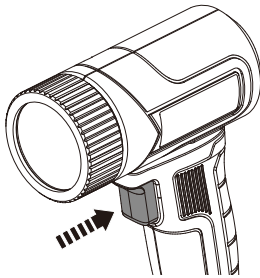

Fig. 4

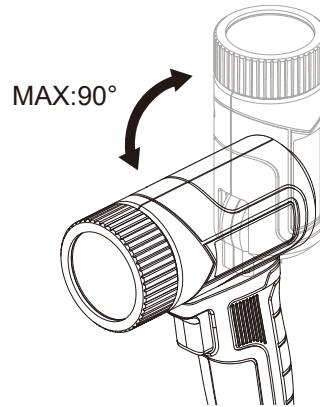

Fig. 5

ADJUSTING THE TORCH HEAD (Fig.5)

Rotatable torch head (2) can adjust light direction to suit your working situation. The rotary range is 0° to 90°.

Care and maintenance

After use

- > Switch the product off, remove the battery pack.
- > Check, clean and store the product as described below.

Maintenance

Your torch requires no additional maintenance. There are no user serviceable parts in your torch. Never use water or chemical cleaners to clean your torch. Wipe clean with a dry cloth. Always store your torch in a dry place. The light source of this torch is not replaceable; when the light source reaches its end of life the whole torch shall be replaced.

Repair

This product does not contain any parts that can be repaired by the consumer. Contact an authorised service centre or a similarly qualified person to have it checked and repaired.

Storage

- > Switch the product off and remove the battery pack.
- > Clean the product as described above.
- > Store the product and its accessories in a dark, dry, frost-free, well-ventilated place.
- > Always store the product in a place that is inaccessible to children.
- > We recommend using the original package for storage or covering the product with a suitable cloth or enclosure to protect it against dust.

Transportation

- > Switch the product off and remove the battery pack.
- > Attach transportation guards, if applicable.
- > Always carry the product by its handle.
- > Protect the product from any heavy impact or strong vibrations which may occur during transportation in vehicles.
- > Secure the product to prevent it from slipping or falling over.

Troubleshooting

Suspected malfunctions are often due to causes that the users can fix themselves. Therefore, check the product using this section. In most cases the problem can be solved quickly.



WARNING! Only perform the steps described within these instructions! All further inspection, maintenance and repair work must be performed by an authorised service center or a similarly qualified specialist if you cannot solve the problem yourself!

Problem	Possible cause	Solution
1. Product does not start	1.1. Battery pack not properly attached 1.2. Battery pack discharged 1.3. Battery pack damaged	1.1. Attach properly 1.2. Remove and charge battery pack 1.3. Check by a specialist electrician
2. Product suddenly stops	2.1. Battery pack discharged	2.1. Remove and charge battery pack

In more detail...

Recycling and disposal



Waste electrical products should not be disposed of with household waste. Please recycle where facilities exist. Check with your local Authority or local store for recycling advice.

Disposal of an exhausted battery pack



To preserve natural resources, please recycle or dispose of the battery pack properly. Consult your local waste authority for information regarding available recycling and/or disposal options. Discharge your battery pack by operating your tool, then remove the battery pack from the tool and cover the battery pack connections with heavy duty adhesive tape to prevent short circuit and energy discharge. Do not attempt to open or remove any of the components.

Guarantee

We take special care to select high quality materials and use manufacturing techniques that allow us to create products incorporating design and durability. This product (TITAN Torch) has a manufacturer's guarantee of 2 years against manufacturing defects, from the date of purchase (if bought in store) or date of delivery (if bought online), at no additional cost.

To make a claim under this guarantee, you must present your proof of purchase (such as a sales receipt, purchase invoice or other evidence admissible under applicable law), please keep your proof of purchase in a safe place. For this guarantee to apply, the product you purchased must be new, it will not apply to second hand or display products. Unless stated otherwise by applicable law, any replacement product issued under this guarantee will only be guaranteed until expiry of the original guarantee period.

This guarantee covers product failures and malfunctions provided the product was used for the purpose for which it is intended and subject to installation, cleaning, care and maintenance in accordance with the information contained in these terms and conditions, in the user manual and standard practice, provided that standard practice does not conflict with the user manual.

This guarantee does not cover defects and damage caused by normal wear and tear or damage that could be the result of improper use, faulty installation or assembly, neglect, accident, misuse, or modification of the product. Unless stated otherwise by applicable law, this guarantee will not cover, in any case, ancillary costs (shipping, movement, costs of uninstalling and reinstalling, labour etc), or direct and indirect damage.

This guarantee does not cover defects and damage caused by or resulting from:

Normal wear and tear

Overload, misuse or neglect

Repairs attempted by anyone other than an authorised agent

Cosmetic damage

Damage caused by foreign objects, substances or accidents

Accidental damage or modification

Failure to follow manufacturer's guidelines

Loss of use of the goods

If the product is defective, we will, within a reasonable time, repair or replace it.

Rights under this guarantee are enforceable in the country in which you purchased this product. Guarantee related queries should be addressed to the store you purchased this product from.

The guarantee is in addition to and does not affect your statutory rights.

**(UK) DECLARATION OF CONFORMITY**

Product

- Torch
- TTI913TOR
- Serial number: from 000001 to 999999

Name and address of the manufacturer or his authorised representative:

Kingfisher International Products Limited
 3 Sheldon Square
 London W2 6PX
 United Kingdom

This declaration of conformity is issued under the sole responsibility of the manufacturer.

Object of the declaration

Product	Model	EAN
Torch	TTI913TOR	

The object of the declaration described above is in conformity with the relevant legislation:

References to the relevant designated standards used or references to the other technical specifications in relation to which conformity is declared:

Authorised signatory and technical file holder:
 Kingfisher International Products Limited
 3 Sheldon Square
 London W2 6PX
 United Kingdom

David Awe
 Group Quality Director

On: 28/05/2022



(EN) EU DECLARATION OF CONFORMITY
 (FR) DÉCLARATION UE DE CONFORMITÉ
 (PL) DEKLARACJA ZGODNOŚCI UE
 (RO) DECLARAȚIA DE CONFORMITATE UE

Product/ Produit/ Produkt/Produsul

- Torch / ***** / ***** / *****
- TTI913TOR
- SN: 000001-999999

Name and address of the manufacturer or his authorised representative:

Nom et adresse du fabricant ou de son mandataire:

Nazwa i adres producenta lub jego upoważnionego przedstawiciela:

Denumirea și adresa producătorului sau a reprezentantului său autorizat:

Kingfisher International Products B.V.,
 Rapenburgerstraat 175E,
 1011 VM Amsterdam,
 The Netherlands

This declaration of conformity is issued under the sole responsibility of the manufacturer.

La présente déclaration de conformité est établie sous la seule responsabilité du fabricant.

Niniejsza deklaracja zgodności wydana zostaje na wyłączną odpowiedzialność producenta.

Prezenta declarație de conformitate este emisă pe răspunderea exclusivă a producătorului.

Object of the declaration/Objet de la declaration/Przedmiot deklaracji/Obiectul declarației

Product/Produit/Produkt/Produsul

Model/Modèle/Model/Modelul

EAN

Torch

TTI913TOR

The object of the declaration described above is in conformity with the relevant Union harmonisation legislation:

L'objet de la déclaration décrit ci-dessus est conforme à la législation d'harmonisation de l'Union applicable:

Wymieniony powyżej przedmiot niniejszej deklaracji jest zgodny z odpowiednimi wymaganiami unijnego prawodawstwa harmonizacyjnego:

Obiectul declarației descris mai sus este în conformitate cu legislația relevantă de armonizare a Uniunii:

In more detail...

References to the relevant harmonised standards used or references to the other technical specifications in relation to which conformity is declared:

Références des normes harmonisées pertinentes appliquées, y compris la date de celles-ci, ou des autres spécifications techniques, y compris la date de celles-ci, par rapport auxquelles la conformité est déclarée:
Odwolania do odnośnych norm zharmonizowanych, które zastosowano, wraz z datą normy, lub do innych specyfikacji technicznych, wraz z datą specyfikacji, w odniesieniu do których deklarowana jest zgodność:
Trimiteri la standardele armonizate relevante folosite, inclusiv data standardului, sau trimiteri la celelalte specificații tehnice, inclusiv data specificațiilor, în legătură cu care se declară conformitatea:

Authorised signatory and technical file holder/signataire et responsable de la documentation technique
authorisé/ podmiot uprawniony do wystawienia i adres przechowywania dokumentacji technicznej/semnatar
autorizat și deținător al dosarului tehnic

Kingfisher International Products B.V.,
Rapenburgerstraat 175E, 1011 VM Amsterdam, The Netherlands



David Awe
Group Quality Director

28/05/2022



TITAN

Manufacturer, Fabricant, Producent, Producător, Fabricante:

UK Manufacturer:

Kingfisher International Products Limited
3 Sheldon Square, London, W2 6PX
United Kingdom
www.kingfisher.com/products

EU Manufacturer:

Kingfisher International Products B.V.
Rapenburgerstraat 175E
1011 VM Amsterdam
The Netherlands
www.kingfisher.com/products

- | | | |
|-----------|--|---|
| EN | www.screwfix.com
www.screwfix.ie | To view instruction manuals online, visit
www.kingfisher.com/products |
| FR | www.bricodepot.fr | Pour consulter les manuels d'instructions en ligne,
rendez-vous sur le site www.kingfisher.com/products |
| ES | www.bricodepot.es | Para consultar los manuales de instrucciones en línea,
visite www.kingfisher.com/products |
| PT | www.bricodepot.pt | Para consultar manuais de instruções online, visite
www.kingfisher.com/products |