

TITAN

450W TILE CUTTER

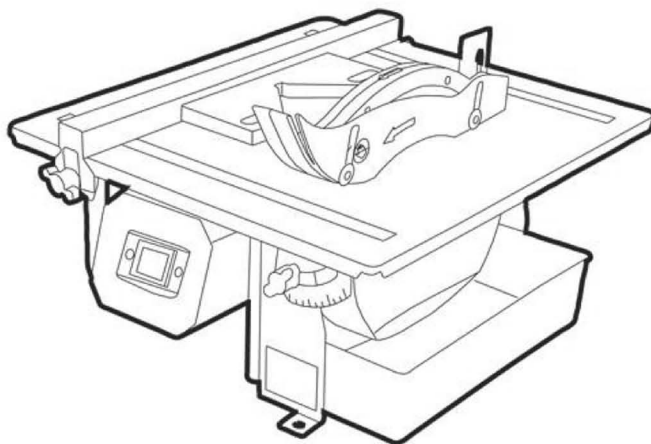

TTB934TCB

EAN: 5059340397603



WARNING: Read the instructions before using the product!

BX220IM

Let's get started...

These instructions are for your safety. Please read through them thoroughly before use and retain them for future reference.



Getting **started...**

Technical and legal information	02
Your Product	13
Technical specification	14
Before you start	19



In more **detail...**

Operation	21
Care and maintenance	22
Troubleshooting	25
Recycling and disposal	26
Guarantee	27
Declaration of conformity	29

Safety warnings

General power tool safety warnings



WARNING! Read all safety warnings, instructions, illustrations and specifications provided with this power tool. *Failure to follow all instructions listed below may result in electric shock, fire and/or serious injury.*

Save all warnings and instructions for future reference.

The term "power tool" in the warnings refers to your mains-operated (corded) power tool or batteryoperated (cordless) power tool.



WARNING Read all safety warnings, instructions, illustrations and specifications provided with this power tool. *Failure to follow all instructions listed below may result in electric shock, fire and/or serious injury.*

Save all warnings and instructions for future reference.

The term "power tool" in the warnings refers to your mains-operated (corded) power tool or battery-operated (cordless) power tool.

1) Work area safety

- a) **Keep work area clean and well lit.** *Cluttered or dark areas invite accidents.*
- b) **Do not operate power tools in explosive atmospheres, such as in the presence of flammable liquids, gases or dust.** *Power tools create sparks which may ignite the dust or fumes.*
- c) **Keep children and bystanders away while operating a power tool.** *Distractions can cause you to lose control.*

2) Electrical safety

- a) **Power tool plugs must match the outlet. Never modify the plug in any way. Do not use any adapter plugs with earthed (grounded) power tools.** *Unmodified plugs and matching outlets will reduce risk of electric shock.*
- b) **Avoid body contact with earthed or grounded surfaces, such as pipes, radiators, ranges and refrigerators.** *There is an increased risk of electric shock if your body is earthed or grounded.*
- c) **Do not expose power tools to rain or wet conditions.** *Water entering a power tool will increase the risk of electric shock.*
- d) **Do not abuse the cord. Never use the cord for carrying, pulling or unplugging the power tool. Keep cord away from heat, oil, sharp**

edges or moving parts. *Damaged or entangled cords increase the risk of electric shock.*

- e) **When operating a power tool outdoors, use an extension cord suitable for outdoor use.** *Use of a cord suitable for outdoor use reduces the risk of electric shock.*
 - f) **If operating a power tool in a damp location is unavoidable, use a residual current device (RCD) protected supply.** *Use of an RCD reduces the risk of electric shock.*
- 3) Personal safety**
- a) **Stay alert, watch what you are doing and use common sense when operating a power tool. Do not use a power tool while you are tired or under the influence of drugs, alcohol or medication.** *A moment of inattention while operating power tools may result in serious personal injury.*
 - b) **Use personal protective equipment. Always wear eye protection.** *Protective equipment such as a dust mask, non-skid safety shoes, hard hat or hearing protection used for appropriate conditions will reduce personal injuries.*
 - c) **Prevent unintentional starting. Ensure the switch is in the off-position before connecting to power source and/or battery pack, picking up or carrying the tool.** *Carrying power tools with your finger on the switch or energising power tools that have the switch on invites accidents.*
 - d) **Remove any adjusting key or wrench before turning the power tool on.** *A wrench or a key left attached to a rotating part of the power tool may result in personal injury.*
 - e) **Do not overreach. Keep proper footing and balance at all times.** *This enables better control of the power tool in unexpected situations*
 - f) **Dress properly. Do not wear loose clothing or jewellery. Keep your hair and clothing away from moving parts.** *Loose clothes, jewellery or long hair can be caught in moving parts.*
 - g) **If devices are provided for the connection of dust extraction and collection facilities, ensure these are connected and properly used.** *Use of dust collection can reduce dust-related hazards.*
 - h) **Do not let familiarity gained from frequent use of tools allow you to become complacent and ignore tool safety principles.** *A careless action can cause severe injury within a fraction of a second.*
- 4) Power tool use and care**
- a) **Do not force the power tool. Use the correct power tool for your application.** *The correct power tool will do the job better and safer at the rate for which it was designed.*

- b) **Do not use the power tool if the switch does not turn it on and off.** *Any power tool that cannot be controlled with the switch is dangerous and must be repaired.*
 - c) **Disconnect the plug from the power source and/or remove the battery pack, if detachable, from the power tool before making any adjustments, changing accessories, or storing power tools.** *Such preventive safety measures reduce the risk of starting the power tool accidentally.*
 - d) **Store idle power tools out of the reach of children and do not allow persons unfamiliar with the power tool or these instructions to operate the power tool.** *Power tools are dangerous in the hands of untrained users.*
 - e) **Maintain power tools and accessories. Check for misalignment or binding of moving parts, breakage of parts and any other condition that may affect the power tool's operation. If damaged, have the power tool repaired before use.** *Many accidents are caused by poorly maintained power tools.*
 - f) **Keep cutting tools sharp and clean.** *Properly maintained cutting tools with sharp cutting edges are less likely to bind and are easier to control.*
 - g) **Use the power tool, accessories and tool bits etc. in accordance with these instructions, taking into account the working conditions and the work to be performed.** *Use of the power tool for operations different from those intended could result in a hazardous situation.*
 - h) **Keep handles and grasping surfaces dry, clean and free from oil and grease.** *Slippery handles and grasping surfaces do not allow for safe handling and control of the tool in unexpected situations.*
- 5) **Service**
- a) **Have your power tool serviced by a qualified repair person using only identical replacement parts.** *This will ensure that the safety of the power tool is maintained.*

ADDITIONAL SAFETY INSTRUCTIONS FOR TILE CUTTER

1. Set up the machine on a level, non-slip surface. Make sure that the machine does not wobble.
2. Check that the voltage on the rating plate is the same as your supply voltage. Only then are you to insert the power plug in the socket outlet.
3. Always wear both eye and ear protection when using the machine. Ensure that the directional arrow marked on the blade corresponds with the rotational direction of the motor.
4. Wear safety gloves.
5. Never use cracked blade. Replace immediately.
6. Never use segmented blade.
7. **Caution!** The blade runs on after the machine is switched off!

8. Never apply side pressure to the blade to bring it to a halt.
9. **Caution!** The blade must be cooled with water at all times.
10. Always pull out the power plug before changing the blade.
11. Use only suitable blade.
12. Never leave the machine unattended in rooms with children.
13. Always pull out the power plug before examining the electric motor compartment system.
14. Remove the mains plug from socket before carrying out any adjustment, servicing.
15. If the supply cord is damaged, it must be replaced by the manufacturer, its service agent or similarly qualified persons in order to avoid a hazard.
16. With the machine disconnected from the power supply, rotate the blade by hand to ensure it is free from obstruction.
17. Always keep the blade securing arbor and collars clean.
18. Ensure that the blade-securing bolt is securely tightened with a suitable wrench.
19. Never try to cut freehand. Always ensure that the tile to be cut is pressed firmly against the parallel side fence.
20. Ensure that the work piece to be cut off has sufficient room to move sideways. Failure to do so may result in the off-cut binding against the blade.
21. Never cut more than one tile at a time.
22. Never cut pieces too small to be held securely against the side fence without leaving enough space for the hand to be a safe distance from the blade.
23. Ensure that the table and surrounding area are clear with the exception of the tile to be cut.
24. Never fit substandard blades to the machine. Only fit correctly sized diamond blades.
25. Only use continuous rim diamond cutting-off wheel designed for cutting tiles.
26. Do Not use blades that are larger than specified, only use blades that are rated for the machine. The rotational speed shown on the blade should always be higher than the rotational speed of the Machine.
 - Ensure that the directional arrow marked on the blade corresponds with the rotational direction of the motor. Whenever replacing blades ensure that the surface of the blade collar fits snugly against the surface of the blade.
 - If the work piece cannot be held securely by hand, then use the jig or clamp to hold it in place whilst it is being cut.
 - Never cut pieces that are too small to be held securely against the back fence with the thumb and index finger.
 - Ensure that long work pieces are adequately supported at both ends.
 - Keep the handles dry and free of grease. Slippery handles can lead to accidents.
 - Prevent overheating of the device and the work piece. Excess heat may damage the tool and the device.

27. Shortly after being used, the tool may be very hot. Allow a hot tool to cool down. Touching a hot tool may cause burns.
28. Never clean a hot tool with flammable liquids. There is a risk of fire and explosion.
29. Store the unused power tool safely in a dry place that can be locked. This ensures that the power tool is not damaged because of storage and inexperienced persons do not operate it.
30. Never leave the power tool before it has come to a complete standstill. Tools that continue to operate may cause injury.
31. Before cutting a tile, let the cutter blade run freely for a few seconds. If it makes an unfamiliar sound or vibrates excessively switch it off immediately and disconnect from the power supply. Investigate the cause or consult a qualified person for advice.
32. Let the blade reach full speed before commencing the cut.
33. Do not force the blade to cut the tile.
34. Let the blade come to a complete stop before removing any jammed or off cut material from around the blade area.
35. Use a residual circuit breaker on all 230V Power tools. This can help minimize the risk of an electrical shock if an earth fault or short circuits occurs.
36. If using a power cable extension, ensure that the cable is fully unwound and that its length is less than 30m. Lengths over 30m will affect the tools performance as a result of voltage drop.
37. To avoid the possibility of the tool plug or receptacle getting wet, position tile cutter away from receptacle and plug. The user should arrange a "drip loop" in the cord connecting the cutter to a receptacle. The "drip loop" is that part of the cord below the level of the receptacle, or the connector if an extension cord is used, to prevent water traveling along the cord and coming in contact with the receptacle.
38. If the plug or receptacle does get wet, DON'T unplug the cord. Disconnect the fuse or circuit breaker that supplies power to the tool. Then unplug and examine for presence of water in the receptacle.
39. If an extension cord is used, the drip loop must be before the cord connection and the extension cord connection must be placed on an elevated surface.
40. Secure work firmly against the miter guide or fence.
41. Never stand or have any part of your body in line with the path of the blade.
42. Never attempt to free a stalled blade without first turning the cutter OFF and disconnecting the cutter from the power source.
43. Avoid awkward operations and hand positions where a sudden slip could cause your hand to move into the cutting tool.
44. Make sure the work area has ample lighting to see the work and that no obstructions will interfere with safe operation before performing any work using the cutter.
45. Always turn off cutter before disconnecting it, to avoid accidental

starting when reconnecting to power supply.

46. Do not operate with any guard disabled, damaged, or removed. Moving guards must move freely and close instantly.
47. The use of accessories or attachments not recommended by the manufacturer may result in a risk of injury to persons.
48. When servicing use only identical replacement parts.
49. Maintain labels and nameplates on the tool. These carry important safety information.
50. For your own safety, read instruction manual before operating tile cutter:
 - Wear eye, hearing, and breathing protection.
 - Use wheel guard for every operation for which it can be used.
 - Disconnect cutter before servicing, when changing blade and cleaning.
 - Use tool only with smooth edge blade free of openings, grooves and teeth.
 - Replace damaged blade before operating.
 - Do not fill water tray above Max. water fill line.

ADDITIONAL SAFETY WARNING FOR CONSTRUCTION DUST



WARNING! When using electric tools basic safety precautions should always be followed to reduce the risk of fire, electric shock and personal injury including the following. Read all these instructions before attempting to operate this product and save these instructions".

The updated Control of Substances Hazardous to Health Regulations 1st October 2012 now also targets to reduce the risks associated with silica, wood and gypsum dusts. Construction workers are one of the at-risk groups within this because of the dust that they breathe: silica dust is not just a nuisance; it is a real risk to your lungs!

Silica is a natural mineral present in large amounts in things like sand, sandstone and granite. It is also commonly found in many construction materials such as concrete and mortar. The silica is broken into very fine dust (also known as Respirable Crystalline Silica or RCS) during many common tasks such as cutting, drilling and grinding. Breathing in very fine particles of crystalline silica can lead to the development of:

- Lung cancer
- Silicosis Chronic
- Obstructive Pulmonary Disorder (Chronic obstructive pulmonary disease (COPD))

And breathing in fine particles of wood dust can lead to the development of

Asthma The risk of lung disease is linked to people who regularly breathe construction dust over a period of time, not on the odd occasion.

To protect the lung, the COSHH Regulations sets a limit on the amount of these dusts that you can breathe (called a Workplace Exposure Limit or WEL) when averaged over a normal working day. These limits are not a large amount of dust: when compared to a penny it is tiny – like a small pinch of salt: This limit is the legal maximum; the most you can breathe after the right controls have been used.

HOW TO REDUCE THE AMOUNT OF DUST?

- a) Reduce the amount of cutting by using the best sizes of building products.
- b) Use a less powerful tool e.g. a block cutter instead of angle grinder.
- c) Using a different method of work altogether – e.g. using a nail gun to direct fasten cable trays instead of drilling holes first.

Please always work with approved safety equipment, such as those dust masks that specially designed to filter out microscopic particles and use the dust extraction facility at all time.



WARNING! Some dust particles created by power sanding, sawing, grinding, drilling and other construction jobs contain chemicals known to cause cancer, birth defects or other reproductive harm. Some examples of these chemicals are:

- Lead from lead-based paints.
 - Crystalline silica from bricks and cement and other masonry products.
 - Arsenic and chromium from chemically treated timber.
- Your risk from these exposures varies, depending upon how often you do this type of work. To reduce your exposure to these chemicals:
- Work in a well-ventilated area.
 - Work with approved safety equipment, such as those dust masks that are specially designed to filter microscopic particles.

Safety warnings

VIBRATION

The European Physical Agents (Vibration) Directive has been brought in to help reduce hand arm vibration syndrome injuries to power tool users. The directive requires power tool manufacturers and suppliers to provide indicative vibration test results to enable users to make informed decisions as to the period of time a power tool can be used safely on a daily basis and the choice of tool.

SEE TECHNICAL SPECIFICATIONS IN THE INSTRUCTION MANUAL FOR THE VIBRATION LEVELS OF YOUR TOOL.

The declared vibration emission value should be used as a minimum level and should be used with the current guidance on vibration.

Calculating the actual period of use can be difficult and the HSE website has further information.

The declared vibration emission value has been measured in accordance EN 62841-1 and EN 62841-2-14 and may be used to compare one tool with another.

The declared vibration emission value may also be used in a preliminary assessment of exposure.



WARNING! The vibration emission value during actual use of the power tool can differ from the declared value depending on the ways in which the tool is used:

- How the materials are grinded, cut or drilled.
- If the tool is in good condition and well maintained.
- Use correct accessory for the tool and ensure it is sharp and in good condition.
- The tightness of the gripping handles.
- The tool is being used as intended by its design and these instructions.

While working with this power tool, hand/arm vibrations occur. Adopt the correct working practices in order to reduce the exposure to vibration. This tool may cause hand-arm vibration syndrome if its use is not adequately managed.



WARNING! Identify safety measures to protect the operator that are based on an estimation of exposure in the actual conditions of use (taking account of all parts of the operating cycle such as the times when the tool is switched off and when it is running idle in addition to the trigger time).

Note:

- The use of other tools will reduce the users' total working period on this tool.
- Helping to minimise your vibration exposure risk.
ALWAYS use sharp chisels, drills and blades.
- Maintain this tool in accordance with these instructions and keep well lubricated (where appropriate).
- Avoid using tools in temperatures of 10 °C or less. Plan your work schedule to spread any high vibration tool use across a number of days.

Health surveillance

All employees should be part of an employer's health surveillance scheme to help identify any vibration related diseases at an early stage, prevent disease progression and help employees stay in work.

Vibration and noise reduction

To reduce the impact of noise and vibration emission, limit the time of operation, use low-vibration and low-noise operating modes as well as wear personal protective equipment.

Take the following points into account to minimise the vibration and noise exposure risks:

- a) Only use the product as intended by its design and these instructions.
- b) Ensure that the product is in good condition and well maintained.
- c) Use correct attachments for the product and ensure they are in good condition.
- d) Keep tight grip on the handles/grip surface.
- e) Maintain this product in accordance with these instructions and keep it well lubricated (where appropriate).
- f) Plan your work schedule to spread any high vibration tool use across a longer period of time.
- g) Prolonged use of the product exposes the user to vibrations that can cause a range of conditions collectively known as hand-arm vibration syndrome (HAVS) e.g. fingers going white; as well as specific diseases such as carpal tunnel syndrome. To reduce this risk when using the product, always wear protective gloves and keep your hands warm.

Emergency

Familiarise yourself with the use of this product by means of this instruction manual. Memorise the safety directions and follow them to the letter. This will help to prevent risks and hazards.

- a) **Always be alert when using this product, so that you can recognise and handle risks early.** *Fast intervention can prevent serious injury and damage to property.*
- b) **Switch off and disconnect from the power supply if there are malfunctions.** *Have the product checked by a qualified professional and repaired, if necessary, before you operate it again.*

Residual risks

Even if you are operating this product in accordance with all the safety requirements, potential risks of injury and damage remain. The following dangers can arise in connection with the structure and design of this product:

- a) Health defects resulting from vibration emission if the product is being used over long periods of time or not adequately managed and properly maintained.
- b) Injuries and damage to property due to broken cutting attachments or the sudden impact of hidden objects during use.
- c) Danger of injury and property damage caused by flying objects or poor power tool accessories.



WARNING! This product produces an electromagnetic field during operation! This field may under some circumstances interfere with active or passive medical implants! To reduce the risk of serious or fatal injury, we recommend persons with medical implants to consult their doctor and the medical implant manufacturer before operating this product!

Your product

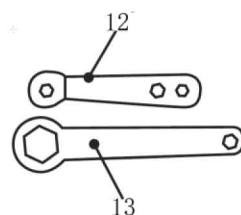
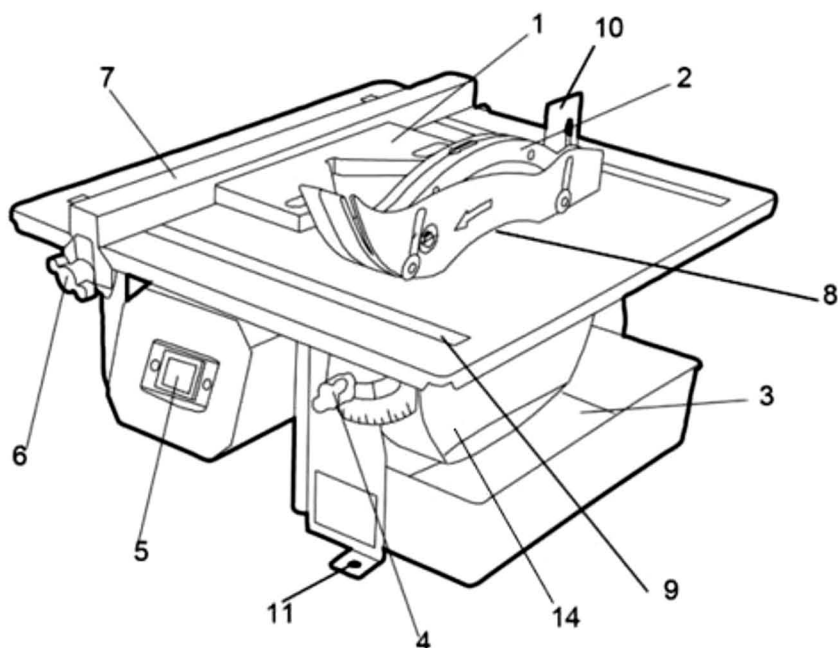

- | | |
|--------------------------|-------------------------|
| 1. Angle ruler | 8. Blade |
| 2. Blade guard (upper) | 9. Scale |
| 3. Water tank | 10. Riving Knife |
| 4. Table adjustment knob | 11. Mounting holes |
| 5. Switch | 12. 8mm Wrench |
| 6. Fence fixed knob | 13. 19mm wrench |
| 7. Fence | 14. Blade guard (lower) |

Getting started...

Technical specifications

Voltage: 230-240V~,50Hz
 Rated input: 250W S1, 450W S6 15%
 No-load speed: 2990min⁻¹
 Protection class: "I" Ⓢ
 Blade size: Ø180xØ22.2x2.2mm
 Degree of protection: IP44
 Dimensions of table: 330x 360mm
 Blade tilting range: 0°-45°
 Depth of cut @90°: 34mm
 Depth of cut @45°: 18mm
 Net weight: 7.2kg

NOISE DATA

Sound power level (L_{WA}^*):86,9 dB(A)
 Uncertainty K_{PA} :4dB
 Noise pressure level (L_{PA}^*):99,9dB(A)
 Uncertainty K_{WA} :4dB

A load factor of S1 means that you may operate the motor continuously at its nominal power level (250W);

A load factor of S6 15% (intermittent periodic duty) means that you may operate the motor continuously at its nominal power level (450W) for no longer than the time (1 min) stipulated on the specifications label. If you fail to observe this time limit the motor will overheat. During the no-load running period the motor will cool again to its starting temperature.

The sound intensity level for the operator may exceed 80 dB(A) and ear protection measures are necessary.

WARNING!

- the declared noise emission value has been measuring in accordance with a standard test method and maybe used for comparing one tool with another.
- the declared noise emission value may also be used in a preliminary assement of exposure.
- the noise emission during actual use of the power tool can differ from the declared total value depending on the ways in which the tool is used especially what kind of workpiece is processed.
- the need of Identify safety measures to protect the operator that are based on an estimation of exposure in the actual conditions of use (taking account of all parts of the operating cycle such as the times

when the tool is switched off and when it is running idle in addition to the trigger time).

Rating label explanation

TTB934TCB = Model number

TT = Titan

B = Voltage (240 V~)

934= Sequential code

TCB = Tile Cutter Bench Top

Symbols

On the product, the rating label and within these instructions you will find among others the following symbols and abbreviations. Familiarise yourself with them to reduce hazards like personal injuries and damage to property.



Read the instruction manual



Caution, risk of cutting



Wear eye protection



Wear hearing protection



Wear a dust mask



Wear safety gloves



Do not dispose of batteries in a fire.



Do not throw this product into rivers or immerse in water.



Warning! This symbol warns of damage to the machine, environment or property



This product is classified as protection class I and must be connected to a protective ground during operation.



Continuous rim diamond cutting-off wheel ONLY



UK Conformity Assessed



The product complies with the applicable European Directives and an evaluation method of conformity for these Directives was done.



Take a power tool in the domestic waste! In accordance with European Directive 2012/19/EU on waste electrical and electronic equipment and its implementation in national law, electric tools collected separately and environmentally friendly recycling is used. Take advantage of the collection facilities. Ask your local government for the collection systems. If electrical appliances are disposed of, they can be poisonous for years while they cause hazardous substances into the groundwater and enter the food chain, or flora and fauna.



yyWxx Manufacturing date code: Year of manufacturing (20yy) and week of manufacturing (Wxx)

Unpacking

1. Unpack all parts and lay them on a flat, stable surface.
2. Remove all packing materials and shipping devices if applicable.
3. Make sure the delivery contents are complete and free of any damage. If you find that parts are missing or show damage do not use the product but contact your dealer. Using an incomplete or damaged product represents a hazard to people and property.
4. Ensure that you have all the accessories and tools needed for assembly and operation. This also includes suitable personal protective equipment.



WARNING! The product and the packaging are not children's toys!

Children must not play with plastic bags, sheets and small parts! There is a danger of choking and suffocation!

Setup



WARNING! The machine must be fully assembled before operation!

Do not use a machine that is only partly assembled or assembled with damaged parts!

Follow the assembly instructions step-by-step and use the pictures provided as a visual guide to easily assemble the machine!

Do not connect the product to the power supply before it is completely assembled!

ASSEMBLING THE RIVING KNIFE (A1-A3)

The machine is supplied with a riving knife. The riving knife is an important safety feature which prevents the diamond blade jamming while cutting. For safety reasons the machine may never be used without the riving knife fitted. The riving knife and blade guard come pre-assembled together.

1. Slightly loosen the pre-mounted riving knife clamping screws with screwdriver. **(A1)**
2. Slide the 2 slots of the supporting foot of riving knife into the 2 clamping screws, while the supporting foot of riving knife should stay between the 2 plate surfaces. **(A2)** Tilting the table may make this task easier.
3. Fasten the clamping screws. **(A3)**

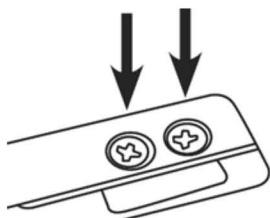

A1

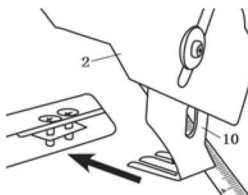

A2

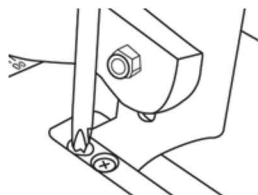

A3

ASSEMBLING THE BLADE (B1-B3)

1. Loosen the two fixing screws at the left and right of the blade guard (bottom), Note that the fixing screws are permanently attached to the blade guard (bottom) and must not be completely removed. Remove the blade guard.(B1)
2. Remove the outer flange and the spindle nut.
3. Slide the blade (8) over the spindle. The arrow on the blade shall indicate the same rotation direction as shown by the arrow on the metal plate near the spindle and on the blade guard (B2). Slide the flange over the blade. Screw the spindle nut onto the spindle(B2). Hold the spindle in place with the 8 mm wrench (supplied) and tighten the spindle nut with the 19 mm wrench (supplied) (B3).
4. Slide the blade guard (bottom) over the blade, tighten the screws.

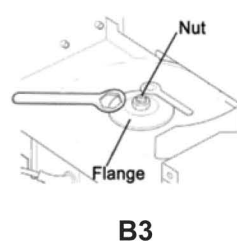
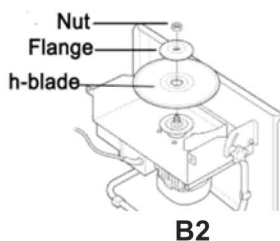
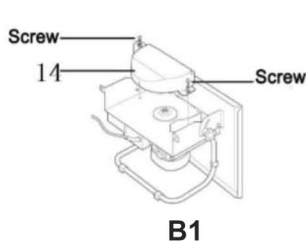

ADJUSTING THE RIVING KNIFE

Ensure that there is sufficient clearance between the blade and the blade guard. The rotating blade may not touch the blade guard during operation. Readjust left/right position of the riving knife if the rotating blade will touch the internal side of blade guard.

- The riving knife (10) must be aligned with the blade (8). Check the alignment using a rule.
- If necessary, loosen the screws and adjust the position of the riving knife.

ASSEMBLING THE FENCE (C)

The fence can be set to the required position using the scale on the saw table.

- Fix the parallel guide (7) in position on the table by tightening the fence fixed knob (6) both sides.
- Make sure the fence is parallel to the blade direction.

FITTING THE WATER TANK (D)

NOTE: Always use the water bath and ensure that the water level is between the MIN and MAX markings.

1. Put the machine as shown and install the water tank under the blade guard (bottom).

2. Lower the machine carefully. The wall of the water tank furthest away from you must fit between the blade guard (bottom) and the metal wall of the machine.

FIXING ON THE BENCH (E)

- Locate the machine on work bench.
- Use 6mm bolts mounting holes (11) to fix machine on bench.

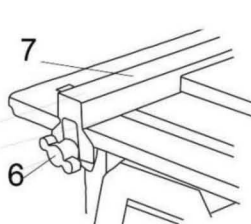

C

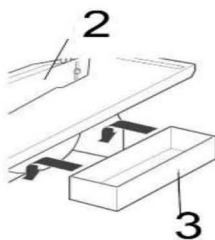

D

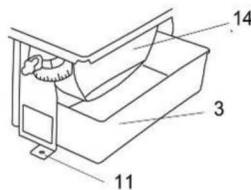

F

CONNECTION TO THE POWER SUPPLY

Connect the plug with a suitable socket.

Your product is now ready to be used.



WARNING! Check the voltage! The voltage must comply with the information on the rating label!

STARTING AND STOPPING (F)

- To start the machine, press the green button marked "I"(5)
- To stop the machine, press the green button marked "O"(5).

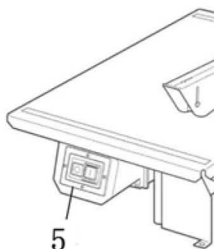

F

In more detail...



Operation	21
Care and maintenance	22
Troubleshooting	25
Recycling and disposal	26
Guarantee	27
Declaration of conformity	29

Intended use

This tile cutter TITAN TTB934TCB is designated with a rated input of 450 Watts. The electric tile cutter is designed for making straight and mitre cuts in ceramic tiles in accordance with the operating instructions and may not be used for any other purpose.

The manufacturer cannot be held responsible for damage or injury caused by using the machine for other than its intended purpose. Only continuous rim diamond blades which are suitable for the machine can be used.

Non-observance of the safety, assembly and operating instructions while operating the machine counts as misuse. Anyone who operates or services the machine must be familiar with these instructions and must be aware of possible dangers. Any applicable health and safety regulations must be followed.

The machine may not be modified. The manufacturer can accept no responsibility for damage or injury caused by modifications to the machine.

General operation

Check to make sure the device is in safe operating condition:

- Check to make sure there are no visible defects.
- Check to make sure all device components are correctly mounted.
- Check to make sure the safety mechanisms are functioning properly.
- Check the function of switch.
- Check the cooling water level is sufficient.
- Check the working area is clear of obstructions.

Never reach into the work area of the rotating cutting wheel when the machine is running, apart from the operator nobody shall be within in the working area.



WARNING! Wait until the tool has reached its Maximum rotational speed and the cutting surface of the cutting wheel is supplied with cooling water before starting to cut.

Everyone apart from the user should be at least 1m away from the machine.

STRAIGHT CUTTING (G)

Fit the parallel guide(7) to the left-hand side of the saw table. Set to the required position using the scale on the table and tighten the knobs (6).

- Put the workpiece on table against the fence. Feed the workpiece into blade as arrows show.

ANGLED CUTS (H)

Follow the same procedure for a straight cut but use the angle ruler (1) for 45 degree cutting of tiles. Ensure that the tile is held firmly into the guide before making the cut.

BEVEL CUTTING (I)

Follow the same procedure for a straight cut but:

- Loosen the table adjustment knob (4) on both sides of the cutting machine.
- Cant the table to the desired angle and tighten the knob (4).
- Make bevel cut.

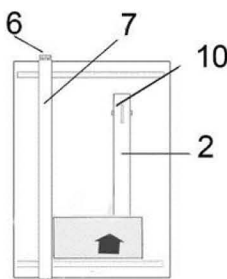

G

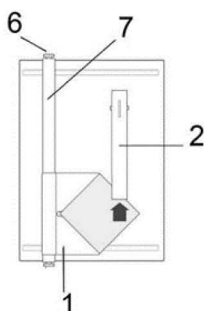

H

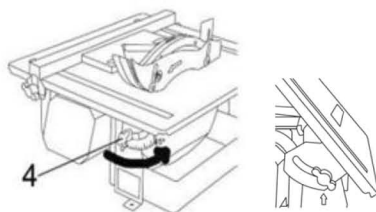

I

AFTER USING

When all cutting has been completed, switch off the machine and disconnect power supply. After allow the machine to cool, and before storing, it is advisable to thoroughly clean the machine. Empty the water tank and clean away any tile slurry from inside the tank and on the table.

The golden rules for care



WARNING! Always switch the machine off, disconnect the machine from the power supply and let it cool down before performing inspection, maintenance and cleaning work!

1. Keep the machine clean. Remove tile slurry from it after each use and before storage.
2. Regular and proper cleaning will help ensure safe use and prolong the life of the product.
3. Inspect the machine before each use for worn and damaged parts. Do not operate it if you find broken and worn parts.

Maintenance

For safety reasons, each damaged (cracked) tool has to be replaced before using. Have all other work, in particular repairs, conducted by a trained technician. If the supply cord is damaged, it must be replaced by the manufacturer, its service agent or similarly qualified persons in order to avoid a hazard. Improperly performed work may cause damage to the machine and result in injury.

Prior to any maintenance and/or cleaning:

- Switch the machine off
- Let the machine cool down
- Pull out the plug.
- Empty the water tank and clean away any tile slurry from inside the tank and on the table.
- Clean the tile saw with a clean dry cloth from time to time depending on the slurry accumulation.

Repair

This machine does not contain any parts that can be repaired by the consumer. Contact an authorised service centre or a similarly qualified person to have it checked and repaired.

Storage

1. Switch the machine off and disconnect it from the power supply.
2. Clean the machine as described above.
3. Store the machine and its accessories in a dark, dry, frost-free, well-ventilated place.
4. Always store the machine in a place that is inaccessible to children. The ideal storage temperature is between 10 °C and 30 °C.
5. We recommend using the original package for storage or covering the machine with a suitable cloth or enclosure to protect it against dust.

Transportation

1. Switch the machine off and disconnect it from the power supply.
2. Attach transportation guards, if applicable.
3. Protect the machine from any heavy impact or strong vibrations which may occur during transportation in vehicles.

4. Secure the machine to prevent it from slipping or falling over.

Power cord

If the supply cord is damaged, it must be replaced by a specially prepared cord available through the service organization.

UK plug (for UK only)

If you need to replace the fitted plug, then follow the instructions below.

IMPORTANT: The wires in the mains lead are coloured in accordance with the following code:

Blue - Neutral

Brown - Live

As the colours of the wire in the mains lead of this product may not correspond with the coloured marking identifying the terminals in your plug, proceed as follows. The wire, which is coloured blue, must be connected to the terminal, which is marked with N or coloured black. The wire, which is coloured brown, must be connected to the terminal, which is marked L or coloured red. The wire, which is colored green/yellow, must be connected to the terminal, which is mark E or ⊕.

Connect green/yellow wire to terminal E(Protective earth)

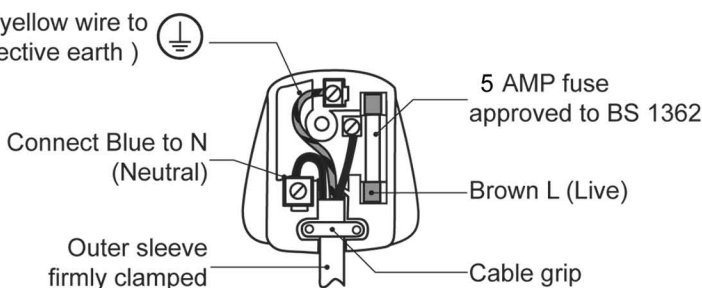

WARNING! Never connect live or neutral wires to the earth terminal of the plug, which is marked with E.

Only fit an approved 5 Amp BS 1363 or BS 1363/A plug and correctly rated 5 A BS 1362 fuse. If in doubt, consult a qualified electrician.



WARNING! If a moulded plug is fitted and has to be removed take great care in disposing of the plug and severed cable, it must be destroyed to prevent engaging into a socket.

Troubleshooting

Suspected malfunctions are often due to causes that the users can fix themselves. Therefore check the product using this section. In most cases the problem can be solved quickly.

Problem	Possible cause	Solution
1. Product does not start	1.1 PRCD protection 1.2 Not connected to power supply 1.3 Power cord or plug is defective 1.4 Other electrical defect to the product	1.1. Press the RESET Button 1.2 Connect to power supply 1.3 Check by a specialist electrician. 1.4 Check by a specialist electrician
2. Product does not reach full power	2.1 Extension cord not suitable for operation with this product 2.2 Power source (e.g. generator) has too low voltage 2.3 Air vents are blocked	2.1Use a proper extension cord 2.2. Connect to another power source 2.3. Clean the air vents
3. Unsatisfactory result	3.1 Accessory not suitable for work piece material	3.1. Use proper accessory



WARNING! Only perform the steps described within these instructions!
All further inspection, maintenance and repair work must be performed by an authorised service centre or a similarly qualified specialist if you cannot solve the problem yourself!

In more detail...

Recycling and disposal

Waste electrical products should not be disposed of with household waste. Please recycle where facilities exist. Check with your Local Authority or local store for recycling advice.



For further information visit www.recycle-more.co.uk. The product comes in a package that protects it against damage during shipping.

Keep the package until you are sure that all parts have been delivered and the product is working properly. Recycle the package afterwards.

Guarantee

We take special care to select high quality materials and use manufacturing techniques that allow us to create products incorporating design and durability. This product TITAN 450W TILE CUTTER has a manufacturer's guarantee of 2 years against manufacturing defects, from the date of purchase (if bought in store) or date of delivery (if bought online), at no additional cost for normal (non-professional or commercial) household use.

To make a claim under this guarantee, you must present your proof of purchase (such as a sales receipt, purchase invoice or other evidence admissible under applicable law), please keep your proof of purchase in a safe place. For this guarantee to apply, the product you purchased must be new, it will not apply to second hand or display products. Unless stated otherwise by applicable law, any replacement product issued under this guarantee will only be guaranteed until expiry of the original guarantee period.

This guarantee covers product failures and malfunctions provided the product was used for the purpose for which it is intended and subject to installation, cleaning, care and maintenance in accordance with the information contained in these terms and conditions, in the user manual and standard practice, provided that standard practice does not conflict with the user manual.

This guarantee does not cover defects and damage caused by normal wear and tear or damage that could be the result of improper use, faulty installation or assembly, neglect, accident, misuse, or modification of the product. Unless stated otherwise by applicable law, this guarantee will not cover, in any case, ancillary costs (shipping, movement, costs of uninstalling and reinstalling, labour etc), or direct and indirect damage.

This guarantee does not cover defects and damage caused by or resulting from:

- Normal wear and tear
- Overload, misuse or neglect
- Repairs attempted by anyone other than an authorised agent
- Cosmetic damage
- Damage caused by foreign objects, substances or accidents
- Accidental damage or modification
- Failure to follow manufacturer's guidelines
- Loss of use of the goods

If the product is defective, we will, within a reasonable time, repair or replace

it.

Rights under this guarantee are enforceable in the country in which you purchased this product. Guarantee related queries should be addressed to the store you purchased this product from.

The guarantee is in addition to and does not affect your statutory rights.

In more detail...



(EN) EU DECLARATION OF CONFORMITY
 (FR) DÉCLARATION UE DE CONFORMITÉ
 (PL) DEKLARACJA ZGODNOŚCI UE
 (RO) DECLARAȚIA DE CONFORMITATE UE
 (ES) DECLARACIÓN UE DE CONFORMIDAD
 (PT) DECLARAÇÃO DE CONFORMIDADE UE

Product/ Produit/ Produkt/Produsul/Producto/Produto

- 450W tile cutter / Coupe-carreaux 450W / Przecinarka do płytek 450W / 450W Mașină de tăiat plăci ceramice / Cortadora de azulejos 450W / Cortador de azulejos 450W
- TTB934TCB
- Serial number range 000001 to 999999

Name and address of the manufacturer or his authorised representative:

Nom et adresse du fabricant ou de son mandataire:

Nazwa i adres producenta lub jego upoważnionego przedstawiciela:

Denumirea și adresa producătorului sau a reprezentantului său autorizat:

Nombre y dirección del fabricante o de su representante autorizado:

Nome e endereço do fabricante ou do respetivo mandatário:

Kingfisher International Products B.V.,
 Rapenburgerstraat 175E,
 1011 VM Amsterdam,
 The Netherlands

This declaration of conformity is issued under the sole responsibility of the manufacturer.

La présente déclaration de conformité est établie sous la seule responsabilité du fabricant.

Niniejsza deklaracja zgodności wydana zostaje na wyłączną odpowiedzialność producenta.

Prezenta declarație de conformitate este emisă pe răspunderea exclusivă a producătorului.

La presente declaración de conformidad se expide bajo la exclusiva responsabilidad del fabricante.

A presente declaração de conformidade é emitida sob a exclusiva responsabilidade do fabricante.

Object of the declaration/Objet de la declaration/Przedmiot deklaracji/Obiectul declarației/Objeto de la declaración/Objeto da declaração

Product/Produit/Produkt/Produsul/Producto/Produto

Model/Modèle/Model/Modelul/Modelo/Modelo

EAN

450W tile cutter / Coupe-carreaux 450W / Przecinarka do płytek 450W / 450W Mașină de tăiat plăci ceramice / Cortadora de azulejos 450W / Cortador de azulejos 450W

TTB934TCB

5059340397627

The object of the declaration described above is in conformity with the relevant Union harmonisation legislation:

L'objet de la déclaration décrit ci-dessus est conforme à la législation d'harmonisation de l'Union applicable:

Wymieniony powyżej przedmiot niniejszej deklaracji jest zgodny z odpowiednimi wymaganiami unijnego prawodawstwa harmonizacyjnego:

Obiectul declarației descris mai sus este în conformitate cu legislația relevantă de armonizare a Uniunii:

El objeto de la declaración descrita anteriormente es conforme con la legislación de armonización pertinente de la Unión:

O objeto da declaração acima descrito está em conformidade com a legislação de harmonização da União aplicável:

2006/42/EC as amended Machinery Directive
 2014/30/EU as amended Directive Electromagnetic compatibility
 2011/65/EU as amended Directive Restriction of the use of certain hazardous substances in electrical and electronic equipment
 Directive 2006/42/CE relative aux machines
 2014/30 / UE telle que modifiée Directive Compatibilité électromagnétique
 Directive 2011/65/UE relative à la limitation de l'utilisation de certaines substances dangereuses dans les équipements électriques et électroniques
 2006/42/WE w zmienionej dyrektywie maszynowej
 2014/30 / UE ze zmianami Dyrektywa Kompatybilność elektromagnetyczna
 2011/65 / UE ze zmianami Dyrektywa Ograniczenie stosowania niektórych niebezpiecznych substancji w sprzęcie elektrycznym i elektronicznym
 2006/42/CE, astfel a fost modificată Directiva privind echipamentele
 2014/30/UE, astfel a fost modificată Directiva privind compatibilitatea electromagnetică
 2011/65/UE, astfel a fost modificată Directiva privind limitarea utilizării anumitor substanțe periculoase în echipamentele electrice și electronice
 Directiva sobre maquinaria modificada 2006/42/CE
 2014/30/UE modificada Directiva Compatibilidad electromagnética
 2011/65/UE modificada Directiva Restricción del uso de determinadas sustancias peligrosas en equipos eléctricos y electrónicos
 2006/42/CE como diretiva de máquinas alteradas
 2014/30/UE como alteração da compatibilidade eletromagnética
 2011/65/UE como restrição diretiva alterada da utilização de certas substâncias perigosas em equipamentos elétricos e eletrônicos

References to the relevant harmonised standards used or references to the other technical specifications in relation to which conformity is declared:

Références des normes harmonisées pertinentes appliquées, y compris la date de celles-ci, ou des autres spécifications techniques, y compris la date de celles-ci, par rapport auxquelles la conformité est déclarée:

Odwolania do odnośnych norm zharmonizowanych, które zastosowano, wraz z datą normy, lub do innych specyfikacji technicznych, wraz z datą specyfikacji, w odniesieniu do których deklarowana jest zgodność:

Trimiteri la standardele armonizate relevante folosite, inclusiv data standardului, sau trimiteri la celelalte specificații tehnice, inclusiv data specificațiilor, în legătură cu care se declară conformitatea:

Referencias a las normas armonizadas pertinentes utilizadas, incluidas las fechas de las normas, o referencias a las otras especificaciones técnicas, incluidas las fechas de las especificaciones, respecto a las cuales se declara la conformidad:

Referências às normas harmonizadas aplicáveis utilizadas, incluindo a data da norma, ou às outras especificações técnicas, incluindo a data da especificação, em relação às quais é declarada a conformidade:

EN 62841-1:2015

EN 12418:2000/A1:2009

EN 55014-1:2017/A11:2020

EN 55014-2:2015

EN 61000-3-2:2014

EN 61000-3-3:2013

EN IEC 61000-3-2:2019

EN 61000-3-3:2013/A1:2019

Authorised signatory and technical file holder/signataire et responsable de la documentation technique autorisé/
 podmiot uprawniony do wystawienia i adres przechowywania dokumentacji technicznej/semnatar autorizat și deținător
 al dosarului tehnic/firmante autorizado y titular del expediente técnico/ signatário autorizado e detentor da ficha técnica

Kingfisher International Products B.V.,
 Rapenburgerstraat 175E,
 1011 VM Amsterdam,
 The Netherlands
 David Awe
 Group Quality Director

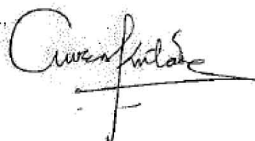

On : [20/04/2022]

**(UK) DECLARATION OF CONFORMITY**

Product		
<ul style="list-style-type: none"> • 450w tile cutter • TTB934TCB • Serial number range 000001 to 999999 		
Name and address of the manufacturer or his authorised representative:		
Kingfisher International Products Limited 3 Sheldon Square London W2 6PX United Kingdom		
This declaration of conformity is issued under the sole responsibility of the manufacturer.		
Object of the declaration		
Product	Model	EAN
450W TILE CUTTER	TTB934TCB	5059340397627
The object of the declaration described above is in conformity with the relevant legislation:		
Supply of Machinery (Safety) Regulations 2008 as amended Electromagnetic Compatibility Regulations 2016 as amended The Restriction of the use of Certain Hazardous Substances in Electrical and Electronic Equipment Regulations 2012 as amended		
References to the relevant designated standards used or references to the other technical specifications in relation to which conformity is declared:		
EN 62841-1:2015 EN 12418:2000/A1:2009 EN 55014-1:2017/A11:2020 EN 55014-2:2015 EN 61000-3-2:2014 EN 61000-3-3:2013 EN IEC 61000-3-2:2019 EN 61000-3-3:2013/A1:2019		
Authorised signatory and technical file holder: Kingfisher International Products Limited 3 Sheldon Square London W2 6PX United Kingdom		
David Awe Group Quality Director		
On [20/04/2022]		

In more detail...



**Manufacturer, Fabricant, Producent,
Producător, Fabricante:**

UK Manufacturer:
Kingfisher International Products Limited
3 Sheldon Square
London
W2 6PX
United Kingdom

EU Manufacturer:
Kingfisher International Products B.V.
Rapenburgerstraat 175E
1011 VM Amsterdam
The Netherlands



Distributor: **B&Q plc**,
Chandlers Ford, Hants,
SO53 3LE United Kingdom
www.diy.com

Screwfix Direct Limited
Trade House, Mead Avenue
Yeovil BA22 8RT, United Kingdom
www.screwfix.com

To view instruction manuals online,
visit www.kingfisher.com/products
