

TITAN

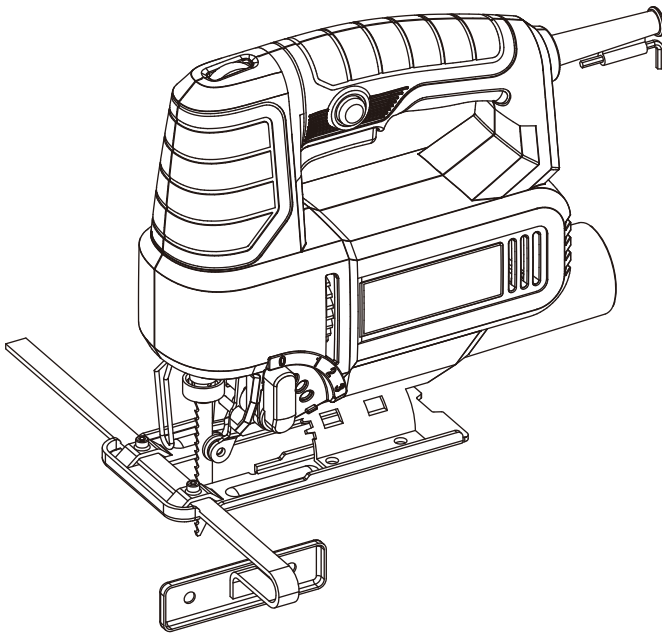

TTB867JSW

WARNING: Read the instructions before using the product!



Let's get started...

These instructions are for your safety. Please read through them thoroughly before use and retain them for future reference.



Getting **started...** 02

Safety information	03
Your product	15
Before you start	18



In more detail... 22

Product functions	23
Operation	27
Care and maintenance	32
Trouble shooting	34
Recycling and disposal	35
Guarantee	36
Declaration of conformity	37

Safety warnings

General power tool safety warnings



WARNING! Read all safety warnings, instructions, illustrations and specifications provided with this power tool. Failure to follow all instructions listed below may result in electric shock, fire and / or serious injury. **Save all warnings and instructions for future reference.** The term “power tool” in the warnings refers to your mains-operated (corded) power tool or battery-operated (cordless) power tool.

Work area safety

- > **Keep work area clean and well lit.** Cluttered or dark areas invite accidents.
- > **Do not operate power tools in explosive atmospheres, such as in the presence of flammable liquids, gases or dust.** Power tools create sparks which may ignite the dust or fumes.
- > **Keep children and bystanders away while operating a power tool.** Distractions can cause you to lose control.

Electrical safety

- > **Power tool plugs must match the outlet. Never modify the plug in any way. Do not use any adapter plugs with earthed (grounded) power tools.** Unmodified plugs and matching outlets will reduce risk of electric shock.
- > **Avoid body contact with earthed or grounded surfaces, such as pipes, radiators, ranges and refrigerators.** There is an increased risk of electric shock if your body is earthed or grounded.

Safety warnings

- > **Do not expose power tools to rain or wet conditions.** Water entering a power tool will increase the risk of electric shock.
- > **Do not abuse the cord. Never use the cord for carrying, pulling or unplugging the power tool. Keep cord away from heat, oil, sharp edges or moving parts.** Damaged or entangled cords increase the risk of electric shock.
- > **When operating a power tool outdoors, use an extension cord suitable for outdoor use.** Use of a cord suitable for outdoor use reduces the risk of electric shock.
- > **If operating a power tool in a damp location is unavoidable, use a residual current device (RCD) protected supply.** Use of an RCD reduces the risk of electric shock.

Personal safety

- > **Stay alert, watch what you are doing and use common sense when operating a power tool. Do not use a power tool while you are tired or under the influence of drugs, alcohol or medication.** A moment of inattention while operating power tools may result in serious personal injury.
- > **Use personal protective equipment. Always wear eye protection.** Protective equipment such as dust mask, non-skid safety shoes, hard hat, or hearing protection used for appropriate conditions will reduce personal injuries.

- > **Prevent unintentional starting. Ensure the switch is in the off-position before connecting to power source and/or battery pack, picking up or carrying the tool.** Carrying power tools with your finger on the switch or energising power tools that have the switch on invites accidents.
- > **Remove any adjusting key or wrench before turning the power tool on.** A wrench or a key left attached to a rotating part of the power tool may result in personal injury.
- > **Do not overreach. Keep proper footing and balance at all times.** This enables better control of the power tool in unexpected situations.
- > **Dress properly. Do not wear loose clothing or jewellery. Keep your hair, clothing and gloves away from moving parts.** Loose clothes, jewellery or long hair can be caught in moving parts.
- > **If devices are provided for the connection of dust extraction and collection facilities, ensure these are connected and properly used.** Use of dust collection can reduce dust-related hazards.
- > **Do not let familiarity gained from frequent use of tools allow you to become complacent and ignore tool safety principles.** A careless action can cause severe injury within a fraction of a second.

Power tool use and care

- > **Do not force the power tool. Use the correct power tool for your application.** The correct power tool will do the job better and safer at the rate for which it was designed.
- > **Do not use the power tool if the switch does not turn it on and off.** Any power tool that cannot be controlled with the switch is dangerous and must be repaired.

- > **Disconnect the plug from the power source and/or the battery pack from the power tool before making any adjustments, changing accessories, or storing power tools.** Such preventive safety measures reduce the risk of starting the power tool accidentally.
- > **Store idle power tools out of the reach of children and do not allow persons unfamiliar with the power tool or these instructions to operate the power tool.** Power tools are dangerous in the hands of untrained users.
- > **Maintain power tools. Check for misalignment or binding of moving parts, breakage of parts and any other condition that may affect the power tool's operation. If damaged, have the power tool repaired before use.** Many accidents are caused by poorly maintained power tools.
- > **Keep cutting tools sharp and clean.** Properly maintained cutting tools with sharp cutting edges are less likely to bind and are easier to control.
- > **Use the power tool, accessories and tool bits etc. in accordance with these instructions, taking into account the working conditions and the work to be performed.** Use of the power tool for operations different from those intended could result in a hazardous situation.
- > **Keep handles and grasping surfaces dry, clean and free from oil and grease.** Slippery handles and grasping surfaces do not allow for safe handling and control of the tool in unexpected situations.

Service

- > **Have your power tools serviced by a qualified repair person using only identical replacement parts.** This will ensure that safety of the power tool is maintained.

Jig saw safety warnings

- > **Hold power tool by insulated gripping surfaces, when performing an operation where the cutting accessory may contact hidden wiring or its own cord.** Cutting accessory contacting a “live” wire may make exposed metal parts of the power tool “live” and could give the operator an electric shock.
- > Use clamps or another practical way to secure and support the workpiece to a stable platform. Holding the workpiece by hand or against your body leaves it unstable and may lead to loss of control.

Vibration and noise reduction

To reduce the impact of noise and vibration emission, limit the time of operation, use low-vibration and low-noise operating modes as well as wear personal protective equipment.

Take the following points into account to minimise the vibration and noise exposure risks:

- > Only use the product as intended by its design and these instructions.
- > Ensure that the product is in good condition and well maintained.
- > Use correct cutting attachments for the product and ensure they are in good condition.
- > Keep tight grip on the handles/grip surface.
- > Maintain this product in accordance with these instructions and keep it well lubricated (where appropriate).
- > Plan your work schedule to spread any high vibration tool use across a longer period of time.

Safety warnings

Emergency

Familiarise yourself with the use of this product by means of this instruction manual. Memorise the safety directions and follow them to the letter. This will help to prevent risks and hazards.

- > **Always be alert when using this product, so that you can recognise and handle risks early.** Fast intervention can prevent serious injury and damage to property.
- > **Switch off and disconnect from the power supply if there are malfunctions.** Have the product checked by a qualified professional and repaired, if necessary, before you operate it again.

Residual risks

Even if you are operating this product in accordance with all the safety requirements, potential risks of injury and damage remain. The following dangers can arise in connection with the structure and design of this product:

- > Health defects resulting from vibration emission if the product is being used over long periods of time or not adequately managed and properly maintained.
- > Injuries and damage to property due to broken cutting attachments or the sudden impact of hidden objects during use.
- > Danger of injury and property damage caused by flying objects.



WARNING! This product produces an electromagnetic field during operation! This field may under some circumstances interfere with active or passive medical implants! To reduce the risk of serious or fatal injury, we recommend persons with medical implants to consult their doctor and the medical implant manufacturer before operating this product!



WARNING! Some dust created by power sanding, sawing, grinding, drilling and other construction activities contains chemicals known to cause cancer, birth defects or other reproductive harm. Some examples of these chemicals are:

- Lead from lead-based paint
- Crystalline silica from bricks and cement and other masonry products
- Arsenic and chromium from chemically treated timber

Your risk from these exposures varies, depending upon how often you do this type of work. To reduce your exposure to these chemicals:

- Work in a well-ventilated area.
- Work with approved protective equipment, such as those dust masks that are specially designed to filter microscopic particles.

The following information applies to professional users only but is good practice for all users:

ADDITIONAL SAFETY WARNING FOR CONSTRUCTION DUST

Safety warnings

- > The updated Control of Substances Hazardous to Health Regulations 1st October 2012 now also targets to reduce the risks associated with silica, wood and gypsum dusts.
- > Construction workers are one of the at-risk groups within this because of the dust that they breathe: silica dust is not just a nuisance; it is a real risk to your lungs!
- > Silica is a natural mineral present in large amounts in things like sand, sandstone and granite. It is also commonly found in many construction materials such as concrete and mortar. The silica is broken into very fine dust (also known as Respirable Crystalline Silica or RCS) during many common tasks such as cutting, drilling and grinding Breathing in very fine particles of crystalline silica can lead to the development of:
 - > Lung cancer Silicosis Chronic Obstructive Pulmonary Disorder (Chronic obstructive pulmonary disease (COPD) And breathing in fine particles of wood dust can lead to the development of Asthma The risk of lung disease is linked to people who regularly breathe construction dust over a period of time, not on the odd occasion.
 - > To protect the lung, the COSHH Regulations sets a limit on the amount of these dusts that you can breathe (called a Workplace Exposure Limit or WEL) when averaged over a normal working day.
These limits are not a large amount of dust: when compared to a penny it is tiny – like a small pinch of salt:
This limit is the legal maximum; the most you can breathe after the right controls have been used.

How to reduce the amount of dust?



1. Reduce the amount of cutting by using the best sizes of building products.
2. Use a less powerful tool e.g. a block cutter instead of angle grinder.
3. Using a different method of work altogether – e.g. using a nail gun to direct fasten cable trays instead of drilling holes first.

Please always work with approved safety equipment, such as those dust masks that specially designed to filter out microscopic particles and use the dust extraction facility at all time.

For more information please see the HSE website:

<http://www.hse.gov.uk/construction> or

<http://www.hse.gov.uk/pubns/cis69.pdf>

⚠ Warning: Some dust particles created by power sanding, sawing, grinding, drill and other construction jobs contain chemicals known to cause cancer, birth defects or other reproductive harm. Some examples of these chemicals are:

- Lead from lead-based paints.
 - Crystalline silica from bricks and cement and other masonry products.
 - Arsenic and chromium from chemically treated timber.
- Your risk from these exposures varies, depending upon how often you do this type of work. To reduce your exposure to these chemicals:
- Work in a well-ventilated area.
 - Work with approved safety equipment, such as those dust masks that are specially designed to filter microscopic particles.

Safety warnings

VIBRATION

The European Physical Agents (Vibration) Directive has been brought in to help reduce hand arm vibration syndrome injuries to power tool users. The directive requires power tool manufacturers and suppliers to provide indicative vibration test results to enable users to make informed decisions as to the period of time a power tool can be used safely on a daily basis and the choice of tool.

The declared vibration emission value should be used as a minimum level and should be used with the current guidance on vibration.

Calculating the actual period of the actual period off use can be difficult and the HSE website has further information.

The declared vibration emission been measured in accordance with a standardised test stated above and may be used to compare one tool with another tool.

The declared vibration emission value may also be used in a preliminary assessment of exposure.

⚠ Warning: The vibration emission value during actual use of the power tool can differ from the declared value depending on the ways in which the tool is used dependant on the following examples and other variations on how the tool is used:

How the tool is used and the materials being cut or drilled.

The tool being in good condition and well maintained.

The use the correct accessory for the tool and ensuring it is sharp and in good condition.

The tightness of the grip on the handles.

And the tool is being used as intended by its design and these instructions.

While working with this power tool, hand/arm vibrations occur. Adopt the correct working practices in order to reduce the exposure to vibration. This tool may cause hand-arm vibration syndrome if its use is not adequately managed.

⚠ Warning: Identify safety measures to protect the operator that are based on an estimation of exposure in the actual conditions of use (taking account of all parts of the operating cycle such as the times when the tool is switched off and when it is running idle in addition to the trigger time). Note The use of other tools will reduce the users' total working period on this tool.

Helping to minimise your vibration exposure risk. ALWAYS use sharp chisels, drills and blades.

Maintain this tool in accordance with these instructions and keep well lubricated (where appropriate).

Avoid using tools in temperatures of 10°C or less. Plan your work schedule to spread any high vibration tool use across a number of days.

Health surveillance

All employees should be part of an employer's health surveillance scheme to help identify any vibration related diseases at an early stage, prevent disease progression and help employees stay in work.

Symbols

On the product, the rating label and within these instructions you will find among others the following symbols and abbreviations. Familiarize yourself with them to reduce hazards like personal injuries and damage to property.

V~	Volt, (alternating voltage)	mm	Millimetre
Hz	Hertz	kg	Kilogram
W	Watt	dB(A)	Decibel (A-rated)
/min or min ⁻¹	Per minute	m/s ²	Metres per seconds squared



Lock / to tighten or secure.



Unlock / to loosen.



Note / Remark.



Caution / Warning.



Read the instruction manual.



Wear hearing protection.



Wear eye protection.



Wear a dust mask.



Wear protective gloves.



Wear protective, slip-resistant footwear.

yyWxx

Manufacturing date code; year of manufacturing (20yy) and week of manufacturing (Wxx)



Switch the product off and disconnect it from the power supply before assembly, cleaning, adjustments, maintenance, storage and transportation.



This product is of protection class II. That means it is equipped with enhanced or double insulation.



The product complies with the applicable European directives and an evaluation method of conformity for these directives was done.



UK Conformity Assessed.



WEEE symbol. Waste electrical products should not be disposed of with household waste. Please recycle where facilities exist. Check with your Local Authority or local store for recycling advice.



For wood cutting only



For metal cutting only



Your product

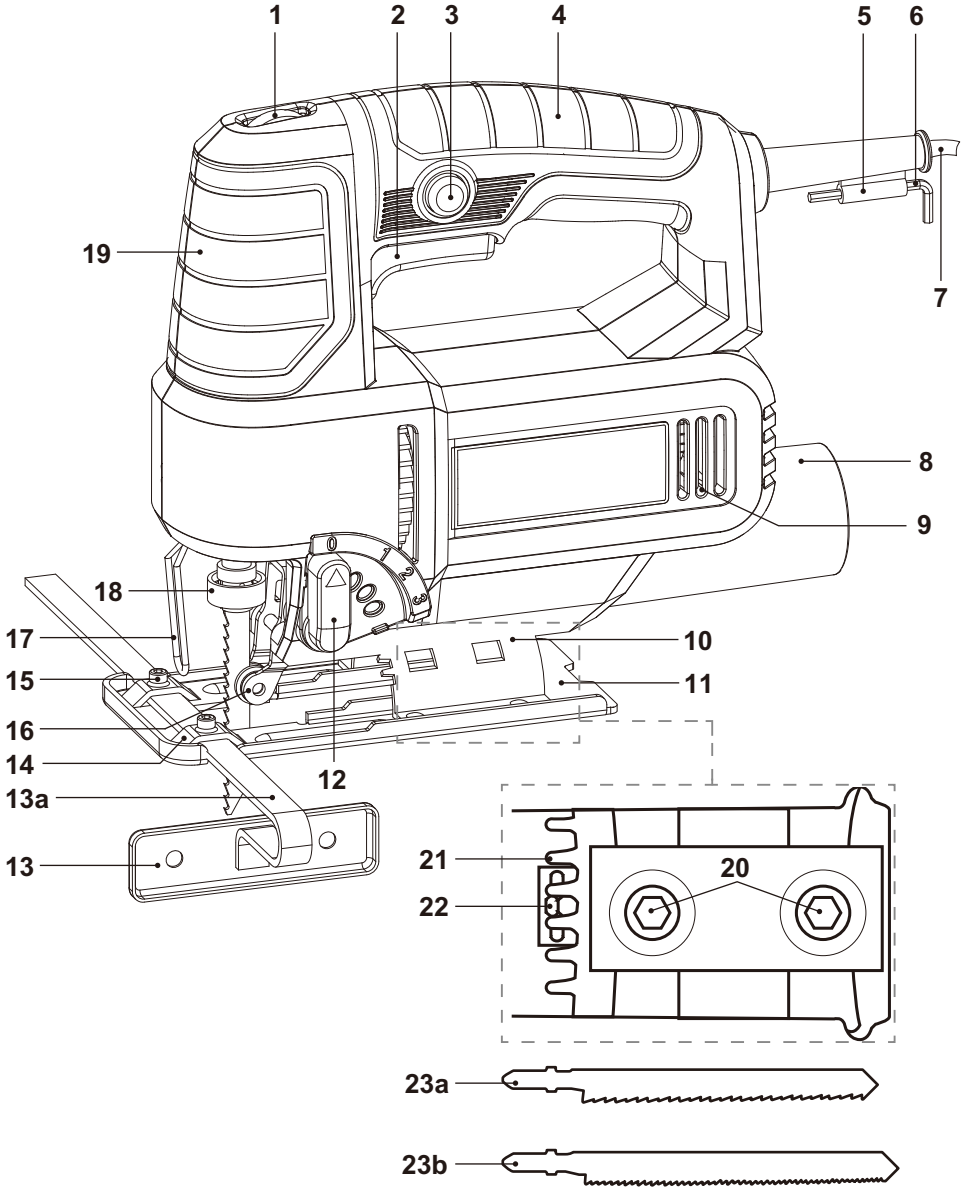

Getting started...

Your product

- | | |
|---------------------------|----------------------------|
| 1. Speed dial | 14. Bracket |
| 2. On/off switch | 15. Hex bolt (x 2) |
| 3. Lock-on button | 16. Blade guide |
| 4. Handle | 17. Blade guard |
| 5. Holder | 18. Tool socket |
| 6. Hex key | a. Lever* |
| 7. Power cord with plug | 19. Gripping surface |
| 8. Dust extraction outlet | 20. Hex bolt |
| 9. Air vents | 21. Teeth |
| 10. Bevel scale | 22. Pin |
| 11. Base plate | 23a. Saw blade (for wood) |
| 12. Pendulum selector | 23b. Saw blade (for steel) |
| 13. Parallel guide | |
| a. Scale | |



NOTE: Parts marked with * are not shown in this overview. Please refer to the respective section in the instruction manual.

Technical specifications

General

- > **Rated voltage, frequency** : 220-240 V~, 50 Hz
- > **Rated power input** : 600 W
- > **Rated no load speed n_0** : 800-3000 min⁻¹
- > **Length of stroke** : 18 mm
- > **Blade type:** : T
- > **Protection class** : II 
- > **Weight** : approx. 2.0 kg

Maximum cutting capacity

- > **in wood** : max. 80 mm
- > **in aluminium** : max. 16 mm
- > **in mild steel** : max. 8 mm

Sound values

- > **Sound pressure level** L_{pA} : 89.4 dB (A)
- > **Sound power level** L_{WA} : 100.4 dB (A)
- > **Uncertainty** K_{pA} , K_{WA} : 5 dB (A)

Hand arm vibration values

- > **Cutting board** $a_{h,B}$: 14.9 m/s²
- > **Uncertainty** K : 1.5 m/s²

The sound values have been determined according to noise test code given in EN 62841-1, using the basic standards EN ISO 3744 and EN ISO 11203.

The sound intensity level for the operator may exceed 80 dB(A) and ear protection measures are necessary.

The declared vibration value and noise value has been measured in accordance with a standard test method (according to EN 62841-2-11) and may be used for comparing one product with another. The declared vibration value and noise value may also be used in a preliminary assessment of exposure.



WARNING! The vibration and noise emissions during actual use of the power tool can differ from the declared values depending on the ways in which the tool is used especially what kind of workpiece is processed; and need to identify safety measures to protect the operator that are based on an estimation of exposure in the actual conditions of use (taking account of all parts of the operating cycle such as the times when the tool is switched off and when it is running idle in addition to the trigger time).

RATING LABEL EXPLANATION

TTB867JSW = Model number

TT = TITAN

B = 220-240V ~

867 = Serial Number

JSW = Multi-pendulum jigsaw

Unpacking

- > Unpack all parts and lay them on a flat, stable surface.
- > Remove all packing materials and shipping devices, if applicable.
- > Make sure the delivery contents are complete and free of any damage. If you find that parts are missing or show damage do not use the product but contact your dealer. Using an incomplete or damaged product represents a hazard to people and property.
- > Ensure that you have all the accessories and tools needed for assembly and operation. This also includes suitable personal protective equipment.



WARNING! The product and the packaging are not children's toys! Children must not play with plastic bags, sheets and small parts! There is a danger of choking and suffocation!

You will need

(items not supplied)

Suitable personal protective equipment

(items supplied)

Hex key (6)

Parallel guide (13)

Saw blade (for wood) (23a)

Saw blade (for steel) (23b)

Setup



WARNING! The product must be fully assembled before operation! Do not use a product that is only partly assembled or assembled with damaged parts!



Follow the assembly instructions step-by-step and use the pictures provided as a visual guide to easily assemble the product!

Do not connect the product to power supply before it is completely assembled!

Saw blades

Type T saw blades can be used with the product depending on the workpiece material. Please avoid using type U blade on this product.



WARNING! Always use the correct saw blade according to the intended use!



Observe the technical requirements of this product (see section "Technical specifications") when purchasing and using saw blades! Saw blades are very sharp and become hot during use! Handle them carefully! Wear protective gloves when handling saw blades in order to avoid injuries like burns and cuts!

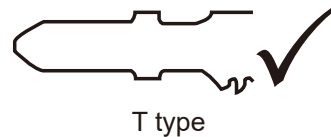
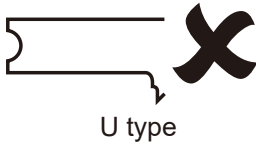

Inserting

- > Turn the product upside down.
- > Press the release lever (18a) and hold it in position (Fig. 1, step 1).
- > Insert the required saw blade (23a, 23b) into the tool socket (18) all the way to the stop (Fig. 1, step 2). Ensure the blade edge sits properly against the blade guide (16).
- > Carefully release the lever (18a) to secure the saw blade (23a, 23b).
- > Pull on the saw blade (23a, 23b) to test if it sits properly in place. It should not be possible to pull it out.

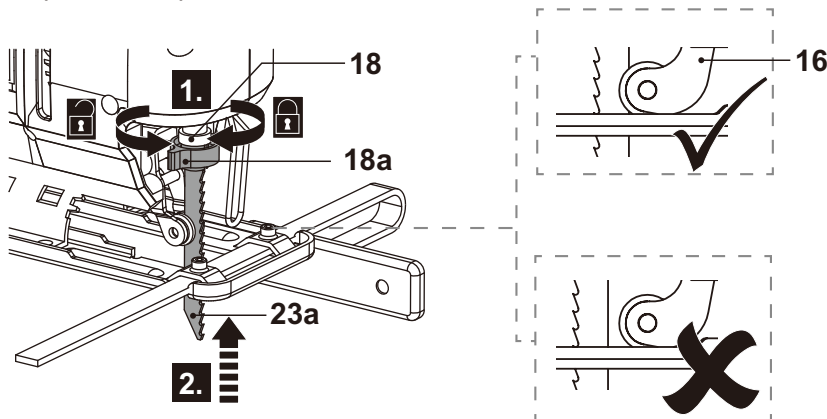

Fig. 1

Saw blades

Removing/Replacing

- > Turn the product upside down.
- > Press the lever (18a) and hold it in position.
- > Remove the saw blade (23a, 23b) and insert a new blade as required.

Parallel guide

Attach the parallel guide from the left or right side to perform cuts parallel to the workpiece edges.

- > Loosen the 2 hex bolts (15) with the hex key (6) (Fig. 2, step 1).
- > Align the parallel guide (13) with the brackets (14) and insert it (13) through them (Fig. 2, step 2).
- > Use the scale (13a) to adjust the desired width.
- > Tighten the hex bolts (15) to secure the parallel guide (13) in position (Fig. 2, step 3).

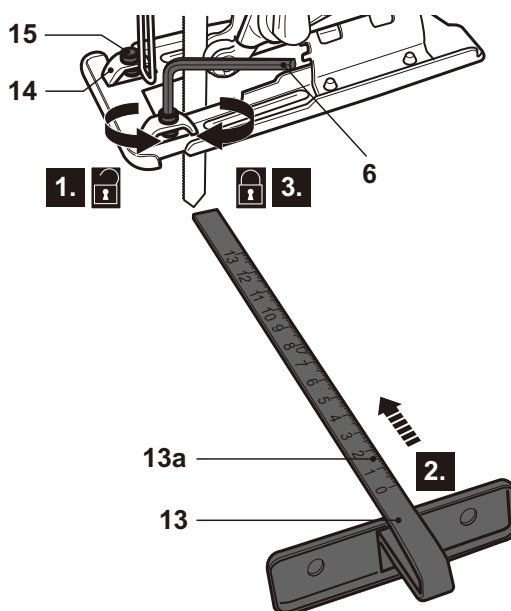

Fig. 2

Dust extraction



WARNING! Attach a dust extraction device when using this product to saw wood in order to keep the working area clean! Wear a dust mask when operating this product! Dust can be harmful to health! Especially dust and chips of wood that has been treated, e. g. with wood preservative or a stain!



Attach a proper dust extraction device, e. g. a suitable vacuum cleaner, to the dust extraction outlet (8) (Fig. 3).

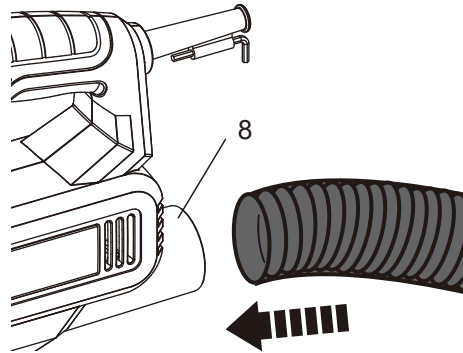

Fig. 3

Connection to power supply

- > Make sure the on/off switch (2) is in its off position.
- > Connect the plug with a suitable socket.



WARNING! Check the voltage! The voltage must comply with the information on the rating label!

- > Your product is now ready to be used.

In more detail...



Product functions	23
Operation	27
Care and maintenance	32
Trouble shooting	34
Recycling and disposal	35
Guarantee	36
Declaration of conformity	37

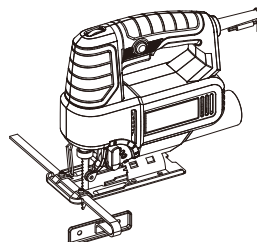

Intended use

This product is intended for cutting wood and similar material e. g. MDF and chipboard, plastic and metal using appropriate saw blades.

The product must be used in an upright position only with the base plate laying flat on the workpiece. It may not be used upside down or as stationary product on a work bench.

For safety reasons it is essential to read the entire instruction manual before first operation and to observe all the instructions therein.





Pendulum selector



WARNING! Always switch the product off and disconnect it from power supply before making any adjustments!

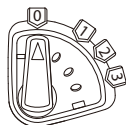

Adjust the pendulum speed according to the workpiece material and thickness.

Illustration	Position	Pendulum action	Application
	0	off	fine cuts in thin workpieces cutting tight curves or circles
	1	small	hard workpieces, (e. g. steel & chipboard)
	2	medium	thick workpieces (e. g. wood and plastics)
	3	large	fast cuts in soft materials (e. g. softwood) cutting in the direction of the wood grain

In more detail...

Speed dial

Limit the maximum speed using the speed dial (1).

- > Turn the speed dial (1) forward (as seen from the operator's position) to increase the maximum speed (Fig. 4). A higher setting is suitable for cutting with fine saw blades and soft materials.
- > Turn the speed dial (1) backward (as seen from the operator's position) to decrease the maximum speed (Fig. 5). A lower setting is suitable for cutting with coarse saw blades and hard materials.

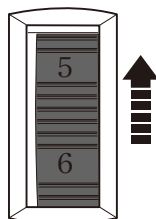

Fig. 4

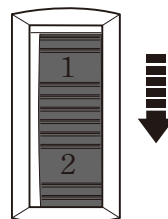

Fig. 5

1	2	3	4	5	6
slow		medium		fast	
hardwood, thick workpieces		plywood, soft steel, aluminium and plastics, non-ferrous metal		soft, thin workpieces	

Angle adjustment



WARNING! Always ensure the product is switched off and disconnected from the power supply before carrying out any work on the product!

Adjust the cutting angle according to your needs (Fig. 6).

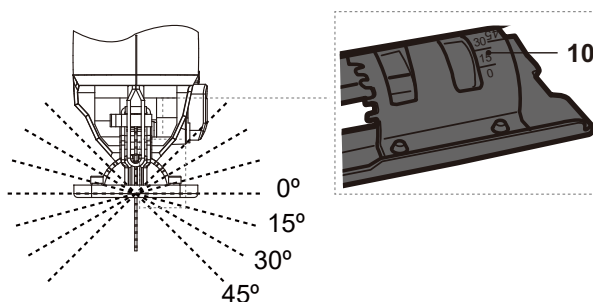

Fig. 6

- > Turn the product upside down.
- > Loosen the 2 hex bolts (20) with the hex key (6) anticlockwise (Fig. 7, step 1).
- > Slide the base plate (11) backward to disengage the teeth (21) from the pin (22) (Fig. 7, step 2).

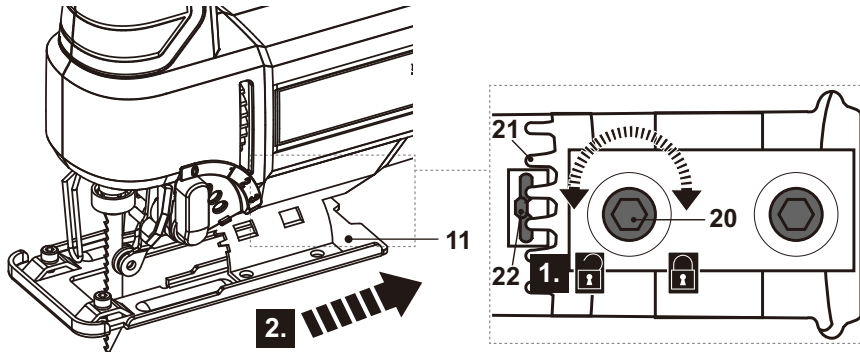

Fig. 7

- > Tilt the base plate (11) to adjust required cutting angle (Fig. 8).

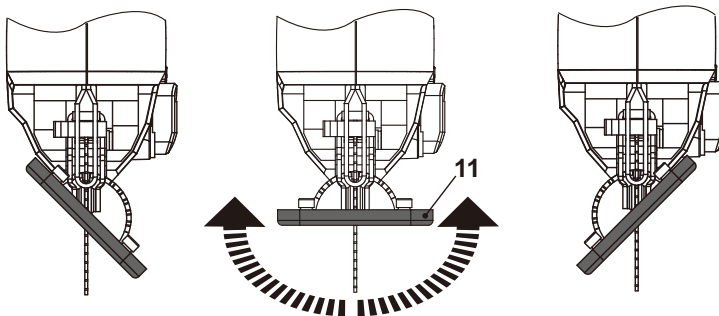

Fig. 8

- > Slide the base plate (11) forward to engage the teeth (21) to the pin (22) (Fig. 9, step 1).



WARNING! Always adjust to a position in which the teeth are engaged! Do not attempt to adjust any other position to avoid sudden tilting during operation and thereby resulting in injuries and damage property!

- > Tighten the 2 hex bolts (20) with the hex key (6) (Fig. 9, step 2).

Angle adjustment

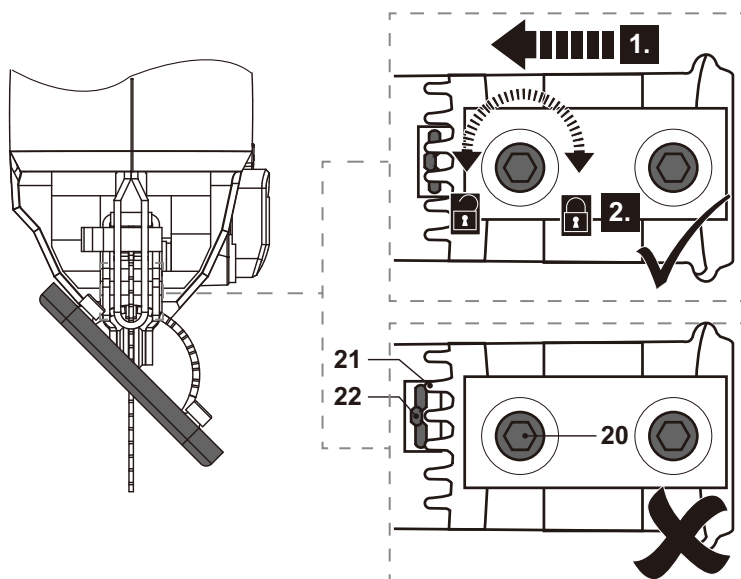

Fig. 9

Switching on/off

Operate the product either in instant or continuous mode.

Instant mode

- > Switch the product on by pressing the on/off switch (2) (Fig. 10).
- > Switch the product off by releasing the on/off switch (2).

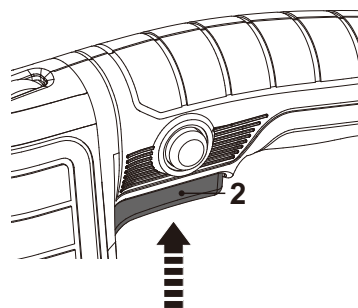

Fig. 10

Continuous mode

- > Switch the product on by pressing the on/off switch (2) and hold it in position (Fig. 11, step 1).
- > Press the lock-on button (3) and hold it in position to lock the on/off switch (2) (Fig. 11, step 2).
- > Release the lock-on button (3) and on/off switch (2). The on/off switch is now locked on for continuous use.
- > Depress and release the on/off switch (2) to switch the product off.

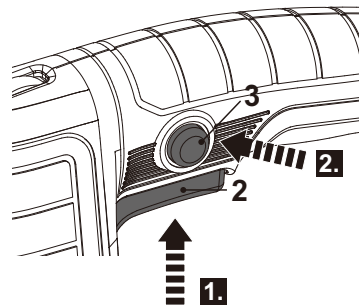

Fig. 11

General operation

- > Check the product, its power cord and plug as well as accessories for damage before each use. Do not use the product if it is damaged or shows wear.
- > Double check that the accessories and attachments are properly fixed.
- > Always hold the product on its handle and gripping surface. Keep the handle and gripping surface dry to ensure safe support.
- > Ensure that the air vents are always unobstructed and clear. Clean them if necessary with a soft brush. Blocked air vents may lead to overheating and damage the product.
- > Switch the product off immediately if you are disturbed while working by other people entering the working area. Always let the product come to complete stop before putting it down.
- > Do not overwork yourself. Take regular breaks to ensure you can concentrate on the work and have full control over the product.

In more detail...

Cutting



WARNING! During operation fine dust will be generated!

Some dusts are highly inflammable and explosive! Do not smoke during operation, keep heat sources and open flames out of the working area! Always use a dust extraction system and wear a dust mask to protect yourself against hazards resulting from fine dust!



WARNING! This tool generates noise above 80dB(A). Always ensure that ear defenders are worn during use.

- > Cut in the direction of the wood grain whenever possible to avoid jamming the saw blade and fraying edges.
- > Take the cutting edge into consideration when cutting along marked cutting lines. Do not cut directly on the line but next to it (Fig. 12).

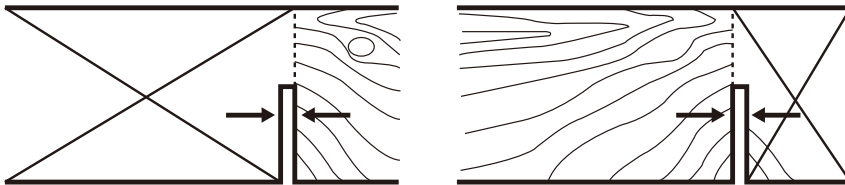

Fig. 12

- > Always add cutting oil along the cutting line to reduce heat when cutting metal.
- > Ensure the workpiece is free of obstacles like nails or screws before operation. Remove them if required.
- > Check that there is sufficient clearance for the saw blade under the workpiece.
- > Hold the product with one hand on the handle (4), and with the other hand on the gripping surface (19). Never try to operate the product with only one hand! Keep your hands away from under the workpiece (Fig. 13).
- > Switch the product on and wait until it runs at full speed before placing it on the workpiece.
- > Place the base plate (11) flat on the workpiece and push the product forward at an even speed.

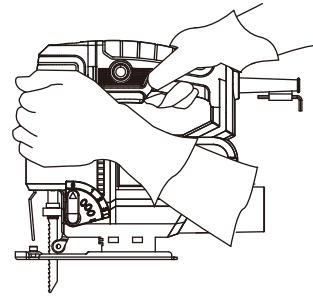

Fig. 13



WARNING! Always ensure the base plate lays flat on the workpiece during operation! Do not try to make cuts with the product only held by hand!

- > Only apply as much pressure as necessary to keep the product flat on the workpiece. Higher pressure will not increase but lower the performance of the product and leads to uneven results.
- > Keep the product moving at all times, do not stop in one position to avoid grooves.
- > Lift the product from the workpiece before switching it off.
- > Switch the product off, let it come to a complete stop and disconnect it from the power supply if the saw blade gets stuck in the workpiece. Only then free the jammed blade.

Parallel cutting

- > Attach the parallel guide (13) to the product as described above and adjust to desired width (Fig. 14).
- > Place the product laterally to the workpiece and guide the product along the edge.

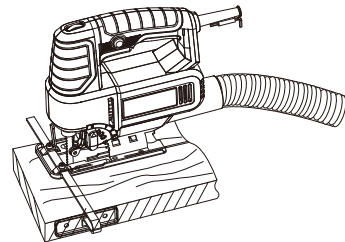

Fig. 14



NOTE: Apply light pressure against the workpiece and move the product along the edge to achieve an even result.

Cutting

Angle cutting

- > Adjust the required cutting angle; ensure the hex bolts (20) are properly tightened. For accurate work, first perform test cuts on offcuts of the workpiece. Check the cut and reset the angle until the correct cut is achieved.
- > Switch the product on and wait until it runs at full speed before placing it on the workpiece.
- > Place the base plate (11) flat on the workpiece and push the product forward at an even speed (Fig. 15).

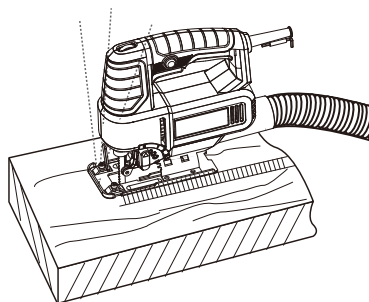

Pocket cutting

Use the following "hole method" to start a cut in the centre of the workpiece.



NOTE: Pocket cutting may be used only on soft materials such as wood, gypsum plaster boards, etc.!
Use only short saw blades!

Always ensure the base plate lays flat on the workpiece during operation! Do not try to make cuts with the product only held by hand!



Only operate the pocket cutting at bevel angle of 0° (Fig. 16).



Fig. 16



Hole method

- > Use a suitable drill to drill a hole of at least 12 mm on the cutting line (Fig. 17).
- > Insert the saw blade that is fitted to the product into the hole and ensure it does not touch the workpiece.
- > Switch the product on and wait until it runs at full speed before pushing the product forward.

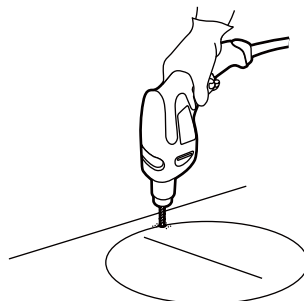

Fig. 17

After use

- > Switch the product off, disconnect it from the power supply and let it cool down.
- > Check, clean and store the product as described below.

The golden rules for care



WARNING! Always switch the product off, disconnect the product from the power supply and let the product cool down before performing inspection, maintenance and cleaning work!



- > Keep the product clean. Remove debris from it after each use and before storage.
- > Regular and proper cleaning will help ensure safe use and prolong the life of the product.
- > Inspect the product before each use for worn and damaged parts. Do not operate it if you find broken and worn parts.



WARNING! Only perform repairs and maintenance work according to these instructions! All further works must be performed by a qualified specialist!

In more detail...

General cleaning

- > Clean the product with a dry cloth. Use a brush for areas that are hard to reach.
- > In particular clean the air vents (9) after every use with a cloth and brush.
- > Remove stubborn dirt with high pressure air (max. 3 bar).



NOTE: Do not use chemical, alkaline, abrasive or other aggressive detergents or disinfectants to clean this product as they might be harmful to its surfaces.

- > Check for worn or damaged parts. Replace worn parts as necessary or contact an authorised service centre for repair before using the product again.

Maintenance

Before and after each use, check the product and accessories (or attachments) for wear and damage. If required, exchange them for new ones as described in this instruction manual. Observe the technical requirements.

Power cord

If the supply cord of this power tool is damaged, it must be replaced by a specially prepared supply cord available through the service organization.

UK plug

If you need to replace the fitted plug, then follow the instructions below.
IMPORTANT: The wires in the mains lead are coloured in accordance with the following code:

Blue – Neutral Brown – Live

As the colours of the wire in the mains lead of this product may not correspond with the coloured marking identifying the terminals in your plug, proceed as follows. The wire, which is coloured blue, must be connected to the terminal, which is marked with N or coloured black. The wire, which is coloured brown, must be connected to the terminal, which is marked L or coloured red.

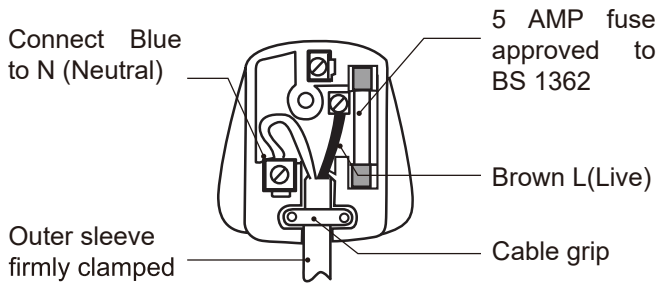

WARNING! Never connect live or neutral wires to the earth terminal of the plug, which is marked with E.

Only fit an approved 13 Amp BS 1363 or BS 1363/A plug and the correctly rated fuse. If in doubt, consult a qualified electrician.



NOTE: If a moulded plug is fitted and has to be removed take great care in disposing of the plug and severed cable, it must be destroyed to prevent engaging into a socket.

Repair

This product does not contain any parts that can be repaired by the consumer. Contact an authorised service centre or a similarly qualified person to have it checked and repaired.

Storage

- > Switch the product off and disconnect it from the power supply.
- > Clean the product as described above.
- > Store the product and its accessories in a dark, dry, frost-free, well-ventilated place.
- > Always store the product in a place that is inaccessible to children. The ideal storage temperature is between 10°C and 30°C.
- > We recommend using the original package for storage or covering the product with a suitable cloth or enclosure to protect it against dust.

Transportation

- > Switch the product off and disconnect it from the power supply.
- > Attach transportation guards, if applicable.
- > Always carry the product by its handle (4).
- > Protect the product from any heavy impact or strong vibrations which may occur during transportation in vehicles.
- > Secure the product to prevent it from slipping or falling over.

Troubleshooting

Suspected malfunctions are often due to causes that the users can fix themselves. Therefore check the product using this section. In most cases the problem can be solved quickly.



WARNING! Only perform the steps described within these instructions! All further inspection, maintenance and repair work must be performed by an authorised service centre or a similarly qualified specialist if you cannot solve the problem yourself!

Problem	Possible cause	Possible cause
1. Product does not start	1.1. Not connected to power supply 1.2. Power cord or plug is defective 1.3. Other electrical defect to the product	1.1. Connect to power supply 1.2. Check by a specialist electrician 1.3. Check by a specialist electrician
2. Product does not reach full power	2.1. Extension cord not suitable for operation with this product 2.2. Power source (e. g. generator) has too low voltage 2.3. Air vents are blocked	2.1. Use a proper extension cord 2.2. Connect to another power source 2.3. Clean the air vents
3. Unsatisfactory result	3.1. Saw blade is worn 3.2. Saw blade not suitable for workpiece material	3.1. Replace with new one 3.2. Use proper saw blade
4. Excessive vibration or noise	4.1. Saw blade is worn 4.2. Bolts/nuts are loose	4.1. Replace with a new one 4.2. Tighten bolts/nuts



Recycling and disposal



Waste electrical products should not be disposed of with household waste. Please recycle where facilities exist. Check with your Local Authority or local store for recycling advice.

In more detail...

Guarantee

We take special care to select high quality materials and use manufacturing techniques that allow us to create products incorporating design and durability. This product (TITAN Multi-pendulum jigsaw) has a manufacturer's guarantee of 2 years against manufacturing defects, from the date of purchase (if bought in store) or date of delivery (if bought online), at no additional cost.

To make a claim under this guarantee, you must present your proof of purchase (such as a sales receipt, purchase invoice or other evidence admissible under applicable law), please keep your proof of purchase in a safe place. For this guarantee to apply, the product you purchased must be new, it will not apply to second hand or display products. Unless stated otherwise by applicable law, any replacement product issued under this guarantee will only be guaranteed until expiry of the original guarantee period.

This guarantee covers product failures and malfunctions provided the product was used for the purpose for which it is intended and subject to installation, cleaning, care and maintenance in accordance with the information contained in these terms and conditions, in the user manual and standard practice, provided that standard practice does not conflict with the user manual.

This guarantee does not cover defects and damage caused by normal wear and tear or damage that could be the result of improper use, faulty installation or assembly, neglect, accident, misuse, or modification of the product. Unless stated otherwise by applicable law, this guarantee will not cover, in any case, ancillary costs (shipping, movement, costs of uninstalling and reinstalling, labour etc), or direct and indirect damage.



This guarantee does not cover defects and damage caused by or resulting from:

- Normal wear and tear
- Overload, misuse or neglect
- Repairs attempted by anyone other than an authorised agent
- Cosmetic damage
- Damage caused by foreign objects, substances or accidents
- Accidental damage or modification
- Failure to follow manufacturer's guidelines
- Loss of use of the goods

If the product is defective, we will, within a reasonable time, repair or replace it.

Rights under this guarantee are enforceable in the country in which you purchased this product. Guarantee related queries should be addressed to the store you purchased this product from.

The guarantee is in addition to and does not affect your statutory rights.

 (UK) DECLARATION OF CONFORMITY		
Product		
<ul style="list-style-type: none"> • Multi-pendulum jigsaw • TTB867JSW • Serial number: from 000001 to 999999 		
Name and address of the manufacturer or his authorised representative:		
Kingfisher International Products Limited 3 Sheldon Square London W2 6PX United Kingdom		
This declaration of conformity is issued under the sole responsibility of the manufacturer.		
Object of the declaration		
Product	Model	EAN
Multi-pendulum jigsaw	TTB867JSW	5059340252162
The object of the declaration described above is in conformity with the relevant legislation:		
Supply of Machinery (Safety) Regulations 2008 as amended Electromagnetic Compatibility Regulations 2016 as amended The Restriction of the use of Certain Hazardous Substances in Electrical and Electronic Equipment Regulations 2012 as amended		
References to the relevant designated standards used or references to the other technical specifications in relation to which conformity is declared:		
EN 62841-1:2015 EN 62841-2-11:2016/A1:2020 EN 55014-1:2017/A11:2020 EN 55014-2:1997/A2:2008 EN 55014-2:2015 EN 61000-3-2:2014 EN IEC 61000-3-2:2019 EN 61000-3-3:2013 EN 61000-3-3:2013/A1:2019		
Authorised signatory and technical file holder: Kingfisher International Products Limited 3 Sheldon Square London W2 6PX United Kingdom		
		
David Awe Group Quality Director		On: 28/02/2022

In more detail...



(EN) EU DECLARATION OF CONFORMITY
 (FR) DÉCLARATION UE DE CONFORMITÉ
 (ES) DECLARACIÓN UE DE CONFORMIDAD
 (PT) DECLARAÇÃO DE CONFORMIDADE UE

Product/ Produit/ Producto/Produto

- Multi-pendulum jigsaw/Scie sauteuse pendulaire/Sierra de calar pendular multiple
Serra tico-tico pendular
- TTB867JSW
- SN: 000001-999999

Name and address of the manufacturer or his authorised representative:

Nom et adresse du fabricant ou de son mandataire:

Nombre y dirección del fabricante o de su representante autorizado:

Nome e endereço do fabricante ou do respetivo mandatário:

Kingfisher International Products B.V.,
 Rapenburgerstraat 175E,
 1011 VM Amsterdam,
 The Netherlands

This declaration of conformity is issued under the sole responsibility of the manufacturer.

La présente déclaration de conformité est établie sous la seule responsabilité du fabricant.

La presente declaración de conformidad se expide bajo la exclusiva responsabilidad del fabricante.

A presente declaração de conformidade é emitida sob a exclusiva responsabilidade do fabricante.

Object of the declaration/Objet de la declaration/Objeto de la declaración/Objeto da declaração

Product/Produit/Producto/ Produto

Model/Modèle/Modelo/Modelo

EAN

Multi-pendulum jigsaw
 Scie sauteuse pendulaire
 Sierra de calar pendular multiple
 Serra tico-tico pendular

TTB867JSW

5059340252162 (UK)
 5059340252179 (EU)

The object of the declaration described above is in conformity with the relevant Union harmonisation legislation:

L'objet de la déclaration décrit ci-dessus est conforme à la législation d'harmonisation de l'Union applicable:

El objeto de la declaración descrita anteriormente es conforme con la legislación de armonización pertinente de la Unión:

O objeto da declaração acima descrito está em conformidade com a legislação de harmonização da União aplicável:

2006/42/EC as amended Machinery Directive
 2014/30/EU as amended Directive Electromagnetic compatibility
 2011/65/EU as amended Directive Restriction of the use of certain hazardous substances in electrical and electronic equipment

Directive 2006/42/CE relative aux machines
 2014/30 / UE telle que modifiée Directive Compatibilité électromagnétique
 Directive 2011/65/UE relative à la limitation de l'utilisation de certaines substances dangereuses dans les équipements électriques et électroniques

Directiva sobre maquinaria modificada 2006/42/CE
 2014/30/UE modificada Directiva Compatibilidad electromagnética
 2011/65/UE modificada Directiva Restricción del uso de determinadas sustancias peligrosas en equipos eléctricos y electrónicos

2006/42/CE como diretiva de máquinas alteradas
 2014/30/UE como alteração da compatibilidade eletromagnética
 2011/65/UE como restrição diretiva alterada da utilização de certas substâncias perigosas em equipamentos elétricos e eletrônicos

References to the relevant harmonised standards used or references to the other technical specifications in relation to which conformity is declared:

Références des normes harmonisées pertinentes appliquées, y compris la date de celles-ci, ou des autres spécifications techniques, y compris la date de celles-ci, par rapport auxquelles la conformité est déclarée:
 Referencias a las normas armonizadas pertinentes utilizadas, incluidas las fechas de las normas, o referencias a las otras especificaciones técnicas, incluidas las fechas de las especificaciones, respecto a las cuales se declara la conformidad:

Referências às normas harmonizadas aplicáveis utilizadas, incluindo a data da norma, ou às outras especificações técnicas, incluindo a data da especificação, em relação às quais é declarada a conformidade:

EN 62841-1:2015
 EN 62841-2-11:2016/A1:2020
 EN 55014-1:2017/A11:2020
 EN 55014-2:1997/A2:2008
 EN 55014-2:2015
 EN 61000-3-2:2014
 EN IEC 61000-3-2:2019
 EN 61000-3-3:2013
 EN 61000-3-3:2013/A1:2019

Authorised signatory and technical file holder/signataire et responsable de la documentation technique
 autorisé/ firmante autorizado y titular del expediente tecnico/ signatário autorizado e detentor da ficha técnica

Kingfisher International Products B.V.,
 Rapenburgerstraat 175E, 1011 VM Amsterdam, The Netherlands



David Awe
 Group Quality Director

28/02/2022

In more detail...



TITAN

Manufacturer, Fabricant, Producent, Producător, Fabricante:

UK Manufacturer:

Kingfisher International Products Limited
3 Sheldon Square, London, W2 6PX
United Kingdom
www.kingfisher.com/products

EU Manufacturer:

Kingfisher International Products B.V.
Rapenburgerstraat 175E
1011 VM Amsterdam
The Netherlands
www.kingfisher.com/products

EN

www.screwfix.com
www.screwfix.ie

To view instruction manuals online, visit
www.kingfisher.com/products

FR

www.bricodepot.fr

Pour consulter les manuels d'instructions en ligne,
rendez-vous sur le site www.kingfisher.com/products

ES

www.bricodepot.es

Para consultar los manuales de instrucciones en línea,
visite www.kingfisher.com/products

PT

www.bricodepot.pt

Para consultar manuais de instruções online, visite
www.kingfisher.com/products