

Fitting/replacing bulbs

- This system contains non-replaceable parts and cannot be serviced. If damage occurs the part should be scrapped.

We recommend cleaning with a soft dry cloth.

Do not use solvents or abrasive cleaners as these could damage the finish.

Recycling advice



Waste electrical products should not be disposed of with household waste. Please recycle where facilities exist. Check with your Local Authority or retailer for recycling advice.

Safety information

For your safety, always switch off the supply before cleaning.

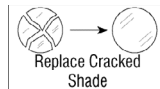

The LED's are protected by a lens. This part must be replaced immediately should the lens become cracked or damaged. This fitting must not be used without the lens in place.

Instruction leaflet

Laryn PIR Flood Light

5278J, 7172J



UK Manufacturer:
BH17 7BY

EU Manufacturer:
Brilliant AG, 27442, Germany

27012021



Thank you for purchasing this light fitting. Please read the instructions carefully before use to ensure safe and satisfactory operation of this product. Please retain these instructions for future reference.

Warning

The unit cannot be dimmed.

This system contains non-replaceable parts and cannot be serviced. If damage occurs the part should be scrapped.

Waste electrical products should not be disposed of with household waste. Please recycle where facilities exist. Check with your local authority or retailer for recycling advice.

This product is rated at IP44.

This product is not suitable for location in or near a marine environment.

Battery Care:-

- Do not recharge non-rechargeable batteries.
- Do not mix old and new batteries or batteries of different types/brands.
- Do not use rechargeable batteries. Always remove exhausted batteries from the product.
- Always insert batteries with the correct polarity.
- Do not short the supply terminals.
- This product is suitable for use by adults only.

Specification

- Voltage: 4.5V
- Lamp: 5278J: 1 x 2W LED module (SMD 5630), 7172J : 2 x 2W LED module (SMD 5630)
- IP rating: 44
- Battery Type: 3 x 1.5V LR14 'C' (not supplied). Using good quality batteries, the expected length of time 5278J will operate is 9 hours, and 4.5 hours for 7172J.

Layout

- Avoid mounting on surfaces subject to vibration, as this may affect the PIR sensor.
- To avoid damage to the unit, do not aim the sensor towards the sun or areas of strong electro-magnetic disturbances.
- To avoid nuisance triggering, the sensor should be aimed away from heat sources, such as BBQ's, Air-Conditioners, other outside lighting, moving cars and flue vents or reflective surfaces such as smooth white walls or swimming pools.
- When selecting location, it is advisable to note that movement across the sensors field is more effective than towards/away from it..

Installation

- Decide on the optimum location for the product. Ensure the wall is capable of holding the weight of the product.
- Place the floodlight in an upright position.
- Remove the screw from the base of the product and set aside for refitting later.
- To detach the wall back from the product, press down the button (on top of the battery box) with one hand and pull the ribbon tab with the other hand.
- Using the wall back as a template, mark and drill the position of the fixing holes.
- Fix the wall back to the wall using the screws and plugs. Take care to avoid damaging any concealed wiring and pipes. The correct fixings should be used for brick or cavity walls.
- Fit the batteries, ensuring the Battery Care warnings on the previous page are heeded.
- Push the button on top of the wall back down with one hand and push the product onto the wall back. It will click in place. Refit the screw to the base of the product to secure in place.
- Switch on the product using the toggle switch and adjust the PIR sensor as detailed below. Please note the sensor rotates for easy access to the controls. Line the white dots up at the front of the product to ensure the correct orientation.
- Your light is now ready for use.

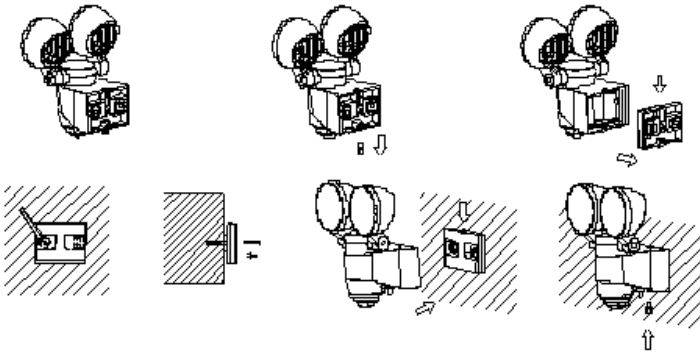

PIR Adjustment

- The unit must be installed in a vertical position, and fitted between 1.8 and 2.5m above the ground.
- The PIR sensor can be adjusted, allowing the detection distance to be altered to suit the location. The detection angle is set at 130 degrees. The duration that the lamp stays on can be altered from 5 seconds - 1 minute. The detection distance "SENS" can be adjusted from 1.5m to 8m Use a small screwdriver to adjust the 'TIME' and 'SENS' screws. When adjusting the sensitivity (detection distance) in daylight it will be necessary to cover the sensor to simulate night time.

Adjustable up to 8 metres	Base of product
Detection range can be adjusted by turning 'SENS' screw	Duration the bulb stays on is adjustable by turning 'TIME' screw The sensor trigger point is adjustable by turning the 'LUX' screw.