

ASSEMBLY AND USAGE INSTRUCTIONS

ERDE
- 102.2

ERDE
WEEK-END

DAXARA by erde
- 107.2

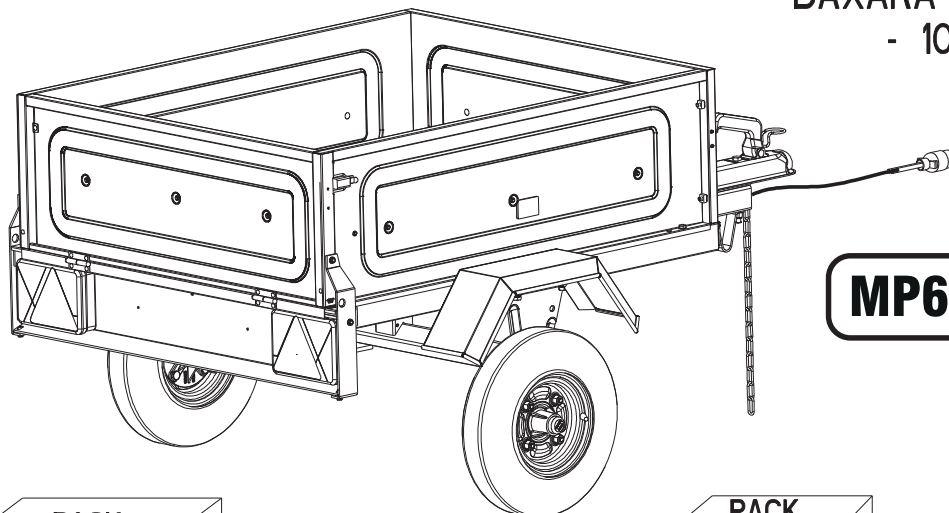

MP6810

PACK
A

PACK
B

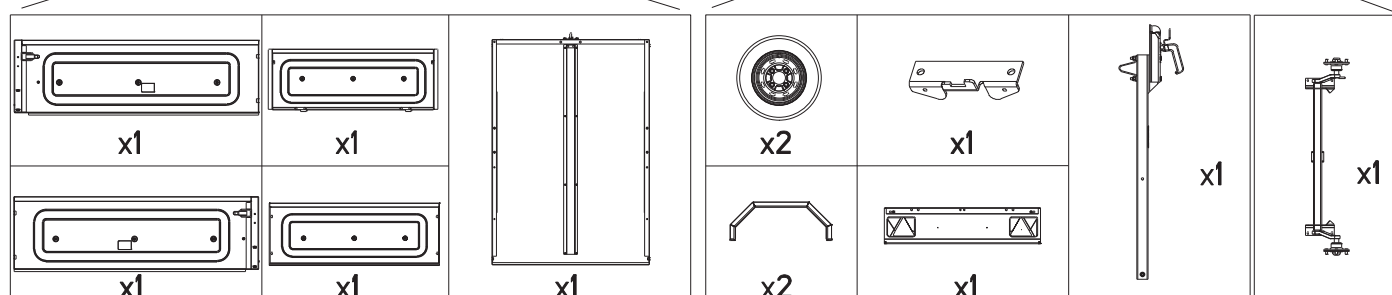

NUTS AND BOLTS CONTENT

| | | | | |
|---------|--------|--------|-------------|--------|
| | | | | |
| x4 | x4 | x10 | x4 | x4 |
| M 10x25 | M 8x25 | M 8x20 | 90° BRACKET | M 6x12 |
| | | | | |
| x4 | x 8 | x1 | | |
| Ø 10 | Ø10 | 8x16 | | |



WEAR GLOVES
DURING ASSEMBLY

Manufactured on behalf of

MAYPOLE
LIMITED

Maypole Ltd, Birmingham UK
www.maypole.ltd.uk
sales@maypoleltd.co.uk

ERDE

WWW.ERDE.EU

TOOLS REQUIRED FOR ASSEMBLY. NOT PROVIDED

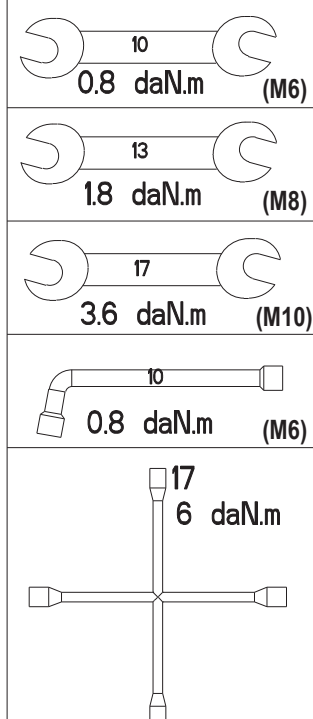

NOTE: TIGHTEN FIXINGS TO TORQUES
PRESCRIBED IN THE LIST OF TOOLS

A

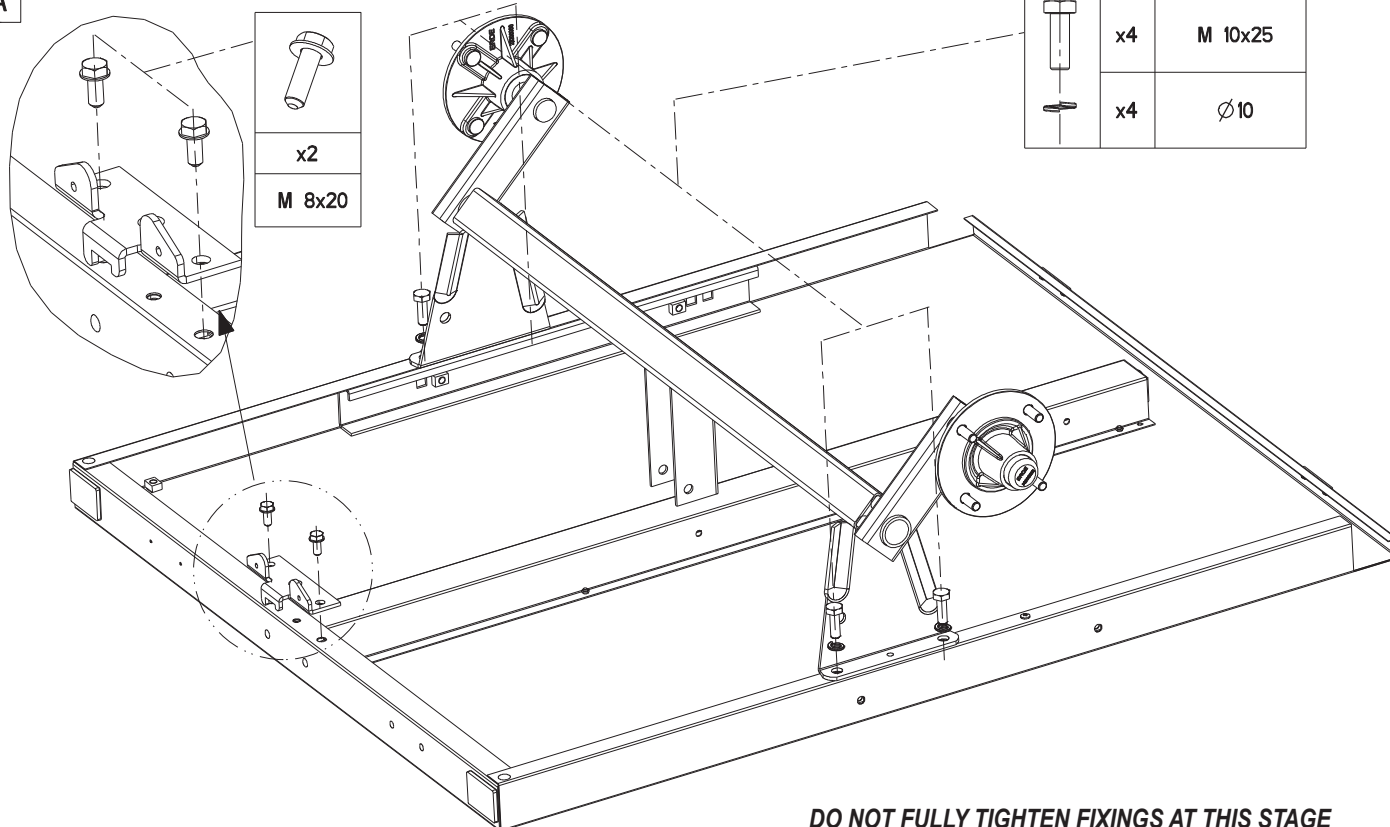

B

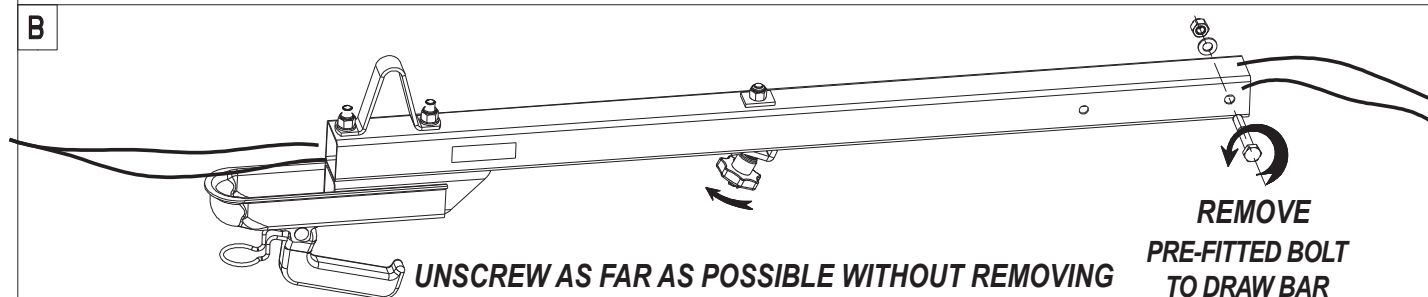

C

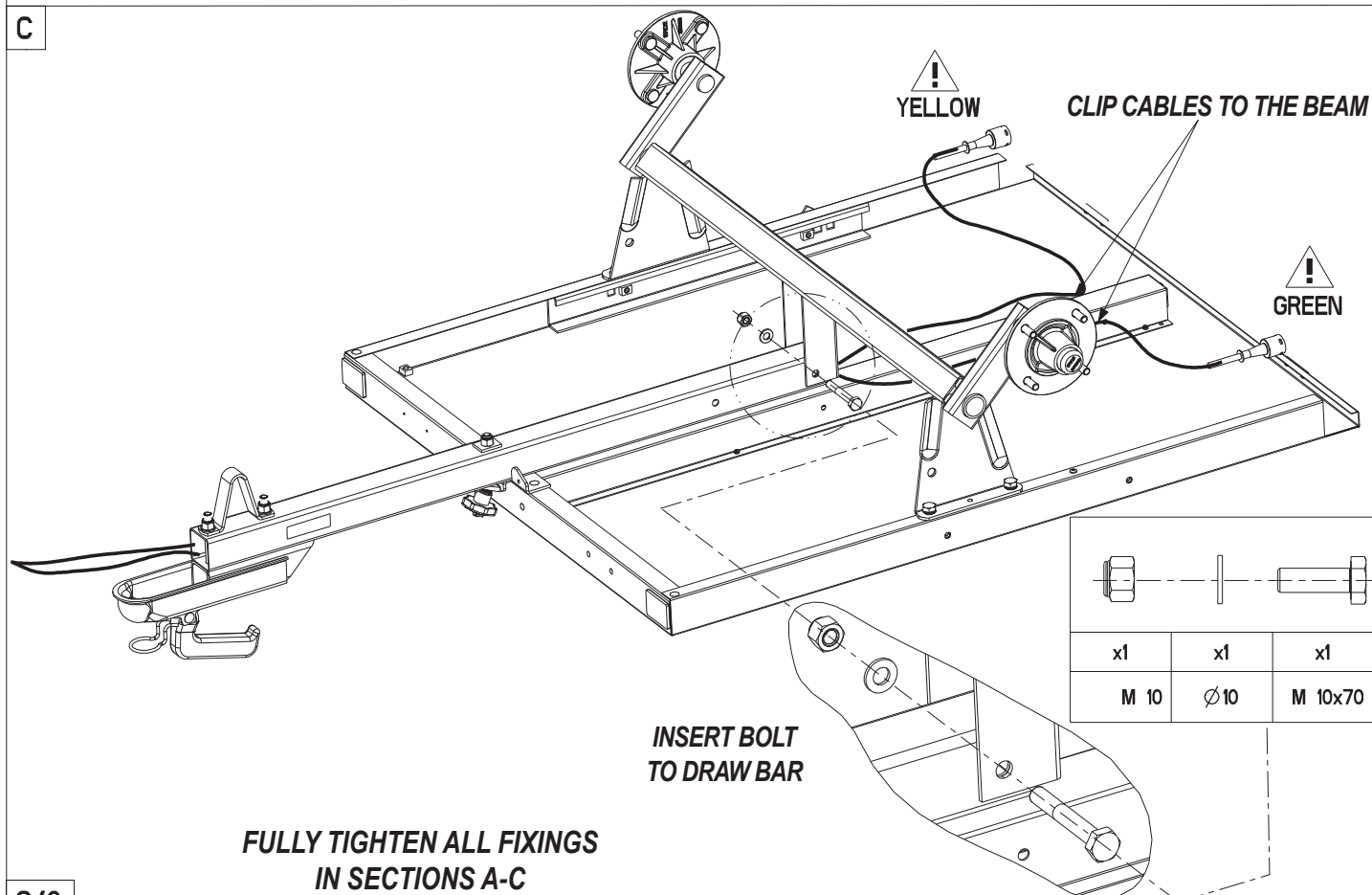

D

**DOMED HEAD AGAINST
THE WHEEL RIM**

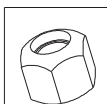

x8

WHEEL NUT

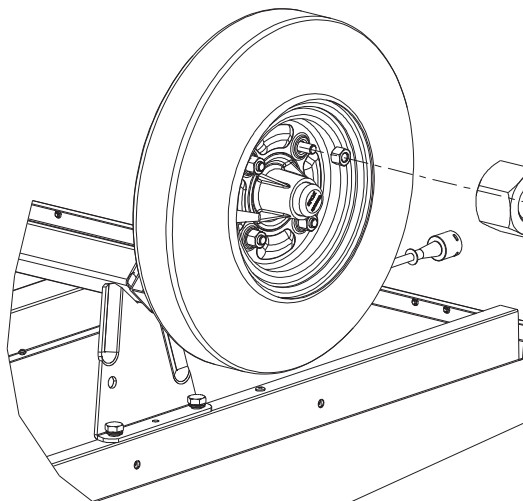

E

**1 CAREFULLY TURN THE TRAILER OVER
SO WHEELS ARE ON THE GROUND**

2 TIGHTEN FIRMLY

3 INSERT THE PIN

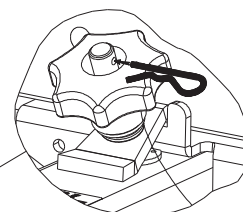
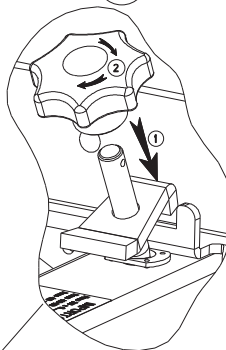

**4 FULLY TIGHTEN THE
WHEEL NUTS**

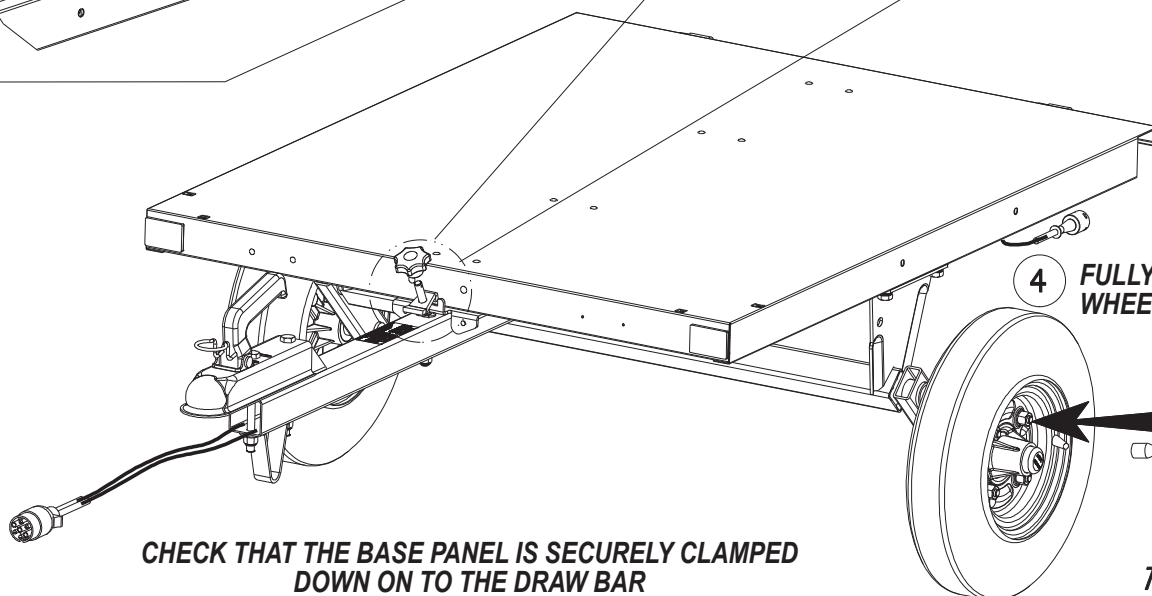

TORQUE
6 daN.m or 6 Kg.m

**CHECK THAT THE BASE PANEL IS SECURELY CLAMPED
DOWN ON TO THE DRAW BAR**

FULLY TIGHTEN FIXINGS IMMEDIATELY

F

1

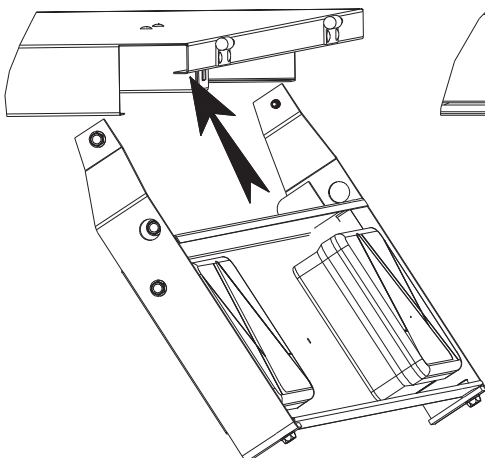

2

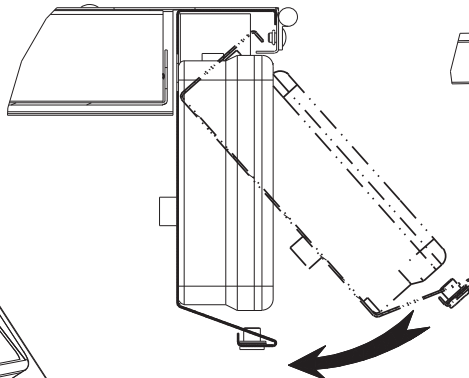

3

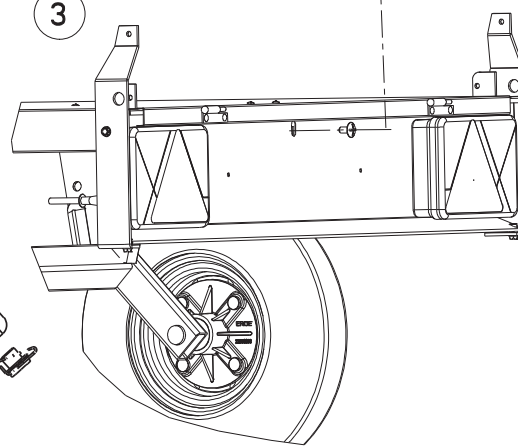

x1

8x16

G

DO NOT FULLY TIGHTEN FIXINGS IN SECTIONS G-J UNTIL INSTRUCTED TO DO SO

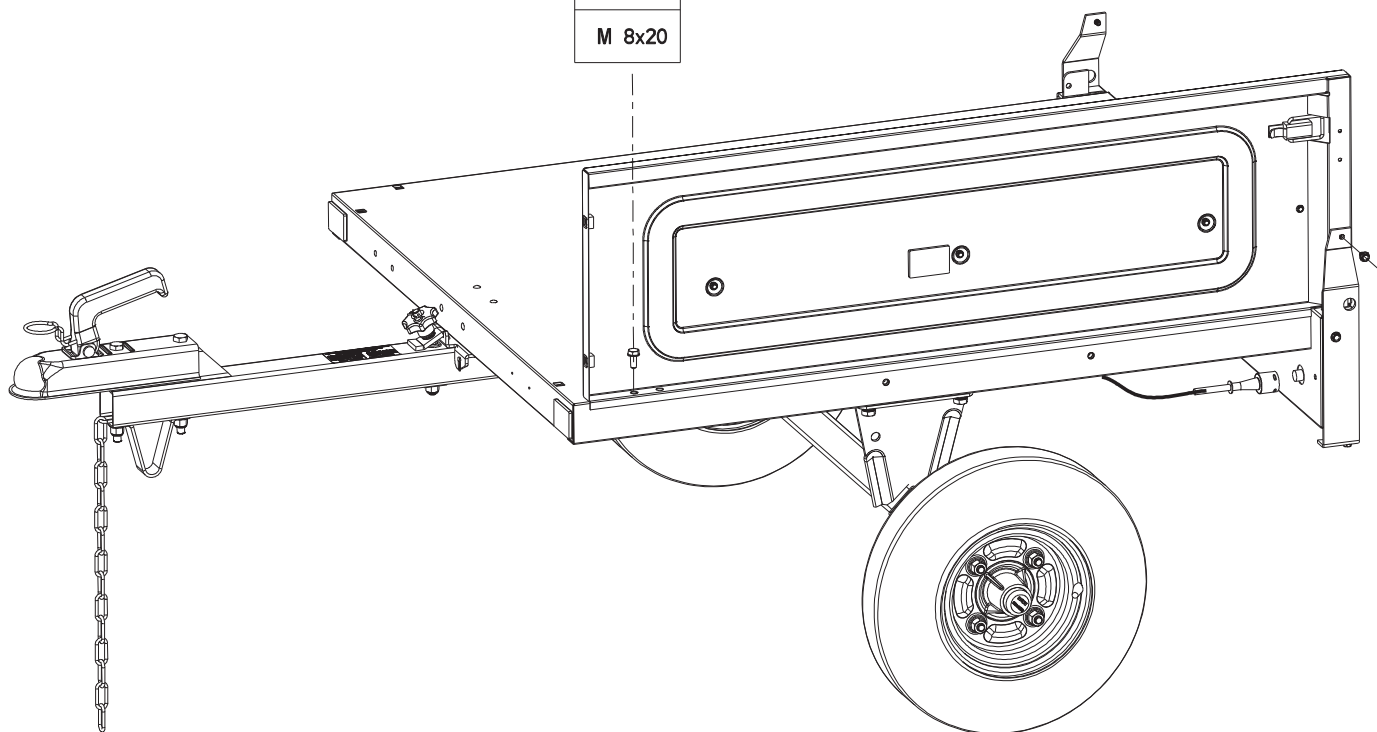
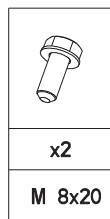

H

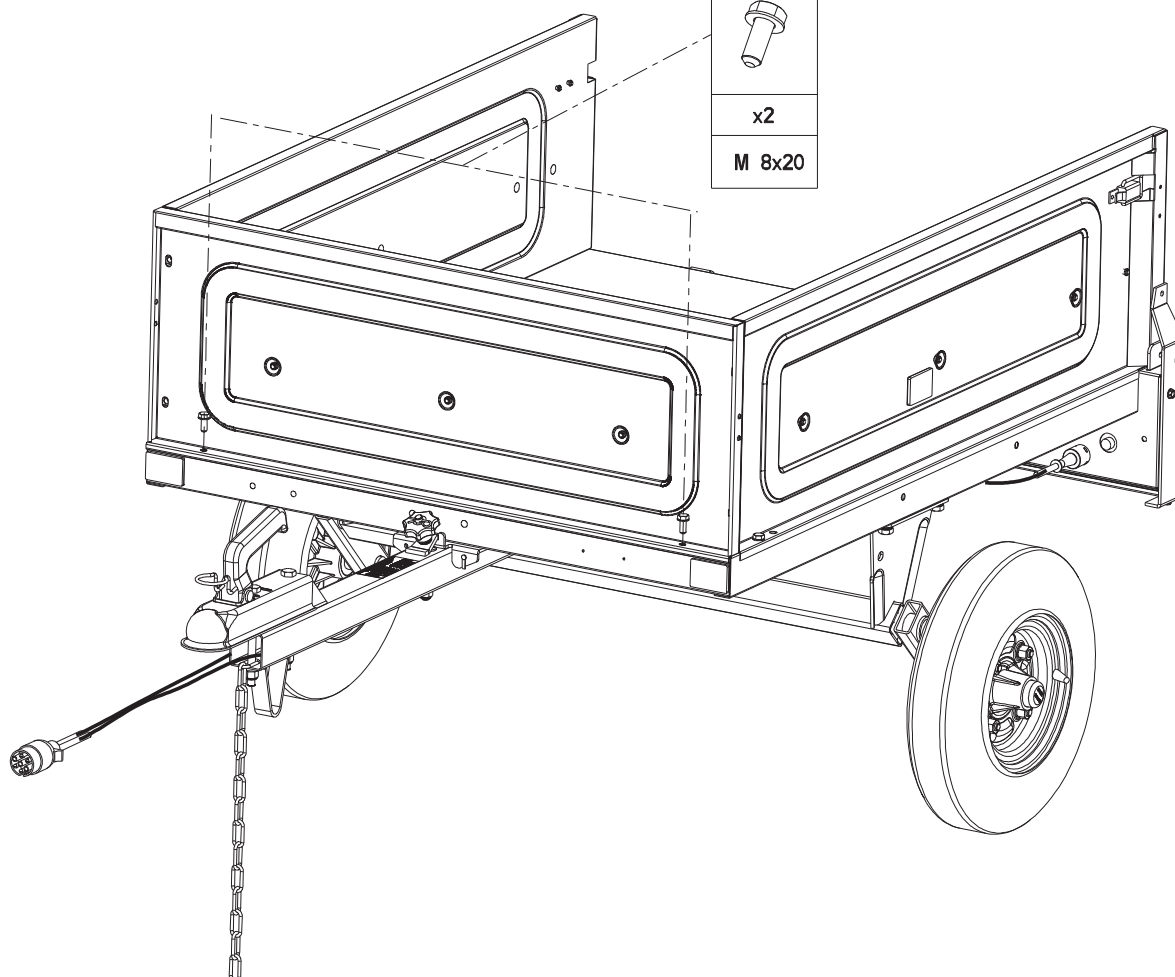
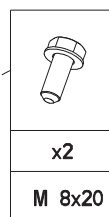

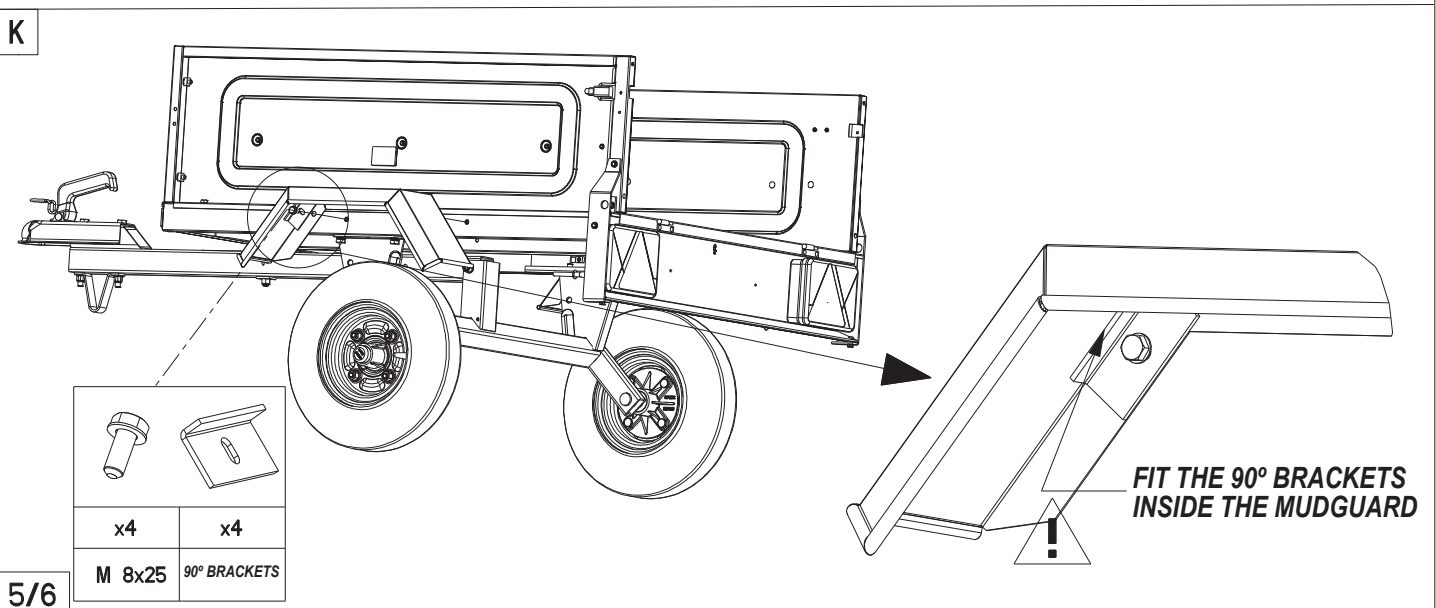
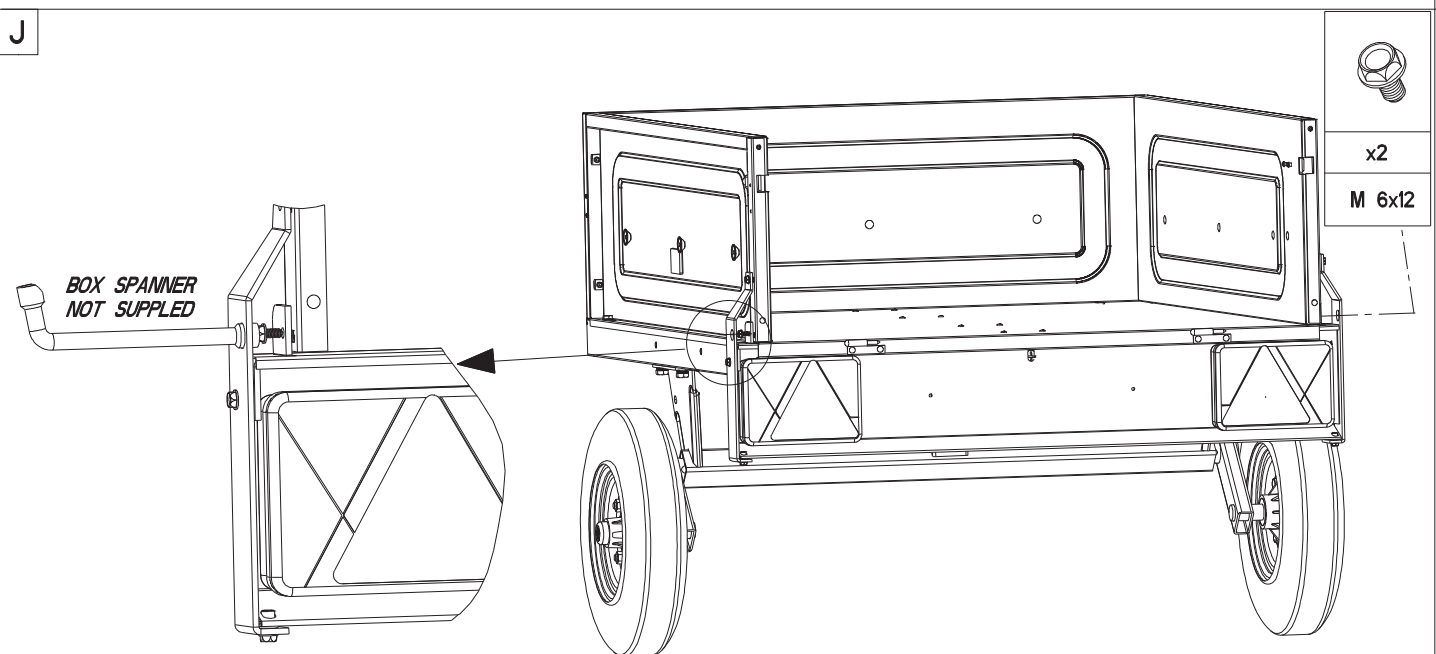
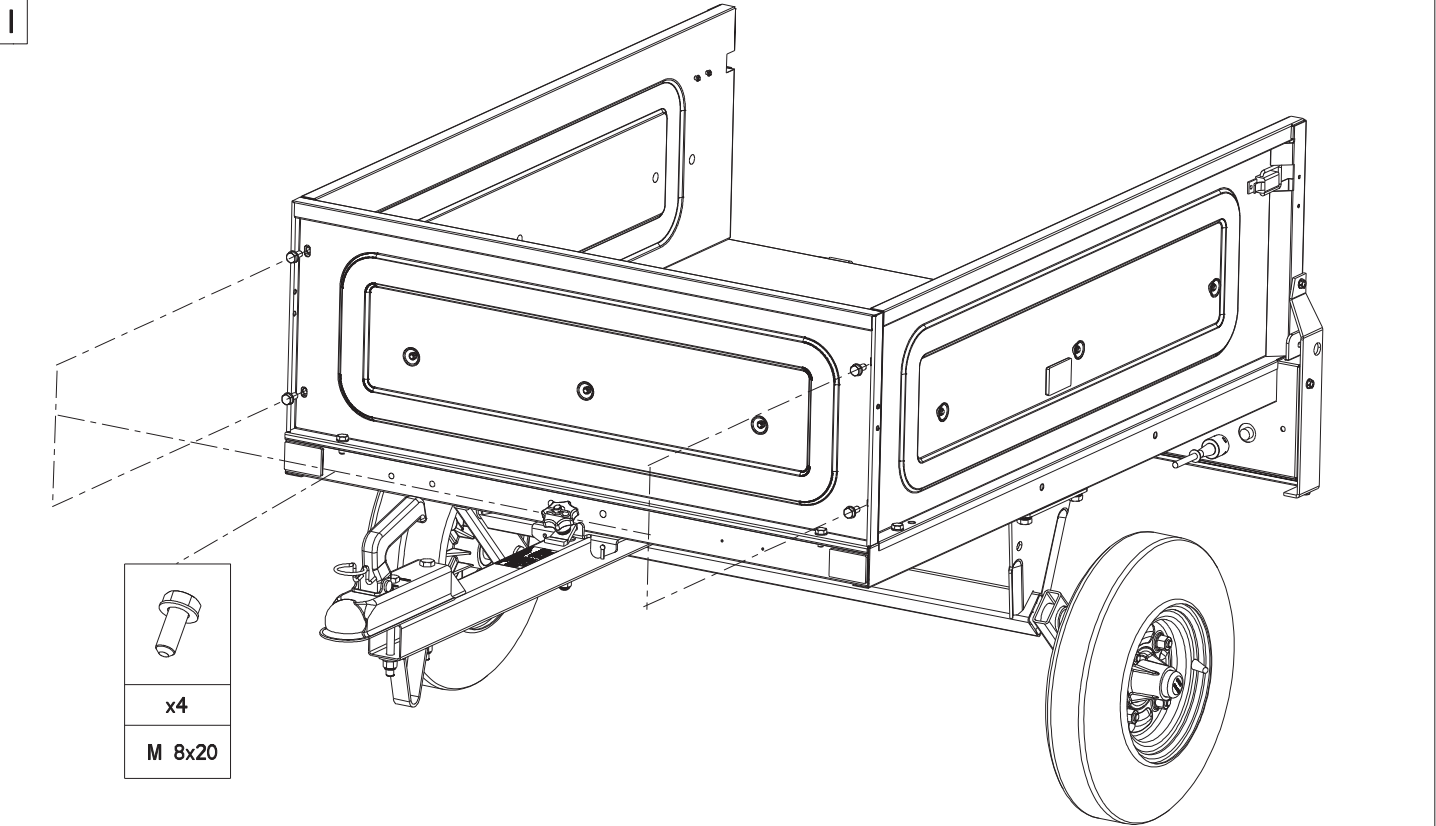

L

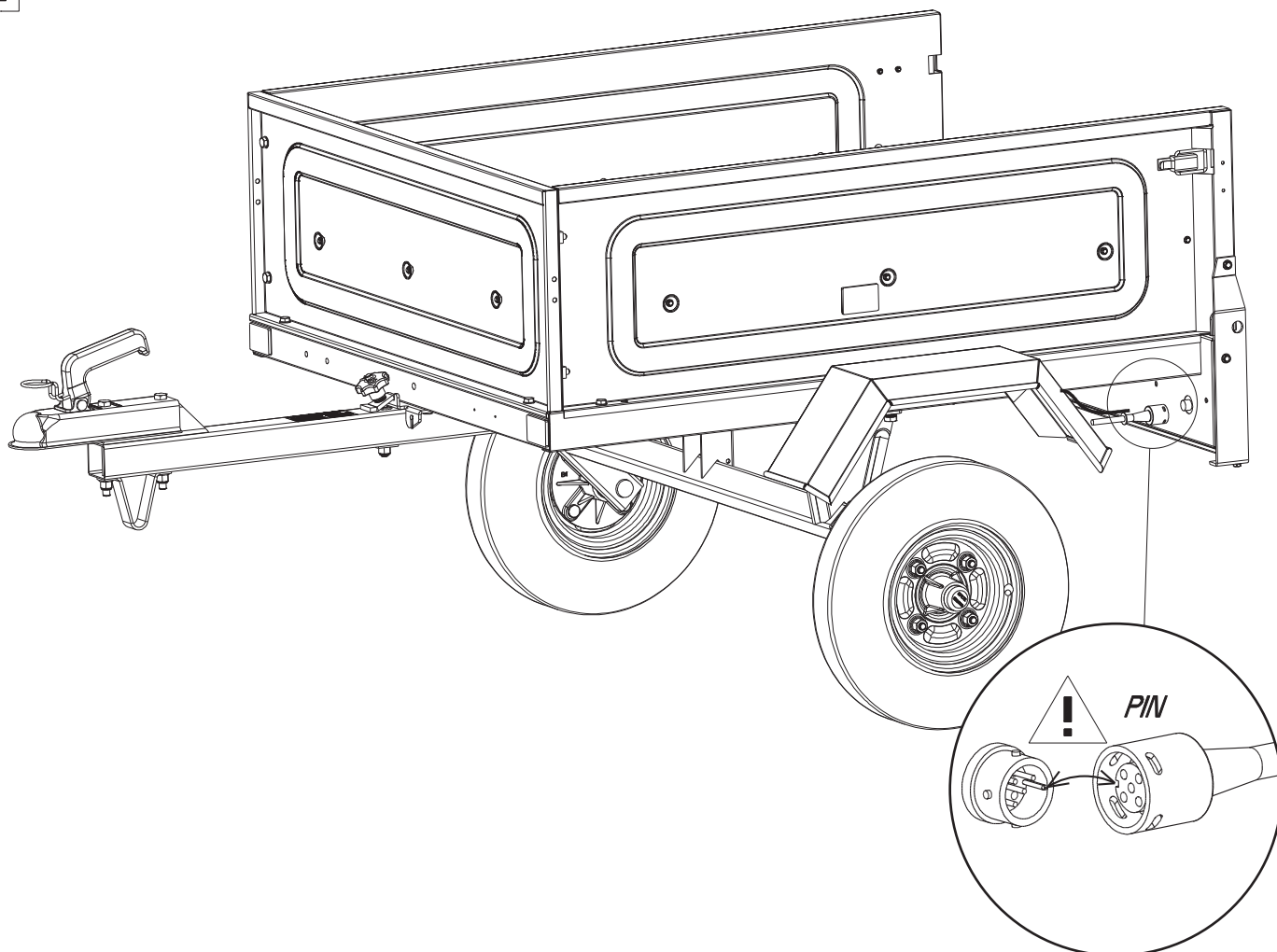

M

CLOSE AND SECURE TAILGATE THEN FULLY TIGHTEN ALL FIXINGS IN SECTIONS G-K

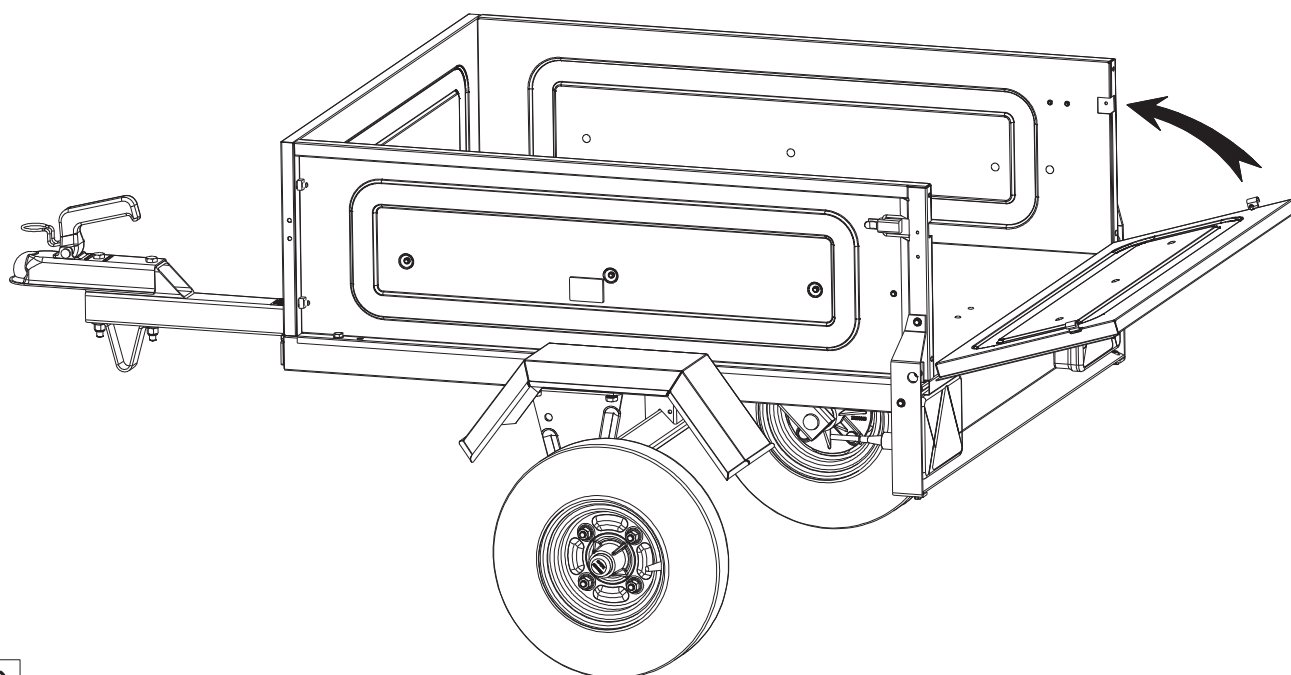

6/6

After assembly and again after the first 60 miles, check the tightness of all fixings on the opposite listed components:

- Wheels
- Axle
- Drawbar
- Coupling head
- Mudguards
- Lighting

Road trailers must be inspected prior to use to ensure they are of a road worthy condition; it is a legal requirement that all trailers are maintained and comply with all relevant regulations. While there is very little maintenance required on Erdé trailers, it is important that the unit should be checked at least annually by a competent person. Sealed bearings do not require lubrication but require frequent inspection for wear and should be replaced if worn or noisy.