



Petrol Walk Behind Vacuum & Blower

WEWBVAC

1938267001

en - Original Instructions

ASSEMBLY REQUIRED
Minimum Two Persons

Sales & Support: 01793 333212

Before use please read & understand this manual; paying particular attention to the safety instructions before use.

Incorrect use of the product could put the operator or machine in danger.

Whilst every effort has been made to ensure the accuracy of information contained in this manual, our policy of continuous improvement determines the right to make modifications without prior warning.

Images are used for illustration purposes only.



INSTRUCTION MANUAL



11 Sep 2020

Copyright Notice

Copyright © Handy Distribution

Permission is granted to reproduce this publication for personal & educational use only.

Commercial copying, redistribution, hiring or lending is prohibited.

No part of this publication may be stored in a retrieval system or transmitted in any other form or means without written permission from Handy Distribution.

In all cases this copyright notice must remain intact.

CONTENTS

INTENDED USE

SAFETY INSTRUCTIONS

SPECIFICATIONS

KNOW YOUR MACHINE

ASSEMBLY

ACCESSORIES

PRE-OPERATION

OPERATION

MAINTENANCE, CLEANING & STORAGE

TROUBLE SHOOTING

PARTS DIAGRAM & LIST

DECLARATION OF CONFORMITY

WARRANTY

INTENDED USE

The basic version of the equipment is a petrol walk behind vacuum & blower intended for private use, i.e. for use in home and gardening environments. It is designed to collect or blow garden debris in medium to large lawns.

The vacuum & blower is for private use, whose annual operating time generally does not exceed 50 hours. Public facilities, sporting halls, and agricultural / forestry applications are excluded.

Please read this entire manual prior to operating the equipment. It instructs you how to safely and easily set up, operate and maintain your machine. Please be sure that you, and any other persons who will operate the machine, carefully follow the recommended safety practices, at all times. Failure to do so could result in personal injury or property damage.

TO THE OWNER

All information in this manual is relative to the most recent product information available at the time of printing. Review this manual frequently to familiarise yourself with the machine, its features and operation. Please be aware that this Instruction Manual may cover a range of product specifications for various models. Characteristics and features discussed and/or illustrated in this manual may not be applicable or exact to all models.

We reserve the right to change product specifications, designs and equipment without notice and without incurring obligation. If you have any problems or questions concerning the machine, phone your local authorised service dealer or ourselves. Throughout this manual, all references to *right* and *left* side of the machine are observed from the operating position



WARNING



For safety reasons, the vacuum & blower may not be used as a drive unit for other equipment or toolkits of any kind, unless specifically advised to do so by the manufacturer. The equipment is to be used only for its prescribed purpose. Any other use is deemed to be a case of misuse. The user/operator and not the manufacturer will be liable for any damage or injuries of any kind caused as a result of this.

Please note that our equipment has not been designed for use in commercial, trade or industrial applications. Our warranty will be 90 days from the original date of sale for commercial, trade or industrial businesses or for equivalent purposes.

INSTRUCTION MANUAL

SAFETY INSTRUCTIONS

Read and understand the owner's manual and labels affixed to the machine. Learn its application and limitations as well as the specific potential hazards. Retain these instructions for future reference. The operator is responsible for following the warnings & instructions in this manual and on the product.

	Read & understand operator's manual before using the machine. Failure to follow instructions could result in death or serious injury. Please keep in a safe place for future reference.		Always wear safety eye and ear protection when operating this machine.
	DANGER Keep all bystanders & animals away from the machine during operation. If approached, stop the machine immediately.		Always wear gloves to protect your hands. Wear foot protection or sensible shoes when using the machine
	WARNING — CARBON MONOXIDE Never run an engine indoors or in a poorly ventilated area. Engine exhaust contains carbon monoxide, an odorless and deadly gas.		DANGER — THROWN DEBRIS Remove objects that can be thrown by the machine in any direction.
	DANGER — SLOPES Use extra caution on slopes. Do not trim on slopes greater than 15°.		Always remove the spark plug lead from the spark plug before performing any maintenance, inspection or repair.
	WARNING — PETROL IS FLAMMABLE Allow the engine to cool at least two minutes before refueling.		Do not expose to rain or damp conditions.
	No smoking		Do not use near a flame, or sparks
	WARNING— HOT SURFACE Engine parts, especially the muffler, become extremely hot during operation. Allow engine and muffler to cool before touching.		Moving Parts Rotating parts can contact or entangle hands, feet, hair, clothing or accessories. Traumatic amputation or severe laceration can result
	Keep guards in place and in working order. Replace damaged, missing or failed parts before using it.		Safety alert symbol. Used to alert you to potential personal injury hazards. Obey all safety messages that follow this symbol to avoid possible injury.
	Indicates an imminently hazardous situation which, if not avoided, will result in serious injury		Indicates a potentially hazardous situation which, if not avoided, could result in serious injury
	Indicates a potentially hazardous situation which, if not avoided, may result in minor or moderate injury.	CAUTION	Used without the safety alert symbol indicates a potentially hazardous situation which, if not avoided, may result in property damage.
	CE Marking - the product meets demand and regulations set by the EU		Noise Level 105dB - See label on machine for full details

GENERAL SAFETY RULES



WARNING

Before you put the machine into operation, you must read this instruction manual.

When using this machine, observe the following safety instructions to exclude the risk of personal injury or material damage. Please also observe the special safety instructions in the respective chapters. Where applicable, follow the legal directives or regulations for the prevention of accidents in relation to the use of this machine.

When using petrol tools, basic safety precautions, including the following, should always be followed to reduce the risk of serious personal injury and/or damage to the unit.

GENERAL OPERATION

1. Read this instruction manual carefully in its entirety before attempting to assemble this machine. Read, understand, and follow all instructions on the machine and in the manual(s) before operation. Keep this manual in a safe place for future and regular reference and for ordering replacement parts.
2. Be completely familiar with the controls and the proper use of this machine before operating it.
3. This machine is a precision piece of power equipment, not a plaything. Therefore, exercise extreme caution at all times. This machine has been designed to perform one job: to cut out moss and weeds from the root. Do not use it for any other purpose.
4. Never allow children under 16 years of age to operate this machine. Children 16 and over should read and understand the instructions and safe operation practices in this manual and on the machine and should be trained and always supervised by an adult.
5. Only responsible individuals who are familiar with these rules of safe operation should be allowed to use this machine.
6. Thoroughly inspect the area where the equipment is to be used. Remove all stones, sticks, wire, bones, toys and other foreign objects, which could be tripped over or picked up and thrown by the machine. Thrown objects can cause serious personal injury.
7. Plan your operating pattern to avoid discharge of material toward roads, pathways, bystanders and the like. Also, avoid discharging material against a wall or obstruction, which may cause discharged material to ricochet back toward the operator.
8. To help avoid tine contact or a thrown object injury, stay in operator zone behind handles and keep children, bystanders, helpers and pets at least 20 metres from machine while it is in operation. Stop machine if anyone enters area.
9. Always wear safety glasses or safety goggles during operation and while performing an adjustment or repair to protect your eyes. Thrown objects which ricochet can cause serious injury to the eyes.
10. Wear sturdy, rough-soled work shoes and close-fitting trousers and shirts. Shirts and trousers that cover the arms and legs and steel-toed shoes are recommended. Never operate this machine in bare feet, sandals, slippery or light-weight (e.g. canvas) shoes.
11. Do not put hands or feet near or under rotating parts. Always keep clear of discharge area, as the rotating tines can cause injury.
12. Never operate the machine without proper shields, guards, control lever or other safety protective devices in place and working.
13. Never operate the machine with damaged safety devices. Failure to do so, can result in personal injury.
14. Many injuries occur as a result of the tines being pulled over the foot during a fall caused by slipping or tripping. Do not hold on to the machine if you are falling; release the handle immediately.
15. Never pull the machine back towards you while you are walking. If you must back the machine away from a wall or obstruction, first look down and behind to avoid tripping and then follow these steps:
 - A. Step back from the machine to fully extend your arms.
 - B. Be sure you are well balanced with sure footing.
 - C. Pull the machine back slowly, no more than halfway towards you.
 - D. Repeat these steps as needed.



INSTRUCTION MANUAL

16. Do not operate the machine while under the influence of alcohol or drugs.
17. The OPC/Brake lever is a safety device. Never attempt to bypass its operation. Doing so makes the safety device inoperative and may result in personal injury. The OPC/Brake lever must operate easily in both directions and automatically return to the disengaged position when released.
18. Never operate the machine in wet grass. Always be sure of your footing. A slip and fall can cause serious personal injury. If you feel you are losing your footing, release the OPC/Brake lever immediately and the spindle will stop rotating within three seconds.
19. Operate only in daylight or good artificial light. Walk, never run.
20. Stop the engine when crossing gravel or stone areas.
21. If the machine starts to vibrate abnormally, stop the engine and check immediately for the cause. Vibration is generally a warning of trouble.
22. Shut the engine off and wait until the engine comes to a complete stop before cleaning the discharge area. Some components continue to rotate for a few seconds after the OPC/Brake lever is released. Never place any part of the body in the machine area until you are sure the machine has stopped, and the spark plug cap removed from the spark plug and contact cannot be made between the two.
23. Never operate the machine without proper shields, discharge cover, OPC/Brake lever or other safety protective devices in place and working. Never operate with damaged safety devices. Failure to do so can result in personal injury.
24. Muffler and engine can become hot and cause burns. Do not touch!
25. Only use parts and accessories made for this machine by the manufacturer. Failure to do so can result in personal injury.
26. When starting the engine, pull cord slowly until resistance is felt, then pull rapidly. Rapid retraction of starter cord (kickback) will pull hand and arm towards engine faster than you can let go. Broken bones, fractures, bruises or sprains could result.
27. If situations occur which are not covered in this manual, use care and good judgement. Contact your nearest Approved Service Dealer for assistance

SLOPE OPERATION

Slopes are a major factor related to slip and fall accidents, which can result in severe injury. Operation on slopes requires extra caution. If you feel uneasy on a slope, or it is greater than 15 degrees, do not scarify on it.

Do:

1. Scarify across the face of slopes; never up and down. Exercise extreme caution when changing direction on slopes.
2. Watch for holes, ruts, rocks, hidden objects, or bumps which can cause you to slip or trip. Tall grass can hide obstacles.
3. Always be sure of your footing. A slip and fall can cause serious personal injury. If you feel you are losing your balance, release the OPC/Brake lever immediately and the tines will stop rotating within three (3) seconds.

Do Not:

1. Do not operate near drop-offs, ditches or embankments, you could lose your footing or balance.
2. Do not operate on slopes greater than 15 degrees.
3. Do not operate on wet grass. Unstable footing could cause slipping.

CHILDREN

Tragic accidents can occur if the operator is not alert to the presence of children. Children are often attracted to the machine and the activity. They do not understand the dangers. Never assume that children will remain where you last saw them.

1. Keep children out of the scarifying area and under care of a responsible adult other than the operator.
2. Be alert and turn the machine off if a child enters the area.
3. Before and while moving backwards, look behind and down for small children.
4. Use extreme care when approaching blind corners, doorways, shrubs, trees, or other objects that may obscure your vision of a child who may run into the machine.
5. Keep children away from hot or running engines. They can suffer burns from a hot muffler.
6. Never allow children under 16 years of age to operate this machine. Children 16 and over should read and understand the instructions and safe operation practices in this manual and on the machine and be trained and supervised by an adult.

SERVICE

Safe Handling of Petrol:

1. To avoid personal injury or property damage use extreme care in handling petrol. Petrol is extremely flammable, and the vapors are explosive. Serious personal injury can occur when petrol is spilled on yourself or your clothes, which can ignite. Wash your skin and change clothes immediately.
2. Use only an approved petrol container.
3. Never fill containers inside a vehicle or on a truck or trailer bed with a plastic liner. Always place containers on the ground away from your vehicle before filling.
4. Remove petrol-powered equipment from the truck or trailer and refuel it on the ground. If this is not possible, then refuel such equipment on a trailer with a portable container, rather than from a petrol dispenser nozzle.
5. Keep the nozzle in contact with the rim of the fuel tank or container opening at all times until fueling is complete. Do not use a nozzle lock-open device.
6. Extinguish all cigarettes, cigars, pipes and other sources of ignition.
7. Never fuel machines indoors because flammable vapors will accumulate in the area.
8. Never remove petrol cap or add fuel while engine is hot or running. Allow engine to cool at least two minutes before refueling.
9. Never over fill fuel tank. Fill tank up to 80% capacity to allow for expansion.
10. Replace petrol cap and tighten securely.
11. If petrol is spilled, wipe it off the engine and equipment. Move machine to another area. Wait 5 minutes before starting engine.
12. Never store the machine or fuel container near an open flame, spark or pilot light on petrol appliances.
13. To reduce fire hazard, keep machine free of grass, leaves, or other debris build-up. Clean up oil or fuel spillage and remove any fuel-soaked debris.
14. Allow machine to cool at least 5 minutes after use, before storing.

General Service:

1. Never run an engine indoors or in a poorly ventilated area. Engine exhaust contains carbon monoxide, an odorless and deadly gas.
2. Before cleaning, repairing, or inspecting, make certain the tines and all moving parts have stopped. Disconnect the spark plug wire and ground against the engine to prevent unintended starting.
3. Check the machine and engine mounting bolts at frequent intervals for proper tightness. Also, visually inspect for damage. Replace with the original equipment manufacturer's (O.E.M.) parts only, listed in this manual. "Use of parts which do not meet the original equipment specifications may lead to improper performance and compromise safety!"
4. Keep all nuts, bolts, and screws tight to be sure the equipment is in safe working condition.
5. Never tamper with safety devices. Check the correct operation regularly.
6. After striking or vacuuming a foreign object, stop the engine, disconnect the spark plug wire and ground against the engine. Thoroughly inspect the machine for any damage. Repair the damage before starting and operating the machine.
7. Machine components, guards and shields are subject to wear and damage which could expose moving parts or allow objects to be thrown. For safety protection, frequently check components and replace immediately with original equipment manufacturers (O.E.M.) parts only, listed in this manual. "Use of parts which do not meet the original equipment specifications may lead to improper performance and compromise safety!"
8. Do not change the engine's governor setting or over-speed the engine. The governor controls the maximum safe operating speed of the engine.
9. Check fuel line, tank, cap, and fittings frequently for cracks or leaks. Replace if necessary.
10. Do not crank engine with spark plug removed.
11. Maintain or replace safety and instruction labels, as necessary.
12. Observe proper disposal laws and regulations. Improper disposal of fluids and materials can harm the environment.

DO NOT MODIFY THE ENGINE

To avoid serious injury or death, do not modify the engine in any way. Tampering with the governor setting can lead to a runaway engine and cause it to operate at unsafe speeds. Never tamper with factory setting of engine governor. Please refer to the Briggs & Stratton engine manual, before undertaken any inspection, repair or maintenance.



INSTRUCTION MANUAL

PERSONAL SAFETY

1. This machine is not intended for use by persons (including children) with reduced physical, sensory or mental capabilities, or lack of experience and knowledge, unless they have been given supervision or instruction concerning use of the machine by a person responsible for their safety.
2. Children should be supervised to ensure that they do not use or play with the machine.
3. Stay alert, watch what you are doing and use common sense when operating this machine.
4. Do not use this machine while you are tired, ill or under the influence of drugs, alcohol, or medication. A moment of inattention while operating this machine can cause you to lose control & may result in serious personal injury.
5. Use safety equipment. Always wear eye protection. Safety equipment such as a dust mask, non-skid safety shoes, hard hat, or hearing protection used for appropriate condition will reduce personal injuries.
6. Dress properly. Do not wear loose clothing or jewellery. Keep your hair, clothing & gloves away from moving parts and vacuuming inlet. Loose clothes, jewellery or long hair can be caught in moving parts or the vacuum inlet.
7. Prolonged use of the machine may lead to disorders of blood circulation in hands caused by vibration. These effects can be worsened by low ambient temperatures and/or by gripping the handgrips excessively tightly. Period of use you can extend with appropriate gloves or regular breaks. Take frequent work breaks. Limit the amount of exposure per day.

SPECIFICATIONS

Model No.	WEWBVAC
Product No.	1938267001
Engine	B&S 500e
Engine Power	2.03 kW
Engine No-Load Speed	3400 r/min
Engine Displacement	140 cm ³
Fuel Capacity	0.8 L
Oil Capacity	0.47 L
Self-Propelled Speed	3.4 km/h
Working Width	58 cm (23")
Collector Capacity	150 L
Suction Height	15-60 mm
Max Air Speed	270 km/h (167 mph)
Max Air Volume	18m ³ /Min
Recommended Spark Plug	Refer to B&S engine manual
Measured Sound Power Level L _{WA} :	105 dB(A)
Vibration Level:	4.2 m/s ²
Weight:	Net 38 kg - Gross 41 kg

The manufacturer reserves the right to change the product specification and livery according to continued product improvements.



KNOW YOUR MACHINE

1. Collection Bag Fixing Bracket	2. Collection Bag
3. Cleaning Brush (Not Included - Accessory WEWBVACBRUSH)	4. Scarifier (Not Included - Accessory WEWBVACSCAR)
5. Auxiliary Hose with Baffle Board (Not Included - Accessory WEWBVACHOSE)	6. OPC/Brake Lever
7. Self-Propelled Lever	8. Guide Wheels

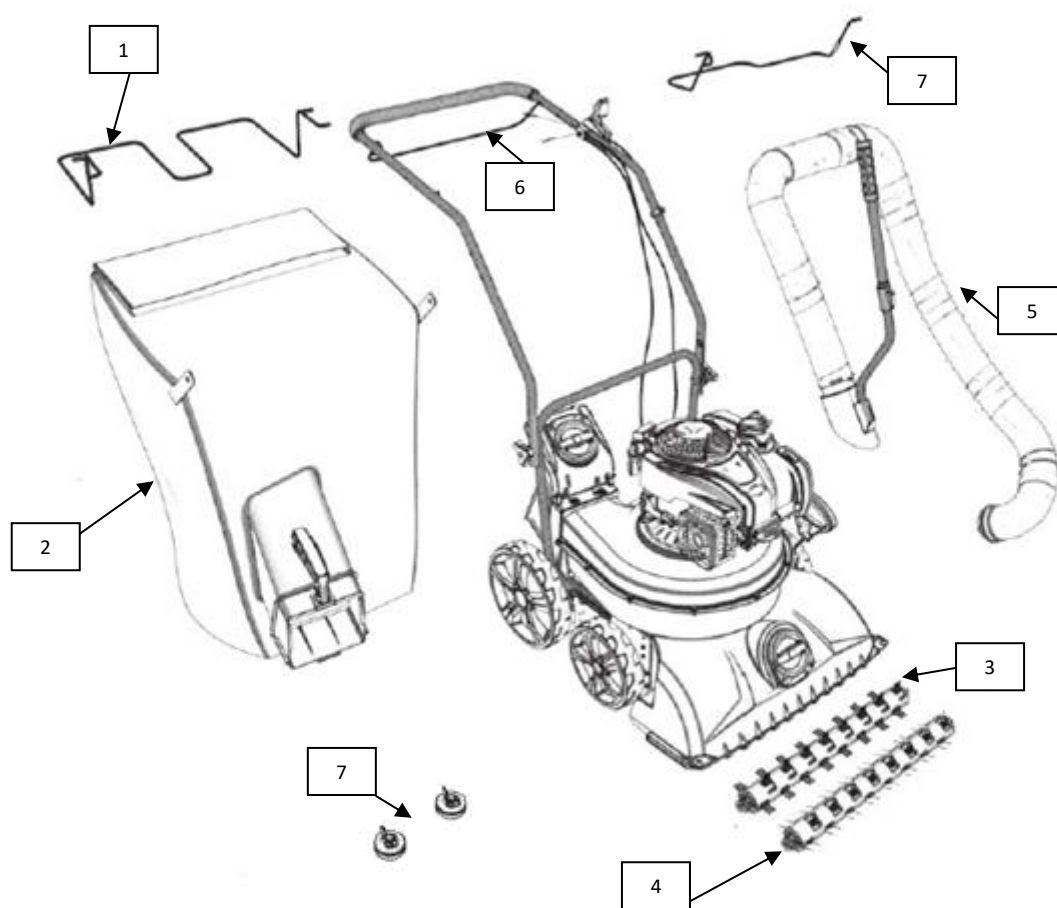

* Image may vary from actual machine



INSTRUCTION MANUAL

ASSEMBLY

Remove the machine and contents from the carton. Be sure the carton is empty before discarding.

If you require assistance with regards to the contents or operation of the machine, please contact us:

Tel: 01793 333212

Email: customerservice@webbgardenpower.co.uk

Opening hours weekdays: February to October 8:30am - 5:30pm / November to January 8:30am - 5:00pm
(Closed Bank Holidays)

IMPORTANT INFORMATION

NOTE: This product is a 4-stroke engine powered machine. It cannot be used immediately after it has been removed from the carton. Assembly is required and **THE ENGINE IS SHIPPED WITHOUT PETROL OR OIL.** You **MUST** fill with the engine with recommended 4-stroke SAE30 or 10W/30 air cooled lawnmower engine oil **BEFORE** starting. Please follow the steps in the Briggs & Stratton engine manual on filling the engine. Fresh (Under 30 days old from the date of purchase) unleaded petrol must be used in this unit. **DO NOT** use Ethanol based fuels. **DO NOT** mix oil with fuel.



WARNING

Stop the engine and unplug the spark plug before any repairs or maintenance operations.

DO NOT attempt to start this machine without it first being **FULLY** assembled.

DO NOT attempt to start this mower without first adding 4-stroke SAE30 or 10W/30 air cooled lawnmower engine oil to the engine.

SELF-PROPELLED & ROLLER LEVERS

1. Insert the cable Z-head into the roller drive lever. (fig a-1)
2. Insert the roller drive lever into the left and right fixing holes of the upper handle (fig. a-2)
3. Insert the self-propelled cable into the self-propelled lever. (fig. a-3)

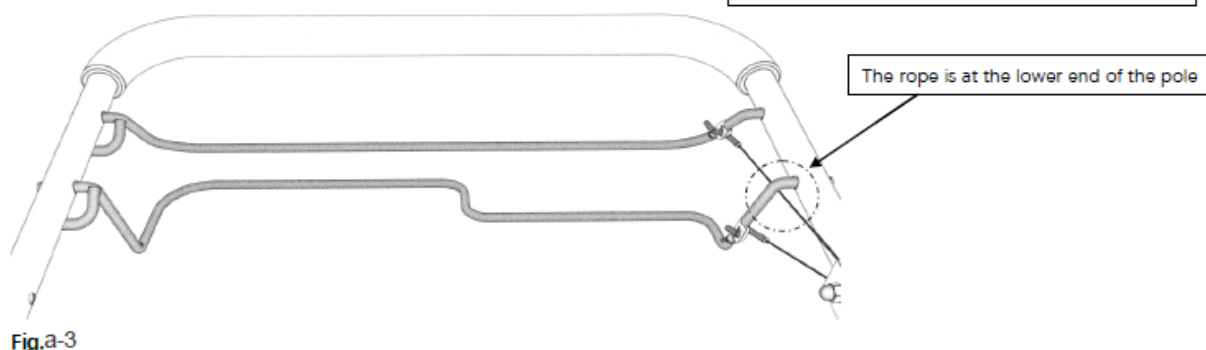
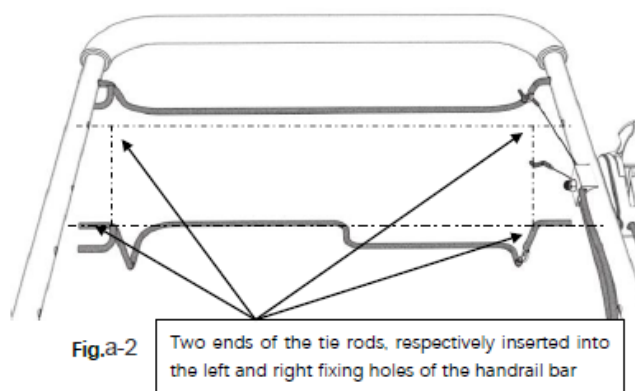
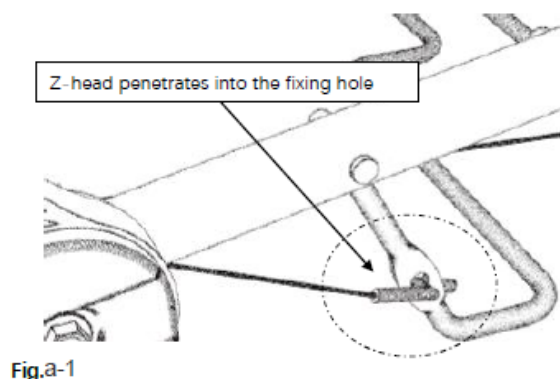

UPPER HANDLE

1. Place the upper handle onto the outside of the lower handle and line up the fixing hole of both handles.
2. Secure with the 2x upper handle bolts M8x46 and 2x M8 wing knobs. The wing knobs should sit on the outside of the handle assembly. Tighten until finger tight. (fig. 7-1)

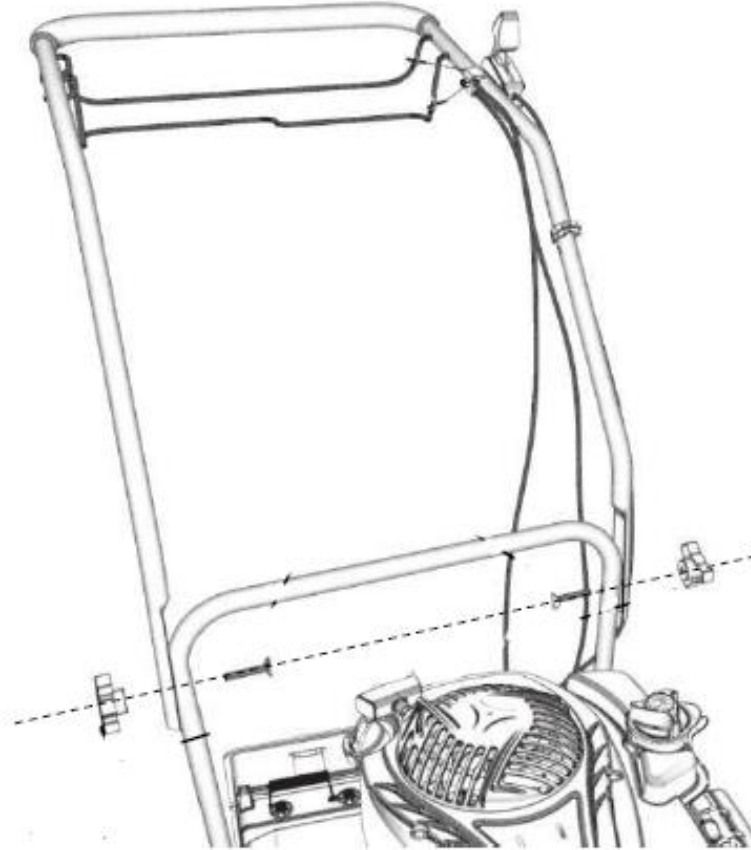

Fig.7-1

COLLECTION BAG BRACKET

1. Insert the left and right ends of the collection bag bracket into the 4x fixing holes of the upper handle.

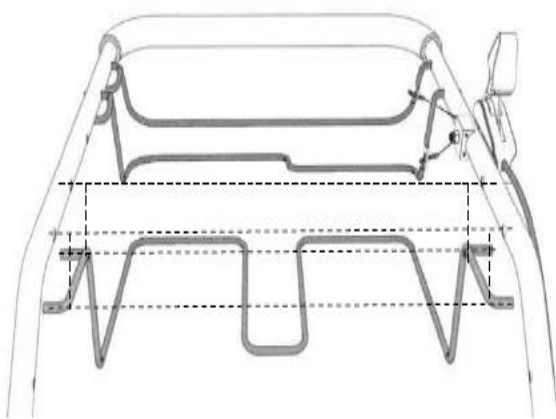

Fig.8-1

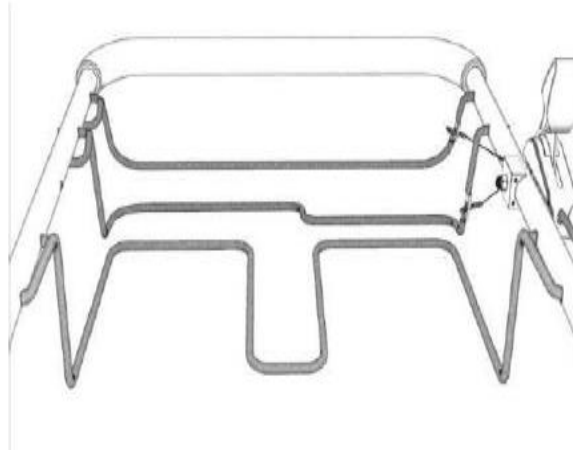

Fig.8-2



INSTRUCTION MANUAL

HOSE BRACKET

1. Insert the left and right ends of the hose bracket into the fixing holes of the upper handle.

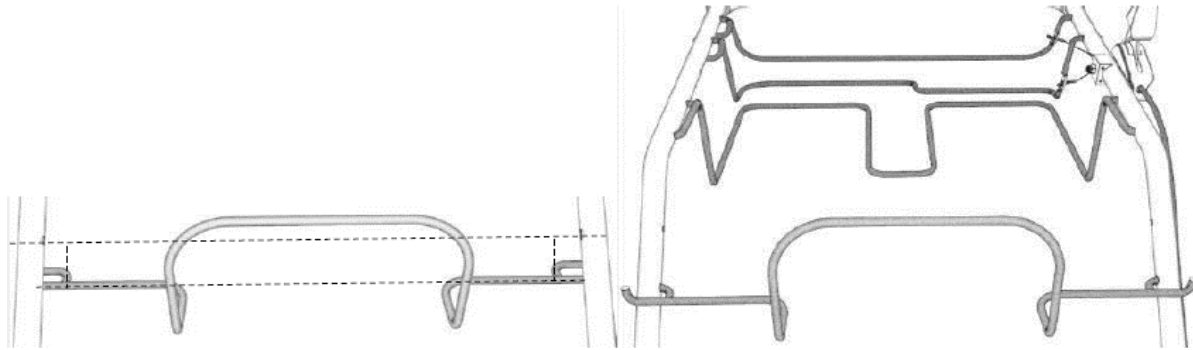

COLLECTION BAG

Important: Before you attach the collector, please ensure that the engine is switched off any accessory cassette fitted are not rotating.

1. Put the upper section of the collection bag onto the collection bag bracket. Secure by wrapping the plastic hooks over the bracket. (fig. 10-1 & 10-2)
2. Hang the left and right hanging plates on the end of the hose bracket. (fig. 10-3 & 10-4)
3. Press the baffle located under the hose inlet and open the rear cover. (fig. 10-5).
4. Insert the collection bag inlet into the rear cover (fig. 10-6).

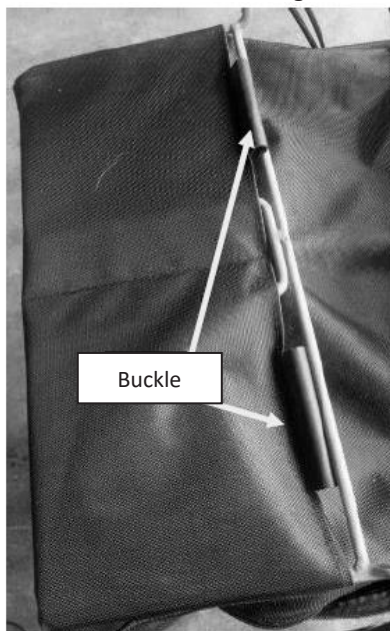

Fig.10-1 Nested into the collection bag



Fig.10-2

Fastening Card strip



Fig.10-3 Assembly hanging board



Fig.10-4



Fig.10-5 Press the baffle and open the rear cover



Fig.10-6 Insert back cover bracket



Fig.10-7 Insert in place



Fig.10-8 Installation completion diagram



INSTRUCTION MANUAL

GUIDE WHEELS

The guide wheels are fitted to the front corners of the suction housing. Fit in the following order:

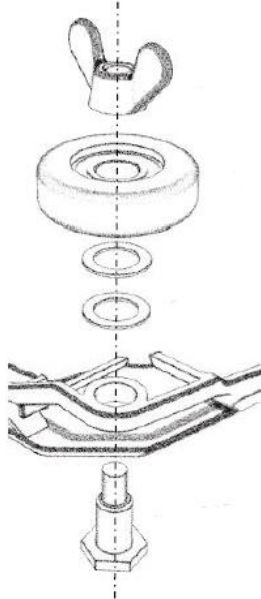

ACCESSORIES

BRUSH OR SCARIFIER - MINIMUM TWO ADULT ACTION

The equipment can be assembled with the Dethatching (blades) or Scarifying (Spring Tines) cylinders. Only replace the cylinder with an original Webb product, to ensure top performance & safety. To change the cylinder, proceed as follows. We recommend this is undertaken by a minimum of two adults and that suitable hard-wearing gloves are worn at all times.



WARNING

When changing the cassette, ensure suitable hard-wearing gloves are worn at all times



CAUTION

Only use genuine cassettes with this machine.

1. Tip the machine backwards.
2. Pull the quick release trigger and open the quick release cover.
3. Align the square end of the accessory cassette into the square housing of the machine.
4. Insert the bearing end of the accessory cassette into the quick release bracket bearing mounting position.
5. Pull the quick release trigger and fasten the upper cover.



WARNING

Before Installing, it is necessary to turn the engine off.

The quick release cover must be snapped into place. Pull the roller firmly without pulling the trigger. Please check if the cassette will fall out.

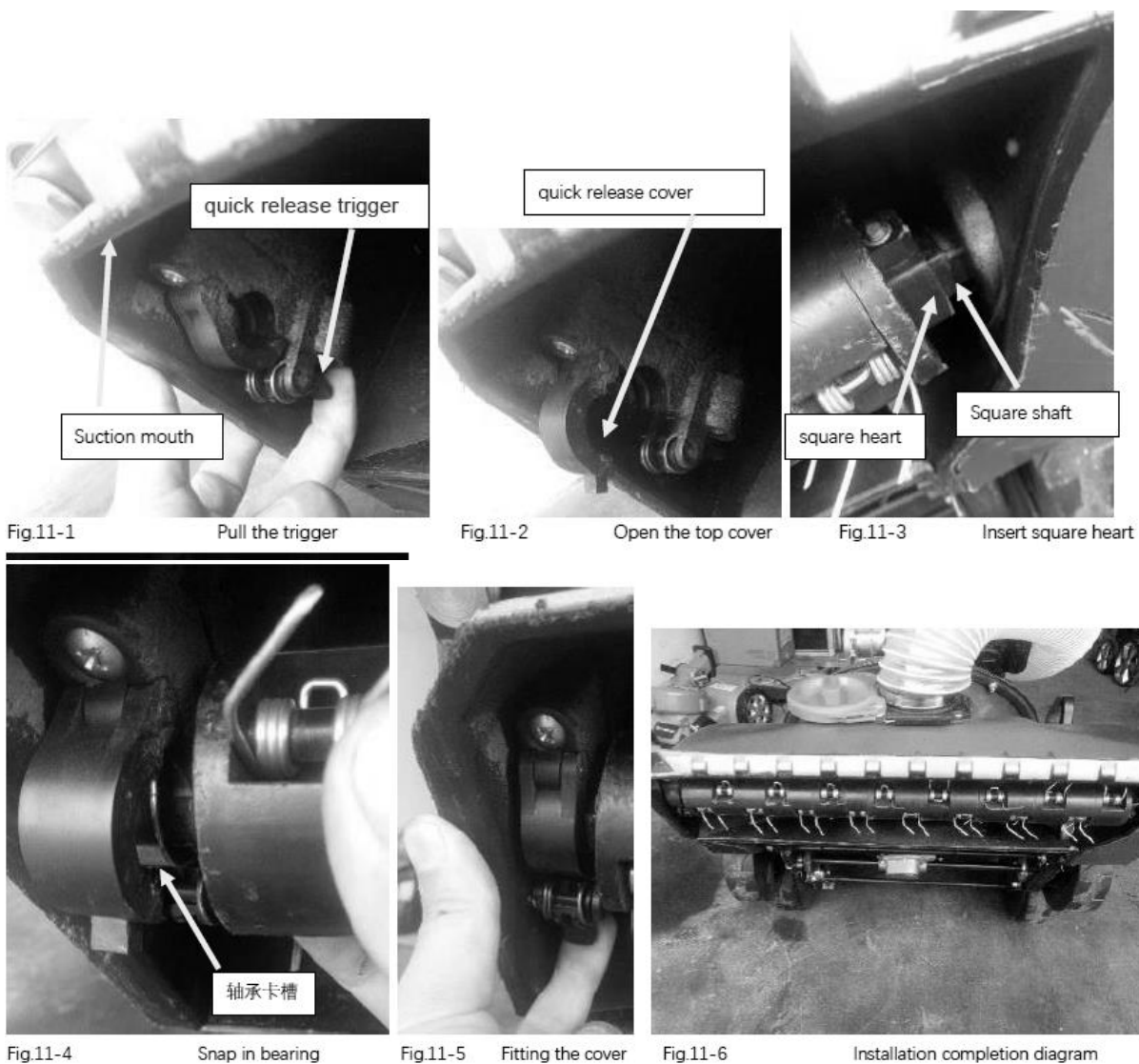

HOSE & BAFFLE PLATE

1. Open the front hose cover.
2. Align the end of the hose connector with the front hose inlet.
3. Insert the hose connector.
4. Rotate the hose connector clockwise to lock.
5. Insert the suction inlet baffle to block the inlet and provide full suction power to the hose.

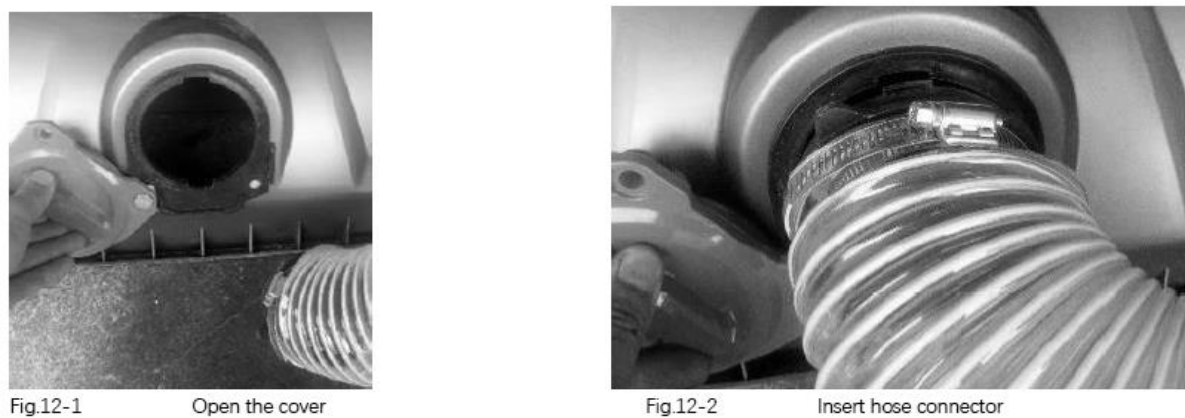



INSTRUCTION MANUAL



Fig.12-3 Screw the interface



Fig.12-4 Complete the installation diagram



PRE-OPERATION

FUEL & OIL



WARNING

YOUR MACHINE IS SUPPLIED WITHOUT ENGINE OIL OR UNLEADED PETROL

Operating the engine with insufficient oil can have catastrophic consequences. Any failure caused by insufficient oil, will not be covered by the manufacturer's warranty.

Read instructions carefully.



Fuel & its vapors are very flammable. Do not use or fuel the machine near a flame, sparks or while smoking. Allow the engine to cool for more than 3 minutes, before re-fueling. Never fuel the machine with the engine running. Fuel the engine at least 15 metres away from your work area. Always fuel your machine outdoors.

IMPORTANT:

Fuel which is older than 30 days old can become stale and cause acid & gum deposits in the fuel system or essential carburettor components. This could result in starting issues which would not be covered by the manufacturer's warranty.

Ensure that any stored petrol is clearly marked in a separate appropriate canister for a maximum of 30 days if not mixed with a fuel additive. If the machine is not going to be used for a long period, drain the petrol from the fuel tank, start the engine and drain the carburetor of any remaining fuel.

To keep fuel fresh, refer to instructions from the engine manual supplied with this machine. A fuel additive which you add to your fuel, can help make your machine easier to start, extend the shelf life of your fuel for up to two years, keeping the carburettor & engine clean, plus reducing emissions and increasing fuel economy.

ADD FUEL & OIL

IMPORTANT:

Oil and fuel specifications and levels are referred to in the Briggs & Stratton engine manual supplied with this machine. Do not attempt to use the machine if you are missing the Briggs & Stratton engine manual, please contact us.



INSTRUCTION MANUAL

OPERATION

IMPORTANT:

The engine does not come with oil in it. Therefore, be sure to add oil before starting the engine. The oil level in the engine must be checked each time before operating.

IMPORTANT:

Before starting, please check if the accessories used are attached correctly.

STARTING THE ENGINE - COLD

1. Check the engine oil. See **Check Oil Level** section within engine manual.
2. Make sure the rocker arm microswitch is in the closed position. This is located at the rear, towards the bottom of the machine.

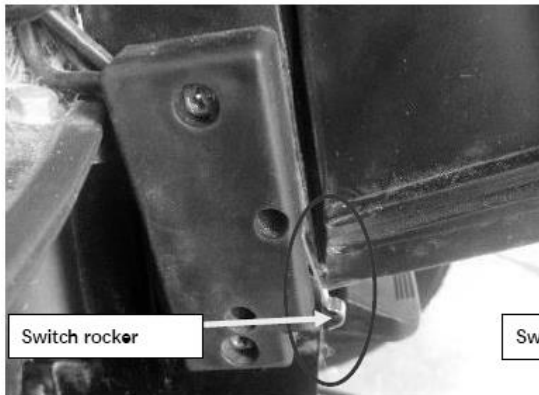

Fig.14-1 Switch rocker - Open state

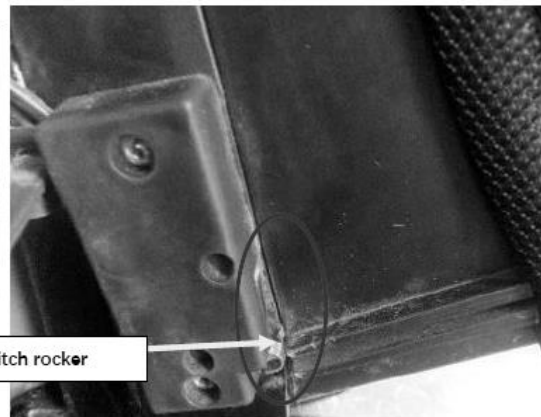

Fig.14-2 Switch rocker - Closed state

3. Move the throttle lever to the engine start position.



Fig.15-1 Throttle handle- Engine stop

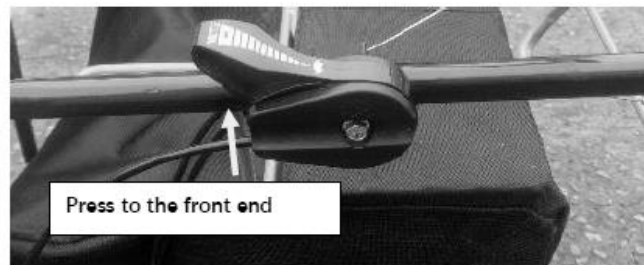

Fig.15-2 Throttle handle- Engine start

4. Press the Red engine primer bulb 3-5 times.



5. Grab the recoil starter handle and pull lightly until resistance is felt, then pull rapidly.

NOTE: Before you pull the recoil starter handle, please be aware of your surroundings.



6. Allow the engine to warm up briefly and then adjust the throttle lever accordingly.

STARTING THE ENGINE - WARM

1. Check the engine oil. See **Check Oil Level** section within engine manual.
2. Make sure the rocker arm microswitch is in the closed position.
3. Move the throttle lever to the engine start position.
4. Grab the recoil starter handle and pull lightly until resistance is felt, then pull rapidly.

NOTE: Before you pull the recoil starter handle, please be aware of your surroundings.

5. Allow the engine to warm up briefly and then adjust the throttle lever accordingly.

CAUTION

Do not allow the starter grip to snap back against the engine. Return it gently to prevent damage to the starter.



WARNING

**Accessory cassettes begin to rotate as soon as the engine is started.
Never open the collector flap when the engine is running. A rotating cutting unit can cause injuries.**



INSTRUCTION MANUAL

STOPPING THE ENGINE

1. Move the throttle to the stop position



IMPORTANT:

Any accessory cassette fitted will rotate for a few seconds after the motor is switched off. Never attempt to stop the cassette yourself. In the event that the cassette strikes an object, immediately switch off the machine and wait for the cassette to come to a complete stop. Inspect the condition of the cassette. Replace any parts that are damaged.

HEIGHT ADJUSTMENT

Turn the engine off, prior to making any height adjustment.

1. The height adjustment handle is located on the left hand side of the machine, as you stand in the operating position.
2. Pull the height adjustment handle away from the deck and move up or down to relocate in your chosen operating height.
3. Select according to the area and it's surroundings.

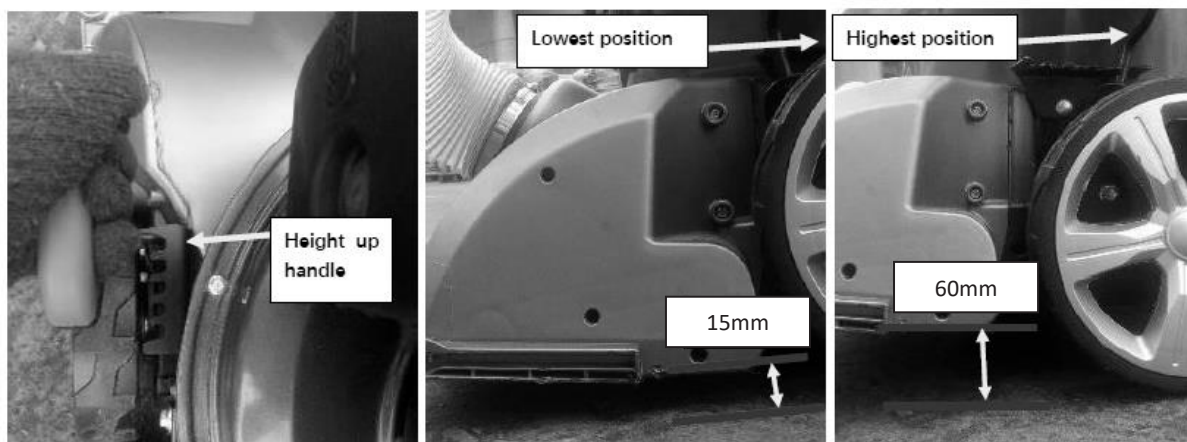

GUIDE WHEEL

1. During Normal speed (3.4km/h). Impact at an angle of less than 45 degrees and to fixed hard objects.
2. The guide wheel will rub against a hard object, causing the direction of travel to change. Thereby avoiding the hard object and preventing the machine from being damaged.

NOTE: Do not exceed the normal self-propelled speed and an impact angle of less than 45 degrees. Such operation will cause the guide wheel to lose its function and the suction inlet to be damaged.

NOTE: This function is an auxiliary function that protects the suction inlet against accidental damage. DO NOT intentionally test its strength. Concentrate on operating the machine, slow down in advance and change direction to avoid hard objects.

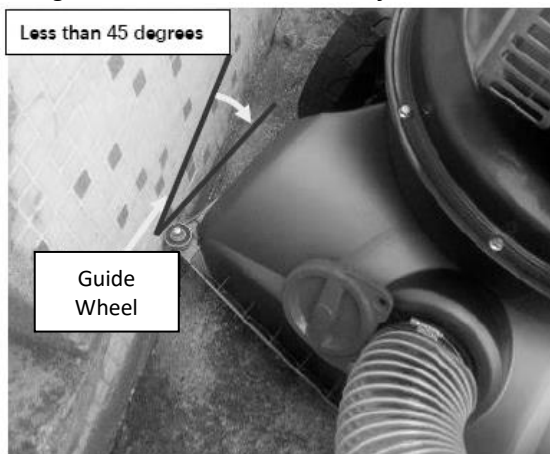

HOSE & BAFFLE

1. The engine is off.
2. Assemble the hose and baffle to the machine, following the instructions from the Accessories section of this instruction manual.
3. Start the machine. Point the end of the hose to the debris to be collected.

NOTE: When fitting or removing the hose and baffle, ensure the engine is off.

NOTE: The suction inlet baffle can only be used with the hose is fitted and in use.





INSTRUCTION MANUAL

HOSE TELESCOPIC HANDLE

1. Telescopic handle of the hose can be adjusted for different handle heights.
2. Push the lock pin in with your thumb, adjusting the height of the handle, up or down to the required height.



HOSE BLOWER

The accessory hose can be fitted to the machine, to enable leaves and debris to be blown to a safe vacuum area.

1. Separate the collection bag from the rear baffle.
2. Ensure the rear baffle is in the closed position.



3. Make sure the rocker arm microswitch is in the closed position. This is located at the rear, towards the bottom of the machine.



4. Open the rear hose cover.
5. Align the end of the hose connector with the rear hose inlet.
6. Insert the hose connector.
7. Rotate the hose connector clockwise, to lock.



NOTE: Please understand the parameters of the hose before use.

NOTE: When working, try to straighten the hose and work it to ensure maximum suction and wind speed.

NOTE: It is strictly forbidden to point the hose to others or any non-working area during work.

NOTE: It is strictly forbidden to load and unload the hose interface when the engine is running and machine started.

NOTE: Do not pull the hose to move the machine forward or backward.

NOTE: Do not align the hose head with liquids, fire, and hazardous gases.

NOTE: Do not pick up the debris which is larger than the hose opening.

NOTE: When the hose is blocked, stop the machine and clear the obstruction.

NOTE: Keep the hose away from the engine and muffler.



INSTRUCTION MANUAL

BRUSH OR SCARIFIER CASSETTE

SCARIFIER - Only to be used on the lawn!

The cassette rotates and combs the lawn or aerates the slightly mossy areas. The removed moss is conveyed into the collector. During aeration the surface of the ground is scratched; this improves water drainage and facilitates the absorption of oxygen. We recommend scarifying the lawn during the entire growing period as and when required.

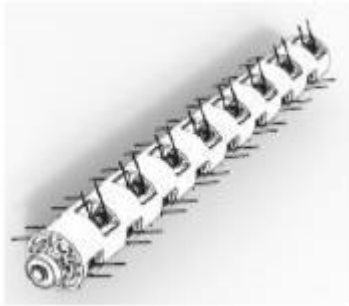

BRUSH - When you encounter rubbish, wet leaves etc stuck on the ground and difficult to handle, use the brush cassette. This does not damage the ground. Not to be used for collecting stones, metal cans, plastic, wire and other debris which may damage the machine or engine.

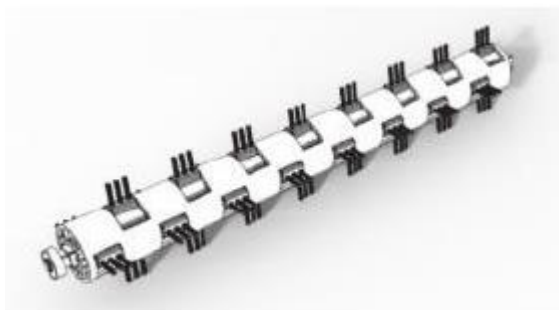

Be sure the working area is clear of stones, sticks, wire, or other objects which could damage the machine or engine. Such objects could be accidentally thrown by the machine or accessory cassette in any direction and cause serious personal injury to the operator and others.

Always ensure that a safe distance (provided by the handles) is maintained between the user and the housing. Be especially careful when scarifying and changing direction on slopes and inclines. Maintain a solid footing and wear sturdy, non-slip footwear and long trousers.

Do not work on excessively steep slopes, a maximum slope of 15 degrees is recommended. If a slope is difficult to stand on, do not work. Do not trim on slopes when the ground is slippery or wet. Work across the face of a slope, not up and down. Use special caution when backing up and pulling the machine backwards (tripping hazard)!



WARNING

The operation of any accessory cassette can result in foreign objects being thrown into eyes, which can cause severe damage. Always wear safety glasses or goggles while operating the accessory cassette, or while performing any adjustments or repairs on it.

Shut the engine off and wait until the accessory cassette comes to a complete stop before cleaning the discharge area. The accessory cassette continues to rotate for a few seconds after throttle lever is moved to the Stop position.



CAUTION

While operating the scarifier cassette, do not allow the tines to contact concrete, tarmac or gravel surfaces. Doing so will result in premature wear.

ACCESSORY CASSETTE ROTATION

1. Please assemble the accessory cassette, according to the Accessories section of this manual.
2. After starting the engine, pull the roller lever up to the top handle.

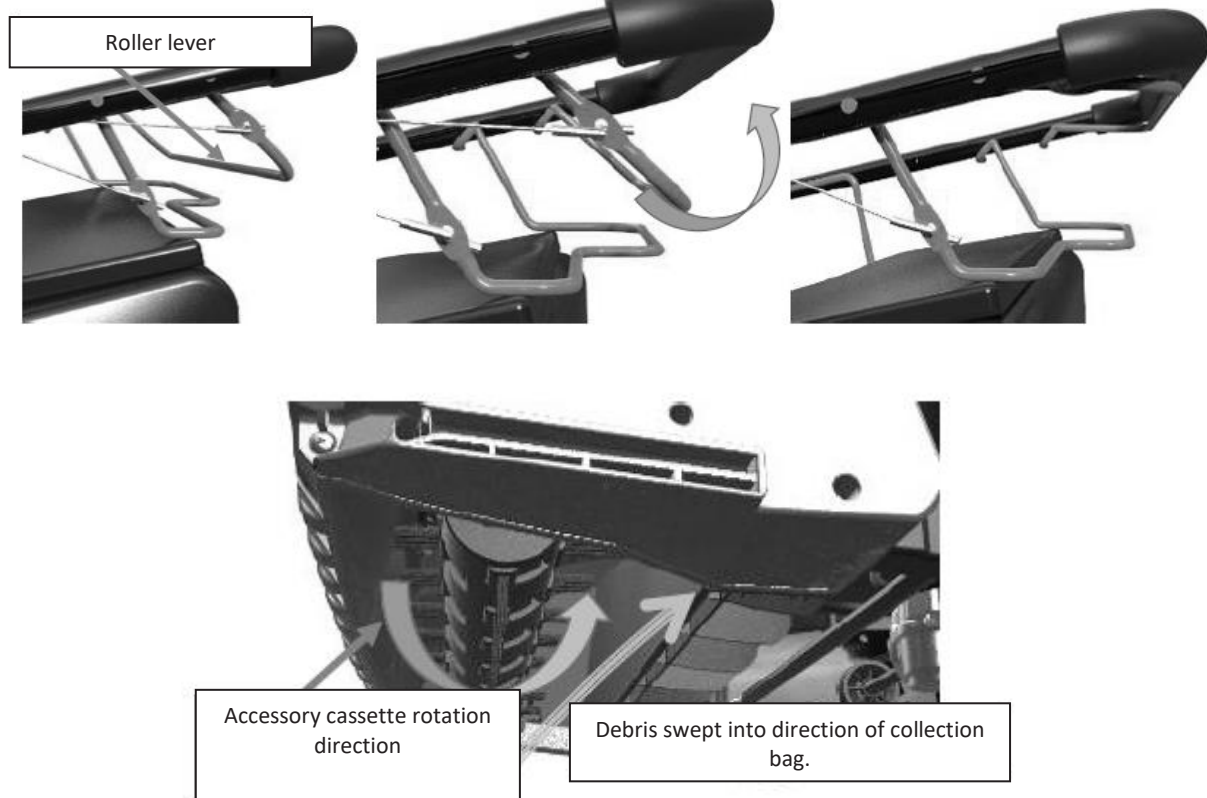

SELF-PROPELLED

1. After starting the machine, pull the roller lever up to the top handle.
2. Then pull the self-propelled lever up to the top handle.
3. The rear wheels should rotate, propelling the machine forwards.



COLLECTION BAG

1. Assemble the collection bag, as per the Assembly section of this Instruction Manual.
2. During machine use, the debris collected by the machine may cause the venting holes of the collection bag to become blocked or cause the air to return when the collection bag is full. Should this occur, open the side vent zip's of the collection bag to allow ventilation and also check if the bag is full.

INSTRUCTION MANUAL

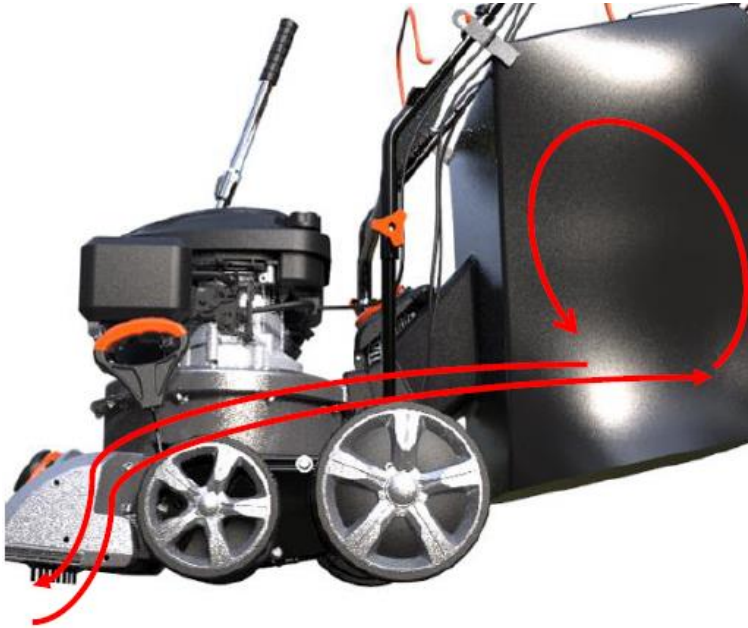

Fig.36-2 Open zipper



3. When the collection bag is full, stop the machine, remove the collection bag and empty the debris to a controlled area.



COLLECTION BAG PRECAUTIONS

NOTE: When encountering backflow, please check:

1. if the venting hole of the collecting bag is blocked.
2. Whether the collection bag is full.
3. Stop the machine and check if the collection bag interface is blocked.

NOTE: When loading and unloading the collection bag, please make sure the machine has been turned off.

NOTE: Before starting the machine, please ensure the collection bag is closed.

NOTE: It is strictly forbidden to open the collection bag when the machine is working.

NOTE: When cleaning the collection bag, do not tap the collection bag with a tool.

TRANSPORT

When moving the machine to and from the work area, always ensure the engine is turned off and the height adjustment lever is placed in the highest cutting height to ensure the accessory cassette is not in contact with the ground.

MAINTENANCE, CLEANING & STORAGE



WARNING

Improper maintenance & storage of the machine may void your warranty. Keep the machine clean for better and safer performance.

Turn off the engine before performing any maintenance. If the engine must be run, make sure the area is well ventilated. The exhaust emits dangerous carbon monoxide gases.

MAINTENANCE

General Recommendations

1. Always observe safety rules when performing any maintenance.
2. The manufacturers warranty does not cover items that have been subjected to operator abuse or negligence. To receive full value from the warranty, the operator must maintain the machine as instructed.
3. Changing of the engine-governed speed will void engine warranty.
4. All adjustments should be checked at least once each season.



WARNING

Always stop engine, disconnect spark plug, and ground the spark plug cap against the engine before performing any type of maintenance on your machine.

Lubrication

1. Lubricate pivot points on the levers at least once a season with general maintenance spray. This control must operate freely in both directions.
2. Lubricate the wheel ball bearings, shafts, drive cogs and pins once a year with multi-purpose grease.
3. All engine lubrication information, will be available in the engine separate engine manual supplied with your machine.

Check/Add Oil - (Always refer to the Briggs & Stratton Engine Manual)

1. Remove the dipstick and wipe with a clean cloth.
2. Insert the dipstick into the filler neck without screwing it in.
3. Remove the dipstick and check the oil level. The oil level should be in between the MIN. and MAX. levels on the dipstick.
4. If low, add oil slowly into the engine oil fill tube (the use of a funnel will aid the filling). Do not overfill. After adding oil wait one minute and then recheck the oil level.
5. Replace and tighten the dipstick.



INSTRUCTION MANUAL



Air Filter - (Always refer to the Briggs & Stratton Engine Manual)

Under normal conditions, please maintain the air filter in accordance with the engine manufacturer engine manual; clean it every few hours under extremely dusty conditions.

When the engine is not performing well or after being invaded by water, the air filter and carburettor should normally be repaired.

To service the air filter, refer to the engine manual supplied with the unit.

Spark Plug - (Always refer to the Briggs & Stratton Engine Manual)

To ensure proper engine operation, the spark plug must be properly gapped and free of deposits.

1. Remove the spark plug cap.



WARNING

If the engine has been running, the exhaust (muffler) will be very hot. Be careful not to touch the exhaust (muffler).

2. Visually inspect the spark plug. Discard it if the insulator is cracked or chipped.
3. Measure the spark plug gap with a feeler gauge. The gap should be 0.76, correct as necessary by bending the side electrode.
4. Attach the plug washer, thread the plug in by hand to prevent cross-threading.
5. When mounting a new spark plug, you should screw 1/2 more thread with the wrench after the washer is compressed. If you are mounting an old one, you should only screw 1/8-1/4 more thread.



CAUTION

The spark plug must be securely tightened. An improperly tightened plug can become very hot and possibly damage the engine. Never use a spark plug with an improper heat range.

CLEANING

Engine Care - (Always refer to the Briggs & Stratton Engine Manual)

Clean the engine regularly with a cloth or brush. Keep the top of the engine clean to permit proper air circulation. Remove all grass, dirt and debris from the exhaust (muffler) area.



CAUTION

Do not use a water hose or pressure washer to clean the engine. Water can damage the engine or contaminate the fuel system.

1. Engines stored for over 30 days need to have the fuel drain from the fuel tank or a fuel stabilizer applied to prevent deterioration and gum forming in the fuel system or essential carburetor parts.

Deck Care

Clean underside of the machine after each use to prevent build-up of debris. Follow steps below:

1. Disconnect the spark plug cap. Drain petrol from the engine with a suction pump. Alternatively, tip the machine so that it rests on its side. Keep the side with the air filter housing facing up. Drain all fuel from fuel tank into proper receptacle for storage. Secure the machine.



WARNING

Never tip the machine more than 90 degrees in any direction and do not leave the machine tipped for any excessive length of time. Oil can drain into the upper part of the engine causing a starting problems.

2. Scrape and clean the underside of the machine with a suitable tool. Do not spray with water.
3. Put the machine back onto its wheels on the ground.
4. Clean the engine regularly with a cloth or brush. Keep the cooling system (blower housing area) clean to permit proper air circulation which is essential to engine performance and life. Be certain to remove all dust, dirt and combustible debris from exhaust area.

Collection Bag

Remove the collection bag from the machine and wash it with a garden hose or high-pressure cleaning equipment. Allow the bag to dry completely before storing.

STORAGE & TRANSPORT

The following steps should be taken to prepare your machine for storage.

2. Empty the fuel tank. Disconnect the spark plug cap. Drain petrol from the engine with a suction pump. Alternatively, tip the machine so that it rests on its side. Keep the side with the air filter housing facing up. Drain all fuel from fuel tank into proper receptacle for storage. Secure the machine.



WARNING

**Do not drain the petrol in enclosed spaces, in proximity of open fire, etc.
Do not smoke! Petrol fumes can cause explosion or fire.**

3. While engine is still warm, change oil. See Engine Oil Change section of this manual.
4. Clean engine of surface debris, chaff or grass.
5. Remove spark plug. Place 1 teaspoon or 20 ml. of oil into spark plug hole.
6. Pull starter rope slowly 8-10 times to properly coat the cylinder bore and piston for storage.
7. Replace spark plug and tighten. Any residual oil may burn off in subsequent starts. This may result in white smoke emission from muffler.
8. This machine may be stored in a variety of positions. It is best to store in horizontal position with the spark plug up. Do not store or transport with the spark plug down.

NOTE: Storing or transporting with the spark plug down will result in hard starting and/or engine smoking.

- Store in a dry, clean and frost-protected place, out of reach of unauthorised persons.
 - When removing unit from storage, only use fresh petrol. Perform operation checks (see maintenance schedule) before starting engine.
9. Keep out of direct sunlight.



CAUTION

The engine must have completely cooled down before storing.

NOTE: When storing any type of power equipment in an unventilated or material storage shed,

- Care should be taken to rust-proof the equipment. Using a light oil or silicone, coat the equipment, especially cables and all moving parts.
- Be careful not to bend or kink cables.
- If the starter rope becomes disconnected from rope guide on handle, disconnect and ground the spark plug cap. Pull the OPC/brake lever up to and against the upper handle and pull the engine recoil starter handle slowly out of the engine.



INSTRUCTION MANUAL

DO NOT STORE fuel for longer than 30 days. Fuel can become stale and cause damage to the engine carburetor, which is not covered by the machines manufacturer's warranty.

TROUBLE SHOOTING

PROBLEM	POSSIBLE CAUSES	REMEDIAL ACTION
Engine does not start	Engine does not start	Move throttle lever to correct position
	Fuel tank is empty.	Fill tank with fuel: refer to ENGINE OWNERS MANUAL.
	Spark plug loose.	Tighten spark plug.
	Spark plug wire loose or disconnected from plug.	Install spark plug cap on to spark plug.
	Spark plug gap is incorrect	Set correct gap between electrodes: refer to ENGINE OWNERS MANUAL.
	Spark plug is defective.	Install new, correctly gapped plug: refer to ENGINE OWNERS MANUAL.
	Carburettor is flooded with fuel.	Remove air filter cover and air filter. Pull starter rope continuously until carburetor clears itself and install air filter and cover.
Engine speed drops off	Exit chute blocked	Turn off engine, let accessory cassette stop rotating. Remove spark plug cap. Remove collector and empty. Lift rear baffle and clear any debris in exit chute. Refit collector.
	Air filter clogged	Clean air filter: refer to ENGINE OWNERS MANUAL.
Poor scarification results	Depth of cut too small	Set to lower height adjustment
	Worn cutting blades	Have cutting blades sharpened or replaced by garden machinery specialist.
Collector never fills	Collector is clogged	Stop machine. Clear blockage or clean it
	Ejector channel blocked	Turn off engine, let blade/tines stop rotating. Remove spark plug cap. Remove collector and empty. Lift rear flap and clear any debris in exit chute. Refit collector.
Unusual noises	Bolts, nuts or other mounting parts slack.	Tighten parts
Vibration	Cutting assembly is loose	Tighten blade
	Cutting assembly is unbalanced	Have cutting blades sharpened or replaced by garden machinery specialist.

PARTS DIAGRAM - WEWBVAC 1938267001

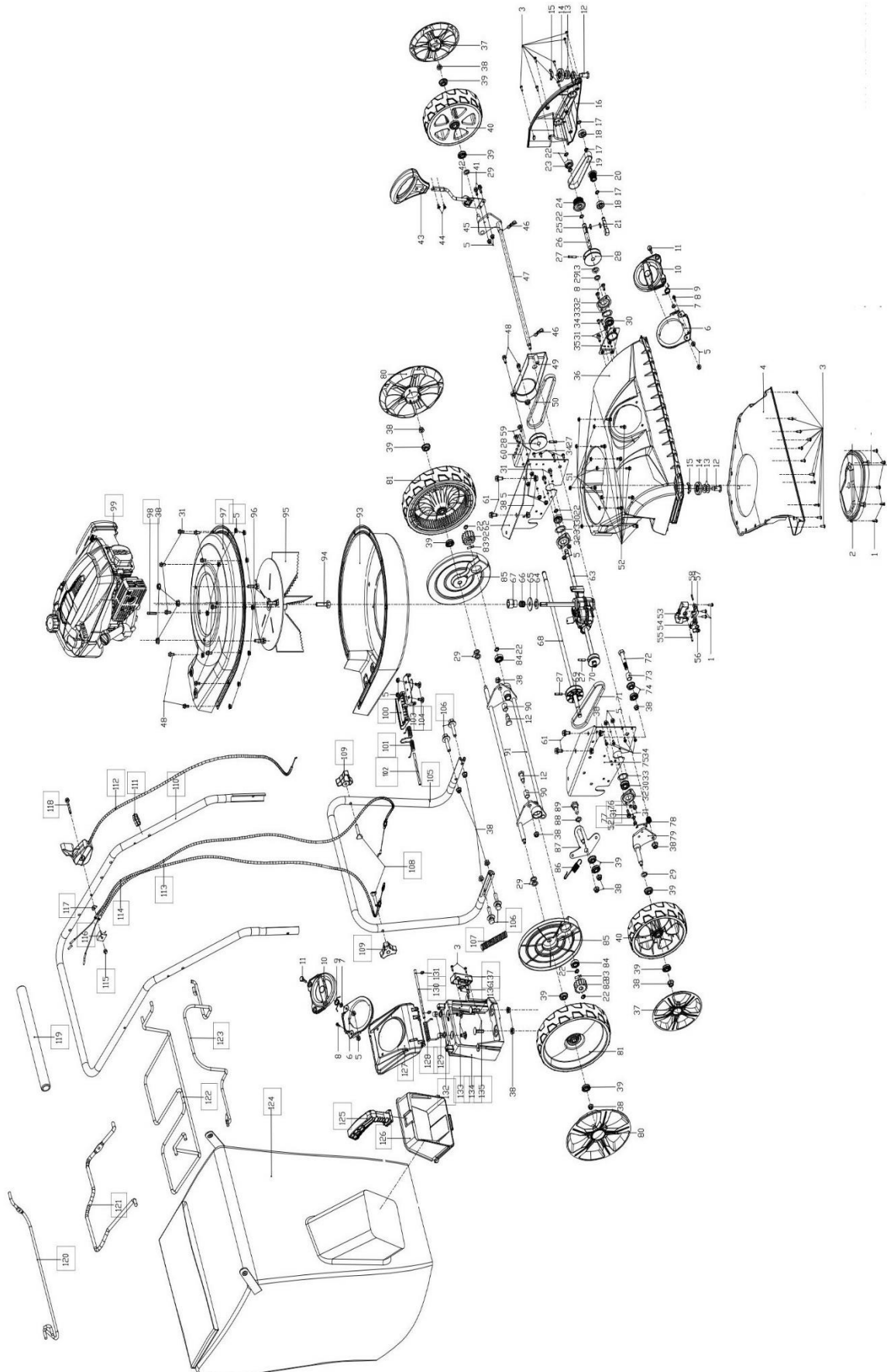



INSTRUCTION MANUAL

PARTS LIST - WEWBVAC 1938267001

Item No	Webb Part No.	Webb Description	Qty	Item No	Webb Part No.	Webb Description	Qty
1	WE185-50080110000	Self-Tapping Screw	8	35	WE185-30360130000	Fixing Board	1
2	WE185-42190000130	Nozzle Bottom Cover	1	36	WE185-42160002130	Nozzle Top Cover	1
3	WE185-50060010000	Self-Tapping Screw	18	37	WE185-40100070083	Front Wheel Trim	1
4	WE185-42170000130	Nozzle Inner Cover	1	38	WE185-50290030000	Hex Flange Nut M8	26
5	WE185-50290020000	Hex Flange Screw M6	20	39	WE185-50500060000	Wheel BS Bearing	2
6	WE185-42280000130	Cover Holder	2	40	WE185-40050090001	Front Wheel	2
7	WE185-50340210000	Washer	2	41	WE185-50030160000	Hex Flange Bolt	2
8	WE185-50140030000	Cross Screw Bolt	4	42	WE185-30170200000	Height Adjustment Lever	1
9	WE185-50430230000	Cover Return Spring	2	43	WE185-40350140083	Height Adjustment Handle	1
10	WE185-42290000280	Cover	2	44	WE185-50140040000	Crosshead Screw	2
11	WE185-50190040000	Cover Rotation Bolt	2	45	WE185-30300090000	Bushing	1
12	WE185-50190050000	Guide Wheel Bolt	4	46	WE185-50370070000	B-pin	2
13	WE185-50340390000	Guide Wheel Washer	5	47	WE185-30040330130	Front Axle Assembly	1
14	WE185-50500210000	Guide Wheel	2	48	WE185-50030310000	Hex Flange Bolt	4
15	WE185-50580010000	Guide Wheel Wingnut	2	49	WE185-42320000130	Belt Cover	1
16	WE185-42180001130	Nozzle Sideboard	1	50	WE185-50000250000	Belt 520	1
17	WE185-50360010000	Washer	5	51	WE185-50290010000	Lock Nut	9
18	WE185-50500200000	Bearing 1	2	52	WE185-50030060000	Hex Flange Bolt	11
19	WE185-50000220000	Small Belt	1	53	WE185-42260020130	Lower Frame	1
20	WE185-42250010000	Belt Pulley Small	1	54	WE185-42260010130	Trigger	1
21	WE185-32070040000	Connecting Shaft 1	1	55	WE185-30280180000	Pin 1	1
22	WE185-50360000000	Washer	9	56	WE185-50430220000	Spring	1
23	WE185-50500190000	Bearing 2	1	57	WE185-42260000130	Upper Cover	1
24	WE185-42250000000	Belt Pulley Medium	1	58	WE185-30280170000	Pin 2	1
25	WE185-50460010000	Key	2	59	WE185-50010010000	Bolt	2
26	WE185-32070050000	Connecting Shaft 2	1	60	WE185-30310090000	Height Adjustment Gauge	1
27	WE185-50370020000	Pin	4	61	WE185-50030180000	Bolt	4
28	WE185-30290080000	Belt Wheel Large	2	62	WE185-10210130031	Left Frame	1
29	WE185-50340070000	Washer	9	63	WE185-30030192000	Gearbox	1
30	WE185-50500160000	Bearing 3	3	64	WE185-50430380000	Spring	1
31	WE185-50030290000	Bolt	14	65	WE185-50340500000	Washer	1
32	WE185-30360070000	Washer	3	66	WE185-35340060000	Oil Seal	1
33	WE185-50360030000	Ring	3	67	WE185-30400040000	Connector	1
34	WE185-50080200000	Screw	10	68	WE185-32070062000	Output Shaft	1

Spare Parts are available from our Spares Team. Please call 01793 333212, option 1 for assistance.

PARTS LIST - WEWBVAC 1938267001

Item No	Webb Part No.	Webb Description	Qty	Item No	Webb Part No.	Webb Description	Qty
69	WE185-40360070130	Droven Belt Wheel	1	104	WE185-50010000000	Square Neck Bolt	2
70	WE185-30290090000	Belt Wheel	1	105	WE185-10020200031	Lower Handle	1
71	WE185-50000210000	Belt O470	1	106	WE185-50130050000	Lower Handle Bolt	4
72	WE185-10210121031	Right Frame	1	107	WE185-40350140130	Bellows Hose	1
73	WE185-50190070000	Fixed Bolt	1	108	WE185-50010070000	Square Neck Bolt	2
74	WE185-50500170000	Bearing	2	109	WE185-40310010083	Handle Fixing Knob	1
75	WE185-35520030000	Bushing	1	110	WE185-30010120031	Upper Handle with Foam	1
76	WE185-50340350000	Washer	1	111	WE185-40390010130	Cable Clip	2
77	WE185-50340340000	Spring	1	112	WE185-30110470280	Throttle Cable	1
78	WE185-50430250000	Spring	1	113	WE185-30130230000	Accessory Cassette Cable	1
79	WE185-30040320130	Frame Board	1	114	WE185-30130220000	Self-Propelled Cable	1
80	WE185-40110050083	Rear Wheel Trim	1	115	WE185-50310010000	Cap Nut	1
81	WE185-40060160001	Rear Wheel	2	116	WE185-40470010130	Cable Clamp	1
82	WE185-30390100000	Right Rear Drive Cog	1	117	WE185-50340380000	Washer	1
83	WE185-50380000000	Drive Pin	2	118	WE185-50030150000	Hex Flange Bolt	1
84	WE185-50500000000	Bearing	2	119	N/A	Handle Foam	1
85	WE185-40120060130	Inner Wheel Cover	2	120	WE185-10160060280	Accessory Cassette Lever	1
86	WE185-50430260000	Spring	1	121	WE185-10160050280	Self-Propelled Lever	1
87	WE185-33010061000	Fram Assembly	1	122	WE185-30190081031	Collector Upper Bracket	1
88	WE185-30270000000	Block	1	123	WE185-30190090031	Hose Bracket	1
89	WE185-50190061000	Washer	1	124	WE185-40160051002	Collection Bag	1
90	WE185-32080000000	Bushing	2	125	WE185-42230000130	Collection Bag Inlet Handle	1
91	WE185-30050501130	Rear Axle	1	126	WE185-42220000130	Collection Bag Neck	1
92	WE185-30390110000	Left Rear Drive Cog	1	127	WE185-42200000130	Rear Baffle	1
93	WE185-10001990380	Lower Deck	1	128	WE185-50430040000	Rear Cover Torsion Spring	1
94	WE185-50020070000	Fan Bolt	1	129	WE185-50310020000	Cap Nut	1
95	WE185-32040010000	Fan	1	130	WE185-30280160000	Round Bar 2	1
96	WE185-50030190000	Fan Nut	3	131	WE185-50350010000	Split Washer	2
97	WE185-10001981380	Upper Deck	1	132	WE185-50340110000	Washer	2
98	WE185-50470040000	Key	1	133	WE185-50010040000	Square Neck Bolt	2
99	N/A	BS500E Engine	1	134	WE185-42210000130	Rear Cover Bracket	1
100	WE185-42240000130	Rear Baffle	1	135	WE185-50010090000	Square Neck Bolt	2
101	WE185-50430000000	Baffle Torsion Spring	1	136	WE185-80130080000	Switch Box	1
102	WE185-30280040000	Round Bar 2	1	137	WE185-42300000130	Switch	1
103	WE185-30350001000	Rear Bracket	1				

Spare Parts are available from our Spares Team. Please call 01793 333212, option 1 for assistance.



EC DECLARATION OF CONFORMITY

We Handy Distribution Ltd - SN3 5HY (Importer) declare that the product:

Designation: Petrol Walk Behind Blower & Vacuum

Model(s): WEWBVAC

Product No.: 1938267001

Type/Serial No. As per rating label on machine

Engine Displacement: 140 cm³

Rated Engine Power: 2.03kW

Working Width: 58cm

Complies with the following directives:

Machinery Directive 2006/42/EC

The conformity assessment procedure followed was in accordance with

EN 15503:2009+A2:2015, EN ISO 12100:2010, EN ISO 3744:1995, ISO 11904:1991, EN ISO 14982:2009

EMC Directive 2014/30/EU

ROHS Directive 2011/65/EU

Noise Directive 2000/14/EC

Guaranteed Sound Power Level L_{WA} : 105 dB(A)

Vibration a_{hv} : 4.2 m/s²

Notified Body:

Intertek Deutschland GmbH,

Authorised signatory and technical file holder

Date: 10/09/2020

Signature:

Name: Mr Simon Belcher

Position: Chairman

Company: Handy Distribution Ltd

Address: Murdock Rd, Swindon, Wiltshire, SN3 5HY.



Notes



Notes



INSTRUCTION MANUAL

This Service Book is provided with your Webb, to help you look after your purchase to our recommendations and enable you to take advantage of the conditional manufacturer domestic warranty*.

Present this service book to your authorised Webb repair dealer, whenever a service or a warranty appraisal is required.

The booklet is applicable to the following products, in the UK only:

Ride On Lawn Tractors
Cylinder Lawnmowers
Petrol Rotary Lawnmowers
Petrol Hand Held Range

Please register your machine using the following pages or at www.webbgardenpower.co.uk. By registering your machine, you agree to maintain the machine in accordance with the service schedules specified in this manual and services duly recorded. (Not applicable for Webb electric handheld machines). You may be asked to produce this booklet as proof of servicing in the event of a claim. Proof of purchase should also be kept as a reference.

Ensure you have the following information available from your machine product label. The two examples below can be found on your machine:



1. Model Number

2. Serial & Product Number

Please complete using BLOCK CAPITALS.
Sections marked* must be completed to validate Warranty.

SERVICE BOOK

1. Users Statement of Warranty

Each new machine is warranted against defective material or assembly of material under normal usage. The warranty applies to the original purchaser, is not transferable and covers faulty parts and the labour involved in replacing and repairing those parts, which are of original manufacture.

2. Period of Warranty - valid from 1 January 2020

Webb (excludes Dynamic, Legacy & Heritage), 2 year conditional warranty from the original date of sale to the first domestic user.

Webb (Dynamic, Legacy & Heritage) 1 year warranty from the original date of sale to the first domestic user.

90 days from the original date of sale to the professional/commercial or for hire user.

Engine warranty as per the engine manufacturer's warranty, which will be supplied with the machine.

90 days from the original date of sale for Replacement Spare Parts

All machines' must be serviced within the first 14 months from the original date of purchase, to qualify for a second year parts & labour warranty, details of the service must be recorded in the service record within this manual.

A reduced warranty period of 90 days applies to those items which are subject to normal wear and tear and in normal use, will need replacement or adjustment.

These items are chargeable after 90 days of ownership.

Filters
Tyres / Wheels
Drive chains and belts
Brake & clutch friction components
Control cable & starter cords
Fluids & lubricants
Spark plugs
Blades (Lawnmowers & Brushcutters)
Cutter bars (Hedgecutters)
Drive & clutch cable surfaces
Nylon Lines (Line Trimmers)
Carburettor cleaning
Bearings
Bushes
Electric cable
Grass collectors

3. Not covered by this warranty

(a) The warranty policy does not cover any depreciation or damages caused by ordinary wear, rusting or corrosion, lack of correct maintenance or operation, misuse, abuse, lack of transportation or accident.

(b) The warranty policy does not cover any costs necessary for the standard periodic maintenance services instructed by the operators manual, or service parts replacement which would include oil, filters, tyres, belts, brake linings, fuses, blades, seals and other service parts unless it can be proven that the item has evidence of faulty manufacture.

(c) The warranty policy will not cover failure or damage caused as a result of parts or accessories being modified without the written approval of GJ Handy & Co Ltd.

(d) The warranty policy will not cover the unit if non-genuine parts have been fitted and as a result damage has occurred to the unit.

(e) The warranty policy is non-transferable and is only applicable to the original purchaser.

4. Disclaimer

(a) This warranty is only a remedy for defect of products. GJ Handy & Co Ltd will never warranty in terms of the merchantability or the fitness for a particular purpose.

(b) No person is authorised to make any warranties, representations or promises, expressed or implied, on behalf of GJ Handy & Co Ltd, or to modify the terms conditions or limitation of this warranty policy in any way.



INSTRUCTION MANUAL

(c) Neither GJ Handy & Co Ltd nor any company affiliated with GJ Handy & Co Ltd shall be liable in any event or manner whatsoever for incidental or consequential damages or injuries, including, but not limited to, loss of crops, loss of profit, out of pocket expenses or profits, rental of substitute equipment or other commercial losses.

5. General

(a) Most warrantable failures show up within the first few weeks of use. These failures are usually straightforward and warranty assessment is relatively easy.

(b) Failures relating to cutter decks and belts need careful investigation, as the cause may not always be straightforward. Look for damage to blades and pulleys especially when the cutter belt or blade boss have snapped or cracked as this could be due to impact damage.

(c) Customers should always refer to the operator/instruction manual when any disputed problem arises, you will find most areas covered within the manual.

Protecting your machine

Maintenance

Regular maintenance of your Webb machine is essential to ensure it operates, safely, efficiently and therefore reducing the environmental impact.

It is the owner's responsibility to ensure that their Webb machine is maintained at specific intervals. Any approved Webb service dealer can undertake a service, which are specialised in our products and will be aware of your particular machine and any technical updates which will save valuable time & money.

If you are using your machine in dry, dusty or high temperatures, you will need to service the machine more regularly.

Fuel (if applicable)

Due to ongoing efforts by fuel companies to reduce emissions, unleaded petrol will oxidize & deteriorate in storage overtime, leaving residue from detergent components.

Fuel deterioration problems may occur when petrol is stored for over 30 days. If you are planning to store fuel for over 30 days, we recommend you add Handy Parts Sure-Start fuel stabilizer to fresh fuel after purchasing. Sure-Start cannot reconstitute stale fuel.

Storage

When storing your machine for an extended period, we do recommend that you follow the instructions of engine instruction manual.

Always store the fuel in a clean, approved and sealed container. If the container is steel, ensure it is not corroded. If the container is not filled to its recommended capacity, air can accelerate fuel deterioration.

Always store fuel away from direct sunlight, in a dark, cool environment.

SERVICE BOOK

Your servicing Webb approved dealer will stamp & date the below relevant sections, when the correct service actions have been completed.

PLEASE ENSURE THE SERVICE BOOK IS AVAILABLE FOR THE DEALER, DURING SERVICE WORK.

1st Service

This must be stamped by an approved service dealer to qualify for a free second year warranty.
(Excluding the Webb Electric Handheld machines)

12 Months

Date

24 Months

Date

36 Months

Date



INSTRUCTION MANUAL

48 Months

Date

60 Months

Date

72 Months

Date

84 Months

Date

96 Months

Date

108 Months

Date

120 Months

Date

132 Months

Date

Product Information (* Compulsory)

Personal Information (* Compulsory)

You may give Webb Lawnmowers notice in writing at any time that you no longer wish to receive direct marketing communications

Webb Lawnmowers
Murdock Road
Dorcan
Swindon
Wiltshire
SN3 5HY