



188

Tubular Mortice Latch Fitting Instructions

Installing Tubular Mortice Latch

NOTE: Suitable for door between 35mm and 54mm in thickness

To fit a Tubular Mortice Latch you will require:

- Pencil
- Chisel
- Screwdriver
- Drill
- 10mm and 22mm drill bits

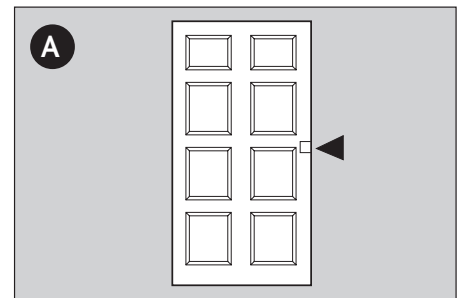

A Select position of tubular latch on door

B Open door, mark hole position in centre of door edge. Drill a 22mm hole to a depth of 65mm for a 64mm latch and 80mm for a 76mm latch (to accept latch case), ensuring you keep the drill straight and level at all times. Place tubular latch in hole. Using a pencil draw around the forend of the latch. Remove latch and chisel out timber so that the latch face is flush with the door edge

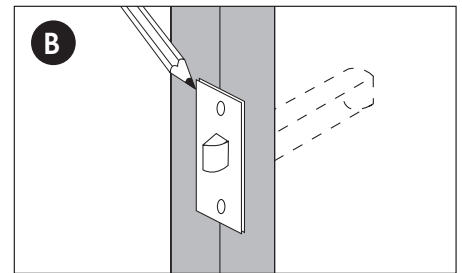

C Using the latch template, ensuring latch is parallel with hole drilled, mark position for handle spindle. Drill a 10mm hole through the door. Place tubular latch in hole and secure with screws provided. Prior to closing door fix furniture and test latch bolt operation

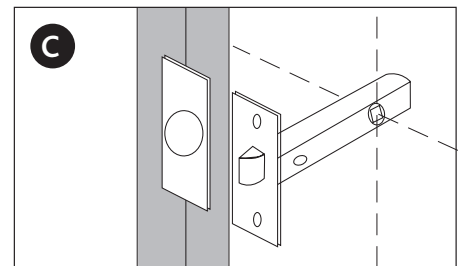

D Close door gently against the door frame. Mark top and bottom positions of latch plate on the door frame. Position striker plate within markings and using a pencil draw around the striking plate and mark the location of receiving hole. Rebate striker (if necessary) using chisel. Remove timber from frame using a chisel to a suitable depth to accept latch bolt. Fix striking plate in position required and check operation

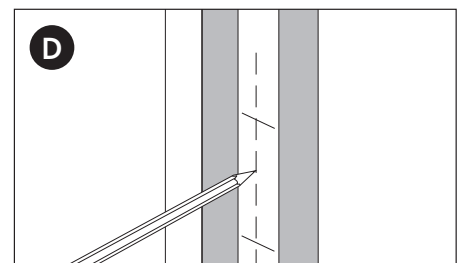

Additional Information

Maintenance

Use a moist cloth only - lubrication may occasionally be required