

R-RLK-P Rawlok - Bolt Projecting

All purpose expansion anchor for use in medium weight applications



Product information

Features and benefits

- Medium weight applications anchor
- Anchor designed for optimum performance in most base materials
- Integral collapse feature to ensure maximum clamping force is applied to the fixture
- Bolt and drill size marked on sleeve for accurate installation

Applications

- Radiators
- Signs
- Stadium seating
- Satellite dishes
- Wall plates
- Shutter
- Garage doors

Base materials

Approved for use in:

- Non-cracked concrete C20/25-C50/60
- Solid Brick
- Reinforced concrete

Also suitable for use in:

- Natural Stone

Installation guide

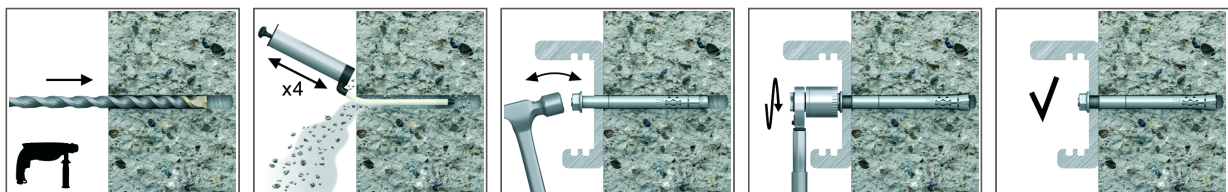

1. Drill a hole of required diameter and depth. Note: When fixing into brickwork, mortar joints should be avoided
2. Remove debris and thoroughly clean hole with brush and pump
3. Insert Rawlock through the fixture into the hole
4. Tighten to the recommended torque