

37086 +
89089

DEWALT®

D26500(K)
D26501K

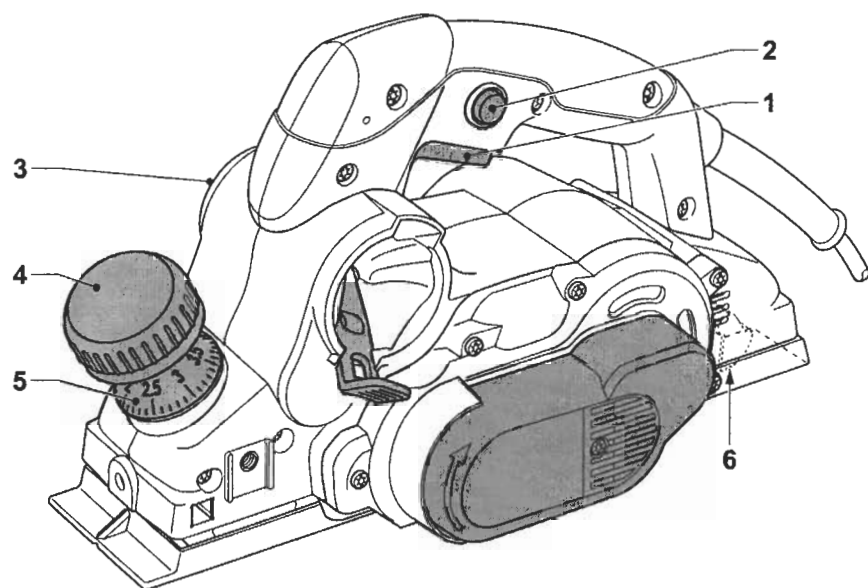

A

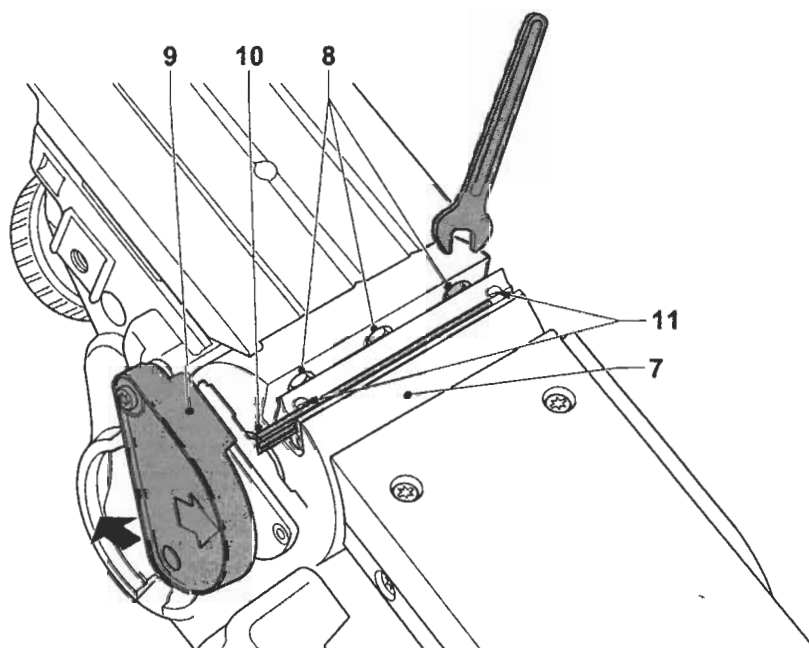

B

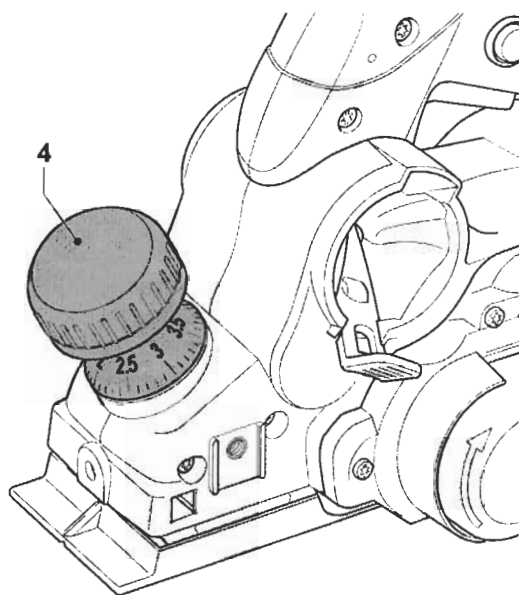

C

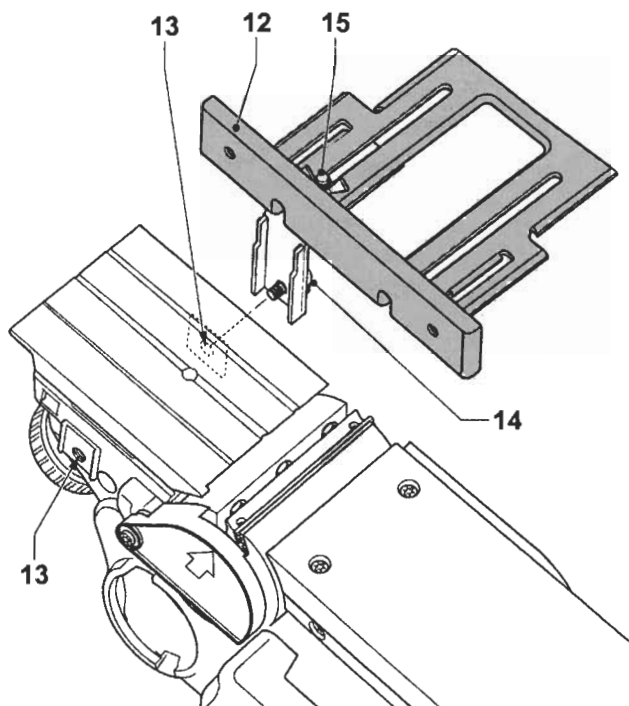

D

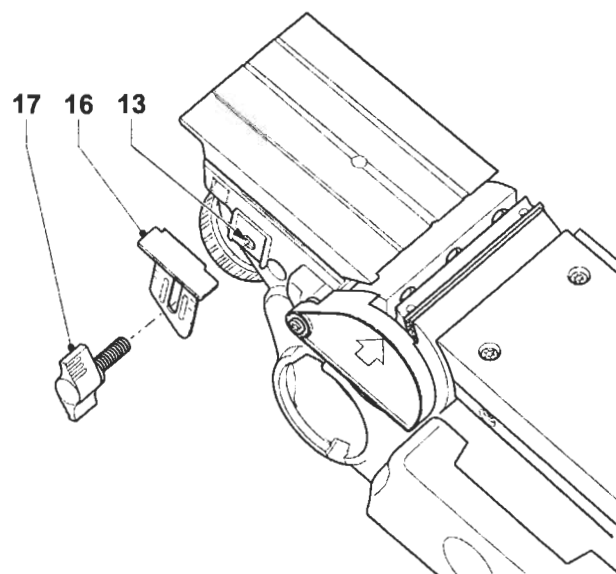

E

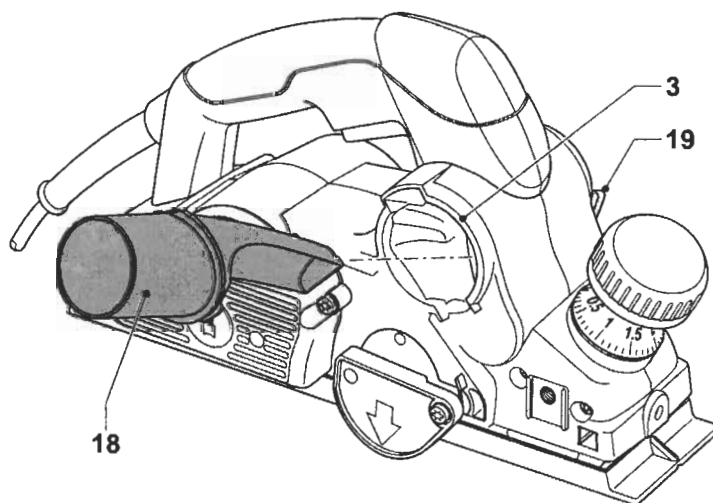

F1

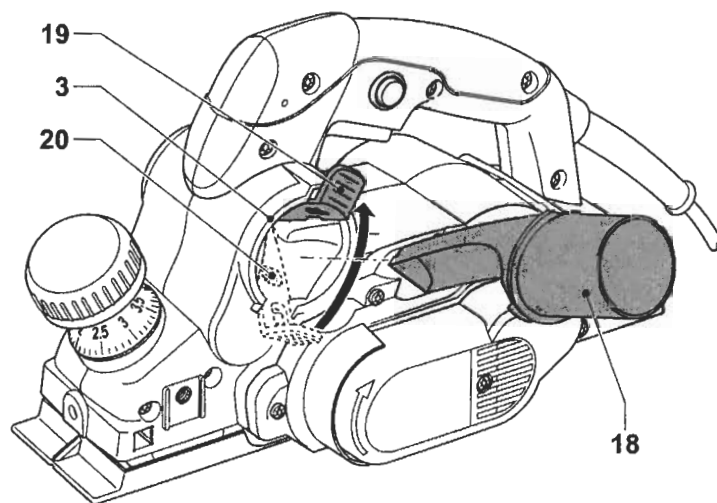

F2

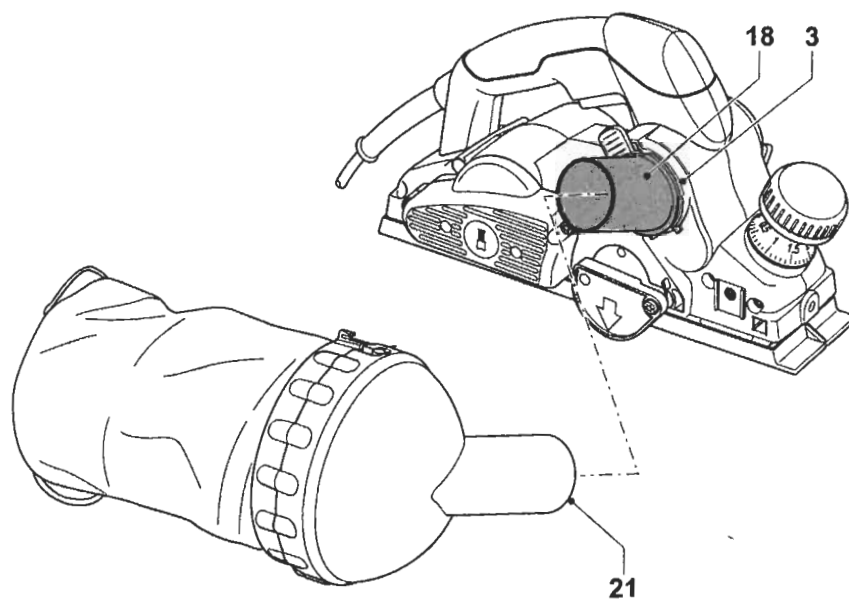

G

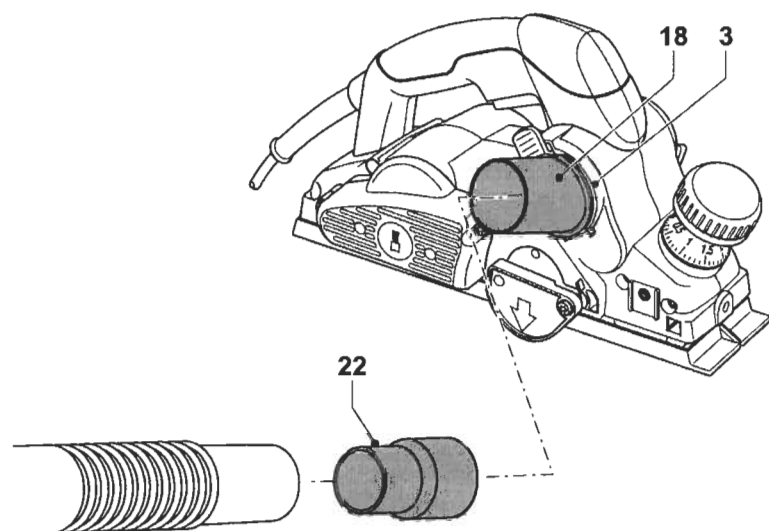

H

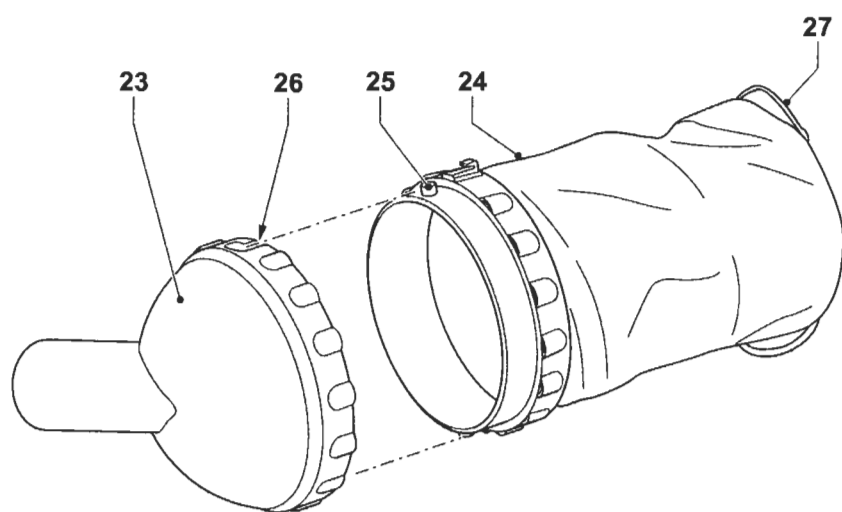

I

PLANER D26500(K)/D26501K

Congratulations!

You have chosen a DeWALT tool. Years of experience, thorough product development and innovation make DeWALT one of the most reliable partners for professional power tool users.

Technical data

	D26500(K)	D26501K
Voltage	V 230	230
(U.K. & Ireland only)	V 230/115	230/115
Power input	W 1,050	1,150
No-load speed	min ⁻¹ 13,500	11,500
Base length	mm 320	320
Planing width	mm 82	82
Rebating depth (max.)	mm 25	25
Planing depth (max.)	mm 4.0	4.0
Weight	kg 4	4

Fuses:

Europe	230 V tools	10 Amperes, mains
U.K. & Ireland	230 V tools	13 Amperes, in plugs

The following symbols are used throughout this manual:



Denotes risk of personal injury, loss of life or damage to the tool in case of non-observance of the instructions in this manual.



Denotes risk of electric shock.

EC-Declaration of conformity



D26500(K)/D26501K

DeWALT declares that these power tools have been designed in compliance with: 98/37/EEC, 89/336/EEC, 86/188/EEC, EN 60745, EN 55014-1, EN 55014-2, EN 61000-3-2, EN 61000-3-3.

For more information, please contact DeWALT at the address below, or refer to the back of the manual.

	D26500(K)	D26501K
L _{PA} (sound pressure)	dB(A) 88	84
L _{WA} (acoustic power)	dB(A) 99	95
Weighted RMS acceleration value	m/s ² < 2.5	< 2.5

K _{PA} (sound pressure uncertainty)	dB(A) 2.8
K _{WA} (acoustic power uncertainty)	dB(A) 2.8

Director Engineering and Product Development
Horst Großmann

DeWALT, Richard-Klinger-Straße 11
D-65510, Idstein, Germany

ENGLISH

General safety rules

Warning! Read all instructions. Failure to follow all instructions listed below may result in electric shock, fire and/or serious injury. The term „power tool“ in all of the warnings listed below refers to your mains operated (corded) power tool or battery operated (cordless) power tool. **SAVE THESE INSTRUCTIONS.**

1 Work area

- a **Keep work area clean and well lit.** Cluttered and dark areas invite accidents.
- b **Do not operate power tools in explosive atmospheres, such as in the presence of flammable liquids, gases or dust.** Power tools create sparks which may ignite the dust or fumes.
- c **Keep children and bystanders away while operating a power tool.** Distractions can cause you to lose control.

2 Electrical safety

- a **Power tool plugs must match the outlet.** Never modify the plug in any way. Do not use any adapter plugs with earthed (grounded) power tools. Unmodified plugs and matching outlets will reduce risk of electric shock.
- b **Avoid body contact with earthed or grounded surfaces such as pipes, radiators, ranges and refrigerators.** There is an increased risk of electric shock if your body is earthed or grounded.
- c **Do not expose power tools to rain or wet conditions.** Water entering a power tool will increase the risk of electric shock.
- d **Do not abuse the cord.** Never use the cord for carrying, pulling or unplugging the power tool. Keep cord away from heat, oil, sharp edges or moving parts. Damaged or entangled cords increase the risk of electric shock.
- e **When operating a power tool outdoors, use an extension cord suitable for outdoor use.** Use of a cord suitable for outdoor use reduces the risk of electric shock.

3 Personal safety

- a **Stay alert, watch what you are doing and use common sense when operating a power tool.**

Do not use a power tool while you are tired or under the influence of drugs, alcohol or medication. A moment of inattention while operating power tools may result in serious personal injury.

- b **Use safety equipment. Always wear eye protection.** Safety equipment such as dust mask, non-skid safety shoes, hard hat, or hearing protection used for appropriate conditions will reduce personal injuries.
- c **Avoid accidental starting. Ensure the switch is in the off position before plugging in.** Carrying power tools with your finger on the switch or plugging in power tools that have the switch on invites accidents.
- d **Remove any adjusting key or wrench before turning the power tool on.** A wrench or a key left attached to a rotating part of the power tool may result in personal injury.
- e **Do not overreach. Keep proper footing and balance at all times.** This enables better control of the power tool in unexpected situations.
- f **Dress properly. Do not wear loose clothing or jewellery. Keep your hair, clothing and gloves away from moving parts.** Loose clothes, jewellery or long hair can be caught in moving parts.
- g **If devices are provided for the connection of dust extraction and collection facilities, ensure these are connected and properly used.** Use of these devices can reduce dust related hazards.

4 Power tool use and care

- a **Do not force the power tool. Use the correct power tool for your application.** The correct power tool will do the job better and safer at the rate for which it was designed.
- b **Do not use the power tool if the switch does not turn it on and off.** Any power tool that cannot be controlled with the switch is dangerous and must be repaired.
- c **Disconnect the plug from the power source before making any adjustments, changing accessories, or storing power tools.** Such preventive safety measures reduce the risk of starting the power tool accidentally.

- d **Store idle power tools out of the reach of children and do not allow persons unfamiliar with the power tool or these instructions to operate the power tool.** Power tools are dangerous in the hands of untrained users.
- e **Maintain power tools. Check for misalignment or binding of moving parts, breakage of parts and any other condition that may affect the power tools operation. If damaged, have the power tool repaired before use.** Many accidents are caused by poorly maintained power tools.
- f **Keep cutting tools sharp and clean.** Properly maintained cutting tools with sharp cutting edges are less likely to bind and are easier to control.
- g **Use the power tool, accessories and tool bits etc., in accordance with these instructions and in the manner intended for the particular type of power tool, taking into account the working conditions and the work to be performed.** Use of the power tool for operations different from those intended could result in a hazardous situation.

5 Service

- a **Have your power tool serviced by a qualified repair person using only identical replacement parts.** This will ensure that the safety of the power tool is maintained.

Additional safety rules for planers

- **Wait for the cutter to stop before putting the tool down.** An exposed cutter may engage the surface leading to possible loss of control and serious injury.

Package contents

The package contains:

- 1 Planer
- 1 Parallel fence
- 1 Rebating depth stop
- 1 Wing bolt
- 1 Spanner
- 1 Shavings ejector
- 1 Shavings deflector (K-models only)
- 1 Dustbag (K-models only)
- 1 Dust extraction adapter
- 1 Kitbox (K-models only)
- 1 Instruction manual
- 1 Exploded drawing

- Check for damage to the tool, parts or accessories which may have occurred during transport.
- Take the time to thoroughly read and understand this manual prior to operation.

Description (fig. A)

Your D26500(K)/D26501K planer has been designed for professional planing of wood.

- 1 On/off switch
- 2 Lock-off button
- 3 Shavings discharge outlet
- 4 Planing depth adjustment knob
- 5 Planing depth graduation
- 6 Parking shoe

D26501K - Constant speed feature

The constant speed feature maintains the cutting speed under load. This means less noise and a constant cutting speed. Moreover the speed will not increase dramatically when lifting the tool off the workpiece.

D26501K - Electronic brake

The electronic brake stops the cutters upon releasing the on/off switch.

Electrical safety

The electric motor has been designed for one voltage only. Always check that the power supply corresponds to the voltage on the rating plate.



Your DeWALT tool is double insulated in accordance with EN 50144; therefore no earth wire is required.

Mains plug replacement (U.K. & Ireland only)

- Should your mains plug need replacing and you are competent to do this, proceed as instructed below. If you are in doubt, contact an authorized DeWALT repair agent or a qualified electrician.
- Disconnect the plug from the supply.
- Cut off the plug and dispose of it safely; a plug with bared copper conductors is dangerous if engaged in a live socket outlet.
- Only fit 13 Amperes BS1363A approved plugs fitted with the correctly rated fuse (1).

ENGLISH

- The cable wire colours, or a letter, will be marked at the connection points of most good quality plugs. Attach the wires to their respective points in the plug (see below). Brown is for Live (L) (2) and Blue is for Neutral (N) (4).
- Before replacing the top cover of the mains plug ensure that the cable restraint (3) is holding the outer sheath of the cable firmly and that the two leads are correctly fixed at the terminal screws.

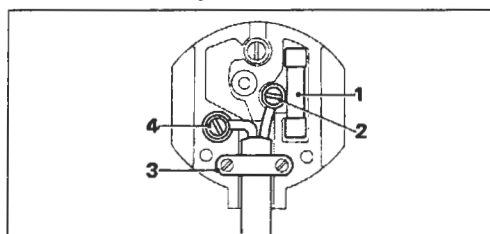

Never use a light socket.
Never connect the live (L) or neutral (N) wires to the earth pin marked E or \perp .

For 115 V units with a power rating exceeding 1500 W, we recommend to fit a plug to BS4343 standard.

Using an extension cable

If an extension cable is required, use an approved extension cable suitable for the power input of this tool (see technical data). The minimum conductor size is 1.5 mm².

When using a cable reel, always unwind the cable completely. Also refer to the table below.

Conductor size (mm ²)		Cable rating (Amperes)					
0.75		6					
1.00		10					
1.50		15					
2.50		20					
4.00		25					
		Cable length (m)					
		7.5	15	25	30	45	60
Voltage	Amperes	Cable rating (Amperes)					
115	0 - 2.0	6	6	6	6	6	10
	2.1 - 3.4	6	6	6	6	15	15
	3.5 - 5.0	6	6	10	15	20	20
	5.1 - 7.0	10	10	15	20	20	25
	7.1 - 12.0	15	15	20	25	25	-
	12.1 - 20.0	20	20	25	-	-	-

230	0 - 2.0	6	6	6	6	6	6
	2.1 - 3.4	6	6	6	6	6	6
	3.5 - 5.0	6	6	6	6	10	15
	5.1 - 7.0	10	10	10	10	15	15
	7.1 - 12.0	15	15	15	15	20	20
	12.1 - 20.0	20	20	20	20	25	-

Assembly and adjustment



Prior to assembly and adjustment always unplug the tool.

Replacing the cutting blades (fig. B)

The cutting blades fitted on this tool are reversible. If both sides are worn, the cutting blades have to be replaced.



Always replace the blades simultaneously.

- Carefully rotate the cutterhead (7) until the first blade becomes visible.
- Loosen the bolts (8) using the spanner supplied.
- Pull up the side guard (9).
- Slide the blade (10) out of its holder.
- Reverse the blade or replace it.
- Slide the blade into the holder. At the rebating side (i.e. the side where the side guard is mounted), the cutting blade must be flush with the planing shoe.
- Adjust the blade as described below.
- Tighten the bolts (8).
- Repeat as for the other blade.

Adjusting the blades (fig. B)

- Ensure the depth of cut is set at 0 mm.
- Check the position of the blade (10) at both ends. Use a flat object as a level across the planing shoe.
- The tip of the blade must be flush with the planing shoe surface.
- If adjustment is required, proceed as follows:
- Turn each adjusting screw (11) in or out as necessary until the blade tip coincides with the planing shoe.

Adjusting the depth of cut (fig. C)

- Turn the planing depth adjustment knob (4). One revolution of the adjustment knob equals a 4.0 mm change in depth.

One graduation corresponds to a depth of cut of 0.1 mm.

Attaching, removing and adjusting the parallel fence (fig. D)

The parallel fence (12) is used for optimum tool control on narrow workpieces. The parallel fence can be fitted to either side of the tool.

- Assemble the parallel fence (12) in such way that the fence profile will provide guidance from the front of the tool until behind the cutterhead.
- Fit the parallel fence to the threaded hole (13) from either side.
- Tighten the wing bolt (14).
- To remove the parallel fence, remove the wing bolt.

To adjust the parallel fence:

- Loosen the wing nut (15).
- Adjust the fence so that there will be just enough area of the cutterhead left to cut the workpiece surface.
- Tighten the wing nut.

Attaching, removing and adjusting the rebating depth stop (fig. E)

- Install the depth stop (16).
- Tighten the wing bolt (17) at the desired height in the threaded hole (13) using the scale.
- To remove the depth stop, remove the wing bolt.

Fitting and removing the shavings ejector (fig. F1 & F2)

The tool can be used for both left-hand and right-hand side shavings discharge.

For right-hand side shavings discharge (fig. F1), the tool can be used with or without the ejector. The ejector must be used in combination with the dust extraction adaptor when connecting a vacuum extractor.

- Push the ejector (18) into the right-hand side shavings discharge outlet (3) until it clicks in place.
- To remove the ejector, raise the lever (19) and pull out the ejector.

For left-hand side shavings discharge (fig. F2), the ejector must always be used.

- Raise the lever (19) to open the spring-loaded closure (20).

- Push the ejector (18) into the left-hand side shavings discharge outlet (3) until it clicks in place.
- Release the lever.
- To remove the ejector, raise the lever and pull out the ejector.

Dust extraction (fig. G - I)



When appropriate, connect a dust extraction system designed in compliance with the applicable directives regarding dust emission.

The tool is supplied with an adapter for connecting a dustbag or a vacuum extractor. The dustbag is standard for K-models and available as an option for all other models.

- Fit the shavings ejector (18) into the outlet (3) as shown.
- Attach the dustbag (21) to the shavings ejector.
- Alternatively, connect the tool to a vacuum extractor using the adaptor (22).

Assembling the dustbag (fig. I)

- Assemble the dustbag by aligning the open-ended slots (26) with the notches (25) and fitting the (23) deflector onto the bag (24).
- Turn the assembly clockwise to lock it in position.
- Release the loops (27) to unfold the bag.
- Fit the dustbag as described above.

Instructions for use



- Always observe the safety instructions and applicable regulations.

Prior to operation:

- Adjust the depth of cut.
- If necessary, fit and adjust the parallel fence.
- Attach the shavings ejector.
- Use sharp cutting blades only.

Switching on and off (fig. A)

For safety reasons the on/off switch (1) of your tool is equipped with a lock-off button (2).

- Press the lock-off button to unlock the tool.

ENGLISH

- To run the tool, press the on/off switch (1). As soon as the on/off switch is released the lock-off switch is automatically activated to prevent unintended starting of the machine.



Do not switch the tool on or off when the cutters touch the workpiece or other materials.

Planing (fig. A)

- Switch the tool on.
- Slowly move the tool over the workpiece.



The feed speed should not be too high, especially when using the maximum depth of cut and planing width. Remember that several shallow cuts are better than one deep cut.

- Always switch off the tool when work is finished and before unplugging.
- The tool is equipped with a parking shoe (6). After switching off the tool can be put down without waiting for the cutters to come to a standstill.

Rebating

- Fit and adjust the parallel fence.
- Fit and adjust the rebating depth stop.
- Proceed as for planing.

Chamfering edges

The V-grooves in the nose piece of the shoe enable you to chamfer edges.

Emptying the dustbag (fig. G & I)

The amount of shavings collected in the dustbag can be determined from the transparent deflector.

- Remove the dustbag (21).
- Remove the deflector (23) from the bag (24) by turning it counter-clockwise.
- Empty the contents of the bag into a waste container.
- Re-assemble the dustbag by aligning the open-ended slots (26) with the notches (25) and fitting the deflector onto the bag.
- Turn the assembly clockwise to lock it in position.
- Re-fit dustbag.



Dust extraction (fig. G - I)

- When the tool is used indoor for extended periods of time, use a suitable dust extractor designed in compliance with the applicable Directives regarding dust emission.

Consult your dealer for further information on the appropriate accessories.

Maintenance

Your DeWALT power tool has been designed to operate over a long period of time with a minimum of maintenance. Continuous satisfactory operation depends upon proper tool care and regular cleaning.



Lubrication

Your power tool requires no additional lubrication.



Cleaning

Keep the ventilation slots clear and regularly clean the housing with a soft cloth.



Unwanted tools and the environment

Take your tool to an authorized DeWALT repair agent where it will be disposed of in an environmentally safe way.

GUARANTEE

• 30 DAY NO RISK SATISFACTION GUARANTEE •

If you are not completely satisfied with the performance of your DeWALT tool, simply return it within 30 days, complete as purchased, to the point of purchase, for a full refund or exchange. Proof of purchase must be produced.

• ONE YEAR FREE SERVICE CONTRACT •

If you need maintenance or service for your DeWALT tool, in the 12 months following purchase, it will be undertaken free of charge at an authorized DeWALT repair agent. Proof of purchase must be produced. Includes labour and spare parts for Power Tools. Excludes accessories.

• ONE YEAR FULL WARRANTY •

If your DeWALT product becomes defective due to faulty materials or workmanship within 12 months from the date of purchase, we guarantee to replace all defective parts free of charge or, at our discretion, replace the unit free of charge provided that:

- The product has not been misused.
- Repairs have not been attempted by unauthorized persons.
- Proof of purchase date is produced.

This guarantee is offered as an extra benefit and is additional to consumers statutory rights.

For the location of your nearest authorized DeWALT repair agent, please use the appropriate telephone number on the back of this manual. Alternatively, a list of authorized DeWALT repair agents and full details on our after-sales service are available on the Internet at www.2helpU.com.