

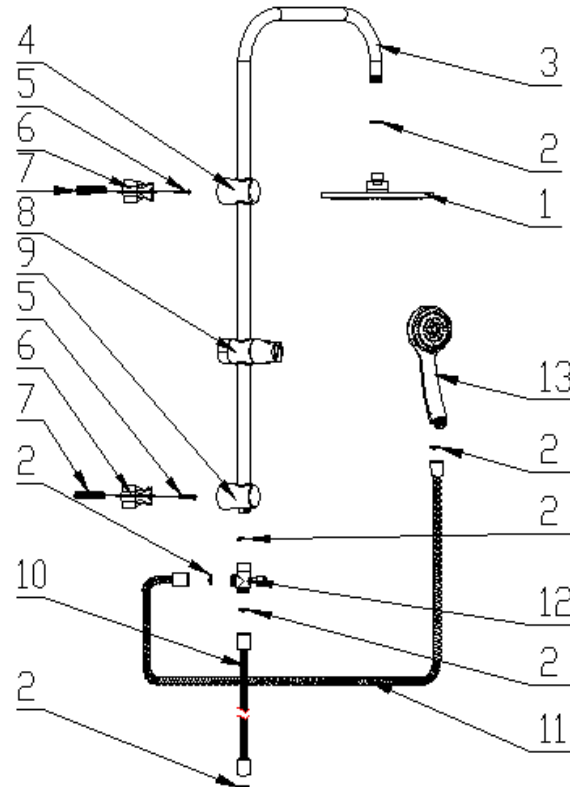

Fitting Instructions

Round Full System



PARTS SUPPLIED

ITEM	DESCRIPTION	QTY
1	Rain Shower Head	1
2	Washer	6
3	Stainless Steel Tube	1
4	Adjustable Wall Bracket Cover	1
5	Wall screw (Ø 4 X 30 mm)	2
6	Wall Bracket	2
7	Wall Plug	2
8	Sliding Cradle	1
9	Stationary Wall Bracket Cover	1
10	50 cm Hose	1
11	150 cm Shower Hose	1
12	Diverter	1
13	Hand Shower	1

TOOLS REQUIRED

power drill
drill bit
Cross head screw driver
pencil
wrench

BEFORE YOU START

- a) Identify all components and check pack contents.
- b) The screws and wall plugs supplied are only suitable for use in solid walls.
- c) Ensure there are no hidden service pipes or cables where you intend to drill.
- d) If drilling into ceramic tiles, please use a ceramic drill bit.
- e) Please be careful of your safety while drilling.
- f) **TURN OFF WATER MAINS SUPPLY.** The mains stopcock is usually situated where the supply enters the building.
- g) It is also recommended that the water heating arrangements are turned off.
- h) Isolate the hot and cold water supply.

INSTALLATION

- 1) Measure the position of both wall brackets (6) and mark position for the holes with a pencil. Suggest the minimum distance from upper hole to lower hole is 600~ 800 mm.
- 2) Drill the wall in marked positions by using the power drill. Then insert wall plugs (7).
- 3) Make sure the screw holes of wall brackets (6) and wall plugs (7) are central. Then put the wall screws (5) through the wall brackets (6) and tighten.
- 4) Insert the stainless steel tube (3) through the hole of the adjustable wall bracket (4), sliding cradle (8) and the rectangular slot on stationary wall bracket (9). The larger opening of the slider cradle (8) should point upward.
- 5) Install the stationary wall bracket cover (9) on the lower wall bracket (6) and ensure the rectangular slot points downward. Install the adjustable wall bracket cover (4) on the upper wall bracket (6).
- 6) Insert the washer (2) into diverter (12) and fasten it onto the stainless steel tube (3).
- 7) Insert the washers (2) into both ends of the 50 cm hose (10). Connect one end of the hose to the bottom of the diverter (12) and the other end to the water inlet.
- 8) Insert the washers (2) into both ends of the 150 cm shower hose (11). Connect one end of the hose to the diverter (12) and the other end to the hand shower (13).

Insert the washer (2) into swivel ball of the rain shower head (1) and fix it onto the stainless steel tube (3).

Note: Operation of Diverter: When pushed in: water diverts to the rain shower head, When pulled out: water diverts to the hand shower. Positioned in the middle, water diverts to both the rain shower head and the hand shower together.

AFTER CARE

- a) To maintain the appearance of this fitting, ensure it is cleaned only using a clean soft damp cloth.
- b) A solution of warm water and mild liquid detergent may be used where necessary and then rinsed thoroughly. Abrasive cleaners or acidic cleaners **MUST NOT BE USED** under any circumstances. Avoid contact with solvents.
- c) Do not lay the hand shower into dirty water.
- d) Please use non-return valves on your shower system.
- e) The minimum operating water pressure is 0.5 bar for satisfactory performance.
- f) Please retain these instructions for future reference.