

TITAN®

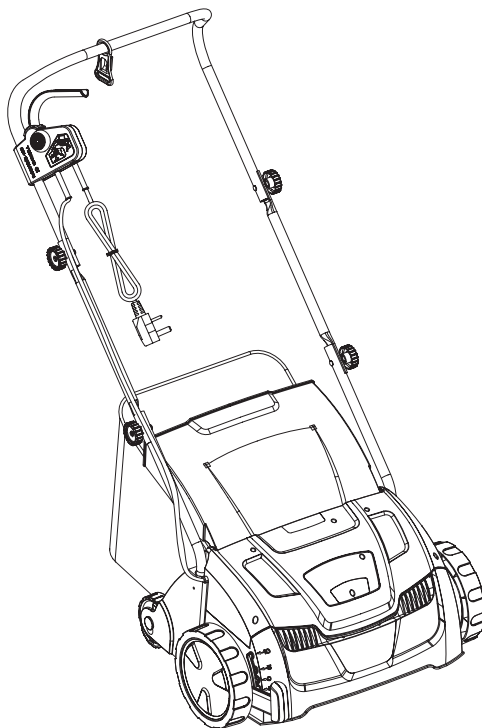

24 month
Manufacturer's
Warranty

SAFETY AND OPERATING MANUAL

Original instructions

SCARIFIER 1300W TTB428GDO



Congratulations on your purchase of a TITAN power tool from Titan Power Tools (UK) Ltd. We want you to continue getting the best performance from it so this handbook includes information on safety, handling and care. Please retain this handbook in case you need to refer to any of the information in the future.

Your TITAN power tool comes with a 24-month guarantee, so should it develop a fault within this period contact your retailer.

GUARANTEE

This **TITAN** product carries a guarantee of 24 months. If your product develops a fault within this period, you should, in the first instance contact the retailer where the item was purchased.

This guarantee specifically excludes losses caused due to:

- Fair wear and tear
- Misuse or abuse
- Lack of routine maintenance
- Failure of consumable items (such as batteries)
- Accidental damage
- Cosmetic damage
- Failure to follow manufacturer's guidelines
- Loss of use of the goods

This guarantee does not affect your statutory rights. This guarantee is only valid in the UK.

For any enquiries relating to the guarantee please refer to your retailer.

SAFETY INSTRUCTIONS



Warnings! Read this instruction carefully before operating this pruner.

Make sure that you are familiar with the controls and properly operate the machine. Following this instructions, you can reduce the risk of fire, electric shock and personal injury.

GENERAL SAFETY INSTRUCTIONS

Read all safety warnings and all instructions. Failure to follow the warnings and instructions may result in electric shock, fire and/or serious injury! Save all warnings and instructions for future reference. The term "garden power tool" in the warnings refers to your mains-operated (corded) garden power tool or battery-operated (cordless) garden power tool!

- 1. This garden power tool is not intended for use by persons (including children) with reduced physical, sensory or mental capabilities, or lack of experience and knowledge, unless they have been given supervision or instruction concerning use of the garden power tool by a person responsible for their safety.**
- 2. Children should be supervised to ensure that they do not play with the garden power tool.**
- 3. The garden power tool must be kept out of reach of children.**
- 4. Store the instruction manual in a location accessible to all users of the garden power tool and always include the instruction manual when passing it on to other users.**
- 5. Instruct inexperienced persons on the safe use of this garden power tool using this instruction manual.**

IMPORTANT READ CAREFULLY BEFORE USE KEEP FOR FUTURE REFERENCE

Training

Read the instructions carefully. Be familiar with the controls and the proper use of the machine.

Preparation

- 1. Never allow people unfamiliar with these instructions or children to use the product.** Local regulations can restrict the age of the operator.
- 2. Never operate the product while people, especially children, or pets are nearby.**
- 3. Keep in mind that the operator or user is responsible for accidents or hazards occurring to other people or their property.**
- 4. Wear ear protection and safety glasses at all times while operating the product.**
- 5. Always wear substantial footwear and long trousers while operating the product.** Do not operate the product when barefoot or wearing open sandals.
- 6. Thoroughly inspect the area where the product is to be used and remove all stones, sticks, wires, bones and other foreign objects.**
- 7. Before using, always visually inspect to see that the tines, bolts are not worn or damaged.** Replace worn or damaged tines and bolts in sets to preserve balance.

SCARIFIER 1300W TTB428GDO

Operation

1. Operate the product only in daylight or in good artificial light.
2. Avoid operating the product in wet grass or take additional precautions to avoid slipping.
3. Always be sure of your footing on slopes.
4. Walk, never run.
5. Always work across the face of slopes, never up and down.
6. Exercise extreme caution when changing direction on slopes.
7. Do not operate the product on steep slopes.
8. Use extreme caution when reversing or pulling the product towards you.
9. **Stop the tines if the product has to be tilted for transportation.** Do not operate the tines when crossing surfaces other than grass, and when transporting the product to and from the working area.
10. **Never operate the product with defective guards,** or without safety devices, for example deflectors and/or grass catchers, in place.
11. Switch on the motor carefully according to instructions and with feet well away from the tine(s).
12. **Do not tilt the product when switching on the motor, except if the product has to be tilted for starting.** In this case, do not tilt it more than absolutely necessary and lift only the part which is away from the operator.
13. Do not start the motor when standing in front of the discharge opening.
14. **Do not put hands or feet near or under rotating parts.** Keep clear of the discharge opening at all times.
15. Never pick up or carry a product while the motor is running.
16. **Stop the motor and disconnect the product from the power supply:**
 - before clearing blockages or unclogging the discharge opening;
 - before checking, cleaning or working on the product;
 - after striking a foreign object. Inspect the product for damage and make repairs before restarting and operating the product;
 - if the product starts to vibrate abnormally (check immediately).
 - whenever you leave the product.
17. Never use the scarifier without the grass catcher bag securely fitted.

Maintenance and storage

1. Keep all nuts, bolts and screws tight to be sure the product is in a safe working condition.
2. Allow the product to cool before storing in any enclosure.
3. Check the grass catcher frequently for wear or deterioration.
4. Examine the product regularly and replace worn or damaged parts for safety.

Additional safety warnings

1. Warning! Beware of sharp tines. Tines continue to rotate after the motor is switched off.
2. Do not use the product if the cords are damaged or worn.
3. **Do not to connect a damaged cord to the supply or touch a damaged cord before it is disconnected from the supply.** A damaged cord can lead to contact with live parts.
4. **Keep extension cords away from the tines.** The tines can cause damage to the cords and lead to contact with live parts.
5. **If operating a garden power tool in a damp location is unavoidable, use a residual current device (RCD) protected supply.** Use of an RCD reduces the risk of electric shock.

Vibration and noise reduction

To reduce the impact of noise and vibration emission, limit the time of operation, use low-vibration and low-noise operating modes as well as wear personal protective equipment.

Take the following points into account to minimize the vibration and noise exposure risks:

1. Only use the product as intended by its design and these instructions.
2. Ensure that the product is in good condition and well maintained.
3. Use correct application tools for the product and ensure they in good condition.
4. Keep tight grip on the handles/grip surface.
5. Maintain this product in accordance with these instructions and keep it well lubricated (where appropriate).
6. Plan your work schedule to spread any high vibration tool use across a number of days.

Emergency

Familiarise yourself with the use of this product by means of this instruction manual. Memorise the safety directions and follow them to the letter. This will help to prevent risks and hazards.

1. **Always be alert when using this product, so that you can recognise and handle risks early.** Fast intervention can prevent serious injury and damage to property.
2. **Switch off and disconnect from the power supply if there is any malfunction.** Have the product checked by a qualified specialist and repaired, if necessary, before you put it into operation again.

Residual risks

Even if you are operating this product in accordance with all the safety requirements, potential risks of injury and damage remain. The following dangers can arise in connection with the structure and design of this product:

1. Health defects resulting from vibration emission if the product is being used over long periods of time or not adequately managed and properly maintained.
2. Injuries and damage to property due to broken application tools or the sudden impact of hidden objects during use.
3. Danger of injury and property damage caused by flying objects.

WARNING! This product produces an electromagnetic field during operation! This field may under some circumstances interfere with active or passive medical implants! To reduce the risk of serious or fatal injury, we recommend persons with medical implants to consult their doctor and the medical implant manufacturer before operating this product!

SCARIFIER 1300W TTB428GDO

VIBRATION

The European Physical Agents (Vibration) Directive has been brought in to help reduce hand arm vibration syndrome injuries to power tool users. The directive requires power tool manufacturers and suppliers to provide indicative vibration test results to enable users to make informed decisions as to the period of time a power tool can be used safely on a daily basis and the choice of tool. Further Advice can be found at www.hse.gov.uk

Vibration total values (triax vector sum) determined according to EN60335-2-92 and EN13683	
Vibration level for operation	Vibration emission value $a_h = 3.591 \text{ m/s}^2$
	Uncertainty $K = 1.5 \text{ m/s}^2$

The declared vibration emission value should be used as a minimum level and should be used with the current guidance on vibration.

Calculating the actual period of the actual period off use can be difficult and the HSE website has further information.

The declared vibration emission been measured in accordance with a standard listed test stated above and may be used to compare one tool with another. The declared vibration emission value may also be used in a preliminary assessment of exposure.

WARNING! The vibration emission value during actual use of the power tool can differ from the declared value depending on the ways in which the tool is used dependant on the following examples and other variations on how the tool is used:

How the tool is used and the materials being ground or cut.

The tool being in good condition and well maintained.

The use the correct accessory for the tool and ensuring it is sharp and in good condition.

The tightness of the grip on the handles.

And the tool is being used as intended by its design and these instructions.

This tool may cause hand-arm vibration syndrome if its use is not adequately managed.

WARNING! identify safety measures to protect the operator that are based on an estimation of exposure in the actual conditions of use (taking account of all parts of the operating cycle such as the times when the tool is switched off and when it is running idle in addition to the trigger time). Note The use of other tools will reduce the users' total working period on this tool.

Helping to minimise your vibration exposure risk.

Maintain this tool in accordance with these instructions and keep well lubricated (where appropriate).

Avoid using tools in temperatures of 10°C or less.

Plan your work schedule to spread any high vibration tool use across a number of days. Health Surveillance.

Health Surveillance.

All employees should be part of an employer's health surveillance scheme to help identify any vibration related diseases at an early stage, prevent disease progression and help employees stay in work.

Double insulation:

The tool is double insulated. This means that all the external metal parts are electrically insulated from the mains power supply. This is done by placing insulation barriers between the electrical and mechanical components making it unnecessary for the tool to be earthed.

Important note:

Be sure the supply is the same as the voltage given on the rating plate. The tool is fitted with a two-core cable and plug. Remove the mains plug from socket before carrying out any adjustment or servicing.

SYMBOLS



Warning



Read the instruction manual



Double insulation



Compliance with relevant safety standards



Wear eye protection

Wear ear protection

Wear breath protection



Gloves with saw protection



Boots with saw protection, steel toecap and non-slip sole



To avoid potential electric shock, do not use the unit in humid or wet conditions



Switch off! Remove plug from mains before cleaning or maintenance



Switch off! Remove plug from the mains immediately if the cable is damaged or cut.



Work across the face of slopes, never up and down.

SCARIFIER 1300W TTB428GDO



Inspect the area where the product is to be used and remove all objects which could be thrown by the product. If objects are hidden while operating stop the motor and remove them.



Beware of sharp tines. Tines continue to rotate after the motor is switched Off. Remove plug from power supply before maintenance or if the power cord is damaged.



Keep supply cord away from the cutting device.



Cutting device continues to rotate after the product is switched off. Wait until all components have completely stopped before touching the product.



Objects thrown by the product could hit the user or other bystanders. Always ensure that other people and pets remain at a safe distance from the product when it is in operation. In general, children must not come near the area where the product is.



Waste electrical products should not be disposed of with household waste, please recycle where facilities exist. Check with your local authority or retailer for recycling advice.



Guaranteed sound power level

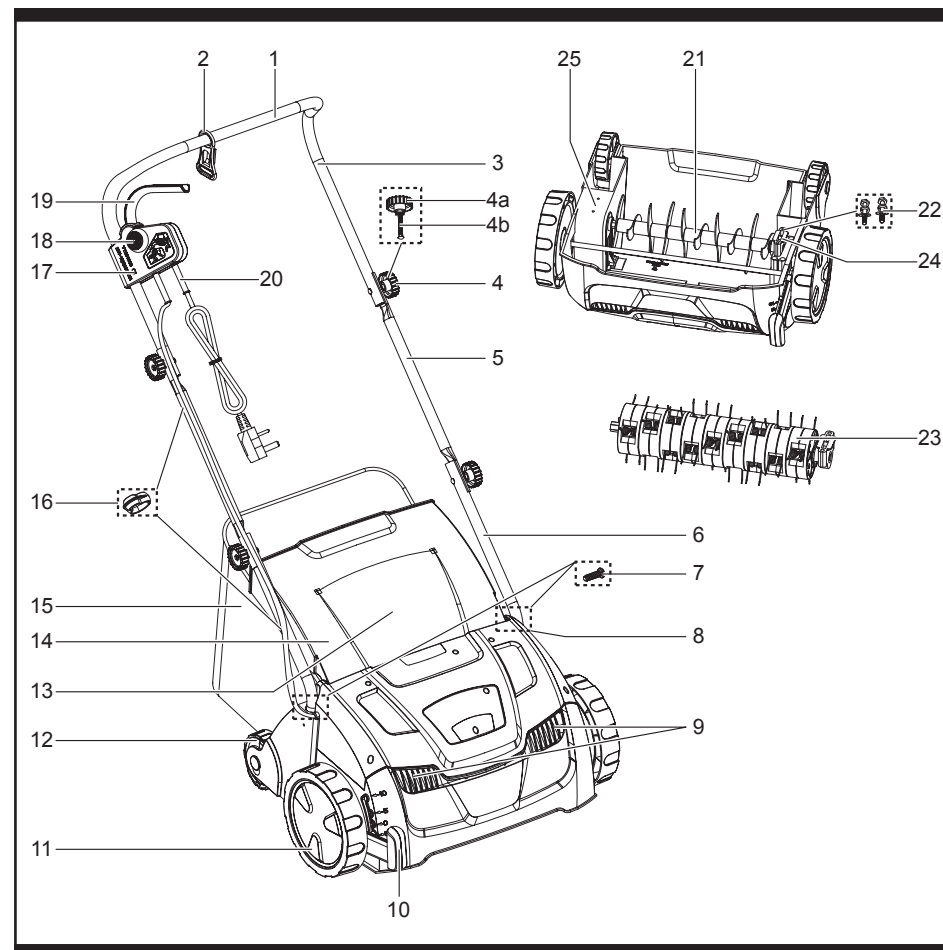

- 1. Handle**
- 2. Cord strain relief**
- 3. Upper handle bar**
- 4. Mounting set (x4) for handle bar**
 - 4a. Knob**
 - 4b. Bolt**
- 5. Middle handle bar**
- 6. Lower handle bar**
- 7. Screw (x2)**
- 8. Support**

SCARIFIER 1300W TTB428GDO

9. Air vents
10. Depth adjustment lever
11. Wheel
12. Castor
13. Discharge opening
14. Deflector guard
15. Grass catcher
15a. Bag
15b. Frame
16. Cord clip (x2)
17. Switch box
18. Lock-off button
19. Start/stop lever
20. Power cable
21. Cutting device (scarifying cylinder)
22. Mounting set for cutting device (x4)
22a. Bolt
22b. Spring washer
23. Cutting device (raking cylinder)
24. Bearing
25. Drive shaft

TECHNICAL DATA

Rated voltage	230-240VAC 50Hz
Rated input power	1300W
No-load speed	2990 /min
Max. cutting width	320mm
Working height range	-10/-5/0/5/10 mm, 5 adjustments
Grass catcher volume	30 L
Protection class	IPX4
Net Weight	15 kg
Cable length	10m

NOISE AND VIBRATION DATA

Measured sound pressure level	84.5 dB(A), K=3 dB (A)
Measured sound power level	97.9 dB(A), K=3 dB (A)
Guaranteed sound power level	104 dB(A)
Vibration:	3.591 m/s ² , K=1.5m/s ²

The declared vibration value has been measured in accordance with a standard test method and may be used for comparing one tool with another.
The declared vibration value may also be used in a preliminary assessment of exposure.

WARNING! The vibration emission value during actual use of the tool can differ from the declared value depending on the ways in which the tool is used. Identify safety measures to protect the operator that are based on an estimation of exposure in the actual conditions of use (taking account of all parts of the operating cycle such as the times when the tool is switched off and when it is running idle in addition to the trigger time).

The sound intensity level for the operator may exceed 85dB(A) and ear protection measures are necessary.

ACCESSORIES

Grass catcher with frame	1SET
Cutting device (raking cylinder)	1PC
Bolt (M6)	4PC
Knob	4PC
Spring washer	4PC
Screw	2PC
Cable clamp	2PC

SCARIFIER 1300W TTB428GDO

OPERATION INSTRUCTIONS

WARNING! Read all instructions carefully. Do not connect the scarifier to mains supply power before it is completely assembled. Always wear gloves during assembly.

1. INTENDED USE

- 1). This scarifier and raker is designated with a rated input of 1300 Watts. Depending on the fitted cutting device this product is either intended for scarifying and removing thatch from lawns or for raking in domestic and hobby gardens.
- 2). When used as a scarifier, this product works by scratching through and between the grass with specially adapted prongs that collect and remove any unwanted parts from the lawn whilst leaving the grass blades intact. At the same time the product scarifies the ground resulting in a better airing.
- 3). When used as a raker, the fine needles will scratch the surface of the lawn while simultaneously picking light debris for better oxygen absorption, airing and draining.
- 4). This product is not to be used in wet weather conditions and may not be used to mow dry, wet or unusually high grass, e. g. pasture grass or for shredding leaves.
- 5). This product is intended for private domestic use only, not for any commercial trade use. It must not be used for any purposes other than those described.

2. ASSEMBLY INSTRUCTIONS

Follow the operating instructions step-by-step and use the pictures provided as a visual guide to easily assemble the machine.

1). HANDLE BAR ASSEMBLY

- a). Align the lower hand bars (6) with the supports (8). Make sure the holes in the lower handle bars correspond those in the supports (8) and secure the bars with one screw (7) each to the support (8). (See Fig. 1a, 1b).

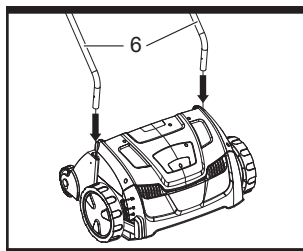

Fig. 1a

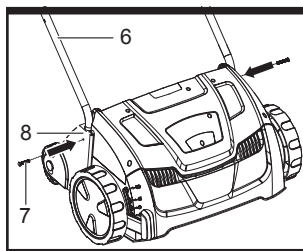

Fig. 1b

- b). Align the middle handle bars (5) to the lower ones (6). Make sure the holes of the handle bars (5, 6) correspond and secure them with one mounting set (4) on each side. (See Fig. 2).

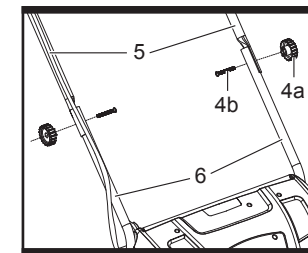

Fig. 2

- c). Slide the cord strain relief (2) onto the upper handle bar (3). (See Fig. 3).

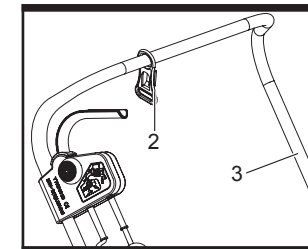

Fig. 3

- d). Align the upper handle bar (3) with the middle handle bar (5) and secure them with one mounting set (4) on each side. (See Fig. 4a,4b).

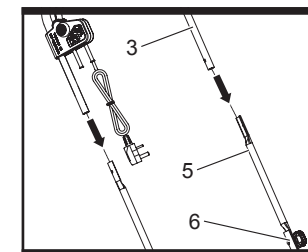

Fig. 4a

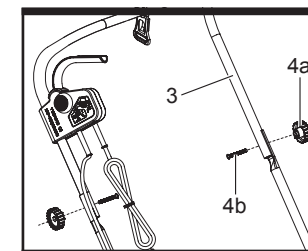

Fig. 4b

SCARIFIER 1300W TTB428GDO

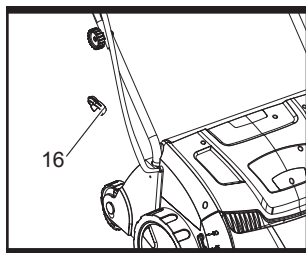

Fig. 5

e). Fix the cord with the cord clips (16) to the handle bar (Fig. 5).

2). GRASS CATCHER ASSEMBLY

WARNING! Do not attempt to use the product without the grass catcher attached. Danger of flying objects!

WARNING! The product must be switched off and the cutting device must have stopped rotating before you attach or empty the grass catcher!

WARNING! Never use the scarifier without the grass catcher bag securely fitted.

NOTE: A full grass catcher will reduce the performance of this product.

Attach the grass catcher (15) to the product before operation.

a). Open the deflector guard (14), hold it in position and align the hooks on the grass catcher (15) with the hinges to hang it onto. (See Fig. 6).

b). Empty the grass catcher (15) frequently during use. Do not wait until it is completely full. We recommend emptying it when it is half full.

c). Lift the deflector guard (14) and pull the grass catcher (15) off the hinges to remove it.

d). Empty the collected material onto a compost heap and reattach it onto the product.

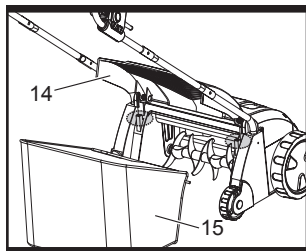

Fig. 6

3. CABLE ROUTING

1). Always route the electric main cable away from the work area to prevent it from coming into contact with the cutting device. Plan your route before starting work. Start your work at the nearest point to the electrical outlet, and work away from it. This will keep the cable away from the cutting device and avoid it being accidentally cut. Keep the cable over your shoulder for added safety.

2). For cord strain relief of the cable, form a loop of the end of the main cable and bring this through the opening at the handle and insert it into the cord strain relief.

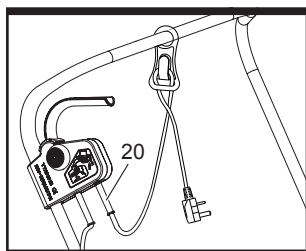

Fig. 7

4. CUTTING DEPTH ADJUSTMENT

WARNING! Always switch the product off and pull the mains plug from power supply before any adjustment.

Adjust the depth according to the needs of your lawn. The most suitable depth depends on the kind of lawn and the actual height of the grass.

1). Push the depth adjustment lever (10) towards the wheel (11), then move it forward or backward to adjust the cutting depth. (See Fig. 8a).

2). Adjust the lever (10) to one out of the five stages. Read the adjusted depth from the scale. (See Fig 8b and table)

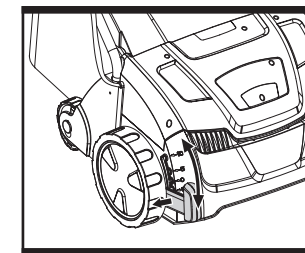

Fig. 8a

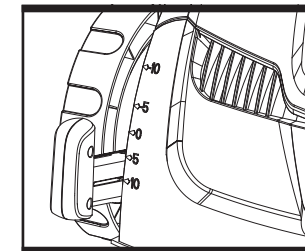

Fig. 8b

Scale / Position	Setting	Application			
		Depth	Scarifying	Depth	Raking
1	transport	-10 mm	for transportation and storage	-10 mm	for transportation and storage
2	minimal	+5 mm	scarifying a young or sensitive lawn, removing thin thatch layers, also use this setting when scarifying a second time in the Autumn	+10 mm	raking a young or sensitive lawn, removing thin thatch layers
3	middle	0 mm	scarifying healthy lawn, removing thatch	+5 mm	raking healthy lawn
4	deep	-5 mm	scarifying healthy lawn, removing thicker thatch	0 mm	raking an unkempt lawn
5	maximal	-10 mm	scarifying an unkempt lawn, removing thick thatch layers	-5 mm	do not use for raking

SCARIFIER 1300W TTB428GDO

5. POWER CONNECTION

WARNING! Before operating the scarifier, ensure that the fastening elements are undamaged. In order to prevent risk, always switch off the motor and pull out the mains plug before starting this task.

The product can be connected to any socket (with 230-240V alternating current). We recommend to always use the appliance via a Residual Current Device (RCD) with a tripping current of max. 30mA.

- 1). Mains leads on scarifier are particularly susceptible to insulation damage. The causes of this include the following:
 - Cut the cable by passing over it with the scarifier.
 - Damage through crushing if the mains lead is routed under doors or windows.
 - Cracks caused by ageing of the insulation sheath.
 - Kinks caused by incorrect fastening or routing of the mains lead.
- 2). Such damaged mains leads should not be used under any circumstances as they may cause fatal injuries due to their damaged insulation sheath.
- 3). Always check the plug and cable and make sure they are in good condition before operation.

6. STARTING AND STOPPING

1). STARTING

The product is fitted with a lock-off button feature. To start the product, simply depress the lock-off button (18) then fully press and hold the start/stop level (19). The lock-off button can now be released. (See Fig.9)

NOTE: It is not necessary to maintain pressure on the lock-off button once the start/stop level is squeezed and the motor is running. The lock-off button is a safety device to avoid accidental start-up of the device.

2). STOPPING

The product will automatically stop once the start/stop level is released. The lock-off button will have to be depressed and the start/stop level squeezed to restart the product motor.

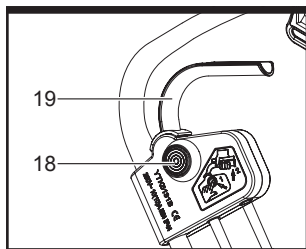

Fig. 9

7. OVERLOAD PROTECTION

The overload protection will be activated in the following circumstances:

- 1). A build up of scarified material around the cutting device.
- 2). If the material scarified is larger than the motor capacity.
- 3). Where there is too much resistance against the cutting device.

When the circuit breaker has been activated switch off the product and disconnect from the power supply.

Let the product cool down and eliminate the cause before using the product again.

8. GENERAL OPERATION

WARNING! In some countries regulations define at what time of the day and on what special days products are allowed to be used and what restrictions apply! Ask your community for detailed information and observe the regulations in order to preserve a peaceful neighbourhood and avoid committing administrative offences!

WARNING! If the product strikes a foreign object stop the motor! Switch the product off, disconnect it from the power supply and let it cool down. Inspect the product thoroughly for damage! Have any damage repaired before restarting!

WARNING! Extensive vibration of the product during operation is an indication of damage! The product should be promptly inspected and repaired!

- 1). Check the product, its power cord and plug as well as accessories for damage before each use. Do not use the product if it is damaged or shows wear.
- 2). Double check that accessories are properly fixed.
- 3). Push the product forward by its handle. Keep the handle dry to ensure safe support.
- 4). Ensure that the air vents are always unobstructed and clear. Clean them if necessary with a soft brush. Blocked air vents may lead to overheating and damage the product.
- 5). Switch the product off immediately if you are disturbed while working by other people entering the working area. Always let the product come to complete stop before putting it down.
- 6). Do not overwork yourself. Take regular breaks to ensure you can concentrate on the work and have full control over the product.
- 7). Mow the lawn before working and fertilise afterwards.
- 8). Make sure that the lawn is clear of stones, sticks, wire or other objects that could damage the product or its motor.

SCARIFIER 1300W TTB428GDO

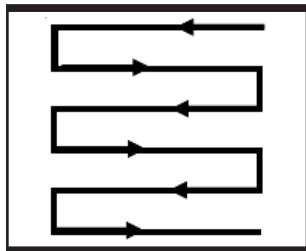

Fig. 10

- 9). Select the suitable cutting depth for the actual grass height.
- 10). Do not work with this product on a wet lawn because it tends to stick to the underbody of the product, preventing the proper discharge of collected material, and it could also cause you to slip and fall.
- 11). Slowly push the product forward. Move the product at appropriate speed. Do not move it too fast to prevent the discharge opening from getting blocked and engine from useless overloading.
- 12). Work in slight overlapping rows. The most effective pattern for scarifying/raking lawns is straight lines along one of the sides. This will keep the rows even and ensures that all the lawn is scarified/raked without missing any spots. (See Fig. 10).
- 13). Circle around flower beds. When reaching a flower bed in the middle of the lawn, make a row or two around the circumference of the bed.
- 14). Pay special attention when changing direction.

SCARIFYING

Consider the weather when scarifying. Scarify the lawn with an increased depth setting during spring time between April and May as the lawn is better able to recover during this season. During a wet summer scarify again in late summer with a decreased depth setting. Do not scarify during periods of hot weather condition. During a dry rainless summer do not scarify a second time in autumn.

RAKING

In order that a healthy lawn can develop in the spring, it is necessary for greater amounts of air to penetrate the area around the roots of the grass. We recommend aerate the lawn every 4 - 6 weeks depending on the state of your lawn.

MAINTENANCE

! WARNING! Before carrying out any repairs or servicing work, you must ensure that the product has been disconnected from the power supply. Repairs and maintenance work other than described within this instruction manual may be performed only by qualified specialist!

1. SERVICE AND STORAGE

To ensure long and reliable service, carry out the following maintenance regularly. Servicing and cleaning work on the product and the removal of the guards may only be carried out after the motor has been switched off and the plug disconnected from the power supply.

- 1). Regularly check for obvious defects such as loose, dislodged or damaged chain and guide bar, loose fixings and worn or damaged components.
- 2). Check that covers and guards are undamaged and correctly fitted. Carry out necessary maintenance or repairs before using the product.
- 3). If the cutting device should happen to fail despite the care taken in manufacturing and testing, repair should be carried out by an authorized specialist.
- 4). Do not clean the product while it is running.
- 5). Ensure that all the fastening elements (screws, nuts, etc.) are tight at all times so that you can safely work with the product.
- 6). Check the product frequently for signs of wear. Replace worn or damaged parts.
- 7). Store your product in a dry place. To ensure a long service life all screw parts should be cleaned and then oiled.
- 8). Clean the product with a brush or cloth. Do not use any solvents or water to remove dirt.
- 9). The component that is subject to most wear is the cutting device. You should therefore check the condition of the cutting device and its mounting at regular intervals.
 - If the cutting device is worn or blunt it must be replaced immediately;
 - If the product starts to suffer from excessive vibrations, this means that the cutting device has not been balanced correctly or has suffered deformation due to impacts. In this case it must be repaired or replaced.

SCARIFIER 1300W TTB428GDO

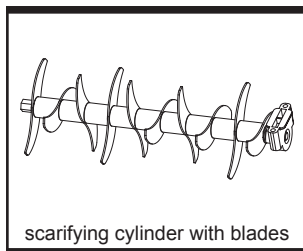

scarifying cylinder with blades

Fig. 11a

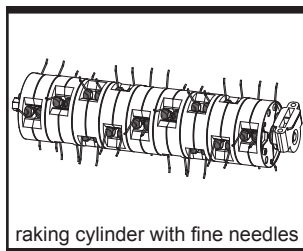

raking cylinder with fine needles

Fig. 11b

2. REPLACING/CHANGING CUTTING DEVICE

WARNING! Always switch the product off, disconnect it from power supply and let it cool down before changing/replacing the cutting device!

WARNING! Always use a correct cutting device according to the intended use! Observe the technical requirements of this product (see section Technical specifications) when purchasing and using cutting devices!

WARNING! Cutting devices are very sharp and become hot during use! Handle them carefully!

Wear safety gloves when handling cutting devices in order to avoid injuries like burns and cuts!

WARNING! Make sure two bolts are tight completely before operate the product, don't operate the product if anyone of bolt is missing or loose.

If bolt thread is damaged, it must be replaced for safety cause. You can replace it with one suitable size.

The product has two functions, scarifying or raking. The scarifying cylinder is preassembled on the product. The raking cylinder is included in the supply box. The cylinder can be changed according to different application. (See Fig. 11a, 11b)

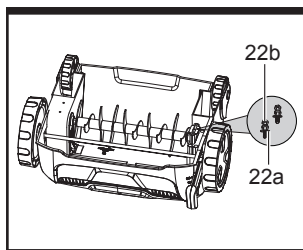

Fig. 12a

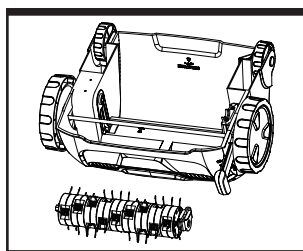

Fig. 12b

- 1). Remove the grass catcher .
- 2). Place the product upside down on a flat stable ground to have access to the underbody.
- 3). Loosen the two bolts (22a) with a suitable wrench, remove them together with the spring washers (22b) and the presently attached cutting device (21 or 23). (See Fig. 12a).
- 4). To remove the cutting device, first lift the bearing and then pull it out from the drive shaft (25).

- 5). Align and insert the respective cutting device: Slide the hex nut into the socket of driving shaft (25) and fix the bearing to the support with the bolts (22a) and spring washers (22b). (See Fig. 12b).

3. AFTER USE

- 1). Switch the product off, disconnect it from the power supply and let it cool down.
- 2). Check, clean and store the product as described below.

4. GRASS CATCHER

- 1). Inspect the grass catcher (15) before each use. Do not use it if you find any damage.
- 2). Clean the grass catcher (15) after operation. Let the grass catcher dry thoroughly before storing to avoid mildew.

5. TRANSPORTATION

- 1). Switch the product off and disconnect it from power supply before transporting it anywhere.
- 2). Attach transportation guards, if applicable.
- 3). Adjust the cutting depth to the transportation stage (refer to "CUTTING DEPTH ADJUSTMENT").
- 4). Always transport the product by its handle.
- 5). Protect the product from any heavy impact or strong vibrations which may occur during transportation in vehicles.
- 6). Secure the product to prevent it from slipping or falling over.

SCARIFIER 1300W TTB428GDO

TROUBLESHOOTING

WARNING! Only perform the steps described in these instructions! All further inspection, maintenance and repair work must be performed by a qualified specialist! Contact a specialist if the problem cannot be solved by yourself!

WARNING! If the product does not perform properly, or sound are abnormal, or motor cannot be started, or stopped as described, or the cutting device does not work properly, or any other irregularity, or malfunction occurs, do not attempt to repair the product by yourself. Please contact helpline or local service center.

Problem	Possible cause	Fault correction
Product does not start	Not connected to power supply	Connect to power supply
	Power cord or plug is defective	Check by a specialist electrician.
	Other electrical defect to the product	Check by a specialist electrician.
	Lock-off button not pressed	Press lock-off button first, then the start/stop lever
Product does not reach full power	Power source (e.g. generator) has too low voltage	Connect to another power source
	Air vents are blocked	Clean the air vents
Poor result	Cutting device is dull/damaged	Replace with a new one
	Scarified material exceeds capacity	Only scarify materials according to capacity of the product
	Scarifying depth is incorrect	Adjust depth

ENVIRONMENTAL PROTECTION



Waste electrical products should not be disposed of with household waste. Please recycle where facilities exist. Check with your Local Authority or retailer for recycling advice.

For further information visit www.recycle-more.co.uk.

UK PLUG REPLACEMENT

The fuse in the main plug of your garden power tool should always be replaced with one of identical rating. Check the voltage given on your garden power tool matches the supply voltage. The garden power tool is supplied with a fitted plug, however if you should need to fit a new plug follows the instruction below.

IMPORTANT:

The wires in the mains lead are coloured in accordance with the following code:

Blue – Neutral

Brown – Live.

As the colours of the wires in the mains lead of this appliance may not correspond with the coloured markings identifying the terminals in your plug, proceed as follows:

The wire which is coloured **blue** must be connected to the terminal which is marked with **N**.

The wire which is coloured **brown**, must be connected to the terminal, which is marked with the letter **L**.

Warning: Never connect live or neutral wires to the earth terminal of the plug. A 13AMP (BS1363/A) plug must be used and a 13AMP fuse must be fitted.

NOTE: If a moulded plug is fitted and has to be removed take great care in disposing of the plug and severed cable, it must be destroyed to prevent engaging into a socket. If the supply cord is damaged it must be replaced by a service agent or a similarly qualified person in order to avoid hazard.

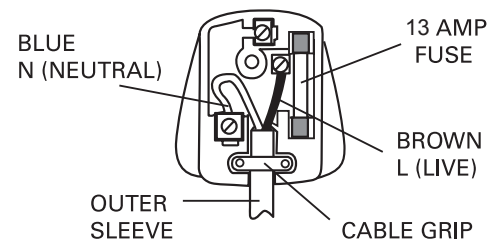

SCARIFIER 1300W TTB428GDO

TITAN®

Declaration of Conformity

We, Importer
TITAN Power Tools (UK) Ltd
Trade House, Mead Avenue, BA22 8RT

Declare that the product
Designation: 1300W SCARIFIER
Model: TTB428GDO

Complies with the following directives:
2006/42/EC - Machinery Directive
2004/108/EC - Electromagnetic Compatibility Directive
2006/95/EC - Low Voltage Directive
2000/14/EC amended by 2005/88/EC - Noise Emission in the Environment by Equipment for Use Outdoors Directive
2002/95/EC - Restrictions of the Use of Certain Hazardous Substances in Electrical and Electronic Equipment
2002/96/EC and 2003/108/EC - Waste Electrical and Electronic Equipment (WEEE)

The conformity assessment followed was according to Annex III of the directive for equipment listed in schedule 1 / article 13 the chosen conformity assessment route Internal control of production (schedule 10 / Annex V)
- Measured Sound Power Level 97.9 dB(A)
- Guaranteed Sound Power Level 104 dB(A)

Standards and technical specifications referred to:
EN60335-1:2002 + A1:2004 + A2:2006 + A11:2004 + A12:2006 + A13:2008 + A14:2011
EN60335-2-92:2005
EN13683:2004 + A3:2009
EN62233:2008
EN55014-1:2006 + A1:2009
EN55014-2:1997 + A1:2001 + A2:2008
EN61000-3-2:2006 + A1:2009 + A2:2009
EN61000-3-3:2008

Authorised signatory and technical file holder

Date: 30/11/11

Signature: *P.C. Harries*

Name / title: Peter Harries / Quality Manager

Titan Power Tools (UK)Ltd. Trade House, Mead Avenue, BA22 8RT



ISSUE DATE: REV1-NOV11

8458-6702

SCARIFIER 1300W TTB428GDO

SCARIFIER 1300W TTB428GDO

