

ENTRANCE DOOR KNOB SET

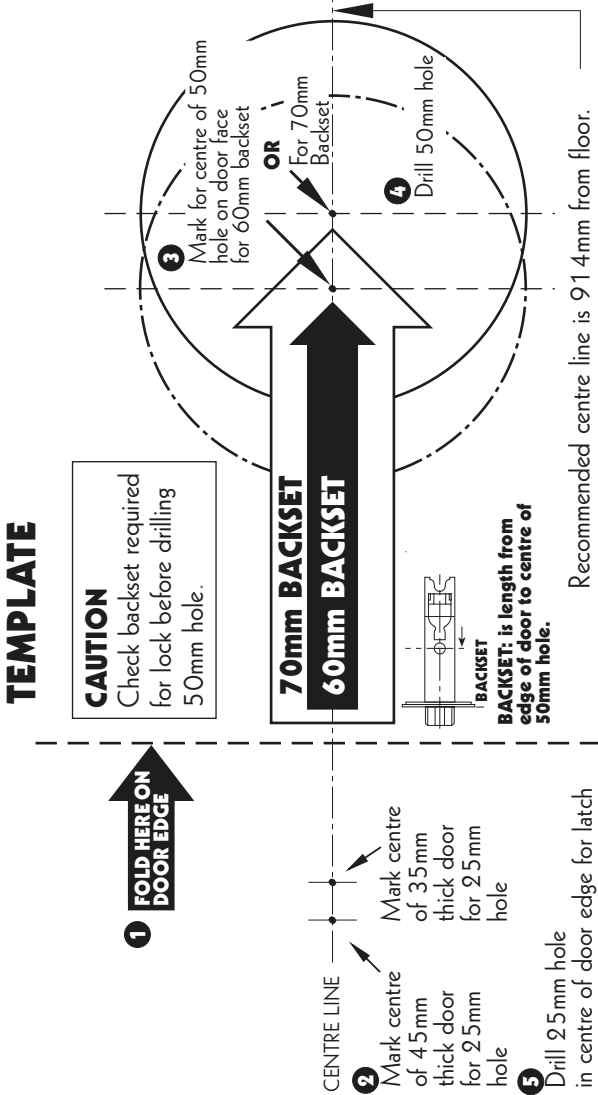

Reduce the risk with ERA PRODUCTS LTD
TECHNICAL HELPLINE
01922 490 050
 Call 01922 490000 for your FREE brochure
 www.era-security.com



TEMPLATE

To fit the door set you will require the following:
 Power drill, 50mm and 25mm drill bits, Hammer, Chisel, Posidriv Screwdriver, Bradawl

Contents
 2 x knobs, latch, striker plate & fixings.

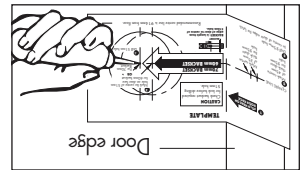

1 Mark Door
 Mark centre of door edge and centre hole on door face using the enclosed template. Using the centre line on the template mark the frame. From this mark measure into the centre of the frame and mark.

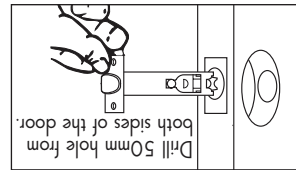

2 Drill Two Holes
 Drill a 50mm hole through the door in the door edge long enough to reach through to the 50mm hole already drilled. Insert the latch into the door and mark around the forend. Recess to a depth of 2mm to allow latch to fit flush against the door. Fit latch using the screws provided.

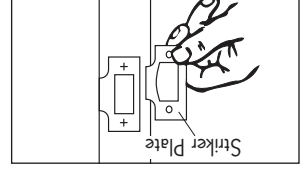

3 Install Striker
 Drill a 25mm hole in the frame where previously marked (if plastic dust pocket is used, chisel frame to suit). Screw striker plate over the hole using screws provided. (recess if necessary)

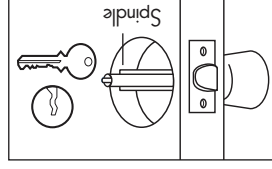

4 Install External Knob
 Insert external handle into the latch ensuring the spindle and stems position correctly into the latch and key hole is as shown. Press flush against the door.

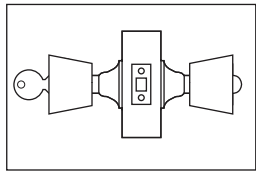

5 Opening test
 Check operation of lock set by turning key or internal thumb turn to ensure handles lock.

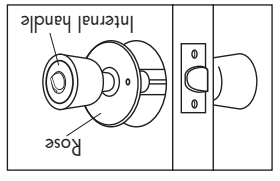

6 Install Internal Assembly
 Insert internal handle over the spindle ensuring the fixing holes on rose are horizontal. Use bolts provided to fasten handles together.