



Door Hinge Bolts

To fit Hinge Bolts you will require -

a tape measure, bradawl, a drill, 9.5mm and 22mm drill bits, screwdriver and pencil.

Easy fitting guide

A Fit hinge bolts 75mm below top hinge and 75mm above bottom hinge.

B Cut out template below. With door open, position template into right angle corner of door edge and door frame. Ensure template sides are flat against both. When using template on doors where hinges are on right side as you face door, pierce template hole centres. Offer template, (top uppermost), with the front of the pack facing you. Use bradawl to mark position of bolt and screw holes as shown on template.

C Drill holes in frame and door to sizes shown on template. Door may require removal for drilling. Screw receiving plate onto door frame (recess if necessary). Tap bolt into door.

Maintenance - use a moist cloth only to clean all types of finish, household abrasives or solvents may affect the surface finish.

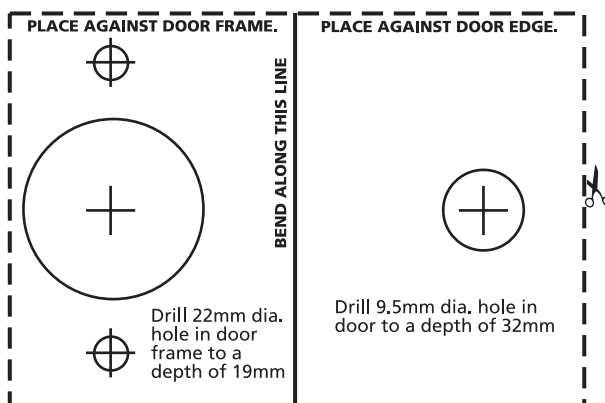
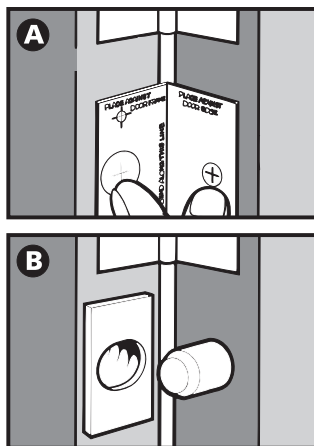

Reduce the risk with ERA PRODUCTS LTD
Call 01922 490000 for your FREE brochure
www.era-security.com

TECHNICAL HELPLINE
01922 490 050