

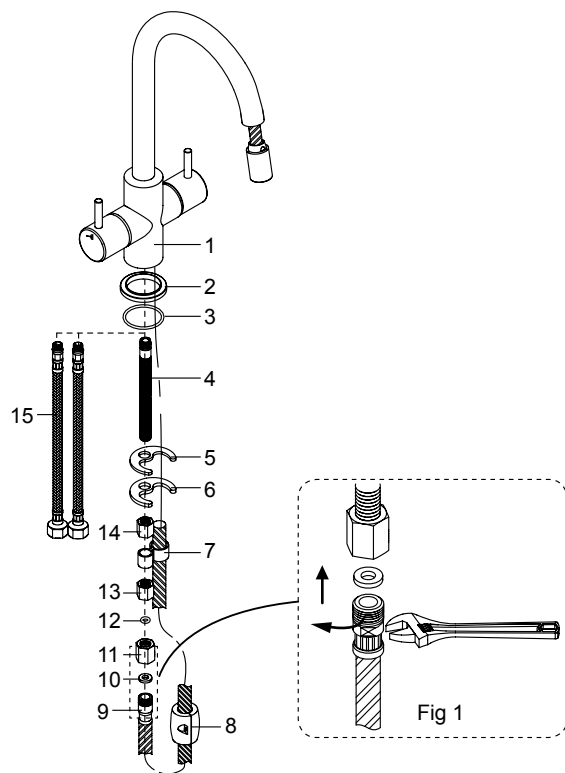

Fitting Instructions

Mono Sink Mixer with Pull-out Spray



PARTS SUPPLIED

ITEM	DESCRIPTION	QTY
1	Tap Body	1
2	Flange	1
3	Anti-Rotational Washer	1
4	Fixing Stud	1
5	Rubber Horseshoe Washer	1
6	Metal Horseshoe Washer	1
7	Hose Retainer	1
8	Counter Balance Weight	1

ITEM	DESCRIPTION	QTY
9	Pull-out Hose	1
10	Sealing Washer	1
11	Adaptor	1
12	O Ring	1
13	Thick Fixing Nut	1
14	Thin Fixing Nut	1
15	Braided Connectors	2

BEFORE YOU START

This tap is suitable for use at water supply pressures of 1 bar (min.) to 5 bar (max.).

If the tap is installed into a low pressure (tank fed) system, the minimum height from the outlet of the nozzle to the underside of the water tank should be at least 5 metres to ensure adequate performance.

This product must be connected to water supply in accordance with the Water Supply (Water Fittings) Regulations 1999, and also to comply with UK Building Regulations. If you are in any doubt about these requirements, contact a qualified plumber, your local Water Company or the Water Regulations Advisory Service (WRAS).

- Identify all components and check pack contents.
- TURN OFF WATER MAINS SUPPLY. The mains stopcock is usually situated where the supply enters the building.
- It is also recommended that the water heating arrangements are turned off.
- Isolate the hot and cold water supply.

INSTALLATION

- Screw Fixing Stud(4) to the Tap Body(1) and tighten.
- Ensure that the Anti_Rotational Washer(3) is fitted to the Flange(2). Fit Flange(2) with Anti_Rotational Washer(3) to the Tap Body(1), Pull_out Hose(9) must be through the hole of the Flange(2).
- Screw 2x Braided Connectors(15) to Tap Body(1) through the hole of the Flange(2) by hand.
- Locate the tap assembly down through the hole of the sink.
- Fit Rubber Washer(5) and Metal Washer(6) onto the threaded end of the Fixing Stud(4), then fit Thick Fixing Nut(14) onto Fixing Stud(4). **DO NOT OVER TIGHTEN.**
- Fit Hose Retainer(7) over the Pull-out Hose(9) and Fixing Stud(4), secure this into position using the Thin Fixing Nut(13).
- Ensure that the O-Ring(12) and Washer(10) are fitted to the Adaptor(11).
- Fit Adaptor(11) to Fixing Stud(4). Do not over tighten.
- Fit Pull_out Hose(9) to the adaptor(11). See Fig 1.
- Fit Counter Balance Weight(8) to Pull_out Hose(9) in the position.
- Connect Braided Connectors(15) to the hot and cold water supplies using suitable plumbing joints.
- Turn on the water supplies. Lift and turn handle both ways a few minutes, to check all joints and connections for leaks.

AFTER CARE

To maintain the appearance of this fitting, ensure it is cleaned only using a clean soft damp cloth. A solution of warm water and mild liquid detergent may be used where necessary and then rinsed thoroughly. Abrasive cleaners or acidic cleaners **MUST NOT BE USED** under any circumstances. Avoid contact with solvents.