

Easiload Barrow-in-a-box Assembly Instructions

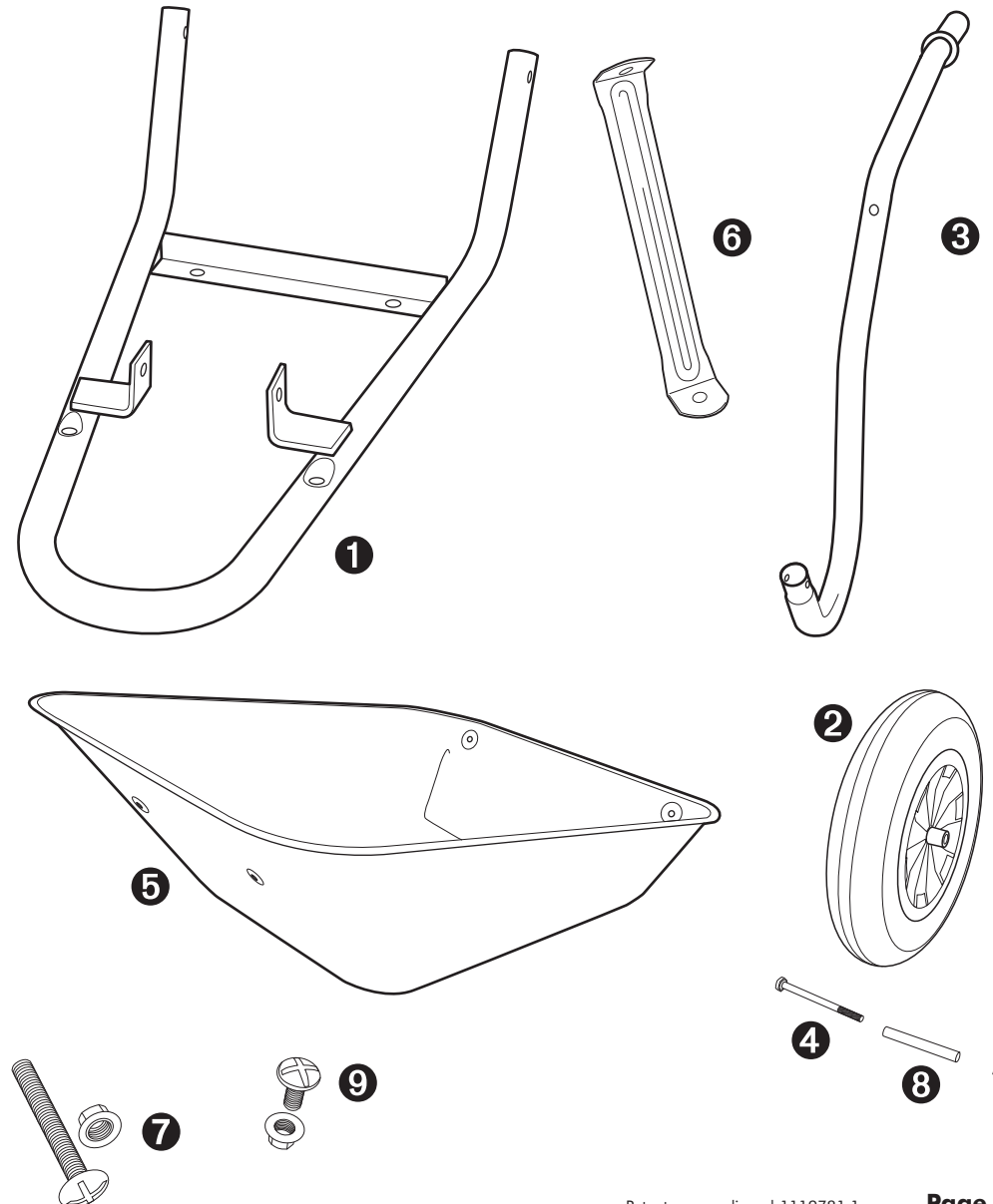
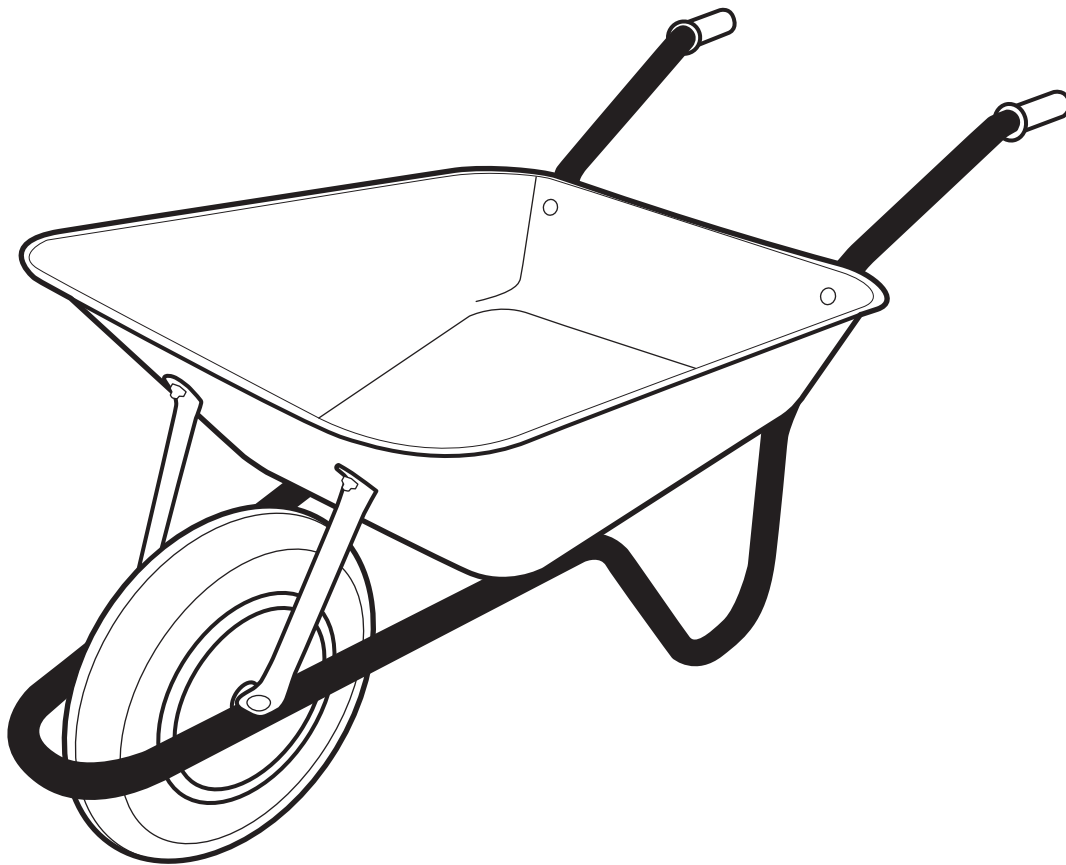

Easiload Product Contents:

Part No.1 - Nose – 1 off

Part No.2 - Wheel – 1 off

Part No.3 - Handle – 2 off

Part No.4 - M10 x 130mm Bolt and Nut – 1 off

Part No.5 - Pan – 1 off

Part No.6 - Front Support – 2 off

Part No.7 - M8 x 40mm Bolts and Nut – 6 off

Part No.8 - Insert Tube – 1 off

Part No.9 - M8 x16 Bolts and Nut – 4 off

If you need help or have received damaged or missing parts call the Customer Helpline: 01902 304002

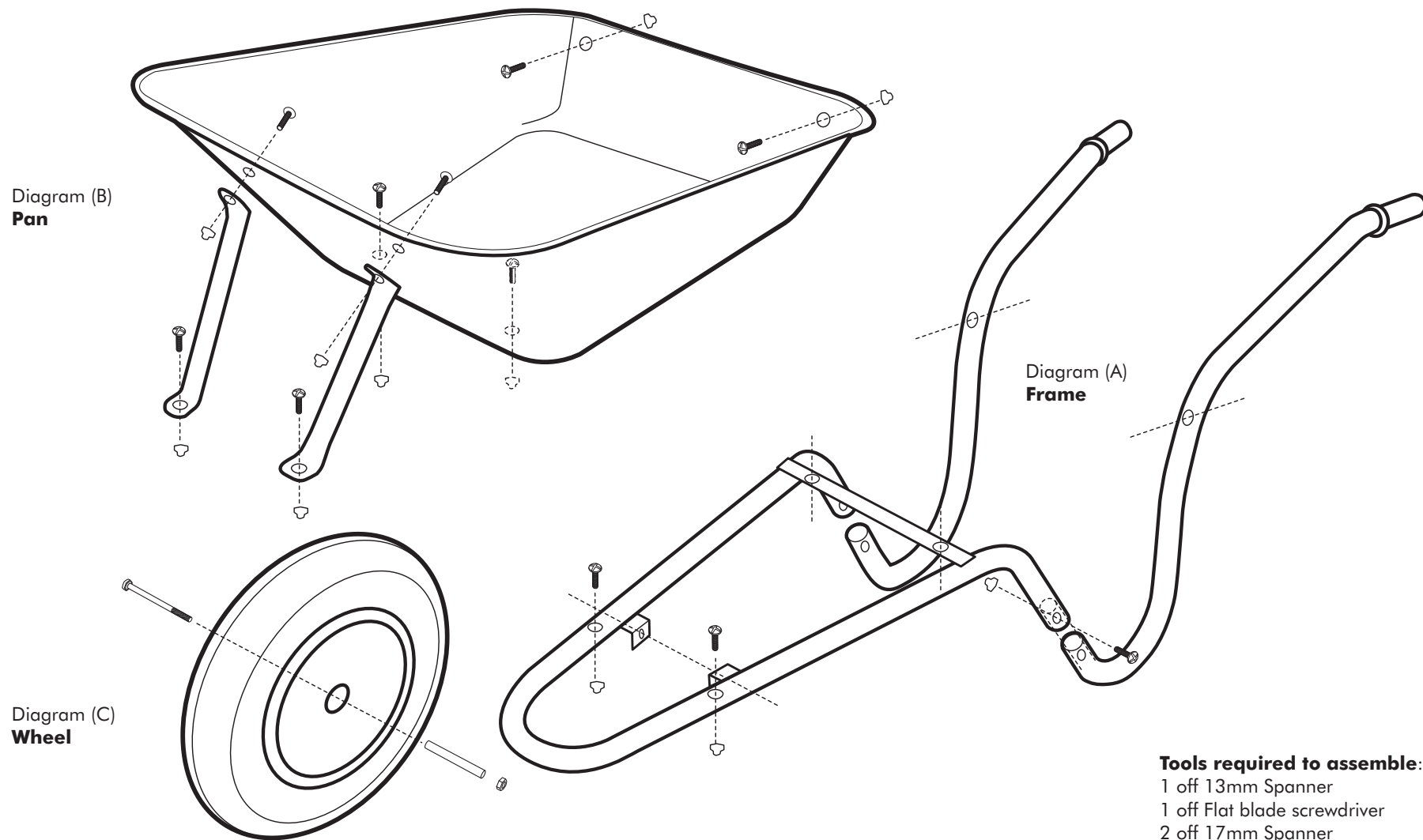
**Tools required to assemble:**

- 1 off 13mm Spanner
- 1 off Flat blade screwdriver
- 2 off 17mm Spanner

NB: Do not tighten fixings until all nuts and bolts are in correct position

- 1) Select a clear area to assemble product. Please check that you have all the fittings listed on page 1 and you have read these instructions fully before starting assembly.
- 2) Assembly - insert handle (3) into nose (1) to form frame. Align holes.
- 3) Fasten frame together by inserting bolt (7) through frame and fasten frame together with nut. Ensure bolt head (7) is on the outside of the frame as per diagram (A).
- 4) Repeat this sequence again on the opposite side of the frame
- 5) Assembly - back of frame to back of pan (5) by aligning pan holes with frame holes. Fasten frame and pan together by inserting bolt (7) through pan and frame. Fasten together with nut. Assembly - front of frame to bottom of pan by aligning pan holes with frame holes.
- 6) Repeat this sequence again on the opposite side of the pan.
- 7) Fasten frame and pan together by inserting bolt (9) through frame and pan and fasten together with nut.
- 8) Repeat this sequence again on the opposite side of the pan.
- 9) Assembly - front support (6) between pan (5) and frame (1,3) by aligning front pan holes with support fitting. Fasten support fitting (6) and pan (5) together by inserting bolt (7) through pan (5) and front support fitting (6). Fasten together with nut.
- 10) Repeat this sequence again on the opposite side of the pan.
- 11) Assembly - front support (6) on frame by aligning frame holes with support fitting holes. Fasten support fitting and frame together by inserting bolt (6) through frame and front fitting and fasten together with nut.
- 12) Repeat this sequence again on the opposite side of the frame.
- 13) Assembly wheel (2) on frame by inserting tube spacer (8) through wheel. Slot wheel (2) between welded wheel brackets. Fasten wheel (2) and frame together using bolt (4) and nut.
- 14) Final assembly stage - check all assembly points and fully tighten all nuts using tools listed above.