

Swann Security (Android)

Have a Smartphone or Tablet? With the Swann Security app, you can turn your mobile device into a monitoring centre for your DVR or NVR. Have the peace of mind that you can monitor your home or business at any time from any place. Best of all, it only takes minutes to get it up and running.

To download the app:

1. Go to your app store and search for “**Swann Security**” or using your mobile device, scan the QR code below.
2. Follow the on-screen instructions to install and accept any license requirements that may appear.
3. After installing Swann Security, locate the app, and tap the icon to run.



You may need to download a QR code reader to your mobile device to scan this QR code.

3

Attention! Make sure you have completed guides 1 and 2 first.

For instructions on the functions available, access the User Manual within the app. You can also download this manual from our website support.swann.com, search for - **Swann Security Manual**.



QSSWANNSECREV6 | © Swann 2023

Registering your Account

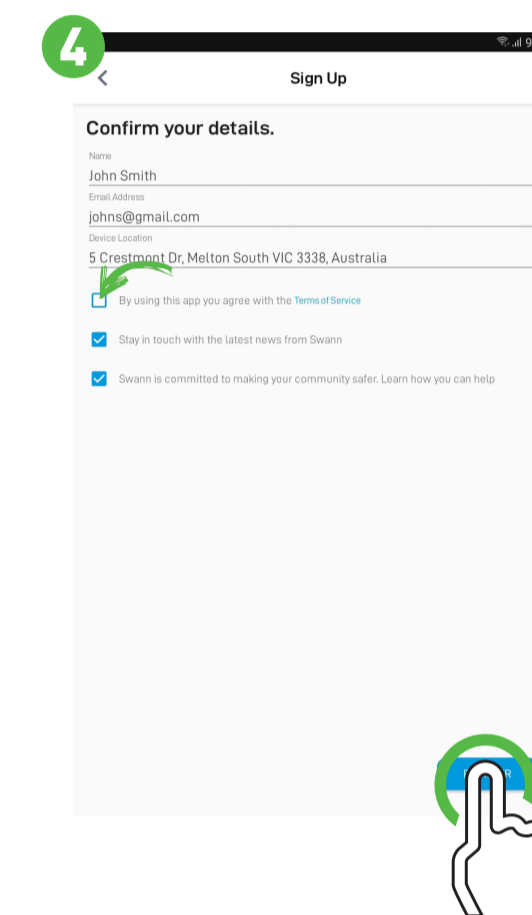
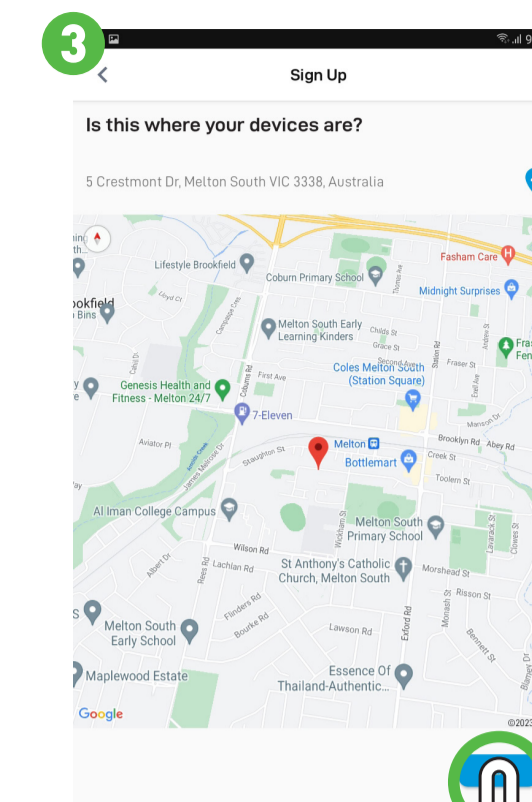
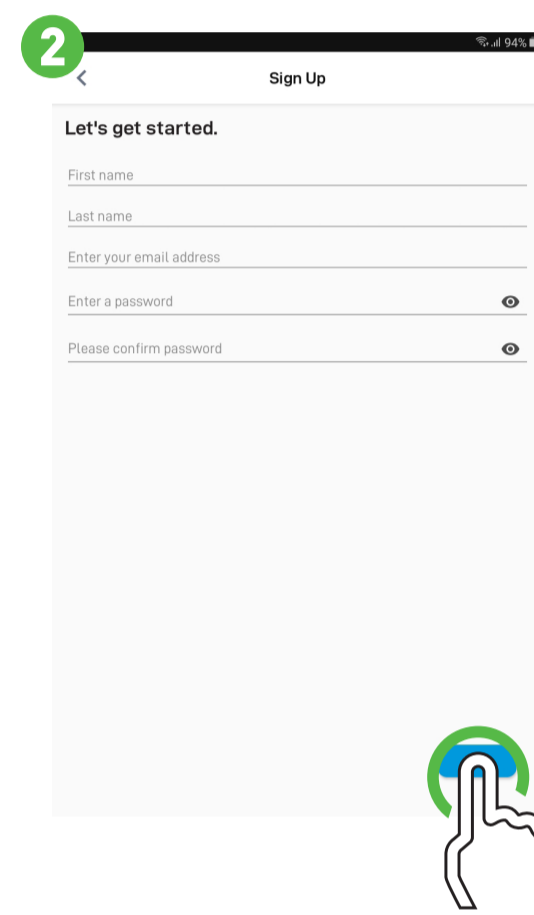
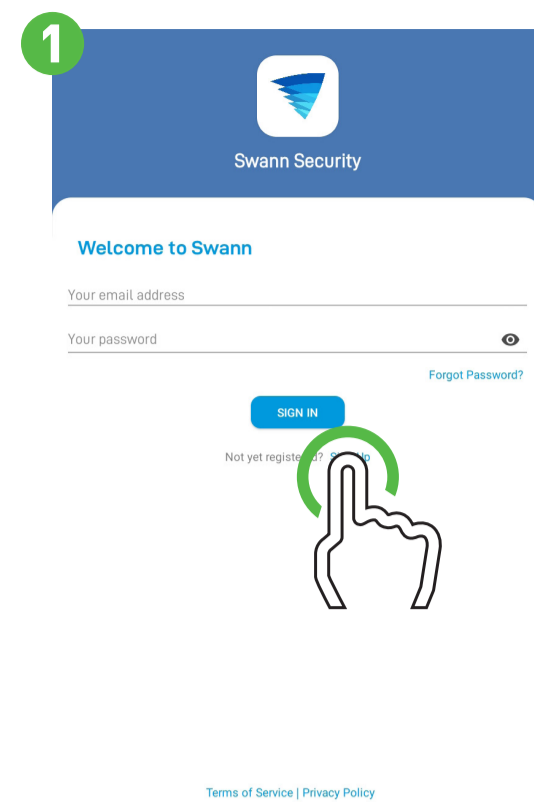

Welcome to Swann. Sign in or register.

If you have already registered an account with the app, sign in with your Swann Security credentials, then skip to step 7. For new users, tap “Sign Up”. Proceed to step 2.

Let's get started.

Enter your first and last name, email address, and password. The password must be a minimum of six characters and must contain a mixture of numbers and letters (use a password that you can remember). Enter your password again to confirm. For safekeeping, write down your password. When finished, tap “NEXT”. Proceed to step 3.

Is this where your devices are?

The app will ask if it can access your device's location, tap “Confirm” then tap “Allow only while using the app” (it does this so it can accurately detect the location of your mobile and DVR or NVR). The app will detect your address. If the address isn't shown, tap the blue icon, input your address, and then tap “DONE”. When finished, tap “NEXT”. Proceed to step 4.

Confirm your details.

Your name, email address, and device location will be shown here. Tap the “Terms of Service” checkbox, then tap “REGISTER”. Proceed to step 5.

Registering your Account

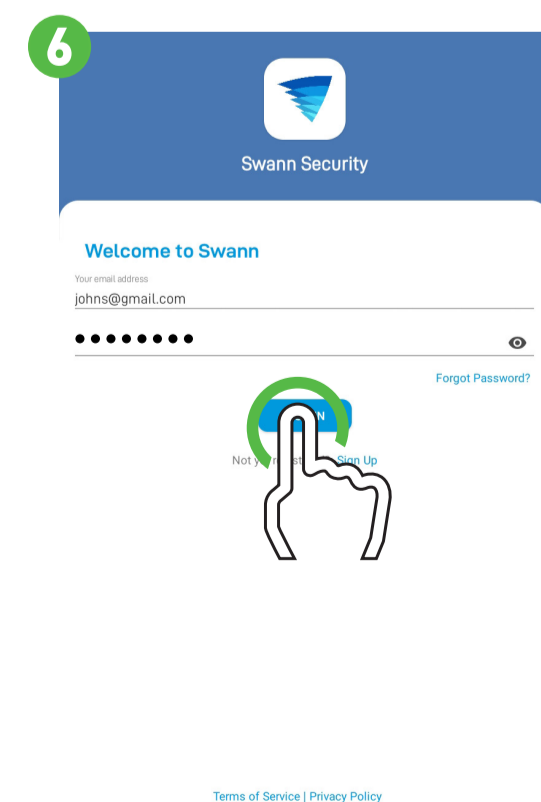
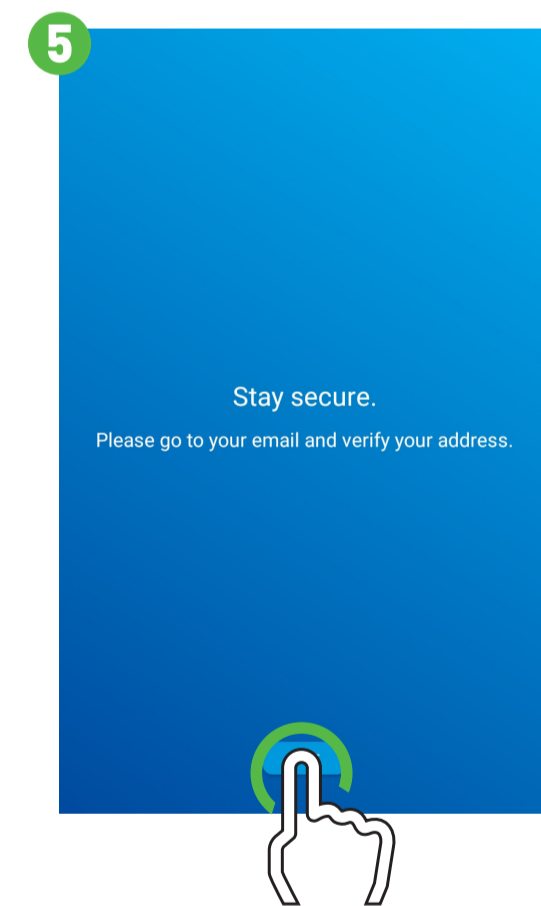

Stay secure.

You will receive an email asking to verify your email address. Go to the email app on your mobile device or computer, open the email, and tap or click the link to verify (if the email hasn't been received, check your junk or spam folder). Once verified, you will receive a welcome email confirming your registration.

When finished, tap “DONE”. Proceed to step 6.

You will be taken back to the sign-in page. Upon verification, enter your email address and account password, then tap “SIGN IN”. Proceed to step 7.

Pairing your Device

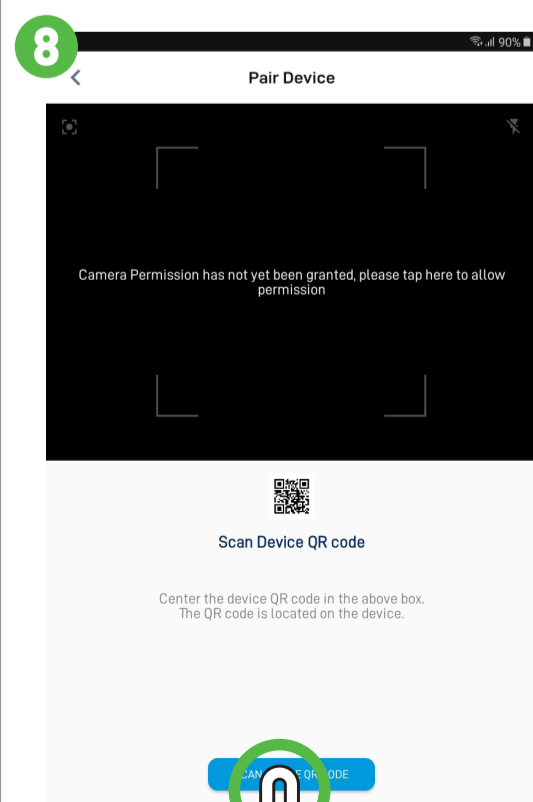
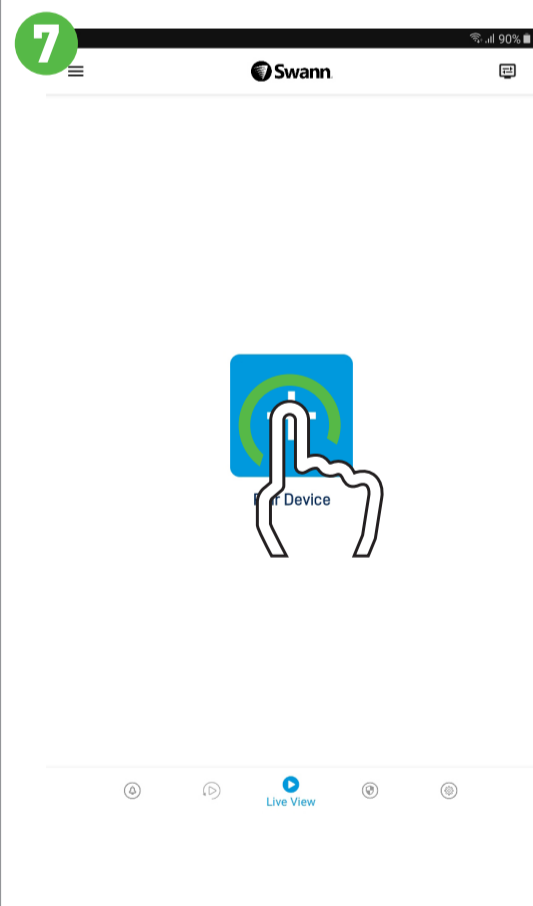

After sign in, to pair your DVR or NVR to your account, you need to scan the device's QR code. Check that your DVR or NVR is connected to your router, so it has access to the internet.

When ready, tap “Pair Device”, then tap “START”.

Proceed to step 8.

Tap “SCAN DEVICE QR CODE”. The app will ask if it can take pictures and record video, tap “Allow”.

Scan the QR code sticker on your DVR or NVR with your mobile device. When the QR code has successfully scanned, proceed to step 9.

Pairing your Device

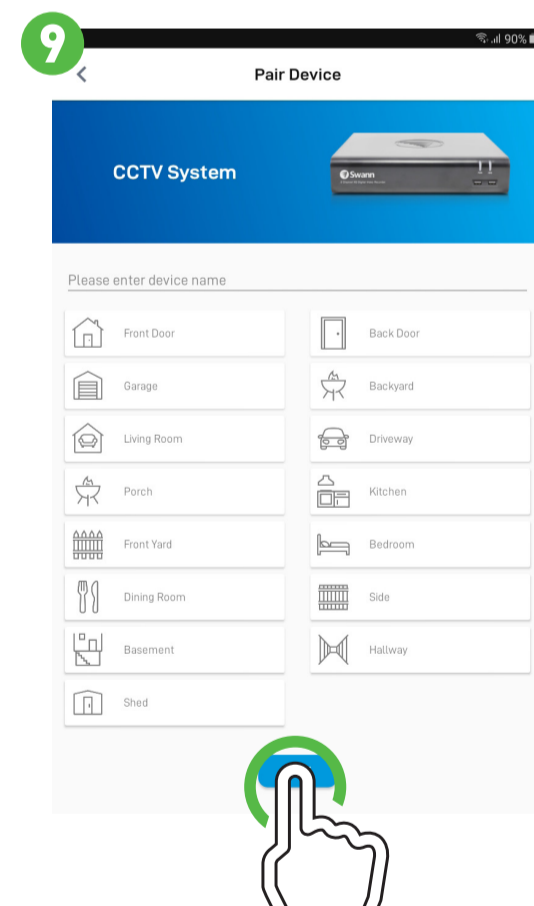

Tap on where the item was purchased.

Enter a device name for your DVR or NVR, “My DVR” for example, or tap on one of the relevant locations listed.

When finished, tap “NEXT”.

Proceed to step 10.

User Name: The default user name for your DVR or NVR is admin, tap to enter.

Password: Enter the password created during the Startup Wizard on your DVR or NVR (there is no default password).

Port number: Leave the default setting (unless instructed to change it by Swann Technical Support).

When finished, tap “NEXT”.

Your device is now linked to your Swann Security account - tap “DONE” to finish.



1. Tap to open the Menu. You can edit your account profile, pair a new device, view notifications, read the user manual, and more.

2. Tap to configure settings for the Live View tab. You can hide device tiles and customize the order of device tiles according to your preferences.

3. Tap to toggle the layout of the camera (channel) tiles in the viewing area.

4. Tap to view the camera full screen and to display controls such as taking a snapshot, starting a recording, enabling the camera's microphone, alarm & pan-tilt controls (if supported), and changing the display aspect ratio and stream quality. Turn your mobile device horizontally to view the camera full screen.

5. Tap to access the Notifications screen to view and manage notifications.

6. Tap to access the video activity timeline to search and view events on your DVR or NVR.

7. Tap to enter the Modes tab.

8. Tap to access device & camera settings. From here, you can change the device name, motion settings, siren settings, view technical information about your device, and more.

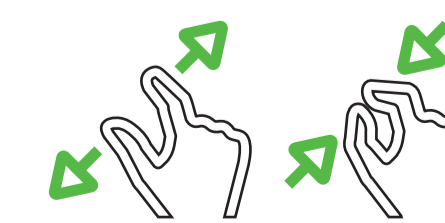

When viewing a camera full screen (as per instruction 4), use the spread and pinch gestures to zoom in or out. When zoomed in, tap and hold the image to move around within the Live View. This works when holding your mobile device horizontally or vertically.

Swann Security (iOS)

Have a Smartphone or Tablet? With the Swann Security app, you can turn your mobile device into a monitoring centre for your DVR or NVR. Have the peace of mind that you can monitor your home or business at any time from any place. Best of all, it only takes minutes to get it up and running.

To download the app:

1. Go to your app store and search for **“Swann Security”** or using your mobile device, scan the large QR code below.
2. Follow the on-screen instructions to install and accept any license requirements that may appear.
3. After installing Swann Security, locate the app, and tap the icon to run.



You may need to download a QR code reader to your mobile device to scan this QR code.

3

Attention! Make sure you have completed guides 1 and 2 first.

For instructions on the functions available, access the [User Manual within the app](#). You can also download this manual from our website support.swann.com, search for - **Swann Security Manual**.



QSSWANNSECREV6E | © Swann 2023

Registering your Account

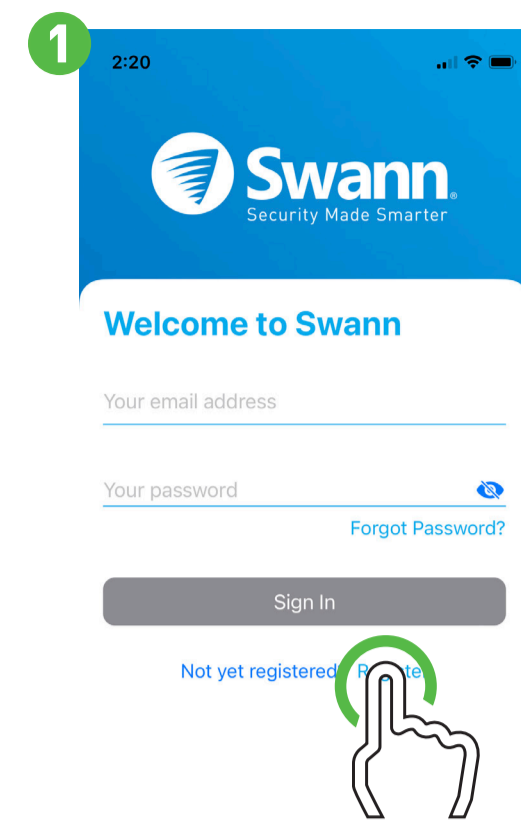

Welcome to Swann. Sign in or register.

If you have already registered an account with the app, sign in with your Swann Security credentials, then skip to step 7.

For new users, tap “Register”.

Proceed to step 2.

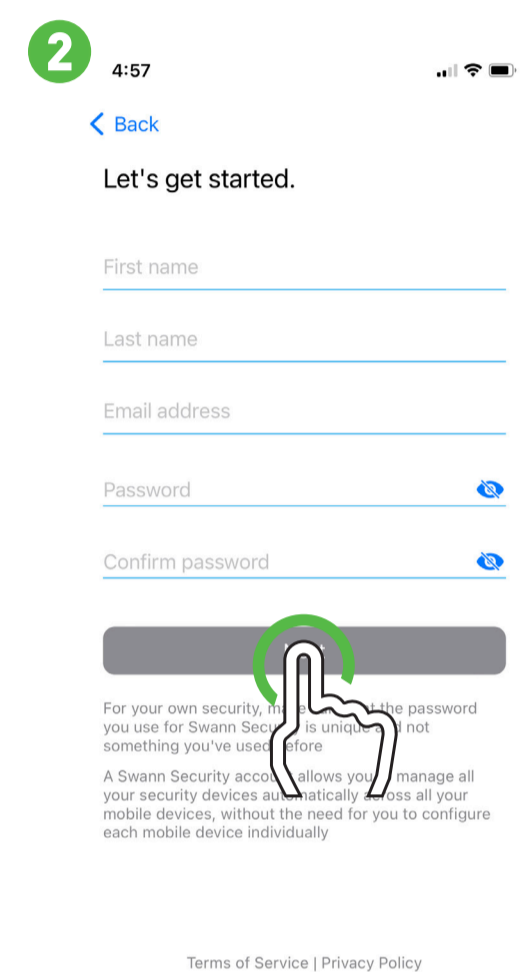

Let's get started.

Enter your first and last name, email address, and password. The password must be a minimum of six characters and must contain a mixture of numbers and letters (use a password that you can remember). Enter your password again to confirm. For safekeeping, write down your password.

When finished, tap “Next”.

Proceed to step 3.

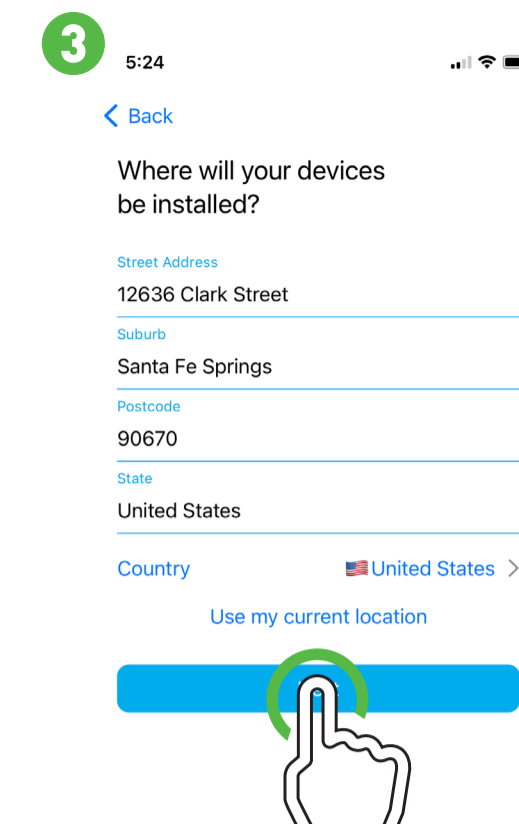

Where will your devices be installed?

Input the address of your DVR or NVR or tap “Use my current location”. If using this option, tap “Allow While Using App” (it does this so it can accurately detect the location of your mobile and DVR or NVR).

The app will detect your address. If the address isn't correct, tap each field to edit.

When finished, tap “Next”.

Proceed to step 4.

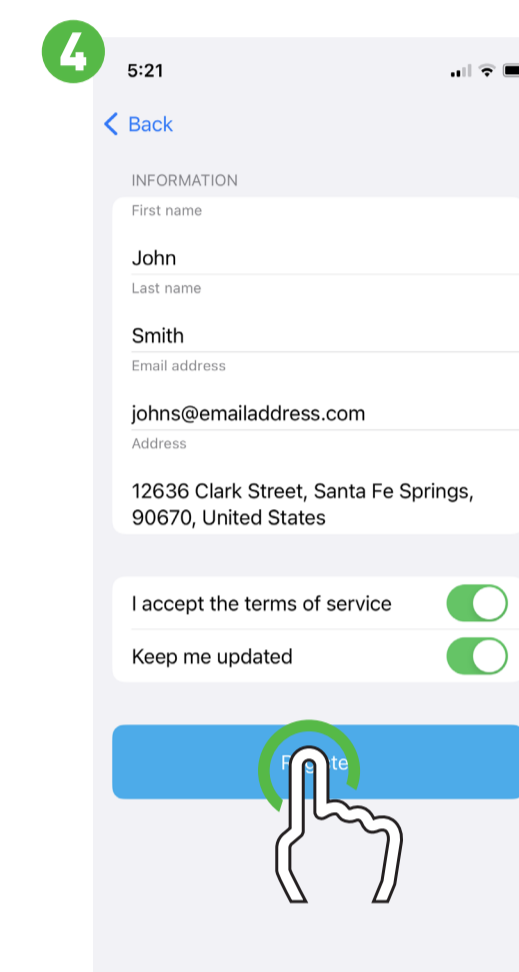

Last step.

Your first and last name, email address and location will be shown here.

Tap “Register”.

Proceed to step 5.

Registering your Account

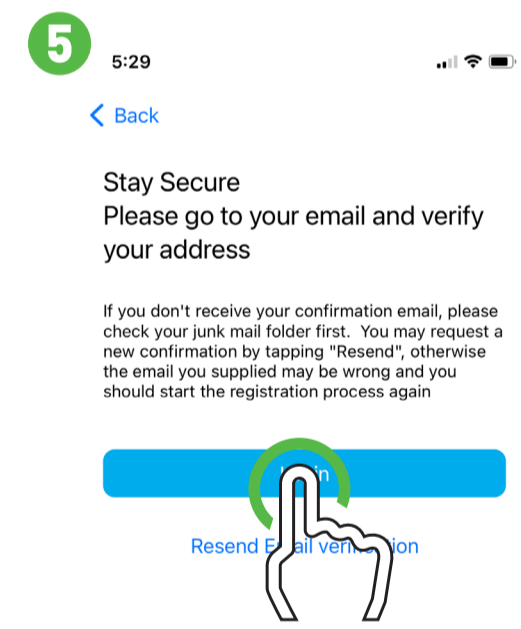

Stay Secure.

You will receive an email asking to verify your email address. Go to the email app on your mobile device or computer, open the email, and tap or click the link to verify (if you haven't received the email, check your junk or spam folder). Once verified, you will receive a welcome email confirming your registration.

When finished, tap “Login”.

Proceed to step 6.



You will be taken back to the sign-in page. Upon verification, enter your email address and account password, then tap “Sign In”.

Proceed to step 7.

Pairing your Device

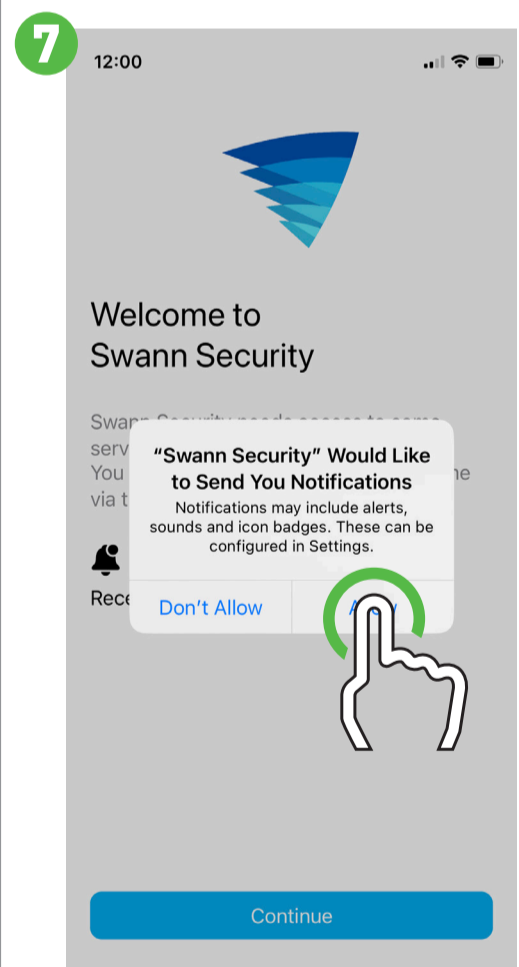

After sign-in, the app will request to send notifications - tap “Continue” then tap “Allow”.

Proceed to step 8.

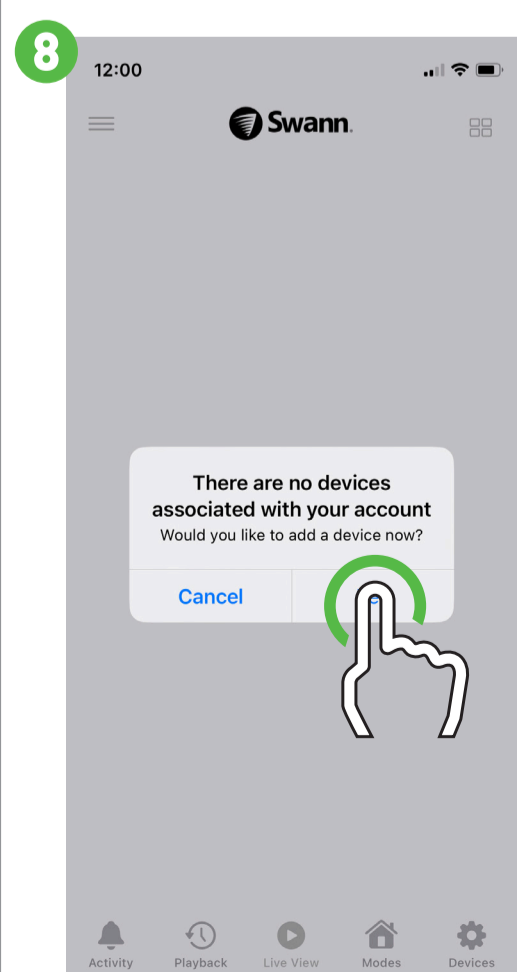

You will now be requested to add a device - tap “Yes”, then tap “Start”.

The app will request to find and connect to devices on your local network - tap “Allow”.

The app will now request to access the camera on your mobile device - tap “OK”.

Tap to scan the QR code sticker on DVR or NVR with your mobile device. After scanning the QR code, proceed to step 9.

Pairing your Device

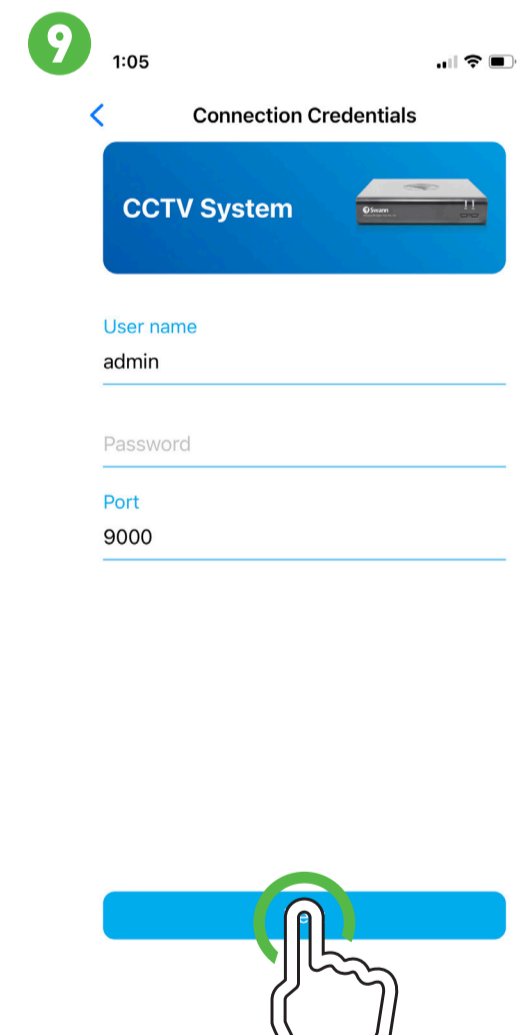

User name: The default user name for your DVR or NVR is admin - tap to enter.

Password: Enter the password created during the Startup Wizard on your DVR or NVR (there is no default password).

Port: Leave the default setting (unless instructed to change it by Swann Technical Support).

When finished, tap “Next”.

Proceed to step 10.

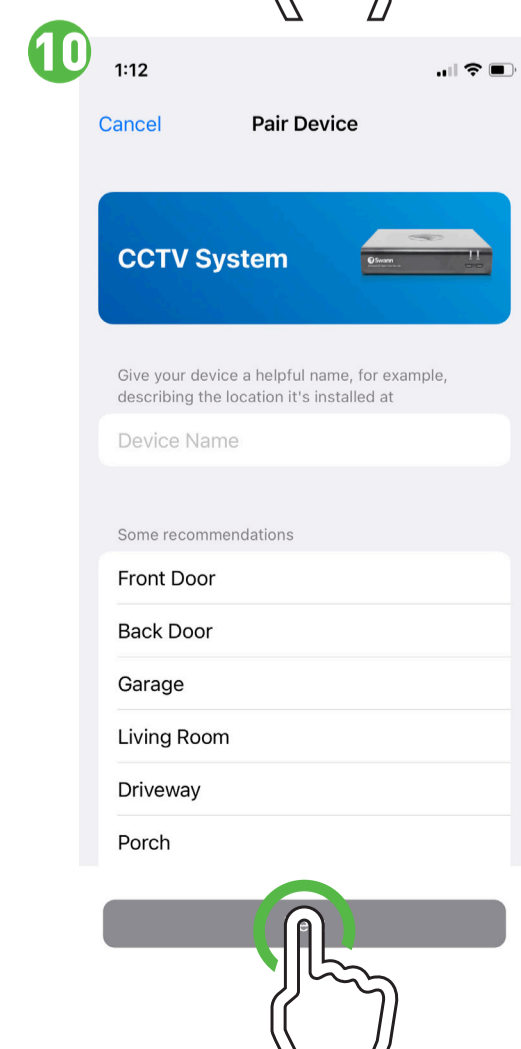

Enter a device name for your DVR or NVR, “My DVR” for example, or tap on one of the locations listed. When finished, tap “Next”.

Tap on where the item was purchased.

Your device is now linked to your Swann Security account - tap “Done” to finish.

There is the option of starting your Secure+ 90-day free trial - click “Activate 90-Day Free Trial” or “Skip” to activate it later.

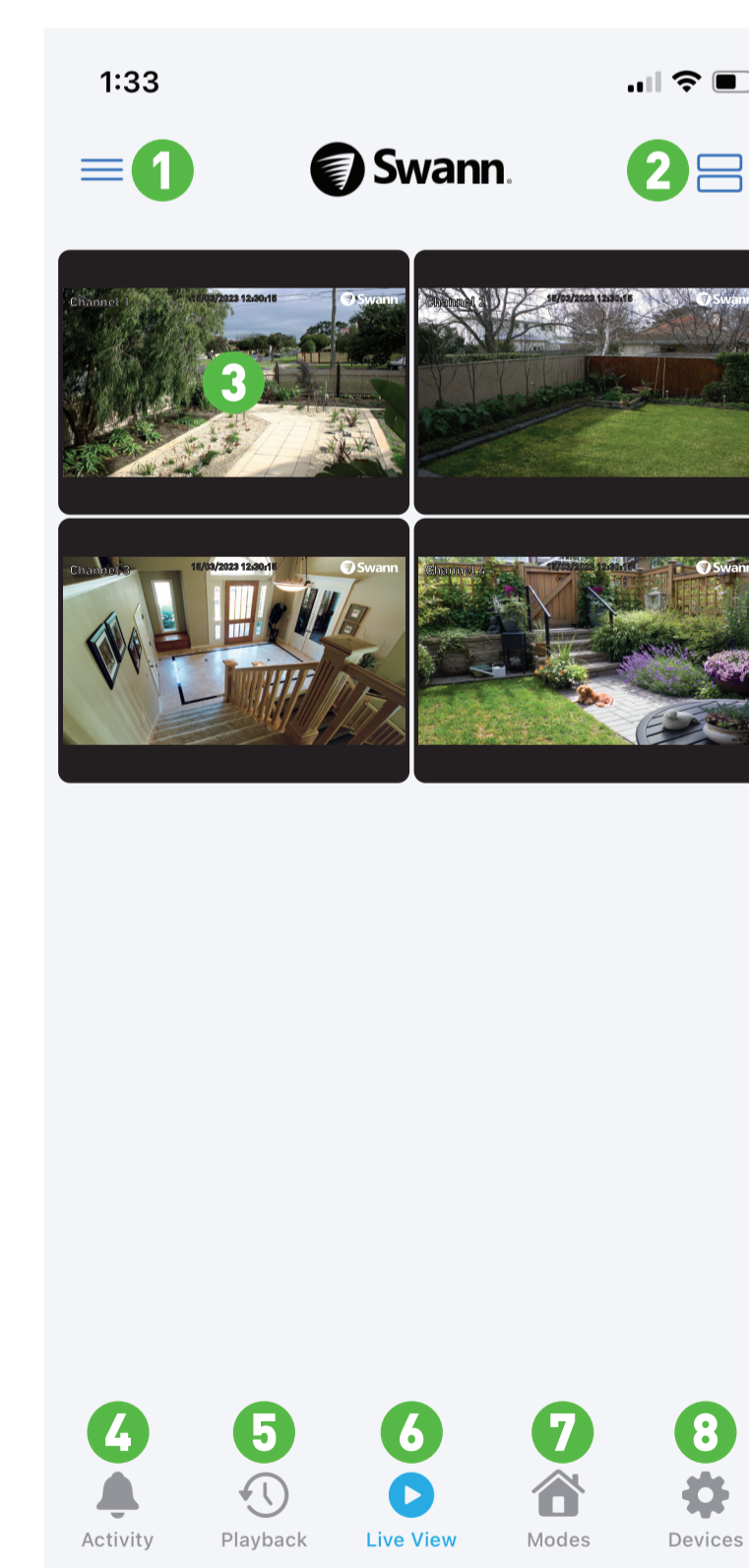

1. Tap to open the Menu. You can edit your account profile, pair a new device, read the user manual, and more.

2. Tap to toggle the layout of the camera (channel) tiles in the viewing area.

3. Tap a camera to display controls such as taking a snapshot, starting a recording, enabling the camera's microphone, alarm & pan-tilt controls (if supported), and changing the display aspect ratio and stream quality. Turn your mobile device horizontally to view the camera full screen.

4. Tap to access the Notifications screen to view and manage notifications.

5. Tap to access the video activity timeline to search and view events on your DVR or NVR.

6. Tap to access or return to Live View mode to view live video from your cameras.

7. Tap to enter the Modes tab.

8. Tap to view Device Settings. You can check the status of your cameras, display the technical details of your security device, or remove the device from your account.

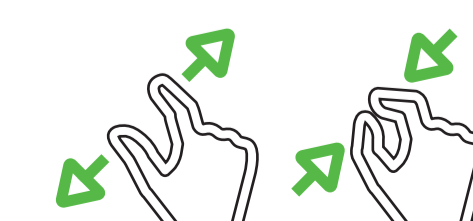

When viewing a camera full-screen, use the spread and pinch gestures to zoom in or out. When zoomed in, tap and hold the image to move around within the Live View. This works when holding your mobile device horizontally or vertically.