

EAN :3663602798019

PTC450E

ORIGINAL INSTRUCTIONS



	Safety Instructions	7
	Product description	15
	Assembly	17
	Use	20
	Care & maintenance	22
	Guarantee	25
	EC declaration of conformity	26



WARNING! Please read all safety warnings carefully and be sure that they are fully understood before handling the tool.

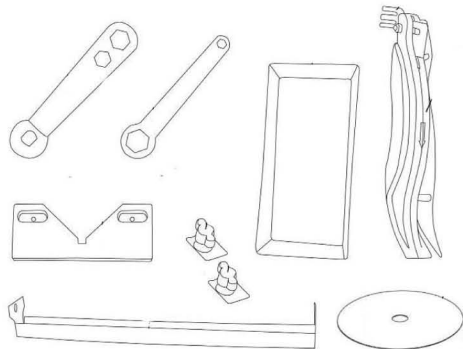
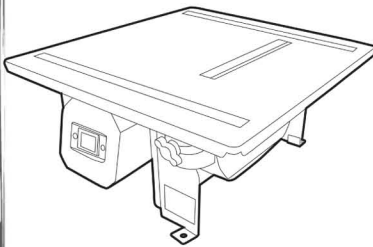



Product description

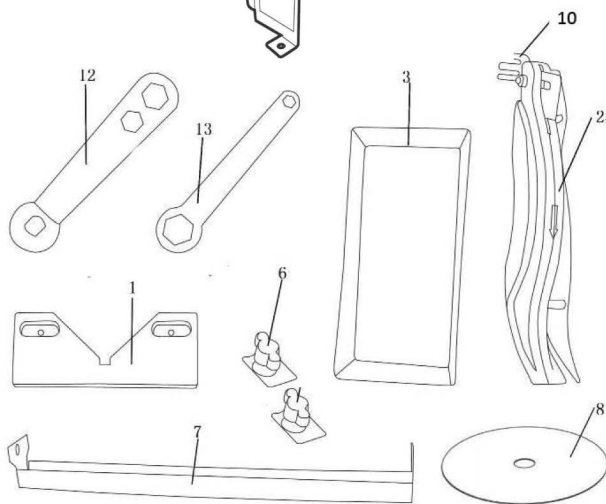
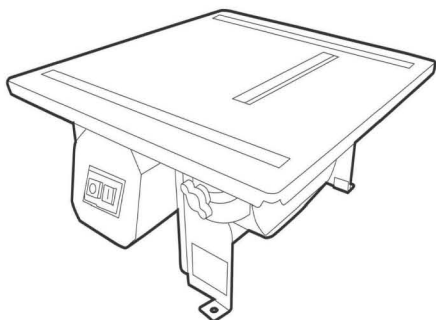
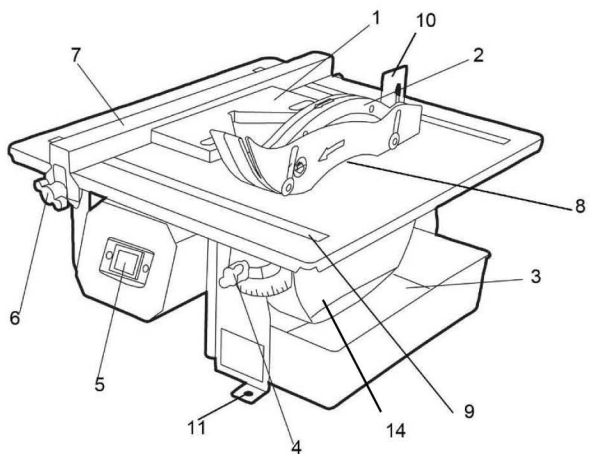

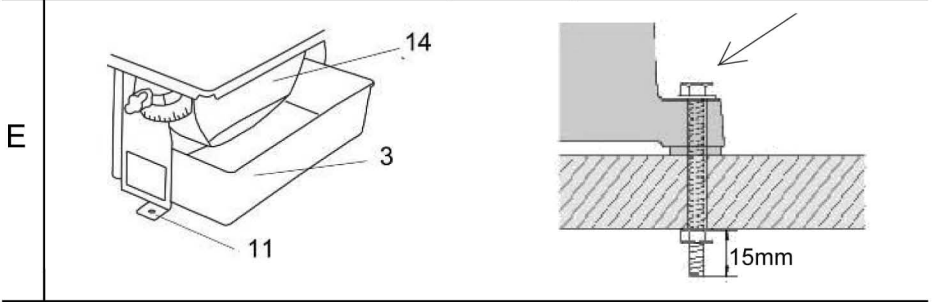
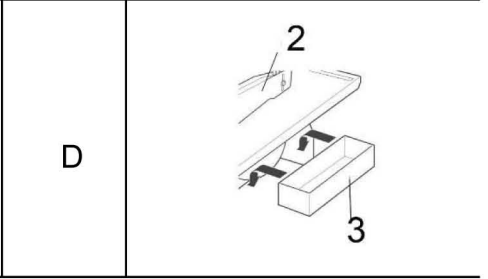
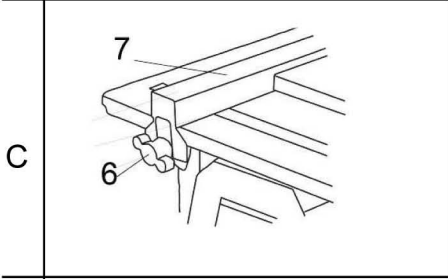
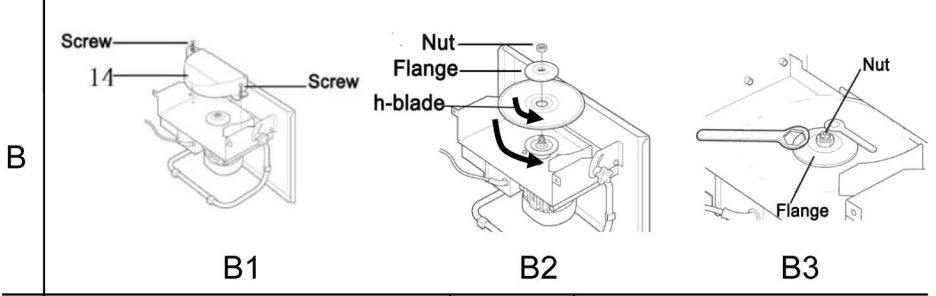
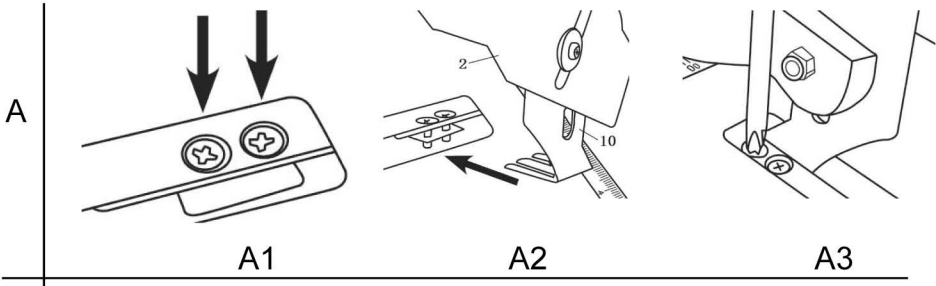

F

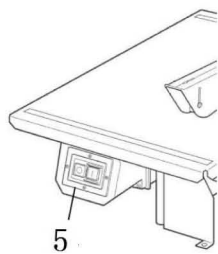

G

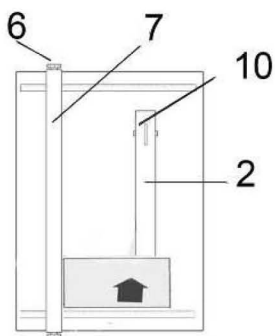

H

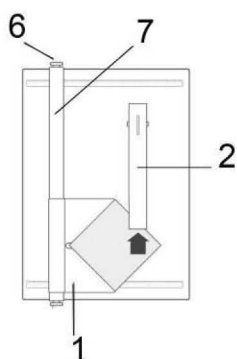

I

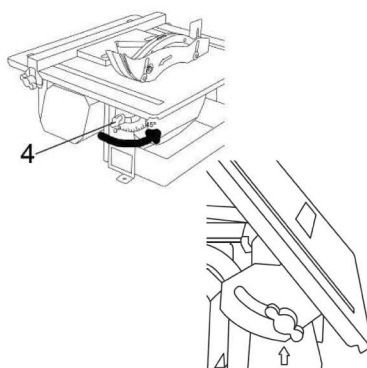



Safety Instructions

GENERAL POWER TOOL SAFETY WARNINGS



WARNING! When using electric tools basic safety precautions should always be followed to reduce the risk of fire, electric shock and personal injury including the following. Read all these instructions before attempting to operate this product and save these instructions”.

WORK AREA SAFETY

1. **Keep work area clear.** Clutter areas and benches invite injuries.
2. **Consider work area environment.** Do not expose tools to rain. Do not use tools in damp or wet locations. Keep work area well lit. Do not use tools in the presence of flammable liquids or gases.
3. **Guard against electric shock.** Avoid body contact with earthed or grounded surfaces (e.g. pipes, radiators, ranges, refrigerators).
4. **Keep other persons away.** Do not let persons, especially children, not involved in the work touch the tool or the extension cord and keep them from the work area.
5. **Store idle tools.** When not in use, tools should be stored in a dry locked-up place, out of reach of children.
6. **Do not force the tool.** It will do the job better and safer at the rate for which it was intended.
7. **Use the right tool.** Do not force small tools to do the job of a heavy-duty tool. Do not use tools for purposes not intended; for example, do not use circular saws to cut tree limbs or logs.
8. **Dress properly.** Do not wear loose clothing or jewelry, they can be caught in moving parts. Non-skid footwear is recommended when working outdoors. Wear protective hair covering to contain long hair.
9. **Use protective equipment.** Use safety glasses. Use face or dust mask if working operations create dust.
10. **Connect dust extraction equipment.** If the tool is provided for the connection of dust extraction and collecting equipment, ensure these are connected and properly used.
11. **Do not abuse the cord.** Never yank the cord to disconnect it from the

socket, keep the cord away from heat, oil and sharp edges.

12. **Secure work.** Where possible use clamps or a vice to hold the work. It is safer than using your hand.
13. **Do not overreach.** Keep proper footing and balance at all times.
14. **Maintain tools with care.** Keep cutting tools sharp and clear for better and safer performance. Follow instruction for lubricating and changing accessories. Inspect tool cords periodically and if damaged have them repaired by an authorized service facility. Inspect extension cords periodically and replace if damaged. Keep handles dry, clean and free from oil and grease.
15. **Disconnect tools.** When not in use, before servicing and when changing accessories such as blades, bits and cutters, disconnect tools from the power supply.
16. **Remove adjusting keys and wrenches.** From the habit of checking to see that keys and adjusting wrenches are removed from the tool before turning it on.
17. **Avoid unintentional starting.** Ensure switch is in “off” position when plugging in.
18. **Use outdoor extension leads.** When the tool is used outdoors, use only extension cords intended for outdoor use and so marked.
19. **Stay alert.** When what you are doing, use common sense and do not operate the tool when you are tired.
20. **Check damaged parts.** Before further use of tool, it should be carefully checked to determine that it will operate properly and perform its intended function. Check for alignment of moving parts, binding of moving parts, breakage of parts, mounting and any other conditions that may affect its operation. A guard or other part that is damaged should be properly repaired or replaced by an authorized service center unless otherwise indicated in this instruction manual. Have defective switches replaced by an authorized service center. Do not use the tool if the switch does not turn it on and off.
21. **WARNING!** The use of any accessory or attachment other than one recommended in this instruction manual may present a risk of personal injury.
22. **Have your tool repaired by a qualified person.** This electric tool complies with the relevant safety rules. Repairs should only be carried out by qualified persons using original spare parts, otherwise this may result in considerable danger to the user.

ADDITIONAL SAFETY INSTRUCTIONS FOR YOUR TILE CUTTER

1. Set up the machine on a level, non-slip surface. Make sure that the machine does not wobble.
2. Check that the voltage on the rating plate is the same as your supply voltage. Only then are you to insert the power plug in the socket outlet.
3. Always wear both eye and ear protection when using the machine. Ensure that the directional arrow marked on the blade corresponds with the rotational direction of the motor.
4. Wear safety gloves.
5. Never use cracked blade. Replace immediately.
6. Never use segmented blade.
7. **Caution!** The blade runs on after the machine is switched off!
8. Never apply side pressure to the blade to bring it to a halt.
9. **Caution!** The blade must be cooled with water at all times.
10. Always pull out the power plug before changing the blade.
11. Use only suitable blade.
12. Never leave the machine unattended in rooms with children.
13. Always pull out the power plug before examining the electric motor compartment system.
14. Remove the mains plug from socket before carrying out any adjustment, servicing.
15. If the supply cord is damaged, it must be replaced by the manufacturer, its service agent or similarly qualified persons in order to avoid a hazard.
16. With the machine disconnected from the power supply, rotate the blade by hand to ensure it is free from obstruction.
17. Always keep the blade securing arbor and collars clean.
18. Ensure that the blade-securing bolt is securely tightened with a suitable wrench.
19. Never try to cut freehand. Always ensure that the tile to be cut is pressed firmly against the parallel side fence.
20. Ensure that the work piece to be cut off has sufficient room to move sideways. Failure to do so may result in the off-cut binding against the blade.
21. Never cut more than one tile at a time.
22. Never cut pieces too small to be held securely against the side fence without leaving enough space for the hand to be a safe distance from the blade.
23. Ensure that the table and surrounding area are clear with the exception of the tile to be cut.
24. Never fit substandard blades to the machine. Only fit correctly sized diamond blades.

25. Only use continuous rim diamond cutting-off wheel designed for cutting tiles.
26. Do Not use blades that are larger than specified, only use blades that are rated for the machine. The rotational speed shown on the blade should always be higher than the rotational speed of the Machine.
 - Ensure that the directional arrow marked on the blade corresponds with the rotational direction of the motor. Whenever replacing blades ensure that the surface of the blade collar fits snugly against the surface of the blade.
 - If the work piece cannot be held securely by hand, then use the jig or clamp to hold it in place whilst it is being cut.
 - Never cut pieces that are too small to be held securely against the back fence with the thumb and index finger.
 - Ensure that long work pieces are adequately supported at both ends.
 - Keep the handles dry and free of grease. Slippery handles can lead to accidents.
 - Prevent overheating of the device and the work piece. Excess heat may damage the tool and the device.
 - > Shortly after being used, the tool may be very hot. Allow a hot tool to cool down. Touching a hot tool may cause burns.
 - > Never clean a hot tool with flammable liquids. There is a risk of fire and explosion.
 - > Store the unused power tool safely in a dry place that can be locked. This ensures that the power tool is not damaged because of storage and inexperienced persons do not operate it.
 - > Never leave the power tool before it has come to a complete standstill. Tools that continue to operate may cause injury.
26. Before cutting a tile, let the cutter blade run freely for a few seconds. If it makes an unfamiliar sound or vibrates excessively switch it off immediately and disconnect from the power supply. Investigate the cause or consult a qualified person for advice.
27. Let the blade reach full speed before commencing the cut.
28. Do not force the blade to cut the tile.
29. Let the blade come to a complete stop before removing any jammed or off cut material from around the blade area.
30. Use a residual circuit breaker on all 230V Power tools. This can help minimize the risk of an electrical shock if an earth fault or short circuits occurs.
31. If using a power cable extension, ensure that the cable is fully unwound and that its length is less than 30m. Lengths over 30m will affect the tools performance as a result of voltage drop.
32. To avoid the possibility of the tool plug or receptacle getting wet, position tile cutter away from receptacle and plug. The user should arrange a “drip loop” in the cord connecting the cutter to a receptacle. The “drip

- loop” is that part of the cord below the level of the receptacle, or the connector if an extension cord is used, to prevent water traveling along the cord and coming in contact with the receptacle.
33. If the plug or receptacle does get wet, DON'T unplug the cord. Disconnect the fuse or circuit breaker that supplies power to the tool. Then unplug and examine for presence of water in the receptacle.
 34. If an extension cord is used, the drip loop must be before the cord connection and the extension cord connection must be placed on an elevated surface.
 35. Secure work firmly against the miter guide or fence.
 36. Never stand or have any part of your body in line with the path of the blade.
 37. Never attempt to free a stalled blade without first turning the cutter OFF and disconnecting the cutter from the power source.
 38. Avoid awkward operations and hand positions where a sudden slip could cause your hand to move into the cutting tool.
 39. Make sure the work area has ample lighting to see the work and that no obstructions will interfere with safe operation before performing any work using the cutter.
 40. Always turn off cutter before disconnecting it, to avoid accidental starting when reconnecting to power supply.
 41. Do not operate with any guard disabled, damaged, or removed. Moving guards must move freely and close instantly.
 42. The use of accessories or attachments not recommended by the manufacturer may result in a risk of injury to persons.
 43. When servicing use only identical replacement parts.
 44. Maintain labels and nameplates on the tool. These carry important safety information.
 45. For your own safety, read instruction manual before operating tile cutter:
 - Wear eye, hearing, and breathing protection.
 - Use wheel guard for every operation for which it can be used.
 - Disconnect cutter before servicing, when changing blade and cleaning.
 - Use tool only with smooth edge blade free of openings, grooves and teeth.
 - Replace damaged blade before operating.
 - Do not fill water tray above Max. water fill line.

ADDITIONAL SAFETY WARNING FOR CONSTRUCTION DUST

The updated Control of Substances Hazardous to Health Regulations 1st October 2012 now also targets to reduce the risks associated with silica, wood and gypsum dusts. Construction workers are one of the at-risk groups within this because of the dust that they breathe: silica dust is not just a nuisance; it is a real risk to your lungs!

Silica is a natural mineral present in large amounts in things like sand, sandstone and granite. It is also commonly found in many construction materials such as concrete and mortar. The silica is broken into very fine dust (also known as Respirable Crystalline Silica or RCS) during many common tasks such as cutting, drilling and grinding. Breathing in very fine particles of crystalline silica can lead to the development of: Lung cancer Silicosis Chronic Obstructive Pulmonary Disorder (Chronic obstructive pulmonary disease (COPD) And breathing in fine particles of wood dust can lead to the development of Asthma. The risk of lung disease is linked to people who regularly breathe construction dust over a period of time, not on the odd occasion.

To protect the lung, the COSHH Regulations sets a limit on the amount of these dusts that you can breathe (called a Workplace Exposure Limit or WEL) when averaged over a normal working day. These limits are not a large amount of dust: when compared to a penny it is tiny – like a small pinch of salt:

This limit is the legal maximum; the most you can breathe after the right controls have been used.

How to reduce the amount of dust?

1. Reduce the amount of cutting by using the best sizes of building products. Use a less powerful tool e.g. a block cutter instead of angle grinder.
2. Using a different method of work altogether – e.g. using a nail gun to direct fasten cable trays instead of drilling holes first.
3. Please always work with approved safety equipment, such as those dust masks that specially designed to filter out microscopic particles and use the dust extraction facility at all time.

For more information please see the HSE website: <http://www.hse.gov.uk/construction> or <http://www.hse.gov.uk/pubns/cis69.pdf>



WARNING! Some dust particles created by power sanding, sawing, grinding, drill and other construction jobs contain chemicals known to cause cancer, birth defects or other reproductive harm. Some examples of these chemicals are:

- Lead from lead-based paints.
- Crystalline silica from bricks and cement and other masonry products.
- Arsenic and chromium from chemically treated timber.
- Your risk from these exposures varies, depending upon how often you do this type of work. To reduce your exposure to these chemicals:
- Work in a well-ventilated area.
- Work with approved safety equipment, such as those dust masks that are specially designed to filter microscopic particles

VIBRATION

The European Physical Agents (Vibration) Directive has been brought in to help reduce hand arm vibration syndrome injuries to power tool users. The directive requires power tool manufacturers and suppliers to provide indicative vibration test results to enable users to make informed decisions as to the period of time a power tool can be used safely on a daily basis and the choice of tool.

SEE TECHNICAL SPECIFICATIONS IN THE INSTRUCTION MANUAL FOR THE VIBRATION LEVELS OF YOUR TOOL.

The declared vibration emission value should be used as a minimum level and should be used with the current guidance on vibration. Calculating the actual period of the actual period off use can be difficult and the HSE website has further information.

The declared vibration emission been measured in accordance with a standardized test stated above and may be used to compare one tool with another tool.

The declared vibration emission value may also be used in preliminary assessment of exposure.



WARNING! The vibration emission value during actual use of the power tool can differ from the declared value depending on the ways in which the tool is used dependent on the following examples and other variations on how the tool is used:

- How the tool is used and the materials being cut or drilled.
- The tool being in good condition and well maintained.
- Use the correct accessories for the tool and ensure they are sharp and in good condition.
- The tightness of the grip on the handles.
- The tool is being used as intended by its design and these instructions.

While working with this power tool, hand/arm vibrations occur. Adopt the correct working practices in order to reduce the exposure to vibration. This tool may cause hand-arm vibration syndrome if its use is not adequately managed.



WARNING! Identify safety measures to protect the operator that are based on an estimation of exposure in the actual conditions of use (taking account of all parts of the operating cycle such as the times when the tool is switched off and when it is running idle in addition to the trigger time).

Helping to minimize your vibration exposure risk. **ALWAYS** use sharp chisels, drills and blades. Maintain this tool in accordance with these instructions and keep well lubricated (where appropriate).

Avoid using tools in temperatures of 10°C or less. Plan your work schedule to spread any high vibration tool use across many days.

Note: The use of other tools will reduce the users' total working period on this tool.

HEALTH SURVEILLANCE

All employees should be part of an employer's health surveillance scheme to help identify any vibration related diseases at an early stage, prevent disease progression and help employees stay in work.

IMPORTANT NOTE

Be sure the supply is the same as the voltage given on the rating plate for the charger. The charger is fitted with a two-core cable and plug. Remove the mains plug from socket before carrying out any adjustment or servicing.



Product description

- | | |
|--------------------------|-------------------------|
| 1. Angle ruler | 8. Blade |
| 2. Blade guard (upper) | 9. Scale |
| 3. Water tank | 10. Riving Knife |
| 4. Table adjustment knob | 11. Mounting holes |
| 5. Switch | 12. 8mm Wrench |
| 6. Fence fixed knob | 13. 19mm wrench |
| 7. Fence | 14. Blade guard (lower) |

01

TECHNICAL SPECIFICATIONS

Voltage: 230-240V~,50Hz

Rated input: 450W S2 30min

No-load speed: 2950min⁻¹

Protection class: IPX4

Blade size: Ø180xØ22.2x2.2mm

Dimensions of table: 330x 360mm

Blade tilting range: 0°-45°

Depth of cut @90°: 34mm

Depth of cut @45°: 18mm

Net weight: 7.2kg

NOISE DATA

Sound power level (L_{WA}^*):105 dB(A)

Uncertainty K_{PA} :3dB

Noise pressure level (L_{PA}^*):92dB(A)

Uncertainty K_{WA} :3dB

Vibration value (<2.5 m/s²))

S2 corresponds to an operating time in minutes at the power given. For example, S2 10 minutes; S2 30 minutes. This operation must be followed by a rest period to allow cooling the motor and optimizing the life of the machine.

- The level of acoustic intensity perceived by the user may exceed 92dB (A), making it necessary to use a noise-cancelling headset.
- The total declared value of vibration has been measured in accordance with a standard test method and may be used for comparing one tool to another.
- The declared total value of vibrations can also be used to a preliminary assessment of exposure.
- The vibration emission during actual use of the power tool can differ from the declared total value depending on the ways in which the tool is used; and of the need to identify safety measures to protect the operator that are based on an estimation of exposure in the actual conditions of use (taking account of all parts of the operating cycle such as the times when the tool is switched off and when it is running idle in addition to the trigger time)

RATING LABEL EXPLANATION

PTC450E = MODEL NUMBER

P =P BRAND

TC = TILE CUTTER

450 = POWER (WATTS)

E = VERSION OF MACHINE



Assembly

01

SYMBOLS



Read the instruction manual



Caution, risk of cutting



Wear hearing protection



Wear a dust mask



Wear eye protection



Wear safety gloves



Do not dispose of batteries in a fire.



Do not throw this product into rivers or immerse in water.



Warning! This symbol warns of damage to the machine, environment or property



Continuous rim diamond cutting-off wheel ONLY!



The product complies with the applicable European Directives and an evaluation method of conformity for this Directives was done



Take a power tool in the domestic waste! In accordance with European Directive 2012/19/EU on waste electrical and Electronic equipment and its implementation in national law, electric tools collected separately and environmentally friendly recycling is fed. Take advantage of the collection facilities. Ask your local



government for the collection systems. If electrical appliances are disposed of, can be poisoned for years while the cause hazardous substances into the groundwater and entering the food chain, or flora and fauna

yyWxx Manufacturing date code:

Year of manufacturing (20yy) and week of manufacturing (Wxx);

02

UNPACKING

Unpack all parts and lay them on a flat, stable surface.

- Remove all packing materials and shipping devices, if applicable.
- Make sure the delivery contents are complete and free of any damage. If you find that parts are missing or show damage do not use the product but contact your dealer. Using an incomplete or damaged product represents a hazard to people and property.
- Ensure that you have all the accessories and tools needed for assembly and operation. This also includes suitable personal protective equipment.



WARNING! The product and the packaging are not children's toys! Children must not play with plastic bags, sheets and small parts! There is a danger of choking and suffocation!

03

ASSEMBLY

ASSEMBLING THE RIVING KNIFE (A1-A3)

The machine is supplied with a riving knife. The riving knife is an important safety feature which prevents the diamond blade jamming while cutting. For safety reasons the machine may never be used without the riving knife fitted. The riving knife and blade guard come pre-assembled together.

1. Slightly loosen the pre-mounted riving knife clamping screws with screwdriver. **(A1)**
2. Slide the 2 slots of the supporting foot of riving knife into the 2 clamping screws, while the supporting foot of riving knife should stay between the 2 plate surfaces. **(A2)** Tilting the table may make this task easier.
3. Fasten the clamping screws. **(A3)**

ASSEMBLING THE BLADE (B1-B3)

1. Loosen the two fixing screws at the left and right of the blade guard (bottom), Note that the fixing screws are permanently attached to the blade guard (bottom) and must not be completely removed. Remove the blade guard. **(B1)**

2. Remove the outer flange and the spindle nut.
3. Slide the blade (8) over the spindle. The arrow on the blade shall indicate the same rotation direction as shown by the arrow on the metal plate near the spindle and on the blade guard **(B2)**. Slide the flange over the blade. Screw the spindle nut onto the spindle **(B2)**. Hold the spindle in place with the 8 mm wrench (supplied) and tighten the spindle nut with the 19 mm wrench (supplied) **(B3)**.
4. Slide the blade guard (bottom) over the blade, tighten the screws.

ADJUSTING THE RIVING KNIFE

Ensure that there is sufficient clearance between the blade and the blade guard. The rotating blade may not touch the blade guard during operation. Readjust left/right position of the riving knife if the rotating blade will touch the internal side of blade guard.

- The riving knife (10) must be aligned with the blade (8). Check the alignment using a rule.
- If necessary, loosen the screws and adjust the position of the riving knife.

ASSEMBLING THE FENCE (C)

The fence can be set to the required position using the scale on the saw table.

- Fix the parallel guide (7) in position on the table by tightening the fence fixed knob (6) both sides.
- Make sure the fence is parallel to the blade direction.

FITTING THE WATER TANK (D)

NOTE: Always use the water bath and ensure that the water level is between the MIN and MAX markings.

1. Put the machine as shown and install the water tank under the blade guard (bottom).
2. Lower the machine carefully. The wall of the water tank furthest away from you must fit between the blade guard (bottom) and the metal wall of the machine.

FIXING ON THE BENCH (E)

- Locate the machine on work bench.
- Use 6mm bolts mounting holes (11) to fix machine on bench.

CONNECTION TO THE POWER SUPPLY

Connect the plug with a suitable socket.
Your product is now ready to be used.



WARNING! Check the voltage! The voltage must comply with the information on the rating label!

STARTING AND STOPPING (F)

- To start the machine, press the green button marked “I”(5)
- To stop the machine, press the green button marked “O”(5).



Use

INTENDED USE

The electric tile cutter is designed for making straight and mitre cuts in ceramic tiles in accordance with the operating instructions and may not be used for any other purpose. The tile cutter is designed for DIY use only and is not suitable for commercial use or heavy duty use on building sites etc.

The manufacturer cannot be held responsible for damage or injury caused by using the machine for other than its intended purpose. Only continuous rim diamond blades which are suitable for the machine can be used.

Non-observance of the safety, assembly and operating instructions while operating the machine counts as misuse. Anyone who operates or services the machine must be familiar with these instructions and must be aware of possible dangers. Any applicable health and safety regulations must be followed.

The machine may not be modified. The manufacturer can accept no responsibility for damage or injury caused by modifications to the machine.

GENERAL OPERATION

Check to make sure the device is in safe operating condition:

- Check to make sure there are no visible defects.
- Check to make sure all device components are correctly mounted.
- Check to make sure the safety mechanisms are functioning properly.
- Check the function of switch.
- Check the cooling water level is sufficient.
- Check the working area is clear of obstructions.

Never reach into the work area of the rotating cutting wheel when the machine is running, apart from the operator nobody shall be within in the working area.



WARNING! Wait until the tool has reached its Maximum rotational speed and the cutting surface of the cutting wheel is supplied with cooling water before starting to cut.

Everyone apart from the user should be at least 1m away from the machine.

STRAIGHT CUTTING (G)

Fit the parallel guide(7) to the left-hand side of the saw table. Set to the required position using the scale on the table and tighten the knobs (6).

- Put the workpiece on table against the fence. Feed the workpiece into blade as arrows show.

ANGLED CUTS (H)

Follow the same procedure for a straight cut but use the angle ruler (1) for 45 degree cutting of tiles. Ensure that the tile is held firmly into the guide before making the cut.

BEVEL CUTTING (I)

Follow the same procedure for a straight cut but:

- Loosen the table adjustment knob (4) on both sides of the cutting machine.
- Cant the table to the desired angle and tighten the knob (4).
- Make bevel cut.

AFTER USING

When all cutting has been completed, switch off the machine and disconnect power supply. After allow the machine to cool, and before storing, it is advisable to thoroughly clean the machine. Empty the water tank and clean away any tile slurry from inside the tank and on the table.



Care & maintenance

CARE

1. Make sure the power cord is not damaged.
2. Only use blades that are recommended by the supplier and that are in good condition.
3. Repairs should be carried out by a professional.
4. The water tank must be fully filled between max. and min. water mark.
5. Clean the table before cutting.

MAINTENANCE

For safety reasons, each damaged (cracked) tool has to be replaced before using. Have all other work, in particular repairs, conducted by a trained technician. If the supply cord is damaged, it must be replaced by the manufacturer, its service agent or similarly qualified persons in order to avoid a hazard. Improperly performed work may cause damage to the machine and result in injury.

Prior to any maintenance and/or cleaning:

- Switch the machine off
- Let the machine cool down
- Pull out the plug.
- Empty the water tank and clean away any tile slurry from inside the tank and on the table.
- Clean the tile saw with a clean dry cloth from time to time depending on the slurry accumulation.

RECYCLING AND DISPOSAL



Waste electrical products should not be disposed of with household waste. Please recycle where facilities exist. Check with your Local Authority or retailer for recycling advice. For further information visit www.recycle-more.co.uk

REPAIR

This product does not contain any parts that can be repaired by the consumer. Contact an authorized service center or a similarly qualified person to have it checked and repaired.

STORAGE

- Switch the product off and disconnect it from the power supply.
- Clean the product as described above.
- Store the product and its accessories in a dark, dry, frost-free, well-ventilated place.
- Always store the product in a place that is inaccessible to children. The ideal storage temperature is between 10°C and 30°C.
- We recommend using the original package for storage or covering the product with a suitable cloth or enclosure to protect it against dust.

TRANSPORTATION

1. Switch the product off and disconnect it from power supply before transportation.
2. Attach transportation guards, if applicable.
3. Protect the product from any heavy impact or strong vibrations which may occur during transportation in vehicles.
4. Secure the product to prevent it from slipping or falling over.

UK plugs

If you need to replace the fitted plug then follow the instructions below.

IMPORTANT: The wires in the mains lead are colored in accordance with the following code:

Blue – Neutral, Brown – Live, Green & Yellow – Earth

As the colors of the wires in the Mains lead of this apparatus may not correspond with the colored markings identifying the terminals in your plug, proceed as follows. The wire which is colored blue, must be connected to the terminal, which is marked with N or colored black. The brown wire must be connected to the terminal which is marked with an L or colored red. The green & yellow

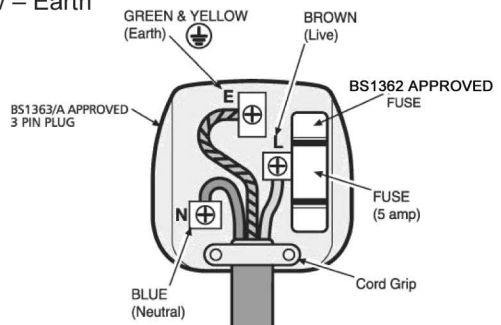

TROUBLE SHOOTING

Suspected malfunctions are often due to causes that the user can fix themselves. Therefore, check the product using this section. In most cases the problem can be solved quickly.

Problem	Possible cause	Solution
1. Product does not start	1.1 PRCD protection 1.2 Not connected to power supply 1.3 Power cord or plug is defective 1.4 Other electrical defect to the product	1.1. Press the RESET Button 1.2 Connect to power supply 1.3 Check by a specialist electrician. 1.4 Check by a specialist electrician
2. Product does not reach full power	2.1 Extension cord not suitable for operation with this product 2.2 Power source (e.g. generator) has too low voltage 2.3 Air vents are blocked	2.1 Use a proper extension cord 2.2. Connect to another power source 2.3. Clean the air vents
3. Unsatisfactory result	3.1 Accessory not suitable for work piece material	3.1. Use proper accessory



Guarantee

This **P** power tool is guaranteed for 1 year from the date of purchase, if bought in store, delivered or if bought online, for normal (non-professional or commercial) household use. You may only make a claim under this guarantee upon presentation of your sales receipt or purchase invoice. Please keep your proof of purchase in a safe place.

This guarantee covers product failures and malfunctions provided the **P** power tool was used for the purpose for which it is intended and subject to installation, cleaning, care and maintenance in accordance with standard practice and with the information contained above and in the user manual. This guarantee does not cover defects and damage caused by or resulting from:

- Normal wear and tear
- Overload, misuse or neglect
- Trade, professional or hire use
- Repairs attempted by anyone other than an authorised agent
- Cosmetic damage
- Damage caused by foreign objects, substances or accidents
- Accidental damage or modification
- Failure to follow manufacturer's guidelines
- Loss of use of the goods

This guarantee is limited to parts recognised as defective. It does not, in any case, cover ancillary costs (movement, labour) and direct and indirect damage.

If the **P** power tool is defective during the guarantee period, then we reserve the right, at our discretion, to replace the item with a product of equivalent quality and functionality or to provide a refund.

This guarantee only applies to the country of purchase or delivery and is not transferrable to any other countries. This guarantee is non-transferrable to any other person or product. Relevant local law will apply to this guarantee.

Guarantee related queries should be addressed to a store affiliated with the distributor from where you purchased the **P** power tool.

This guarantee is in addition to and does not affect your statutory rights relating to faulty goods as a consumer.



EC declaration of conformity



**Declare that the product
<PTC450E + Tile Cutter >**

Serial number: from 000001 to 999999

Complies with the essential health and safety requirements of the
following Directives:

EC Machinery Directive 2006/42/EC

The EMC Directive 2014/30/EU

2011/65/EU Restrictions of the Use of Certain Hazardous Substances in
Electrical and Electronic Equipment

2012/19/EU Waste Electrical and Electronic Equipment (WEEE)

Regulation (EC) No 1907/2006, concerning the Registration, Evaluation, Authorization
and Restriction of Chemicals (REACH)

Standards and technical specifications referred to:

EN 61029-1:2009/A11:2010

EN ISO 12100:2010

EN 55014-1:2006/A2: 2011

EN 55014-2:2015

EN 61000-3-2:2014

EN 61000-3-3:2013

Authorized Signatory and technical file holder
Signed for and on behalf of:

Kingfisher International Products Limited
3 Sheldon Square
London W2 6PX
United Kingdom

Lisa Davis
Group Quality Director



**Manufacturer, Fabricant, Producent,
Hersteller, Producător, Fabricante:**
Kingfisher International Products Limited
3 Sheldon Square
London
W2 6PX
United Kingdom
www.kingfisher.com/products



Distributor: **B&Q plc**,
Chandlers Ford, Hants,
SO53 3LE United Kingdom
www.diy.com

Screwfix Direct Limited
Trade House, Mead Avenue
Yeovil BA22 8RT, United Kingdom
www.screwfix.com

To view instruction manuals online,
visit www.kingfisher.com/products
