

# USER INSTRUCTION

DRAIN UNBLOCKER

Item No. 11325

## PARTIAL ASSEMBLY instruction:

### Step 1:

First slide Part B onto Part A with the outstanding piece of the black handle facing downward, as shown in the instruction. Then place Part C onto Part A.

### Step 2:

Fasten Part C together onto the hole in Part A with the screw. The handle will be firmly fixed to Part A and is ready for use

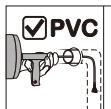
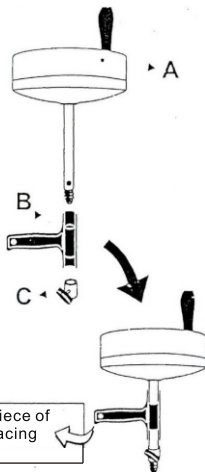

The outstanding piece of the black handle facing downward

- Not suitable for toilets
- The Metal end may mark porcelain

## Usage Instructions:

Feed the corkscrew head and of your auger down the drain until blockage is reached.

Rotate, using slight forward pressure.

Wash air dry & oil tool before storing.

- Easy to use
- Clears Clogged drains and waste lines
- Work where plungers and chemicals fail

