

TITAN

High Pressure Cleaner 1800W

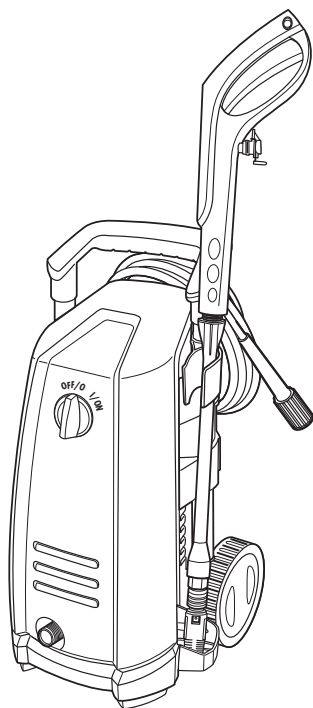

TTB669PRW

Barcode: 5052931516438

Ref. No.: 5014J

WARNING: Read the instructions before using the product!





TITAN

Congratulations on your purchase of **TITAN a power tool from Kingfisher International Products Limited. We want you to continue getting the best performance from it so this handbook includes information on safety, handling and care. Please retain this handbook in case you need to refer to any of the information in the future.**

Your **TITAN power tool comes with a 2 years guarantee, so should it develop a fault within this period contact your retailer.**

GUARANTEE

This **TITAN** product carries a guarantee of 2 years. If your product develops a fault within this period, you should in the first instance contact the retailer where the item was purchased.

This guarantee specifically excludes losses caused due to:

- Fair wear and tear
- Misuse or abuse
- Lack of routine maintenance
- Failure of consumable items (Such as batteries)
- Accidental damage
- Cosmetic damage
- Failure to follow manufacturer's guidelines
- Loss of use of the goods

This guarantee does not affect your statutory rights. This guarantee is only valid in the UK.

For any enquiries relating to the guarantee please refer to your retailer.

High Pressure Cleaner 1800W - TTB669PRW



Let's get started...

These instructions are for your safety. Please read through them thoroughly before use and retain them for future reference.



Getting **started...**

03

Safety information 04

Your product 12

Before you start 15



In more **detail...**

27

Product functions 28

Operation 32

Care and maintenance 36

Troubleshooting 41

Recycling and disposal 42

EC declaration of conformity 43

Safety warnings

- >Product shall not be used by children. Children should be supervised to ensure that they do not play with the product.
- >This product can be used by people with reduced physical, sensory or mental capabilities or lack of experience and knowledge if they have been given supervision or instruction concerning the use of the product in a safe way and understand the hazards involved.

IMPORTANT READ CAREFULLY BEFORE USE KEEP FOR YOUR REFERENCE

High pressure cleaner safety warnings

- >If the power cord is damaged, it must be replaced by the manufacturer, its service agent or similarly qualified persons in order to avoid a safety hazard.
- >WARNING: This product has been designed for use with the cleaning agent supplied or recommended by the manufacturer. The use of other cleaning agents or chemicals may adversely affect the safety of the product.
- >WARNING: High pressure jets can be dangerous if subject to misuse. Never direct the jet at persons, live electrical equipment or the product itself.
- >WARNING: Do not use the product within range of persons unless they wear protective clothing.
- >WARNING: Wear appropriate Personnel Protection Equipment (PPE) while operating the product.



- >WARNING: Do not direct the jet against yourself or others in order to clean clothes or foot-wear.
- >WARNING: Risk of explosion – Do not spray flammable liquids.
- >WARNING: This product shall not be used by children or untrained personnel.
- >WARNING: High pressure hoses, fittings and couplings are important for the safety of the product. Use only hoses, fittings and couplings recommended by the manufacturer.
- >WARNING: Only use original spare parts from the manufacturer or approved by the manufacturer to ensure product safety. The use of non-original accessories and any other accessories not specifically intended for the model in question is prohibited.
- >WARNING: Consider water that has flown through backflow preventers to be non-potable.
- >WARNING: Switch the product off and disconnect it from the power supply removing the power plug from the socket outlet before assembly, cleaning, adjustments, maintenance, storage and transportation or converting the product to another function.
- >WARNING: Do not use the product if the power cord or any part of the product is damaged, e. g. safety devices, high pressure hoses, trigger gun. Never use the product if the high pressure hose is damaged.

Safety warnings

- >WARNING: Inadequate extension cords can be dangerous. If an extension cord is used, it shall be suitable for outdoor use, and the connection has to be kept dry and off the ground. The plug and socket must be of watertight construction. It is recommended that this is accomplished by means of a cord reel which keeps the socket at least 60 mm above the ground.
- >WARNING Always switch off the mains disconnecting switch when leaving the product unattended.
- >Have the electric supply connection to be made by a qualified electrician and in compliance with IEC 60364-1. It is recommended that the electric supply to this product should include either a residual current device that will interrupt the supply if the leakage current to earth exceeds 30 mA for 30 ms or a device that will prove the earth circuit.
- >Never use the product with inflammable or toxic liquids, or liquids with characteristics incompatible with its proper operation.
- >Never use the product outdoors in the rain.
- >Never touch the plug and/or socket with wet hands.
- >Never lock the gun trigger in the operating position.
- >Check that the product is fitted with its rating label; contact your dealer if it is missing. Products without rating label must not be used, since they cannot be identified and are potentially hazardous.
- >Never tamper with or adjust the setting of the safety valve or the safety devices.
- >Never change the original diameter of the adjustable nozzle.



- >Never leave the product unattended when it is connected to the power supply.
- >Never move the product by pulling on the electrical power cord.
- >Do not allow vehicles to drive over the pressure hose.
- >Do not move the product by pulling on the pressure hose.
- >When directed towards tyres, tyre valves or other pressurised components, the high pressure jet is potentially dangerous. Do not apply a jet stream and always keep the nozzle at a distance of at least 30 cm during cleaning.
- >Protect all electrical conductors against the water jet.
- >During start-up, the product may generate interference on the electricity supply system.
- >High pressure may cause parts to rebound: wear all the protective clothing and equipment needed to ensure the operator's safety.
- >Be aware of kick-back: grip the gun firmly when pulling the trigger.
- >Comply with the regulations of the local water supply authority. Under EN 12729 (Type BA) the product can be connected directly to the mains drinking water supply only if the supply hose is fitted with a backflow preventer device with drainage facility.
- >Have maintenance and/or repair work on electrical components to be carried out by qualified staff.
- >Discharge residual pressure before disconnecting the hose from the product.
- >Check before each use, and at regular intervals, that all metal fasteners are tight and the product's components are in good condition; inspect for broken or worn parts.

Safety warnings

- >Use only detergents compatible with the high pressure hose / electrical power cord cladding materials.
- >Use only authorised electrical extension cords with suitable conductor gauge.

Maintenance and storage

- >Disconnect the product from the power supply and check for damage after use.
- >Disconnect the product from the power supply before carrying out maintenance or cleaning work.
- >Use only the manufacturer's recommended replacement parts and accessories.
- >Inspect and maintain the product regularly. Have the product repaired only by an authorised service centre or similar qualified specialist.
- >When not in use, store the product out of the reach of children.

Vibration and noise reduction

To reduce the impact of noise and vibration emission, limit the time of operation, use low-vibration and low-noise operating modes as well as wear personal protective equipment.

Take the following points into account to minimise the vibration and noise exposure risks:

- >Only use the product as intended by its design and these instructions.
- >Ensure that the product is in good condition and well maintained.
- >Use correct accessories for the product and ensure they in good condition.

- >Keep tight grip on the handles/grip surface.
- >Maintain this product in accordance with these instructions and keep it well lubricated (where appropriate).
- >Plan your work schedule to spread any high vibration tool use across a longer period of time.

Emergency

Familiarise yourself with the use of this product by means of this instruction manual. Memorise the safety directions and follow them to the letter. This will help to prevent risks and hazards.

- >**Always be alert when using this product so that you can recognise and handle risks early.** Fast intervention can prevent serious injury and damage to property.
- >**Switch off and disconnect from the power supply if there are malfunctions.** Have the garden power tool checked by a qualified professional and repaired, if necessary, before you operate it again.

Residual risks

Even if you are operating this product in accordance with all the safety requirements, potential risks of injury and damage remain. The following dangers can arise in connection with the structure and design of this product:

- >Health defects resulting from vibration emission if the product is being used over long periods of time or not adequately managed and properly maintained.
- >Danger of injury and property damage caused by flying objects.
- >Injuries and damage to property due to broken accessories or the sudden impact of hidden objects during use.







Safety warnings



WARNING! This product produces an electromagnetic field during operation! This field may under some circumstances interfere with active or passive medical implants! To reduce the risk of serious or fatal injury, we recommend persons with medical implants to consult their doctor and the medical implant manufacturer before operating this product!

Symbols

On the product, the rating label and within these instructions you will find among others the following symbols and abbreviations. Familiarise yourself with them to reduce hazards like personal injuries and damage to property.

V~	Volt, (alternating voltage)	bar	Pressure unit
Hz	Hertz	°C	Degree Celsius
W	Watt	∅	Diameter
l/min	Litres per minute	mm	Millimetre
m	Metres	kg	Kilogram
N	Newton	dB(A)	Decibel (A-rated)
MPa	Mega Pascal, pressure unit	m/s ²	Metres per second squared
IPX5	The product is protected against water (out of a nozzle) from all directions.		
yyWxx	Manufacturing date code; year of manufacturing (20yy) and week of manufacturing (Wxx).		
	Lock / to tighten or secure.		Unlock / to loosen.
	Note / Remark.		Caution / Warning.
	Read the instruction manual.		Wear hearing protection.



Wear eye protection.



Wear protective gloves.



Wear protective, slip-resistant footwear.



Switch the product off and disconnect it from the power supply before assembly, cleaning, adjustments, maintenance, storage and transportation.



Do not expose the product to rain or wet conditions.



Always ensure that other people and pets remain at a safe distance from the product when it is in operation. In general, children must not come near the area where the product is.



Local regulations can prohibit connection of the product to drinking water supply equipment.



Do not direct the water jet onto people, animals, electrical equipment or onto the product itself.



Do not reach the patio cleaner as long as the motor is running. Wait until all components have completely stopped before touching them.



Guaranteed sound power level value in dB.



This product is of protection class II. That means it is equipped with enhanced or double insulation.



The product complies with the applicable European directives and an evaluation method of conformity for these directives was done.



WEEE symbol. Waste electrical products should not be disposed of with household waste. Please recycle where facilities exist. Check with your Local Authority or local store for recycling advice.

Getting started...

Getting started...

Your product

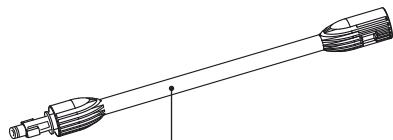
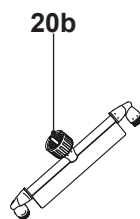
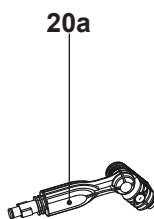
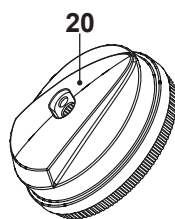
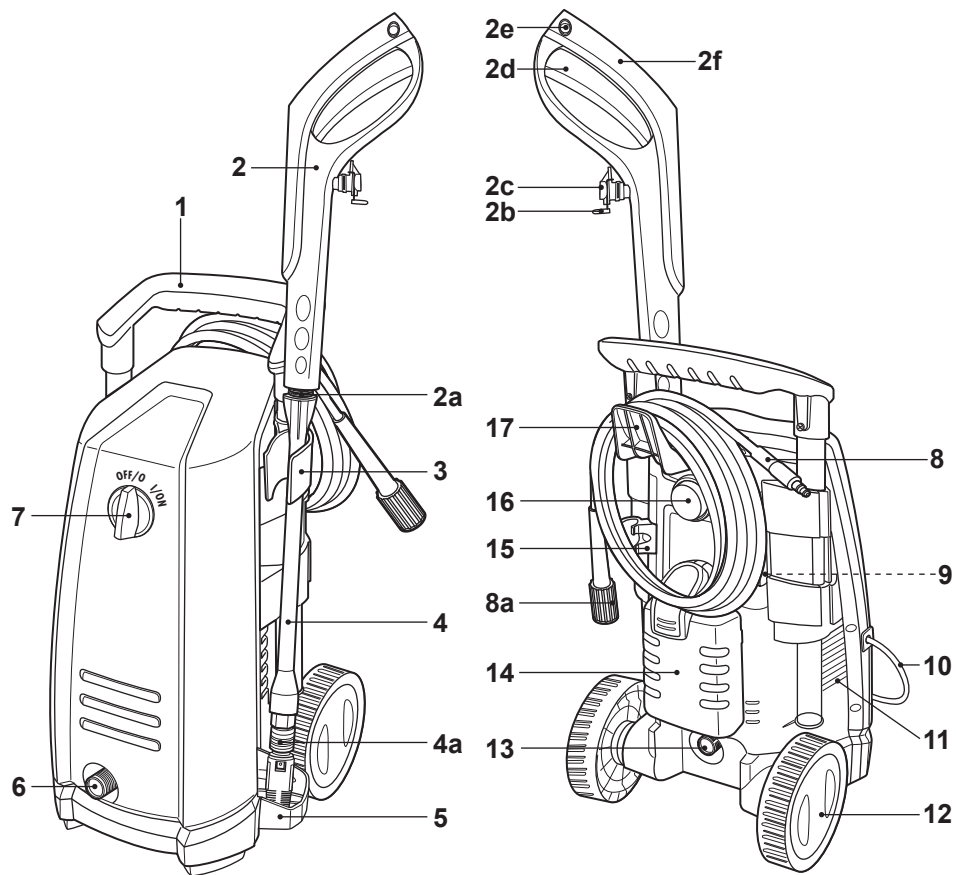

1. Transportation handle
2. Spray gun
 - a. Lance connection port
 - b. Hose release
 - c. Hose connection port
 - d. Trigger
 - e. Trigger lock
 - f. Handle
3. Upper spray gun (with pressure lance) holder
4. Pressure lance
 - a. Nozzle connection port
5. Lower spray gun (with pressure lance) holder
6. Water outlet
 - a. Cap*
7. On/off switch (“I/ON”/“OFF/O”)
8. Pressure hose
 - a. Locking sleeve
9. Nozzle holder
10. Power cord with plug
11. Air vents
12. Wheel (x 2)
13. Water inlet
 - a. Cap*
14. Detergent attachment
 - a. Tank
 - b. Tube*
 - c. Cover*
15. Extension lance holder
16. Handle release button (Transportation handle adjustment)
17. Pressure hose holder
18. Variable spray nozzle
19. Rotary nozzle
20. Patio brush
 - a. Angle connector
 - b. Rotating nozzle
21. Extension lance
22. Water hose connector
 - a. Washer*
 - b. Filter*
23. Cleaning needle
24. Long screw (x 3)



NOTE: Parts marked with * are not shown in this overview. Please refer to the respective section in the instruction manual.

Technical specifications

General

- > **Rated voltage, frequency** : 220 - 240 V~, 50 Hz
- > **Rated power input** : 1800 W
- > **Protection class** : II 
- > **Degree of protection** : IPX5
- > **Weight** : approx. 8 kg
- > **Dimensions** : approx. 331 x 323 x 779 mm
- > **Rated pressure PN** : 90 bar (9 MPa)
- > **Max. inlet water pressure** : 7 bar (0.7 MPa)
- > **Max. permissible pressure PS_{max}** : 130 bar (13 MPa)
- > **Rated flow Q** : 6.0 l/min

Getting started...

Technical specifications

> Maximum rated flow Q_{\max}	: 7.2 l/min
> Rated temperature T	: max. 50 °C
> Gun kickback force at maximum pressure	: 9.4 N
Pressure hose	
> Permissible pressure	: 160 bar (16 MPa)
> Maximum temperature	: 60 °C
> Length	: 6 m
Water hose (not supplied)	
> Quality	: reinforced
> Diameter	: min. \varnothing 12.7 mm (1/2")
> Max. length	: 10 m
Sound values	
> Sound pressure level L_{pA}	: 79 dB(A)
> Uncertainty K_{pA}	: 3 dB(A)
> Sound power level L_{WA}	: 92 dB(A)
> Uncertainty K_{WA}	: 3 dB(A)
Hand arm vibration values	
> Hand arm vibration a_h	: 1.8 m/s ² (< 2.5 m/s ²)
> Uncertainty K	: 1.5 m/s ²

The sound values have been determined according to noise test code given in EN 60335-2-79, using the basic standards EN ISO 3744 and EN ISO 11203.

The sound intensity level for the operator may exceed 80 dB(A) and ear protection measures are necessary.

The declared vibration value has been measured in accordance with a standard test method (according to EN 60335-2-79) and may be used for comparing one product with another. The declared vibration value may also be used in a preliminary assessment of exposure.



WARNING! Depending on the actual use of the product the vibration values can differ from the declared total. Adopt proper measures to protect yourself against vibration exposures. Take the whole work process including times the product is running under no load or switched off into consideration.

Proper measures include among others regular maintenance and care of the product and accessories, keeping hands warm, periodical breaks and proper planning of work processes.

Unpacking

- > Unpack all parts and lay them on a flat, stable surface.
- > Remove all packing materials and shipping devices, if applicable.
- > Make sure the delivery contents are complete and free of any damage. If you find that parts are missing or show damage do not use the product but contact your dealer. Using an incomplete or damaged product represents a hazard to people and property.
- > Ensure that you have all the accessories and tools needed for assembly and operation. This also includes suitable personal protective equipment.



WARNING! The product and the packaging are not children's toys! Children must not play with plastic bags, sheets and small parts! There is a danger of choking and suffocation!

You will need

(items not supplied)

suitable personal protective equipment
 suitable crosshead screwdriver
 detergent
 water hose
 lubricant

(items supplied)

spray gun (2)
 pressure lance (4)
 pressure hose (8)
 detergent attachment (14)
 variable spray nozzle (18)
 rotary nozzle (19)
 patio brush (20)
 extension lance (21)
 water hose connector (22)
 cleaning needle (23)

Assembly



WARNING! The product must be fully assembled before operation! Do not use a product that is only partly assembled or assembled with damaged parts!

Follow the assembly instructions step-by-step and use the pictures provided as a visual guide to easily assemble the product!

Do not connect the product to power supply before it is completely assembled!

Assembly



NOTE: Take care of small parts that are removed during assembly or when making adjustments. Keep them secure to avoid loss.

Holders

- > Align the mounting holes and assemble the pressure hose holder (17) onto the product.
- > Secure the connection with the long screws (24) (Fig. 1).

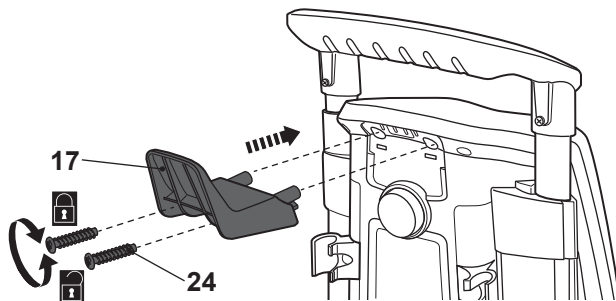

Fig. 1

- > Align the mounting hole and assemble the lower spray gun (with pressure lance) holder (5) onto the product.
- > Secure the connection with the long screw (24) (Fig. 2).

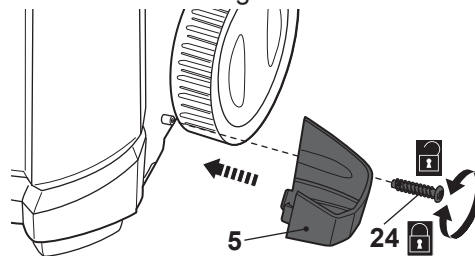

Fig. 2



NOTE: Variable spray nozzle (18) and rotary nozzle (19) can be stored on the nozzle holder (9) while not used.

Water hose connector

- > Remove the cap (13a) from the water inlet (13) (Fig. 3, step 1).
- > Screw the water hose connector (22) to the water inlet (13) (Fig. 3, step 2).

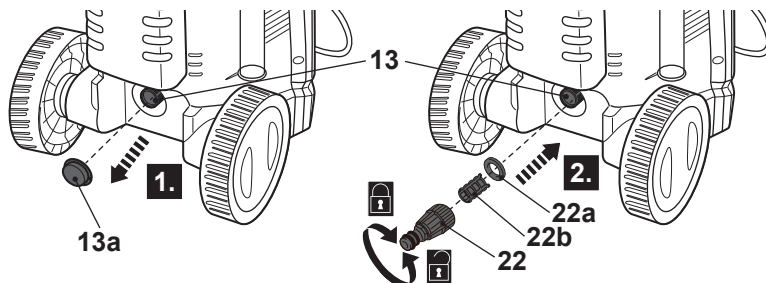

Fig. 3



NOTE: The water hose connector (22) is supplied with an insulating washer (22a).

The water hose connector (22) contains a filter (22b) to protect the product against larger particles. Ensure that this is fixed appropriately. Do not use the water hose connector without a washer and filter.

Pressure hose

- > Push the hose release (2b) and hold it in position (Fig. 4, step 1).
- > Insert the connector of the pressure hose (8) into the hose connection port (2c) of the spray gun (2). Ensure it snaps in place (Fig. 4, step 2).
- > Release the hose release (2b) afterwards.
- > Remove the cap (6a) from the water outlet (6) (Fig. 5, step 1).
- > Screw the pressure hose locking sleeve (8a) to the water outlet (6). Make sure the connection is properly tightened (Fig. 5, step 2).

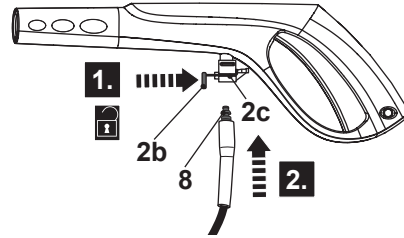

Fig. 4

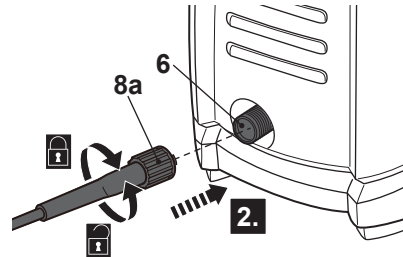
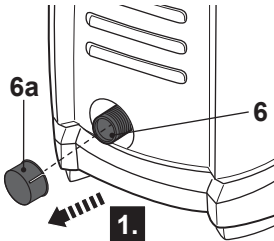

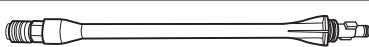

Fig. 5

Accessories

A choice of accessories is supplied in the scope of the delivery of this product. Please check the technical specification of any accessories that you purchase to ensure they are compatible with this product.

Getting started...

Accessories

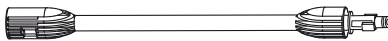
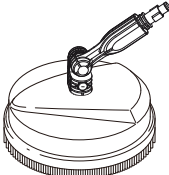
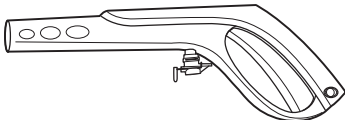
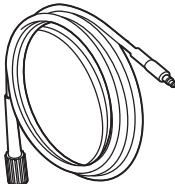
Illustration	Description	Application
	Pressure lance (4)	To be used with nozzles (18, 19)
	Variable spray nozzle (18)	To apply detergent and clean wood decks, siding, vehicles etc.
	rotary nozzle (19)	To clean hard surfaces from dirt. While in use, the rotation of the water jet provides a greater washing power.
	Extension lance (21)	To be used with patio brush (20)
	Patio brush (20)	To clean floors, e. g. garden path or courtyards To be used in conjunction with the extension lance (21)
	Spray gun (2)	
	Pressure hose (8)	

Pressure lance

> Align the tongues of the pressure lance (4) with the grooves of the lance connection port (2a) of the spray gun (2) and insert it (Fig. 6, step 1).



NOTE: There is a spring in the connection port of the spray gun (2). The spring has to be pressed down and might need some pressure.

> Securely fit the pressure lance (4) by turning it clockwise and letting it lock into place (Fig. 6, step 2).



NOTE: After connection with the pressure lance (4), a 90° rotation can be applied to the spray gun (2).

- > To remove the pressure lance (4), press it towards the lance connection port (2a) of the spray gun (2) and turn it anticlockwise to remove it (Fig. 7).

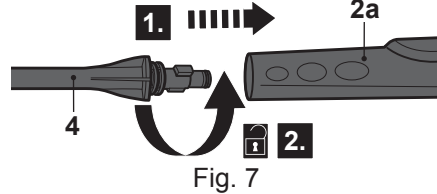
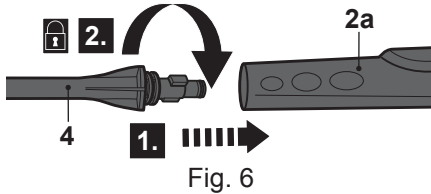

Rotary nozzle



NOTE: Use the rotary nozzle (19) to clean hard surfaces from dirt. While in use, the rotation of the water jet provides a greater washing power.

- > Align the rotary nozzle (19) with the nozzle connection port (4a) of the pressure lance (4) and push it until it snaps in place (Fig. 8).
- > To remove the nozzle, pull the sleeve of the nozzle connection port (4a) of the pressure lance (4) backward (Fig. 9).

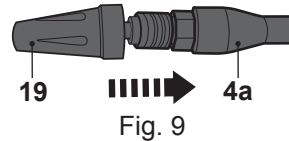
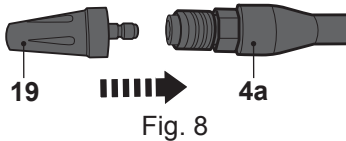

Variable spray nozzle



NOTE: Use the variable spray nozzle (18) to apply detergent and clean wood decks, siding, vehicles etc.

- > Align the variable spray nozzle (18) with the nozzle connection port (4a) of the pressure lance (4) and push it until it snaps in place (Fig. 10).

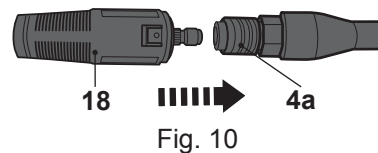

NOTE: Check the jet position when connecting the variable spray nozzle (18) to the nozzle connection port (4a) of the pressure lance (4).

Getting started...

Accessories



WARNING! Do not attempt to adjust the variable spray nozzle when the trigger (2d) is pressed.

- > Turn the variable spray nozzle (18) to adjust the water jet according to the surface you want to clean. The double arrow on the nozzle indicates the direction of the desired application (Figs. 11 - 12).

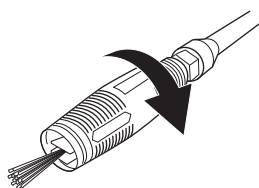

Fig. 11

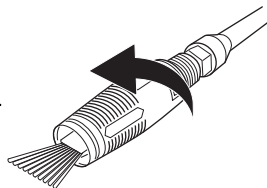

Fig. 12

- > Turn the spray gun (2) to orientate the fan jet in a better way (Figs. 13, 14).
- > Always start using the fan spray and begin spraying from a minimum 30 cm away to avoid damaging the surface of the material you are cleaning.

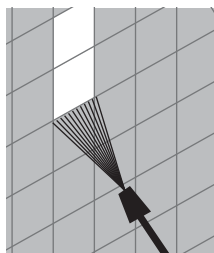

Fig. 13

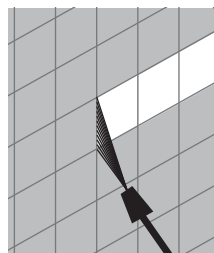
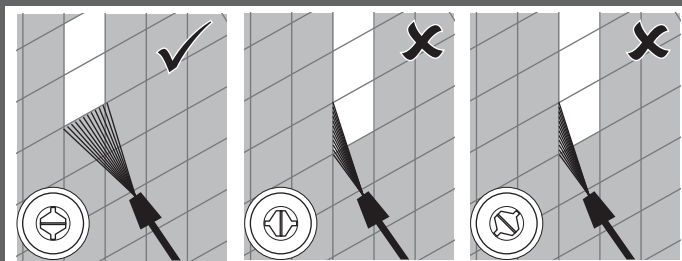

Fig. 14



NOTE: While working from top to bottom, ensure that the metal plates of the variable spray nozzle (18) are perpendicular to the spray gun for a better result.



When applying detergent, only use the low pressure setting of the variable spray nozzle (18). The detergent will automatically be mixed with water. Ensure that the detergent tank (14) has been properly filled with detergent (refer to section "Accessories - Detergent attachment" for details).

- > Pull the nozzle forward to set the water jet to low pressure (Fig. 15).
- > Pull the nozzle backward to set the water jet to high pressure (Fig. 16).

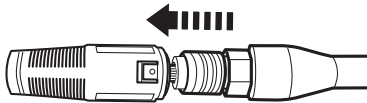

Fig. 15

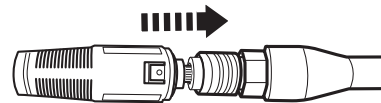

Fig. 16

- > To remove the nozzle, pull the sleeve of the nozzle connection port (4a) of the pressure lance (4) backward (Fig. 17).

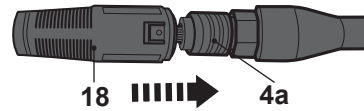

Fig. 17

Detergent attachment

Some cleaning tasks can be completed with water alone, but for most tasks it is advantageous to use a detergent. A detergent ensures a quick soaking of the dirt allowing the high pressure water to penetrate and remove the dirt more effectively.

Use only low pressure setting to carefully apply the detergent. This setting is also recommended for rinsing surfaces after applying wax or for other applications which require working with a lower water pressure than attained with a garden hose.

- > Remove the cover (14c) and tube (14b) from the detergent tank (14a) (Fig. 18, step 1).
- > Fill the tank with detergent until the level reaches the upper graduation mark (Fig. 18, step 2).



NOTE: Only use mild, environmentally friendly detergents. Never use aggressive chemicals, abrasive detergents or similar to avoid damage to your health, the product and the environment.

Accessories

- > Put the cover (14c) back onto the tank (14a) (Fig.18, step 3). Make sure the tube (14b) is not pinched when reattaching the cover (14c).

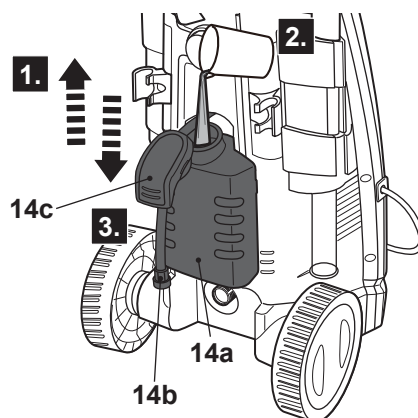

Fig. 18



WARNING! Avoid skin contact with detergents, in particular contact with eyes! If detergents gets in your eyes flush your eyes with clean water and seek immediate medical attention!



NOTE: Remove the tank (14a) from the product to fill the tank with detergent more easily, if necessary.

Detergent cleaning after use

- > Remove the cover (14b) and tube (14a) from the tank (14).
- > Pull off the tank (14) (Fig. 19, step 1).
- > Wash the tank (14) with clean water and keep it dry for storage.
- > Fix back the tank (14) on its support with the tube (14a) and cover (14b) in their original position (Fig. 19, step 2).

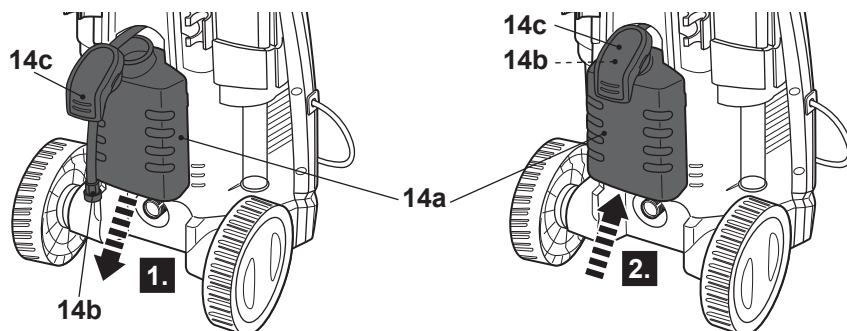

Fig. 19

Extension lance

Always attach the extension lance (21) when using the patio brush (20) (See section "Accessories – Patio brush" for the patio brush assembly steps).



WARNING! Never use the patio brush without the extension lance – danger of injury!

Attaching extension lance

> Align the tongues of the extension lance (21) with the grooves of the lance connection port (2a) of the spray gun (2) and insert it (Fig. 20, step 1).



NOTE: There is a spring in the connection port of the spray gun (2). The spring has to be pressed down and might need some pressure.

> Securely fit the extension lance (21) by turning it clockwise and letting it lock into place (Fig. 20, step 2).

> Align the tongues of the suitable accessory with the grooves of the extension lance (21), push it in (Fig. 21, step 1) and turn the accessory until it snaps in place (Fig. 21, step 2).

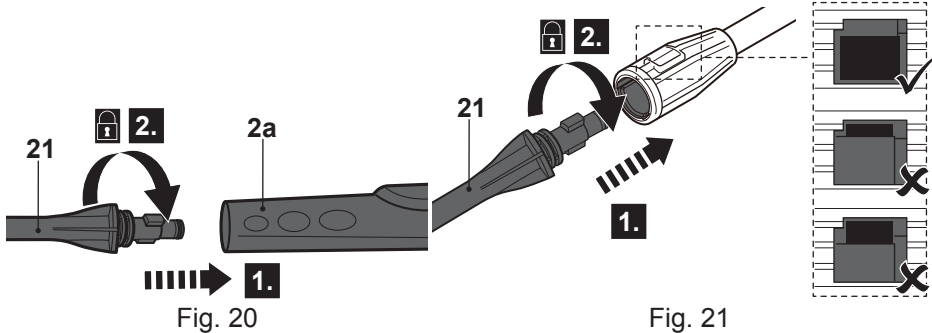

Fig. 20

Fig. 21



NOTE: There is a spring in the connection port of the extension lance (21). The spring has to be pressed down and might need some pressure.



NOTE: After connection with the extension lance (21), a 90° rotation can be applied to the spray gun (2).

Removing extension lance

> Press the suitable accessory towards the extension lance (21) (Fig. 22, step 1) and turn it anticlockwise to remove it (Fig. 22, step 2).

Getting started...

Accessories

- > Press the extension lance (21) towards the lance connection port (2a) of the spray gun (2) (Fig. 23, step 1) and turn it anticlockwise to remove it (Fig. 23, step 2).

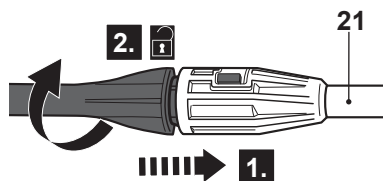

Fig. 22

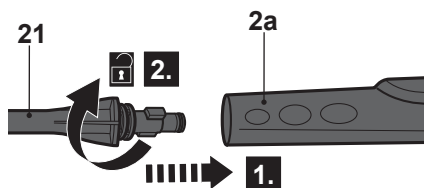

Fig. 23

Patio brush

Always use the patio brush (20) together with the extension lance (21) when cleaning floors.

- > Align the angle connector (20a) to the top of the patio brush (20) and the rotating nozzle (20b) to the bottom side (Fig 24).
- > Screw the rotating nozzle (20b) on the thread of the angle connector (20a). Tighten it well (Fig 25).

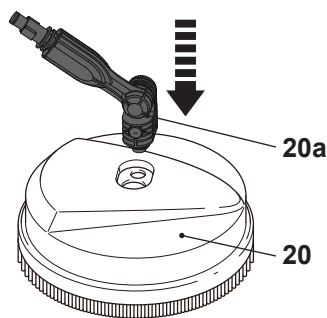

Fig. 24

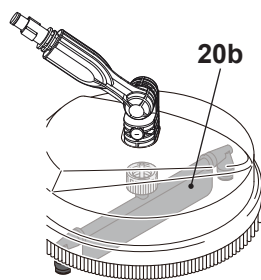

Fig. 25

- > Attach the extension lance (21) to the spray gun (2) (Fig. 26, steps 1, 2)



NOTE: After connection with the extension lance (21), a 90° rotation can be applied to the spray gun (2).

- > Attach the angle connector (20a) to the extension lance (21) (Fig. 26, steps 3, 4)

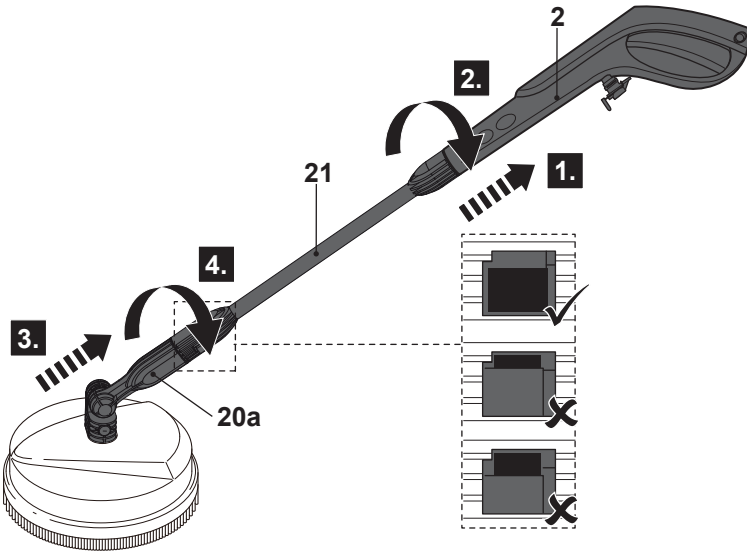

Fig. 26

> Remove the patio brush (20) from the extension lance (21) after use (Fig. 27).

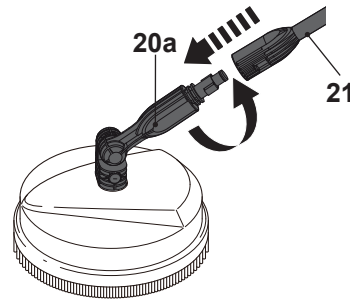

Fig. 27



WARNING! The patio cleaner is only intended to be used on flat surfaces! Do not attempt to use it on steps or try to touch the rotating nozzle while operating (Fig. 28)!

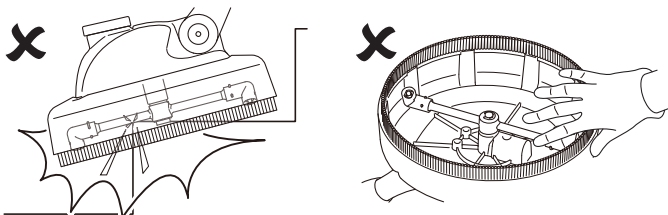

Fig. 28

Connection to water supply



WARNING! Although this product is suitable for attachment to the drinking water supply local regulations may prohibit the connection to drinking water connections!

Observe the regulations of your local utility company when connecting the product to a water supply line! If it is prohibited to connect to the drinking water facility, you must use a backflow preventer which corresponds to EN 12729 Type BA or EN 61770! Make sure that the hose is at least a diameter of 12.7 mm (1/2") and is reinforced!

- > Attach a suitable water hose (not included) to the water supply and the other end to the water hose connector (22) (Fig. 29).

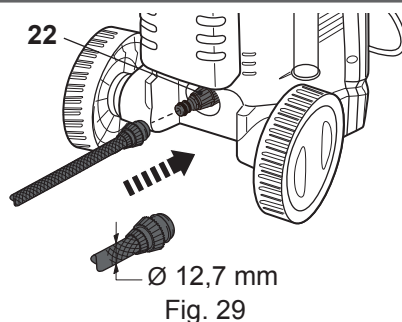

NOTE: The water hose connector (22) is supplied with an insulating washer (22a).

The water hose connector (22) contains a filter (22b) to protect the product against larger particles. Ensure that this is fixed appropriately. Do not use the water hose connector without a washer and filter.

Connection to power supply

- > Make sure the on/off switch (7) is in its off position "OFF/O".
- > Connect the plug with a suitable socket.



WARNING! Check the voltage! The voltage must comply with the information on the rating label!

If using an extension cord it must be suitable for outdoor use with sockets protected against water splashing. Ensure the extension cord is of the proper size and type for your product ($\geq 1.5 \text{ mm}^2$)!

Always use a residual current device (RCD) protected supply.

- > Your product is now ready to be used.



In more detail...

Product functions	28
Operation	32
Care and maintenance	36
Troubleshooting	41
Recycling and disposal	42
EC declaration of conformity	43

In more detail....

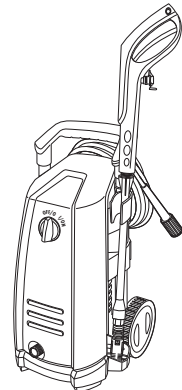

Intended use

This high pressure cleaner TTB669PRW is designated with a rated input of 1800 Watts and is designed with an adjustable transportation handle. The intended use of this product covers the cleaning of vehicles, buildings, terraces, facades and garden equipment using clean water and biodegradable chemical detergents. Likewise the product can be used to clean paving slabs or rain gutters.

This product may not be used to clean clothing, shoes and other textiles. The water jet should not be directed against persons, animals, any electrical equipment or on the product itself. Do not flush any objects which contain health hazardous materials (e. g. asbestos). The product must not be run with inflammable, explosive and toxic liquids.

For safety reasons it is essential to read the entire instruction manual before first operation and to observe all the instructions therein.

This product must not be used for any purposes other than those described.

Handle adjustment

- > Pushing the handle release button (16) and hold it in position.
- > Slightly move the transportation handle (1) upward.
- > Release the handle release button and keep moving the transportation handle until it snaps in place (Fig. 30).

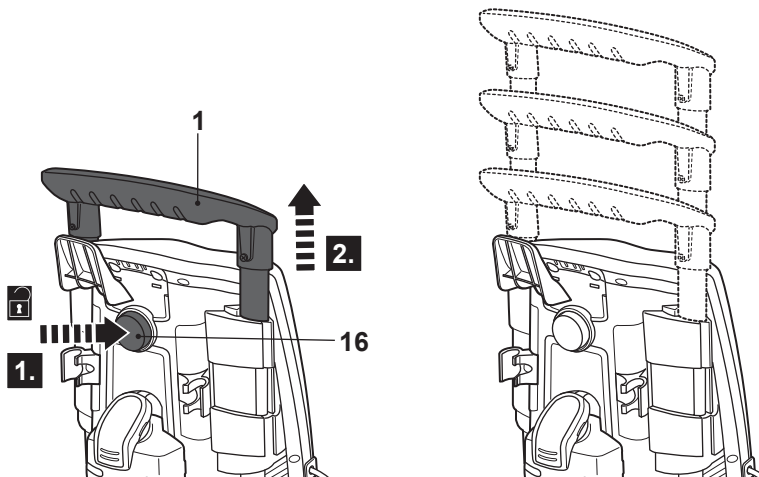
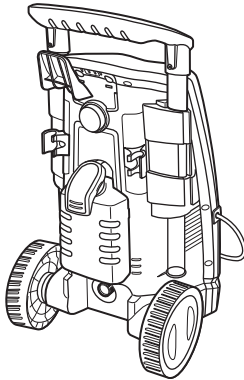
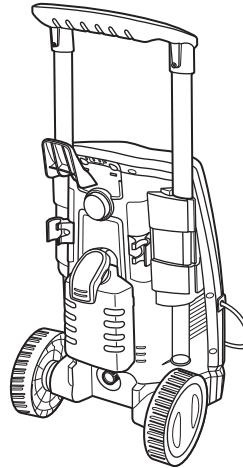

Fig. 30



Storage position



Transport position



WARNING! Always ensure that the handle release button (16) snaps into place after adjusting the transportation handle (1) in upper position! Never adjust the transportation handle to an intermediate position!

Accessory holder

Use the accessory holders to store the product accessories (Fig. 31):

- the upper and lower spray gun holders (3, 5) to store the spray gun (2) assembled with the pressure lance (4)
- the nozzle holder (9) to store both variable spray nozzle (18) and rotary nozzle (19)
- the extension lance holder (15) to store the extension lance (20c)
- the pressure hose holder (17) to store the pressure hose (8).

Completely unwind the pressure hose (8) from the holder (17) before operation.



WARNING! Always unwind the pressure hose completely before operation, to avoid damage or injuries!

In more detail...

Accessory holder

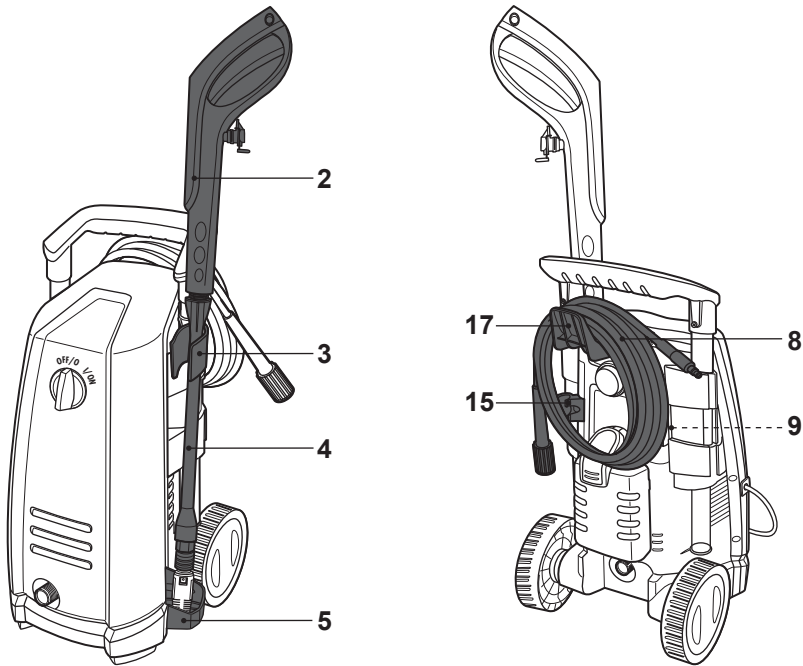

Fig. 31



NOTE: This product is equipped with several safety devices to avoid damage and injuries.

Overload cut-out

In case of overload, the motor stops. In this case, switch the product off, remove the mains plug and let it cool down for 10 minutes. Then repeat the starting procedure as described below.



WARNING! Make sure the on/off switch (7) is set to “OFF/O” (off) and insert the plug into a properly installed socket.

- > Turn on the water tap fully.
- > Turn the on/off switch (7) to "ON/I" (on).
- > Hold the spray gun (2) with both hands.
- > Direct the nozzle of the chosen accessory away from you towards the surface to be cleaned (Fig. 32).



Fig. 32



NOTE: Always keep a reasonable distance between the nozzle and the object to be washed in order to avoid damage.

- > Press the trigger (2d) and direct the water jet to the object to be washed.
 - > Release the trigger (2d) to stop the water jet.
- If the problem reoccurs more than once, contact your authorised service centre.

Trigger lock

The spray gun (2) is equipped with a trigger lock (2e) in order to prevent accidental activation of the trigger (2d).

Activate the trigger lock

When the trigger lock (2e) is in locked position, the spray gun trigger (2d) will be disabled (Fig. 33). Use the safety trigger lock (2e), when the product is not in use, when it is left unattended or during assembly of additional accessories.

Deactivate the trigger lock

When the trigger lock (2e) is in unlocked position, the spray gun trigger (2d) will be enabled and ready for use (Fig. 34).

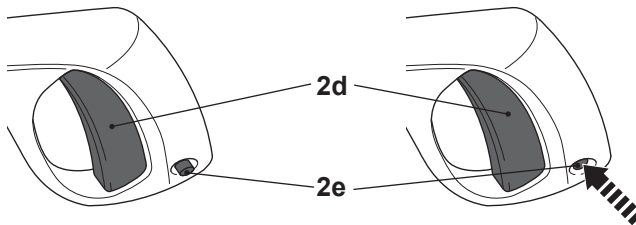

Fig. 33, locked position, trigger is disabled

Fig. 34, unlocked position, trigger is enabled

Safety valve

The safety valve is a pressure limiting valve. When the trigger (2d) is released, the valve opens and discharges the pressure inside the pump.

Automatic motor start/stop device

Automatic motor start/stop device is operated by the spray gun trigger (2d). When the trigger (2d) is released the dynamic pressure automatically cuts out the motor.

When the trigger (2d) is depressed the automatic drop in pressure starts the motor and the pressure is restored after a very slight delay.



NOTE: If the automatic motor start-stop device is to function correctly all trigger releasing and depressing operations must be performed with an interval of at least 5 seconds between each operation.

General operation

- > Check the product, its power cord and plug as well as accessories for damage before each use. Do not use the product if it is damaged or shows wear.
- > Double check that the accessories and attachments are properly fixed.
- > Always hold the product on its handle. Keep the handle dry to ensure safe support.
- > Ensure that the air vents are always unobstructed and clear. Clean them if necessary with a soft brush. Blocked air vents may lead to overheating and damage the product.
- > Switch the product off immediately if you are disturbed while working by other people entering the working area. Always let the product come to complete stop before putting it down.
- > Do not overwork yourself. Take regular breaks to ensure you can concentrate on the work and have full control over the product.

Switching On/off

- > Turn the on/off switch (7) clockwise to its on position **"I/ON"** to switch the product on (Fig. 35).
- > Turn the on/off switch (7) anticlockwise to its off position **"OFF/O"** to switch the product off (Fig. 36).

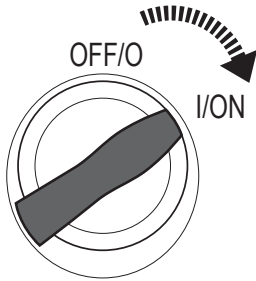

Fig. 35

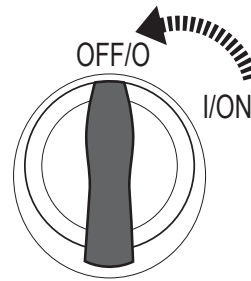

Fig. 36

Operation



WARNING! Do not operate the product when the ambient temperature is below 0 °C. Water will freeze inside the product and damage it.



WARNING! Do not operate the product with a closed water tap! This leads to dry running and subsequently damage the product! Kickback forces result from pressing the trigger! Therefore, always hold the spray gun with both hands! Pay attention to safe posture! Improper handling can lead to injuries!



WARNING! Make sure the on/off switch (7) is set to "OFF/O" (off) and insert the plug into a properly installed socket.

Connect the product to power and water supply as described.

- > Open the water supply.
- > Hold the spray gun (2) with both hands.
- > Direct the nozzle of the chosen accessory away from you towards the surface to be cleaned (Fig. 37).



Fig. 37

- > Unlock the trigger (2d) and press it until a constant amount of water flows through the nozzle, to allow air trapped in the hose to escape.
- > Release the trigger (2d).
- > Turn the on/off switch (7) to "ON/I" (on).
- > Hold the spray gun (2) with both hands (Fig. 38). Direct the water jet to the object to be cleaned and press the trigger (2d).

In more detail...

Operation

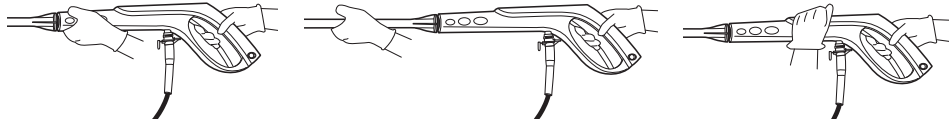

Fig. 38



WARNING! Beware of kickback when pressing the trigger!



NOTE: Always keep a reasonable distance between the nozzle and the object to be cleaned in order to avoid damage. Ask your specialist dealer for advice if required.

- > Release the trigger (2d) to stop the water jet.

Tips



WARNING! Prevent water from penetrating the air vents of the product to minimise the risk of damage to the product and to reduce the risk of electric shock to the operator!

- > When dealing with vertical surfaces work from the bottom upwards. Rinse from the bottom upward, use the high pressure jet at a minimum distance of 30 cm at 45° angle and then from the top downward.
- > In some cases, scrubbing with brushes is needed to remove dirt. High pressure is not always the best solution for good washing results, since it may damage some surfaces. The finest (thinnest jet) adjustable nozzle jet setting should not be used on delicate or painted parts, or on pressurised components (e. g. tyres, inflation valves, etc.).
- > Effective washing depends on both the pressure and volume of the water used, to the same degree.
- > Begin by spraying in a testing area free and clear of people and objects.

Wood and vinyl decks

- > Reduce your work area to smaller sections and clean each section one at a time for optimal results.
- > Rinse at high pressure using fan spray keeping the nozzle at least 15-25 cm from the cleaning surface.
- > Maintain a further distance from the cleaning area when using jet spray.

- > Caution! Increase the distance from the cleaning area for softer woods.

Cement patios, stone, and brick

- > Rinse at high pressure using fan spray in a sweeping motion keeping the nozzle at least 7-15 cm from the cleaning surface.
- > Maintain a further distance from the cleaning area when using jet spray.

Cars, boats, and motorcycles

- > Clean one side at a time to achieve the best results.
- > Rinse at high pressure using fan spray in a sweeping motion keeping the nozzle at least 20 cm from the cleaning surface. Maintain a further distance from the cleaning area when using jet spray.
- > Wipe surface dry for a polished finish.
- > Do not clean the engine with this product!

After use

- > Release the trigger (2d) and lock it.
- > Turn the on/off switch (7) to its off position "OFF/O".
- > Turn off the water tap.
- > Unlock and press the trigger (2d) to release the pressure still present in the product.



WARNING! Only separate the high-pressure hose from the spray gun and the water hose from the product when no more pressure exists in the system! Also ensure that the product is turned off and separated from electrical supply!

- > Lock the trigger (2d).
- > Disconnect the product from the power supply.
- > Separate the water hose from the water supply and then from the water hose connector (22).
- > Wind the pressure hose (8) and place it onto the pressure hose holder (3). Ensure that the hose is not bent or twisted but winded up evenly.
- > Dismantle the accessories in the reverse sequence of the assembly instructions if you are not going to use this product for a long period of time.
- > Check, clean and store the product as described below.

The golden rules for care



WARNING! Always switch the product off, disconnect the product from the water and power supply and let the product cool down before performing inspection, maintenance and cleaning work!



- > Keep the product clean. Remove debris from it after each use and before storage.
- > Regular and proper cleaning will help ensure safe use and prolong the life of the product.
- > Inspect the product before each use for worn and damaged parts. Do not operate it if you find broken and worn parts.



WARNING! Only perform repairs and maintenance work according to these instructions! All further works must be performed by a qualified specialist!

General cleaning

- > Clean the product with a dry cloth. Use a brush for areas that are hard to reach.
- > In particular clean the air vents (11) after every use with a cloth and brush.
- > Remove stubborn dirt with high pressure air (max. 3 bar).



NOTE: Do not use chemical, alkaline, abrasive or other aggressive detergents or disinfectants to clean this product as they might be harmful to its surfaces.

- > Check for worn or damaged parts. Replace worn parts as necessary or contact an authorised service centre for repair before using the product again.

Maintenance

Before and after each use, check the product and accessories (or attachments) for wear and damage. If required, exchange them for new ones as described in this instruction manual. Observe the technical requirements.

Nozzle

Remove any dirt deposits from the nozzle hole (18, 19) using the cleaning needle (23) (Fig. 39).

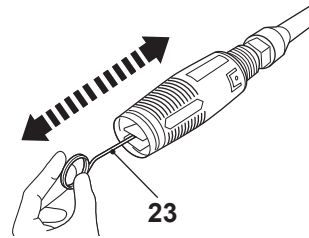

Fig. 39

Filter

- > Remove the water hose connector (22) from the water inlet (13).
- > Disassemble the water hose connector (22) (Fig. 40).
- > Rinse the parts with clear water (Fig. 41).

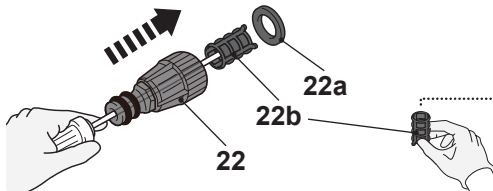

Fig. 40

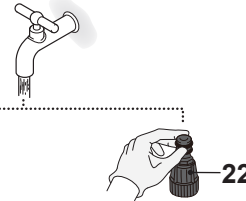

Fig. 41

O-Ring

Apply a drop of lubricant to the O-ring at connector of the pressure hose (8) (Fig. 42, A).

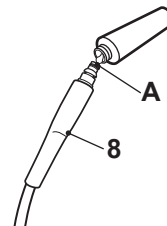

Fig. 42

Lime scale removal

From time to time – according to the nature of your tap water – calcium deposits form in the product and accessories. The strength of the deposits (and thus the frequency of removal) depends upon the degree of hardness of the water and how often the product is used. Check with your local water company in order to find the hardness of the water in your area.



NOTE: Use a mixture of water and citric acid or vinegar for lime scale removal. These substances are readily biodegradable and environmentally friendly!

- > Make a mixture of one part of proper vinegar and two parts hot water ($\leq 50^{\circ}\text{C}$) in a suitable container, e. g. in a bowl.
- > Lay the detachable accessories in the mixture.
- > Leave the accessories in the mixture for approximately 12 hours.
- > Then rinse the accessories with clear water.

UK plug

If you need to replace the fitted plug, then follow the instructions below.
IMPORTANT: The wires in the mains lead are coloured in accordance with the following code:

Blue – Neutral

Brown – Live

As the colours of the wire in the mains lead of this product may not correspond with the coloured marking identifying the terminals in your plug, proceed as follows. The wire, which is coloured blue, must be connected to the terminal, which is marked with N or coloured black. The wire, which is coloured brown, must be connected to the terminal, which is marked L or coloured red.

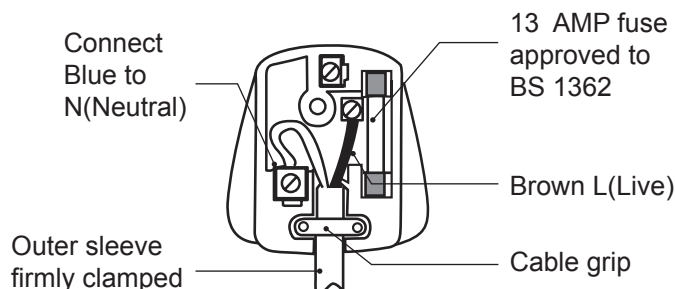



WARNING! Never connect live or neutral wires to the earth terminal of the plug, which is marked with E.

Only fit an approved BS 1363 or BS 1363/A plug and correctly rated BS 1362 13 Amp fuse. If in doubt, consult a qualified electrician.



NOTE: If a moulded plug is fitted and has to be removed take great care in disposing of the plug and severed cable, it must be destroyed to prevent engaging into a socket.

Repair

This product does not contain any parts that can be repaired by the consumer. Contact an authorised service centre or a similarly qualified person to have it checked and repaired.

There are no spare parts available for this product. Contact an authorised dealer or through our customer service for more information.

Storage

- > Switch the product off and disconnect it from the water and power supply.
- > Clean the product as described above.
- > Adjust the transportation handle (1) to the storage position.
- > Store the product and its accessories in a dark, dry, frost-free, well-ventilated place.
- > Always store the product in a place that is inaccessible to children. The ideal storage temperature is between 10 °C and 30 °C.
- > We recommend using the original package for storage or covering the product with a suitable cloth or enclosure to protect it against dust.
- > Drain remaining water and wash out the detergent tank (14a) at the end of the working session. To wash out the tank (14a), use clean water instead of the detergent.
- > Store the accessories in the accessory holders (3, 5, 9, 15, 17) of the product (Fig. 43).

In more detail...

Storage

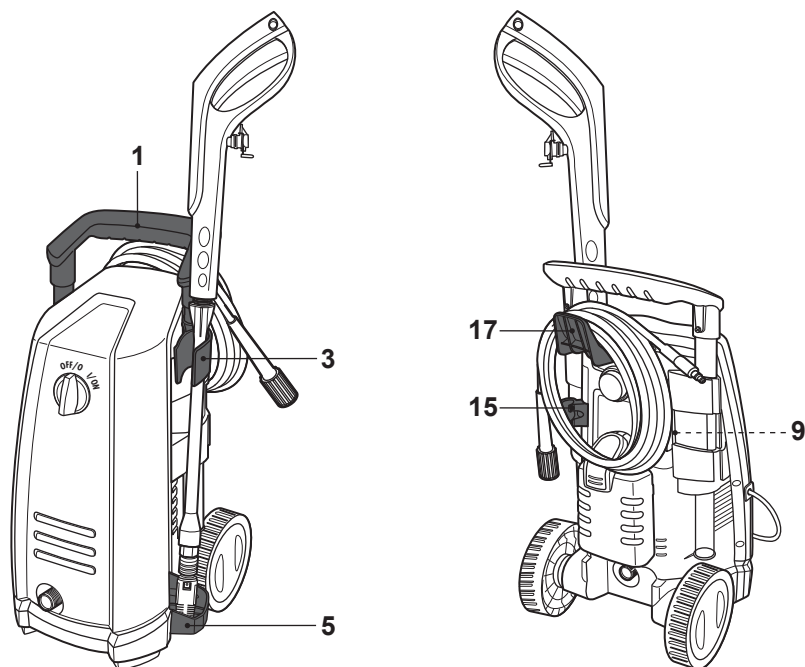

Fig. 43

Transportation

- > Switch the product off and disconnect it from the water and power supply before transporting it anywhere.
- > Attach transportation guards, if applicable.
- > Adjust the transportation handle (1) to the transport position.
- > Tilt the product towards you until it balances on the wheels (12). Then move it by its transportation handle (1) (Fig. 44).
- > Protect the product from any heavy impact or strong vibrations which may occur during transportation in vehicles.
- > Secure the product to prevent it from slipping or falling over.

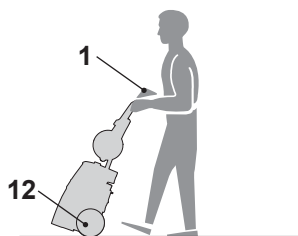

Fig. 44

Troubleshooting

Suspected malfunctions are often due to causes that the users can fix themselves. Therefore check the product using this section. In most cases the problem can be solved quickly.



WARNING! Only perform the steps described within these instructions! All further inspection, maintenance and repair work must be performed by an authorised service centre or a similarly qualified specialist if you cannot solve the problem yourself!

Problem	Possible cause	Solution
1. Product does not start	1.1 Not connected to power supply 1.2 Power cord or plug is defective 1.3 Other electrical defect to the product 1.4 Trigger lock has not been deactivated 1.5 Nozzle clogged	1.1 Connect to power supply 1.2 Check by a specialist electrician 1.3 Check by a specialist electrician 1.4 Unlock trigger 1.5 Clean nozzle
2. Product does not reach full power	2.1 Extension cord not suitable for operation with this product 2.2 Power source (e. g. generator) has too low voltage 2.3 Air vents are blocked 2.4 Insufficient water supply 2.5 Filter is dirty 2.6 Hose partly blocked 2.7 Nozzle partly blocked 2.8 Pressure hose leaking 2.9 System not airtight	2.1 Use a proper extension cord 2.2 Connect to another power source 2.3 Clean the air vents 2.4 Check water supply 2.5 Check filter 2.6 Check hose 2.7 Check nozzle 2.8 Replace pressure hose 2.9 Tighten all connections

In more detail...

Troubleshooting

Problem	Possible cause	Solution
3. No water jet	3.1 Trigger is not pressed 3.2 Trigger lock is activated 3.3 No water supply 3.4 Filter is dirty 3.5 Hose blocked 3.6 Nozzle blocked	3.1 Press the trigger 3.2 Deactivate the trigger lock 3.3 Check water supply 3.4 Clean filter 3.5 Check hose 3.6 Check nozzle
4. Water leakage from product	4.1 Small leakage in the product related to its technical conditions are not a problem	4.1 Have electrician examine in case of strong leakage
5. No detergent taken in	5.1 Detergent too dense 5.2 Deposits or restriction in detergent circuit 5.3 Variable spray nozzle not set on low pressure	5.1 Dilute with water 5.2 Flush with clean water and eliminate any restrictions. 5.3 Set the variable spray nozzle on low pressure
6. Excessive vibration or noise	6.1 Water inlet volume too low 6.2 Bolts/nuts are loose	6.1 Increase water inlet quantity 6.2 Tighten bolts/nuts

Recycling and disposal

The product comes in a package that protects it against damage during shipping. Keep the package until you are sure that all parts have been delivered and the product is working properly. Recycle the package afterwards.



WEEE symbol. Waste electrical products should not be disposed of with household waste. Please recycle where facilities exist. Check with your Local Authority or local store for recycling advice.

EC declaration of conformity

TITAN

Declaration of conformity

We, Importer
Kingfisher International Products Limited
3 Sheldon Square London W2 6PX United Kingdom

Declare that the product
Designation: High Pressure Cleaner
TTB669PRW

Complies with the following directives:
2006/42/EC - Machinery Directive
2014/30/EU - Electromagnetic Compatibility Directive
Standards and technical specifications referred to:
EN 60335-1:2012+A11:2014
EN 60335-2-79:2012
EN 62233:2008
EN 55014-1:2006+A1:2009+A2:2011
EN 55014-2:2015
EN 61000-3-2:2014
EN 61000-3-3:2013
EN 61000-3-11:2000

2000/14/EC amended by 2005/88/EC - Noise Emission in the Environment by
Equipment for Use Outdoors Directive

Notified body: TÜV SÜD Certification and Testing (China) Co., Ltd Shanghai Branch
The conformity assessment followed was according to Annex V of the directive
Measured Sound Power Level: 90.5 dB(A)
Guaranteed Sound Power Level: 91 dB(A)
EN ISO 3744:1995

2011/65/EU - Restrictions of the Use of Certain Hazardous Substances in Electrical and
Electronic Equipment

Authorised Signatory and Technical File Holder
Date: 23/01/2018

Signature: *Lisa Davis*
Name / title: Lisa Davis / Group Quality Director

Kingfisher International Products Limited
3 Sheldon Square London W2 6PX United Kingdom



2017

High Pressure Cleaner 1800W - TTB669PRW

In more detail...



EN

Kingfisher International Products Limited
3 Sheldon Square London W2 6PX
United Kingdom
