

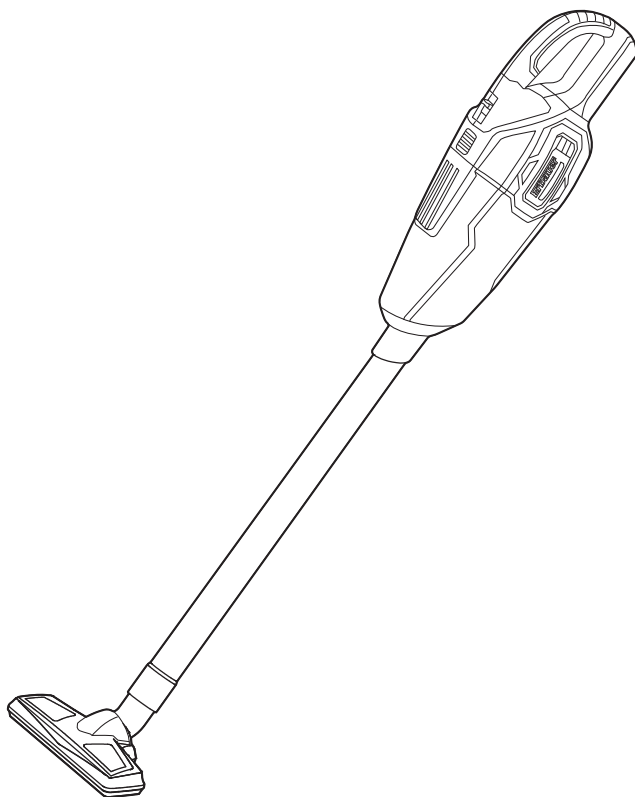

**Erbauer**



MNL\_EVAC18-Li\_V01\_180608

EAN. 3663602799122

# EVAC18-Li

ORIGINAL INSTRUCTIONS

EN



Safety instructions



Product description



Assembly



Use



Care & maintenance



Guarantee



Declaration of Conformity



**WARNING!** Please read all safety warnings carefully and be sure that they are fully understood before handling the tool.

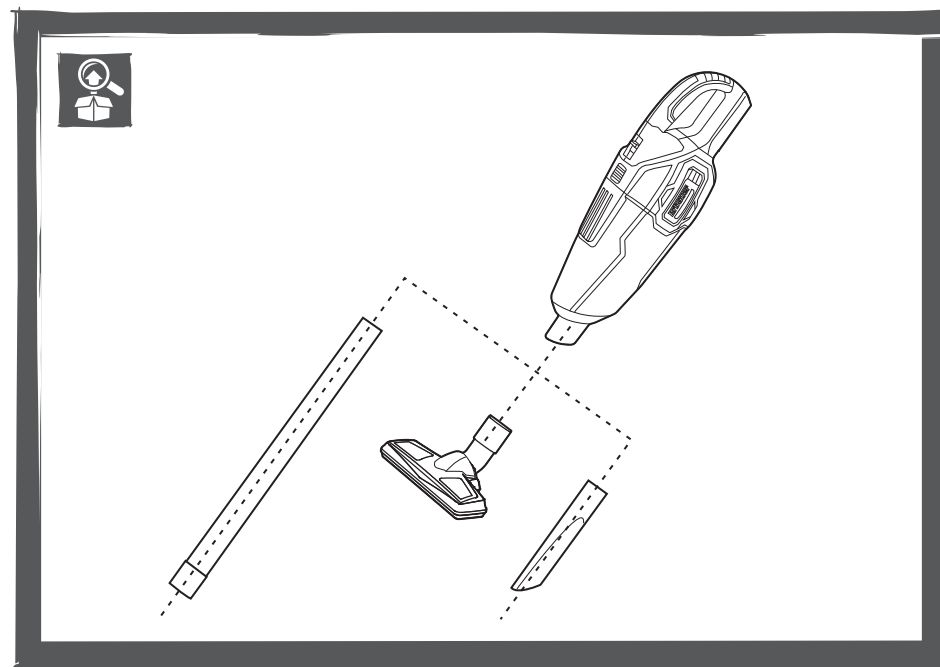

# PRODUCT DESCRIPTION



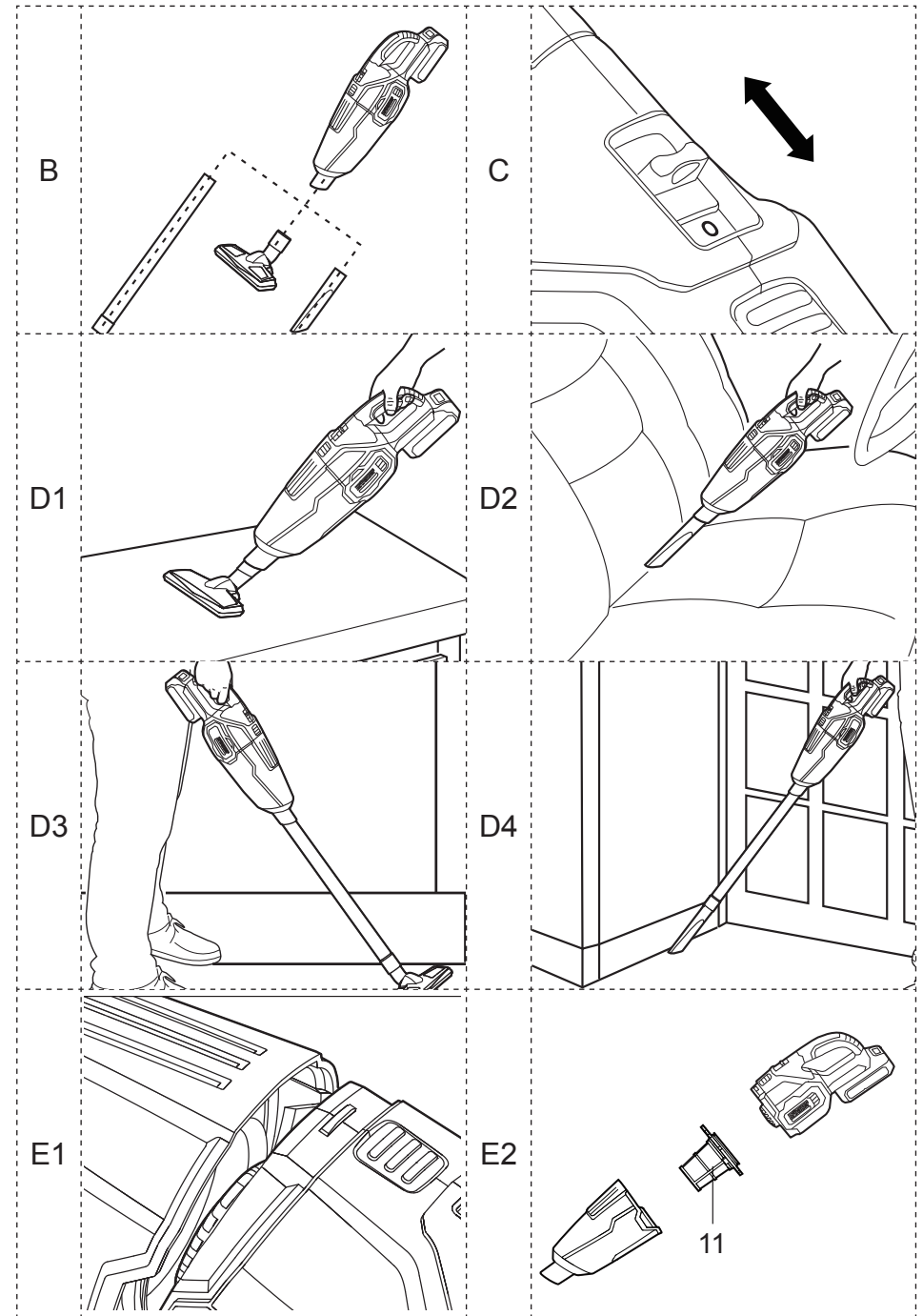
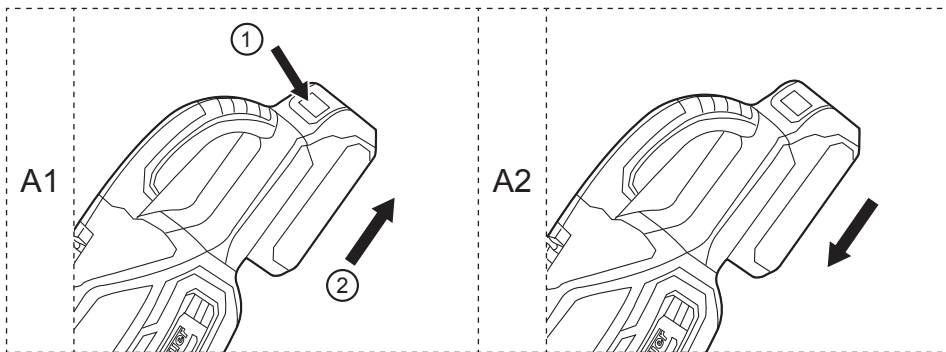
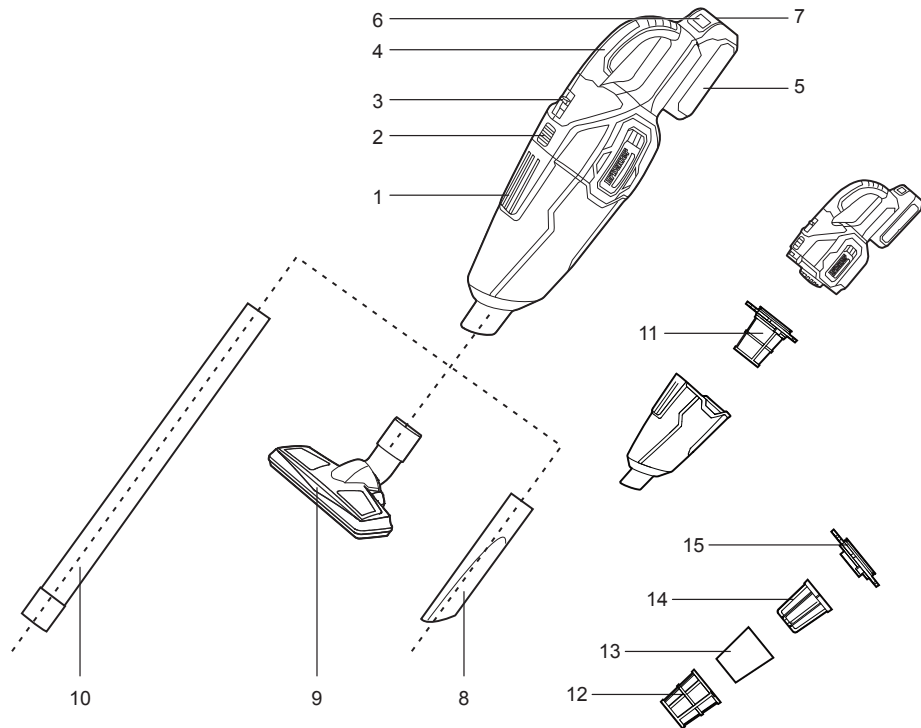

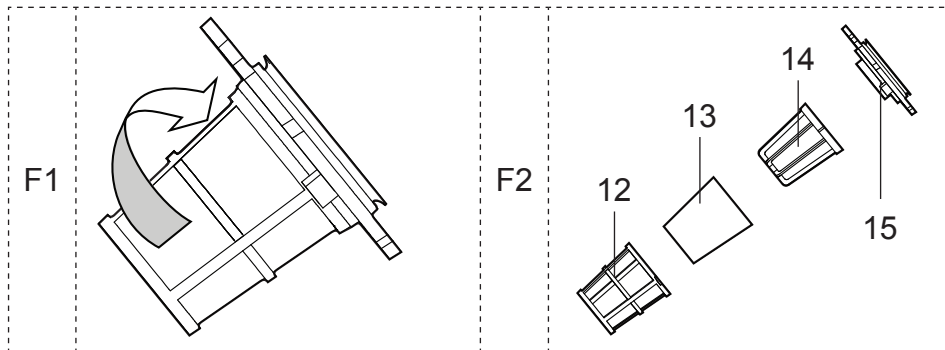
## SAFETY INSTRUCTIONS

### GENERAL SAFETY WARNINGS



**WARNING!** Read all safety warnings, instructions, illustrations and specifications provided with this tool. Failure to follow all instructions listed below may result in electric shock, fire and/or serious injury.

Save all warnings and instructions for future reference.

- a. This appliance can be used by children aged from 8 years and above and persons with reduced physical, sensory or mental capabilities or lack of experience and knowledge if they have been given supervision or instruction concerning use of the appliance in a safe way and understand the hazards involved. Children shall not play with the appliance. Cleaning and user maintenance shall not be made by children without supervision.
- b. This vacuum cleaner is intended for household light-duty use only. Do not use outdoors or on wet surfaces.
- c. Do not pick up the following materials:
  - Hot materials such as lit cigarettes or spark/metal dust generated by grinding/cutting metal.
  - Flammable materials such as gasoline, thinner, benzene, kerosene or paint.
  - Explosive materials like nitroglycerin.
  - Ignitable materials such as Aluminum, zinc, magnesium, titanium, phosphorus or celluloid.
  - Wet dirt, water, oil or the like.

- Hard pieces with sharp edges, such as wood chips, metals, stones, glasses, nails, pins or razors.
  - Powder to clot such as cement or toner.
  - Conductive dust such as metal or carbon.
  - Fine particle like concrete dust. Such action may cause fire, injury and/or property damage.
- d. Stop operation immediately if you notice anything abnormal.
  - e. If you drop or strike the cleaner, check it carefully for cracks or damage before operation.
  - f. Do not bring close to stoves or other heat sources.
  - g. Do not block the intake hole or vent holes.

#### BATTERY TOOL USE AND CARE

- a. **Recharge only with the charger specified by the manufacturer.** *A charger that is suitable for one type of battery pack may create a risk of fire when used with another battery pack.*
- b. **Use tools only with specifically designated battery packs.** *Use of any other battery packs may create a risk of injury and fire.*
- c. **When battery pack is not in use, keep it away from other metal objects, like paper clips, coins, keys, nails, screws or other small metal objects, that can make a connection from one terminal to another.** *Shorting the battery terminals together may cause burns or a fire.*
- d. **Under abusive conditions, liquid may be ejected from the battery; avoid contact. If contact accidentally occurs, flush with water. If liquid contacts eyes, additionally seek medical help.** *Liquid ejected from the battery may cause irritation or burns.*
- e. **Do not use battery pack or tool that is damaged or modified.** *Damaged or modified batteries may exhibit unpredictable behaviour resulting in fire, explosion or risk of injury.*

- f. **Do not expose a battery pack or tool to fire or excessive temperature.** *Exposure to fire or temperature above 130 °C may cause explosion.*
- g. **Follow all charging instructions and do not charge the battery pack or tool outside the temperature range specified in the instructions.** *Charging improperly or at temperatures outside the specified range may damage the battery and increase the risk of fire.*

#### SERVICE

- a. **Have your tool serviced by a qualified repair person using only identical replacement parts.** *This will ensure that the safety of the tool is maintained.*
- b. **Never service damaged battery packs.** *Service of battery packs should only be performed by the manufacturer or authorized service providers.*

#### ADDITIONAL SAFETY WARNINGS FOR BATTERY

- a. *Do not connect the positive terminal and negative terminal of the battery to each other with any metal object (such as wire).*
- b. *Do not carry or store battery together with necklaces, hairpins or other metal objects.*
- c. *Do not pierce the battery with nails, strike the battery with a hammer, step on the battery or otherwise subject it to strong impacts or shocks.*
- d. *Do not solder directly onto the battery.*
- e. *Do not expose battery to water or salt water, or allow the battery to get wet.*
- f. *Do not disassemble or modify the battery.*
- g. *Do not place the battery in or near fire, on stoves or other high temperature locations. Do not place the battery in direct sunlight, or use or store the battery inside cars in hot weather.*

- h. Do not place the battery in microwave ovens, high-pressure containers or on induction cookware.*
- i. If you intend to store a battery for a period without use then store battery at room temperature (19°C to 25°C), charged to about 30 – 50% of capacity. When storing for very long periods boost charge the battery once per year to prevent over discharge.*



## PRODUCT DESCRIPTION

- |                                 |                     |
|---------------------------------|---------------------|
| 1. Dust-canister                | 9. Floor nozzle     |
| 2. Dust-canister release button | 10. Extension tube  |
| 3. On/off Switch                | 11. Filter assembly |
| 4. Gripping handle              | 12. Filter cover    |
| 5. Battery pack (not included)  | 13. Fabric filter   |
| 6. Battery pack release button  | 14. Filter basket   |
| 7. Power bar button             | 15. Filter seal     |
| 8. Crevice nozzle               |                     |

## 01 TECHNICAL SPECIFICATIONS

Rated voltage	18 V 
Vacuum(max):	3.8 kPa
Capacity	650 mL
Overall length	981 mm
Weight(without battery):	1.2 kg

### For use with battery pack and charger as below:

Battery pack model: EBAT18-Li-2 / EBAT18-Li-4 / EBAT18-Li-5

Charger model: EC18-Li / EFC18-Li / EMC18-Li

Ambient temperature range for tool and battery use: -10°C to 40°C

### RATING LABEL EXPLANATION

**EVAC18-Li = MODEL NUMBER**

**E = ERBAUER**

**VAC = Vacuum Cleaner**

**18 = 18 V d.c.**

**Li = LITHIUM ION**



## ASSEMBLY

### 01 SYMBOLS



Read the operator's manual



Wear eye protection



Wear hearing protection.



Wear a dust mask.



Do not dispose of battery packs in rivers or immerse in water.



Do not dispose of battery packs in fire. They will explode and cause injury.



Do not expose battery packs to heat in excess of 40°C



Keep Cool Battery Technology

yyWxx

Manufacturing date code: Year of manufacturing (20yy) and week of manufacturing (Wxx)

### 02 UNPACKING

Unpack all parts and lay them on a flat, stable surface.

- Remove all packing materials and shipping devices, if applicable.
- Make sure the delivery contents are complete and free of any damage. If you find that parts are missing or show damage do not use the product but contact your dealer. Using an incomplete or damaged product represents a hazard to people and property.
- Ensure that you have all the accessories and tools needed for assembly and operation. This also includes suitable personal protective equipment



**WARNING!** The product and the packaging are not children's toys! Children must not play with plastic bags, sheets and small parts! There is a danger of choking and suffocation!

### 03 ASSEMBLING THE MACHINE

#### CHARGING YOUR BATTERY PACK







The battery has been shipped in a low charge condition. Charge it fully before first use. Refer to the charger instruction manual for the details.

#### TO REMOVE OR INSTALL THE BATTERY PACK (A1, A2)

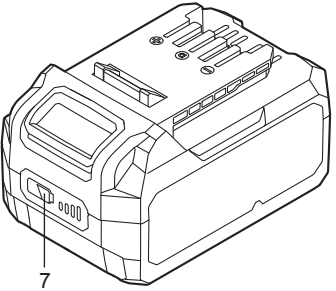
Depress the battery pack release button to release and slide the battery pack out from your tool. After recharge, slide it back into your tool. A simple push and slight pressure will be sufficient.

## BATTERY PACK POWER BAR

The Li-Ion battery pack (5) is equipped with a POWER BAR which is used to give an indication of the battery pack's remaining charge. Press the POWER BAR button (7) to check battery charge as below. The LED will stay lit for approximately 5 seconds.

	76-100% Charge	
	51-75% Charge	
	26-50% Charge	
	5-25% Charge	
	under 5% Charge	

## INSTALLING AND REMOVING NOZZLES (B)

To install, firmly insert one of the nozzles completely into the intake port on the dust canister (1). To remove, simply pull the nozzle out of the dust canister.

## INSTALLING AND REMOVING THE EXTENSION TUBE (B)

To install, firmly insert the extension tube (10) completely into the intake port on the dust canister (1), then insert one of the nozzles into the tube.

To remove, simply pull the extension tube out of the dust canister.



USE

## ON/OFF SWITCH (C)

To turn the vacuum cleaner on, push the on/off switch (3) forward.

To turn the vacuum cleaner off, push the on/off switch (3) backward.

## OPERATING (D1-D4)

Before using, check and ensure that the filter assembly (11) is assembled securely without cracks or damages.

Select a suitable nozzle for desired use. The extension tube (10) can be used if necessary..

Hold the product by its gripping handle (4). Keep the gripping handle (4) dry to ensure safe support.

Switch the product on and push it at an even speed for cleaning.

## TROUBLESHOOTING

Dust in the dust canister and filter may cause weak power for the vacuum cleaner. The solution is cleaning the dust canister and filter or changing a new one.





## CARE & MAINTENANCE

### CLEANING

#### CLEANING THE DUST CANISTER (E1, E2)

To maintain optimal performance of the vacuum cleaner, clean the dust canister (1) after each use, or whenever the suction power is weak.

Press the release button (2) and remove the dust canister (1) from the motor housing. Remove the filter assembly (11) from the dust canister (1).

Shake/tap out the dust canister (1) over a suitable waste bin. If required, clean the dust canister (1) with a moist cloth.

#### CLEANING THE FILTER ASSEMBLY (F1, F2)

Remove the filter assembly (11) from the dust canister.

Twist and remove the filter cover (12) from the filter seal (15).

Remove the fabric filter (13) along with its filter basket (14) and brush the fabric filter (13) with a soft brush. If necessary, you can wet clean the fabric filter (13).

Remove the fabric filter (13) from the filter basket (14) and wash both parts under running water.

Squeeze the water out of the fabric filter (13) and allow the fabric filter and filter basket to dry fully, in order to avoid the formation of mould.

Reassembly is carried out in reverse order.



**NOTE:** After three times washing, the fabric filter should be replaced by a new one.

### MAINTENANCE

Your tool requires no additional lubrication or maintenance. There are no user serviceable parts in your tool. Never use water or chemical cleaners to clean your tool. Wipe clean with a dry cloth. Always store your tool in a dry place. Keep the motor ventilation slots clean. Keep all working controls free of dust.

### RECYCLING AND DISPOSAL



Waste electrical products should not be disposed of with household waste. Please recycle where facilities exist. Check with your Local Authority or retailer for recycling advice.

For further information visit [www.recycle-more.co.uk](http://www.recycle-more.co.uk)

### DISPOSAL OF AN EXHAUSTED BATTERY PACK



To preserve natural resources, please recycle or dispose of the battery pack properly. This battery pack contains Li-Ion batteries. Consult your local waste authority for information regarding available recycling and/or disposal options. Discharge your battery pack by operating your tool, then remove the battery pack from the tool housing and cover the battery pack connections with heavy-duty adhesive tape to prevent short circuit and energy discharge. Do not attempt to open or remove any of the components.

### REPAIR

This product does not contain any parts that can be repaired by the consumer. Contact an authorised service centre or a similarly qualified person to have it checked and repaired.

### STORAGE

- Switch the product off and remove the battery pack.
- Clean the product as described above.
- Store the product and its accessories in a dark, dry, frost-free, well-ventilated place.
- Always store the product in a place that is inaccessible to children.
- We recommend using the original package for storage or covering the product with a suitable cloth or enclosure to protect it against dust.

### TRANSPORTATION

- Switch the product off and remove the battery pack.
- Attach transportation guards, if applicable.
- Always carry the product by its handle.
- Protect the product from any heavy impact or strong vibrations which may occur during transportation in vehicles.
- Secure the product to prevent it from slipping or falling over.



## GUARANTEE

At **Erbauer** we take special care to select high quality materials and use manufacturing techniques that allow us to create ranges of products incorporating design and durability. That's why we offer a 2 year trade guarantee against manufacturing defects on our **Erbauer** power tool products.

This power tool is guaranteed for 2 years from the date of purchase, if bought in store, delivered or bought online. You may only make a claim under this guarantee upon presentation of your sales receipt or purchase invoice. Please keep your proof of purchase in a safe place.

This guarantee covers product failures and malfunctions provided the **Erbauer** power tool was used for the purpose for which it is intended and subject to installation, cleaning, care and maintenance in accordance with standard practice and with the information contained above and in the user manual. This guarantee does not cover defects and damage caused by or resulting from:

- Normal wear and tear, including accessory wear
- Overload, misuse or neglect
- Repairs attempted by anyone other than an authorised agent
- Cosmetic damage
- Damage caused by foreign objects, substances or accidents
- Accidental damage or modification
- Failure to follow manufacturer's guidelines
- Loss of use of the goods

This guarantee is limited to parts recognised as defective. It does not, in any case, cover ancillary costs (movement, labour) and direct and indirect damage.

If the **Erbauer** power tool is defective during the guarantee period, then we reserve the right, at our discretion, to replace the item with a product of equivalent quality and functionality or to provide a refund.

This guarantee only applies to the country of purchase or delivery and is not transferrable to any other countries. This guarantee is non-transferrable to any other person or product. Relevant local law will apply to this guarantee.

Guarantee related queries should be addressed to a store affiliated with the distributor you purchased the **Erbauer** power tool from.

This guarantee is in addition to and does not affect your statutory rights relating to faulty goods as a consumer.



## DECLARATION OF CONFORMITY



### EU Declaration of Conformity

**We**  
**Kingfisher International Products Limited**  
**3 Sheldon Square**  
**London W2 6PX**  
**United Kingdom**

Declare that the product:  
 Erbauer 18V cordless vacuum cleaner EVAC18-Li  
 Serial number 00001-99999

Complies with the essential health and safety requirements of the following directives:

2014/35/EU The Low Voltage Directive

References to the following harmonized standard were made:

EN 60335-1:2012+A11:2014+A13:2017

EN 60335-2-2:2010+A11:2012+A1:2013

EN 62233:2008

2014/30/EU Electromagnetic Compatibility directive

References to the following harmonized standard were made:

EN55014-1: 2017

EN55014-2: 2015

(EU) 2015/863 amending 2011/65/EU Restrictions of the Use of Certain Hazardous Substances in Electrical and Electronic Equipment

Authorised signatory and technical file holder:

Kingfisher International Products Limited  
 3 Sheldon Square  
 London W2 6PX  
 United Kingdom

on: 18/06/2018

Lisa Davis  
 Group Quality Director

**Manufacturer • Fabricant • Producent • Hersteller • Producator • Fabricante:**

Kingfisher International Products Limited  
3 Sheldon Square London W2 6PX  
United Kingdom  
[www.kingfisher.com/products](http://www.kingfisher.com/products)

**EN DISTRIBUTOR:**

B&Q plc,  
Chandlers Ford, Hants, SO53 3LE  
United Kingdom  
[www.diy.com](http://www.diy.com)

Screwfix Direct Limited,  
Trade House, Mead Avenue,  
Yeovil, BA22 8RT, United Kingdom  
[www.screwfix.com](http://www.screwfix.com)

To view instruction manuals online,  
visit [www.kingfisher.com/products](http://www.kingfisher.com/products)