

# WC FRAME INSTRUCTIONS

INSTALLATION MUST BE CARRIED OUT BY A QUALIFIED TRADESMAN

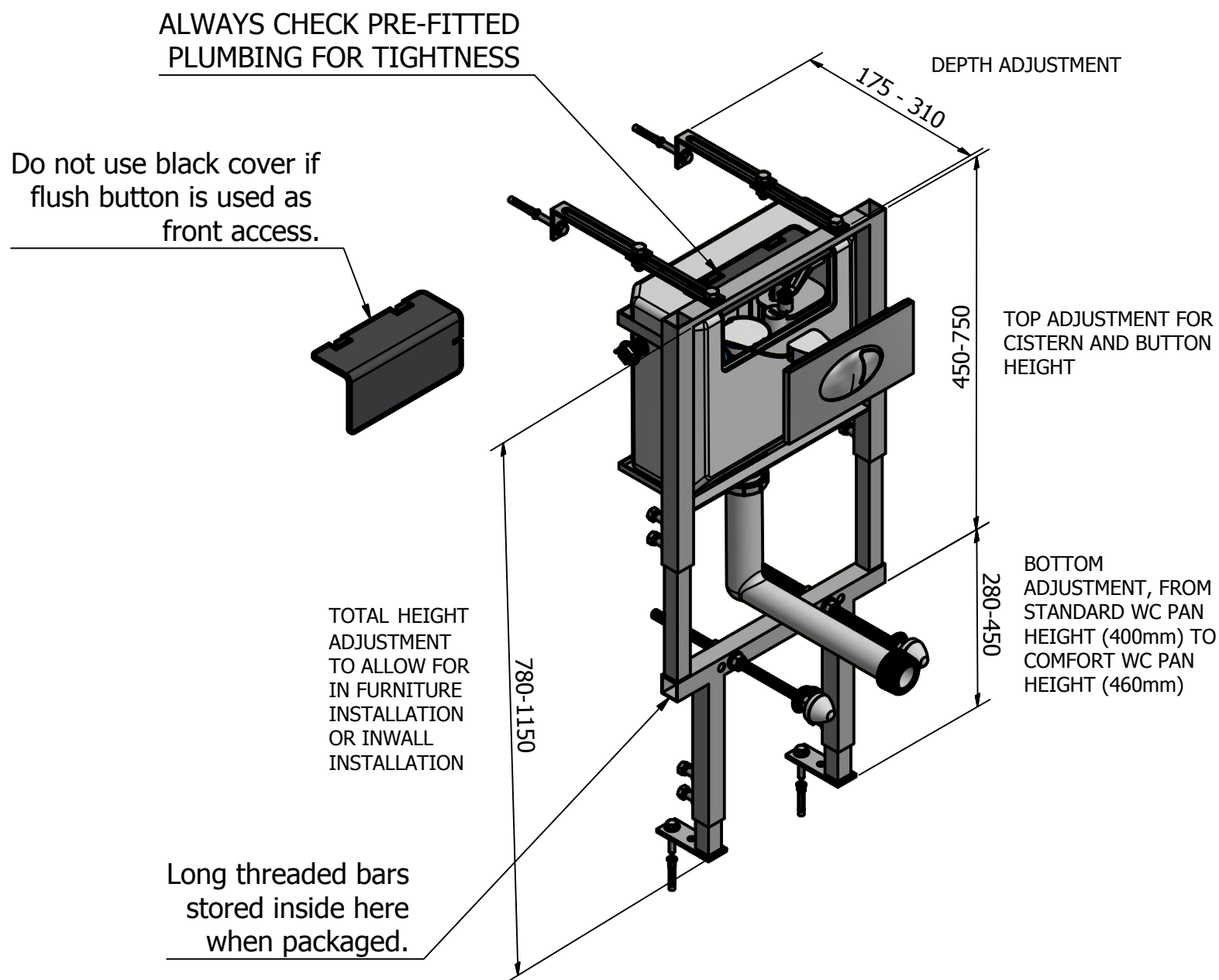

ADJUST THE FRAME TO THE CORRECT HEIGHT FOR YOUR INSTALLATION USING THE TELESCOPIC LEGS AND FRAME, THEN TIGHTEN THE 8 (12) RETAINING BOLTS WITH A WRENCH.

FIX THE FRAME TO THE WALL AND FLOOR USING THE RAWL BOLTS AND PLUGS SUPPLIED, WHEN FIXING TO A STUD WALL ENSURE THAT THE WALL IS FULLY BATTENED. THIS UNIT MUST BE FULLY SECURED TO THE WALL AND FLOOR, IF THE FIXINGS SUPPLIED ARE NOT SUITABLE FOR YOUR TYPE OF WALL SUITABLE FIXINGS MUST BE USED.

WHEN THE UNIT IS IN THE REQUIRED POSITION, MARK OUT THE FACIA FOR ALL CONNECTIONS AND FIXINGS AS SHOWN AND CUT OUT ACCORDINGLY.

MEASURE THE POSITION OF THE WC AND TRIM THE FLUSH AND SOIL PIPES TO SUITE.

RIGID FLUSH PIPE CAN BE USED FROM 780-900mm

FLEXIBLE FLUSH PIPE MUST BE USED WHEN FRAME IS SET HIGHER THAN 900mm

ALSO MEASURE FOR THE LENGTH OF 12 X 310mm SS RODS (4) TO FIX THE PAN AND TRIM IF NECESSARY.

ASSEMBLE THE PUSH BUTTON PLATE AND CONNECT TO THE FLUSH VALVE CABLE BOX.

# WC FRAME INSTRUCTIONS

PARTS LIST			
ITEM	QTY	PART NUMBER	DESCRIPTION
1	1	Inwall WC telescopic bottom frame	
2	1	Inwall WC telescopic top frame	
3	2	Inwall WC leg	
4	2	12 mm x 310 mm rod	
5	2	Wall bracket plate	
6	2	Wall bracket L plate	
7	6	12 N	Metric Plain Washers
8	6	BS 3692 - M12	Precision hexagon nuts
9	2	WC nut cover cap bush	
10	2	WC nut cover cap	
11	10	ANSI B18.22M - 10 N	Metric Plain Washers
12	8	M10 x 1.5 x 40	Hex Machine Screw
13	2	M10 x 1.5 x 30	Hex Machine Screw
14	2	M10 Type 8	metric hexagon nuts
15	4	8 x 50	Hexagon head screws
16	4	8 mm rawl plug	
17	2	10 x 25 mm bolt	
18	2	M5 x 25	Phillips metric machine screws
19	2	M5	Hex Nut
20	2	M5	Flat metal washers
21	1	Inwall front access concealed cistern	
22	1	Flush pipe	
23	1	Concealed cistern valve bracket	
24	1	Inwall frame concealed cistern cover plate	
25	1	cc flexi hose	
26	3	cc flexi hose plastic connecting nut	
27	1	cc flexi hose plastic washer	
28	1	cc flexi hose rubber washer	
29	1	Inlet valve	
30	1	Cable flush valve	
31	1	Push button plate	
32	1	Outer oval button	
33	1	inner oval button	
34	1	Fixing plate	
35	1	flush valve back nut	
36	1	WC inlet cone	
37	1	Flush pipe connecting nut	

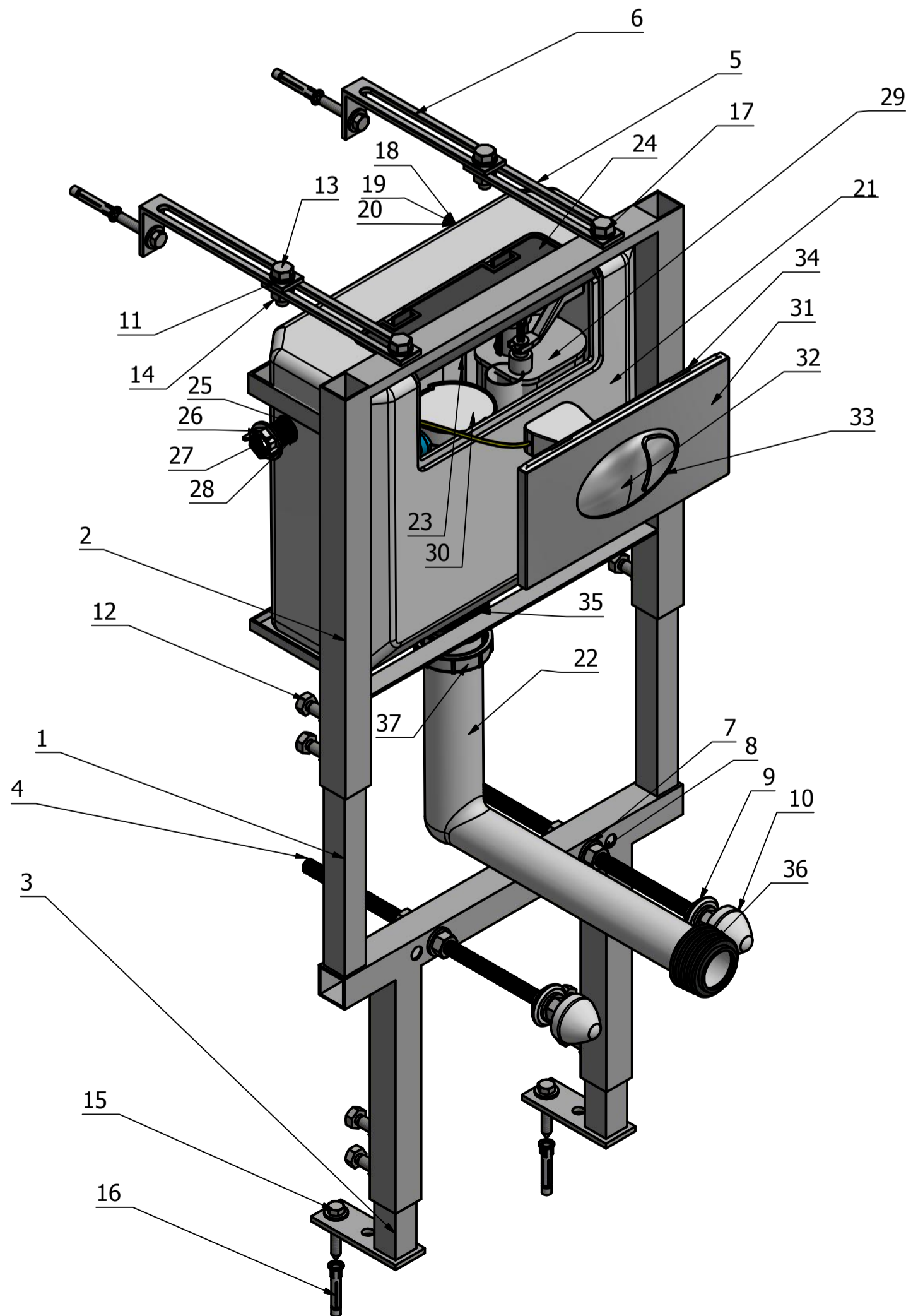

# WC FRAME INSTRUCTION

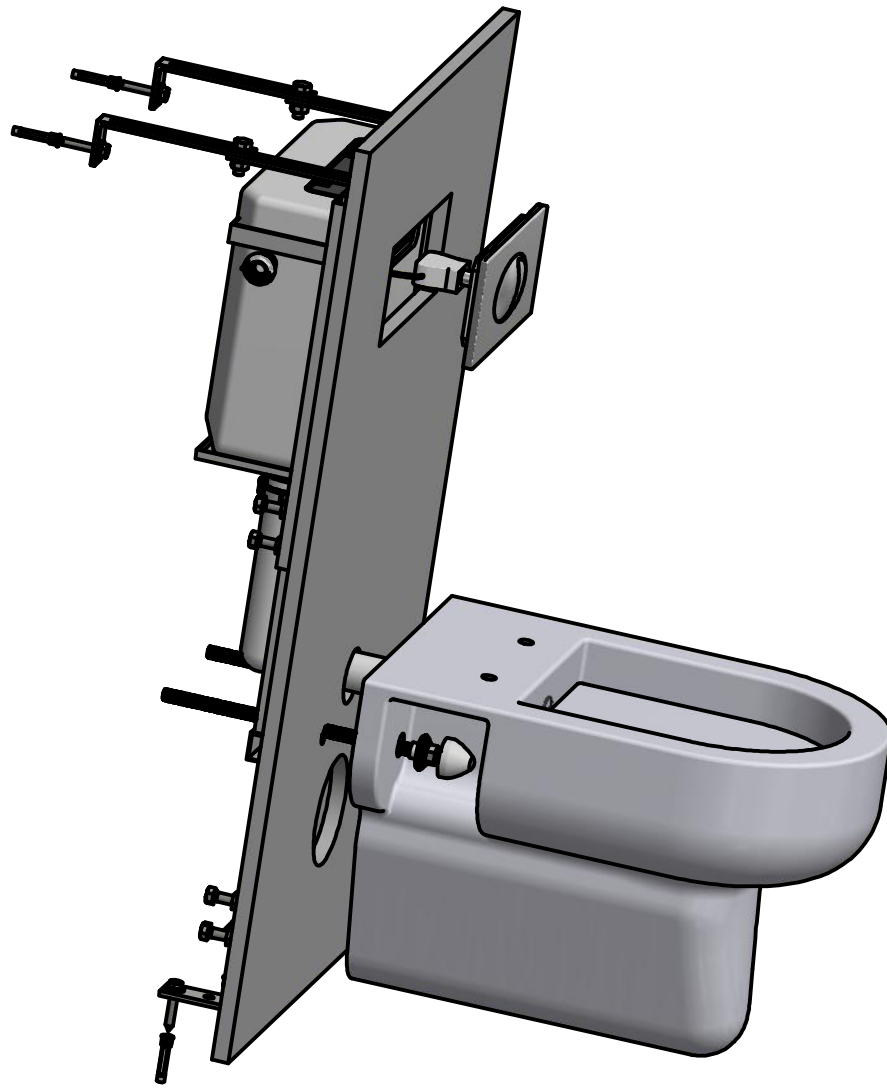

INWALL INSTALLATION

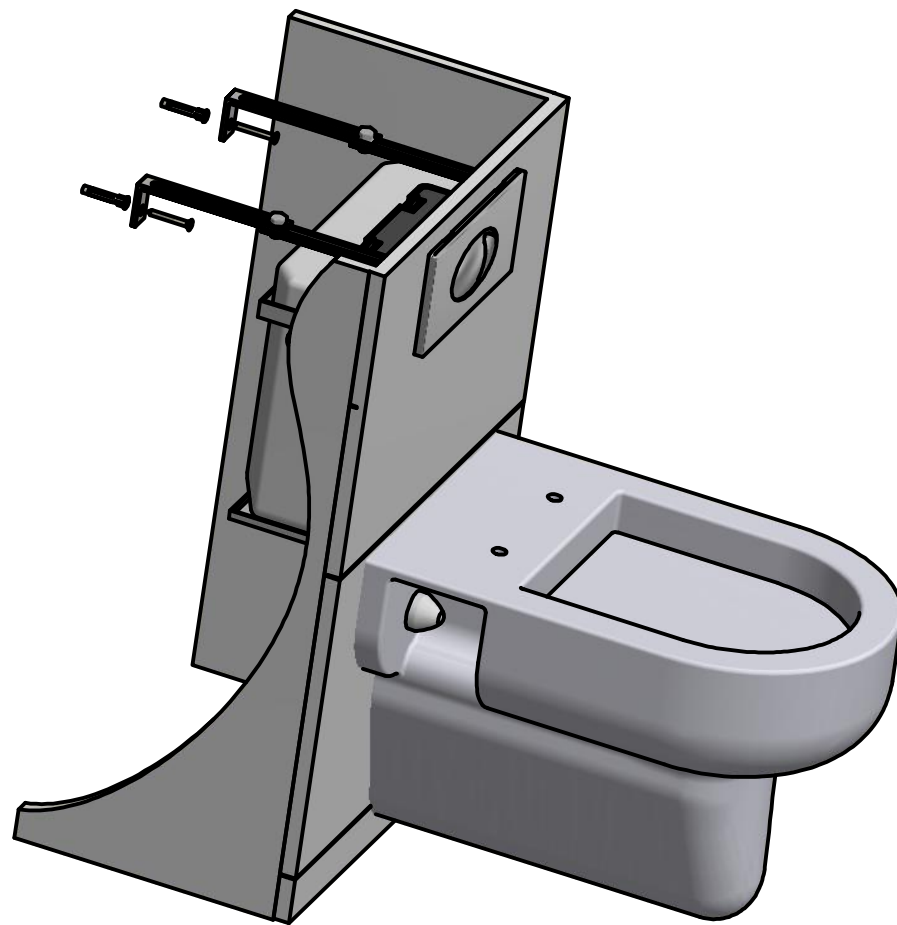

IN-FURNITURE INSTALLATION

# PUSH BUTTON PLATE FIXING INSTRUCTION

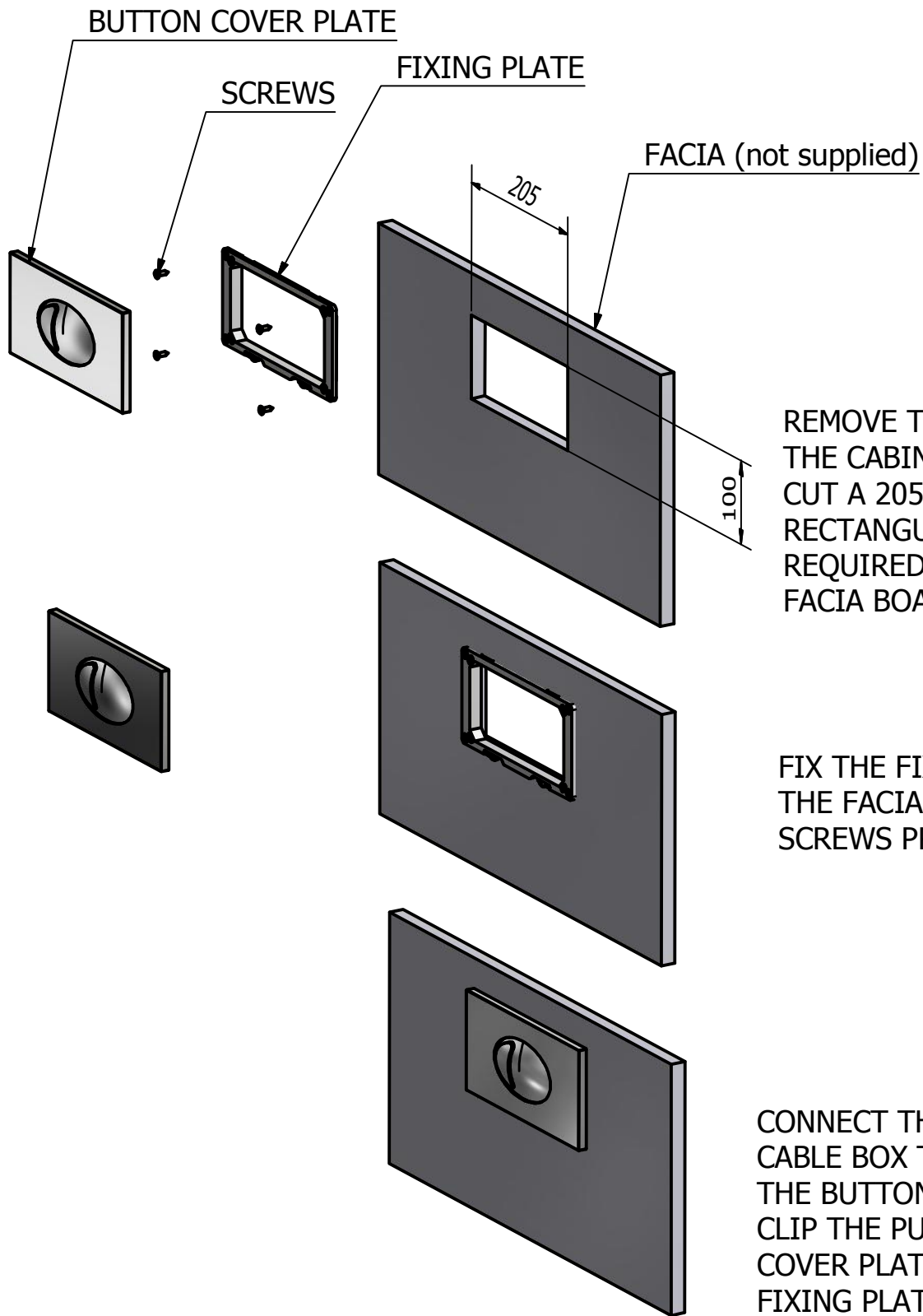

REMOVE THE FACIA FROM THE CABINET.  
CUT A 205mm x 100mm RECTANGULAR HOLE IN THE REQUIRED POSITION OF THE FACIA BOARD

FIX THE FIXING PLATE TO THE FACIA USING THE SCREWS PROVIDED

CONNECT THE FLUSH VALVE CABLE BOX TO THE BACK OF THE BUTTON PLATE. THEN CLIP THE PUSH BUTTON COVER PLATE ONTO THE FIXING PLATE. REPLACE THE FACIA ONTO THE CABINET.