



USE & CARE INSTRUCTIONS

Circulation Tower Fan Model XPSS

A division of GDC Group LTD
Website: www.gdcgroup.co.uk

This product complies with EU Directives 2014/35/EU and 2014/30/EU.

© GDC Group Ltd.

All rights reserved. Material contained in this publication may not be reproduced in whole or in part without prior permission in writing of GDC Group Ltd

GDC Group Ltd reserves the right to modify the content of these instructions, at any time and without prior notice.

171025 Issue 1



**PLEASE READ THESE INSTRUCTIONS CAREFULLY
AND SAVE FOR FUTURE REFERENCE**



IMPORTANT WARNINGS

Failure to comply with the warnings listed below may result in electric shock or serious injury.

This product should be used only in accordance with the specifications outlined in this manual. Usage other than as specified in these instructions may result in serious injury, risk of fire or electric shock.

- **IMPORTANT** - To reduce the risk of electric shock, the plug is intended to fit in a standard polarized 13Amp socket outlet, only plug the appliance directly into a proper electrical outlet.
- To protect against electrical hazards, **DO NOT** immerse in water or other liquids. Do not use near water.
- Children cannot recognize the hazards associated with the usage of electrical appliances. For this reason, always supervise children when they are near the unit.
- This appliance can only be used by children aged from 8 and above and persons with reduced physical, sensory or mental capabilities or lack of experience and knowledge if they have been given supervision or instruction concerning use of the appliance in a safe way and understand the hazards involved. Children shall not play with the appliance. Cleaning and user maintenance shall not be made by children without supervision.
- Children aged from 3 years and less than 8 years shall only switch on/off the appliance provided that it has been placed or installed in its intended normal operating position and they have been given supervision or instruction concerning use of the appliance in a safe way and understand the hazards involved. Children aged from 3 years and less than 8 years shall not plug in, regulate and clean the appliance or perform user maintenance.
- Always unplug the air fan before moving it, cleaning or whenever the fan is not in use. Be sure to pull by the plug and not the cord when un-plugging the appliance.
- **NEVER** drop or insert any object into any openings.
- **DO NOT** operate appliance connected to an extension cable
- Keep the cord out of heavy traffic areas. To avoid fire hazard, **NEVER** put the cord near heat registers, radiator, stoves or heaters.
- **DO NOT** cover cord with carpeting, throw rugs, runners, or similar coverings.
- **DO NOT** route cord under furniture or appliances. Take care to position the cord away from traffic areas and where it will not be tripped over.

- **DO NOT** route cord under furniture or appliances. Arrange cord away from traffic area and where it will not be tripped over.
- If the supply cord is damaged it must be replaced by the manufacturer, its service agent or similarly qualified persons in order to avoid hazard.
- **DO NOT** operate any appliance with a damaged cord or plug, if motor fan fails to rotate, after the appliance malfunctions, or if it has been dropped or damaged in any manner. Send to Customer Service for assistance.
- Use appliance only for intended household use as described in this manual. Any other use not recommended by the manufacturer may cause fire, electric shock or injury to persons.
- **DO NOT** use outdoors.
- **DO NOT** place anything on top of unit.
- **NEVER** block the air openings, grills/outlets or place on a soft surface such as a bed or sofa, as this could cause the unit to tip over, blocking the air intake or outtake opening.
- **DO NOT** attempt to repair or adjust any electrical or mechanical functions on this unit. Doing so will void your warranty. The inside of the unit contains no user serviceable parts. All servicing should be performed by qualified personnel only.
- **WARNING:** To reduce the risk of fire or electric shock, do not use this fan with any solid-state speed control device.
- **WARNING:** To avoid danger of suffocation please remove all packaging materials particularly plastic and EPS and keep these away from vulnerable people, children and babies.
- **WARNING:** To avoid the risk of accidental strangulation from the supply cord all children and vulnerable people must be supervised when in the vicinity of the product whether it is working or not.
- **WARNING:** Prolonged exposure to the direct air flow from any cooling fan can cause illness or health issues to vulnerable people and children in particular.

2、PRODUCT FEATURES

- 1、 Touch control buttons.
- 2、 Wind modes: normal, nature, sleeping, ECO.
- 3、 AC motor, 3 fan speeds: high, medium, low.
- 4、 Automatically 80°horizontal oscillation for the whole unit, the upper air outlet can be manually turned and adjusted to give up to 360°horizontal air flow.

- 5. Runback Timer: 1.2.4 and 8H selectable with digital temperature display.
- 6. LED display: ON/OFF, wind speed, wind modes, oscillation.
- 7. Remote control. Simple and easy to use remote control with on board storage..

3. PART DIAGRAMS

Product Structure

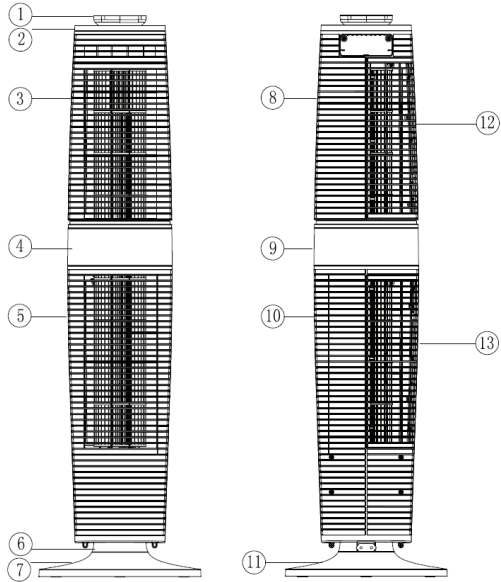

- | | | |
|----------------------------|-----------------------|--------------------------|
| 1、 Handle | 2、 Top Cover | 3、 Upper front housing |
| 4、 Former decorative panel | 5、 Down front housing | 6、 Oscillation base |
| 7、 Front base | 8、 Upper back housing | 9、 Back decorative panel |
| 10、 Down back housing | 11、 Rear base | 12、 Upper filter cover |
| 13、 Down filter cover | | |

- Remote control



- Control panel



- Display panel

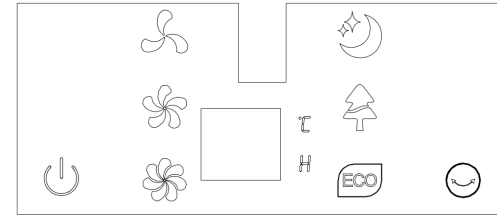

4. INSTALLATION & OPERATING INSTRUCTION

- ASSEMBLY INSTRUCTIONS:

1. Take out the fan and make sure all accessories are included.
2. Please assemble the fan as per below instructions:
 - ① Lock rear base and front base together as indicated in PICTURE 1 below.
 - ② Put the main body into the assembled base along the locating pole as shown in PICTURE 2 below.

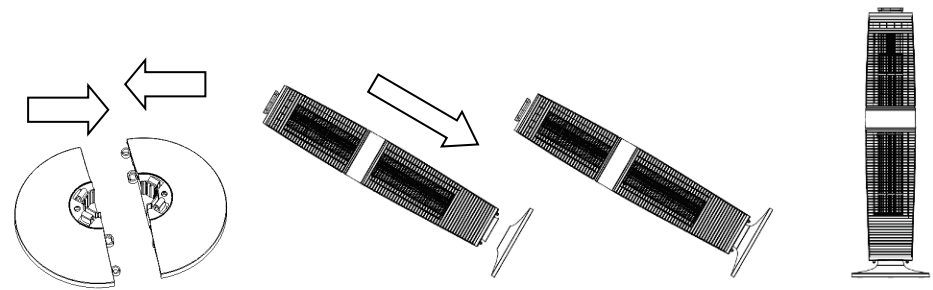

PICTURE 1

PICTURE 2

- ③ After assembling, place the product in a suitable place on a flat firm surface, plug in and operate according to the following Operating Instructions.

● OPERATION INSTRUCTION:

Note: When the product is plugged in a double 'BEEP' sound will confirm that the product is correctly connected to the mains supply and the product is in STANDBY MODE.

Note: The product will not start to operate until you press the "ON/OFF"  button

CONTROL BUTTONS

1) ON/OFF BUTTON

To start the product from STANDBY MODE you must press the "ON/OFF" button. You will hear a single 'BEEP' sound when you have successfully pressed the button, the first time you start the product from Standby it will start to operate with the fan running at "LOW" speed, in Normal Mode, in non-oscillation mode and with the appropriate LED light symbols light up on the display.

The fan will work in the same status with that before it turned off without shut off, except Timer and Mode function. You can change the mode of operation by using the other control buttons as described below.

To turn off the product and return to Standby mode from any mode of operation just press the ON/OFF button, you will hear a long 'Beep' sound to confirm switch operation.

NOTE: As long as you leave the product in Standby Mode and do not disconnect at the mains the product will remember the fan speed and the oscillation mode that you had last set before you switched it off, so when you switch it on again from Standby mode it will start in the fan speed mode and oscillation mode that it was last used in.

2) FAN SPEED SELECTION BUTTON

Default Blower Mode is Normal Mode, you can set your product to work at 3 different fan speeds in Normal mode - Low, Medium & High. Pressing the  button allows you to change from Low to Medium, Medium to High and High back to Low fan speed, the relevant LED light will illuminate to indicate which fan speed is selected/operating.

3) RUNBACK TIMER MODE BUTTON

By pressing this button, the fan can be set to operate continuously in your selected mode of operation for different time intervals, you can select 1 hour, 2 hours, 4

hours or 8 hours, the selected period will be indicated by its LED light which will remain on for the selected period, when the selected operating time has run out the product will switch off automatically and go into standby mode until the user needs it again.

4) BLOWER MODE SELECTION BUTTON

The default operating mode when you power on is 'Normal' mode, there is no separate 'Normal' blower mode operating LED. Pressing  when operating will change the blower operation modes from 'Normal' to 'Sleep' mode, 'Sleep' to 'Natural' mode, 'Natural' to 'ECO' mode and 'ECO' back to Normal mode, the relevant LED light will indicate when Sleep, Natural and ECO modes are selected, (the selected fan speed LED will only light in Normal Blower mode).

A. Normal Blower mode:

See 'FAN SPEED SELECTION BUTTON' section for details of operation in this default mode.

B. Sleep Blower Mode: In this mode the fan speed will continuously vary speed to prevent users from getting sick when asleep. You can select 3 different running patterns in this mode by using the Speed Selection button, the patterns of operation in each speed mode are as follows;

- High speed: Operates for 30 minutes in 'High speed in Natural Blower mode' → 30 minutes at 'Medium speed in Natural Blower mode' → then continues in 'Low speed in Natural Blower mode';
- Medium speed: Operates for 30 minutes in 'Medium speed in Natural Blower mode' → then continues to run in 'Low speed in Natural Blower mode'.
- Low speed: Operates continuously in 'Low speed in Natural Blower mode'.

C. Natural Blower mode: In this mode the fan will automatically change speed to simulate natural variances in the speed of the wind that you experience outside in natural windy conditions. In this mode you can use the speed selection button to change between Low/'Light breeze', Middle/'Strong Breeze' and High/'Strong Wind' modes.

The specific program waveform graph for each Natural Blower Mode is shown below for each of the 3 speed selection modes (HI, MED, LOW)

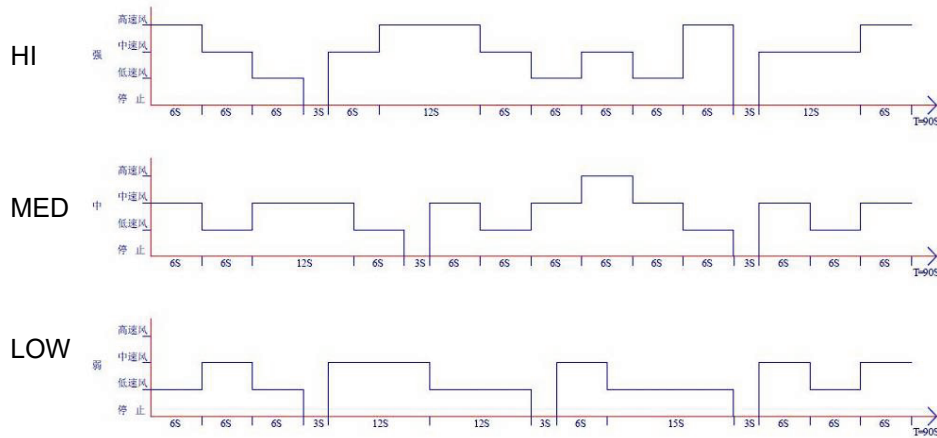

D. ECO Blower Mode:

When this mode is selected your product will automatically switch to operate in different fan speed modes depending on the ambient temperature around the product as follows;

- when the ambient temperature is less than 25°C it will operate at Low speed;
- when the ambient temperature is between 25°C and 29°C it will operate at Med speed.
- when the ambient temperature is more than 29°C it will operate at Hi speed:

5) REMOTE CONTROL OPERATION

To activate the remote control release and slide out the battery holder from the bottom back of the remote control handset (as indicated below), install your 3V CR2032 button battery cell into its location ensuring the positive and negative pole are as indicated on the label on the back of the remote and reinstall the battery holder completely. Align to infrared receiver module when using remote controller.

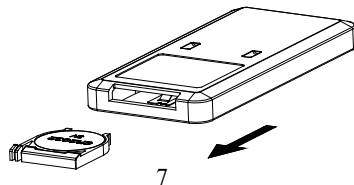

Note - Remote Control will only operate the product if it is in direct line of site and within a distance of 6 meters from the product. If it fails to do so under these conditions after the product has been in use for some time please check the battery is not depleted before taking any other action.

6) AUTO DIMMING FUNCTION

The LED lights on the control display will dim by 30% automatically after a 1 minute delay if the controls are not operated/used to save energy.

7) LED DISPLAY DETAILS:

1. Double 8 digital display 15*14 mm, 0.36inch Common Cathode.
2. Apart from the digital display there are ten LED light function symbols as indicated below,

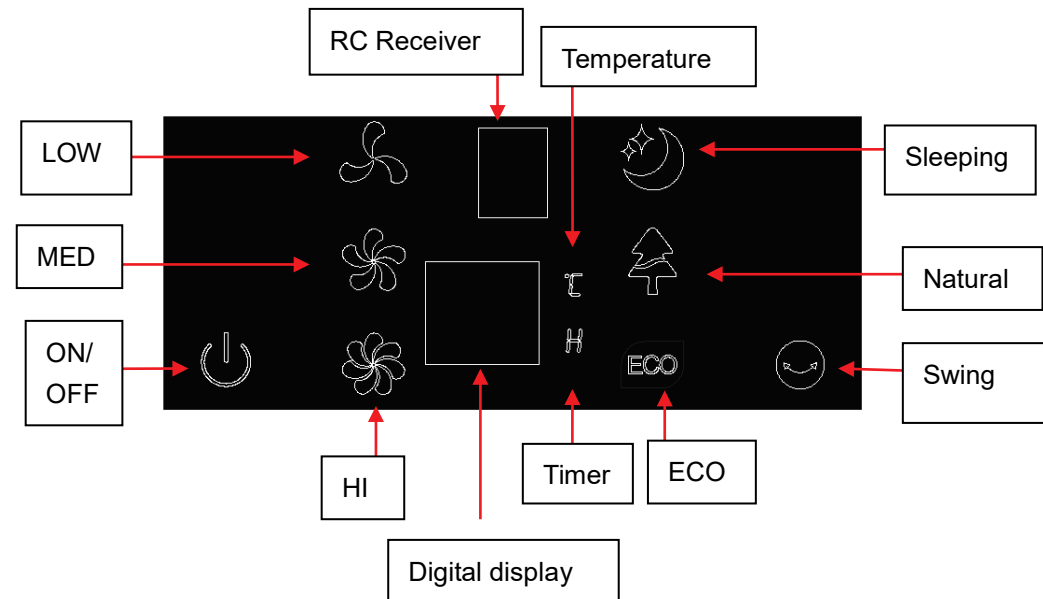

5. CLEANING & MAINTENANCE

Note: If there is too much dust or dirt on the air outlet / inlet grill and the blower wheel of the product then the performance will be affected, if being used regularly we recommend that you clean the product at least once a month.

IMPORTANT

- Always remember to unplug the product before cleaning or maintenance because of the risk of electric shock.
 - Do not allow water, steam or any other fluid to enter the appliance.
 - Do not use abrasive cleaning products as they will damage the product surfaces. You can use a vacuum cleaner to remove loose dust and particulate matter. Clean surfaces using a soft damp cloth or a soft banister brush.
- Do not use any Chemical cleaning agents, corrosive detergents or solvent cleaners.
- Unplug and pack the product away carefully to prevent dust from entering the product when not in use for a long time.
- Store in a dry and well ventilated space when not in use to prevent moisture ingress which might cause the product to malfunction or fail.

6. SPECIFICATION

Model	XPSS
Rated voltage	220-240V~
Rated frequency	50Hz
Rated power	45W
Noise	≤55dB(The average sound pressure level)
Product size(L*W*H)	968x Φ 280mm
Executive standard	EN 60335-1; EN 60335-2-80



RECYCLING

The crossed bin symbol on the appliance indicates that the product, at the end of its life, must be disposed of separately from domestic waste, either by taking it to a separate waste disposal site for electric and electronic appliances or by returning it to your dealer when you buy another similar appliance. The user is responsible for taking the appliance to a special waste disposal site at the end of its life. If the disused appliance is collected correctly as separate waste, it can be recycled, treated and disposed of ecologically; this avoids a negative impact on both the environment and health, and contributes towards the recycling of the product's materials. For further information regarding the waste disposal services available, contact your local waste disposal agency or manufacturer.

After Sales Service and Guarantee terms and conditions

Your product is guaranteed for 1 year from the date of purchase. If you experience a problem with our Xpelair product, which is found to be defective due to faulty materials or workmanship within the Guarantee Period, this Xpelair Guarantee will cover repair or - at the discretion of Xpelair- replacement with a functionally equivalent Xpelair product.

Within the guarantee period we undertake to repair or exchange this product free of charge providing:

- a) Proof of purchase such as a sales receipt should be provided, showing that the appliance was bought within the 12-months prior to registering the defect/fault.
- b) The appliance was correctly installed and operated in accordance with the manufacturer's instructions and used solely for domestic purposes.
- c) The defect/fault was not as a result of accident, misuse, unauthorised modification or inexperienced repair

Your rights under this guarantee are additional to your statutory rights, which in turn are not affected by this guarantee.

If after following these steps your product still does not operate you should return it to your point of purchase. Please do not return a faulty product to us as this may result in loss or damage and delay in providing you with a satisfactory service.

Please retain your receipt as proof of purchase.

What is not covered by an Xpelair Guarantee?

The Xpelair Guarantee does not cover any of the following:

Any fault or damage to your Xpelair product due to faulty materials or workmanship occurring outside the one year Guarantee Period.

Normal wear and tear including parts that might wear out over time or consumables, such as filters.

Any fault or damage occurring to any pre-owned Xpelair product or to any other equipment or property.

Accidental damage to your Xpelair product or damage to your Xpelair product from external sources (for example, transit, weather, electrical outages or power surges).

Fault or damage to your Xpelair product which is:

- not due to faulty materials or workmanship or which is due to circumstances outside Xpelair's control.
- caused by use of your Xpelair product for anything other than normal domestic household purposes in the country where it was purchased.
- caused by any misuse, abuse or negligent use of the Xpelair product, including but not limited to any failure to use it in accordance with the Operating Instructions supplied with the product.
- caused by any failure to assemble, install clean and maintain your Xpelair product in accordance with the Operating Instructions supplied with the product unless this was carried out by Xpelair or its authorised dealers.
- caused by repairs or alterations to your Xpelair product not carried out by Xpelair service personnel or its authorised dealer(s).
- caused by use of any consumables or spare parts for your Xpelair product which are not Xpelair specified. A full range of Xpelair specified consumables, parts and accessories is available at www.xpelair.co.uk

Terms and Conditions

The Xpelair Guarantee is valid for one calendar year from the date of purchase of your Xpelair product from a recognised retailer in the country of purchase and use, or the date of delivery of the product if later, always provided the original receipt has been retained and is produced as proof of purchase.

You must provide to Xpelair or its authorised agents on request the original receipt as proof of purchase and - if required by Xpelair - proof of delivery. If you are unable to provide this documentation, you will be required to pay for any repair work required.

Any repair work under the Xpelair Guarantee will be carried out by Xpelair or its authorised dealer(s) and any parts that are replaced will become the property of Xpelair. Any repairs performed under the Xpelair Guarantee will not extend the Guarantee Period.

Any replacement of your Xpelair product by Xpelair during the Guarantee Period will start the one-year Guarantee Period afresh from the date of delivery of the replacement Xpelair product to you.

The Xpelair Guarantee does not entitle you to recovery of any indirect or consequential loss or damage including but not limited to loss or damage to any other property.

The Xpelair Guarantee is in addition to your statutory rights as a consumer and your statutory rights are not affected by this Xpelair Guarantee.

Contact Xpelair

If you have any questions about what the Xpelair Guarantee covers and does not cover or how to claim under the Xpelair Guarantee, please contact us:

GDC Group LTD, Millbrook House, Grange Drive, Hedge End, Southampton SO30 2DF

Telephone: 0844 879 3588

Email: customer.services@gdcgroup.co.uk

Visit: www.gdcgroup.co.uk