



Power Station

INSTALLATION INSTRUCTION

Product:

➢ DCSxBS-BAYL2U
 DCSxBS-1AYL2U
 HDCSxBS-BAYL2U
 HDCSxBS-1AYL2U

Specification

➢ 220-240V~50Hz
 Max. 13A

xBS = number of BS socket, can be 1BS, 2BS or 3BS
 BA = 1 x Bluetooth speaker, can be Blank or BA
 yL = number of LED Spot light, can be Blank, 1L or 2L
 2U = 2 Poles USB Charger, can be Blank or 2U
 1A = 1 x Audio speaker, can be Blank or 1A

Pack Contents:

Power station x 1

Fixing pack x 1

Instruction leaflet x 1

Additional accessories:

Tray x 1

PLEASE READ THESE BEFORE COMMENCING INSTALLATION AND RETAIN FOR FUTURE REFERENCE.

- If the external flexible cable or cord of this socket is damage, it shall be exclusively replaced by the manufacturer or his service agent or similar qualified person in order to avoid a hazard.
- This is a Class I product. Must earth.
- If in doubt regarding these installations, consult a qualified electrician.
- CAUTION: Risk of Electric Shock - For indoor use only

USB CHARGER SPECIFICATION

- Output Voltage : 5V DC
- Output Current : Max. 2400mA
- Individual switch for power on / off
- LED indicator function when power on
- CAUTION : It is not applicable for the digital products with internal protection or the ones requiring driving programme



MAINTENANCE

- Ensure that to disconnect the power prior to cleaning.
- To keep the finish of this product, wipe over with soft cloth periodically.
- Clean the socket with a damp cloth and mild detergent, dry immediately.
- Do not use harsh chemical solvents, it may dis-color or damage the finish.
- Never force to life up or push down – always check that there are no obstructions that could interfere during retraction.



According to Waste of Electrical and Electronic Equipment (WEEE) directive, WEEE should be separately collected and treated. If at any time in future you need to dispose of this product please do not dispose of this product with household waste. Please send this product to WEEE collecting points where available. Do not dispose this product as unsorted municipal waste. Collection of such waste separately for



Screwfix Direct Limited, BA22 8RT, UK

MINIATURE AUDIO SPEAKER SPECIFICATION

- Output Power : Max. 2W
- Sensitivity : L/R 380MV
- SNR : >80db
- Frequency Range : 280Hz-16KHz
- Audio Connector : Standard 3.5mm headphone connector
- Suitable for all music player, include MP3, MP4, Smartphones, iPhone 5, iPad, Android Phones.



LED Spot Light Specification

- Output Power : Max.2.1W
- Built-in electronic LED driver operated at 220-240V~
- Beam angle adjustable - Please adjust the spot light to the suitable angle.
- The light source contained in this luminaire shall only be replaced by the manufacturer or his service agent or a similar qualified person.
- Caution: risk of electric shock



MINIATURE AUDIO SPEAKER SPECIFICATION

- Output Power : Max. 3W
- Sensitivity : L/R 380MV
- SNR : >80db
- Speaker Frequency Range : 280Hz-16KHz
- Audio Connector : Standard 3.5mm headphone connector
 - Suitable for all music player, include MP3, MP4, Smartphones, iPhone 5, iPad, Android Phones.
- How to Connect to Bluetooth
 - Switch on the power, you will see the bluetooth signal indicator start flashing.
 - Open your mobile device and turn on the bluetooth function, connect the device named "Kengo" or "Kengo0001" (note: if the name showing Kengo0001 it means the number digit would be different.)
 - Then press connect to the device, if the connection ok, then you will hear a "bip" sound and the bluetooth signal indicator flashing a different frequency.
 - Onced connected, you can start play the music now.

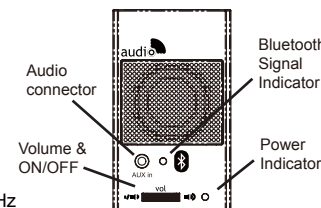

INSTALLATION

The installation may only be carried out by an electrical specialist in accordance with international and national standards.

1. Locate the product and measure the suitable location before installation.

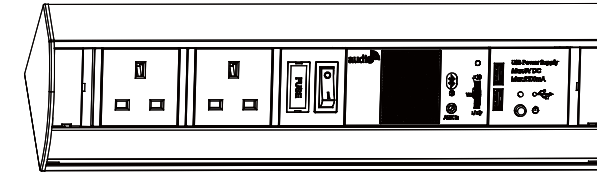

2. If the input cable can not pass through the back side, you can use a plier to remove the end cap corner to let cable pass through.

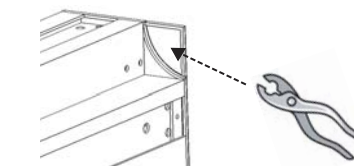
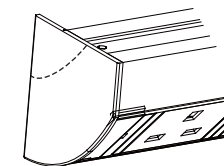

3. Remove the screw covers by a small slotted screw driver on both side carefully.

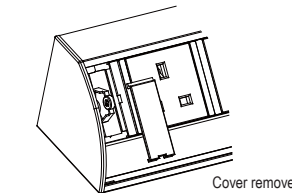
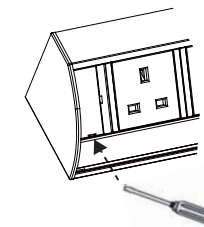

4. Secured the product by provided fixing screws on both sides as shown. Fixing hole must clear any obstruction within the mounting surface, after installation completed, fit the screw covers on both side.

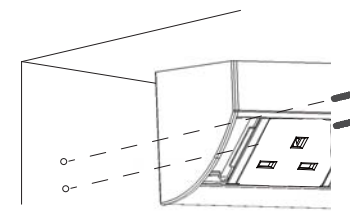

Wall fixing direction.

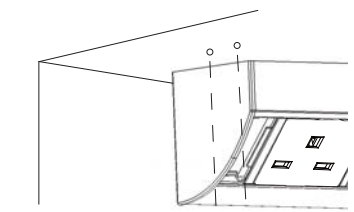

Under cabinet fixing direction.

5. Slide the tray brackets into the Power Station according to following steps.

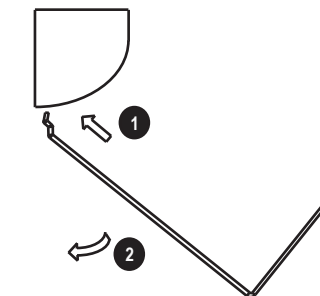

6. Put the shelf onto both brackets, then ready to use.

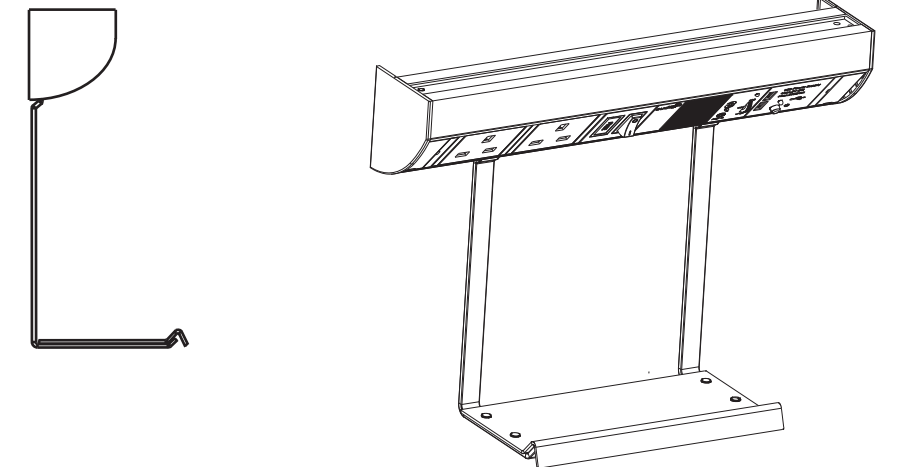



EU Declaration of Conformity

| | | |
|---|----------------|---------------|
| Product | | |
| Product name : Power Station / Cord Extension Set Product model : HDCS2BS-BA2L2U | | |
| Name and address of the manufacturer or his authorised representative: | | |
| Screwfix Direct Limited, BA22 8RT, UK | | |
| This declaration of conformity is issued under the sole responsibility of the manufacturer. | | |
| Object of the declaration: | | |
| Product | Model | EAN |
| Power Station / Cord Extension Set | HDCS2BS-BA2L2U | 4891879277725 |
| The object of the declaration described above is in conformity with the relevant Union harmonisation legislation: | | |
| 2014/53/EU Radio Equipment Directive | | |
| References to the relevant harmonised standards used or references to the other technical specifications in relation to which conformity is declared: | | |
| BS 1363-2:2016+A1 EN 62368-1:2014+A11 EN 60598-2-4:1997, EN 60598-1:2015, EN 62471:2008, EN 62493:2015 EN 55032:2015, EN 55024:2010+A1, EN 55035:2017, EN 61000-3-2:2014, EN 61000-3-3:2013 EN 61000-6-3:2007+A1, EN 61000-6-1:2007 EN 60065:2014+A11 EN 301 489-1 V2.2.0:2017, EN 300328 V2.1.1:2016, EN 301 489-17 V3.2.0:2017 EN 62479:2010 | | |
| The notified body TÜV Rheinland (Guangdong) Ltd. performed an EU-type examination and issued the EU-type examination report No.: 50168342 001, 50143312 001, 50157220 001, 50158990 001, 50158991 001 | | |
| Additional information: Signed for and on behalf of: Screwfix Direct Limited, BA22 8RT, UK On: 23/08/2018 | | |

John Fretwell
Quality Assurance Manager