

VG134-4

4 Heavy duty aluminium roof bars - Interstar / Master '98-'10 / Movano pre '10

SUPPLIED COMPONENTS

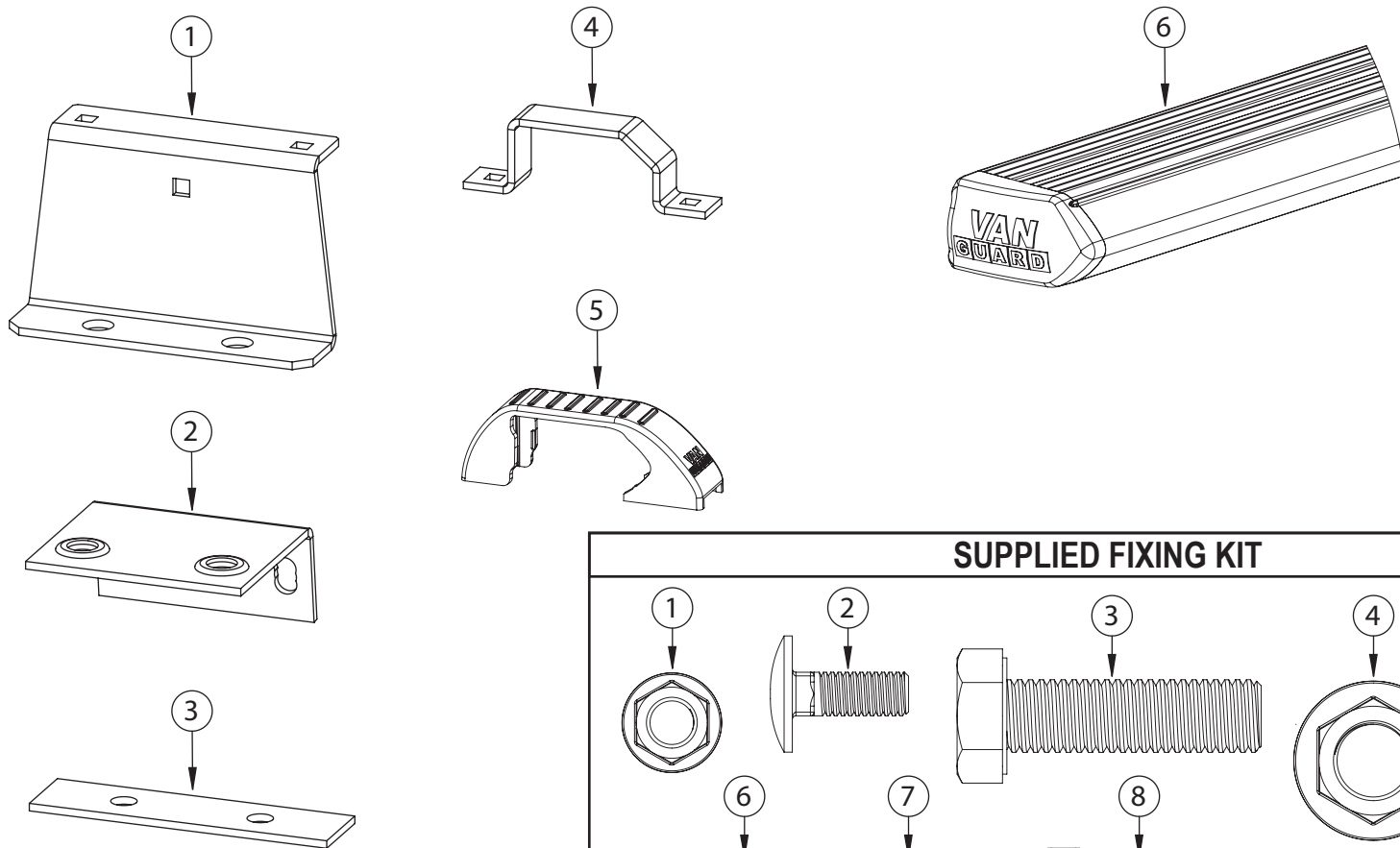

#	DESCRIPTION	QTY
1	ROOF BRACKET	8
2	INNER FIXING BRACKET	8
3	H120-1 RUBBER PAD	8
4	TOP HAT	8
5	TOP HAT COVER	8
6	ROOF BAR	4

SUPPLIED FIXING KIT

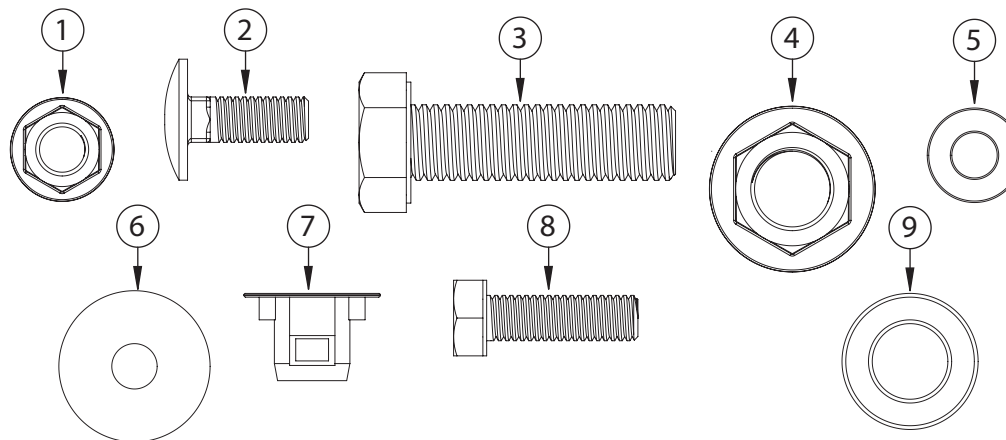

#	DESCRIPTION	QTY
1	M6 SERRATED FLANGE NUT	16
2	M6x16 COACH BOLT	16
3	M10x35 HEX BOLT	16
4	M10 SERRATED FLANGE NUT	16
5	M6 WASHER	16
6	RUBBER WASHER	16
7	M6 1/4 TURN NUT INSERT	16
8	M6x20 HEX BOLT	16
9	M10 WASHER	16

TOOLS REQUIRED: 10mm & 17mm SPANNER / RATCHET

This FITTING INSTRUCTION is the property of VAN GUARD ACCESSORIES LTD. and must not be used for manufacturing purposes, copied nor communicated in any way to third parties without written permission from VAN GUARD ACCESSORIES LTD.

IN8037_A - IW - 03/05/13

Van Guard Accessories Ltd
 Fair Oak Close, Exeter Airport Business Park,
 Exeter, Devon, EX5 2UL
www.van-guard.co.uk

1 Insert the M6 1/4 turn nut inserts as shown below inside the vehicle, below the fixing points you wish to use.

INSIDE VEHICLE

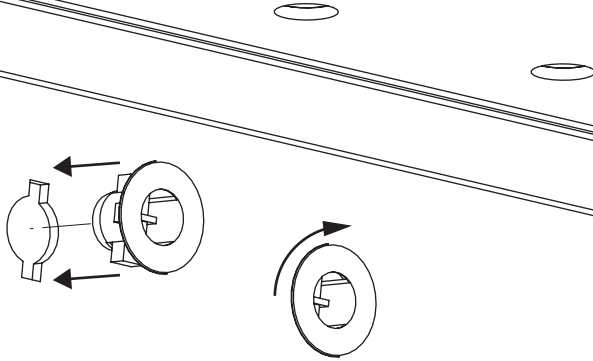

2 Secure the inner fixing brackets to the inside of the vehicle by bolting into the M6 1/4 turn nut inserts using M6x20 hex bolts and M6 washers.

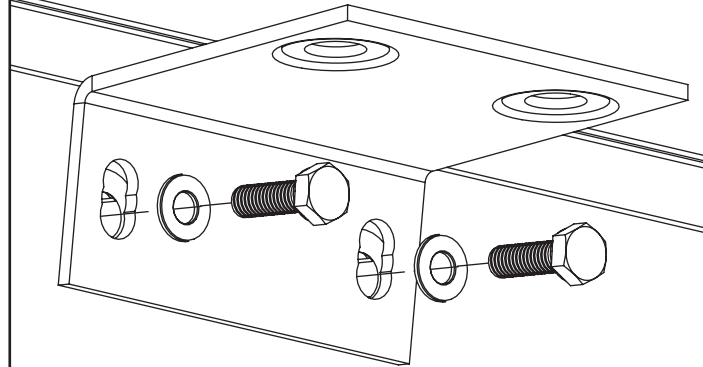

3 Stick rubber pads to the underside of all roof brackets.

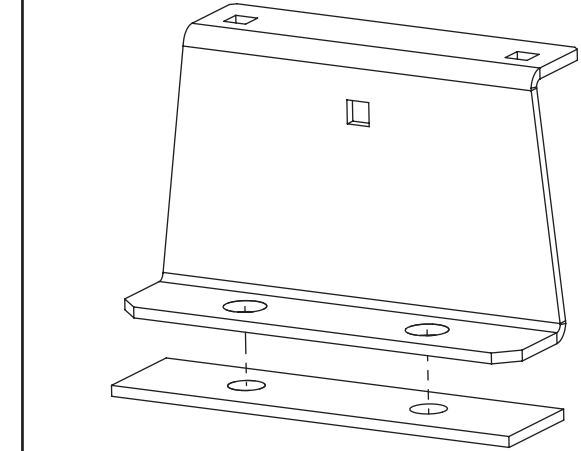

4 Remove roof plugs to reveal the vehicles fixing points. Secure roof brackets by bolting through the fixing points using M10x35 hex bolts, M10 washers & rubber washers, secure under the roof using M10 serrated nuts. Ensure that the top hat flange is facing inwards.

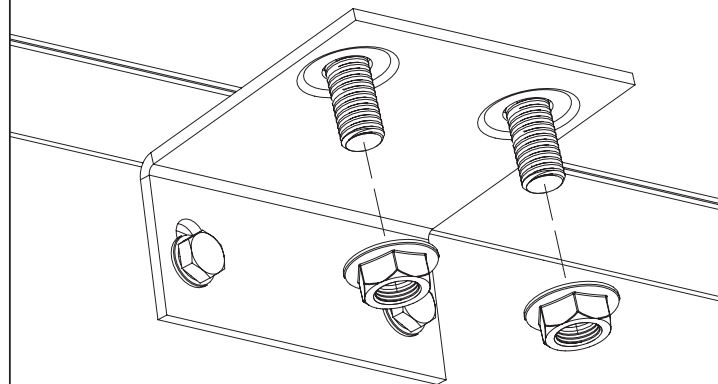
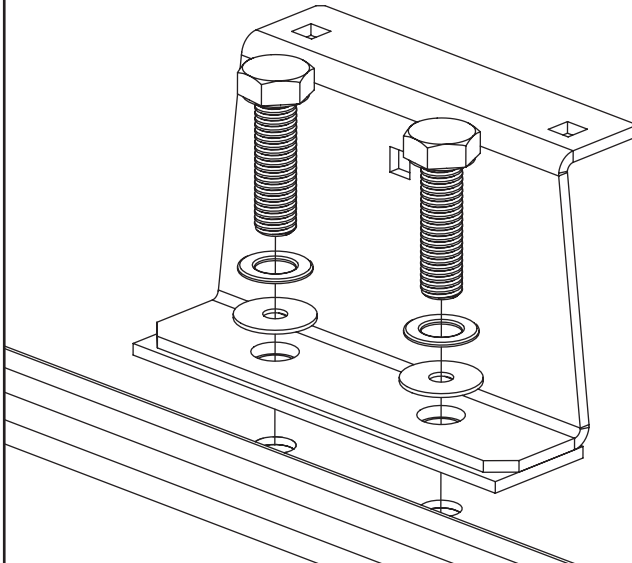

5 Place roof bars onto the roof brackets with the t-slot facing upwards, secure using top hat brackets, M6x16 coach bolts & M6 serrated nuts.

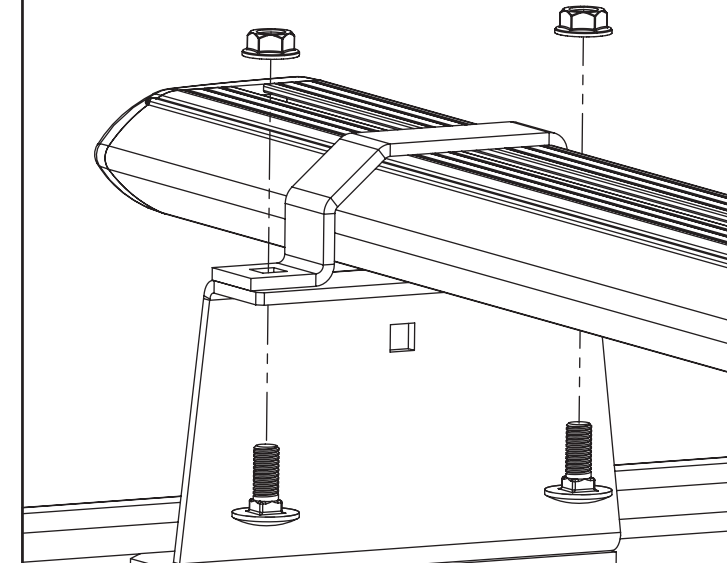

6

Flex the top hat covers over the top hat brackets into position as shown below. Ensure that the covers click into the front and rear of the top hat brackets.

1.

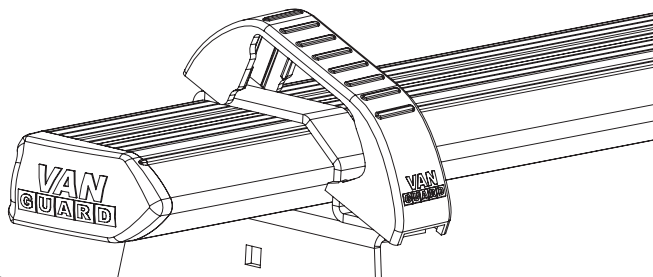

2.

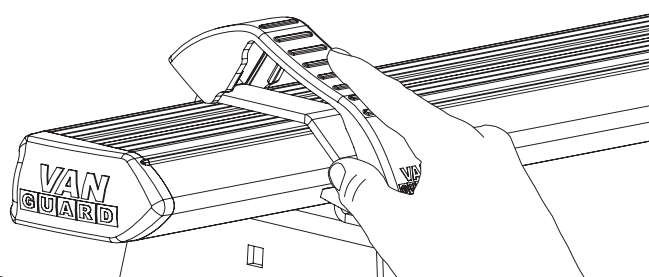

3.

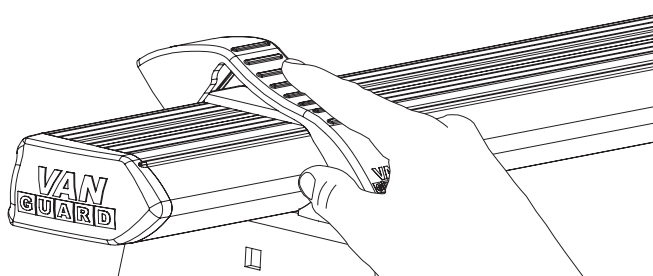

4.

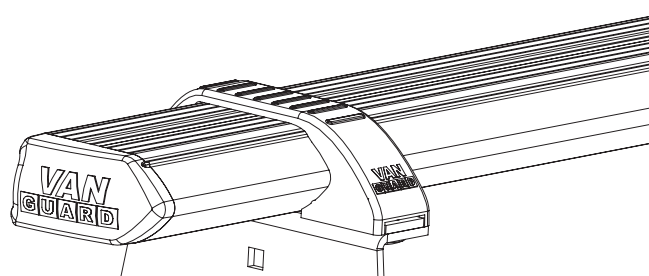
**7**

Once in position tighten all M6 fixings to 8Nm and all M8 fixings to 12Nm. Periodically check all fixings.



**TIGHTEN
TO
8/12Nm**

NOTES:

Maximum load is 55kg per bar. Please check that the vehicle manufacturers load bearing capacity for the roof is not exceeded. (Refer to the vehicle handbook)

Periodically check all fixings.

Retain these instructions for future reference.

VAN

GUARD