



HD Dome Security Camera

For use with Swann 7300 and 7400 Series HD NVRs

EN

INSTRUCTION MANUAL

Introduction

This guide has been designed to help you connect the cables and install your HD Dome camera at your desired location. To set up and configure the camera so you can view it on your Swann NVR-7300 or NVR-7400 please use the guides that came with your NVR or search for them at <http://support.swann.com/> and follow the steps for adding cameras using the on-screen menu.

Important note - All jurisdictions have specific laws and regulations relating to the use of cameras. Before using any camera for any purpose, it is the buyer's responsibility to be aware of all applicable laws and regulations that prohibit or limit the use of cameras.

Important safety instructions

- 1) Make sure the camera is fixed correctly and stable if fastened in place.
- 2) Do not operate if wires and terminals are exposed.
- 3) This camera can only be used in combination with Swann's NVR-7300 and NVR-7400 HD network video recorders.
- 4) The reset button is used to perform a factory reset. Disconnect the Ethernet cable, hold down the reset button then connect the Ethernet cable. Keep holding the reset button for 20 seconds then release. The NVR will take a short time to detect and display the camera after it has been reset.

Warning - Modifications not approved by the party responsible for compliance could void user's authority to operate the equipment.

Choosing a location for your Camera

Some things to consider when choosing a location -

- 1) What you want to monitor and where you'll get the best view of it.
- 2) How you're going to connect the camera to your monitoring system; remember that cables and connections should be kept out of the weather.
- 3) It's recommended to mount your camera at an elevated position to minimise harm.
- 4) Place your camera as close to the area of interest as practicable. The best position is from about 4m (13ft) above looking slightly down, keeping in mind the details you are looking for.
- 5) Although the sky looks nice when you look at the live view from your camera, it is an unlikely direction for an offender to approach, make sure your camera has minimal sky in it as the light in daylight can make the foreground of the image darker.
- 6) Think about the most likely way a potential offender may approach your home, use your cameras to give you the best coverage of these areas.
- 7) The camera's casing is resistant to water, different weather conditions and tampering. It would take an overwhelming event of this kind to damage the housing of the camera. However, the cable and connector are vulnerable and require protection.
- 8) Even though the camera is weather and water-resistant, the cable and connectors are not always as easy to protect. We recommend you cover the connectors and the end of the cable with some waterproof tape or similar for best results.
- 9) Avoid bending your cables at sharp angles.
- 10) Don't put your cable near live electrical wiring. AC electricity generates radio "noise" which can interfere with the signal from your camera.

Connecting your Camera

To connect your camera to the NVR, simply connect the supplied Ethernet cable to the LAN connection on the camera then plug the other end of the cable (1) into one of the IP camera inputs on the back of the NVR.

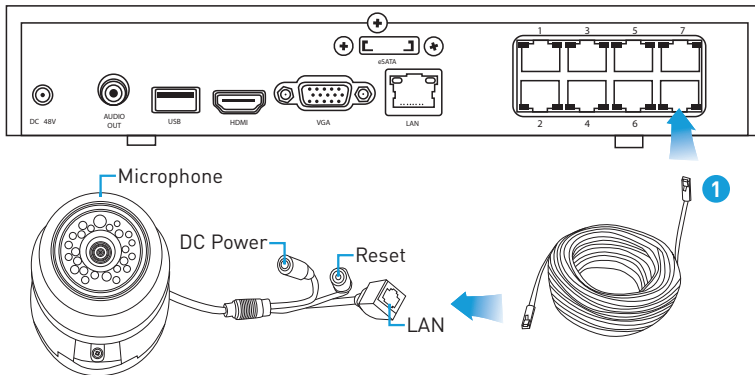

It doesn't really matter which input you use as they are quite versatile and will be configured in a later step. The Ethernet cable is the same at both ends so it doesn't matter which end plugs into the camera or NVR.

Note: The DC Power connector is provided as an alternative power option if required. The NVR will provide PoE power over the network cable when connected as described above and in this case the DC Power is not needed.

Mounting your Camera

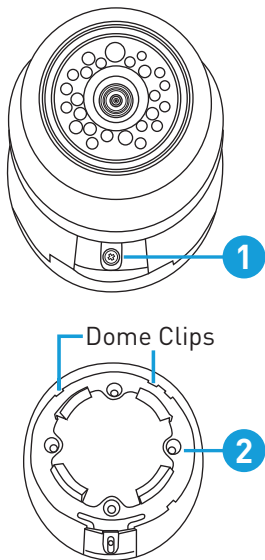

The camera can be mounted onto a flat vertical or horizontal surface and must be of sufficient strength to hold the camera. To mount the camera -

- Using a Phillips head screwdriver, remove the screw **(1)** from the mounting clip. Press down on the mounting clip and carefully remove the dome cover lifting from the front edge first.
- You're now free to remove the camera to gain access to the mounting bracket **(2)**. There are four mounting holes available.
- Position the camera in the location you want to mount to then mark the mounting holes on the surface to position the screws. Using the appropriate screws for the surface you are mounting to, screw the camera into place. Place the camera back onto the mounting bracket.
- To reinstall the dome cover, there are two dome clips located on the mounting base. Place the dome cover into the dome clips first then press down on the cover until it locks into place. Place the screw back onto the mounting clip and tighten.
- The dome cover can be rotated left or right and the camera can be aimed in almost any direction from wherever you choose to mount it.

Limited Warranty - Terms & Conditions

Swann Communications warrants this product against defects in workmanship and material for a period of one (1) year from its original purchase date. You must present your receipt as proof of purchase for warranty validation. Any unit which proves defective during the stated period will be repaired without charge for parts or labour or replaced at the sole discretion of Swann. The end user is responsible for all freight charges incurred to send the product to Swann's repair centres. The end user is responsible for all shipping costs incurred when shipping from and to any country other than the country of origin.

The warranty does not cover any incidental, accidental or consequential damages arising from the use of or the inability to use this product. Any costs associated with the fitting or removal of this product by a tradesman or other person or any

other costs associated with its use are the responsibility of the end user. This warranty applies to the original purchaser of the product only and is not transferable to any third party. Unauthorized end user or third party modifications to any component will render all warranties void. By law some countries do not allow limitations on certain exclusions in this warranty. Where applicable by local laws, regulations and legal rights will take precedence.

For Australia: Our goods come with guarantees which cannot be excluded under Australian Consumer Law. You are entitled to a replacement or refund for a major failure and for compensation for any other reasonably foreseeable loss or damage. You are also entitled to have the goods repaired or replaced if the goods fail to be of acceptable quality.

FCC Verification

This equipment has been tested and found to comply with the limits for Class B digital device, pursuant to part 15 of the FCC Rules. These limits are designed to provide reasonable protection against harmful interference in a residential installation. This equipment generates, uses and can radiate radio frequency energy and, if not installed and used in accordance with the instructions, may cause harmful interference to radio or television reception, which can be determined by turning the equipment off and on, the user is encouraged to try to correct the interference by one or more of the following measures:

- Reorient or relocate the receiving antenna
- Increase the separation between the equipment and the receiver
- Connect the equipment into an outlet on a circuit different from that to which the receiver is connected
- Consult the dealer or an experienced radio/TV technician for help

These devices comply with part 15 of the FCC Rules. Operation is subject to the following two conditions:

(1) These devices may not cause harmful interference.

(2) These devices must accept any interference received, including interference that may cause undesired operation.

Helpdesk/Technical Support

Technical Support E-mail: tech@swann.com

Telephone Helpdesk

USA Toll Free 1-800-627-2799

USA Parts & Warranty 1-800-627-2799

(M-F, 9am-5pm US PT)

AUSTRALIA 1800 788 210

NEW ZEALAND Toll Free 0800 479 266

UK 0808 168 9031



PLATINUM DIGITAL HD

4MP



Super HD Security Camera

4 Megapixel Dome Cameras for HD NVRs

4MP

SUPER HIGH DEFINITION



AUDIO MONITORING

PoE

POWER OVER ETHERNET



NIGHT VISION



WEATHER PROOF

DIY

EASY INSTALLATION

See every detail in rich, super HD

- State-of-the-art security camera with outstanding 4 Megapixel Super HD video image clarity from 75% more pixels than 1080p & enhanced digital zoom providing close-up detail that has to be seen to be believed
- Camera features a built-in microphone so you can see & hear what's happening[^]
- See everything during the day & night with wide 80° viewing angle & the latest infrared cut filter for amazing night vision to 100ft/30m
- Built to suit any conditions with weather resistant rating of IP66 for indoor & outdoor use
- This camera can only be used in combination with Swann's Super HD Network Video Recorders including NVR4-7400™, NVR8-7400™ & NVR16-7400™ for cutting-edge IP surveillance
- Professional surveillance camera gives you the peace of mind from being able to see the detail you need including license plates, faces, clothing colors & more, all in stunning 4 Megapixels

[^]Requires purchase of Swann NVR

SWNHD-819CAM

For more information on this product visit www.swann.com

Super HD Security Camera

4 Megapixel Dome Cameras for HD NVRs

What's in the box?

All installation accessories included

- NHD-819™ Dome Camera
- Ethernet Cable 60ft / 18m
- Mounting Screws & Plugs
- Operating Instructions
- Theft Deterrent Stickers



Specifications

NHD-819™ CAMERA

Video

Video Quality	Up to 4MP
Backlight Compensation	Yes
Wide Dynamic Range	Yes
Viewing Angle	80°

Audio

Microphone	Yes
Audio Range	Up to 16ft/5m

Night Vision

Night Vision Distance	Up to 100ft / 30m
IR cut Filter	Yes

General

Indoor / Outdoor	Indoor / Outdoor, IP66 rated
Operating Power	DC 12V - PoE
Operating Temperature	-4°F ~ 122°F / -20°C ~ 50°C
Body Construction	Aluminum
Dimensions - Camera	4.7" x 4.2" x 3" / 120mm x 108mm x 78mm
Weight - Camera	10.1lbs/460g

Code

Swann Code	SWNHD-819CAM
------------	--------------

Take a closer look

Weather resistant aluminum casing

80° Viewing angle

Color video image sensor

Easy mount base screws into a flat surface



See the difference

VIEW
CLOSE
UP

Know what's happening with zoom 75% more powerful than 1080p

75%
BETTER
RESOLUTION

Perfect for close up detail such as license plates, facial detail, clothing colors & more

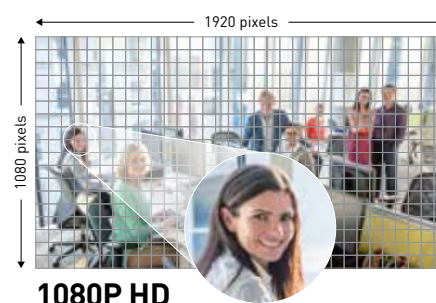

1080P HD

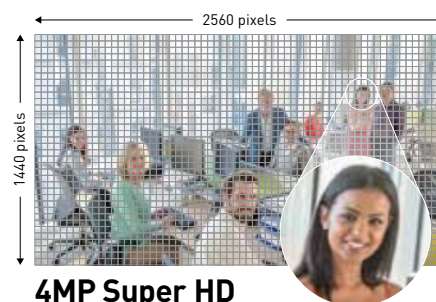

4MP Super HD



Our Promise

Swann stands by its promise of Lifetime Support to make advanced security easy to use, install and maintain. Everything is in the pack but if you need it Swann's help desk is available **24 hours a day, 7 days a week** for the life of the product.

Installation is easy

Do-it-Yourself

Installing this Swann product is simple. For instructions, tips and videos see the operating instructions in this pack or visit www.swann.com

Professional Installation

Need extra help? We have an installer in your region! For more visit www.swann.com

For more information on this product visit www.swann.com