

INSTALLATION & OPERATING INSTRUCTIONS

Valve positioning

Install the valve with the actuator head above the horizontal level of the pipework. The Input and output ports must not be isolated. The flow must be in the direction of the arrow.

Fitting the valve body to the pipework

Fit the valve body using the nuts and olives provided. When tightening the compression nuts ensure that only the valve body is used for grip. Take care not to over-tighten.

Note: Port A – Heating, Port B – Hot Water

Removal of actuator from the valve body

To remove the actuator head from the valve body ensure that the manual override lever is in the manual (open) position. Press the detach button, the actuator will detach from the valve body.

Fitting of actuator to the valve body

Before fitting the actuator to the valve, please ensure that the manual override lever is in the manual (open) position. The actuator is mounted by aligning the 4mm flat spindle on the valve body to the identically sized slot on the actuator. When the valve and actuator are successfully coupled, the actuator locking mechanism will “click” into place.

Once the valve is fitted, place the manual override lever in the manual open position. It is now possible to flush and drain the system to remove any foreign matter. The system can then be refilled and corrosion inhibitor may be added if required.

Wiring Connections

For Fixed Wiring Only

Must be fitted to a 3A Fused Supply

This product must be earthed.

Wire product in accordance with current IET wiring regulations.

Wire product according to the Mid Position System Wiring Diagram on Page 3.

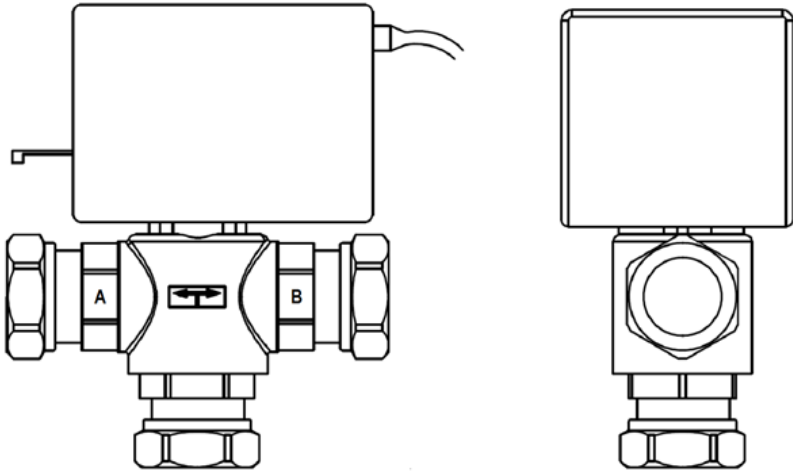

7091G Installation Guide

Flomasta 3-Port Motorised Valve

Please leave this guide with the consumer

Helpline Number: 0845 230 5522

PRODUCT INFORMATION

Product: 7091G 3-Port Motorised Valve



Product range: Flomasta

Contact Address: Watersmith (UK) Ltd Trade House, Yeovil BA22 8RT

Helpline number: 0845 230 5522

TECHNICAL INFORMATION

Actuator: Voltage rating: 230Vac Power consumption: 5W Impedance protected motor Auxiliary switch rating: 3(1)A Max ambient temperature: 50°C	Valve: Valve type: 22mm KV: 3.5 m ³ /h Max static pressure: 8.6 Bar Max differential pressure: 0.7 Bar Operating temperature: 5 - 88°C
Lead: Cable Length: 1.2m Earth connection required	
Pollution degree: II	Rated impulse voltage: 2.5 KV
Ball pressure test temp: 100°C	
Relevant EC Directives: LVD 2006/95/EC, EMC 2004/108/EC, ROHS 2011/65/EU	

Dimensions:

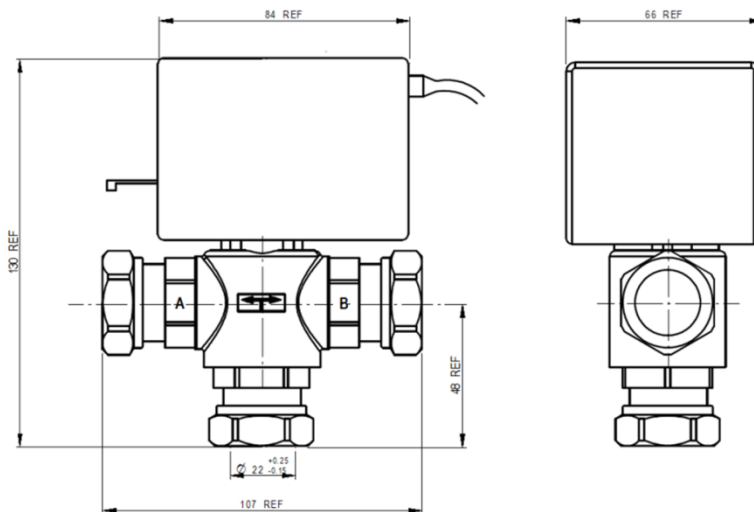

OPERATION

Actuator operation:

230V Power to Open – Spring return to Close

This is not a fail or safety product.

This control is designed Type 1.AA. C in accordance with EN60730

Manual override:

Valve may be manually opened for filling or draining the system.

In normal operation, the lever must be in the Auto position.

Wiring Diagrams

Mid Position System:

