

IT	Motosega - MANUALE DI ISTRUZIONI ATTENZIONE: prima di utilizzare la macchina, leggere attentamente il presente libretto.
EN	Chain-saw - OPERATOR'S MANUAL WARNING: read thoroughly the instruction booklet before using this machine.
FR	Scie à chaîne - MANUEL D'UTILISATION ATTENTION: lire attentivement le manuel avant d'utiliser cette machine.
DE	Motorsäge - GEBRAUCHSANWEISUNG ACHTUNG: vor Inbetriebnahme des Geräts die Gebrauchsanleitung aufmerksam lesen.
ES	Motosierra - MANUAL DE INSTRUCCIONES CUIDADO: antes de utilizar esta máquina, lea atentamente el manual de instrucciones.
NL	Kettingzaag - GEBRUIKERSHANDLEIDING LET OP: Voordat u de deze machine gaat gebruiken dient u eerst deze handleiding aandachtig door te lezen.
PT	Motoserra - MANUAL DE INSTRUÇÕES ATENÇÃO! Antes de usar a moto-roçadeira, ler com atenção este manual de instruções.
EL	Αλυσοπίριο - ΕΓΧΕΙΡΙΔΙΟ ΟΔΗΓΙΩΝ Προσοχή: πριν χρησιμοποιήσετε το μηχάνημα, διαβάστε προσεκτικά το παρόν εγχειρίδιο.
TR	Motorlu testere - KULLANIM KILAVUZU DİKKAT! Makineyi kullanmadan önce talimatlar içeren kilavuzu dikkatle okuyun.
PL	Piła silnikowa - INSTRUKCJE OBSŁUGI UWAGA: Przed użyciem urządzenia przeczytaj uważnie niniejszą instrukcję.
SL	Motorna žaga - PRIROČNIK ZA UPORABU POZOR: Preden uporabite stroj, pazljivo preberite priročnik z navodili.
RU	Бензопила - РУКОВОДСТВО ПО ЭКСПЛУАТАЦИИ ВНИМАНИЕ: Прежде чем пользоваться оборудованием, внимательно прочтите это руководство по эксплуатации.
HR	Motorna pila - PRIRUČNIK ZA UPORABO POZOR: Prije nego pristupite uporabi stroja, pažljivo pročitajte upute.
SV	Motorsåg - BRUKSANVISNING VARNING: Läs igenom hela detta häfte innan du använder maskinen.
FI	Moottorisaha - KÄYTTÖOHJEET VAROITUS: lue käyttöopas huolellisesti ennen koneen käyttöä.
DA	Motorsav - BRUGSANVISNING ADVARSEL: Læs instruktionsbogen omhyggeligt igennem, før du tager denne maskine i brug.
NO	Motorsag - INSTRUKSJONSBOK ADVARSEL: Les denne bruksanvisningen nøye før du bruker maskinen.
CS	Motorová pila - NÁVOD K POUŽITÍ POZOR: Před použitím stroje si pozorně přečtěte tento návod k použití.
HU	Motoros fűrész - HASZNÁLATI UTASÍTÁS FIGYELEM: a gép használatá elótt olvassa el figyelmesen a jelen kézikönyvet!
MK	Моторна пила - УПАТСТВА ЗА УПОТРЕБА ВНИМАНИЕ: пред да ја употребите машината, внимателно прочитајте го упатството за употреба.
LT	Motorinis pjūklas - NAUDOJIMO INSTRUKCIJOS DĖMESIO: prieš naudojant prietaisą, būtina atidžiai susipažinti su vartotojo vadovu.
LV	Motorzāģis - LIETOŠANAS INSTRUKCIJA UZMANĪBU: pirms aparāta lietošanai rūpīgi izlasiet doto instrukciju.
RO	Ferăstrău cu lanț - MANUAL DE INSTRUCȚIUNI ATENȚIE: înainte de a utiliza mașina, citiți cu atenție manualul de față.
BG	Моторна резачка - УПЪТВАНЕ ЗА УПОТРЕБА ВНИМАНИЕ: преди да използвате машината прочетете внимателно настоящата книжка.
ET	Kettsaag - KASUTUSJUHEND ETTEVAATUST: enne masina kasutamist lugeda tähelepanelikult käesolevat kasutusjuhendit.

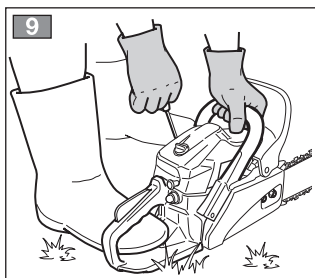

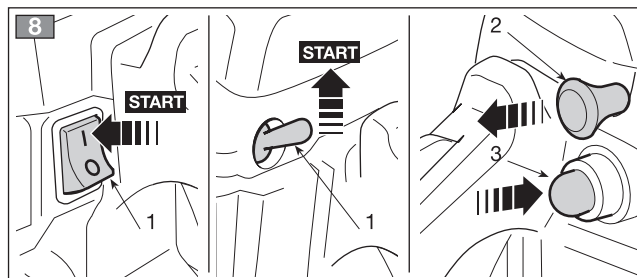

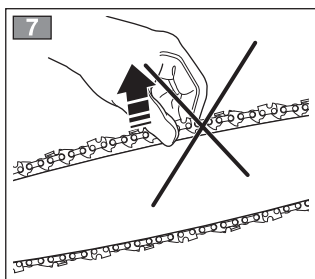

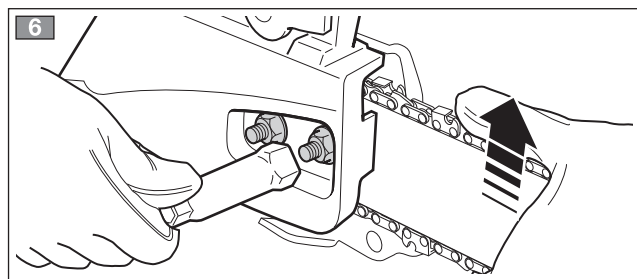
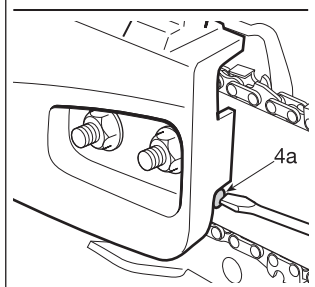
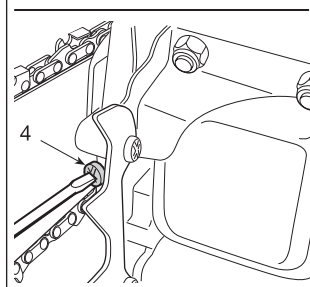
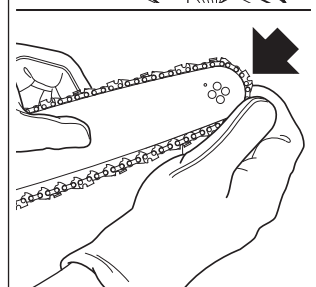
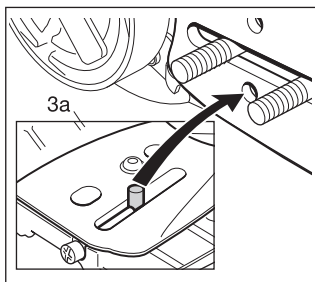
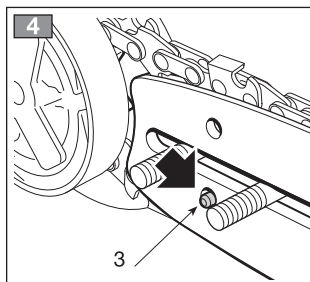
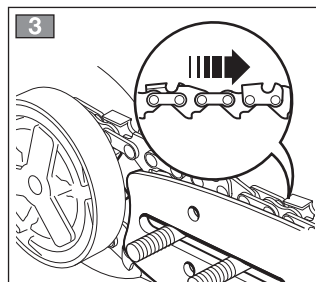
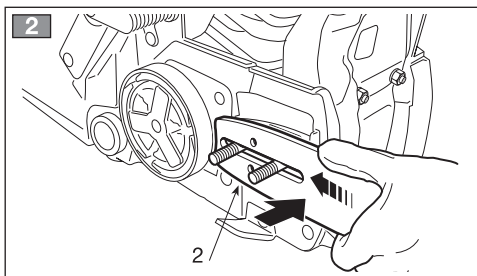
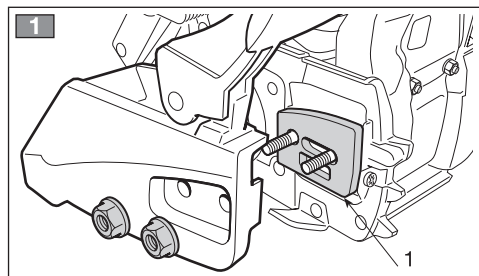
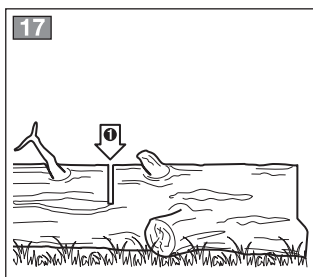
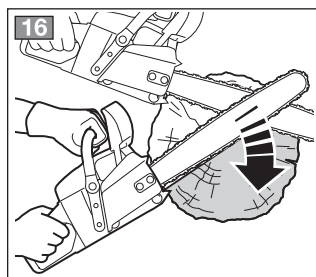
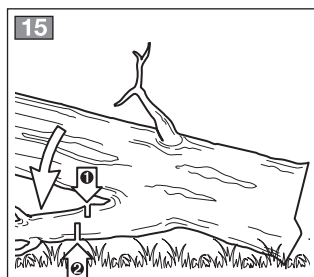
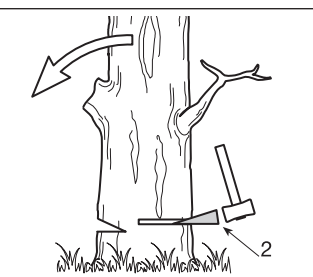
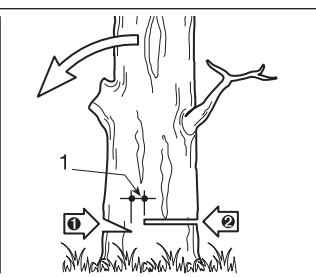
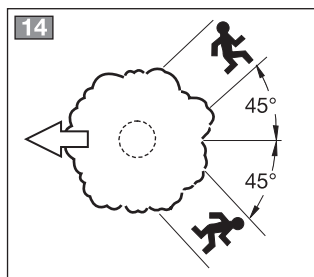
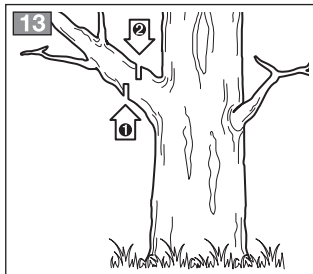
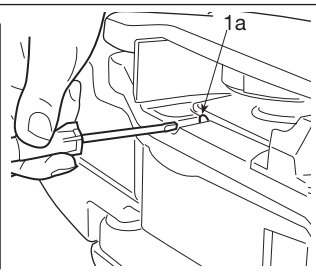
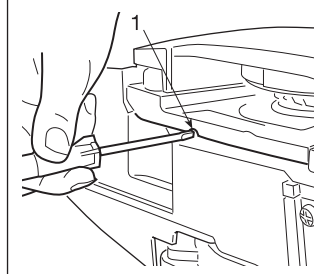
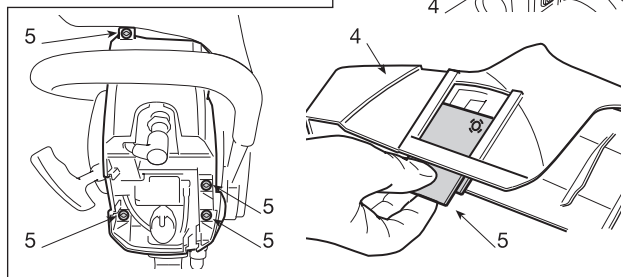
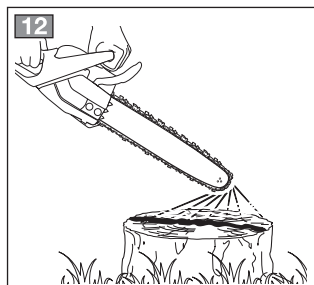
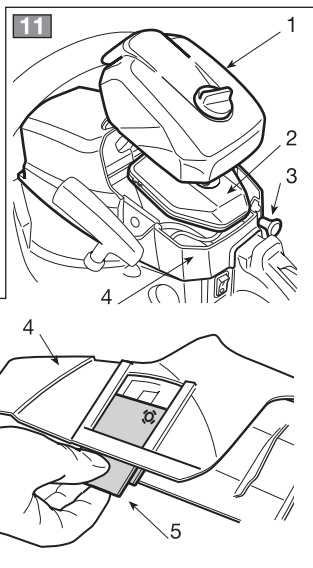
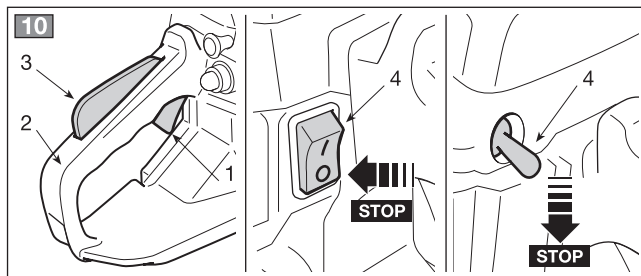
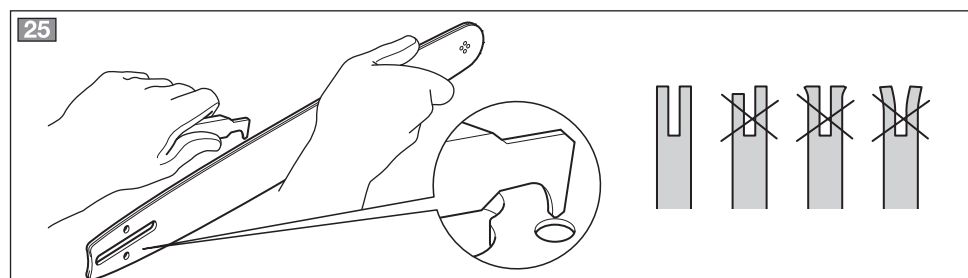
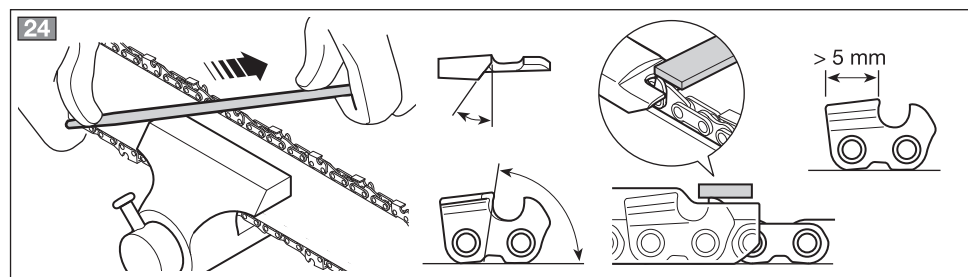
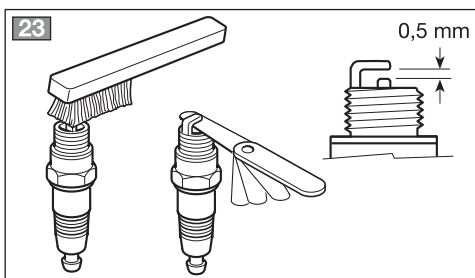
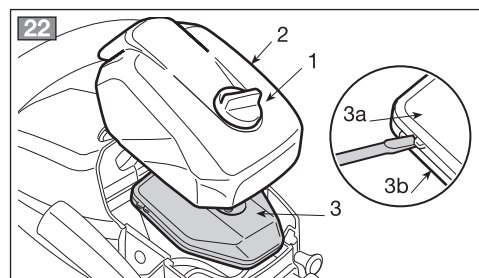
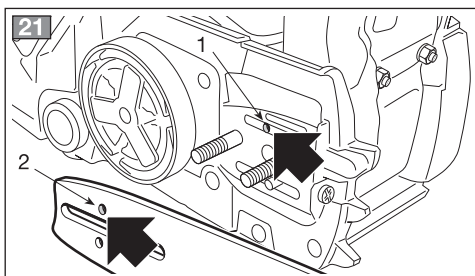
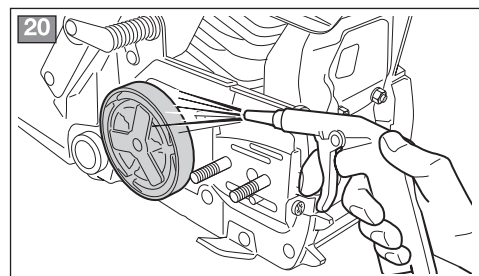
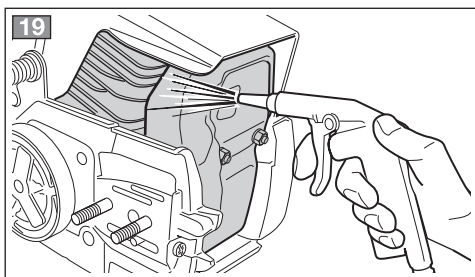
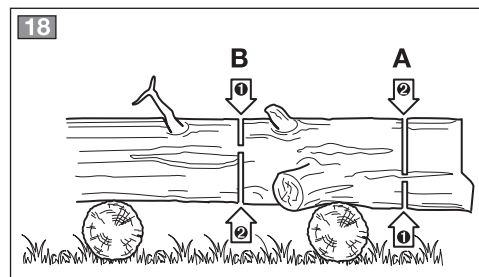

Dear Customer,

thank you for choosing one of our products. We hope that you will be completely satisfied with this machine and that it fully meets your expectations. This manual has been compiled in order to provide you with all the information you need to get acquainted with the machine and use it safely and efficiently. Don't forget that it is an integral part of the machine, so keep it handy so that it can be consulted when necessary, and pass it on to a further user if you resell or loan the machine.

Your new machine has been designed and manufactured in pursuance with current regulations, and is safe and reliable if used in compliance with the instructions provided in this manual (proper use). Using the machine in any other way, or non-compliance with the safety specifications relative to use, maintenance and repair is considered "improper use" which will invalidate the warranty, relieve the manufacturer from all liabilities, and the user will consequently be liable for all and any damage or injury to himself or others.

Since improvements are periodically made to our products, you may find slight differences between your machine and the descriptions contained in this manual. Certain modifications can be made to the machine without prior warning and without the obligation to update the manual, although the essential safety and function characteristics will remain unaltered. In case of any doubts, please contact your dealer. And now enjoy your work!

CONTENTS

1. Identification of the main components	2
2. Symbols	3
3. Safety requirements.....	4
4. Machine assembly	6
5. Preparing to work.....	7
6. How to start - Use – Stop the engine	8
7. Using the machine	10
8. Maintenance and storage	12
9. Identification of faults	16
10. Accessories	16

1. IDENTIFICATION OF MAIN COMPONENTS

MAIN COMPONENTS

- 1. Power unit
- 2. Spiked bumper
- 3. Front hand guard
- 4. Front handgrip
- 5. Rear handgrip
- 6. Chain catcher
- 7. Bar
- 8. Chain
- 9. Bar cover
- 10. Identification plate

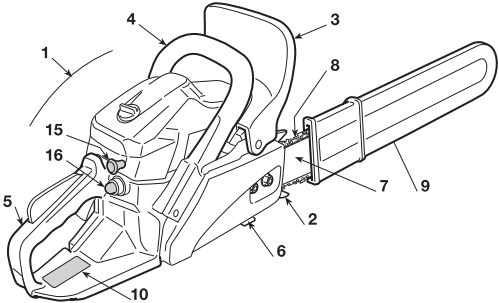

CONTROLS AND REFUELLING

- 11. Engine stop switch
- 12. Throttle trigger
- 13. Throttle trigger lockout
- 14. Starter
- 15. Choke
- 16. Primer
- 21. Fuel tank cap
- 22. Chain oil tank cap
- 23. Air cleaner cover

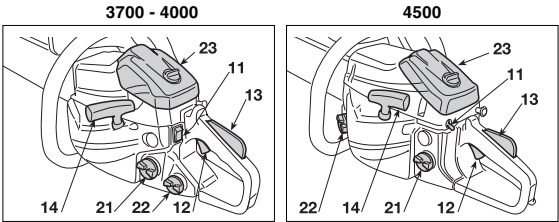

IDENTIFICATION PLATE

- 10.1) Conformity marking
- 10.2) Name and address of the manufacturer
- 10.3) Acoustic output level LWA
- 10.4) Manufacturer's model of reference
- 10.5) Machine model
- 10.6) Serial number
- 10.7) Year of manufacture
- 10.8) Article Code
- 10.9) Emission number

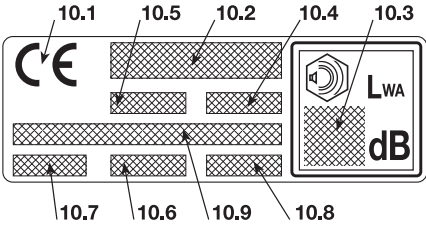

The example of the declaration of conformity can be found on the penultimate page of the manual.

Maximum noise and vibration levels

Model		3700	4000	4500
Operator ear noise pressure level	db(A)	97,1	97,3	98,7
– Measurement uncertainty	db(A)	3,0	3,0	3,0
Measured acoustic output level	db(A)	107,7	108,9	109,4
– Measurement uncertainty	db(A)	2,0	3,0	3,0
Guaranteed acoustic power level	db(A)	110	112	112
Vibration level				
– Front handle	m/s ²	6,7	7,0	7,4
– Rear handle	m/s ²	9,8	10,2	12,2
– Measurement uncertainty	m/s ²	1,5	1,5	1,5

2. SYMBOLS



1) Warning! Danger. The failure to use this machine correctly can be hazardous for oneself and others.

2) Beware of kickback! Kickback is the rapid and uncontrollable backward motion of the chain-saw in the direction of the operator. Always work in complete safety. Use chains with safety links that limit kickback.

3) Never hold the machine with one hand! Hold the machine fast with both hands to control the machine and reduce the risk of kickback.

4) Read the instruction manual before using the machine.

5) If you are using the machine every day in normal conditions, you can be exposed to a noise level of 85 dB (A) or higher. Wear earmuffs or earplugs and a protective helmet.

6) Wear gloves and protective footwear!

EXPLANATORY SYMBOLS ON THE MACHINE (if present)

11



11) Fuel tank

12



12) Chain oil tank and oil flow adjuster

13

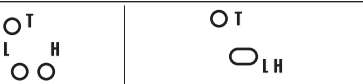

13) Carburettor adjustments

L = low speed mixture adjuster

H = high speed mixture adjuster

T - IDLE - MIN = idle speed adjuster

14

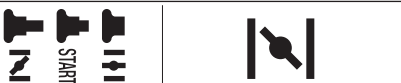

14) Choke

15



15) Primer

16



16) Chain brake (the (○) symbol shows the position in which the brake is released)

17



17) Direction in which the chain is mounted.

3. SAFETY REQUIREMENTS

A) TRAINING

1) **Read the instructions carefully.** Become acquainted with the controls and the proper use of the machine. Learn how to stop the engine quickly.

2) Only use the machine for the purpose for which it was designed, that is for **“felling, bucking and delimbing trees with dimensions suitable for the length of the bar”** or wooden objects with the same characteristics. Any other use may be dangerous and damage the machine.

Examples of improper use may include, but are not limited to:

- trimming hedges;
- intaglio carving;
- sectioning pallets, crates and various packing materials;
- sectioning furniture or other materials with nails, screws or other metal components;
- butchering meat;
- using the machine to lift, move or split objects;
- using the machine while fastened to fixed supports.

3) Never allow children or persons unfamiliar with these instructions to use the machine. Local regulations may restrict the age of the operator.

4) The machine must never be used by more than one person.

5) **Never use the machine:**

- when people, especially children or pets are in the vicinity;
- if the user is tired or unwell, or has taken medicine, drugs, alcohol or any substances which may slow his reflexes and compromise his judgement;
- if the user is not capable of holding the machine firmly with two hands and/or remaining standing on the ground whilst working.

6) Remember that the operator or user is responsible for accidents or hazards occurring to other people or their property.

B) PREPARATION

1) **Always wear adequate clothing which does not hamper movements when using the machine.**

- Always wear slim-fitting protective clothing, fitted with shear-proof protection devices.
- Always wear a helmet, protective gloves, eye-goggles, a half-mask respirator and safety anti-shear boots with non-slip soles.
- Always wear ear and hearing protection devices.
- Never wear scarves, shirts, necklaces, or any hanging or flapping accessory that could catch in the machine or in any objects or materials in the work area
- Tie your hair back if it is long.

2) **WARNING: DANGER! Fuel is highly flammable:**

- keep the fuel in containers which have been specifically manufactured and homologated for such use;
- never smoke when handling fuel;
- slowly open the fuel tank to allow the pressure inside to decrease gradually;
- top up the tank with fuel in the open air, using a funnel;
- add fuel before starting the engine. **Never remove the fuel tank cap or add fuel while the engine is running or when the engine is hot;**
- if you have spilt some fuel, do not attempt to start the engine but move the machine away from the area of spillage and avoid creating any source of ignition until the fuel has evaporated and fuel vapours have dissipated;
- immediately clean up all traces of fuel spilt on the machine or on the ground;
- never start the machine in the same place you refilled it with fuel;
- make sure your clothing does not come into contact with the fuel, on the contrary, change your clothes before starting the engine;
- always put the tank and fuel container caps back on and tighten well.

3) Replace faulty or damaged silencers.

4) **Before using the machine**, check its general condition and in particular:

- the throttle trigger and the safety lever must move freely, they must not need forcing and should return automatically and rapidly back to the neutral position;
- the throttle trigger must remain locked until the safety lever is pressed;
- the engine stop switch must easily move from one position to the other;
- the electric cables and in particular the spark plug cable must be in perfect condition to avoid the generation of any sparks, and the cap must be correctly fitted on the spark plug;
- the machine handgrips and protection devices must be clean and dry and well fastened to the machine;
- the chain brake must be in perfect working order;
- the bar and the chain must be fitted correctly;
- the chain must be tensioned correctly.

5) Before starting your work, make sure that all the protection devices are correctly fitted.

C) OPERATION

1) Do not operate the engine in a confined space where dangerous carbon monoxide fumes can collect.

2) Work only in daylight or good artificial light.

3) **Take on a firm and well-balanced position:**

- where possible, avoid working on wet, slippery ground or in any case on uneven or steep ground that does not guarantee stability for the operator;

- avoid using unstable ladders or platforms;
 - do not work with the machine above your shoulders;
 - never run, but walk carefully paying attention to the lay of the land and any eventual obstacles.
 - avoid working alone or in an isolated place, in case you have to find help after an accident.
- 4) Make sure the machine is securely locked when you start the engine:
- start the motor in an area at least 3 metres from where you refuelled;
 - check that there are no persons in the vicinity of the machine;
 - do not direct the silencer and therefore the exhaust fumes towards inflammable materials.
 - watch out for flying debris caused by the movement of the chain, especially when it hits obstacles or foreign objects.
- 5) **Do not change the engine tuning** and do not rev the engine excessively at maximum speed.
- 6) Do not strain the machine too much and do not use a small chain-saw for heavy-duty sawing. If you use the right machine, you will reduce the risk of hazards and improve the quality of your work.
- 7) Check that when the machine is running idle, there is no movement of the chain and, after pressing the throttle trigger, the engine quickly returns to minimum speed.
- 8) Take care not to hit the bar hard against foreign objects or flying debris caused by the movement of the chain.
- 9) **Stop the engine:**
- whenever you leave the machine unattended;
 - before refuelling.
- 10) **Stop the engine and disconnect the spark plug cable:**
- before cleaning, checking or working on the machine;
 - after striking a foreign object. Inspect the machine for any damage and make repairs before restarting it again;
 - if the machine begins to abnormally vibrate (Immediate look for the cause of the vibrations and take for necessary controls at a Specialised Centre).
 - when the machine is not in use.

D) MAINTENANCE AND STORAGE

- 1) Keep all nuts, bolts and screws tightly fastened to be sure the equipment is in safe working condition. **Routine maintenance is essential for safety and for maintaining a high performance level.**
- 2) Do not store the machine with fuel in the tank in an area where the fuel vapours could reach an open flame, a spark or a strong heat source.
- 3) Allow the engine to cool before storing in any enclosure.
- 4) To reduce fire hazards, keep the engine, exhaust silencer and fuel storage area free from sawdust, branches, leaves, or excessive grease; never leave containers with the cut debris inside the stor-

age area.

5) Se il serbatoio deve essere svuotato, effettuare questa operazione all'aperto e a motore freddo.

6) **If the fuel tank has to be emptied, this should be done outdoors once the engine has cooled down.**

7) **Make sure the chain is well sharpened.** Any work on the chain and bar require specific experience and special tools. For safety purposes, we recommend you contact your dealer to ensure work is done correctly.

8) **For safety reasons, never use the machine with worn or damaged parts. Damaged parts are to be replaced and never repaired. Only use original spare parts.** Parts that are not of the same quality can seriously damage the equipment and compromise safety.

9) Before putting the machine away, check you have removed wrenches or tools used for maintenance.

10) Store the machine out of the reach of children!

E) TRANSPORTATION AND HANDLING

1) Whenever the machine is to be handled or transported you must:

- turn off the engine, wait for the chain to stop and disconnect the spark plug cap;
- mount the bar cover;
- only hold the machine using the handgrips and position the bar in the opposite direction to that used during operation.

2) When using a vehicle to transport the machine, position it so that it can cause no danger to persons and fasten it firmly in place to avoid it from tipping over, which may cause damage or fuel spillage.

F) HOW TO READ THE MANUAL

Certain paragraphs in the manual contain particularly significant information and are marked with various levels of highlighting with the following meaning:

NOTE

or

IMPORTANT

These give details or further information on what has already been indicated, and aim to prevent both damage to the machine, and the machine from causing damage.



WARNING!

Non-observance will result in the risk of injury to oneself or others.



DANGER!

Non-observance will result in the risk of serious injury or death to oneself or others.

4. MACHINE ASSEMBLY

IMPORTANT

The machine is supplied with the bar and chain dismantled and the oil and fuel tanks empty.

⚠ WARNING!

Unpacking and completing the assembly should be done on a flat and stable surface, with enough space for machine handling and its packaging, always making use of suitable equipment. Disposal of the packaging should be done in accordance with the local regulations in force.

⚠ WARNING!

Always wear heavy-duty gloves when handling the bar and chain. Mount the bar and chain very carefully so as not to impair the safety and efficiency of the machine. If in doubt, contact your dealer.

Before fitting the bar, make sure the chain brake is not engaged; this is done by pulling the front hand guard right back towards the body of the machine.

1. BAR AND CHAIN MOUNTING

- Unscrew the nuts and remove the clutch cover to get to the drive sprocket and point where the bar is to be fitted (Fig. 1).
- Remove the plastic spacer, (1); this spacer must be used exclusively when transporting the machine in its packaging and must not be used at any other time (Fig. 1).
- Mount the bar (2) by inserting the stud bolts in the groove and push it towards the back of the machine body (Fig. 2).
- Mount the chain in the right direction around the drive sprocket and along the bar rail (Fig. 3). If the tip of the bar has a nose sprocket, make sure the drive links fit correctly in the sprocket rims.
- **In 3700 - 4000 Models:** Check that the chain tension adjuster pin (3) is fitted properly in the hole on the bar; if it isn't, turn the chain tension adjuster screw (4) using a screwdriver until the pin is completely inserted (Fig. 4).
- Fit the guard back on without tightening the nuts.
- **In 4500 Models:** check that the chain tension adjuster pin (3a) of the clutch cover is fitted properly in the hole on the bar; if it isn't, turn the chain tension adjuster screw (4a) using a screwdriver until the pin is completely inserted (Fig. 5).
- Turn the chain tension adjuster screw (4 or 4a) to adjust the chain tension (Fig. 4 and 5).
- Raise the bar and tighten the guard nuts securely using the wrench (Fig. 6).

2. CHECKS AFTER MOUNTING THE BAR AND THE CHAIN

- Check the chain tension. The tension is correct when the drive links do not slip out of the chain guides if you hold the chain in the middle of the bar (Fig. 7).
- Using a screwdriver, make the chain run along the guides to check it moves smoothly without resistance.

5. PREPARING TO WORK

CHECKING THE MACHINE

Before starting work please:

- check that all the screws on the machine and the bar are tightly fastened;
- check that the chain is sharp and there are no signs of any damage;
- check that the air filter is clean;
- check that the protection devices are well fastened and working efficiently;
- check that the handgrips are well fastened;
- check that the chain brake is working efficiently.

PREPARING THE FUEL

This machine is fitted with a two-stroke engine which requires a mixture of petrol and lubricating oil.

IMPORTANT

Using petrol alone will damage the motor and will cause for invalidation of the warranty.

IMPORTANT

Only use quality fuels and oils to maintain high performance and guarantee the duration of the mechanical parts over time.

• Petrol characteristics

Only use unleaded petrol with a fuel grade of at least 90 N.O.

IMPORTANT

Unleaded petrol tends to create deposits in the container if preserved for more than 2 months. Always use fresh petrol!

• Oil characteristics

Only use top quality synthetic oil specifically for two-stroke engines.

Your dealer can provide you with oils which have been specifically developed for this type of engine, and which are capable of guaranteeing a high level of protection.

The use of these oils makes it possible to prepare a 2% mixture, consisting in 1 part oil to 50 parts petrol.

- Preparation and preservation of the fuel mixture

DANGER!

Petrol and the fuel mixture are highly inflammable!

- ***Keep the petrol and fuel mixture in homologated fuel containers, in safe place, away from any flames or heat sources.***
- ***Never leave the containers within the reach of children.***
- ***Never smoke whilst preparing the mixture and avoid inhaling the petrol fumes.***

The chart indicates the amount of petrol and oil to use to prepare the fuel mixture according to the type of oil used.

Petrol	Synthetic oil 2-stroke	
liters	liters	cm ³
1	0,02	20
2	0,04	40
3	0,06	60
5	0,10	100
10	0,20	200

To prepare the fuel mixture:

- Place about half the amount of petrol in a homologated tank
- Add all the oil, according to the chart.
- Add the rest of the petrol.
- Close the top and shake well.

IMPORTANT

The fuel mixture tends to age. Do not prepare excessive amounts of the fuel mixture to avoid deposits from forming.

IMPORTANT

Keep the petrol and fuel mixture containers separate and easily identifiable to avoid the mistake of using one in place of the other.

IMPORTANT

Periodically clean the petrol and fuel mixture containers to remove any eventual deposits.

REFUELLING

⚠ DANGER! *Never smoke whilst refuelling and avoid inhaling the petrol fumes.*

⚠ WARNING! *Carefully open the tank top as pressure could have formed inside.*

Before refuelling:

- Shake the fuel mixture container well.
- Place the machine on a flat stable surface, with the fuel tank cap facing upwards.
- Clean the fuel tank cap and the surrounding area to avoid any dirt from entering the tank during refilling.
- Carefully open the fuel tank cap to allow the pressure inside to decrease gradually. Use a funnel to refill and avoid filling the tank to the brim.

⚠ WARNING! *Always close the fuel tank cap firmly.*

⚠ WARNING! *Immediately clean all traces of fuel which may have dripped on the machine or the ground and do not start the engine until the petrol fumes have dissipated.*

CHAIN LUBRICANT

IMPORTANT *Only use special oil for chain saws or adhesive oil for chain saws. Do not use oil containing impurities so as not to block the oil filter and to prevent irreparable damage to the oil pump.*

IMPORTANT *The special oil for lubricating the chain is biodegradable. Use of a mineral oil or engine oil causes serious damage to the environment.*

It is essential that you use good quality oil to lubricate the cutting parts effectively. Used or poor quality oil does not guarantee good lubrication and reduces the duration of the chain and bar.

It is always worth topping up the oil tank completely (using a funnel) every time you refuel. Since the oil tank capacity is enough to guarantee that the fuel runs out first, you will avoid the risk of operating the machine without lubricant.

6. HOW TO START - USE – STOP THE ENGINE

STARTING THE ENGINE

⚠ WARNING! *The engine must be started in an area at least 3 metres from where you refilled the fuel tank.*

Before starting the engine:

- Place the machine firmly on the ground.
- Take off the bar cover.
- Make sure the bar is not touching the ground or any other object.

- **Cold starting**

NOTE *A “cold” start of the engine means starting it after at least 5 minutes from when it was switched off or after refuelling.*

To start the engine (Fig. 8):

1. Check that the chain brake is engaged (with the front hand guard pushed forward).
2. Set the switch (1) to «START».
3. Pull the knob (2) as far as possible to engage the starter.
4. Press the primer device button (3) 3 or 4 times to prime the carburettor.
5. Hold the machine firmly on the ground, with your hand on the handgrip and your foot in the rear handgrip, to avoid losing control during starting (Fig. 9).

⚠ WARNING! *If the machine is not held firmly, the force of the engine could cause the user to lose his balance or direct the bar towards him or an obstacle.*

- Pull the starter rope slowly for 10 - 15 cm until you feel some resistance, then tug it hard a few times until you hear the engine turn over.

⚠ WARNING! *Never wind the starter cable around your hand.*

⚠ DANGER! *Never start the chain saw by holding on to the starter cable and allowing it to fall. This is an extremely dangerous method as you lose complete control over the machine and the chain.*

IMPORTANT *To avoid breaking the starter rope, do not pull the whole length of it or let it slide along the edge of the cable guide hole. Release the starter gradually, to avoid letting it fly back uncontrollably.*

- Pull the starter rope again until the engine starts as normal.

NOTE *If the machine has difficulty starting, allow the starter knob to run back half way to prevent flooding the engine.*

NOTE *If the starter rope is pulled repeatedly with the choke on, it may flood the engine and make starting difficult. If you have flooded the engine, remove the spark plug and gently pull the handle on the starter rope to eliminate any excess fuel; then dry the spark plug electrodes and replace it on the engine.*

- When the engine has started, press the throttle trigger to disconnect the starter and allow the engine to idle.

IMPORTANT *Do not let the engine run at high power with the chain brake engaged, as this could cause overheating and damage to the clutch.*

- Let the engine run idle for at least 1 minute before using the machine.

• Hot starting

When hot starting (immediately after stopping the engine), follow the procedure indicated above in points 1 - 2 - 5 - 6 - 8.

USE OF THE ENGINE (Fig. 10)

IMPORTANT *Always disengage the chain brake, pulling the lever towards you before using the accelerator.*

The chain speed is regulated by the throttle trigger (1) on the rear handgrip (2).

The throttle trigger only works if the lockout (3) is pressed at the same time.

The movement is transmitted from the engine to the chain by a centrifugal mass clutch that prevents the chain from moving when the engine is running at minimum speed.

⚠ WARNING! *Do not use the machine if the chain moves when the engine is running idle; in this case, contact your dealer.*

The correct running speed will be achieved by pressing the throttle trigger (1) as far as possible.

IMPORTANT *Avoid using the engine at full power for the first 6-8 working hours.*

STOPPING THE ENGINE (Fig. 10)

To stop the engine:

- Release the throttle trigger (1) and allow the engine to run idle for a few seconds.
- Set the switch (4) to “STOP”.

⚠ WARNING! *When you have reduced speed to a minimum, it may take a few seconds for the chain to stop.*

USING THE ANTI-FREEZE DEVICE (For models 3700 and 4000 only)

Operating chain saws in temperatures of 0 – 5°C at times of high humidity may result in ice forming within the carburetor, and this in turn may cause the output power of the engine to be reduced or for the engine to fail to operate smoothly.

This product has accordingly been designed with a ventilation hatch on the right side of the surface of the cylinder cover to allow warm air to be supplied to the engine and to thereby prevent icing from occurring.

Under normal circumstances the product should be used in the normal operating mode, i.e., in the mode which it is set at the time of shipment. However when the possibility exists that icing may occur, the unit should be set to operate in the anti-freeze mode before use.

To switch from "Normal" mode to "Anti-freeze" mode (and vice versa) (Fig. 11):

1. Switch the engine off.
2. Remove the air filter cover (1) and the air filter (2).
3. Remove the choke (3) from the cylinder cover (4):
4. Unscrew the screws (5) which secure the cylinder cover in place (three screws inside and one outside) and remove the cylinder cover.
5. Use your fingers to press the anti-freeze cap (6) on the right side of the cylinder cover and slide it out from its seat.

6. Turn the anti-freeze cap (6) so that the "SNOW" symbol is facing upwards and then replace the cap.
7. Replace the cylinder cover and all the other parts in their original position.

NOTE

If the machine is used in anti-freeze mode at higher temperatures, this may cause difficulties when starting the engine and during use due to the incorrect engine speed. Always check that the machine is switched to normal mode (with the "SUN" symbol facing upwards) if there is no danger of ice forming.

7. USING THE MACHINE

To respect people and the environment:

- Try not to cause any disturbance.
- Scrupulously comply with local regulations and provisions for the disposal of waste materials after sawing.
- Scrupulously comply with local regulations and provisions for the disposal of oils, petrol, damaged parts or any elements which have a strong impact on the environment.

⚠ WARNING! *Always wear suitable clothing when using the machine. Your dealer can provide you with all the information on the most suitable accident-prevention devices to guarantee your safety. Wear anti-vibration gloves. All the above-mentioned precautions do not however guarantee the prevention of certain risks – i.e. Raynaud's phenomenon or Carpal tunnel syndrome. For operators who use this machine for prolonged periods, it is therefore recommended to have periodic check-ups on the hands and fingers. If any of the above mentioned symptoms should appear, please contact a physician immediately.*

⚠ DANGER! *This machine's starter unit generates an average sized electromag-*

netic field, but it is not however possible to exclude the possibility of interference on any active or passive medical devices that operators may be wearing; this could be risky for their health conditions. All those using medical devices should always consult their GP, or the device manufacturer, before using this machine.

⚠ WARNING! *It takes specific training to use the machine for felling and delimbing.*

CHAIN BRAKE

This machine comes with an automatic brake that stops the chain when kickback occurs during cutting.

This brake can be operated manually by pushing the front guard forward. To release the brake, pull the front guard towards the handgrip until you hear a click.

⚠ WARNING! *Do not use the machine if the chain brake does not function correctly and have it inspected by your dealer.*

- Check that the chain brake is working efficiently.
- Make sure you are holding the machine firmly with both hands when you start the engine

- Use the accelerator level to keep the chain moving, push the brake lever forwards using the back of your left hand; the chain must stop immediately.
- When the chain has stopped, immediately release the accelerator lever.
- Release the brake.

CHECKING THE CHAIN TENSION

The chain tends to stretch gradually as you work, so you need to check its tension frequently.

⚠ WARNING! *Never work with the chain loose, as it can be hazardous if the chain slips out of its guides.*

CHECKING THE OIL DELIVERY

IMPORTANT *Never use the machine without lubrication! The oil tank may get almost empty every time the fuel runs out. Make sure you top up the oil tank every time you refuel the chain-saw.*

⚠ WARNING! *Make sure the bar and the chain are in place when you check the oil delivery.*

Start the engine, keep it running at medium power and check if the chain oil is delivered as shown in the figure (Fig. 12).

You can adjust the chain oil flow using a screwdriver on the adjuster screw (1 or 1a) of the oiler, which is on the bottom of the machine (Fig. 12).

DIRECTIONS FOR USE AND CUTTING TECHNIQUES

Before felling or delimbing for the first time, practise sawing logs on the ground or on trestles, so that you can get familiar with the machine and the most suitable sawing techniques.

⚠ WARNING! *When running, the machine must always be firmly held in both hands, with the right hand on the front handgrip and the left hand on the rear handgrip, even if the operator is left-handed.*

⚠ WARNING! *Stop the engine immediately if the chain stops during sawing. Beware of kickback, which can occur if the bar contacts an obstacle.*

Kickback occurs when the tip of the chain comes in contact with an object or when the wood contracts and jams the chain during sawing.

This contact with the tip of the chain can cause a rapid backward motion, pushing the guide bar up and towards the operator. This also happens when the chain is jammed along the upper part of the bar. In both cases, kickback can cause the operator to lose control of the chain-saw, leading to serious consequences.

• Delimbing (Fig. 13)

⚠ WARNING! *Make sure there is nothing or nobody in the area where the branches will fall.*

1. Stand opposite the branch you want to cut.
2. Start cutting lower branches followed by the higher ones.
3. Cut downwards to prevent the bar from getting jammed.

• Felling (Fig. 14)

⚠ WARNING! *When felling on slopes, always stand uphill from the tree and check that the felled trunk cannot cause damage if it rolls down the hill.*

1. Decide where the tree should fall – you should consider the wind, the natural lean of the tree, the position of the heaviest branches and how easy the work is after felling, etc.
2. Clear the area around the tree and find a stable place to stand.
3. Plan obstacle-free escape routes at a 45° angle back and away from the direction of fall. These routes must allow you reach a safe area at a distance of about 2.5 times the length of the tree to be felled
4. On the side of the fall, mark a felling notch around a third of the trunk's diameter.
5. Cut the tree on the other side, slightly above the bottom of the notch, leaving the uncut wood to act as a "hinge" (1) of approx. 5-10 cm.
6. Reduce the thickness of this hinge without pulling out the bar, until the tree falls.

7. In particular or unstable conditions, you can complete felling by inserting wedges (2) on the opposite side of the fall, and hitting them with a hammer until the tree falls.

• **Bucking (Fig. 15)**

⚠ WARNING! *Be careful of where the branches are lying on the ground, the risk of them being under tension, the direction the branch may go during cutting and the risk of the tree being unstable after the branch has been cut..*

1. Check the direction in which the branch is attached to the tree
2. First cut on the side where the branch bends and then finish cutting on the opposite side.

• **Sawing logs (Fig. 16)**

It is easier to saw a log using the spiked bumper.

1. Dig the spiked bumper into the log and use it as a pivot. Cut with an arched motion to make the bar penetrate the wood.
2. Repeat several times if necessary, changing the point where you plant the spiked bumper.

• **Sawing a log on the ground (Fig. 17)**

Cut up to half the diameter, roll the log over and finishing sawing on the other side.

• **Sawing a raised log (Fig. 18)**

1. If you are sawing the overhanging end of a supported log (A), first cut a third of the diameter from the bottom upwards, then finish from the top.
2. If you are sawing between two supports (B), cut a third of the diameter from the top downwards, then finish from the bottom.

END OF OPERATIONS

When you have finished your work:

- Switch off the engine as indicated above (Chap. 6)..
- Wait for the chain to stop and then mount the bar cover.

8. MAINTENANCE AND STORAGE

Correct maintenance is essential to maintain the original efficiency and safety of the machine over time.

⚠ WARNING! *During maintenance operations:*

- *Remove the spark plug cap.*
- *Wait until the engine is sufficiently cold.*
- *Use protective gloves when handling the bar and chain.*
- *Keep the bar protection devices on, except*

when intervening directly on the bar or the chain.

- *Never dispose of oils, fuel or other polluting materials in unauthorised places.*

CYLINDER AND SILENCER (Fig. 19)

To reduce fire risks, periodically clean the cylinder flaps with compressed air and clear the silencer area to get rid of sawdust, branches, leaves or other debris.

STARTING SYSTEM

To avoid overheating and damage to the engine, always keep the cooling air vents clean and free of sawdust and debris.

The starter rope must be replaced as soon as it shows signs of wear.

CLUTCH UNIT (Fig. 20)

Keep the clutch bell free of sawdust and debris, remove the casing (as illustrated in Chap. 4.1) and replace it correctly when the operation has been completed. Have your dealer check the greasing of the internal bearing every 30 hours (approx.).

CHAIN BRAKE

Regularly check the efficiency of the chain brake and the condition of the metal band around the clutch bell, remove the casing (as illustrated in Chap. 4.1) and replace it correctly when the operation has been completed.

Replace this band when the points in contact with the clutch bell wear down to about half the thickness of the two ends not subject to rubbing.

CHAIN SPROCKET

Regularly check the condition of the sprocket with your local retailer and replace it when wear exceeds the accepted limits.

Do not mount a new chain with a worn sprocket or vice-versa.

LUBRICATION HOLE (Fig. 21)

Periodically remove the casing (as illustrated in Chap. 4.1) remove the bar and check that neither the machine lubrication holes (1) or the bar (2) are clogged.

CHAIN CATCHER

This is an important safety device that restrains the chain if it breaks or degrooves.

Regularly check the condition of the chain catcher and replace it if it gets damaged.

NUTS AND SCREWS

Periodically check that all the nuts and screws are securely tightened and the handgrips are tightly fastened.

CLEANING THE AIR FILTER (Fig. 22)

IMPORTANT

Cleaning the air filter is essential to guarantee the efficiency and duration of the machine. Do not work with a damaged filter or without a filter, as this could permanently damage the engine.

It must be cleaned after every 8-10 working hours.

Clean the filter as follows:

- Unscrew the knob (1) and remove the cover (2).
- Remove the filter element (3) and tap it gently to remove any dirt and, if necessary, clean it with a brush.
- If it is completely clogged, use a screwdriver to separate the two parts (3a and 3b) and wash them in clean petrol. If you are using compressed air, aim the jet so that it blows from the inside towards the outside.
- Replace the two filter element parts by pressing on the edges until you hear them click into place.
- Fit the filter element (3) and the cover (2) back on.

CHECKING THE SPARK PLUG (Fig. 23)

Periodically remove and clean the spark plug using a metal brush to get rid of any deposits.

Check and reset the correct distance between the electrodes.

Replace the spark plug and fasten it firmly using the supplied wrench.

The spark plug must be replaced with one with the same characteristics whenever the electrodes have burnt or the insulation has worn, and in any case every 100 working hours.

TUNING THE CARBURETTOR

The carburettor is tuned by the manufacturer to achieve maximum performance in all situations, with a minimum emission of toxic gas in compliance with the regulations in force.

When performance is poor, first check that the chain runs smoothly and the bar rails are not distorted, then contact your dealer to check the carburetion and the engine.

• Tuning minimum speed

⚠ WARNING! *The chain must not move when the engine is running idle. If the chain moves when the engine is running idle, contact your dealer to correctly regulate the engine.*

SHARPENING THE CHAIN

⚠ WARNING! *To ensure that the chainsaw works safely and efficiently, it is essential that the cutting components are well-sharpened.*

Sharpening is necessary when:

- The sawdust looks like dust.
- Cutting becomes more difficult.
- The cut is not straight.
- Vibrations increase.
- Fuel consumption increases.

⚠ WARNING! *If the chain is not sufficiently sharpened, the kick-back's risk increases.*

A specialized centre will sharpen the chain using the right tools to ensure minimum removal of material and even sharpness on all the cutting edges.

If you sharpen the chain yourself, use special round-section files with the right diameter depending on the type of chain (see "Chain Maintenance Table"). You need a certain amount of skill and experience to avoid damaging the cutting edges.

Sharpen the chain as follows (Fig. 24):

Sharpen the chain as follows (Fig. 24):

- Switch off the engine, release the chain brake and secure the bar with the chain in a vice so that the chain can run smoothly.
- Tighten the chain if it is loose.
- Mount the file in the guide and then insert it in the tooth at a constant angle from the cutting edge.
- Sharpen in a forward motion a few times and repeat this on all the cutting edges facing the same way (right or left).
- Turn the bar over in the vice and repeat on all the other cutting edges.
- Check that the limiter tooth does not stick out further than the inspection instrument and file any projecting parts with a flat file, rounding off the edge.
- After sharpening, remove all traces of filing and dust and lubricate the chain in an oil bath.

Replace the chain whenever:

- The length of the cutting edges reduces to 5 mm or less;
- There is too much play between the links and the rivets.

Chain maintenance table

⚠ WARNING! *The specifications of the chain and the bar homologated for this machine are shown in the "EC Conformity Statement" provided. Do not use other types of chains or bars for safety reasons.*

The table gives the sharpening data for different types of chains, but this does not mean you can use different chains from the homologated one.

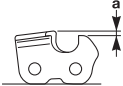
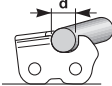
Chain pitch		Limiter tooth level (a)		File diameter (d)	
					
inches	mm	inches	mm	inches	mm
3/8 Mini	9.32	0.018	0.45	5/32	4.0
0.325	8.25	0.026	0.65	3/16	4.8
3/8	9.32	0.026	0.65	13/64	5.2
0.404	10.26	0.031	0.80	7/32	5.6

BAR MAINTENANCE (Fig. 25)

To avoid asymmetrical wear on the bar, make sure it is turned over periodically.

To keep the bar in perfect working order, proceed as follows:

- grease the bearings on the nose sprocket (if present) with the syringe;
- Clean the bar groove with the scraper (not included);
- clean the lubrication holes;
- with a flat file, remove burr from the edges and level off the guides.

Replace the bar whenever:

- the groove is not as deep as the height of the drive links (which must never touch the bottom);
- the inside of the guide is worn enough to make the chain lean to one side.

EXTRAORDINARY MAINTENANCE

All maintenance operations not foreseen in this manual must be performed exclusively by your dealer.

All and any operations performed in unauthorised centres or by unqualified persons will totally invalidate the warranty.

STORAGE

After every work stint, clean the machine thoroughly to remove all dust and debris, and repair or replace any faulty parts.

The machine must be stored in a dry place away from the elements and with the bar cover correctly fitted.

LONG PERIODS OF DISUSE

IMPORTANT

If you are not going to use the machine for a period of more than 2-3 months, we recommend you do a few things before putting it away. This will make it easier when you want to use the machine again and will also prevent permanent damage to the engine.

• Storage

Before putting the machine away:

- Empty the fuel tank.
- Start the engine and run it idle until it comes to a

halt, so that it uses up all the fuel that is left in the carburettor.

- Wait for the engine to cool down and remove the spark plug.
- Pour a teaspoon of (new) 2-stroke engine oil into the spark plug slot.
- Pull the starter rope several times to deliver oil to the cylinder..
- Replace the spark plug with the piston in the dead end upper position (visible from the spark plug slot when the piston is at maximum stroke).

• Restarting work

When you wish to start using the machine again:

- Remove the spark plug.
- Pull the starter rope a few times to eliminate excess oil.
- Check the spark plug as described in chapter “Checking the spark plug”.
- Prepare the machine as indicated in the paragraph entitled “Preparing for work”.

9. TROUBLESHOOTING

PROBLEM	LIKELY CAUSE	SOLUTION
1) The engine will not start or will not keep running	<ul style="list-style-type: none"> – Incorrect starting procedure – Dirty spark plug or incorrect distance between the electrodes – Air filter clogged – Antifreeze device is fitted incorrectly (Fr models 3700 and 4000 only) – Carburetion problems 	<ul style="list-style-type: none"> – Follow the instructions (see chapter 6) – Check the spark plug (see chapter 8) – Clean and/or replace the filter (see chapter 8) – Check the assembly position (see chapter 6) – Contact your dealer
2) The engine starts but is lacking in power	<ul style="list-style-type: none"> – Air filter clogged – Carburetion problems 	<ul style="list-style-type: none"> – Clean and/or replace the filter (see chapter 8) – Contact your dealer
3) The engine runs irregularly and lacks in power when revved	<ul style="list-style-type: none"> – Dirty spark plug or incorrect distance between the electrodes – Carburetion problems 	<ul style="list-style-type: none"> – Check the spark plug (see chapter 8) – Contact your dealer
4) The engine gives off an excessive amount of smoke	<ul style="list-style-type: none"> – Incorrect composition of the fuel mixture – Carburetion problems 	<ul style="list-style-type: none"> – Prepare the fuel mixture according to the instructions (see chap. 5) – Contact your dealer
5) No oil is released	<ul style="list-style-type: none"> – Bad quality oil – Lubrication holes are clogged 	<ul style="list-style-type: none"> – Empty the tank and fill up with new oil – Clean

10. ACCESSORIES

The table contains a list of all possible combinations between bar and chain, indicating those which may be used on each machine, marked with the symbol “★”.

chain are actions made solely by the user, the latter assumes responsibility for damages of any kind due to such actions. When in doubt or if lacking knowledge of the specificity of each bar or chain, contact your retailer or specialised gardening centre.

⚠ WARNING! In consideration that the selection, application and usage of bar and

Bar and chain combinations

Pitch Inches	Length Inches / cm	BAR		CHAIN Code	Model			
		Groove width Inches / mm	Code			3700	4000	4500
3/8"	14" / 35 cm	0,050"/1,3mm	118800127/0	118800133/0		★		
3/8"	16" / 40 cm	0,050"/1,3mm	118800128/0	118800132/0		★	★	
325"	18" / 45 cm	0,058"/1,5mm	118800130/0	118800131/0				★

GGP ITALY SPA

Via del Lavoro, 6

I-31033 Castelfranco Veneto (TV) ITALY



GLOBAL GARDEN PRODUCTS

171501120/2

2014/03/06

Realizzazione: EDIPROM / bergamo