



# INSTRUCTION MANUAL

## 8-TON MANUAL LOGSPLITTER

Model No: THMLS -- Product No: 1938117001

ASSEMBLY REQUIRED

SAVE THESE INSTRUCTIONS

SPARES & SUPPORT: 01793 333212

Please read & understand this manual, paying particular attention to the safety instructions, before use.

The manufacturer reserves the right to change the product specification and livery according to continued product improvements.

Images used are for illustration purposes only



# **CONTENTS**

**SPECIFICATION**

**IMPORTANT INFORMATION**

**GENERAL SAFETY INSTRUCTIONS**

**ASSEMBLY**

**OPERATION & ADJUSTMENT**

**MAINTENANCE & STORAGE**

**TROUBLE SHOOTING**

**PARTS DIAGRAM & LIST**

**WARRANTY**

**DECLARATION OF CONFORMITY**

**NOTES**

## **ASSEMBLY IS REQUIRED**

This product requires assembly before use. See the "Assembly" section for instructions. Please check that all parts required for the assembly of this spreader are included. If for any reason you believe a part for the assembly is missing or damaged, please contact us.

**If you require any assistance with regards to the contents or operation of your machine, please contact us:**

**TEL: 01793 333212**

**(MON – FRI 8.00AM TO 5.30PM EXCL. BANK HOLIDAYS)**

**EMAIL: [customerservice@handydistribution.co.uk](mailto:customerservice@handydistribution.co.uk)**

# SPECIFICATION

The manufacturer reserves the right to change the product specification and livery according to continued product improvements.

Model	THMLS
Product Number	1938117001
Ram Force	8 Ton
Maximum Log Length	584mm (23")
Minimum Log Length	200mm (8")
Maximum Log Diameter *	152mm (6")
Cylinder Hydraulic Oil Capacity	0.23 Litres
Cylinder Stroke	155mm (6.1")
Full Travel (No of Pumps)	13
Ram Return Speed	6 secs
Weight	29kg

\* The diameter of the log is not the only factor that determines how easy it will be to split. A small log can be difficult to split when it has knots or is a particularly hard wood.

## IMPORTANT INFORMATION

### INTENDED USE

The product is intended for domestic use only. This product is **not** intended for commercial use. Generally acknowledged accident prevention regulations and enclosed safety instructions must be observed. Only perform work described in these instructions for use, any other use is incorrect. The manufacturer will not assume responsibility for damage resulting from such use.

### HYDRAULIC OIL

This machine is supplied with Hydraulic Oil from the factory, to allow the machine to be used straight from the carton. Do check the oil level (instructions available in the manual) prior to the first use and periodically thereafter.

### WORKING CONDITIONS









This log splitter is a domestic use model. It is designed for operating under ambient temperatures between +5°C and 40°C and for installation at altitudes no more than 1000m above M.S.L. The surrounding humidity should be less than 50% at 40°C. It can be stored or transported under ambient temperatures between -25°C and 55°C.

### INSPECT YOUR LOG

Make sure there are no nails or foreign objects in logs to be split. The ends of the logs must be cut square. Branches must be cut off entirely so that the trunk is relatively smooth.

# GENERAL SAFETY INSTRUCTIONS

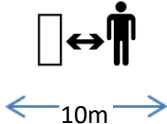
Read and understand the owner's manual and labels affixed to the product. Learn its application and limitations as well as the specific potential hazards. Retain these instructions for future reference. The operator is responsible for following the warnings & instructions in this manual and on the product.

	Read & understand operator's manual before using the machine. Failure to follow instructions could result in death or serious injury.		Always pay full attention to the movement of the log pusher. Do not attempt to load the log on until the log pusher has stopped. Keep hands out of the way of all moving parts.
	Wear gloves to protect your hands		Keep your hands away from splits and cracks which open in the log. They may close suddenly and crush your hands. Do not remove jammed logs with your hands
	Whenever the machine is in use, safety glasses must be worn to safeguard against flying objects. Hearing protection must also be used to protect the operators hearing. If the operator is working in an area where there is a risk of falling objects, a safety helmet must also be worn.		Wear foot protection
	Keep all bystanders & animals at least 10 metres away from the machine during operation. If approached, stop the machine immediately.		Take used oil to an authorized collection point or follow the local stipulations that apply where the log splitter is being used. Do not discharge into drains, soil or water.
	Keep guards in place and in working order. Frequently check to see that keys and adjusting wrenches are removed from the tool area before turning it on. Replace damaged, missing or failed parts before using it.		



Safety alert symbol. Used to alert you to potential personal injury hazards. Obey all safety messages that follow this symbol to avoid possible injury.



## DANGER

Indicates an imminently hazardous situation which, if not avoided, will result in serious injury.



## WARNING

Indicates a potentially hazardous situation which, if not avoided, could result in serious injury



## CAUTION

Indicates a potentially hazardous situation which, if not avoided, may result in minor or moderate injury.

## CAUTION

Used without the safety alert symbol indicates a potentially hazardous situation which, if not avoided, may result in property damage.

## **STAY ALERT**

Do not operate the machine while under the influence of drugs, alcohol, or any medication that could affect your ability to use it properly. Do not use this machine when you are tired or distracted from the job at hand. Be aware of what you are doing at all times. Use common sense.

## **AVOID DANGEROUS CONDITIONS**

Make sure there is adequate surrounding workspace. Cluttered areas invite injuries.

Keep your work area clean with sufficient light. Keep the area around the machine clear of obstructions, grease, oil, rubbish and other debris which could cause persons to fall onto moving parts.

## **INSPECT YOUR MACHINE**

Check all bolts, nuts, and screws for tightness before each use, especially those securing guards and drive mechanisms. Vibration during use, may cause these to loosen.

Form a habit of checking to see that all other tools/equipment are removed from the working area before turning it on.

Replace damaged, missing or failed parts before using it. Warning labels carry important information. Replace any missing or damaged warning labels.

## **DRESS PROPERLY**

Do not wear loose clothing, gloves, scarfs, neckties or jewelry (rings, wrist watches), which can be caught in moving parts. Protective electrically non-conductive gloves and non-skid heavy duty footwear are highly recommended when working. Wear a face or dust mask if the operation is dusty. Always wear safety glasses/goggles and/or face shields. Everyday eyeglasses have only impact resistant lenses; they are not safety glasses/goggles. Wear protective hair covering to contain long hair, preventing it from getting caught in machinery.

## **KEEP BYSTANDERS AND CHILDREN AWAY**

Keep unauthorised persons a minimum distance of 10 metres away from the machine. If approached, stop the machine immediately. Do not allow children to handle, climb on or in the machine.

## **DO NOT OVERREACH**

Keep proper footing and balance at all times when using the machine. Never stand on the machine. Serious injury could occur if the machine is tipped or if the moving parts are unintentionally contacted. Do not store anything above or near the machine, where anyone might stand on the machine to reach them.

## **AVOID INJURY FROM UNEXPECTED ACCIDENT**

Keep hands & feet out of the way of all moving parts. Do not place any part of your body or any tool e.g. in the machine during operation.

## **DO NOT FORCE TOOL**

Always work within the rated capacity. Do not use the machine for a purpose for which it was not intended.

## **NEVER LEAVE MACHINE RUNNING UNATTENDED**

Do not leave the machine unattended until it has come to a complete stop.

## **MAINTAIN YOUR MACHINE WITH CARE**

Clean the machine immediately after use. Keep the machine clean to ensure it operates to its full & safest performance. When maintaining this machine, only the manufacturer's original replacement parts should be used. The use of non-original manufacturer parts may invalidate your warranty.

## **PROTECT THE ENVIRONMENT**

Take left over materials to an authorised collection point or follow the stipulations in the country where the machine is used. Do not discharge into drains, soil or water.

## **STORE IDLE EQUIPMENT**

When not in use, the machine should be stored in a dry location. Keep the machine away from children and others not qualified to use it.

# ASSEMBLY

Place log splitter vertically on the floor in a clear and level area. Refer to the parts list for the following steps:

## STEP 1

Attach handles (part #8) to the top of the log splitter. One handle on each side. Secure each handle using a Lock Washer Ø10 (part #20) and M10 Hex Nut (part #21).

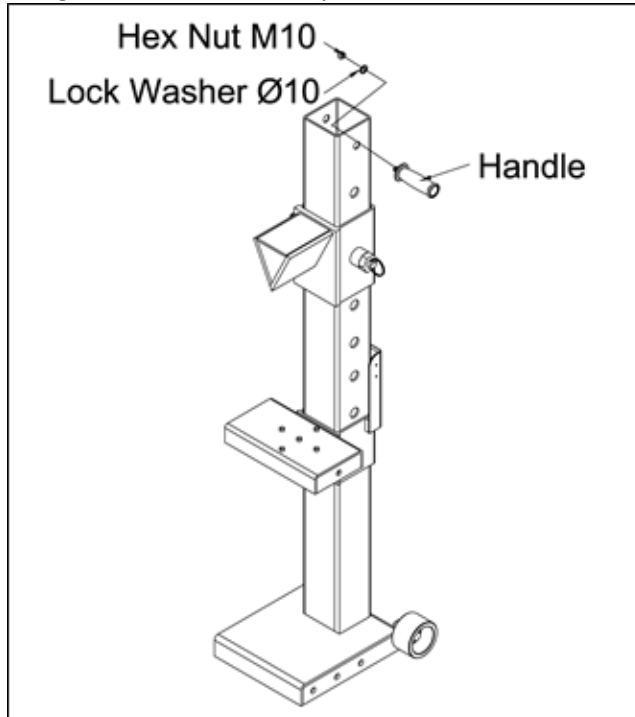

## STEP 2

Assemble the hydraulic pump (part #12) to the base by using two inner hex screws M8x16 (part #14). Note you should use an inner hex wrench to assemble this pump.

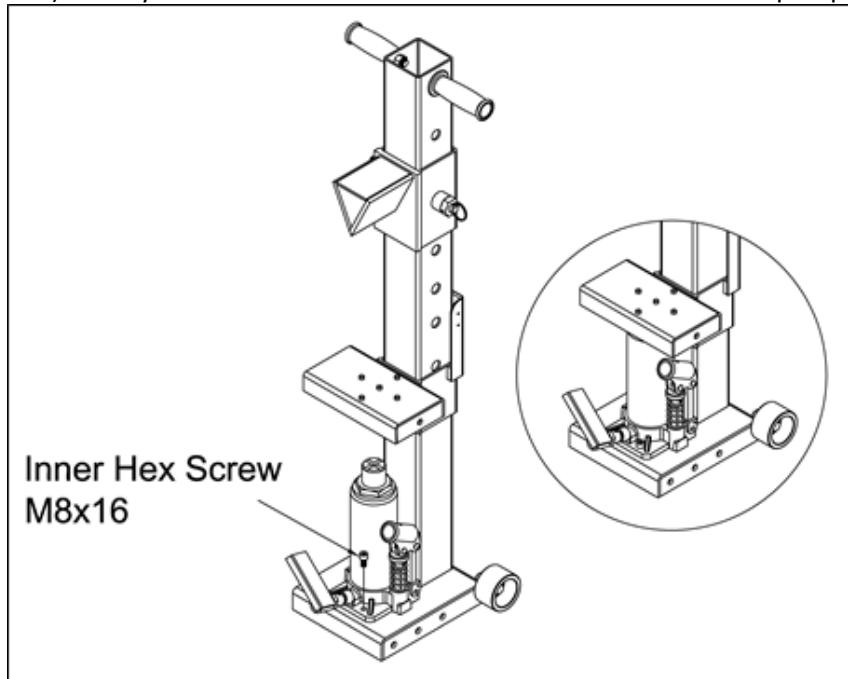

### STEP 3

Attach the Base Feet (part #22) to the bottom of the main post near the hydraulic pump as shown in Step 3. One foot on each side. Secure each foot using two M10X25 Hex Bolts (part #19), two Lock Washers Ø10 (part #20) and two M10 Hex Nuts (part #21).

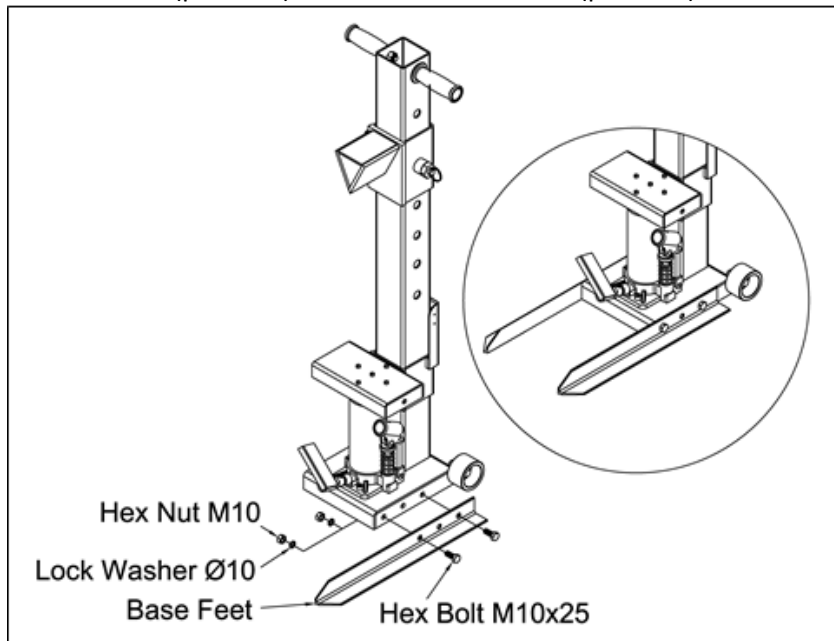

### STEP 4

Insert foot pedal (part #5) into hydraulic pump slot. Tighten hex bolt M6x10 (part #6) to secure the foot pedal to the hydraulic pump. See parts illustration.

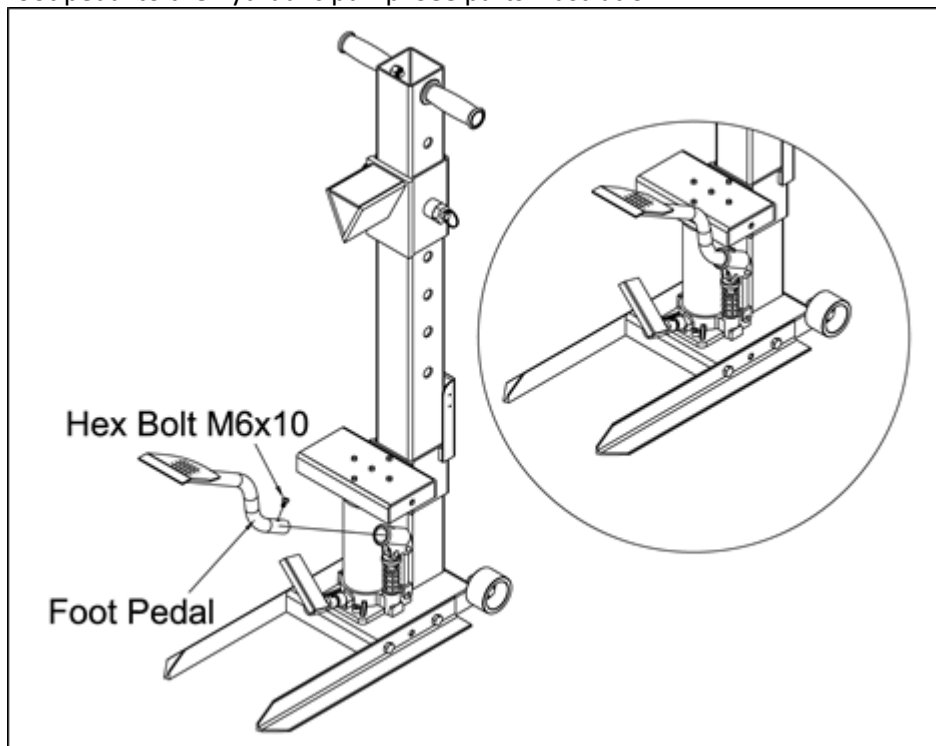



#### STEP 5

Attach each pull spring (part #13) into the centre hole of the foot leg first. Then attach the opposite end to the splitter workbench (part #11). Repeat Step 5 for each spring. This will require force to be applied by the person assembling.

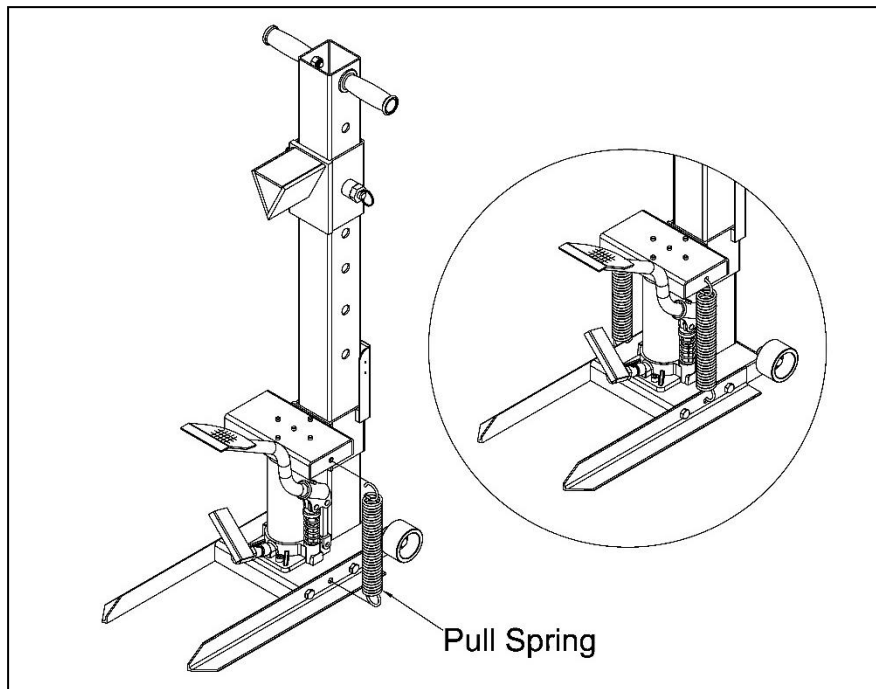

#### STEP 6

Attach the log cradle (part #29) to the main post by using a Hex Bolt M6x12 (part #31) and a Lock Washer Ø6 (part #32).

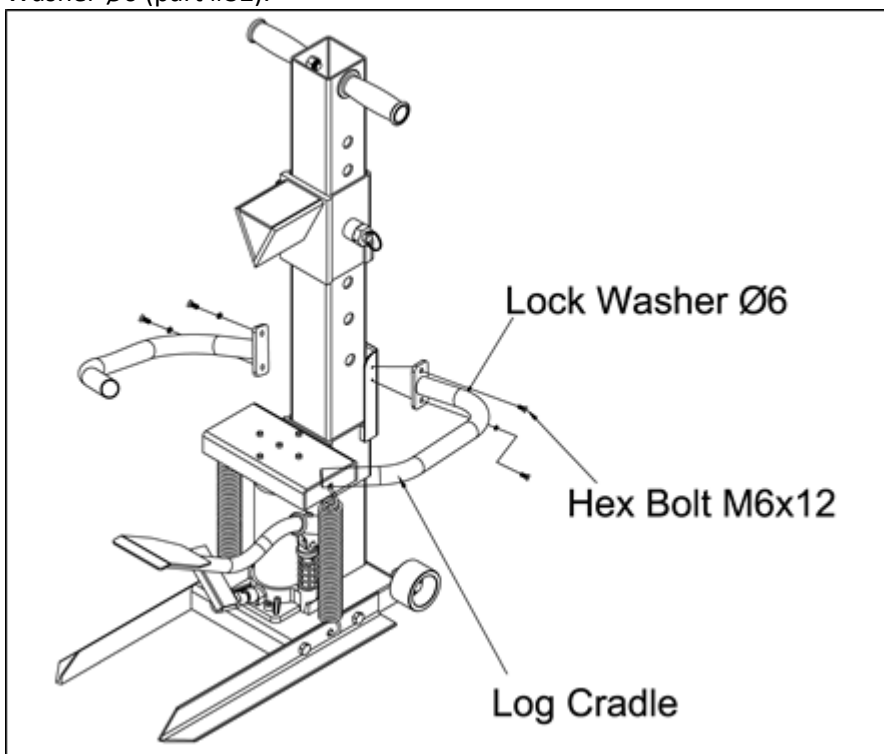

# OPERATION / ADJUSTMENT



## DANGER

The product must only be put into operation if no defects are found. It is crucial that defective parts are replaced before the product is used again. Check the safety equipment and the safe condition of the product: Check all parts to make sure that they fit tightly. Check whether there are any visible defects: broken parts, cracks, etc.

**NOTE:** Always split logs, with the grain of the wood and not against

1. Cut the logs for splitting to 584mm (23") in length or less to fit into the splitter.
2. Do not attempt to split logs with a diameter greater than 152mm (6").
3. Place the log securely on the splitter workbench.
4. Pull both of the wedge release pins out of the holes in the post, and lower the wedge to a height slightly above the length of the log.

**Note: Make sure the wedge release pins are firmly seated in the post holes before continuing.**

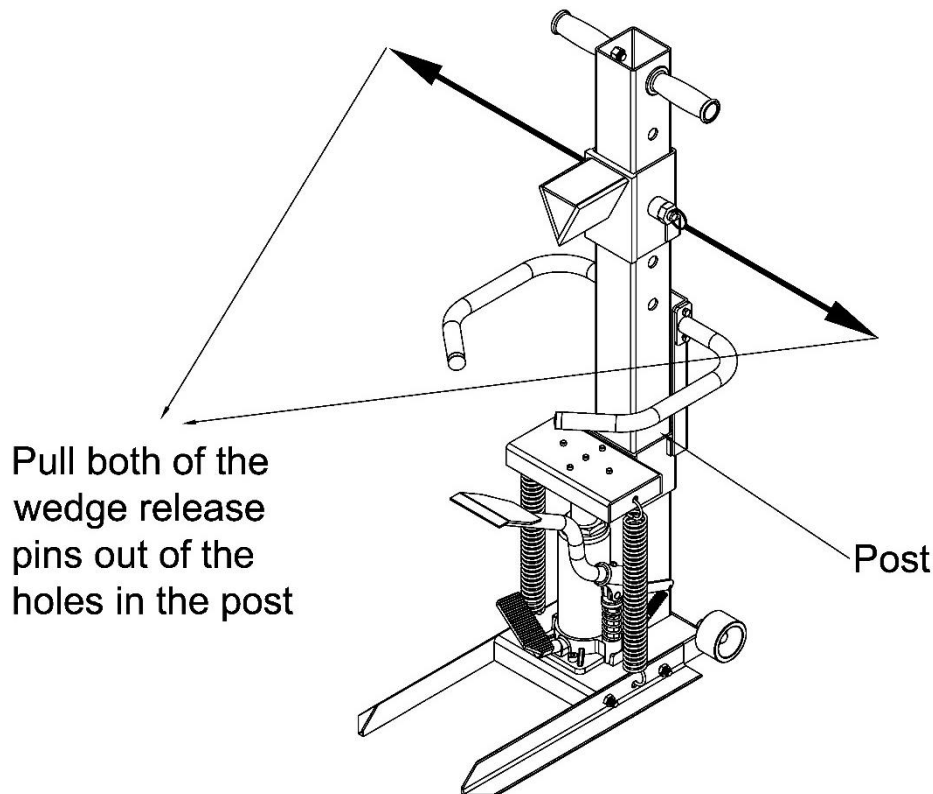

5. To move the hydraulic jack ram -- pump the foot pedal of the hydraulic pump to raise the splitter workbench.
6. Keeping the log stable and your hands out of the way of the wedge, use the hydraulic foot pedal to raise the log up tight against the wedge.
7. Keep your hands away from the log and logsplitter, continue with even strokes of the hydraulic foot pedal until the log is split.
8. Remove the wood pieces and clear the area of any debris.
9. To lower the splitter workbench, first release the hydraulic pump by treading on the release lever on the jack, then apply downward pressure to the workbench.

# MAINTENANCE

## CLEANING

Wipe down the log splitter to remove any tree sap or dirt after each use. After each use thoroughly clean the machine with a stiff brush.

## STORING

Before storing, ensure that the machine is clean and dry.

Store in a dry or protected area and coat exposed metal with light oil when not in use.

## CHECK ALL NUTS, BOLTS AND FASTENING

Before each use check all fastenings are tight & secure.

## ONLY USE MANUFACTURER APPROVED PARTS

If a part needs replacing, only use the manufacturer's original parts. Non-original replacement parts will invalidate your warranty and may result in a safety hazard or poor operation.

## TO ADD OIL TO THE HYDRAULIC PUMP:

Occasionally, you may need to add hydraulic oil to maximize performance. You should also replace the hydraulic oil in the log splitter after every **50 hours** of use.

**Note:** Refer to the *Parts Breakdown* to identify the parts named below.

1. Remove the pull spring, then separate the workbench from hydraulic pump.
2. Use a 6mm inner hex wrench to remove the two inner hex screws that hold the hydraulic pump to the base.
3. Position the pump horizontally and remove the round rubber oil plug on the back of the pump housing.
4. Add ISO VG15 hydraulic oil until the cylinder is approximately 3/4 full (0.23 litres).
5. Replace the rubber oil plug and reassemble the log splitter.

## SHARPENING THE SPLITTING WEDGE

After using the log splitter for some time, sharpen the splitting wedge using a fine-toothed file and smooth any burrs or crushed areas along the cutting edge.

# TROUBLE SHOOTING

ISSUE	CAUSE	SOLUTION
Cannot split log, insufficient pressure?	Trapped air in hydraulic bottle jack.	Remove both pull springs from the log table. Press the bottle jack release pedal 10 times to remove trapped air.
	Insufficient hydraulic oil	Follow add oil to hydraulic pump instructions
	The size or hardness of the log exceeds the capacity of the machine	Reduce the log size before splitting it.
	Oil leak	Locate leak & contact local Approved Dealer
	Splitting wedge is blunt	Refer to 'Sharpening Splitting Wedge' section to sharpen the cutting edge.

# PARTS DIAGRAM & LIST

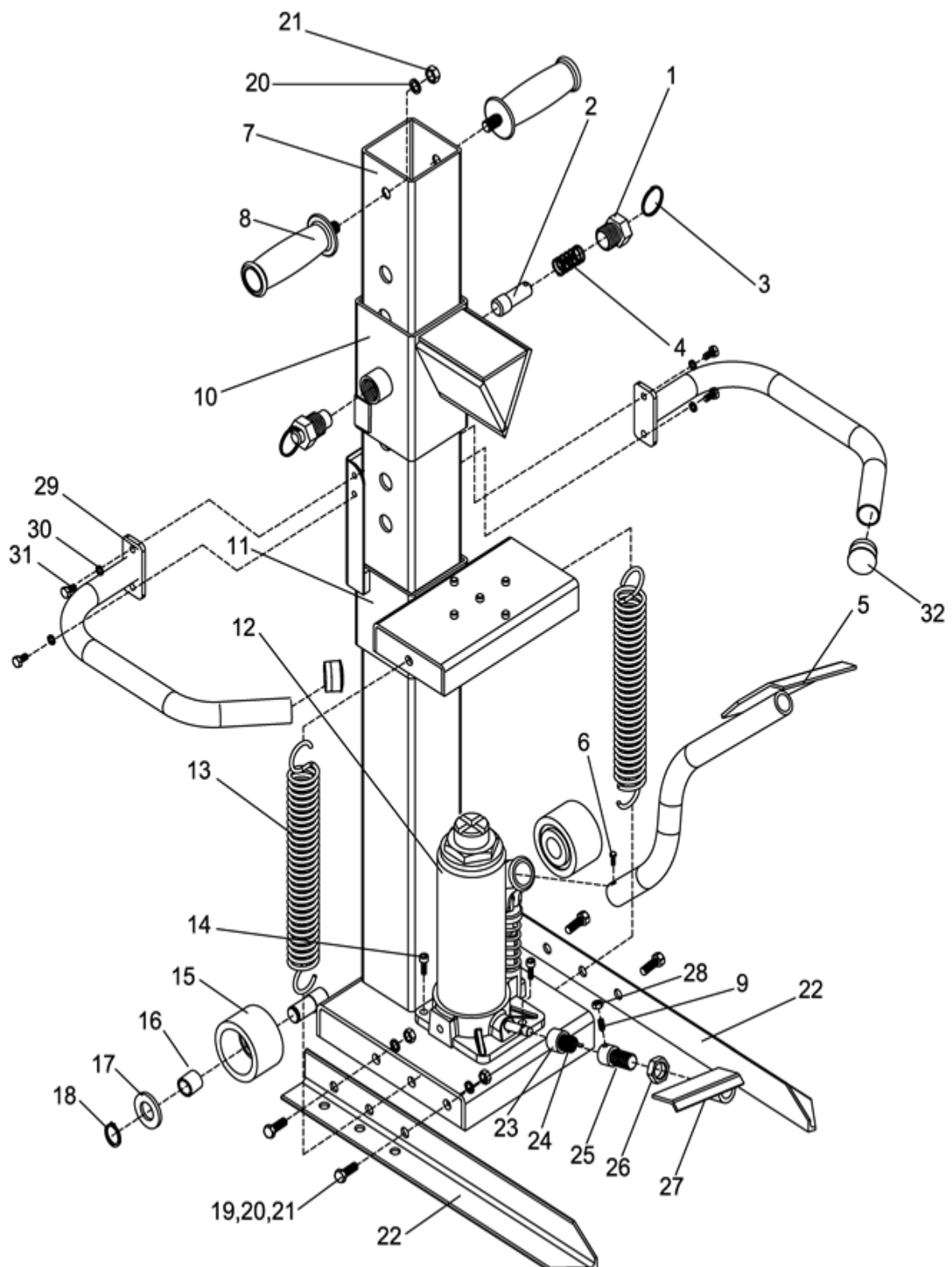

**NOTE:** Parts Lists are supplied for information purposes only, not all parts are stocked individually & we recommend you contact our Spares Team on 01793 333212 for expert advice.

## PARTS LIST

ITEM NO.	PART NO.	DESCRIPTION	QTY
1	TH196-1	Sleeve with Thread	2
2	TH196-2	Pin	2
3	TH196-3	Ring	2
4	TH196-4	Pressure Spring	2
5	TH196-5GM	Foot Pedal	1
6	TH196-6	Hex Bolt M6x10	1
7	TH196-7GM	Beam Frame	1
8	TH196-8	Handle	2
9	TH196-9	Inner Hex Screw M6x12	1
10	TH196-10GM	Wedge Assembly	1
11	TH196-11GM	Workbench	1
12	TH196-12	Hydraulic Pump	1
13	TH196-13	Pull Spring	2
14	TH196-14	Inner Hex Screw M8x16	2
15	TH196-15	Wheel	2
16	TH196-16	Spacer	2
17	TH196-17	Flat Washer Ø16	2
18	TH196-18	Back Ring Ø17	2
19	TH196-19	Hex Bolt M10x25	4
20	TH196-20	Lock Washer Ø10	6
21	TH196-21	Hex Nut M10	6
22	TH196-22GM	Base Feet	2
23	TH196-23	Torsional Spring Sleeve	1
24	TH196-24	Torsional Spring	1
25	TH196-25	Extension Rod	1
26	TH196-26	Thin Nut M16	1
27	TH196-27	Release Lever	1
28	TH196-28	Hex Nut M6	1
29	TH196-29GM	Log Cradle	2
30	TH196-30	Lock Washer Ø6	4
31	TH196-31	Hex Bolt M6x12	4
32	TH196-32	End Cover	2

# GJ HANDY & CO LTD USER WARRANTY POLICY

## **Users Statement of Warranty**

Each new machine is warranted against defective material or assembly of material under normal usage. The warranty applies to the original purchaser and covers faulty parts and the labour involved in replacing and repairing those parts, which are of original manufacture.

## **Period of Warranty**

### **All Webb, Handy Pro (Brushcutter & Long Handle Hedgecutter only) and Sanli domestic products.**

2 years from the original date of sale to the first domestic user.

90 days from the original date of sale to the professional/commercial user.

90 days from the original date of sale when used for hire.

A reduced warranty period of 90 days applies to those items which are subject to normal wear and tear (e.g. wheels, tyres, cutter bars, cylinders, bottom blades, belts, cables, grass bags, spark plugs).

Engines as per the manufacturer's warranty statement which will be supplied with the machine.

90 days from the original date of purchase for Replacement Spare Parts (unless normal wear & tear component, which are covered for 30 days).

All machines' must be serviced within the first 12 months from the original date of purchase to comply with the warranty, failure to do so will invalidate the 2nd year of the warranty.

### **All Handy, Handy Pro (All others), Mowerland and Q-Garden domestic products.**

1 year from the original date of sale to the first domestic user.

90 days from the original date of sale to the professional/commercial user.

90 days from the original date of sale when used for hire.

A reduced warranty period of 90 days applies to those items which are subject to normal wear and tear (e.g. wheels, tyres, cutter bars, cylinders, bottom blades, belts, cables, collection bags, spark plugs).

Engines as per the manufacturer's warranty statement which will be supplied with the machine.

90 days from the original date of purchase for Replacement Spare Parts (unless normal wear & tear component, which are covered for 30 days).

All warranty repairs must be undertaken by an authorised service dealer. These dealers have been accredited by GJ Handy & Co Ltd and agree to only use genuine parts and follow our repair procedures.

# GJ HANDY & CO LTD USER WARRANTY POLICY

## **Not covered by this warranty**

- a) The warranty policy does not cover any depreciation or damages caused by ordinary wear, rusting or corrosion, lack of correct maintenance or operation, misuse, abuse, lack of transportation or accident.
- b) The warranty policy does not cover any costs necessary for the standard periodic maintenance services instructed by the operator's manual, or service parts replacement which would include oil, filters, tyres, belts, brake linings, fuses, blades, seals and other service parts unless it can be proven that the item has evidence of faulty manufacture.
- c) The warranty policy will not cover failure or damage caused as a result of parts or accessories being modified without the written approval of GJ Handy & Co Ltd.
- d) The warranty policy will not cover the unit if non-genuine parts have been fitted and as a result damage has occurred to the unit.
- e) The warranty policy is non-transferable and is only applicable to the original purchaser.

## **Disclaimer**

- a) This warranty is only a remedy for defect of products. GJ Handy & Co Ltd will never warranty in terms of the merchantability or the fitness for a particular purpose.
- b) No person is authorised to make any warranties, representations or promises, expressed or implied, on behalf of GJ Handy & Co Ltd, or to modify the terms conditions or limitation of this warranty policy in any way.
- c) Neither GJ Handy & Co Ltd nor any company affiliated with GJ Handy & Co Ltd shall be liable in any event or manner whatsoever for incidental or consequential damages or injuries, including, but not limited to, loss of crops, loss of profit, out of pocket expenses or profits, rental of substitute equipment or other commercial losses.

## **General**

- a) Most warrantable failures show up within the first few weeks of use. These failures are usually straightforward and warranty assessment is relatively easy.
- b) Failures relating to cutter decks and belts need careful investigation, as the cause may not always be straightforward. Look for damage to blades and pulleys especially when the cutter belt or blade boss have snapped or cracked as this could be due to impact damage.
- c) Customers should always refer to the operator/instruction manual when any disputed problem arises, you will find most areas covered within the manual.

## NOTES

[illegible]



## NOTES

[illegible]



## EC DECLARATION OF CONFORMITY

**We Handy Distribution Ltd - SN3 5HY (Importer) declare that the product:**

**Designation:** 8 Ton Manual Log Splitter

**Model(s):** THMLS

**Product Number:** 1938117001

**Type/Serial No.** As per rating label on machine

Complies with the following directives:

**2006/42/EC** - Machinery Directive

Standards and technical specifications referred to:

**EN 609-1:1999+A2:2009, EN ISO 12100:2010, EN 349:1993+A1:2008,**

**EN 953:1997+A1:2009, EN ISO 13857:2008**

**Name of the Notified Body:**

CHINA CEPREI (SICHUAN) LABORATORY

**Address:**

No. 45 Wenming Dong Road, Longquanyi Chengdu 610100, P.R.C

**Authorised signatory and technical file holder**

**Date:** 08/09/2016

A handwritten signature in black ink, appearing to read 'S Belcher', is written over a horizontal line.

**Signature:**

**Name:** Mr Simon Belcher

**Position:** Managing Director

**Company:** Handy Distribution Ltd

**Address:** Murdock Rd, Swindon, Wiltshire, SN3 5HY.





For spares or support of your handy product,  
please contact us:

Tel: 01793 333212

(Mon – Fri 8.00am to 5.30pm excl. Bank Holidays)

Email: [customerservice@handydistribution.co.uk](mailto:customerservice@handydistribution.co.uk)

To see our range of garden machinery &  
equipment visit:

[www.thehandy.co.uk](http://www.thehandy.co.uk)

# Making gardening easier & affordable since 1938

Distributed by Handy Distribution, Murdock Road, Dorcan, Swindon, SN3 5HY