

Laser class 2  
in acc. with IEC 60825-1

[www.disto.com](http://www.disto.com)



SAP. No. 812 796a

## Change Units

Switch between the following units:



0.000 m	0.00 ft
0.0000 m	0'00" 1/32
2 sec	0 in 1/32

## Bluetooth®



1 x send  
2 sec deactivate/activate

# Quick Start

## Leica DISTO™ D110



- 1 — ON/DIST
- 2 — Area
- 3 — Bluetooth®
- 4 — Clear/Off

- when it has to be **right**

**Leica**  
Geosystems

## Insert Batteries

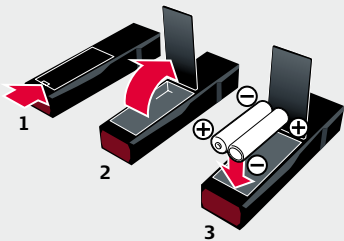

## Operation



1x → ON

CLEAR  
OFF

2 sec → OFF



1x



## Attach/Remove Clip

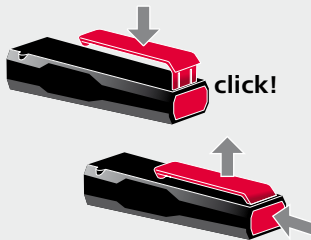

## Area

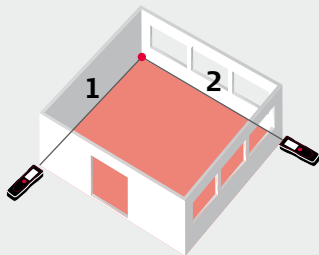

# Leica DISTO™ D110

The original laser distance meter



- when it has to be **right**

*Leica*  
Geosystems

<b>Instrument Set-up</b> .....	2
Introduction .....	2
Overview .....	2
Display .....	3
Insert batteries .....	3
Attach / Remove clip .....	3
<b>Operations</b> .....	4
Switching ON/OFF .....	4
Clear .....	4
Message Codes .....	4
Unit setting .....	4
Beep ON/OFF .....	4
<b>Measuring Functions</b> .....	5
Measuring single distance .....	5
Permanent measuring .....	5
Area .....	5
Bluetooth® Smart .....	6
<b>Technical Data</b> .....	7
<b>Message Codes</b> .....	8
<b>Care</b> .....	8
<b>Disposal</b> .....	8
<b>Warranty</b> .....	8
<b>Safety Instructions</b> .....	9
Symbols used .....	9
Permitted use .....	9
Prohibited use .....	9
Hazards in use .....	9

Limits of use .....	9
Areas of responsibility .....	10
Electromagnetic Compatibility (EMC) .....	10
FCC statement (applicable in U.S.) .....	10
Use of the product with Bluetooth® .....	11
Laser classification .....	11
Labelling .....	11

## Introduction

 The safety instructions and the user manual should be read through carefully before the product is used for the first time.

 The person responsible for the product must ensure that all users understand these directions and adhere to them.

The symbols used have the following meanings:

### **WARNING**

Indicates a potentially hazardous situation or an unintended use which, if not avoided, will result in death or serious injury.

### **CAUTION**

Indicates a potentially hazardous situation or an unintended use which, if not avoided, may result in minor injury and/or appreciable material, financial and environmental damage.

 Important paragraphs which must be adhered to in practice as they enable the product to be used in a technically correct and efficient manner.

## Overview

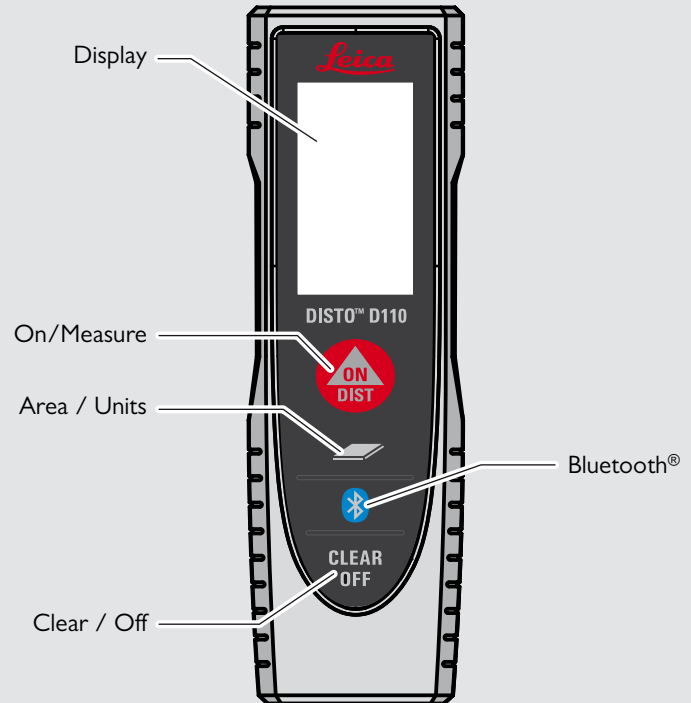

## Display

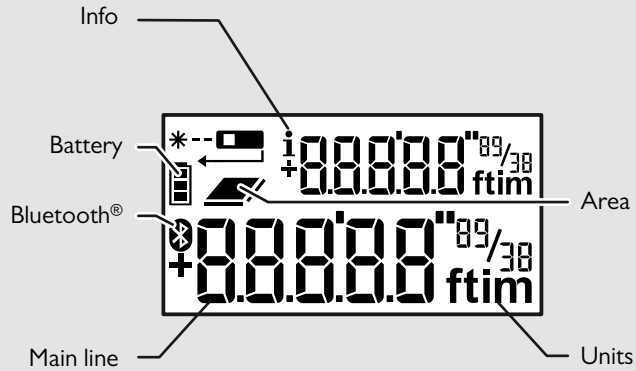

## Insert batteries

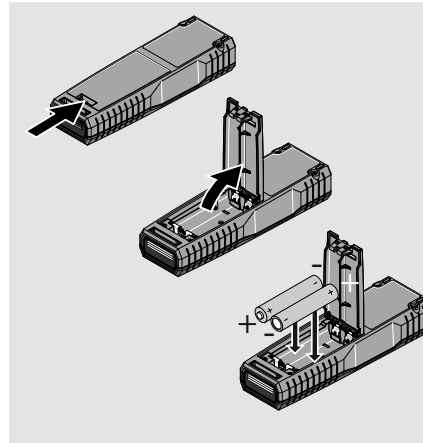

i

To ensure a reliable use, do not use zinc-carbon batteries. Change batteries when battery symbol is flashing.

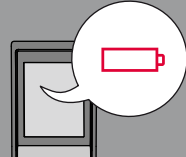

## Attach / Remove clip

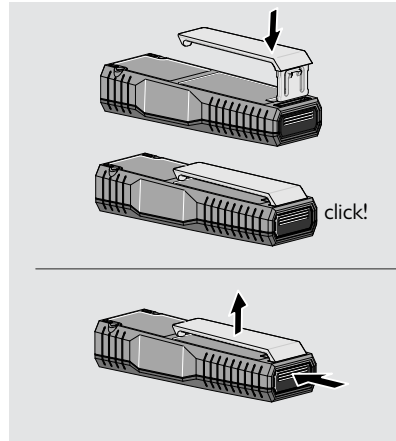

Switching ON/OFF



Device is turned OFF.

**i** Press ON button 2 sec to start continuous laser mode.

Clear



Undo last action.



Leave actual function, go to default operation mode.

Message Codes

If the message "InFo" appears with a number, observe the instructions in "Message Codes" section.  
Example:



Unit setting

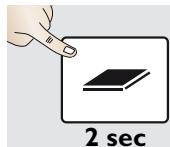

Switch between the following units:

0.000 m	0.00 ft
0.0000 m	0'00" 1/32
	0 in 1/32

Beep ON/OFF

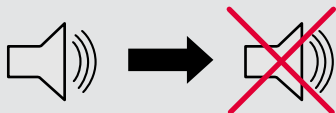
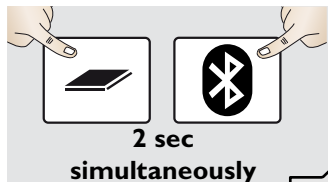

## Measuring single distance

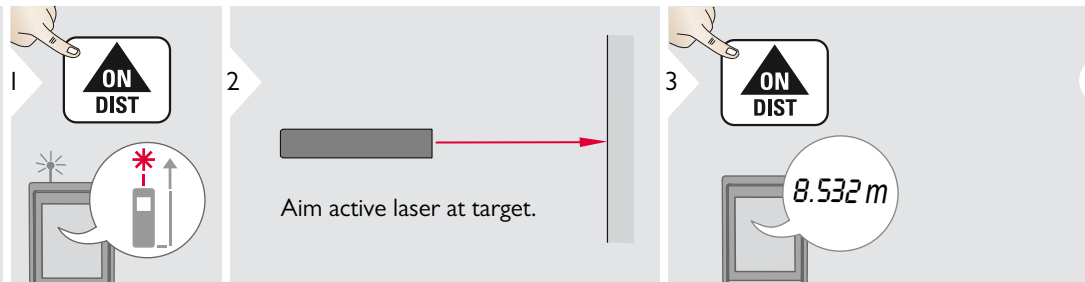

**i** Target surfaces: Measuring errors can occur when measuring to colourless liquids, glass, styrofoam or permeable surfaces or when aiming at high gloss surfaces. Against dark surfaces the measuring time increases.

## Permanent measuring

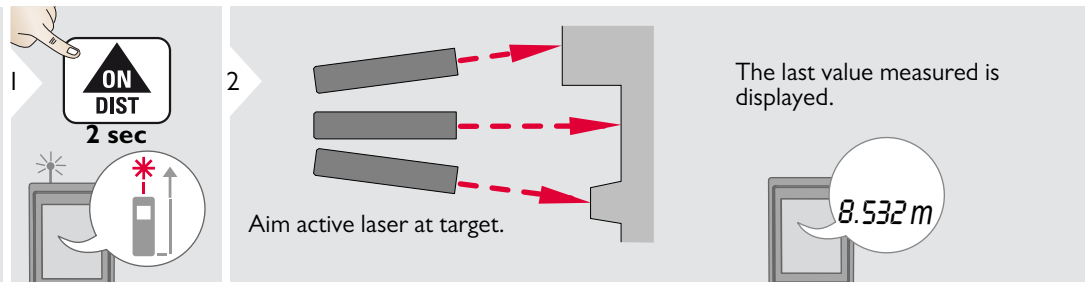

## Area

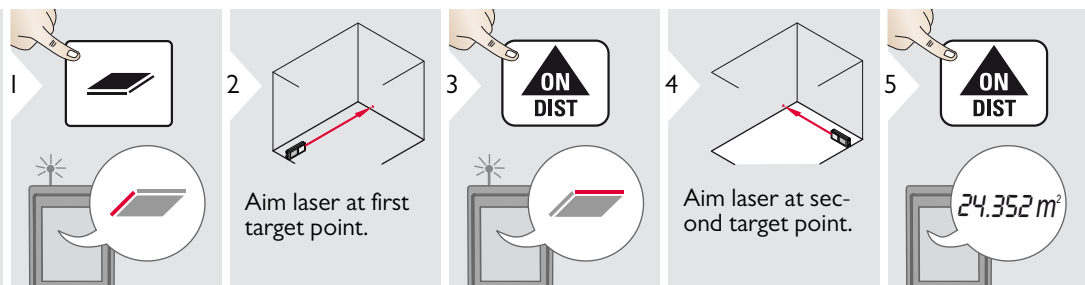



## Bluetooth® Smart

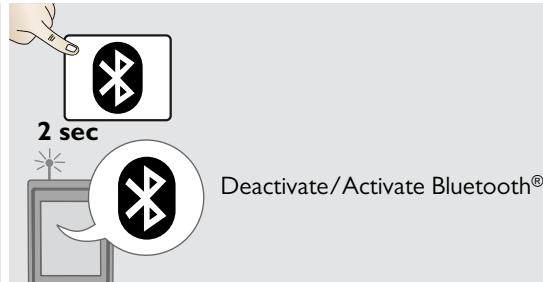
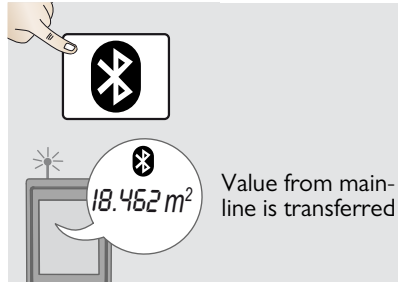

App Mode: Use this mode to transfer the data using an App.

i

Bluetooth® Smart is always active when the device is switched on. Connect the device with your smart-phone, tablet, laptop,...

Measurement values will be transferred automatically right after a measurement. To transfer a result from the main line, press the Bluetooth® key. Bluetooth® switches off as soon as the laser distance meter is switched off. The efficient and innovative Bluetooth® Smart module (with the new Bluetooth® standard V4.0) works together with all Bluetooth® Smart Ready devices. All other Bluetooth® devices do not support the energy saving Bluetooth® Smart Module, which is integrated in the device.

We provide no warranty for free DISTO™ software and offer no support for it. We accept no liability whatsoever arising from the use of the free software and we are not obliged to provide corrections nor to develop upgrades. A wide range of commercial software can be found on our homepage. Apps for Android® or iOS can be found in special internet shops. For more details, see our homepage.

General	
<b>Typical Measuring Tolerance*</b>	± 1.5 mm / ± 0.06 in ***
<b>Maximum Measuring Tolerance**</b>	± 3.0 mm / 0.12 in ***
<b>Range at Leica target plate GZM26</b>	70 m / 230 ft
<b>Typical Range*</b>	0.2-60 m / 0.6-200 ft
<b>Range at unfavourable condition ****</b>	30 m / 98 ft
<b>Smallest unit displayed</b>	0.1 mm / 1/32 in
<b>Power Range Technology™</b>	yes
<b>Laser class</b>	2
<b>Laser type</b>	635 nm, < 1 mW
<b>∅ laser point at distances</b>	6 / 30 / 60 mm 10 / 50 / 100 m
<b>Protection class</b>	IP54 (dust- and splash water protected)
<b>Autom. laser switch off</b>	after 90 s
<b>Autom. power switch-off</b>	after 180 s
<b>Bluetooth® Smart</b>	Bluetooth v4.0
<b>Range of Bluetooth®</b>	10 m
<b>Battery durability (2 x AAA)</b>	up to 5000 measurements
<b>Dimension (H x D x W)</b>	120 x 37 x 23 mm 4.72 x 1.46 x 0.91 in
<b>Weight (with batteries)</b>	92 g / 3.25 oz
<b>Temperature range:</b>	
- Storage	-25 to 70 °C -13 to 158 °F
- Operation	-10 to 50 °C 14 to 122 °F

\* applies for 100 % target reflectivity (white painted wall), low ambient light, 25 °C

\*\* applies for 10 to 500 % target reflectivity, high ambient light, - 10 °C to + 50 °C

\*\*\* Tolerances apply from 0.2 m to 5 m with a confidence level of 95%. The maximum tolerance may deteriorate to 0.1 mm/m. At unfavorable conditions such as bright sunlight, targets with poor reflectivity, or high or low temperatures, the maximum tolerance may deteriorate to 0.15 mm/m above 5m.

\*\*\*\* applies for 100 % target reflectivity, background illumination of approximately 30'000 lux

Functions	
<b>Distance measuring</b>	yes
<b>Permanent measuring</b>	yes
<b>Area</b>	yes
<b>Beep</b>	yes
<b>Bluetooth® Smart</b>	yes
<b>Illuminated display</b>	yes

## Message Codes

If the message **Error** does not disappear after switching on the device repeatedly, contact the dealer.

If the message **InFo** appears with a number, press the Clear button and observe the following instructions:

No.	Cause	Correction
204	Calculation error	Perform measurement again.
240	Data transfer error	Repeat procedure.
252	Temperature too high	Let device cool down.
253	Temperature too low	Warm device up.
254	Battery voltage too low for measurements	Change batteries.
255	Received signal too weak, measuring time too long	Change target surface (e.g. white paper).
256	Received signal too high	Change target surface (e.g. white paper).
257	Too much background light	Shadow target area.
258	Measurement outside of measuring range	Correct range.
260	Laser beam interrupted	Repeat measurement.

## Care

- Clean the device with a damp, soft cloth.
- Never immerse the device in water.
- Never use aggressive cleaning agents or solvents.

## Disposal

### CAUTION

Flat batteries must not be disposed of with household waste. Care for the environment and take them to the collection points provided in accordance with national or local regulations.

The product must not be disposed with household waste.

Dispose of the product appropriately in accordance with the national regulations in force in your country.



Adhere to the national and country specific regulations.

Product specific treatment and waste management can be downloaded from our homepage.

## Warranty

EN

### Lifetime Manufacturer's Warranty

Warranty coverage for the entire usage time of the product according to Leica Geosystems International Limited Warranty. Free of charge repair or replacement for all products that suffer defects as a result of faults in materials or manufacturing, for the entire life of the product.

### 3 Years no Cost

Guaranteed service should the product become defective and require servicing under normal conditions of use, as described in the user manual, at no additional charge.

To receive the "3 years no cost" period, the product must be registered at [www.leica-geosystems.com/registration](http://www.leica-geosystems.com/registration) within 8 weeks of the purchase date. If the product is not registered, a "2 years no cost" period applies.

The person responsible for the instrument must ensure that all users understand these directions and adhere to them.

### Symbols used

The symbols used have the following meanings:

#### **WARNING**

Indicates a potentially hazardous situation or an unintended use which, if not avoided, will result in death or serious injury.

#### **CAUTION**

Indicates a potentially hazardous situation or an unintended use which, if not avoided, may result in minor injury and/or appreciable material, financial and environmental damage.



Important paragraphs which must be adhered to in practice as they enable the product to be used in a technically correct and efficient manner.

### Permitted use

- Measuring distances

### Prohibited use

- Using the product without instruction
- Using outside the stated limits
- Deactivation of safety systems and removal of explanatory and hazard labels
- Opening of the equipment by using tools (screwdrivers, etc.)
- Carrying out modification or conversion of the product
- Use of accessories from other manufacturers without express approval
- Deliberate dazzling of third parties; also in the dark
- Inadequate safeguards at the surveying site (e.g. when measuring on roads, construction sites, etc.)
- Deliberate or irresponsible behaviour on scaffolding, when using ladders, when measuring near machines which are running or near parts of machines or installations which are unprotected
- Aiming directly in the sun

### Hazards in use

#### **WARNING**

Watch out for erroneous measurements if the instrument is defective or if it has been dropped or has been misused or modified. Carry out periodic test measurements, particularly after the instrument has been subject to abnormal use, and before, during and after important measurements.

#### **CAUTION**

Never attempt to repair the product yourself. In case of damage, contact a local dealer.

#### **WARNING**

Changes or modifications not expressly approved by Leica Geosystems for compliance could void the user's authority to operate the equipment.

### Limits of use



Refer to section "Technical data". The device is designed for use in areas permanently habitable by humans. Do not use the product in explosion hazardous areas or in aggressive environments.

## Areas of responsibility

### Responsibilities of the manufacturer of the original equipment:

Leica Geosystems AG

Heinrich-Wild-Strasse

CH-9435 Heerbrugg

Internet: www.disto.com

The company above is responsible for supplying the product, including the User Manual in a completely safe condition.

The company above is not responsible for third party accessories.

### Responsibilities of the person in charge of the instrument:

- To understand the safety instructions on the product and the instructions in the User Manual.
- To be familiar with local safety regulations relating to accident prevention.
- Always prevent access to the product by unauthorised personnel.

## Electromagnetic Compatibility (EMC)



### WARNING

The device conforms to the most stringent requirements of the relevant standards and regulations.

However, the possibility of causing interference in other devices cannot be totally excluded.

### FCC statement (applicable in U.S.)

This equipment has been tested and found to comply with the limits for a Class B digital device, pursuant to part 15 of the FCC Rules. These limits are designed to provide reasonable protection against harmful interference in a residential installation. This equipment generates, uses and can radiate radio frequency energy and, if not installed and used in accordance with the instructions, may cause harmful interference to radio communications.

However, there is no guarantee that interference will not occur in a particular installation. If this equipment does cause harmful interference to radio or television reception, which can be determined by turning the equipment off and on, the user is encouraged to try to correct the interference by one or more of the following measures:

- Reorient or relocate the receiving antenna.
- Increase the separation between the equipment and receiver.
- Connect the equipment into an outlet on a circuit different from that to which the receiver is connected.
- Consult the dealer or an experienced radio/TV technician for help.

This device complies with part 15 of the FCC Rules. Operation is subject to the following two conditions:

- This device may not cause harmful interference, and
- this device must accept any interference received, including interference that may cause undesired operation.

This device complies with Industry Canada license-exempt RSS standard(s). Operation is subject to the following two conditions:

- This device may not cause interference and
- this device must accept any interference, including interference that may cause undesired operation of the device.

Cet appareil est conforme à la section 15 des règlements FCC. Son fonctionnement est soumis aux deux conditions suivantes :

- cet appareil ne doit pas causer d'interférences nuisibles, et
- cet appareil doit accepter toute autre interférence reçue, y compris les interférences pouvant entraîner un fonctionnement non désiré.

Ce dispositif est conforme à la norme RSS-210 d'Industrie Canada. L'utilisation est sujette aux deux conditions suivantes :

- ce dispositif ne doit pas être la source d'interférences nuisibles, et

- ce dispositif doit accepter toutes les interférences, y compris les interférences pouvant induire des opérations non souhaitées.

## Use of the product with Bluetooth®

### WARNING

Electromagnetic radiation can cause disturbances in other equipment, in installations (e.g. medical ones such as pacemakers or hearing aids) and in aircraft. It can also affect humans and animals.

### Precautions:

Although this product conforms to the most stringent standards and regulations, the possibility of harm to people and animals cannot totally be excluded.

- Do not use the product near petrol stations, chemical plants, in areas with a potentially explosive atmosphere and where blasting takes place.
- Do not use the product near medical equipment.
- Do not use the product in airplanes.
- Do not use the product near your body for extended periods.

## Laser classification

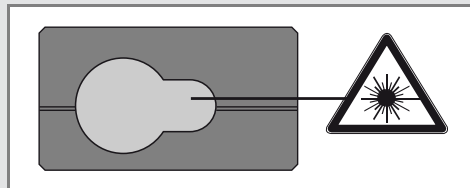

The device produces visible laser beams, which are emitted from the instrument: It is a Class 2 laser product in accordance with:

- IEC60825-1 : 2014 „Radiation safety of laser products“

### Laser Class 2 products:

Do not stare into the laser beam or direct it towards other people unnecessarily. Eye protection is normally afforded by aversion responses including the blink reflex.

### WARNING

Looking directly into the beam with optical aids (e.g. binoculars, telescopes) can be hazardous.

### CAUTION

Looking into the laser beam may be hazardous to the eyes.

Description	Value
Wavelength	620 - 690 nm
Maximum radiant output power for classification	< 1 mW
Pulse repetition frequency	320 MHz
Pulse duration	> 400 ps
Beam divergence	0.16 x 0.6 mrad

## Labelling

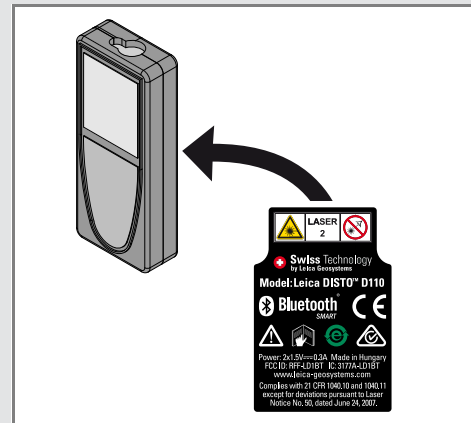

Subject to change (drawings, descriptions and technical data) without prior notice.

Leica Geosystems AG, Heerbrugg, Switzerland has been certified as being equipped with a quality system which meets the International Standards of Quality Management and Quality Systems (ISO standard 9001) and Environmental Management Systems (ISO standard 14001).

Total Quality Management - Our commitment to total customer satisfaction. Ask your local Leica Geosystems agent for more information about our TQM program.

Copyright Leica Geosystems AG, Heerbrugg,  
Switzerland 2015  
Original text (812794c EN)

Pat. No.: WO 9427164, WO 9818019, WO 0244754, WO 0216964,  
US 5949531, EP 1195617, US 7030969, WO 03104748,  
EP2589980

Leica Geosystems AG  
CH-9435 Heerbrugg  
(Switzerland)  
[www.disto.com](http://www.disto.com)

- when it has to be **right**

**Leica**  
Geosystems

# Leica DISTO™ with Bluetooth Smart usage on Android 4.3 or higher



V 1.0

December 2013

- when it has to be **right**

*Leica*  
*Geosystems*



# Content

- Leica DISTO™ devices
- Bluetooth compatibility
- Leica DISTO™ Bluetooth Smart
- Leica DISTO™ sketch for Android

# The Leica DISTO™ devices with Bluetooth®



Leica DISTO™ D3a BT (D330i)  
Bluetooth® 2.1

→ Requires **SPP** support



Leica DISTO™ D8  
Bluetooth® 2.1

→ Requires **SPP** support



Leica DISTO™ D510  
Bluetooth® Smart

→ Requires **Bluetooth® 4.0**





Leica DISTO™ D810 touch  
Bluetooth® Smart

→ Requires **Bluetooth® 4.0**



- when it has to be **right** 

# Overview DISTO™ compatibility

	Availability	Windows 7 	Windows 8 	Windows Mobile 6.5	Android 	iOS 
Leica DISTO™ sketch *)		-	-	-	-	
Leica DISTO™ sketch *)		-	-	-		-
Leica DISTO™ transfer **)		-	-	-		-
Leica DISTO™ transfer PPC ***)	<a href="http://www.disto.com">www.disto.com</a> 	-	-		-	-
Leica DISTO™ transfer PC ***)	<a href="http://www.disto.com">www.disto.com</a> 			-	-	-
Keyboard Mode ***)	No installation required	-		-	-	

\*) Draw sketches and export these as pdf file or the measurements via csv file

\*\*\*) Integrated Excel application to send values to a spread sheet. Also measurements are transferred into the clipboard to be pasted at any position in an application

\*\*\*\*) DISTO™ connects as a keyboard and sends data right to cursor position in any application or software

\*\*\*\*\*) In development, planned for January 2014

# Prolog

This presentation should provide further advice on how to use the Leica DISTO™ with Bluetooth® Smart. Also the corresponding Apps for Android are described in this document.

# Leica DISTO™ Bluetooth Smart



Getting started

- when it has to be **right** *Leica*  
*Geosystems*

# General

## Bluetooth® Smart

- Bluetooth® Smart is compatible with Bluetooth® 4.0 or Bluetooth® Smart Ready devices
- Bluetooth® Smart has very low power consumption why it is by default switched on

# Leica DISTO™ D510 Bluetooth® Smart

- The Bluetooth® can be switched off in the Settings of the Leica DISTO™ D510
- The Leica DISTO™ D510 only supports the connection to iOS or Android 4.3 Apps



Press '=' to switch on or off

# Leica DISTO™ D810 touch Bluetooth® Smart

- The Bluetooth® can be switched off in the Settings of the Leica DISTO™ D810 touch





# Leica DISTO™ D810 touch Bluetooth® Smart

- The Leica DISTO™ D810 touch provides 3 different modes for use with Bluetooth®

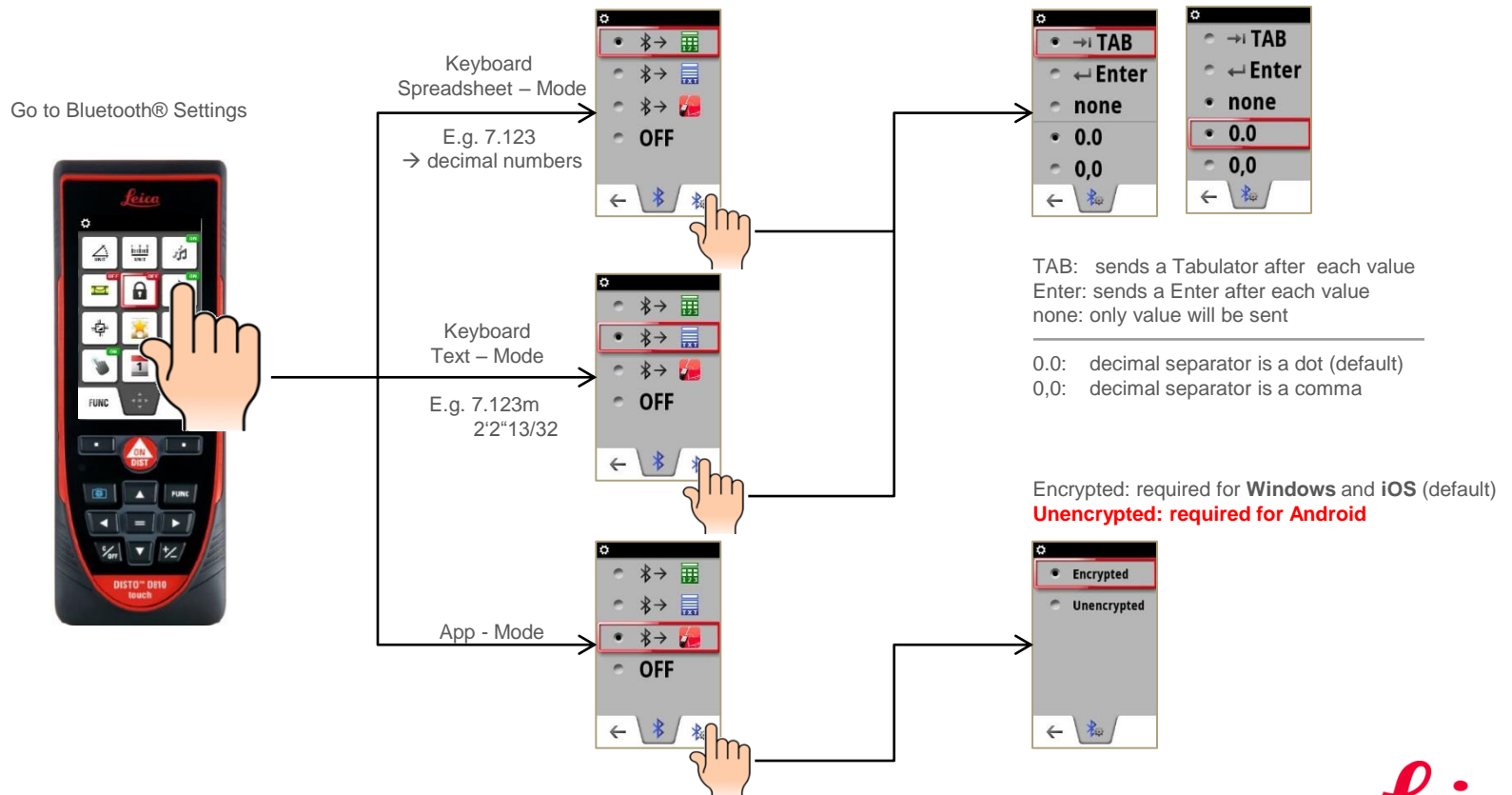

- when it has to be **right**



# Leica DISTO™ sketch

Android 4.3 or higher 

Getting started

- when it has to be **right**

*Leica*  
*Geosystems*

# Leica DISTO™ sketch for Android 4.3 or higher

## Start App

- When using with Leica DISTO™ D810 touch we are recommending to use the App mode for Bluetooth®
- When using with Leica DISTO™ D810 touch it is required to set the Leica DISTO™ device Bluetooth® to unencrypted mode first. Otherwise the device will connect but it will not transfer measurement values!  
This is not required for the Leica DISTO™ D510.



- when it has to be **right**

**Leica**  
Geosystems



Please  
Note

This App works with Leica DISTO™ D3a BT (D330i), D8, D510 and D810 touch



# Leica DISTO™ sketch for Android 4.3 or higher

## Start App – Connect Bluetooth®

Press if you want to start Scan for devices again

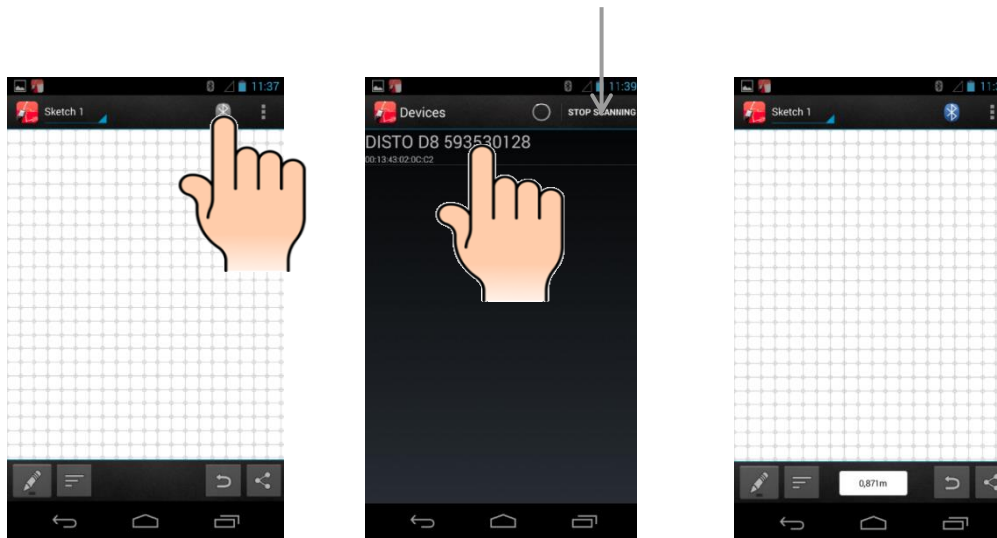

# Leica DISTO™ sketch for Android 4.3 or higher

## Sketch layout Overview

Add new sketch or photograph → Sketch 1

Connect/disconnect Bluetooth® →

Start Menu for Tutorial, Reset App →

Tutorial

Reset App

Acknowledgement

Draw new line →

Value from DISTO™ → 0,871m

Undo →

Export file to library, csv for table and pdf for sketch →

CSV

PDF

Show list of results (table) →

Name	Length	Inclin.	Description
Line 1	0,585m		
Line 2	2,898m		
Line 3	3,568m		
Line 4	0,232m		
Line 5	2,394m		
Line 6	5,009m		
Line 7	40,377m²		
Volume 8	109,405m³		

- when it has to be **right**

# Leica DISTO™ sketch for Android 4.3 or higher

## Create new sketch

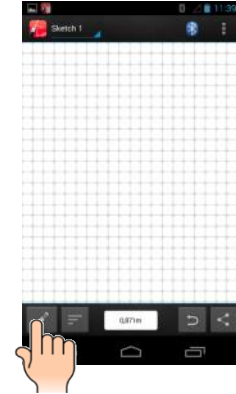
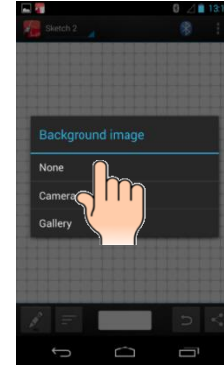
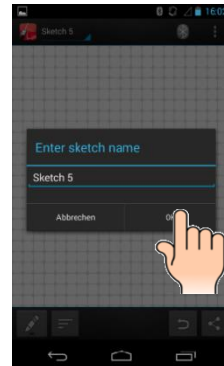
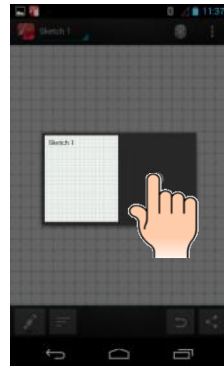
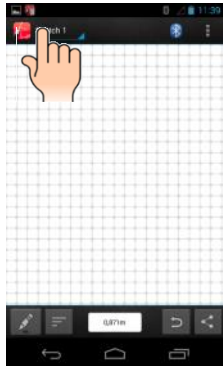

Enter new name if required

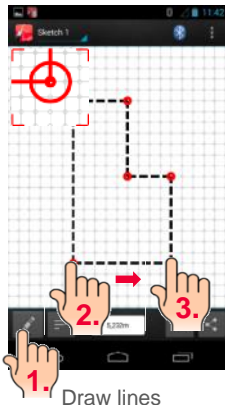

1. Draw lines

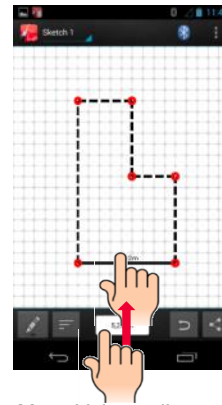

Move Value to line

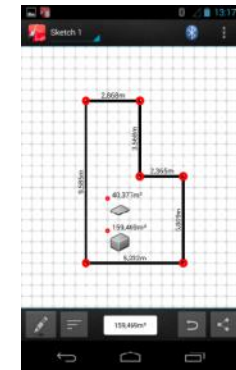
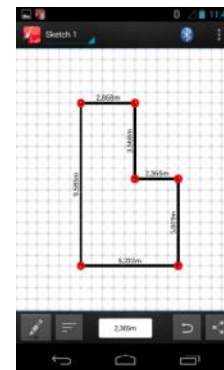

Transfer area, volume or a slope

Please Note

Auto-scale not available for this App version

- when it has to be **right** 

# Leica DISTO™ sketch for Android 4.3 or higher

## Changing sketch name or deleting sketch

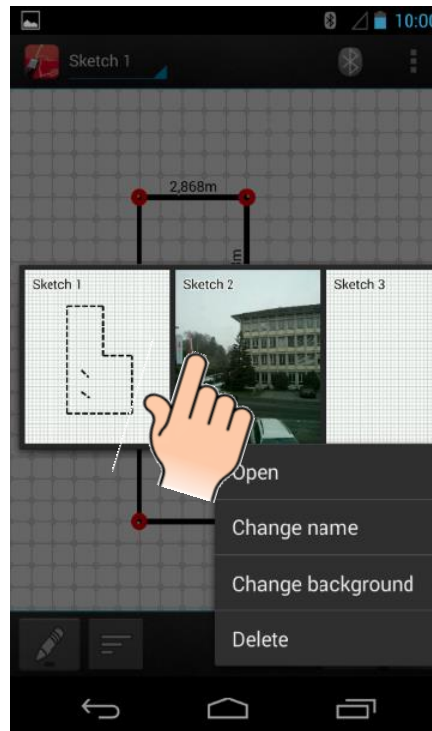



# Leica DISTO™ sketch for Android 4.3 or higher

## Create new sketch with photo

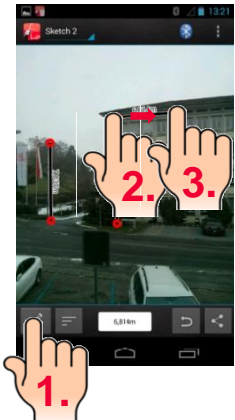
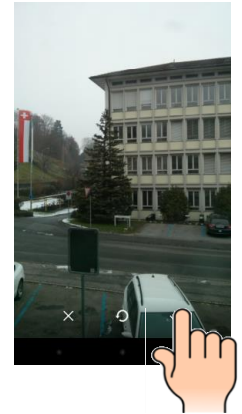
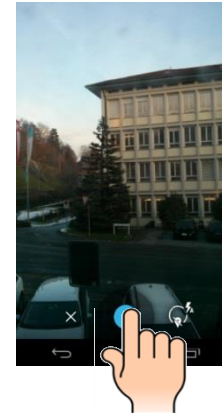
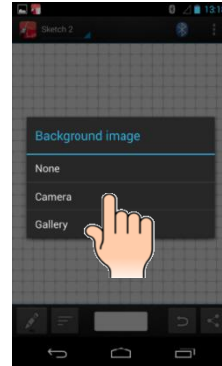
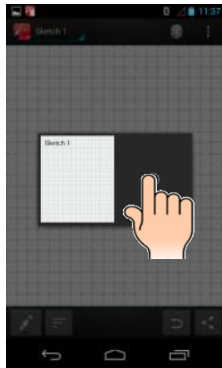
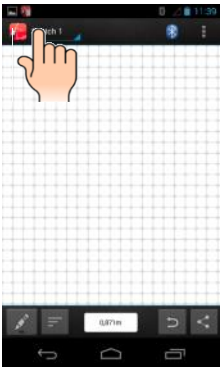

# Leica DISTO™ sketch for Android 4.3 or higher

## Good to know

- The Leica DISTO™ D510 or D810 touch only sends the currently measured value. To send a result from the main line of the DISTO™ press the „=,“ key
- To send a value using a D3a BT or D8 with Bluetooth® 2.1 you need to press the Bluetooth® key
- If you like to transfer distance measurement values including the inclination you need to switch on the Level option in the Setting of your Leica DISTO™ device.



Leica DISTO™ D3a BT (D330i)



Leica DISTO™ D8



Leica DISTO™ D510 or D810 touch

# Leica DISTO™ with Bluetooth Smart usage on Windows 8

V 1.0

December 2013

- when it has to be **right** 

# The Leica DISTO™ devices with Bluetooth®



Leica DISTO™ D3a BT (D330i)  
Bluetooth® 2.1

→ Requires **SPP** support



Leica DISTO™ D8  
Bluetooth® 2.1

→ Requires **SPP** support



Leica DISTO™ D510  
Bluetooth® Smart

→ Requires **Bluetooth® 4.0**



Leica DISTO™ D810 touch  
Bluetooth® Smart

→ Requires **Bluetooth® 4.0**



# Overview DISTO™ compatibility

	Availability	Windows 7 	Windows 8 	Windows Mobile 6.5	Android 	iOS 
Leica DISTO™ sketch *)		-	-	-	-	
Leica DISTO™ sketch *)		-	-	-		-
Leica DISTO™ transfer **)		-	-	-		-
Leica DISTO™ transfer PPC ***)	<a href="http://www.disto.com">www.disto.com</a> 	-	-		-	-
Leica DISTO™ transfer PC ***)	<a href="http://www.disto.com">www.disto.com</a> 			-	-	-
Keyboard Mode ***)	No installation required	-		-	-	

\*) Draw sketches and export these as pdf file or the measurements via csv file

\*\*\*) Integrated Excel application to send values to a spread sheet. Also measurements are transferred into the clipboard to be pasted at any position in an application

\*\*\*\*) DISTO™ connects as a keyboard and sends data right to cursor position in any application or software

\*\*\*\*\*) In development, planned for January 2014

# Prolog

This presentation should provide further advice on how to use the Leica DISTO™ with Bluetooth® Smart. Also the corresponding Apps for iOS and Android are described in this document.

For further information regarding using **Bluetooth® 2.1** please use the document at following link:

**[http://ptd.leica-geosystems.com/en/Leica-DISTO-D8\\_78069.htm](http://ptd.leica-geosystems.com/en/Leica-DISTO-D8_78069.htm)**

→ *Leica DISTO™ transfer - How to connect*

# Leica DISTO™ Bluetooth Smart



Getting started

- when it has to be **right** *Leica*  
*Geosystems*

# General

## Bluetooth® Smart

- Bluetooth® Smart is compatible with Bluetooth® 4.0 or Bluetooth® Smart Ready devices
- Bluetooth® Smart has very low power consumption why it is by default switched on



# Leica DISTO™ D510 Bluetooth® Smart

- The Bluetooth® can be switched off in the Settings of the Leica DISTO™ D510
- The Leica DISTO™ D510 only supports the connection to iOS or Android 4.3 Apps



Press '=' to switch on or off

# Leica DISTO™ D810 touch Bluetooth® Smart

- The Bluetooth® can be switched off in the Settings of the Leica DISTO™ D810 touch



# Leica DISTO™ D810 touch Bluetooth® Smart

- The Leica DISTO™ D810 touch provides 3 different modes for use with Bluetooth®

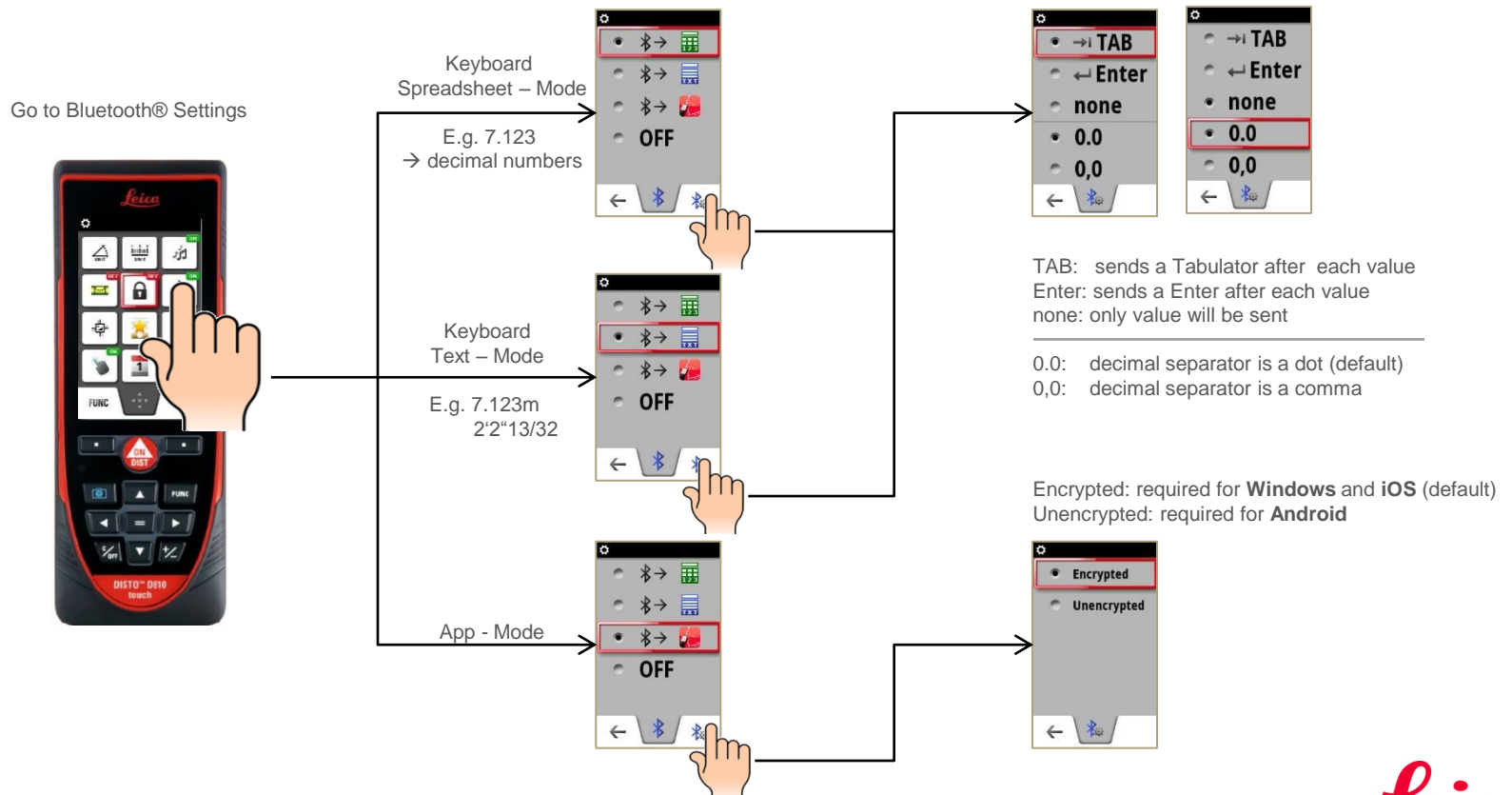

- when it has to be **right**

# Keyboard Mode

Windows 8 or higher 

Getting started

- when it has to be **right** 

# Keyboard Mode for Windows 8

## How to start

- This mode is only supported by the **Leica DISTO™ D810 touch**
- Please use the Bluetooth® manager to pair the devices. Once the Windows 8 device and the Leica DISTO™ are paired they will immediately connect if both are switched on.
- The Leica DISTO™ will be considered as a keyboard. So by sending a measurement the Windows 8 device believes you are writing the value on a keyboard.

# Keyboard Mode for Windows 8

## How to start

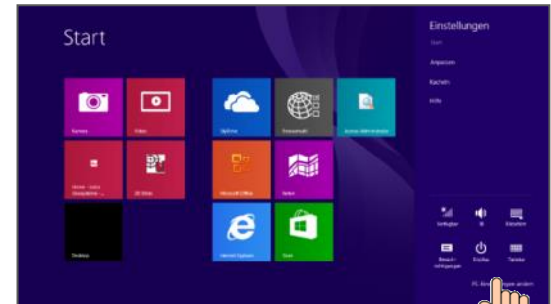

Select „Change PC Settings“

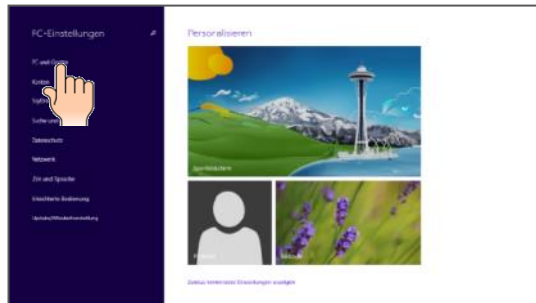

Select „Devices“

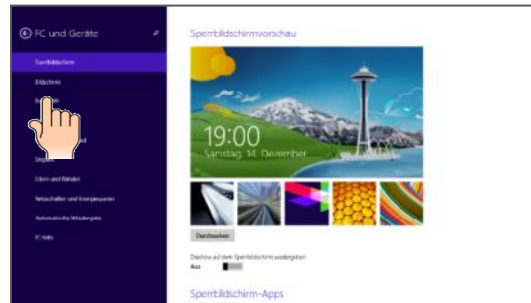

Select „Bluetooth“

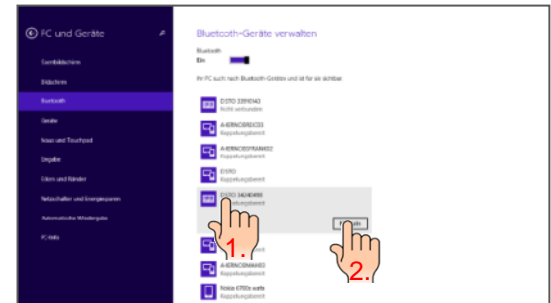

Click on device and select „Pair“

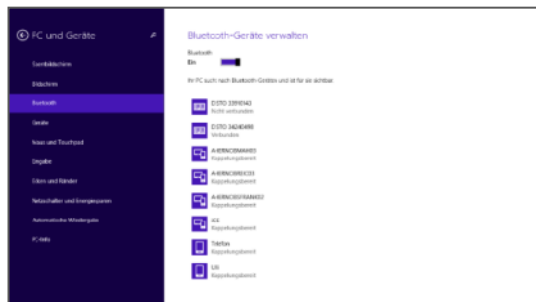

12 Instrument should be listed as paired device

# Keyboard Mode for Windows 8

## How to start

- You need to either set the DISTO™ D810 touch to following modes (see also page 9 of this presentation)
  - Spreadsheet mode:  
Use for sending decimal values without unit for further calculation
  - Text mode:  
Use for sending values an on the device display incl. unit for documentation



# Keyboard Mode for Windows 8

## How to send data and navigate in a Program

- After the devices are connected the favorite keys will change for sending measurement values or navigation

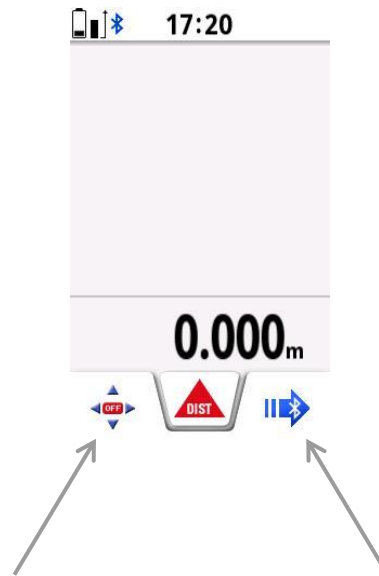

If switched on the Arrow keys on the DISTO™ can be used for navigation on e.g. Excel

Sends the actual value in the main-line of the DISTO™ to the current cursor position of any App



# Keyboard Mod for Windows 8

## Good to know

- If you want to unpair device to prevent automatic detection either switch off Bluetooth® at DISTO™ or press „Remove device“ in the settings of the Windows 8 device.  
To Remove a device in Windows 8 proceed to the same menu like for adding a device.

Please  
Note

**When a Leica DISTO™ D810 touch is already paired with one iOS or Windows 8 device it cannot be paired with a second device at the same time, it needs to be unpaired first!**

# Leica DISTO™ with Bluetooth Smart usage on iOS

V 1.0

December 2013

- when it has to be **right**

*Leica*  
**Geosystems**

# Content

- Leica DISTO™ devices
- Bluetooth compatibility
- Leica DISTO™ Bluetooth Smart
- Leica DISTO™ sketch for iOS
- Keyboard Mode iOS

# The Leica DISTO™ devices with Bluetooth®



Leica DISTO™ D3a BT (D330i)  
Bluetooth® 2.1

→ Requires **SPP** support



Leica DISTO™ D8  
Bluetooth® 2.1

→ Requires **SPP** support



Leica DISTO™ D510  
Bluetooth® Smart

→ Requires **Bluetooth® 4.0**



















Leica DISTO™ D810 touch  
Bluetooth® Smart

→ Requires **Bluetooth® 4.0**



- when it has to be **right** 

# Overview DISTO™ compatibility

	Availability	Windows 7 	Windows 8 	Windows Mobile 6.5	Android 	iOS 
Leica DISTO™ sketch *)		-	-	-	-	
Leica DISTO™ sketch *)		-	-	-	 Android 4.3	-
Leica DISTO™ transfer **)		-	-	-	 Android 4.3 ****)	-
Leica DISTO™ transfer PPC ***)	<a href="http://www.disto.com">www.disto.com</a> 	-	-		-	-
Leica DISTO™ transfer PC ***)	<a href="http://www.disto.com">www.disto.com</a> 		 Windows 8.1 ****)	-	-	-
Keyboard Mode ***)	No installation required	-		-	-	

\*) Draw sketches and export these as pdf file or the measurements via csv file

\*\*\*) Integrated Excel application to send values to a spread sheet. Also measurements are transferred into the clipboard to be pasted at any position in an application

\*\*\*\*) DISTO™ connects as a keyboard and sends data right to cursor position in any application or software

\*\*\*\*\*) In development, planned for January 2014

# Prolog

This presentation should provide further advice on how to use the Leica DISTO™ with Bluetooth® Smart. Also the corresponding Apps for iOS are described in this document.

# Leica DISTO™ Bluetooth Smart



Getting started

- when it has to be **right** *Leica*  
*Geosystems*

# General

## Bluetooth® Smart

- Bluetooth® Smart is compatible with Bluetooth® 4.0 or Bluetooth® Smart Ready devices
- Bluetooth® Smart has very low power consumption why it is by default switched on



# Leica DISTO™ D510 Bluetooth® Smart

- The Bluetooth® can be switched off in the Settings of the Leica DISTO™ D510
- The Leica DISTO™ D510 only supports the connection to iOS or Android 4.3 Apps



Press '=' to switch on or off

# Leica DISTO™ D810 touch Bluetooth® Smart

- The Bluetooth® can be switched off in the Settings of the Leica DISTO™ D810 touch



# Leica DISTO™ D810 touch Bluetooth® Smart

- The Leica DISTO™ D810 touch provides 3 different modes for use with Bluetooth®

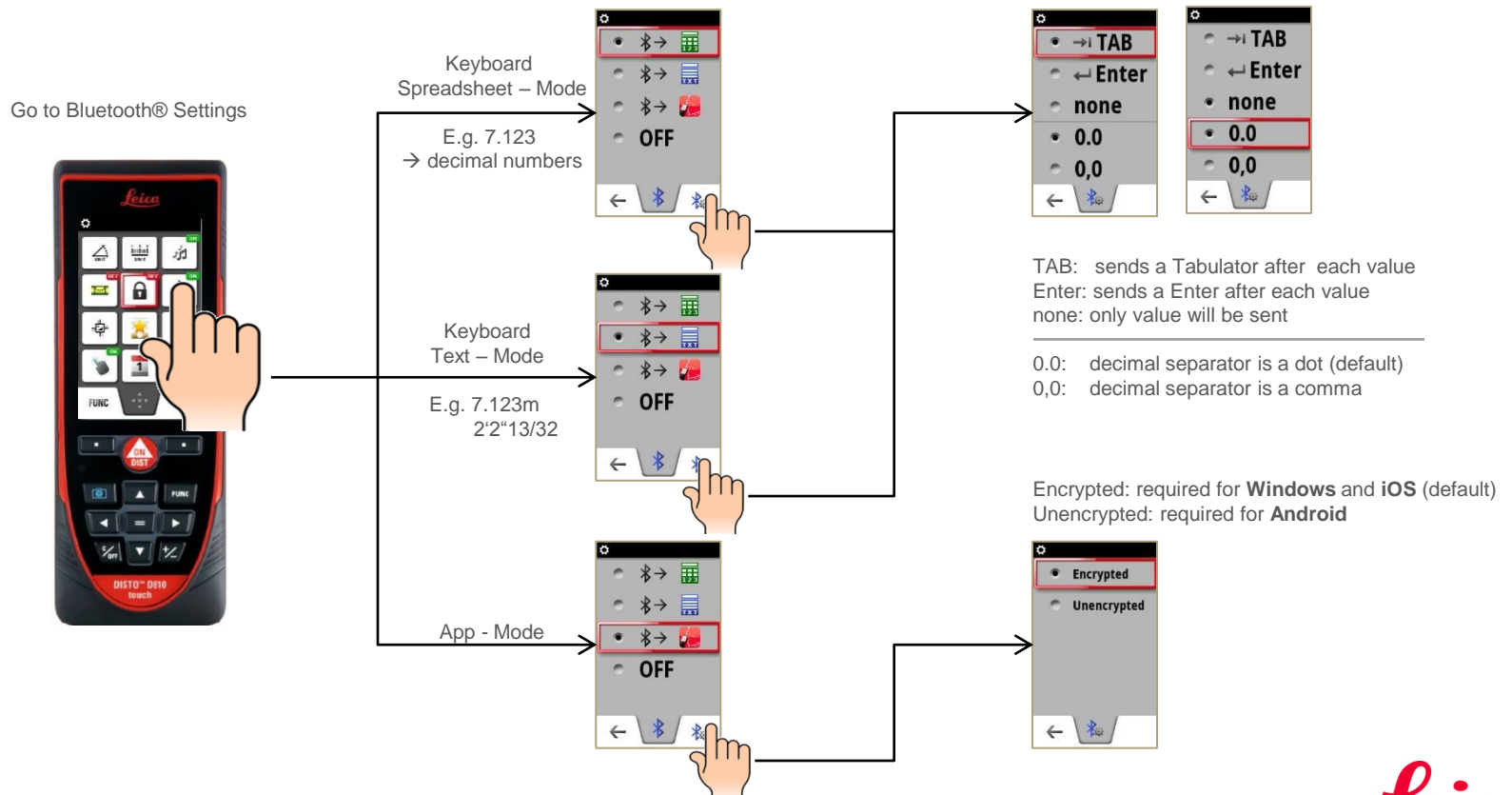

- when it has to be **right**



# Leica DISTO™ sketch

## iOS

### Getting started

- when it has to be **right**

*Leica*  
*Geosystems*

# Leica DISTO™ sketch for iOS

## Start App

- When using with Leica DISTO™ D810 touch we are recommending to use the App mode for Bluetooth®



Tutorial

- when it has to be right

**Leica**  
Geosystems



This App only works with Leica DISTO™ D510 and D810 touch

# Leica DISTO™ sketch for iOS

## Start App – Connect Bluetooth®

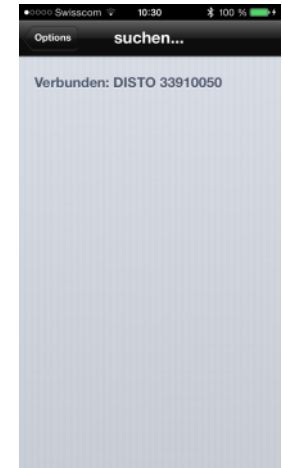
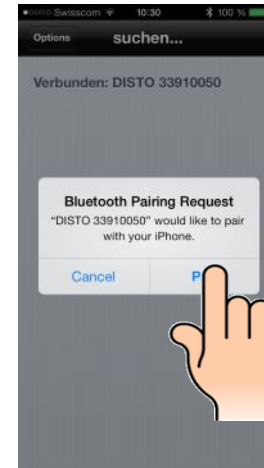
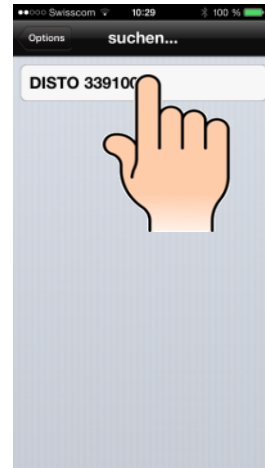
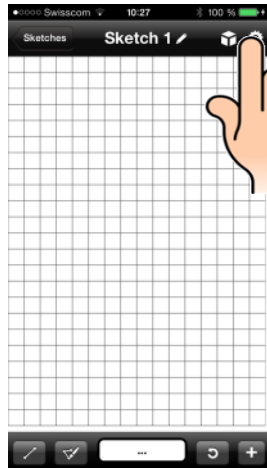
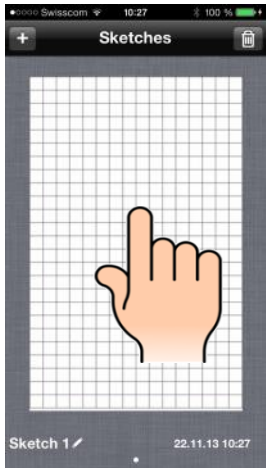

Message only appears for  
Leica DISTO™ D810 touch

# Leica DISTO™ sketch for iOS

## Sketch layout Overview

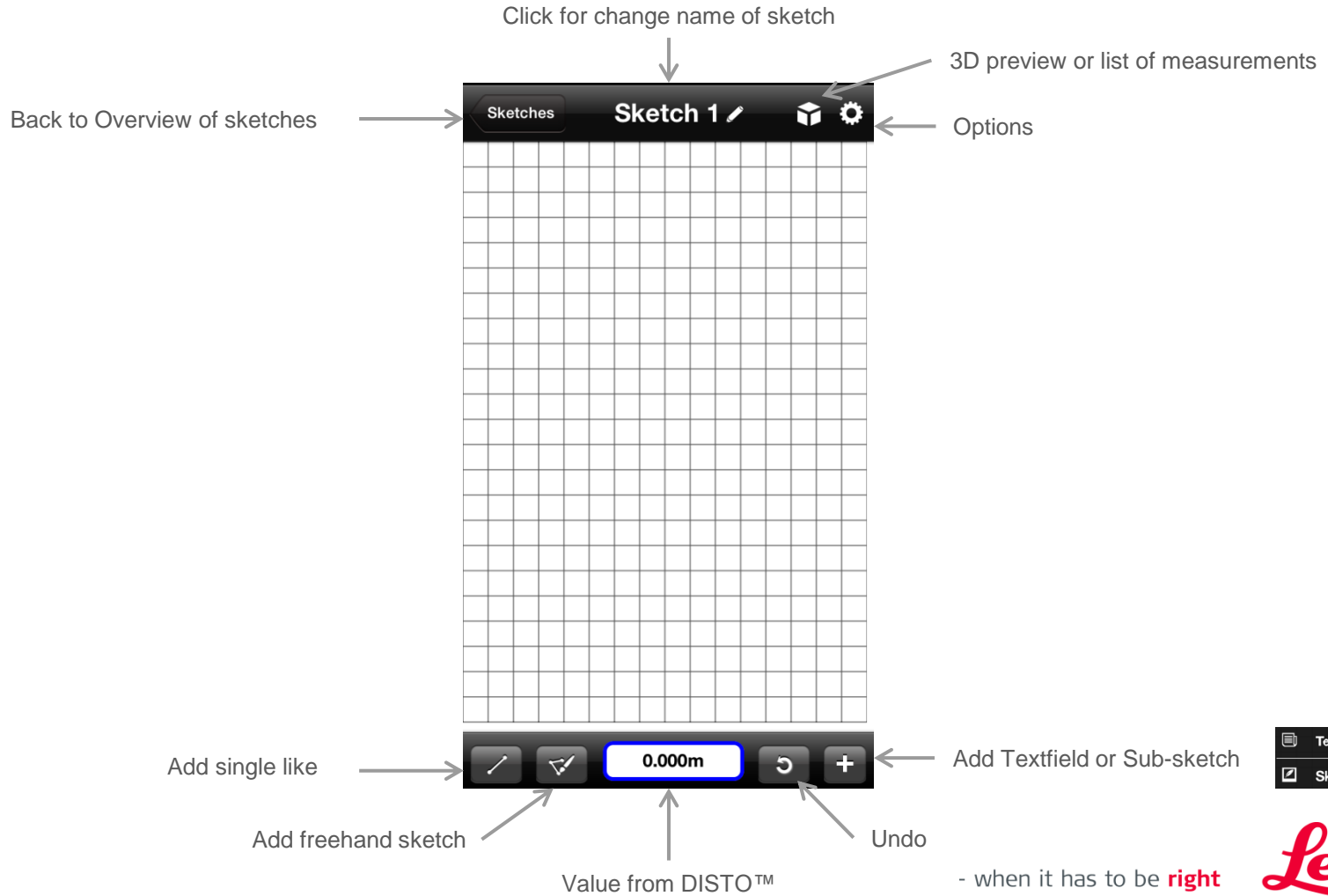

# Leica DISTO™ sketch for iOS

## Options Overview

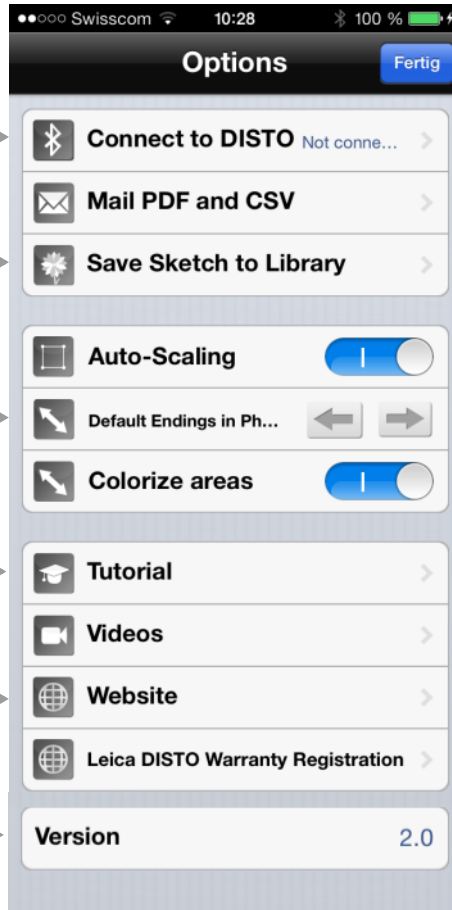
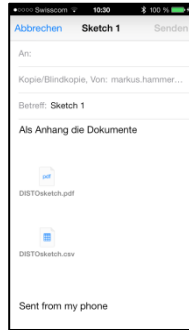

Establish Bluetooth® connection



**Connect to DISTO** Not connec... >

Save drawing or photo and file with list of measurements in photo library



**Save Sketch to Library** >

Send pdf file with drawing or photo and csv file with list of measurements via email



**Mail PDF and CSV** >

Scales drawing according measurements



**Auto-Scaling**

Set type of endings for dimension lines in photos



**Default Endings in Ph...** ← →

Enable coloring of closed areas



**Colorize areas**

Start Tutorial



**Tutorial** >

See Video on YouTube



**Videos** >

Visit Leica DISTO™ webpage



**Website** >

Go to DISTO™ registration for 3rd year warranty



**Leica DISTO Warranty Registration** >

Software version of App



**Version** 2.0

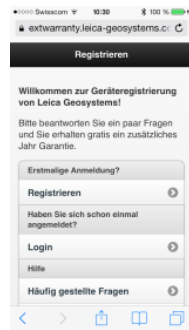

- when it has to be right





# Leica DISTO™ sketch for iOS

## Create new sketch

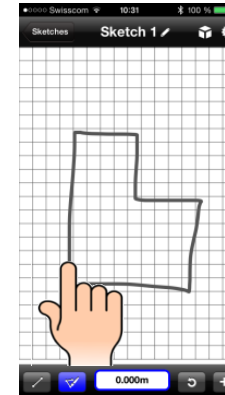
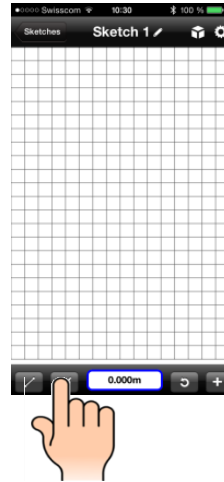
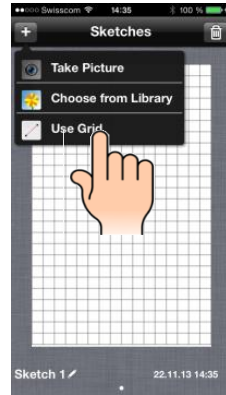
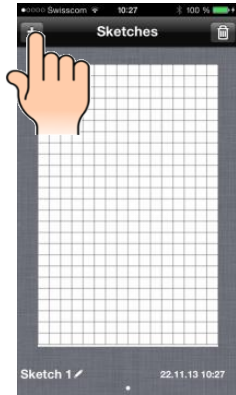

Draw freehand sketch

Magnification of point

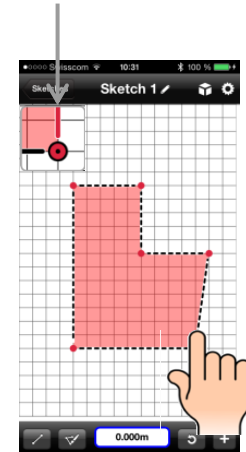

Hold finger on corner and move to rectangular shape

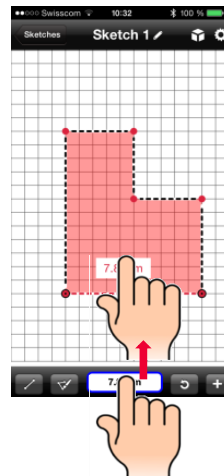
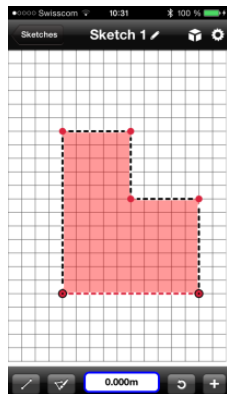

Move Value to line

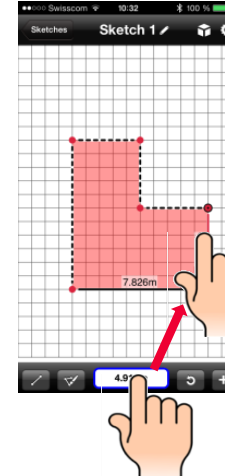

Move Value to line

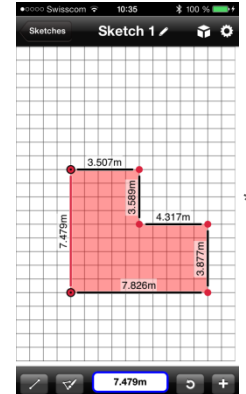

\*)

Please Note

\*) Auto-scale only works on rectangular sketches and it will not change any room angle on the sketch from 90°

# Leica DISTO™ sketch for iOS

## Create new sketch with photo

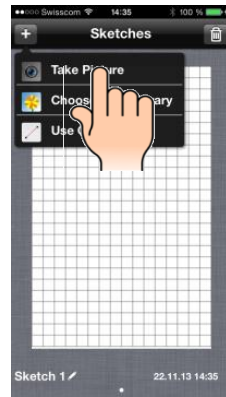
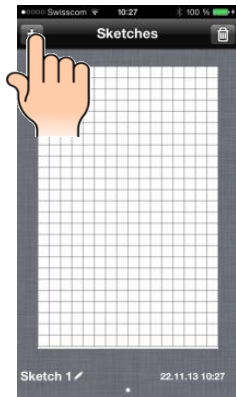

# Leica DISTO™ sketch for iOS

## Download and use of pdf-documents

Send Email with pdf document and open it on iPhone or iPad

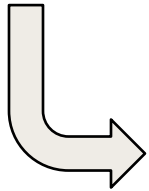

# Leica DISTO™ sketch for iOS

## Adding Sub-sketches and Text to sketches

From 2D Floorplan

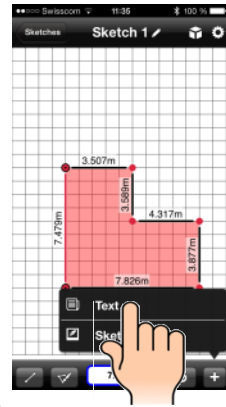
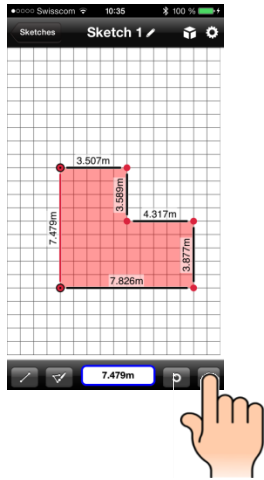

Click on pen to enter Text

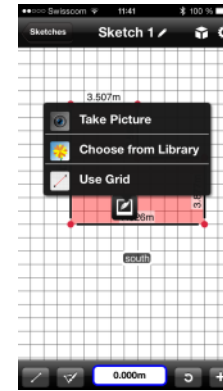
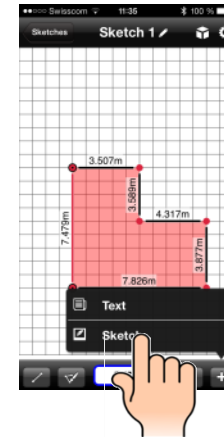
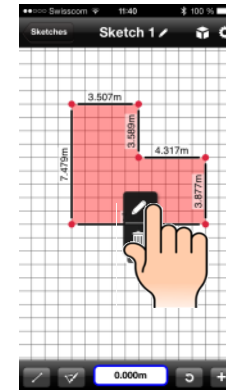

Choose picture, grid or library

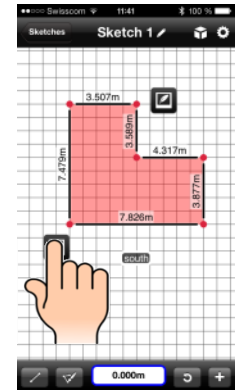

Click and hold for moving icon

From 3D Preview

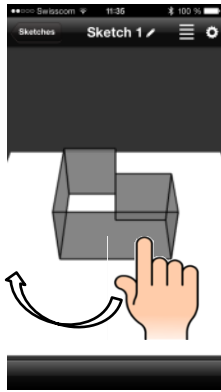

Wipe for rotating

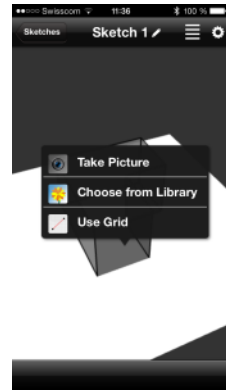

Choose picture, grid or library

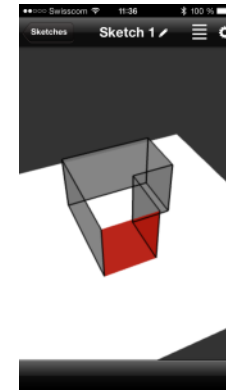

Red wall indicates sub-sketch

- when it has to be **right**



To edit a Text field or sub-sketch in 2D Floorplan click on the Icon or text and then click on the pen symbol

# Leica DISTO™ sketch for iOS

## Good to know

- If you want to unpair device to prevent automatic detection either switch off Bluetooth® at DISTO™ or press „Forget device“ in the settings of the iOS device

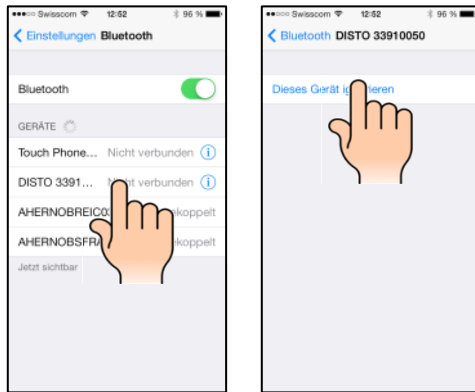

Please Note

**When a Leica DISTO™ D810 touch is already paired with one iOS device it cannot be paired with a second device at the same time, it needs to be unpaired first!**

# Leica DISTO™ sketch for iOS

## Good to know

- Auto-scale only works on rectangular sketches and it will not change any room angle on the sketch from being 90°
- The Leica DISTO™ device only sends the currently measured value. To send a result from the main line of the DISTO™ press the „=„ key
- You can also send any measurement value to the Text input field

# Leica DISTO™ sketch for iOS

## Good to know

- If you like to transfer distance measurement values including the inclination you need to switch on the Level option in the Setting of your Leica DISTO™ device.



- You can also transfer an area, volume or a slope by sending the „=„ key of your Leica DISTO™ device

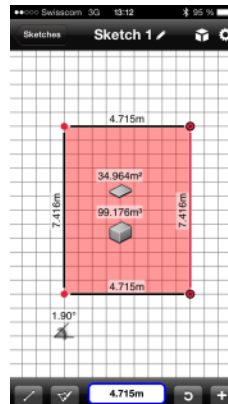

- when it has to be **right** 

# Keyboard Mode

## iOS

### Getting started

- when it has to be **right**

*Leica*  
*Geosystems*



# Keyboard Mode with iOS

## How to start

- This mode is only supported by the **Leica DISTO™ D810 touch**
- You can use either the iOS Bluetooth® manager to pair the devices or the Leica DISTO™ sketch App. Once the iOS device and the Leica DISTO™ are paired they will immediately connect if both are switched on.
- The Leica DISTO™ will be considered as a keyboard. So by sending a measurement the iOS device believes you are writing the value on a keyboard.
- You need to either set the DISTO™ D810 touch to following modes (see also page 10 of this presentation)

- Spreadsheet mode:  
Use for sending decimal values  
without unit for further calculation



- Text mode:  
Use for sending values on the device display  
incl. unit for documentation



- when it has to be **right**

# Keyboard Mode with iOS

## How to send data and navigate in a Program

- After the devices are connected the favorite keys will change for sending measurement values or navigation

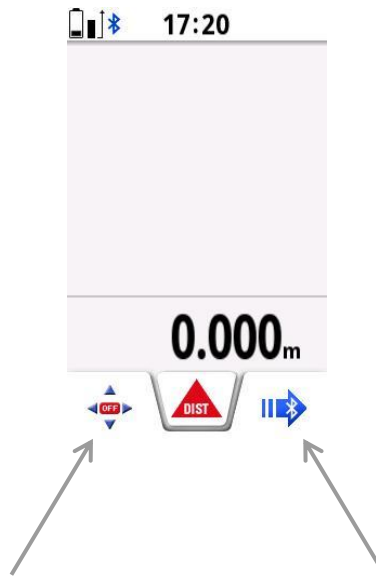

If switched on the Arrow keys on the DISTO™ can be used for navigation on e.g. Excel

Sends the actual value in the main-line of the DISTO™ to the current cursor position of any App

# Keyboard Mode with iOS

## Good to know

- If you want to unpair device to prevent automatic detection either switch off Bluetooth® at DISTO™ or press „Forget device“ in the settings of the iOS device

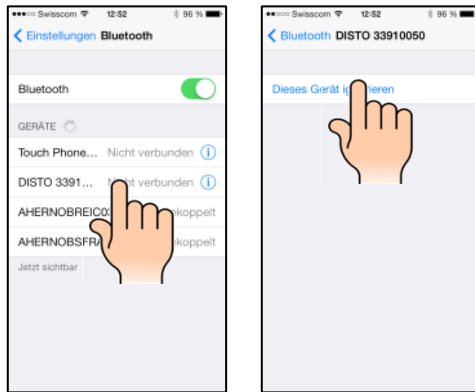

**When a Leica DISTO™ D810 touch is already paired with one iOS or Windows 8 device it cannot be paired with a second device at the same time, it needs to be unpaired first!**