

Hilka

ASSEMBLY INSTRUCTIONS FOR 3 DRAWER ROLLAWAY



Model No.	PMT-112
3 DRAWER ROLLAWAY	
Overall Size:	685 x 465 x 795 mm
Medium Drawer (x2):	584 x 380 x 74 mm
Weight Load per Medium Drawer:	30 kg
Big Drawer (x1):	584 x 380 x 153 mm
Weight Load for Big Drawer:	40 kg
Cabinet (x1):	608 x 430 x 218 mm
Weight Load per Cabinet:	50 kg
Castor (x4):	127 x 32 mm
Unit Weight:	34.80 kg
Maximum Weight Load (Total):	150 kg

Hilka

ASSEMBLY INSTRUCTIONS FOR 3 DRAWER ROLLAWAY

CAUTION

Read and follow all Safety Rules and User Instruction before first use of this product.
Retain this document for further reference.

SAFETY INSTRUCTIONS

- Do not stand on this product.
- Do not mount this product on a truck bed or any other moving object.
- Be careful when opening more than one drawer. The product could become unstable and tip.
- Close and lock all drawers before moving this product.
- Keep the product on a level surface. The product may become unstable and tip if stored or moved on an un-level surface, and may cause personal injury or product damage.
- Use the brakes when not moving the cabinet.

ASSEMBLY

1. CASTER INSTALLING (see figure ①)

Assemble the casters to the bottom using (4 ea.) bolts and spacers.
(Some models do not require spacers)

Note: Swivel casters should be mounted on the same side as the handle.

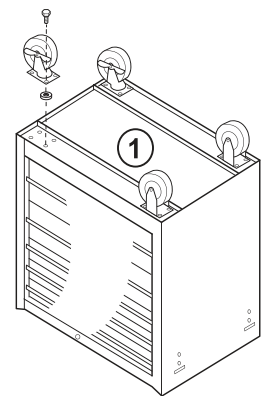

2. HANDLE INSTALLING (see figure ②)

Insert the side handle into the cabinet and attach with (4) bolts and washers,

Note: The side handle should be mounted on the same side as the swivel casters.

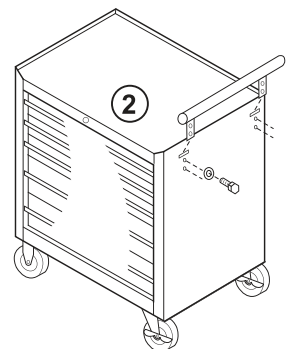

3. REMOVING AND INSTALLING DRAWERS

Drawers can be removed following these easy steps: (see figure ③)

- Press lever on left side of drawer DOWN ↓
Press lever on right side of drawer UP ↑
- With levers pressed as described in step 1, pull drawer from Tool Storage Unit.
- When replacing drawer, be sure to fully close to re-set the levers.
- The Ball Bearing Drawer Slides can be easily lubricated, if necessary, by spraying lubricant, such as white lithium grease, into openings, as indicated below.

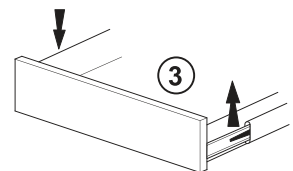

MAINTENANCE

Periodically tighten all hardware.

Periodically lubricate casters.

Lubricate the slides twice a year.

Lubricate the lock with graphite annually.

This product is guaranteed for domestic use only for a period of 12 months against faulty manufacture or materials.

Any other use may invalidate the guarantee. This product is not guaranteed for hire purposes.

This guarantee does not affect the statutory rights of the consumer.

If there is something about our product that you don't understand, or for spares, instruction manuals, FAQs and support request please check on our website at

www.hilka.co.uk/support

NOTE:

These important safeguards and instructions cannot cover all possible conditions and situations that may occur. It must be understood that common sense and caution are factors which cannot be built into any product. These factors must be applied by the person using this product

Hilka Tools UK Ltd

1, Roebuck place, Roebuck road, Chessington, Surrey. KT9 1EU