

**ATTENTION!  
REMOVE FILM PRIOR TO FITTING**

- Please note prior to fitting: Carefully remove all the packaging and film from the bath and examine the bath for damage and suitability of colour match
- Check the panel fit and match prior to installation
- Note instruction 12 before final fixing

**No Claims for the above will be accepted once the bath is fitted**

1. Remove all packaging including the polyethylene film which covers the entire bath
2. Check that colour match is acceptable and that there is no damage on the bath that may have occurred during transit. This can only be done if the film is removed completely.
3. Remove the two tubular cradle legs from the bath frame (keep the screws for instruction 5).
4. Secure the black housing "leg toggles" to the underside of the rim as shown in the diagram
5. Align the cradle over the leg toggles and screw directly into the underside of the bath using the 32mm screws from instruction 3. **YOU MUST CHECK THE SCREW LENGTH**
  - a. If the cradle stands proud of the baseboard it can be shortened using a hacksaw.
6. Once the cradles have been secured to the base of the bath secure them into the leg toggles with the self tapping screws provided
7. Secure the adjustable centre support using screws and nuts provided to the centre of the baseboard. Attach the centre foot with nuts provided
8. Secure x4 panel clips to underside of rim (x4 are for the floor).
9. Secure the Wall Brackets to the bath frame using screws provided approximately 150mm from each end.
10. With the bath in the upright position set top face level using threaded adjustment of feet and lock-nuts.
11. Bath should be set to height of panel
12. **CHECK THAT THE BATH RIM IS LEVEL**
13. Before the final fixing of the bath, fit tap and waste fittings using a suitable sealing compound. When complete place bath into position, re check levels and make any final adjustments necessary. Finally secure the feet to the floor and the wall brackets to the wall. Movement may occur if not fitted correctly.

**SHOWER BATH**

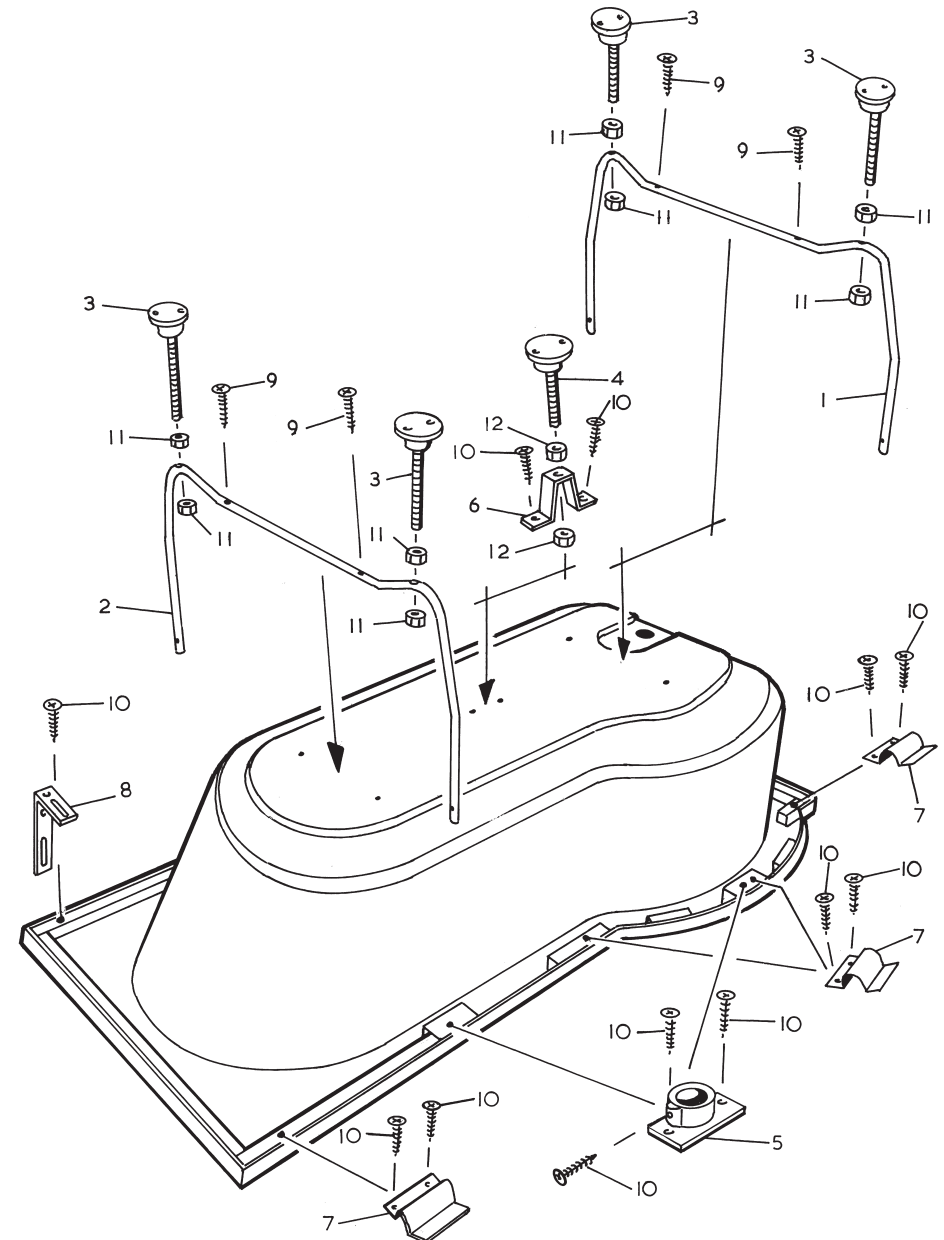

### Item Check List

Item No.	Quantity	Description	Checked
1	1	820 x 440 Front Cradle	
2	1	730 x 400 Back Cradle	
3	4	M10 x 152mm Plastic Feet	
4	1	M8 x 117mm Plastic Foot	
5	4	Black Housing "Leg Toggles"	
6	1	Centre Foot Bracket	
7	8	Panel Clips	
8	2	Wall Fixing Brackets	
9	4	Transit/Cradle Fixing Screws	
10	32	9mm self Tapping Screws	
11	8	M10 Nuts	
12	2	M8 Nuts	
13	1	Fitting Instruction	YES

### **WARNING** **INSPECT THIS PRODUCT BEFORE INSTALLATION**

THIS BATH HAS A POLYTHENE FILM THAT COVERS THE ACRYLIC SURFACE. THIS POLTHENE FILM MUST BE REMOVED **ENTIRELY** BEFORE INSTALLATION. **NO CLAIM** WILL BE ENTERTAINED FOR MATERIAL DEFECT, SCRATCHES, COLOUR VARIATION, CHIPS, BURNS OR ANY OTHER FORM OF SURFACE IMPERFECTION AFTER THE PRODUCT HAS BEEN INSTALLED

### **WARNING** **INSPECT THIS PRODUCT BEFORE INSTALLATION**

## **QUALITY ACRYLIC BATHS** **MANUFACTURED IN ENGLAND**

## **BATH FIXING INSTRUCTIONS** **for** **SHOWER BATH**

### **PLEASE NOTE**

- Before fixing any bath or panel - remove ALL protective covering and examine carefully. The polythene film must be removed in full and the bath checked for any visible damage.
- Check that colour match is acceptable to sanitaryware and panel.

Any refixing costs or claims for wrong colour match, and/or any other faults will not be accepted - **AFTER FIXING**