

SURFACE FITTINGS

IP65 15W SMD LED GOLF SURFACE FITTING



	4,000K:	R150LED-01
Comparable to 2D CFL:		38W
Rated LED Light output L₁₀₀ (lm):		1300
Light output in emergency (lm):		180
Illuminance @ 1m (lx):		410
Beam Angle (deg):		110
CRI L₁₀₀ (Ra):		80
Power Consumed (W):		15
Efficacy (lm/cctW):		87
Power Factor:		0.9
Rated LED Life (hrs):		50,000
Operating Ambient Temp (°C):		-10<Ta<+35
Dimensions Diameter/Depth mm):		330/118
Ingress Protection:		IP65
Mechanical Impact Rating:		IK09
Min/Box Qty:		1/6
Weight (Kg):		1.4
Warranty (Yrs):		5

Utilising the latest Surface Mount Diode LED technology combined with the Robus high efficiency Pro-diffuser, the LED Golf provides one of the most energy and maintenance savings solutions available. These great Golf fittings are suitable for applications in:

- Retail Shops
- Public Buildings
- Stairwells
- Sports centres
- Walkways
- Corridors
- Communal areas

FEATURES

- Provides a great combination of functionality:

- High impact polycarbonate construction (IK09 to EN62262)
- New high efficiency pro-diffuser

- Utilises high quality SMD LED's which provide:
 - High luminous flux with low lumen depreciation over life
 - Low power consumption
 - High efficacy

- Stable colour temperature of 4,000k with high CRI

- Solid state technology

- Robus 5 year guarantee

BENEFITS

- Provides integral sensor activation with fully selectable parameters where external sensors may be difficult to install
- Slave a further 9 fittings off the sensor for corridor or stairways
- Constant selectable background light for safety, peace of mind and user confidence as they are not walking into dark areas

- Strong and durable protection against vandalism with long service life
- New diffuser material:
 - Allows maximum light output
 - Provides low glare
 - Creates even light distribution without dark or hotspots
 - Aesthetically pleasing as the individual LED's are not visible

- Provides long life of 50,000 hours with zero maintenance or annoying dark areas, often the case where traditional 2D lamps have failed
- Comparable light output to replace 2D "one for one"
- Low energy, making energy savings of over 65% compared to 2D
- Provides up to 87 lumens for every watt used, complying with Part L
- All the above help to provide very low energy and maintenance costs through life with paybacks achieved in months

- Provides clear visibility and is ideal for security camera coverage

- Rugged – No heat filaments or electrodes to prematurely fail through vibration & temperature variations
- Can be switched by microwave, PIR and/or photocell
 - Creates even greater energy savings when lighting not required
 - Not detrimental to LED life as it is with CFL light sources

- No internet registration or form filling – simple, peace of mind

Example Installation Comparison

Corridor 20 metres long by 2 metres wide and 2.8 metres high. Operating 12 hours per day, 5 days per week and 52 weeks per year. Cost of electricity = 10p/kWh.

Fittings are 38W 2D and 15W LED from a branded manufacturer and the new 15W LED Golf.

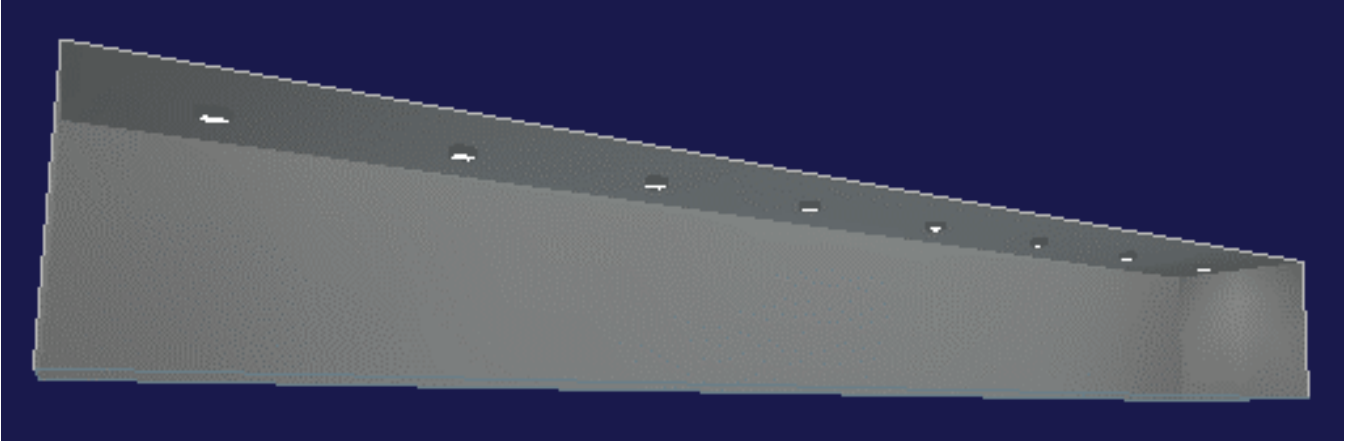

Corridor 20m x 2m x 2.8m high - target 100lx							
Fitting	Qty fittings	Av Illuminance (lx)	Total Luminous Flux (lm)	Total Power(W)	W/m ²	Efficacy (lm/W)	Running Costs £/Yr
38W 2D	8	100	8640	320	8	27	£99.84
15W LED	9	103	8550	153	3.83	56	£47.74
Golf 15W LED	8	105	10040	116.8	1.95	86	£36.44

The results from the above basic Relux scheme demonstrates the great performance and running cost savings of the Robus LED Golf, not only compared to a branded 2D fitting, but also making additional savings when compared to a major brand LED fitting.

Energy savings compared to fitting from a leading brand:

2D >63%
LED >23%

PLEASE NOTE – INFORMATION CONTAINED IN THIS DOCUMENT IS SUBJECT TO CHANGE WITHOUT PRIOR NOTICE



GOLF15W LED WITH PRO-DIFFUSER STANDARD

- High efficiency Pro-diffuser allows maximum light transmission, provides low glare, creates even light distribution – no hot spots
- High impact resistant polycarbonate Pro-diffuser is strong and durable
- Utilises high quality long life SMD technology, providing 1300 lumens using only 15W of power
- Can be switched by microwave, PIR and/or photocell
- Suitable for 24/7 use

R150LED-01	
Colour:	White
Comparable to:	32W 2D Fluorescent
Total Power (W):	15
Power Factor:	0.9
Lumens L₁₀₀ (lm):	1300
Beam Angle (deg):	110
Lux at 1m (lux):	410
CCT L₁₀₀ (K):	4000
CRI at L₁₀₀:	80
Luminaire lm/cctW:	87
Lifetime L₇₀ F₁₀ (hrs):	50000
Diameter (mm):	330
Depth (mm):	118
Box Quantity:	6
Weight (kg):	1.40
Cap Type:	



ROBUS®

QUALITY PRODUCTS BY LED GROUP

GOLF 15W LED WITH PRO-DIFFUSER STANDARD R150LED-01

PLEASE READ INSTRUCTION BEFORE COMMENCING INSTALLATION AND RETAIN FOR FUTURE REFERENCES.
! Electrical products can cause death or injury, or damage to property. If in any doubt about the installation or use of this product, consult a competent electrician

Note:

Product technical information and specification may change over time without prior notification
For the latest technical information please visit our web site www.ledgrouprobust.com or robustdirect.com

Specifications

Model No:	R150LED-01
Voltage:	220-240V ~ 50/60Hz
Power:	15W
Lumen:	1300lm
Beam Angle:	110°
CCT:	4000K
CRI:	80
Power Factor:	0.9
Operating Temp Range:	-5°C ~ +35°C
IP Rating:	65
IK:	08
Safety Classification:	Class I
Diameter:	Ø330mm
Depth:	118mm
Weight:	1.4kg
Warranty:	5 Years
Suitable for mounting on a normally flammable surface	

Installation

1. Ensure mains supply is switched off before commencing work
2. Ensure there is at least 100mm of free space around the luminaire location
3. Remove trim/ diffuser and LED plate from base of the fitting
4. Drill cable entry and mounting holes in the base
5. Mark appropriate fixing hole positions on wall, check location buried cables, pipes and other building services before drilling.
6. Feed supply cables through cable entry hole and attach base to surface
7. Connect supply cables Live, Neutral and Earth to fitting terminals
8. Refit LED plate and trim/ diffuser to base

Information for the Product user:

1. Please note the requirement to dispose of Waste Electrical & Electronic Equipment separately from household waste (WEEE marked with crossed out wheelie bin symbol).
2. Please consider your role in contributing to re-use and recycling by returning this product at end of life to a collection centre for waste electrical equipment or a Civic Amenity site, or to a retail outlet from which you are purchasing a replacement.
3. This equipment may contain substances that are hazardous to health and the environment if disposed of carelessly. It is important that it is separated from normal household waste and recycled in the WEEE chain
4. The "crossed out wheelie bin symbol" on a product indicates this equipment must not be disposed of in normal household waste, but should be disposed of according to local WEEE regulations

The Installation must be carried out by an electrician

LED Group

Western Retail Park
Nangor Road
Dublin 12
Ireland
Issue 1 220415

Tel: +353 1 7099000
Fax: +353 1 7099060
Email: info@led.ie
Website: www.led.ie



Installation diagram

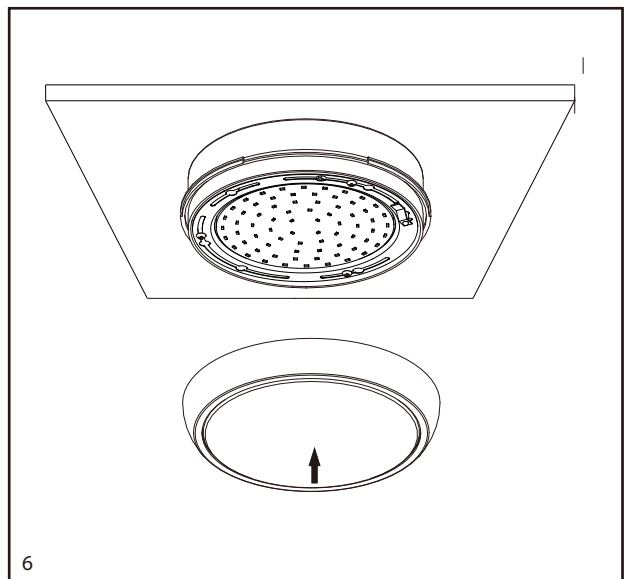
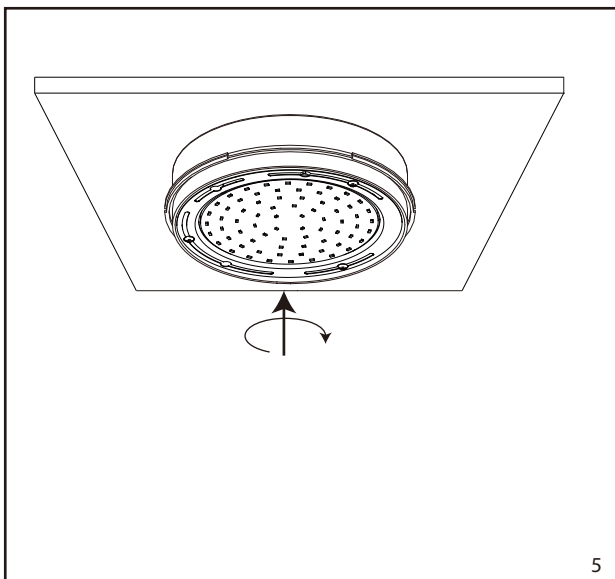
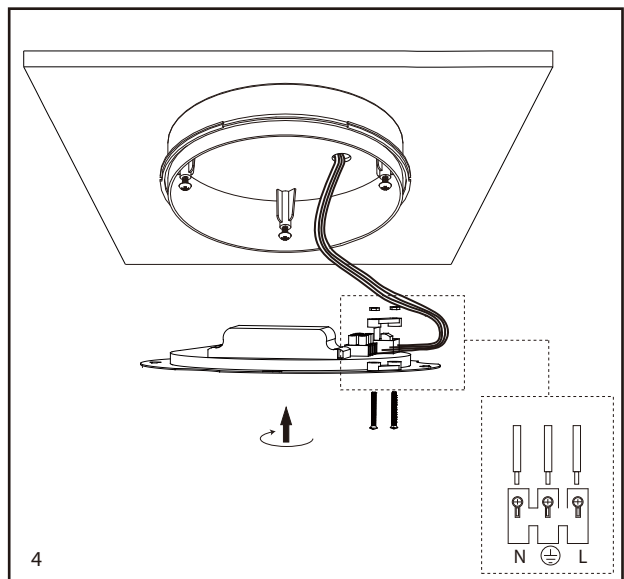
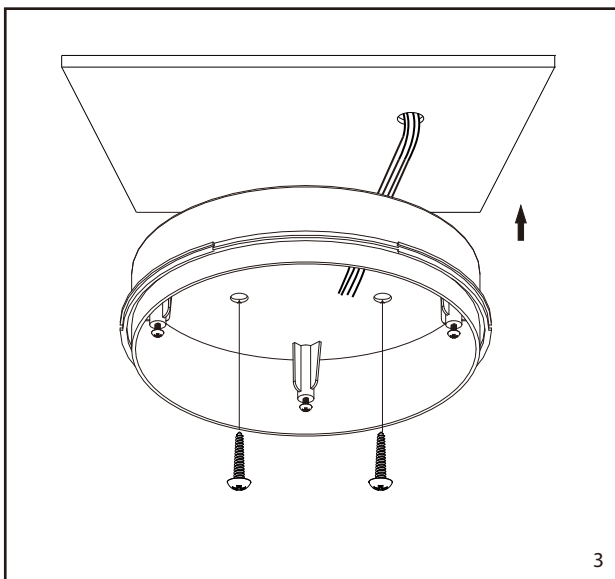
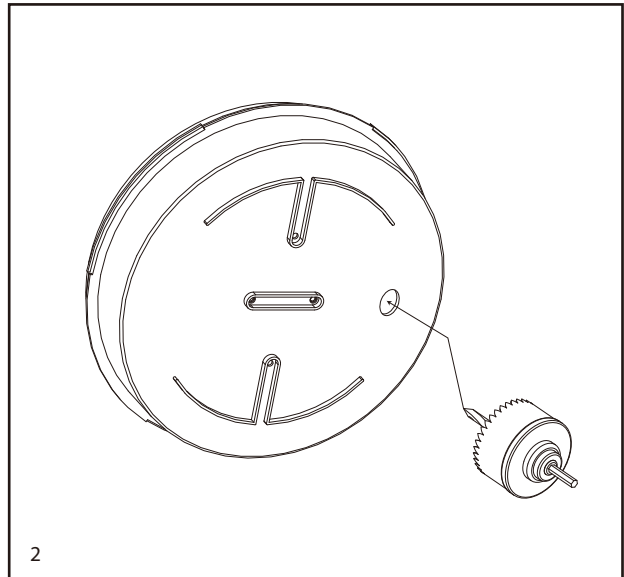
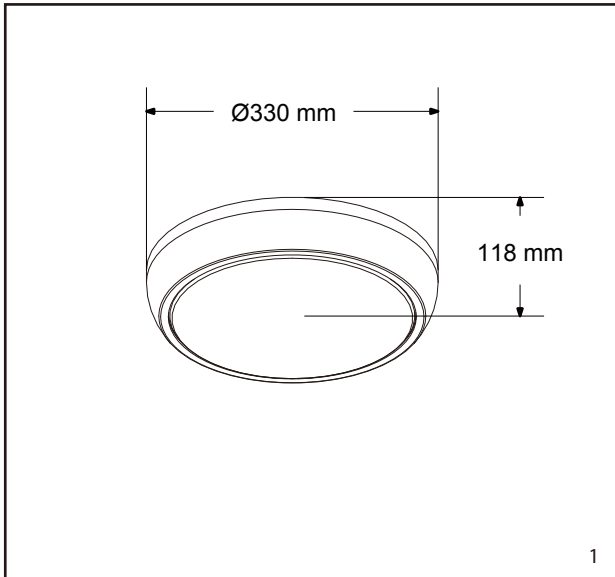

The Installation must be carried out by an electrician

LED Group
Western Retail Park
Nangor Road
Dublin 12
Ireland

Tel: +353 1 7099000
Fax: +353 1 7099060
Email: info@led.ie
Website: www.led.ie

