

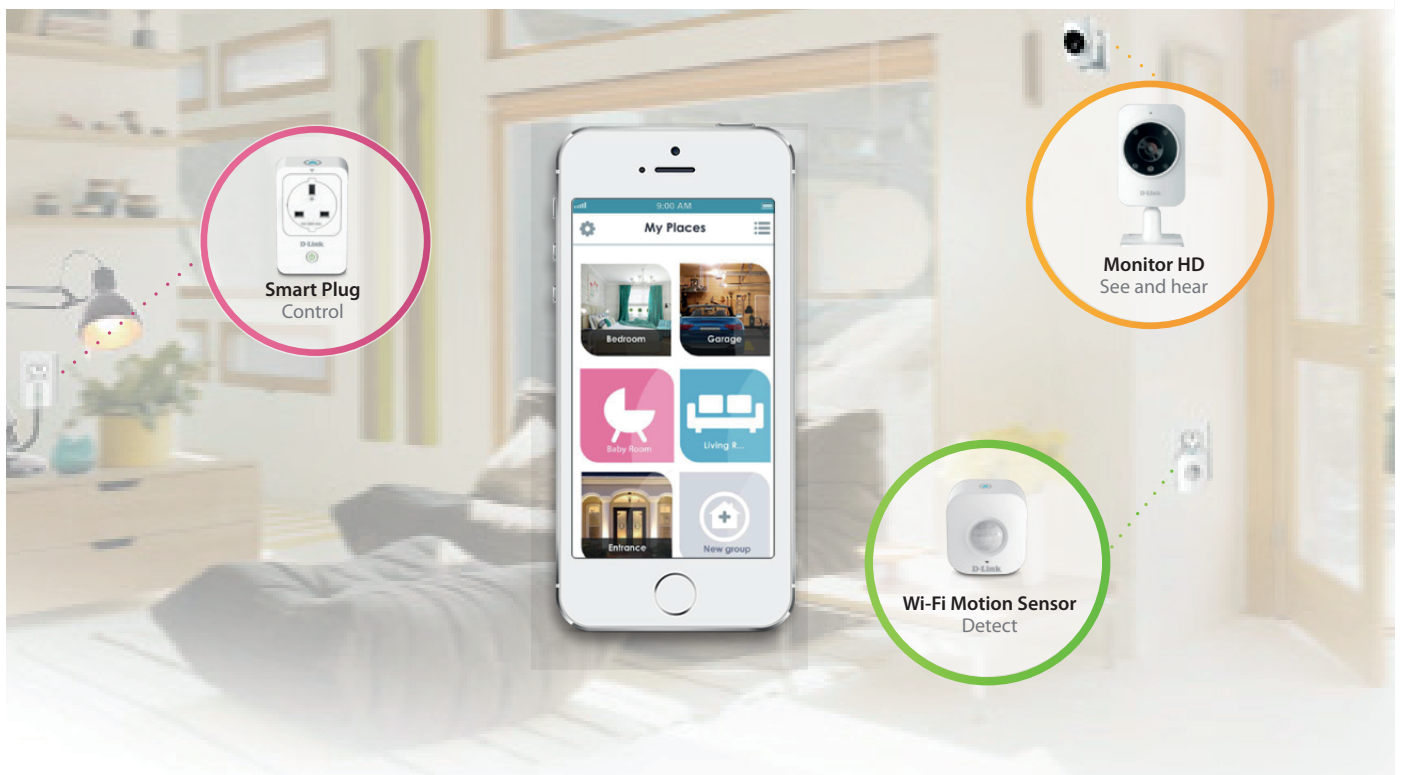

mydlink™ Home

Smart Home HD Starter Kit



Monitor and control your home
using your existing Wi-Fi

Control and Monitor Your Home



This clever little starter kit lets you set, control, monitor and automate your home from anywhere. The Smart Home HD Starter Kit includes a Smart Plug (DSP-W215), a Wi-Fi Motion Sensor (DCH-S150) and a Monitor HD (DCS-935L).

These devices talk to each other and with the mydlink Home smartphone and tablet app you can decide what it is you would like them to do. Below are some examples:



- The Wi-Fi Motion Sensor will detect motion in your home, which then triggers the Smart Plug to turn the lamp on.

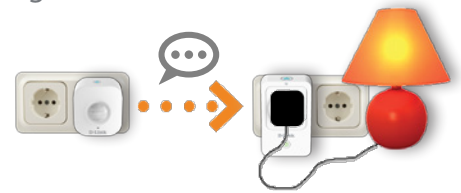

- When motion is detected, be alerted and see what's going on in your home in real-time and in HD with the Home Monitor HD.



- The Smart Plug even monitors the power usage of the electrical appliance plugged in and you can turn them on and off manually or automatically, whenever, from wherever.



This is clever stuff implemented to make your life easier and safer with added peace of mind. It is smart home technology at its most futuristic.

Easy to Setup

Simply download the mydlink Home app and the step by step setup wizard will help you set up all the devices in the kit



Download the free **mydlink Home** App.



Add all your smart devices - the app will guide you step by step.



Automate your home by setting up schedules or rules. Manage and see your home from your smartphone or tablet when you are out and about.

Your mydlink™ Home

mydlink™ Home allows you to start with this convenient starter kit and add more when you want to. The unique mydlink™ Home App¹ for iOS and Android smartphone and tablet puts you in control of all your mydlink™ Home smart devices. You can even setup automation rules to make your home smarter.



No hidden charges. Seriously.



Turn Devices On/Off

Instantly turn devices on or off from your iOS or Android smartphone or tablet using the mydlink™ Home app, wherever you are.

Create schedules

Create on/off schedules to have your appliances work for you when you want them to.

Protect your appliance

The integrated thermal sensor automatically turns off overheating power sockets, giving you peace of mind².

Stay informed

Send automatic alerts to notify you when an appliance has been turned on/off, when power consumption limit is exceeded or if the appliance malfunctions and overheats.

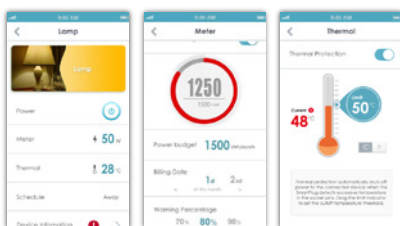

View From Anywhere

View securely over the Internet through your smartphone or tablet. Works with iOS and Android smartphone and tablet through the free mydlink™ Home App¹.



High definition

Monitor your home in HD 720p. See everything in detail, even when zoomed in.

See in the dark

Built-in night vision function allows you to see up to 5 metres even in complete darkness.

Motion and sound detection

Alerts you with push notification whenever motion or sound is detected.

Detect Motion

The passive Infrared (PIR) motion sensor greatly reduces false alarms to ensure you are alerted only when needed.

Wide coverage

Motion detection up to 8 metres (100° horizontal / 80° vertical).

Stay informed

Automatic alerts to notify you when motion is detected.

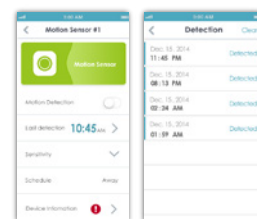

Technical Specifications

DSP-W215 Smart Plug

Device Interface	• 802.11b/g/n wireless with WPA/WPA2 encryption	• WPS button / reset button
LEDs	• Power/Status	
Functionality		
Support Functions	• Smart remote control • Push notifications • Energy usage statistics	• Power scheduling • Overheat protection
Physical		
Dimensions	• 96.5 x 62 x 76.7 mm	
Weight	• 180 g (EU)	• 173 g (UK)
Power	• Input: 100 to 240 V AC	
Maximum Load	• 16A, 250V	
Power Consumption	• Maximum 5 W	
Temperature	• Operating: 0 to 40 °C (32 to 104 °F)	• Storage: -20 to 65 °C (-4 to 149 °F)
Humidity	• Operating: 10% to 90% non-condensing	• Storage: 5% to 95% non-condensing
Certifications	• FCC	• UL

DCH-S150 Wi-Fi Motion Sensor

Device Interfaces	• 802.11b/g/n wireless with WPA/WPA2 encryption	• WPS button / reset button
LED	• Status/WPS	
PIR Sensor	• 8 metres (100° horizontal / 80° vertical) detection range	
Antennas	• One internal antenna	
Plug Type	• Region dependent	
Physical		
Dimensions	• 58 x 54 x 43.5 mm (2.28 x 2.13 x 1.71 inches)	
Weight	• 80 grams (2.82 ounces)	
Power	• Input: 220 to 240 V AC, 50/60 Hz	
Temperature	• Operating: 0 to 40 °C (32 to 104 °F)	• Storage: -20 to 65 °C (-4 to 149 °F)
Humidity	• Operating: 10% to 90% non-condensing	• Storage: 5% to 95% non-condensing
Certifications	• FCC, CE	• UL, CE/LVD

DCS-935L Monitor HD

Camera Hardware Profile	• 1/4" Megapixel progressive CMOS sensor • 5 metre IR illumination distance • Minimum illumination: 0 lux with IR LEDs on • Built-in Infrared-Cut Removable (ICR) Filter module • 4X digital zoom • Lens: Fixed length 2.38 mm • Aperture: F2.4	• Angle of view: • (H) 78.44° • (V) 47.9° • (D) 85.98° • Minimum object distance: 434 mm • Exposure Time: 1/7.5 to 1/24,000 sec. • Built-in microphone
Image Features	• Time stamp and text overlays	• Configurable motion detection windows
Video Compression	• Simultaneous H.264/MJPEG format compression	• JPEG for still images
Video Resolution	• 1280 x 720 at frame rates up to 30 fps	
Audio Compression	• AAC	• G.711
Connectivity	• 802.11b/g/n/ac wireless with WEP/WPA/WPA2 encryption	

Advanced Features

Event Management	• Motion detection	• Sound detection
------------------	--------------------	-------------------

General

Dimensions	• 58.0 x 84.5 x 124.9 mm (2.28 inches x 3.33 inches x 4.92 inches)	
Weight	• 160.0 g (5.6 ounces) ± 5%	
Power	• 5 V DC 1.2 A, 50/60 Hz	
Power Consumption	• 3.5 watts maximum	
Temperature	• Operating: 0 to 40 °C (32 to 104 °F)	• Storage: -20 to 70 °C (-4 to 158 °F)
Humidity	• Operating: 20% to 80% non-condensing	• Storage: 20% to 80% non-condensing
Certifications	• CE • CE LVD	• FCC Class B • C-Tick

¹ mydlink™ Home app is available for iPod touch, iPhone and iPad devices using iOS version 6.0 or later, and Android devices using Android version 4.0 or later.

² Thermal sensor detects temperature at the device plug electrical contacts.



For more information: www.dlink.com

D-Link European Headquarters. D-Link (Europe) Ltd., D-Link House, Abbey Road, Park Royal, London, NW10 7BX. Specifications are subject to change without notice. D-Link is a registered trademark of D-Link Corporation and its overseas subsidiaries. All other trademarks belong to their respective owners. ©2014 D-Link Corporation. All rights reserved. E&OE.

Updated January 2015

D-Link[®]
Home is where the **SMART** is