

Steel Panel Radiator Vertical Range

Installation Instructions



PLEASE READ THESE INSTRUCTIONS THOROUGHLY BEFORE STARTING INSTALLATION



Ancillary Components	
3	Blank Plug
1	Air Vent Plug
2	Wall Bracket
6	Wall Plug
6	Coach Screw
1	Air Bleed Key

DO NOT LIFT THE RADIATOR BY THE END PANELS

PLEASE CHECK THAT ALL COMPONENTS ARE PRESENT AND THAT THE PRODUCT HAS NOT SUFFERED ANY DAMAGED DURING TRANSIT

THIS PRODUCT IS MANUFACTURED FROM MILD STEEL & IT IS ONLY SUITABLE FOR INSTALLATION WITHIN A CENTRAL HEATING SYSTEMS WITH A CORROSION INHIBITOR ADDED TO THE WATER.

Installation should be carried out by a suitably qualified professional or other fully competent person & in accordance with the relevant British and European standards (BS7593:1992, EN12828:2003, EN12831:2003 & EN14336:2004) & all applicable Building Regulations.

When drilling or fixing into walls, floors or ceilings it is essential that you check for pipes & wires before commencing. Please ensure that you wear all necessary personal protective equipment.

Due to our commitment to continuous product development we reserve the right to alter specifications without notice. Products are warrantied against manufacturing defects for the first purchaser only & the warranty is non-transferable. Our liability under any guarantee expressed or implied is strictly limited to replacement of defective goods and no consequential losses of any kind will be entertained. Proof of purchase will be required for all warranty claims.

Regular cleaning with a soft cloth will keep the surface of your product looking new. Soapy water can be used to remove stubborn marks. Do not use abrasive or chemical cleaners as these will damage the surface finish over time.

AFTER INSTALLATION THE SYSTEM MUST BE THOROUGHLY FLUSHED WITH A 'DOMESTIC WATER TREATMENT ASSOCIATION' (DWTA) APPROVED CENTRAL HEATING CLEANSER. FOLLOWING CLEANSING A DWTA APPROVED CENTRAL HEATING PROTECTOR MUST BE ADDED TO THE SYSTEM. FAILURE TO CLEANSE AND PROTECT THE SYSTEM PROPERLY IS LIKELY TO REDUCE THE LIFECYCLE & INVALIDATE THE WARRANTY.



Maximum Working Pressure 1000kPa (10 Bar)
 Maximum Working Temperature 110°C
 Reaction to Fire Class A1
 Made in Turkey

Kudox Limited - 1 Bray Place - London - SW3 3LL
 Technical Support e-mail - support@kudox.com
 Technical Support Phone - 020 75899617
 FAQ & Advice - www.kudox.com

- 1.** Screw the Blank Plug and the Air Vent Plug into the top two threads & tighten firmly with a 22mm or adjustable spanner.
- 2.** Check that the wall is strong enough to hold the weight of the radiator filled with water. On plasterboard walls we strongly recommend fixing to the timbers.
- 3.** Mark the Bracket positions on the wall and then use one of the Brackets to mark the top slot positions. The bottom of the radiator should be at least 150mm above the finished floor level.
- 4.** Drill the top holes at the top of the slot markings, for the fixings you intend to use. The Wall Plugs supplied are only suitable for solid walls and you will need alternative fixings for other wall types. With the spring loaded clip at the top screw the Brackets to the wall through the top slot. Mark the bottom hole position through the Wall Bracket and then swivel the Bracket out of the way to drill the bottom holes. Screw the bottom fixings through the bottom hole in the Bracket and tighten all 4 fixings.
- 5.** The upper spring loaded clip should be pushed and locked into the “up” position. Lift the radiator into position on the bottom of the Bracket (it is strongly recommended that this be done by two people, especially with larger sizes). Once the radiator is in position, tilt the upper clip to release it from the locked position so that the clip grips the radiator as in figure B.
- 6.** Depending on which pair of threads you are connecting to the flow, screw the Blank Plugs into the other two threads which will not be used. Tighten them firmly with a 22mm spanner.
- 7.** To install the radiator valve, we would always recommend that the valve’s manufactured instructions are followed and override our instructions. As a general guide, wind a thick layer of PTFE tape, clockwise around the radiator valve tails (not supplied) & screw the radiator valve tails into the bottom two threads & tighten with a spanner. Fill the system to check for leaks and fix as necessary.
- 8.** Flush the entire system with a DWTA approved central heating cleanser and then refill using a DWTA approved central heating protector.
- 9.** Run the system up to full temperature and release any trapped air using the Air Vent Plug and the installation is complete.

This Kudox radiator has a conditional 15 year manufacturers warranty, to be free from any defect caused by faulty materials or workmanship. The surface finish of the radiator is warranted for 1 year only. To enjoy this extended manufacturers warranty you must complete the warranty registration on www.kudox.com or by sending details of your purchase to: Customer Care, Kudox Limited, 1 Bray Place, London, SW3 3LL. Full terms and conditions are available at www.kudox.com.

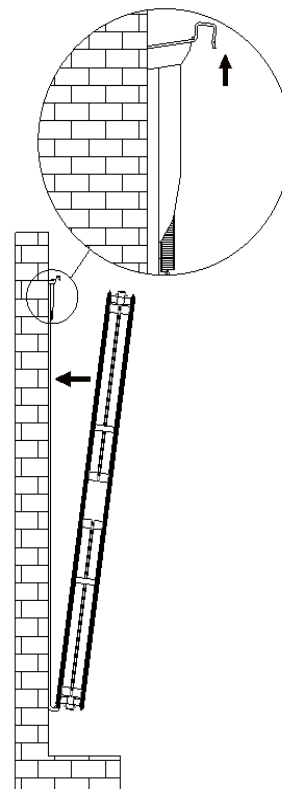

Figure A

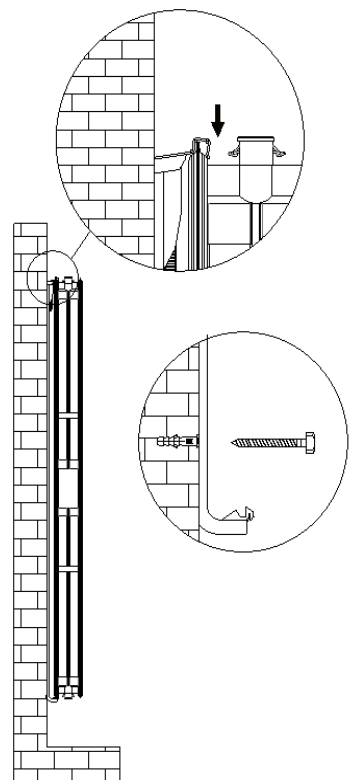

Figure B