

# **MORETTI®**

# Fitting Instructions

## Shower Kit

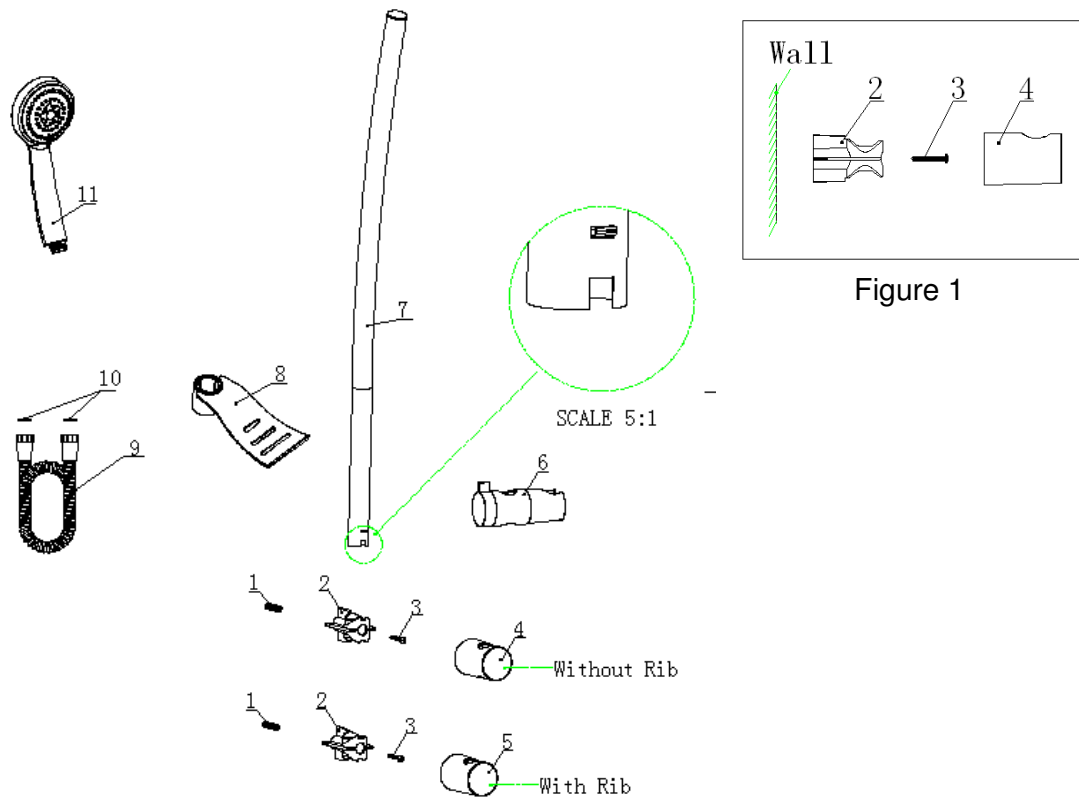

### PARTS SUPPLIED

ITEM	DESCRIPTION	QTY
1	wall plug	2
2	wall bracket holder	2
3	wall screw (Ø 4 X 30 mm)	2
4	adjustable wall bracket	1
5	stationary wall bracket	1
6	Shower Holder	1
7	sliding rail	1
8	soap dish	1
9	stainless steel hose	1
10	rubber washer	2
11	hand shower	1

### TOOLS REQUIRED

power drill
drill bit
Cross head screw driver
Pencil

## **BEFORE YOU START**

- a) Identify all components and check pack contents.
- b) The screws and wall plugs supplied are only suitable for use in solid walls.
- c) Ensure there are no hidden service pipes or cables where you intend to drill.
- d) If drilling into ceramic tiles, please use a ceramic drill bit.
- e) Please be careful of your safety while drilling.
- f) **TURN OFF WATER MAINS SUPPLY.** The mains stopcock is usually situated where the supply enters the building.
- g) It is also recommended that the water heating arrangements are turned off.
- h) Isolate the hot and cold water supply.

## **INSTALLATION**

- 1) Mark the positions of two drill holes. Suggest the distance from upper hole to lower hole is about 190 mm. Drill the wall in marked positions by using the power drill. Then insert the wall plugs (1).
- 2) Make sure the screw holes of wall bracket holders (2) and the wall plugs (1) are central. Then put the screws (3) through the wall bracket holders (2) and tighten them. (see figure 1)
- 3) Match both side notches of the adjustable wall bracket (4) with the two ribs of upper wall bracket holder (2), put the hole upwards. For the lower part, follow the same procedure.
- 4) Put the shower holder (6) and soap dish (8) onto the sliding rail (7). The larger opening of the shower holder (6) should point upward. Insert sliding rail (7) into the hole of adjustable wall bracket (4) and stationary wall bracket (5) separately.
- 5) Insert the rubber washers (10) into both ends of stainless steel hose (9). Then connect one end to hand shower (11), the other to the shower outlet.

Please Note: Both ends of adjustable wall bracket (4) are open. Stationary wall bracket (5) only one end is open.

## **AFTER CARE**

- a) To maintain the appearance of this fitting, ensure it is cleaned only using a clean soft damp cloth.
- b) A solution of warm water and mild liquid detergent may be used where necessary and then rinsed thoroughly. Abrasive cleaners or acidic cleaners **MUST NOT BE USED** under any circumstances. Avoid contact with solvents.
- c) Do not lay the hand shower into dirty water.
- d) Please use non-return valves on your shower system.
- e) Please retain these instructions for future reference.