

ASV73 Four-wire Colour Video Entry System



ASV73 Door Entry Kit



The ASV73 Genway Four-wire Video Entry System has a 3.5" colour flat screen monitor with buttons for speech and lock release.

The kit also includes a robust compact door station for the outside and a power transformer with connections. The modern appearance makes the kit ideal for one-way entry which compliments any interior. The robust door station also has a protective weather cover and a waterproof sheet on the back for mounting on an exposed wall.

Features & Benefits

- Surface mounted 3.5" colour monitor
- Four-wire connection
- Hands-free monitor
- Monitor has buttons for lock release, picture recall and talk
- Monitor has indicators for power, busy and mute
- Adjustments can be made on the monitor for ring and speech volume
- Double ring tone
- Wall mounting plate for monitor to conceal fixings
- Single call button on door station
- Surface mounted robust and compact door station
- Weather proof sheet supplied for cable protection when used on an external wall
- Power to Unlock or Fail Secure locking devices such as the ADCN203+S Electric Release can be connected direct to the door station

ASV73 Four-wire Colour Video Entry System

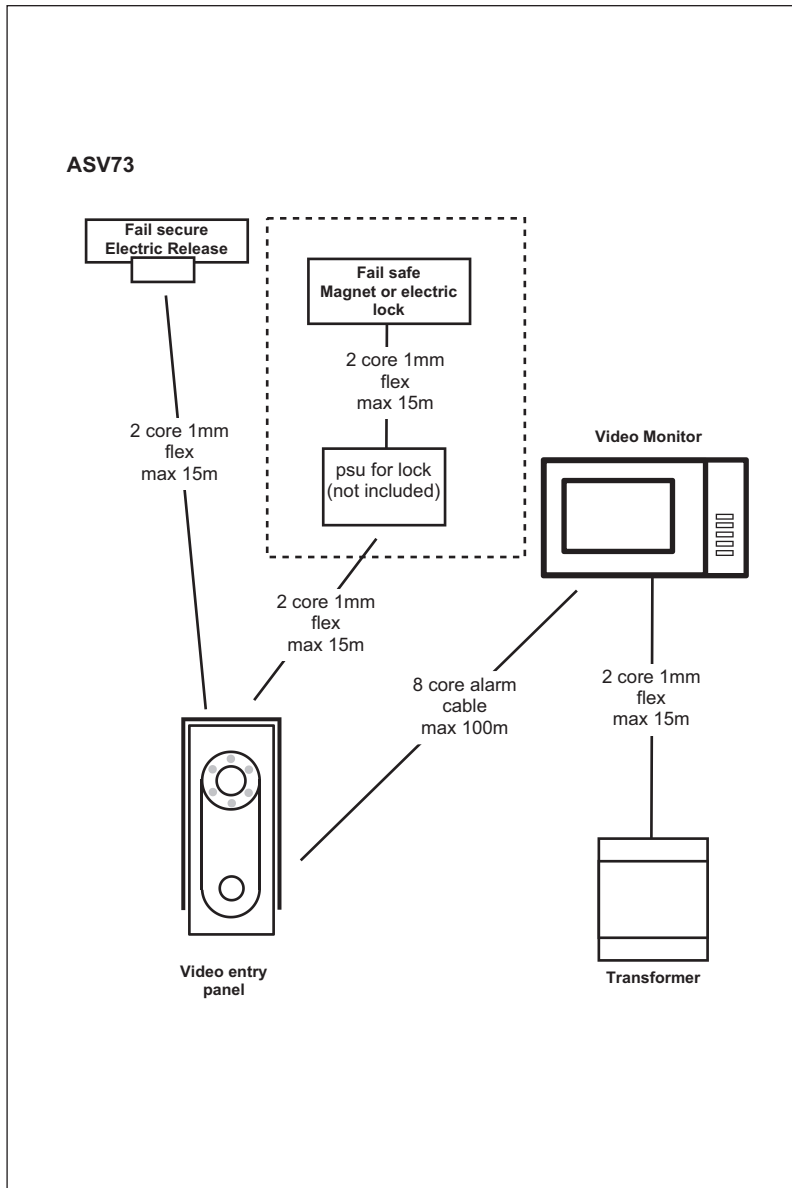

ASV73	Monitor	Door Station
Dimensions	H120 x W185 x D32	H133 x W54 x D48
Weight (Kg)	0.36	0.7
Finish	White	Champagne
Material	Various	Zinc Alloy
Screen	3.5" TFT	-
Resolution	234 x 320	-
Operating Voltage	14v DC	14v DC
Operating Current	700mA	200mA
Standby Current	100mA	30mA
Temperature	-10°C to +55°C	-40°C to +70°C
Humidity	10% to 95%	10% to 95%
Camera	-	Colour CCD & CMOS, PAL system.
Camera Visible Angle	-	90°
Camera Light Source	-	White light LED
Minimum Illumination	-	0.1 Lux.

Additional Information

- The monitor and door station can be fitted up to 50m apart, however for to improve the reception quality it is recommended to include a 6-core alarm cable. For distances over 50m RG59 coax cable is recommended.
- An additional PSU is required for the Power to Lock or Fail Safe locking devices, such as Electro-Magnets.

The Kit Includes

- Robust door station
- Internal monitor with 3.5" TFT screen
- Monitor mounting plate, connections and fixings
- Power transformer
- User manual

For further information contact:
 Securefast Plc
 Unit 6 & 7 Cedar Business Centre
 Avon Road, Cannock
 Staffordshire WS11 1QJ

call > 01704 502 801

email > sales@tatecolson.co.uk

visit > www.securefast.co.uk