

Commissioning

- Refit to front cover to the product using the supplied screws.
- Replace fuse or circuit breaker and switch on. Your light is now ready for use.

Operational check

- Please note that the unit will not illuminate in emergency mode until the mains has been switched on and subsequently failed.
- Restore the mains supply for at least 30 minutes and then turn it off. The LED lamp should illuminate for at least 30 seconds.
- Switch on the Mains Supply and note the indicator LEDs on the side of the unit have illuminated. This indicates that the unit is operating correctly e.g. the lamp continuity is correct and that the battery is being charged.
- The unit has built in High Discharge Protection and this should operate when the battery voltage fails to approximately 8V DC, whilst in emergency mode

Fitting/replacing bulbs

- The LED's in this product are non replaceable.

Care and cleaning

We recommend cleaning with a soft dry cloth. Do not use solvents or abrasive cleaners as these could damage the finish.

Recycling advice



Waste electrical products should not be disposed of with household waste. Please recycle where facilities exist. Check with your Local Authority or retailer for recycling advice.

Safety information

For your safety, always switch off the supply before installation or cleaning.



Installation and Safety Instructions

Protek Non-Maintained Emergency Wall Light



Thank you for purchasing this light fitting. Please read the instructions carefully before use to ensure safe and satisfactory operation of this product. Please retain these instructions for future reference.

Warning

This light fitting is Class 1 and must be connected to an Earth circuit

Please read these instructions carefully before commencing any work.

This unit must be fitted by a competent and qualified electrician.

Install in accordance with IEE Wiring regulations and current Building Regulations.

To prevent electrocution switch off at mains supply before installing or maintaining this fitting. Ensure other persons cannot restore the electrical supply without your knowledge. If you are in any doubt, please consult a qualified electrician.

This light fitting should be connected to a fused circuit.

If replacing an existing fitting, make a careful note of the connections.

This system contains non-replaceable parts and cannot be serviced. If damage occurs the part should be scrapped.

Waste electrical products should not be disposed of with household waste. Please recycle where facilities exist. Check with your local authority or retailer for recycling advice.

This product is rated at IP20.

This product is not suitable for dimming.

Specification

Voltage:	240V 50Hz a.c.
Lamp:	2 x 3W High Power LED - non replaceable
IP rating:	20
Battery:	9.6V 2200mah, 3hrs duration.

Layout

- Plan the desired layout of this fitting carefully, ensuring the cables will reach the distance between the junction box and the light fitting
- Avoid locating any cables in positions that would cause a hazard. Position cables and junction boxes (not supplied) away from areas where they may be at risk from being cut, trapped or damaged
- Cables in walls must be protected using suitable conduit or plastic trunking.
- The mains supply cable must have a minimum cross sectional area of 1.0mm²
- There must be at least 20mm free air circulation around the fitting.

Installation

Existing fittings must be completely removed before installation of a new product. Before removing the existing fitting, carefully note the position of each set of wires.

- Undo the two screws that hold the front cover and remove the lid by lifting and sliding it out.
- Hold the product in position and mark the location of the three fixing holes. Drill holes and fit supplied wall plugs (suitable for masonry only - for other surfaces use

appropriate fixings). Fix product to the wall using the supplied screws. Take care to avoid damaging any concealed wiring and pipes.

- Pierce a hole in the rubber grommet at either side of the product and feed the incoming supply cable through it.
- Wire as detailed below.

Fixing holes on front cover

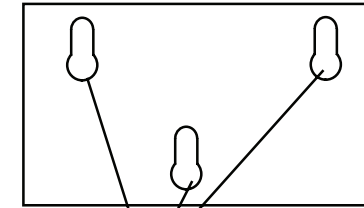
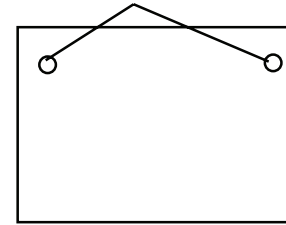

Fixing holes on back of product

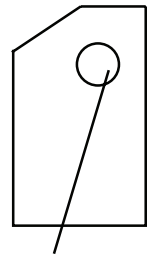

Rubber grommet on side of product.

Wiring

Having correctly identified the wiring from your existing light fitting and connect to the

connection block inside the product in the following way:

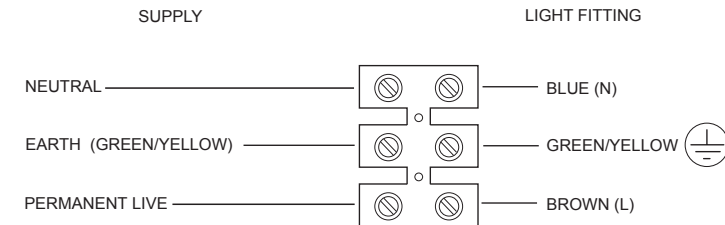

Check that...

- You have correctly identified the wires.
- The connections are tight.
- No loose strands have been left out of the connection block.