

# pushbutton & touchsensor

energysense  
energystyle  
energyoutdoor

## pushbutton & touchsensor fitting and operating instructions

### pushbutton/touchsensor master unit - two wire

**Product:** 350A-1, 350A-2, 360A-1, 360A-2, 750A-1, 760A-1,  
550A-3, 550A-4, 560A-3, 560A-4 Two wire

#### Rating at 240V ac

- Incandescent 16A
- Compact Fluorescent 16A
- Resistive 16A
- Fluorescent 16A
- Time Delay 2min - 2h

The pushbutton/touch timer are part of the Elkay family of switches, timers and detectors which save energy and increase convenience in and around your home, garden or premises.

#### Usage

The push button/touch timer are general purpose time controls. Applications for suitable use include lighting and some heating and ventilation controls. The timers can be used independently or as a master unit when using slave trigger switches. One master product only for each circuit being switched with additional slave units at other positions in the circuit.

WHEN USED WITH SOME LOW WATTAGE LIGHTING, HEATING AND VENTILATION CIRCUITS PLEASE ENSURE A CAPACITOR OF 2 MICROFARADS (MINIMUM) IS FITTED. SUPPLIES OF SUITABLE ELKAY CAPACITORS CAN BE FOUND AT YOUR STOCKIST (REF PFCC-1)

**IMPORTANT** Please note that it is essential that the live in and live out are identified prior to commencing the installation and steps 1 – 3 are followed precisely. No neutral is required on this product (See diagram 1). Do not install the switch timer with the mains power on as this can damage the product.

NOT SUITABLE FOR USE WITH CONTACTORS. DO NOT MEGGER TEST OR INSULATION RESISTANCE TEST THIS PRODUCT. REMOVE BEFORE TESTING OR TEST CIRCUIT PRIOR TO FITTING.

Your Elkay unit is compatible with a single gang, 25mm deep British Standard accessory plate. Please ensure that the top and bottom lugs are removed from metal wall boxes prior to fitting. For 16mm boxes Elkay provide a spacer plate (product code220A-1) to take box depth to 25mm.

#### Slave fitting

When connecting with slaves use three core cable connecting the live in, live out and trigger terminals as shown in Diagram 2. The optional wire to the slaves only applies to the 350A and 550A push button slave units and is ideal for retrofitting (See diagram 2).

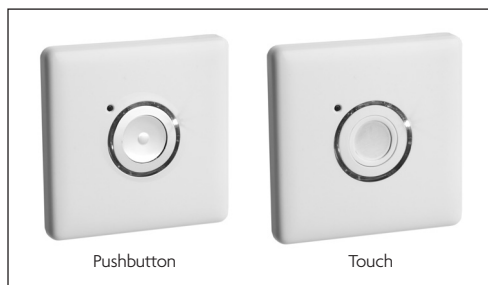
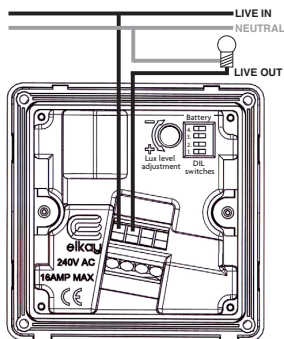

Diagram 1

Wiring diagram for a single sensor unit.



Please note that the trigger terminal is the third terminal. This product requires a 24 hour power supply. The battery inside the unit recharges when the light source or appliance is switched OFF. Where the supply may be interrupted or isolated regularly we must recommend our products from the three wire range.

#### Installation Steps

DO NOT APPLY MAINS UNTIL INSTRUCTED!

**Step 1** - Ensure that the mains power to the circuit is switched off. Place the previously identified Live in into the terminal marked L in and the switched Live Out into the L Out terminal.

**Step 2** - Switch the battery (switch 4) – you will notice a red LED light flashing on the front of the unit- which will be flashing rapidly. Whilst this is in action please select the desired timings by selecting the appropriate time settings shown in diagram 3.

#### IMPORTANT NOTICE

All wiring should be carried out by a competent person or a qualified electrician and should be fitted to IEE 17th Edition Wiring regulations BS7671:2008.

Elkay

Call +44 (0) 1675 468222 or click [www.elkay.co.uk](http://www.elkay.co.uk)

# pushbutton & touchsensor

energysense  
energystyle  
energyoutdoor

## pushbutton & touchsensor fitting and operating instructions

### Diagram 2

Wiring diagram for a sensor unit with slave.

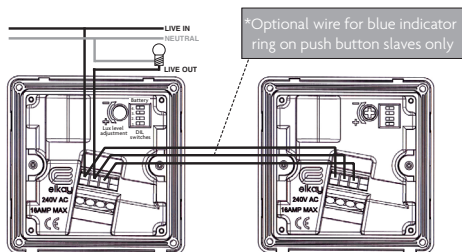

**Step 3** - Attach the unit with the screws to the wall, then clip on the front fascia plate. The red LED light will now change to a single flashing light every 3 seconds approximately. You are now ready to apply the mains power. The light or chosen appliance will now start. Press and hold the button, the red flashing light goes off and the blue locator ring will light up around the push button/touch pad. Your light source or appliance will now be switched off and ready for operation.

### Operation

1. Press the pushbutton/touch pad and the red LED will light once. Your light source or appliance will now be switched on. Please note that the pushbutton has an audible click.
2. At any time during the working of the light source or appliance, the push button/touch pad can be pressed to reset the timing sequence to the originally set time, e.g when the timing period is 30 minutes, if pressed 15 minutes into the sequence, the timer will reset to 30 minutes.
3. To end the timing sequence prematurely, press and hold the push button/touch pad until the red LED flashes

continuously indicating the last minute countdown is in operation. Your light source or appliance will now be switched off, after one minute.

4. At one minute prior to the end of the timing sequence, the red LED will begin to flash continuously for the last minute of operation. The blue locator ring will then illuminate once the light source or appliance has gone off.

### Operation Notes

If the Elkay Timer does not receive power then the unit will put the unit into sleep mode to conserve the battery. To reactivate the unit press and hold for a period of 15 seconds approximately, the red LED should start to flash, release button, the LED changes to a flash every 3 seconds press and hold again until load switches off. The unit will attempt to latch on to the mains power 25 times automatically before going to sleep mode as mentioned above.

### Outdoor Installation

Please note only products in the Elkay energy outdoor range are suitable for use outdoors. Elkay energy outdoor can only be used in conjunction with the surface mount box supplied. Take the surface mount box and remove the knock out section. If required and to ensure IP66 waterproof rating, please use a suitable M20 cable gland and use appropriate sealing washers. Mount the surface mount box on a secure surface using the mounting pack supplied. Place screw cover seals over the mounting screws. It is essential that the correct IP66 rated connections are made to keep the IP66 rating of the back box. Steel wire armored connections without seals are not appropriate.

Turn off mains supply before proceeding with installation - Install as per previous remote installation instructions - Mount unit onto surface mount box using the fixing screws at all four corners ensuring even connection with the seal - Place screw hole seals over left and right screw cavities - Clip on front fascia plate - Re-instate mains supply.

### Diagram 3 - time settings

Please note that the black bar denotes the position of the dip switch.

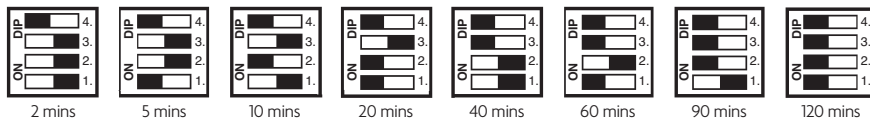

For further wiring diagrams and more information on our products please visit our website on [www.elkay.co.uk](http://www.elkay.co.uk)

### IMPORTANT NOTICE

All wiring should be carried out by a competent person or a qualified electrician and should be fitted to IEE 17th Edition Wiring regulations BS7671:2008.

### TECHNICAL HELPLINE

For further help or assistance or information on this or other products in the range please call the Elkay Technical team on 01675 468222. Please call the Technical helpline before returning any products to your stockist. In the unlikely event that you have to return your product please ensure you switch the battery off first.



Elkay Electrical, Coleshill, Birmingham, England.

Tel: +44 (0) 1675 468222 [www.elkay.co.uk](http://www.elkay.co.uk)