

## BATTERY REPLACEMENT

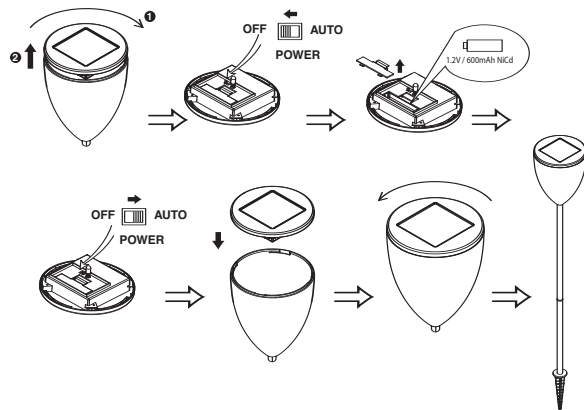

- 1 Unclick by turning top of Solar light clockwise
- 2 Remove top of solar light
- 3 Turn power switch to OFF
- 4 Open battery compartment
- 5 Remove old battery
- 6 Insert new battery (ensuring + terminal meets with + battery end)
- 7 Close battery compartment
- 8 Turn power switch to ON / Auto
- 9 Replace top of solar light
- 10 Turning top of solar light anti clockwise until it clicks back into place

## PRODUCT DISPOSAL



NiCd battery must be recycled or disposed of properly.



Environmental Protection  
Waste electrical products should not be disposed of with household waste.  
Please recycle where facilities exist. Check with your Local Authority or retailer for recycling advice.

“Ryobi takes the care of our environment very seriously. Please dispose of all waste electrical and electronic equipment in a responsible and environmentally friendly way.”

## CAUTION

Please be aware children should not use these as toys and care should be taken at all times.



The Fine Lighting Company International Ltd.  
Medina House, Fieldhouse Lane, Marlow, Bucks SL7 1TB  
Tel: 01628 894 400 Fax: 01628 894 401  
Email: [sales@thefinelightingcompany.com](mailto:sales@thefinelightingcompany.com)  
Web: [www.thefinelightingcompany.com](http://www.thefinelightingcompany.com)  
Technical Helpline: 01628 894 500

All of the Fine Lighting Company™ products include a 1 year warranty The Fine Lighting Company™ reserve the right to change images, specifications and prices without prior notice.



### DECLARATION OF CONFORMITY

We declare under our sole responsibility that this product is in conformity with the following standards or standardized documents.

#### Applicable EC Directive:

EC Directive of electromagnetic Compatibility (89/336/EEC) with amendments

#### Applicable Harmonized Standard:

EN55015/A2:2002  
EN61547/A1:2000  
EN61000-6-3/A11:2004  
Model: SW-377W  
Description: 2 Solar Frosted Dome Lights

Mark Pearson – Managing Director

SW-377W

# AURA

## 2 Solar Frosted Dome Lights

## Instruction Manual



SW-377W

# AURA

## 2 Solar Frosted Dome Lights

The solar light comprises of a solar cell, rechargeable batteries and LED light source. Light from the sun charges the batteries during the day and at night the energy stored in the batteries is used to power the light.

The length of time the light stays on for is dependent on the amount of sunlight the solar panel has been exposed to during the day.

No other power source or connections are required.

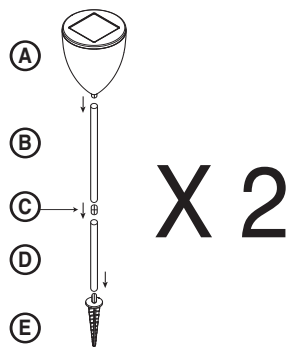

### PACK CONTENTS

- 2 x Solar light units (A)
- 2 x Post pipe in 27cm (B)
- 2 x Connectors (C)
- 2 x Post pipe in 20cm (D)
- 2 x Ground spikes (E)

### WARNING

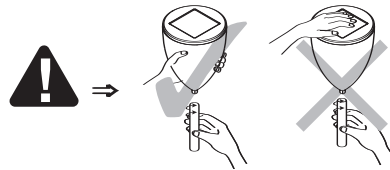

Do not apply pressure to the solar panel.

### PRIOR TO USE

Check the pack contents to make sure you have all the products listed.

Set power switch to "OFF" position and allow battery to charge for 2 days under full sunlight. Repeat this procedure every three months to top up the battery. Please note, this may take longer if there is not constant full sunlight.

Decide on an appropriate location for your product (see Siting Instructions opposite)

### ASSEMBLY INSTRUCTIONS

- 1 Insert Solar light unit into 27cm post pipe
- 2 Then insert connector piece into 27cm post pipe
- 3 Push 20cm post pipe onto connector piece
- 4 Insert ground spike into free end of 20cm post pipe

### SITING INSTRUCTIONS

Solar lights are designed for use outside in an open (un-shaded) location

The solar light should be located where sunlight can fall directly on the unit. Shadows from buildings, trees, walls, hedges or similar should be avoided as these will reduce your light running time.

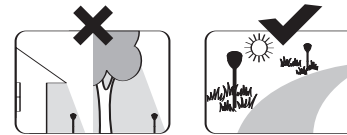

Avoid locations where light from other sources will fall on the panel at night (street lights, floodlights etc) as this may prevent the light from turning on.

The units can be left outside in the rain but should not be exposed to water jets or immersed in any way.

### PRODUCT SPECIFICATIONS

Product Size	11.4cm (L) x 11.4cm (W) x 60cm (H) + 9.5cm (spike)
Solar Cell	0.16W Amorphous
Light Source Type	1 x white LED (per unit)
Laser Classification	Class 1
Surface Material	Stainless Steel
Battery Type	1 x 1.2V NiCd (AA) 600mAh (per unit)
Maximum UK operating Time (summer)	8 hrs
Maximum UK operating Time(winter)	3 hrs
Maximum operating Time (full charge)	12 hrs

For optimum life, the solar panel should be protected from weather extremes such as snow or frost

Do not position near direct sources of heat such as patio heaters or barbecues

The Solar panel is designed to be placed where the ground is soft so that the ground spike can be pushed in easily.

### CARE & USE

Periodically wipe clean with a soft dry cloth. Never use scourers, abrasives or chemical cleaners. Do not allow water to come into contact with electric components.

The solar panel lens should be cleaned periodically to ensure its efficiency is not reduced by dust and dirt.

Some condensation may form inside the lights or solar panel in cold conditions. This is normal and will not affect the performance of your light.